

Series 4, Frontloader Washing Machine, 8 kg, , Silver inox WAN282X1ZA



A+++



Automatic washing machine with EcoSilence Drive™: quiet operation and durability that you can rely on.

- **Active Water Plus:** For highly efficient use of water even with smaller loads thanks to automatic load detection.
- **Eco Silence Drive™:** Quiet and energy-efficient drive, with a 10-year warranty.
- **AntiWrinkle:** Reduces wrinkles by up to 50%
- **Speed Perfect:** perfectly clean in up to 65% less time
- **Speed Perfect:** perfectly clean in up to 65% less time
- .
- **Dark Colors program:** ideal for gentle cleaning of dark-coloured laundry, such as jeans.

Technical data

Built-in / Free-standing : Free-standing

Door hinge : Left

Color / Material body : Silver inox

Length electrical supply cord : 160 cm

Height of the appliance : 848 mm

Dimensions of the product : 848x598x590 mm

Wheels : No

Net weight : 70.5 kg

Drum volume : 65 l

Connection rating : 2300 W

Fuse protection : 10 A

Voltage : 220-240 V

Frequency : 50 Hz

Capacity cotton - NEW (2010/30/EC) : 8.0 kg

Energy efficiency class : A+++

Energy consumption annual - NEW (2010/30/EC) : 137.00 kWh/annum

Power consumption in off-mode - NEW (2010/30/EC) : 0.10 W

Power consumption in left-on mode - NEW (2010/30/EC) : 0.50 W

Water consumption annual - NEW (2010/30/EC) : 9900 l/annum

Maximum spin speed - NEW (2010/30/EC) : 1400 rpm

Average washing time cotton 40C (partial load) - NEW (2010/30/EC) : 160 min

Average washing time cotton 60C (full load) - NEW (2010/30/EC) : 210 min

Average washing time cotton 60C (partial load) - NEW (2010/30/EC) : 160 min



4 242005 381470

Series 4, Frontloader Washing Machine, 8 kg, , Silver inox WAN282X1ZA

Automatic washing machine with EcoSilence Drive™: quiet operation and durability that you can rely on.

- Ferrite-BLDC
- BLDC with warranty

Engine power/Consumption

- Capacity: 8 kg
- Energy Efficiency Class: A+++
- Energy consumption :137 kWh per year, based on 220 standard washing cycles
- Energy consumption:standard 60 °C cotton programme 1 kWh full load and 0.32 kWh partial load and 40 °C cotton programme 0.32 kWh partial load
- Weighted power consumption off-mode / left-on mode: 0.1 W / 0.5 W
- Water consumption 9900 litres per year, based on 220 standard washing cycles
- B spin class
- Maximum spin speed: 1400rpm
Remaining moisture: 53 %
- Programme time:60 °C cotton programme 210 min at full load 160 min at partial load and 40 °C cotton programme 160 min partial load
- Programme time:60 °C cotton programme 210 min at full load 160 min at partial load and 40 °C cotton programme 160 min partial load
- Noise level spinning:73dB (A) re 1 pW:

Programmes

Options

- VarioPerfect: time- or energy optimized programs with perfect wash performance
- Touch control buttons

Comfort and Safety

- Reload function: Be flexible in adding laundry items even after start of the wash cycle.
- waveDrum
- Multiple water protection
- Large display for programme progress indication, temperature, spin speed, remaining time, 24 h end time delay and load recommendation
- Large display for temperature, spin speed, remaining time, 24 h end time delay and load recommendation
- Fully electronic control dial for all wash- and special programs
- AntiVibration Design: more stability and quietness
- 3D AquaSpa wash system with cascade for faster water penetration
- Recommended Load
- Loading introduction
- Foam detection system
- Safeguard monitoring system adjusts load distribution
- easy clean
- Child Lock
- Buzzer
- Metal door catch
- magnet with pull-open latch

General Information

- Dimensions (H x W x D): 84.8 x 59.8 x 59 cm
- Slide-Under

**Series 4, Frontloader Washing Machine, 8
kg, , Silver inox
WAN282X1ZA**

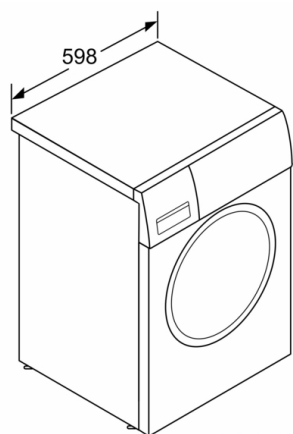

measurements in mm

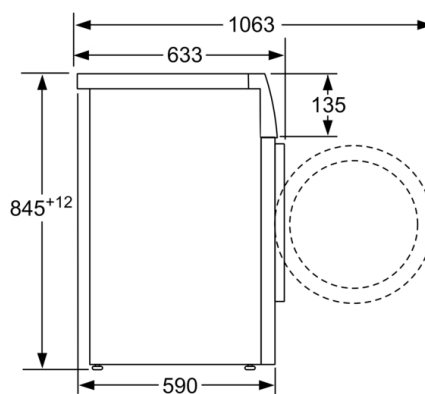

measurements in mm