

**Series 8, 175.6 x 91.2 cm, Black  
KAD92SB30**



**Included accessories**

- 2 x cold accumulator
- 1 x connection hose
- 1 x egg tray
- 1 x cartridge for water filtering system

**A large capacity Side-by-Side fridge-freezer with VariolInverter, VitaFresh Plus and ice-&-water dispenser with LED illumination. The Premium Touch panel provides you absolute control of your fridge with ease.**

- **Ice and water dispenser:** dispenses cool water and ice cubes at the push of a button
- **VitaFresh Plus:** keeps fruits and vegetables fresh for up to 2 times longer.
- **2 cooling circuits:** separately controllable refrigerator and freezer compartments

**Technical Data**

Built-in / Free-standing : Free-standing  
 Number of compressors : 1  
 Number of independent cooling systems : 2  
 Width of the product : 912 mm  
 Height : 1756 mm  
 Depth of the product : 732 mm  
 Net weight : 156.8 kg  
 Door panel options : Not possible  
 Door hinge : left and right  
 Number of Adjustable Shelves in fridge compartment : 3  
 Shelves for Bottles : Yes  
 Interior ventilator : No  
 Reversible Door Hinge : No  
 Length electrical supply cord : 240 cm  
 Noise level : 42 dB(A) re 1 pW  
 Multi-Flow Air Tower : Yes  
 Fast cooling switch : Yes  
 Fast freezing switch : No  
 Carbon Air Filter : No  
 Temperature Controlled Drawer : No  
 Humidity Control Drawer : No  
 Number of Door Bins - Refrigerator : 5  
 Door bin adjustability - Refrigerator : No  
 Tilt-out door bins in fridge : Yes  
 Number of Gallon storage : 2  
 No. of shelves in fridge : 4  
 Number of shelves - Freezer : 2  
 Shelf Adjustability - Freezer : Yes  
 Capacity of Water Tank : 1.0 l  
 Connection Rating : 190 W  
 Fuse protection : 10 A  
 Voltage : 220-240 V  
 Frequency : 50-60 Hz  
 Energy efficiency class (2010/30/EC) : A++  
 Energy consumption annual - NEW (2010/30/EC) : 348.00 kWh/annum  
 Refrigerator Net capacity - NEW (2010/30/EC) : 368 l  
 Freezer Net capacity - NEW (2010/30/EC) : 173 l  
 Freezing capacity) - NEW (2010/30/EC) : 12 kg/24h  
 Storage Period in Event of Power Failure (h) : 12 h  
 Approval certificates : CE, VDE  
 Color / Material body : Chrome Inox-metallic  
 Door panel options : Not possible  
 Noise level : 42 dB(A) re 1 pW  
 Energy Star Qualified : No  
 Required cutout/niche size for installation (in) : x x  
 Dimensions of the packed product : 74.25 x 38.58 x 32.87  
 Net weight : 346.000 lbs  
 Gross weight : 375.000 lbs  
 Product name / Commercial code : KAD92SB30

## **Series 8, 175.6 x 91.2 cm, Black KAD92SB30**

**A large capacity Side-by-Side fridge-freezer with VariolInverter, VitaFresh Plus and ice-&-water dispenser with LED illumination. The Premium Touch panel provides you absolute control of your fridge with ease.**

### **General Data**

- Gross Capacity (Total) : 636 L
- Net Capacity (Fridge) : 368 L
- Net Capacity (Total) : 541 L
- Net Capacity (Freezer) : 173 L
- Appliance Height : 1756 mm
- Appliance Width : 912 mm
- Appliance Depth : 732 mm
- Gross Weight: 162.8 Kg
- Net Weight: 170.0 Kg

### **Cooling System**

- Supercooling - Automatically brings down the temperature of the refrigerator to cool new groceries rapidly.
- Superfreezing - Automatically brings down the temperature of the freezer to keep cool new items rapidly.
- Multiairflow system - Minimises fluctuating temperatures by ensuring optimal and uniform air circulation in the fridge.
- NoFrost - Saves you time and effort from defrosting.

### **Convenience & Safety**

- LED illumination in fridge and freezer sections and ice-water dispenser
- Premium Touch Electronic Panel to set temperature and features of your refrigerator
- Separate temperature controls for Fridge and Freezer
- Energy saving preset mode with Eco and Vacation modes
- Alarm system to alert the prolonged opening of refrigerator doors
- easy positioning and handling with appliance on 4 wheels
- Adjustable front feet for added stability
- NoFrost - Saves you time and effort from defrosting.

### **Fridge Compartment**

- 1 VitaFresh Plus drawer keeps food fresh for up to twice as long
- 1 VitaFresh box so fish and meat stay fresh for longer.
- 1 Vegetable container for extra storage
- 4 Safety glass shelves, of which, 3 are adjustable
- 1 Dairy compartment
- 2 door trays (large)
- 3 door trays (Small)
- 1 wine rack

### **Freezer Compartment**

- Automatic Ice-Water dispenser which dispenses water, ice-cubes and crushed-ice
- 2 drawers, of which 1 is bigbox, capable of storing large-sized packaging
- 2 storage drawers on extension rail systems for easy pull-out
- 3 safety glass shelves, of which, 2 are adjustable
- 4 door trays
- Freezing capacity: 12 kg/24 h

### **Design and Styling**

- Stainless-Steel with fingerprint resistant door finishing for easy cleaning
- Vertical Aluminum Door handle

### **Accessories**

- 1 egg tray
- 1 x Water filter(s)
- 1 x Connection hose(s)

## Series 8, 175.6 x 91.2 cm, Black KAD92SB30

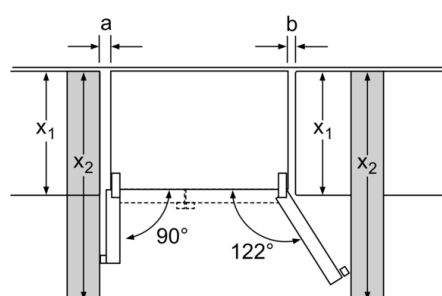
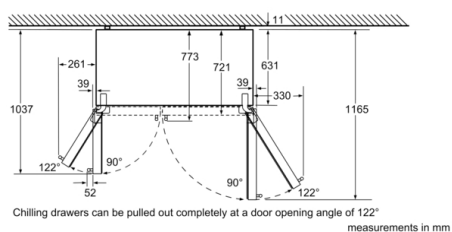

$x_1$ (unit depth)	a	b
600	39	39
650	39	53
700	39	85
$x_2$ (wall)	105	330

measurements in mm

