

**Benchmark®, Speed Oven, 30",
Stainless Steel
HMC80251UC**



**The Speed Oven Pairs the Cooking
Qualities of a Conventional Oven With the
Speed of Microwave Technology**

- **Stainless steel interior:** easy to clean interior thanks to smooth surfaces and no sharp edges.
- **Over-the-Range Microwave:** designed to install with a Bosch range or cooktop.
- **2-in-1 Experience:** offers a variety of cooking options by combining a microwave and convection oven.
- **Triple Distribution Turntable:** offers more even cooking by distributing heat effectively.
- **Electrical Connection - 240 Volt Direct Wire**

UPC code: 825225908555
 Product color: Stainless Steel
 Watts: 3840 W
 Fuse protection:20 A
 Volts:208-240 V
 Frequency: 60 Hz
 Power Cord Length: 48"
 Plug type:fixed connection
 Required Cutout Size (HxWxD) (in): 19 1/4" + 28 1/2" x 23 1/2"
 Overall Appliance Dimensions (HxWxD) (in): ..19 5/8" x 29 3/4" x 21 3/8"
 Product Packaging Dimensions (HxWxD): 23.62 x 26.29 x 33.85
 Net Weight: 86.000 lbs
 Gross Weight:96.000 lbs
 Included Accessories: 1 x grid



Benchmark®, Speed Oven, 30", Stainless Steel HMC80251UC

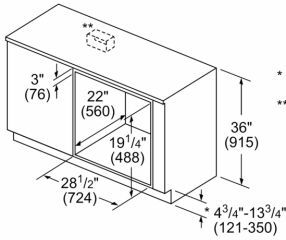

* Includes 3/4" (19) base plate
** Receptacle may be located to the left or right of the unit within reach of the power cord.

measurements in inches (mm)

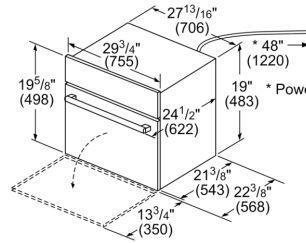

* 48" (1220)
* Power cord with plug on 120 V units is 43" (1092)

measurements in inches (mm)

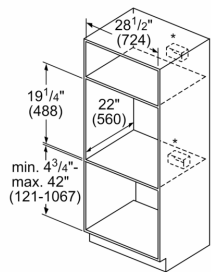

* Receptacle may be located above or beneath the unit within reach of the power cord.

measurements in inches (mm)

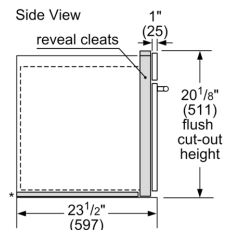
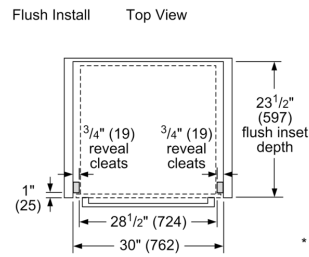

* Flush installation requires a 5/16" (8 mm) high x 28 1/2" (724 mm) wide x 22 1/2" (571 mm) deep baseplate underneath the unit body.

measurements in inches (mm)