

## Series 8, washing machine, front loader, 9 kg, 1400 rpm WAV28M60TH



WMZ2200 Floor securing component  
WMZ2381 Extension for cold water inlet /Aquastop  
WMZPW20W Platform with pull-out, washer, cubic

## Remove common stains quickly and easily with Bosch Anti-Stain technology for greater peace of mind everytime

- **EcoSilence Drive™** friction-free motor minimises heat and wear for long-lasting performance, quiet operation and perfect wash results.
- **SpeedPerfect:** perfectly clean in up to 65% less time.
- **AllergyPlus** programme: suitable for allergy sufferers.
- **Vario Drum:** gently and efficiently wash with even water distribution and without creasing garments.
- **Anti-Vibration Side Panels** reduce vibrations and ensure greater stability during the washing and spinning process

Built-in / Free-standing: ..... Free-standing  
Door hinge: ..... Left  
Color / Material body: ..... White  
Length electrical supply cord: ..... 160.0 cm  
Height of the appliance: ..... 848 mm  
Dimensions of the product: ..... 848x598x590 mm  
Wheels: ..... No  
Net weight: ..... 72.8 kg  
Drum volume: ..... 65 l  
Door Frame: ..... Chrome, blackgray  
Noise level washing: ..... 47 dB(A) re 1pW  
Connection Rating: ..... 2300 W  
Fuse protection: ..... 10 A  
Voltage: ..... 220-240 V  
Frequency: ..... 50 Hz  
Energy Star Qualified: ..... No  
Cord Included: ..... Yes  
Plug type: ..... Thai plug  
Length of supply hose (in): ..... 59.05 "  
Dimensions of the packed product: ..... 34.44 x 25.19 x 26.57  
Net weight: ..... 161.000 lbs  
Gross weight: ..... 162.000 lbs  
Length of drain hose: ..... 150.00 cm  
Length of supply hose: ..... 150.00 cm  
Dimensions of the packed product (HxWxD): ..... 875 x 640 x 675 mm  
Gross weight: ..... 73.6 kg  
Connection Rating: ..... 2300 W  
Fuse protection: ..... 10 A  
Voltage: ..... 220-240 V  
Frequency: ..... 50 Hz  
Water protection system: ..... Multiple water protection  
Maximum spin speed: ..... 1400 rpm  
Spin speed options: ..... Variable  
Digital countdown indicator: ..... Yes  
Drying progress indicator: ..... LED-display  
Maximum capacity in kg (EU 2017/1369): ..... 9.0 kg



## **Series 8, washing machine, front loader, 9 kg, 1400 rpm WAV28M60TH**

**Remove common stains quickly and easily  
with Bosch Anti-Stain technology for  
greater peace of mind everytime**

---

### **Technical Information**

- Capacity: 9kg
- Maximum spin speed : 1400 rpm
- Dimensions (H x W x D): 84.8 x 59.8 x 59 cm
- 32 cm porthole, 171° swing door

### **Programmes**

- Cottons Cottons Eco, Synthetics, PowerMix 59', Delicates/Silk, Wool, Rinse, Spin/Drain, Drum Clean, Quick 15/30min, Quilt/Blanket, Shirts/Blouses. AllergyPlus, Automatic 30°
- AntiStain: Automatic stain removal of the most common stains
- Clean your laundry in just 59minutes with PowerMix 59'
- AllergyPlus effectively reduces allergenic residue such as pollen, animal hair, and dust mites at the touch of a button and is suitable for those with sensitive, irritable skin
- Time delay to select end time of your wash (1 - 24 hours) and time remaining indicator
- Reload function to pause machine operation for adding in last minute laundry items

### **Features**

- EcoSilence Drive™ friction-free motor minimises heat and wear for long-lasting performance, quiet operation and perfect wash results.
- ActiveWater™ Plus: Pressure and water sensor that measures the washing load and adjusts water intake to 256 precise levels for more cost and water savings
- VarioDrum's breakthrough wave-droplet design provides a thorough yet gentle clean for fine textiles
- Anti-Vibration Side Panels reduce vibrations and ensure greater stability during the washing and spinning process.

### **Safety**

- Multiple water protection with magnetic valve to minimise risk of leakage
- Child-proof lock

### **Display Screen & Alerts**

- Large LED display screen to indicate: Programme status, Temperature and Spin Speed Selection, Remaining Time and 24 Hour End Time Delay, Load Recommendation and Consumption

**Series 8, washing machine, front  
loader, 9 kg, 1400 rpm  
WAV28M60TH**

---



measurements in mm

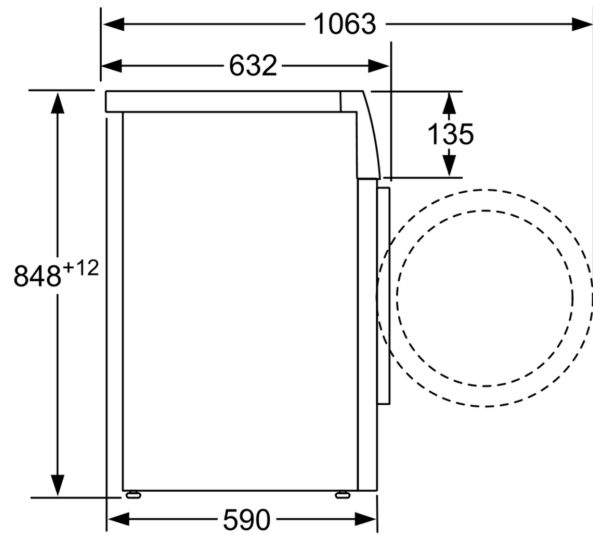

measurements in mm