

**Series 6, washing machine, front loader, 9 kg, 1400 rpm
WAT28461TH**



WMZ20490 Platform with pull-out
WMZ2200 Floor securing component
WMZ2381 Extension for cold water inlet /Aquastop

**German Engineered. Silent Powerful
Performance that Lasts**

Built-in / Free-standing:Free-standing
Door hinge:Left
Color / Material body:White
Length electrical supply cord:160.0 cm
Height of the appliance:848 mm
Dimensions of the product:848 x 598 x 590 mm
Wheels:No
Net weight:69.9 kg
Drum volume:63 l
Door Frame:Silver-black grey
Noise level washing:49 dB(A) re 1 pW
Connection Rating:2300 W
Fuse protection:10 A
Voltage:220-240 V
Frequency:50 Hz
Energy Star Qualified:No
Cord Included:No
Plug type:Thai plug
Length of supply hose (in):59.05 "
Dimensions of the packed product:34.25 x 24.80 x 26.37
Net weight:154.000 lbs
Gross weight:156.000 lbs
Length of drain hose:150.00 cm
Length of supply hose:150.00 cm
Dimensions of the packed product (HxWxD):870 x 670 x 630 mm
Gross weight:70.9 kg
Connection Rating:2300 W
Fuse protection:10 A
Voltage:220-240 V
Frequency:50 Hz
Water protection system:Multiple water protection
Number of Options:7
Maximum spin speed:1400 rpm
Spin speed options:Variable
Digital countdown indicator:Yes
Drying progress indicator:LED-display, LED
Maximum capacity in kg (EU 2017/1369):9.0 kg



Series 6, washing machine, front loader, 9 kg, 1400 rpm WAT28461TH

German Engineered. Silent Powerful Performance that Lasts

Technical Information

- Capacity: 9 kg
- Maximum spin speed: 1400 r/min
- Dimensions (H x W x D): 84.8 x 59.8 x 59 cm
- 32 cm porthole, 165° swing door

Programmes

- Cottons, Cottons+PreWash, Easy Care, Mix, Delicates, Wool, Drum Clean, Spin/Empty, Rinse, Sportswear. Jeans, Shirts, Duvet, Hygiene, Super15'/30'
- Time delay to select end time of your wash (1 - 24 hours) and time remaining indicator
- Reload function to pause machine operation for adding in last minute laundry items

Features

- Intelligent, durable and quiet iQdrive motor for highly effective and efficient laundry care
- VarioPerfect™: high performance programmes which allow you to clean your laundry with 50% less energy or reduce cleaning time by up to 65%
- ActiveWater™ Plus: Pressure and water sensor that measures the washing load and adjusts water intake to 256 precise levels for more cost and water savings
- VarioDrum's breakthrough wave-droplet design provides a thorough yet gentle clean for fine textiles
- Anti-Vibration Side Panels reduce vibrations and ensure greater stability during the washing and spinning process.
- Foam detection system to remove excessive foam

Safety

- Water protection system: Multiple Water Protection with magnetic valve to minimise risk of leakage
- Child-proof lock

Display Screen & Alerts

- LED display screen to indicate: Programme status, Temperature and Spin Speed Selection, Remaining Time and 24 Hour End Time Delay, Load Recommendation and Consumption
- TouchControl buttons: Start/Reload, Temperature, ecoPerfect/speedPerfect, Rinse Plus, Spin Speed Reduction
- Buzzer at end of program

**Series 6, washing machine, front
loader, 9 kg, 1400 rpm
WAT28461TH**



measurements in mm

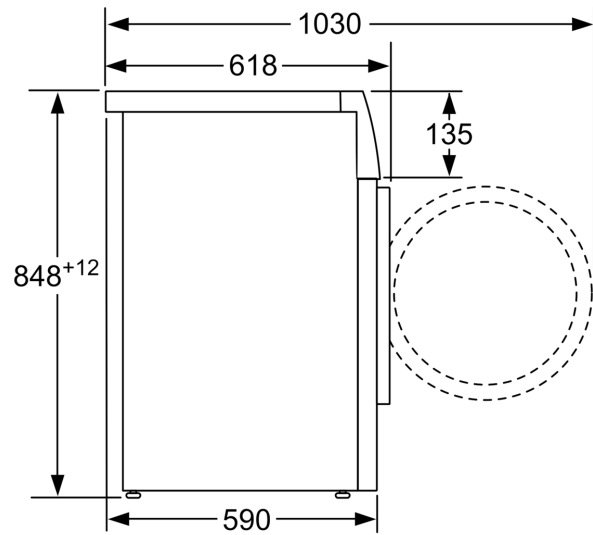

measurements in mm