

**Serie | 8, 175.6 x 91.2 cm, Black  
KAD92SB30**



**Included accessories**

2 x cold accumulator  
1 x connection hose  
1 x egg tray  
1 x cartridge for water filtering system

**A large capacity Side-by-Side fridge-freezer with VariolInverter, VitaFresh Plus and ice-&-water dispenser with LED illumination. The Premium Touch panel provides you absolute control of your fridge with ease.**

**Technical Data**

Built-in / Free-standing : Free-standing  
Number of compressors : 1  
Number of independent cooling systems : 2  
Width of the product : 912 mm  
Height : 1756 mm  
Depth of the product : 732 mm  
Net weight : 156.8 kg  
Door panel options : Not possible  
Door hinge : left and right  
Number of Adjustable Shelves in fridge compartment : 3  
Shelves for Bottles : Yes  
Interior ventilator : No  
Reversible Door Hinge : No  
Length electrical supply cord : 240 cm  
Noise level : 42 dB(A) re 1 pW  
Multi-Flow Air Tower : Yes  
Fast cooling switch : Yes  
Fast freezing switch : No  
Carbon Air Filter : No  
Temperature Controlled Drawer : No  
Humidity Control Drawer : No  
Number of Door Bins - Refrigerator : 5  
Door bin adjustability - Refrigerator : No  
Tilt-out door bins in fridge : Yes  
Number of Gallon storage : 2  
No. of shelves in fridge : 4  
Number of shelves - Freezer : 2  
Shelf Adjustability - Freezer : Yes  
Capacity of Water Tank : 1.0 Q  
Connection Rating : 190 W  
Fuse protection : 10 A  
Voltage : 220-240 V  
Frequency : 50-60 Hz  
Energy efficiency rating : A++  
Energy consumption annual - NEW (2010/30/EC) : 348.00 kWh/ annum  
Refrigerator Net capacity - NEW (2010/30/EC) : 368 Q  
Freezer Net capacity - NEW (2010/30/EC) : 173 Q  
Freezing capacity) - NEW (2010/30/EC) : 12 kg/24h  
Storage Period in Event of Power Failure (h) : 12 h  
Approval certificates : CE, VDE  
Color / Material body : Chrome Inox-metallic  
Door panel options : Not possible  
Noise level : 42 dB(A) re 1 pW  
Energy Star Qualified : No  
Required cutout/niche size for installation (in) : x x  
Dimensions of the packed product : 74.25 x 38.58 x 32.87  
Net weight : 346.000 lbs  
Gross weight : 375.000 lbs  
Product name / Commercial code : KAD92SB30



4 242002 811260

## Serie | 8, 175.6 x 91.2 cm, Black KAD92SB30

**A large capacity Side-by-Side fridge-freezer with VariolInverter, VitaFresh Plus and ice-&-water dispenser with LED illumination. The Premium Touch panel provides you absolute control of your fridge with ease.**

### General Data

- Gross Capacity (Total) : 22.5 Q
- Net Capacity (Total) : 19.1 Q
- Net Capacity (Fridge) : 13.0 Q
- Net Capacity (Freezer) : 6.1 Q
- Energy Consumption: 348 kWh/yr
- Appliance Height: 1756 mm  
Appliance Width: 912 mm  
Appliance Depth: 732 mm
- Gross Weight: 170
- Net Weight: 156.8

### Cooling System

- NoFrost - Saves you time and effort from defrosting
- Supercooling - Automatically brings down the temperature of the refrigerator to cool new groceries rapidly.
- Superfreezing - Automatically brings down the temperature of the freezer to keep cool new items rapidly.
- Multiairflow system - Minimises fluctuating temperatures by ensuring optimal and uniform air circulation in the fridge.

### Convenience & Safety

- LED Illumination in fridge and freezer sections and ice-water dispenser
- Premium Touch Electronic Panel to set temperature and features of your refrigerator
- Separate temperature controls for Fridge and Freezer
- Energy saving preset mode with Eco and Vacation modes
- Alarm system to alert the prolonged opening of refrigerator doors
- Easy positioning and handling with appliance on 4 wheels
- Adjustable front feet for added stability

### Fridge Compartment

- 1 VitaFresh Plus drawer keeps food fresh for up to twice as long
- 1 VitaFresh box so fish and meat stay fresh for longer
- 1 Vegetable container for extra storage
- 3 Extension rail systems for easy pull-out of drawer-compartments
- 4 Safety Glass Shelves of which 3 are height adjustable and extendable
- 1 Dairy compartment
- 2 door trays (large)  
3 door trays (small)
- 1 wine track

### Freezer Compartment

- Automatic Ice-Water dispenser which dispenses water, ice-cubes and crushed-ice
- 2 drawers, of which 1 is bigbox, capable of storing large-sized packaging
- 2 storage drawers on extension rail systems for easy pull-out
- 3 glass shelves which are 2 are adjustable
- 4 door trays

### Design and Styling

- Sleek Black glass door finishing
- Aluminium vertical handle

### Accessories

- 1 x cartridge for water filtering system, 2 x cold accumulator, 1 x connection hose, 1 x egg tray

## Serie | 8, 175.6 x 91.2 cm, Black KAD92SB30

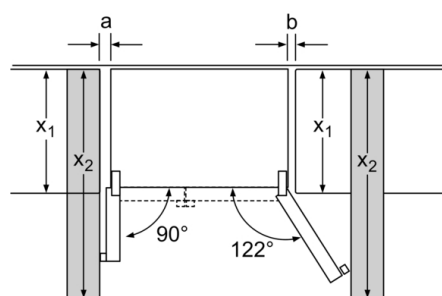
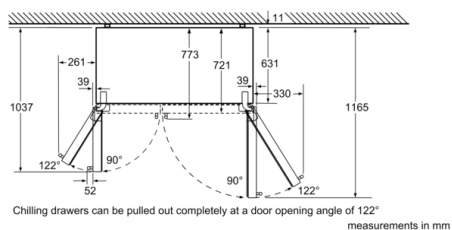

$x_1$ (unit depth)	a	b
600	39	39
650	39	53
700	39	85
$x_2$ (wall)	105	330

measurements in mm

