

Serie | 8

Oven

HBG633BS1J, Stainless steel



A+



Included accessories

- 1 x enamel baking tray
- 1 x combination grid
- 1 x universal pan

Optional accessories

HEZ327000 : Pizza stone

The built-in oven: you get perfect baking and roasting results.

- **4D Hot Air:** even heat distribution for perfect results – on any level.
- **TFT display control:** easy-to-use thanks to the control ring with full text and symbols.
- **EcoClean Direct:** almost no cleaning is necessary thanks to a special coating that automatically absorbs grime.
- **Energy efficiency class A+:** best baking results with lower energy consumption.
- **Flap door with SoftOpen and SoftClose:** the oven door opens and closes especially gently and quietly.

Technical Data

Color / Material Front :	Stainless steel
Built-in / Free-standing :	Built-in
Integrated Cleaning system :	No
Required niche size for installation (HxWxD) :	585-595 x 560-568 x 550
Dimensions of the product (mm) :	595 x 594 x 548
Dimensions of the packed product (HxWxD) (mm) :	675 x 690 x 660
Control Panel Material :	Stainless steel
Door Material :	Glass
Net weight (kg) :	35.544
Usable volume of cavity (l) :	71
Cooking method :	4D hot air, Bottom heat, Conventional heat, Defrost, Full width grill, Half width grill, Hot Air-Eco, Hot air grilling, Pizza setting
First cavity material :	Enamelled
Number of interior lights :	1
Approval certificates :	CE, VDE
Length electrical supply cord (cm) :	120
Interior Lights - cavity 1 :	1
Pull-out system :	Accessory
Clock function :	Alarm, Off, On
Included accessories cavity 1 :	1 x enamel baking tray, 1 x combination grid, 1 x universal pan
Broil Element Wattages cavity 1 (W) :	2800
Convection Element Wattages cavity 1 (W) :	1600
Energy efficiency class (2010/30/EC) :	A+
Energy consumption per cycle conventional (2010/30/EC) :	0.87
Energy consumption per cycle forced air convection (2010/30/EC) :	0.69
Energy efficiency index (2010/30/EC) :	81.2
Electrical connection rating (W) :	2850
Current (A) :	13
Voltage (V) :	220-230
Frequency (Hz) :	50; 60
Plug type :	Gardy plug w/ earthing
Color / Material Front :	Stainless steel
Energy input :	Electric
Approval certificates :	CE, VDE
Required cutout/niche size for installation (in) :	x x
Dimensions of the packed product (in) :	26.57 x 25.98 x 27.16
Net weight (lbs) :	78.000
Gross weight (lbs) :	84
Length electrical supply cord (cm) :	120
Net weight (kg) :	35.544
Gross weight (kg) :	38.0



Serie | 8 Ovens

Oven

HBG633BS1J, Stainless steel

The built-in oven: you get perfect baking and roasting results.

Performance

- Oven with 10 heating methods:
 - 4D hot air
 - Defrost setting
 - Full width grill
 - Hot Air-Eco
 - Half width grill
 - Top and bottom heat
 - Conventional heat ECO
 - Hot air grilling
 - Bottom heat
 - Pizza setting

Functions

- Ecolyse features: back panel
- Temperature range 30 °C - 300 °C

Features

- Cavity volume: 71 l
- TFT color and text display with touch control buttons
- Rapid heating-up
- Oven functions:
 - Automatic temperature proposal
 - Actual temperature display
 - Heating-up control
 - Sabbath mode
- Bottom door with SoftClose, Soft opening

Design:

- Intuitive Control Ring
- Electronic clock
- Halogen interior lighting, Switch for oven illumination

Safety Functions:

- Childproof lock
 - Automatic switch off
 - Residual heat indicator
 - Start button
 - Door contact switch
- Maximum window temperature 40° C
- Triple glass door
- Integral cooling fan

Technical Information:

- Total connected load electric: 2.85 KW
- Length of mains cable: 120 cm
- Appliance dimension (h x w x d): 595 mm x 595 mm x 548 mm
- Niche dimension (h x w x d): 585 mm - 595 mm x 560 mm - 568 mm x 550 mm

Serie | 8 Ovens

Oven

HBG633BS1J, Stainless steel

Installation with a hob.

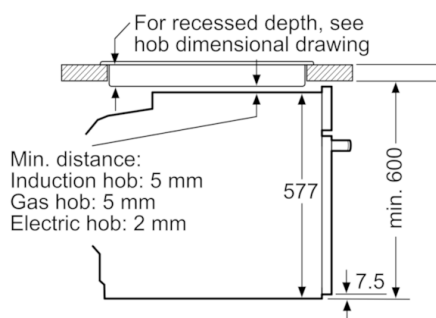

measurements in mm

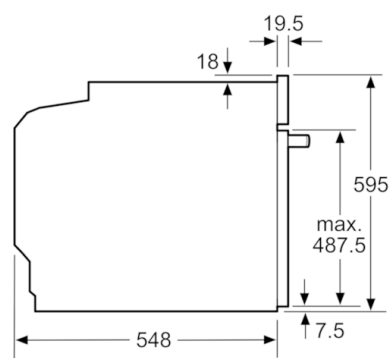

measurements in mm

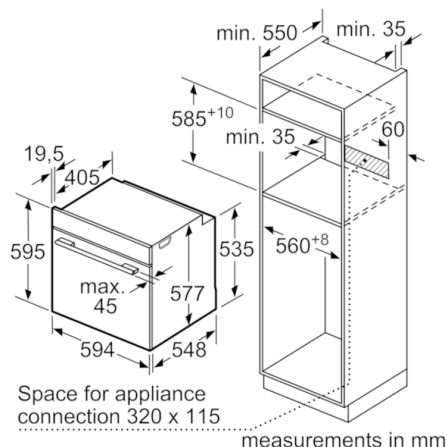

If the appliance will be installed underneath a hob, the following worktop thicknesses (including substructure if necessary) must be taken into account.

Hob type	min. worktop thickness	
	fitted	flush
Induction hob	37 mm	38 mm
Full surface Induction hob	47 mm	48 mm
Gas hob	30 mm	38 mm
Electric hob	27 mm	30 mm

