

**Series 8, Washing machine, front loader, 10 kg, RPM 1600
WGB256A1AU**

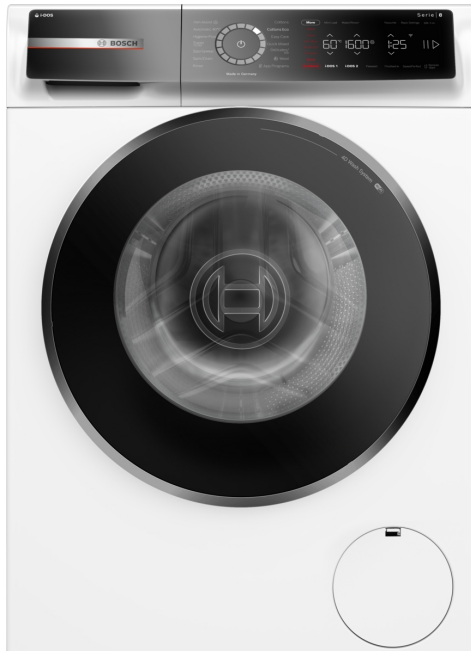

A highly advanced washing machine with i-Dos and detergent scan powered by Home Connect saves water and detergent and reduces your ironing pile with Iron Assist.

- **i-DOS with Detergent Scan:** Skip manual dosing and save detergent.
- **Iron Assist:** Reduce wrinkles up to 50%.²
- **AntiStain :** Reliably removes 16 different stubborn stains without any additional pre-treatment.

Maximum capacity in kg (EU 2017/1369): 10.0 kg
 Built-in / Free-standing: Free-standing
 Dimensions of the product: 845x598x590 mm
 Net weight: 82.6 kg
 Connection rating: 2300 W
 Fuse protection: 10 A
 Voltage: 220-240 V
 Frequency: 50 Hz
 Length electrical supply cord: 160.0 cm
 Door hinge: Left
 Wheels: No
 EAN code: 4242005414772
 Installation type: Free-standing



WMZ2200 Floor securing component
 WMZ2381 Extension for cold water inlet /Aquastop
 WMZPW20W Platform with pull-out, washer, cubic

¹ Please refer to the Energy Star Rating or for more information, refer to www.energyrating.gov.au

² Test No. E-0323-PT-22 of the Deutschen Institute für Textil- und Faserforschung Denkendorf (DITF) of 12.07.22, related to the crease reduction of commercial cotton garments (T-shirts and shirts) in the Iron Assist program according to DIN EN ISO 15487 in comparison to textiles not treated with Iron Assist.

Series 8, Washing machine, front loader, 10 kg, RPM 1600 WGB256A1AU

A highly advanced washing machine with i-Dos and detergent scan powered by Home Connect saves water and detergent and reduces your ironing pile with Iron Assist.

Capacity

- Capacity: 10 kg

Consumption rates

- 5 Star Energy Rating for washing performance
- Energy consumption 250 kWh kWh per year, based on Cottons Eco 60°C program at 1600 RPM seven times per week. When tested in accordance with AS/NZS 2040.2. Actual energy use and running costs will depend on how you use the appliance.
- 5 Star Water rating (WELS)
- Water consumption 75 l litres per wash, using the Cottons Eco 60°C program at 1600 RPM. In accordance with AS/NZS 6400. Actual water consumption will depend on how the appliance is used. C02321

Programs

- Iron Assist: Steam programme that reduces wrinkles on dry clothes
- Standard programs: Cottons Eco, Cottons Program cold to 90°C, Easy Care, App, automatic, Iron Assist - with added steam for wrinkle reduction, Hygiene Plus, Spin / Drain, Quick wash/Mixture, Sportswear, Rinse, Super 15 min / Super 30 min, delicates/silk, Wool
- TouchControl buttons: AntiStain: Selection options of Grass, Red Wine, Oil/Butter and Blood, Temperature selection, Spin speed selection, Prewash, Finish in (delayed start): delay the start of the program by up to 24 hours, SpeedPerfect, start/pause with reload function
- Automatic program 30°C: Sensor controlled washing and dosage. Wash delicate items made from cotton, or synthetic or blended fabrics. Gentle laundry care. The degree of soiling and the type of fabric are automatically detected. The washing process is adaptable to how dirty are the fabrics.
- Special programs: Super 15 min / Super 30 min, Sportswear, Spin / Drain.
- Stain automatic - 6 stains at the touch of a button, 10 further stains via Home Connect
- programmes via app: Automatic Soft, Down, Drum clean with reminder, Shirts, Jeans/dark laundry, Outdoor

Features

- Home Connect: Smart Start, Remote Monitoring and Control, Remote Diagnostics, Onboarding, further programmes via download. Always keep your appliance up to date via firmware update.
- iDos Automatic dosing system: Doses detergent from 1st reservoir and fabric softener only in 2nd reservoir, Self cleaning detergent drawer, From front
- Detergent Scan: Barcode scanning of liquid detergent and softener
- Hygiene Plus: clean laundry and killing germs effectively
- ActiveWater Plus: for highly efficient use of water even with small loads thanks to automatic load detection.

- Reload function: Be flexible in adding laundry items even after start of the wash cycle.
- 4D Wash System: high efficient water and detergent distribution for spotless results.
- Mini Load: Wash single items and small loads efficiently
- Large 32 cm porthole, black-chrome, black with 182° opening door
- Audiable end-of-cycle signal
- VarioDrum's breakthrough wave-droplet design provides a thorough yet gentle clean for fine textiles
- Turbidity Sensor: works with iDos dosing system, to measure the level of soiling, and will adjust accordingly
- Pause/Reload function to pause the washing operation for adding in laundry items
- EcoSilence drive for faster, quieter and more energy efficient performance
- AntiVibration Side Panels reduce vibrations and ensure greater stability during the washing and spinning process
- Sound insulation by additional damping material
- Aqua Protection Plus anti-flood protection with self-sealing hose, minimises the risk of flooding
- Overdosage indication
- Foam detection to remove excessive foam
- Unbalanced load detection
- Self cleaning detergent drawer to remove detergent residue
- Audible notification at the end of the programme

Performance

- Spin speed: 400 - 1600 rpm

Technical Information

- slide-under
- 845 mm x 598 mm x 590 mm (652 mm with door frame)
- Operating noise level for spinning at standard 60°C cotton program at full loading in dB (A): 75

Design and Safety

- Elegant and ergonomically inclined control panel for easy use
- Consumption Indication: Information about energy consumption
- Child lock
- water consumption per wash and Energy Consumption p.a. on Cotton 60, EcoPerfect, Rinse Plus, wash program

**Series 8, Washing machine, front
loader, 10 kg, RPM 1600
WGB256A1AU**

Measurements in mm

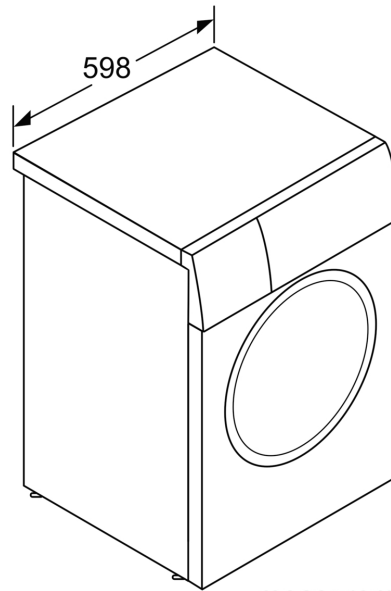
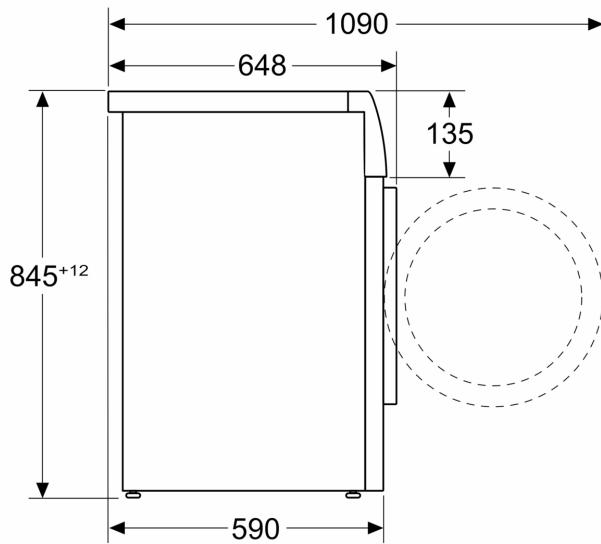

measurements in mm