

Series 8, Built-in compact oven with microwave function, 60 x 45 cm, Stainless steel CMG633BS1B



HEZ327000 Pizza stone, HEZ530000 Half tray, HEZ531010 Baking tray, non-stick ceramic coated, HEZ532010 Universal pan, non-stick ceramic coated, HEZ617000 Pizza pan, enamelled, HEZ625071 Grill tray, anthracite, HEZ631070 Baking tray, enamelled, HEZ632070 Multipurpose pan, enamelled, HEZ634080 Baking and roasting grid, microwave, HEZ636000 Glass pan, HEZ660050 Cover Strip, HEZ660060 Strip, HEZ664000 Baking and roasting grid, steam, HEZ915003 Glass roasting dish, 5,4 L

The compact oven with microwave function: enables you to achieve perfect baking and roasting results very quickly.

- **AutoPilot 14:** every dish is a perfect success thanks to 14 pre-set and tested automatic programmes.
- **4D hotair:** even heat distribution for perfect results.
- **TFT Touch Display:** easy-to-use thanks to the Control Ring with clear text and symbols.
- **LED-light:** perfect illumination of foods with minimum energy consumption.
- **Microwave function:** for quick warming up or for fast cooking in combination with hot air.

Additional function: Microwave combination
Color / Material Front: Stainless steel
Built-in / Free-standing: Built-in
Door opening: Handle
Door colour: Black
Integrated Cleaning system: No
Control Panel Material: Stainless steel
Dimensions: 455x594x548 mm
Dimensions of the packed product (HxWxD): 540 x 650 x 680 mm
Required niche size for installation (HxWxD): 450-455 x 560-568 x 550 mm
Cavity dimensions: 237 x 480 x 392 mm
Cavity capacity: 45 l
Max. microwave power level: 900 W
Number of interior lights: 1
Net weight: 34.5 kg
Gross weight: 36.9 kg
EAN code: 4242002807409
Connection rating: 3600 W
Fuse protection: 16 A
Voltage: 220-240 V
Frequency: 60; 50 Hz
Length electrical supply cord: 150.0 cm



4 242002 807409

Series 8, Built-in compact oven with microwave function, 60 x 45 cm, Stainless steel CMG633BS1B

The compact oven with microwave function: enables you to achieve perfect baking and roasting results very quickly.

Heating Functions

- Compact oven with microwave with 6 PCh heating methods:
- 4D Hot Air
- Full width grill HotAir Eco Half width grill Hot-air grilling Pre-Heating
- Additional heating methods with microwave:
- Microwave, 5 power levels
- combi microwave constant
- Automatic rapid heat function
- AutoPilot Automatic programming, 14 automatic programs automatic programs

Racks and Rails

- Number of shelf levels: 3

Design

- SoftMove oven door with soft close, Drop down oven door with SoftOpen and SoftClose, Bottom hinged door
- Bosch Control Ring
- Cavity volume: 45 l
- Stainless steel bar handle
- Cooling fan
- Switch for oven illumination, LED lighting

Convenience

- TFT Touch Symbol Display
- Built in cooking functions: Automatic programs
- Electronic clock/timer with end time programming

Accessories

- universal pan, combination grid

Safety Features

- Child lock
- Residual heat indicator Automatic switch off Start button Door contact safety switch
- Telescopic rails: 1 Clip-on rail, safety stop function, - full extension, full adjustment to any shelf level

Technical Information

- Total connected load electric: 3.6 KW
- Length of mains cable: 150 cm
- Nominal voltage: 220 - 240 V

Dimensions:

- Appliance dimension (HxWxD): 455 mm x 594 mm x 548 mm
- Installation dimensions (HxWxD): 450 mm - 455 mm x 560 mm - 568 mm x 550 mm
- Please reference the built-in dimensions provided in the installation drawing

**Series 8, Built-in compact oven with
microwave function, 60 x 45 cm,
Stainless steel
CMG633BS1B**

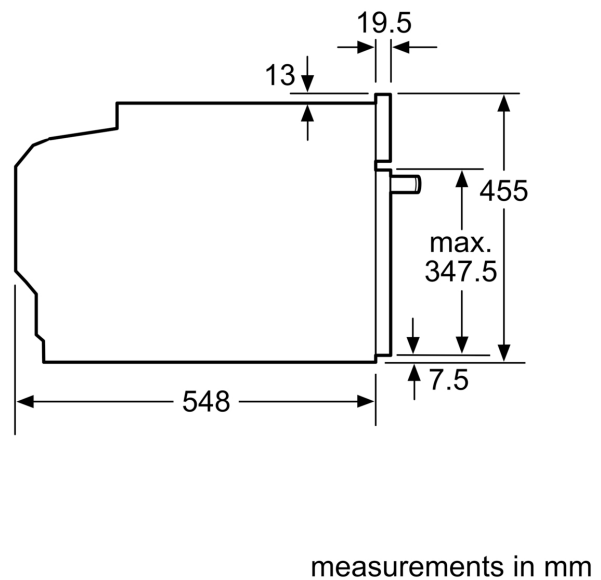
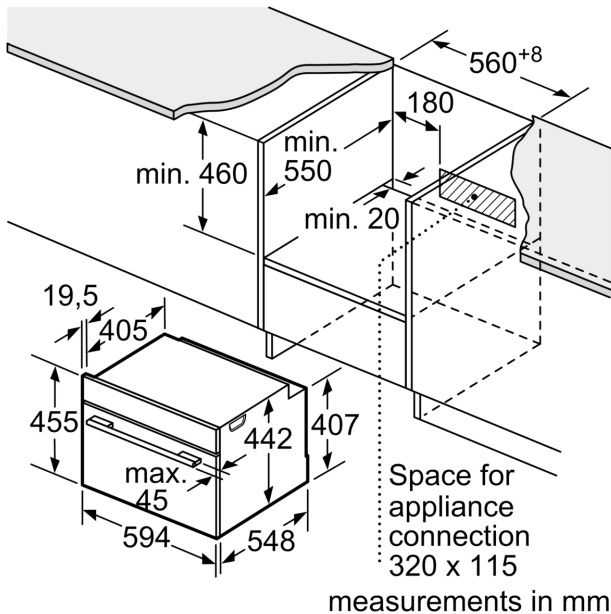

Installation with a hob.

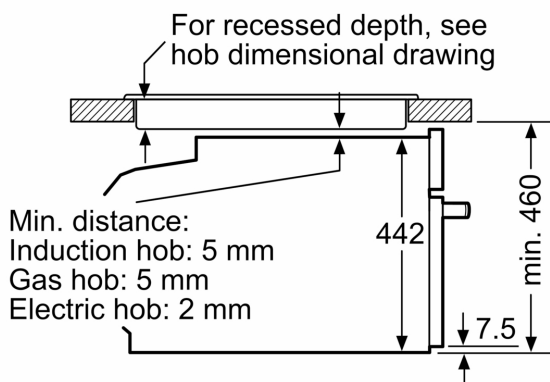

If the compact appliance will be installed underneath a hob, the following worktop thicknesses (including substructure if necessary) must be taken into account.

Hob type	min. worktop thickness	
	fitted	flush
Induction hob	42 mm	43 mm
Full surface Induction hob	52 mm	53 mm
Gas hob	32 mm	43 mm
Electric hob	32 mm	35 mm

