

**Series 8, Heat Pump Dryer, 9 kg,
White
WQB245B0SG**

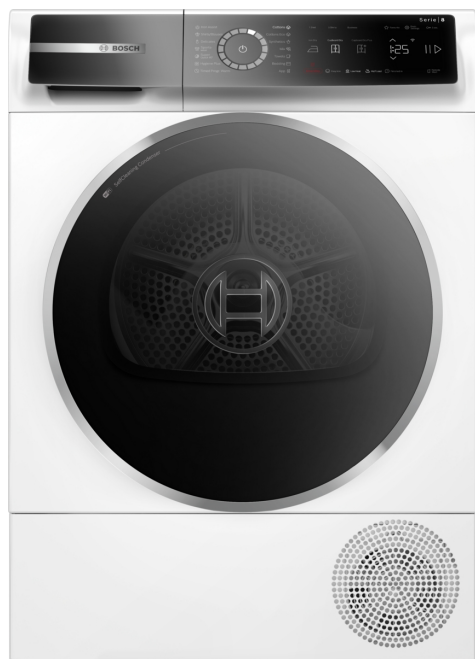

An exceptional heatpump dryer with Smart Dry powered by Home Connect. Maximise your energy savings with A+++ -10%* and the Self Cleaning condenser. Protect your Garments with Auto Dry and reduce your ironing Pile with Iron Assist.

- **Iron Assist:** warm mist treatment that reduces up to 50% wrinkles.
- **Auto Dry:** automatically dries to the exact degree of dryness you want.
- **Anti Vibration Design:** extremely stable and extraordinarily quiet thanks to special vibration protection.
- **Home Connect:** home appliances with smart connectivity for an easier everyday life.
- **Smart Dry:** your connected dryer and washer recommend the right drying programme.

Built-in / Free-standing: Free-standing
Removable top: No
Door hinge: Right reversible
Color / Material body: White
Length electrical supply cord: 145.0 cm
Dimensions (HxWxD): 842x598x613 mm
Net weight: 56.3 kg
Drum volume: 112 l
Fluorinated greenhouse gases: No
Hermetically sealed equipment: Yes
Connection rating: 600 W
Fuse protection: 10 A
Voltage: 220-240 V
Frequency: 50 Hz
Drying process: automatic
Loading capacity: 9.0 kg
Energy efficiency rating: A+++
Power consumption in off-mode - NEW (2010/30/EC): 0.30 W
Power consumption in left-on mode - NEW (2010/30/EC): 0.30 W
Duration of the left-on mode - NEW (2012/30/EC): 15 min
Condensation efficiency class: B

WMZ20600 Wool in basket - accessory
WTZ27500 Stacking kit with pull-out shelf
WTZ27510 Stacking kit
WTZPW20D Platform with pull-out, dryer, cubic



Series 8, Heat Pump Dryer, 9 kg, White WQB245B0SG

**An exceptional heatpump dryer with
Smart Dry powered by Home Connect.
Maximise your energy savings with A+++
-10%* and the Self Cleaning condenser.
Protect your Garments with Auto Dry and
reduce your ironing Pile with Iron Assist.**

- WQB245B0SG
- 9 kg, tumble dryer with heat pump

Performance

- Capacity: 1 - 9 kg
- Noise level: 61 dB (A) re 1 pW

Programmes

- standard programmes: cotton, easy care
- Iron Assist/smartFinish
- Bed Linen Program: reduces tangling of big items thanks to reversible drum
- programmes via app: Woollens finish, Time program cold
- Special programmes: App, Cottons, Bed linens, shirts/blouses, Cotton Eco, Delicates, towels, Hygiene, Iron Assist/smartFinish, mix, Super 40, sportswear, Synthetic, Time program warm

Options

- smartDry/IntelligentDry
- Half Load option: optimizes drying for smaller loads
- Anti crease cycle 120 min at the end of the programme
- Touch control buttons: 1 shirt, 5 shirts, basic setup, Iron dry, Business, Cupboard dry, Cupboard dry+, Ready in, Half load, Child lock, less ironing, My favorite, Power button, Remote Start, Low Heat, smartDry/IntelligentDry, Start / Reload / Pause, 24 h Ready in

Convenience and Safety

- SelfCleaning Condenser
- Elegant and ergonomically inclined control panel for easy use
- load recommendation
- DUO-Tronic
- Sensitive Drying System: Big Stainless steel drum with textile care structure, soft design paddles
- AntiVibration Design: Stability and Quietness
- LED interior drum light
- Container for condensed water
- Child Proof Lock
- Buzzer at the end of the wash programme
- side opening door, hinge right, reversible
- Metal door closing hook

Technical information

- Dimensions (H x W): 84.2 cm x 59.8 cm
- Appliance depth: 61.3 cm
- Appliance depth incl. door: 65.1 cm
- Appliance depth with open door: 110.5 cm
- Heat pump technology with eco-friendly cooling agent R290

**Series 8, Heat Pump Dryer, 9 kg,
White
WQB245B0SG**

Measurements in mm

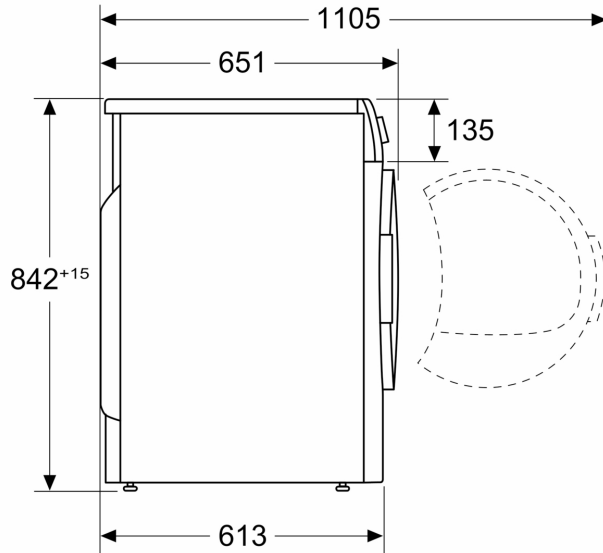

Measurements in mm

