

**Series 8, washing machine, front loader, 10 kg, , Silver inox WGA254AXIN**



- 10kg capacity gives you the opportunity to fit more in one wash, saving time and energy while providing perfect washing results.
- The AntiStain option easily removes the up to 4 of the most stubborn stains, ranging from oil, tea, cosmetics and blood helping you get the perfect washing results, easily.
- Anti Wrinkle feature minimizes wrinkles in laundry by up to 50% making it gentler on fabric and easier to iron
- i-DOS: automatically measures the precise amount of detergent and water needed.
- The SpeedPerfect™ option washes in a shorter time with the cleaning results of the standard program.

Built-in / Free-standing: .....	Freestanding
Door hinge: .....	left
Color / Material body: .....	Silver inox
Length electrical supply cord: .....	160.0 cm
Height of the appliance: .....	845 mm
Dimensions of the product: .....	845x598x588 mm
Wheels: .....	No
Net weight: .....	76.8 kg
Drum volume: .....	70 l
Door Frame: .....	Silver-inox, black-grey
Connection rating: .....	2300 W
Fuse protection: .....	10 A
Voltage: .....	220-240 V
Frequency: .....	50-60 Hz
Energy Star Qualified: .....	No
Cord Included: .....	Yes
Plug type: .....	India plug (10 Ampere)
Length of supply hose (in): .....	59.05 "
Dimensions of the packed product: .....	34.25 x 25.59 x 26.77
Net weight: .....	169.000 lbs
Gross weight: .....	172.000 lbs
Length of drain hose: .....	150.00 cm
Length of supply hose: .....	150.00 cm
Dimensions of the packed product (HxWxD): .....	870 x 650 x 680 mm
Gross weight: .....	77.8 kg
Connection rating: .....	2300 W
Fuse protection: .....	10 A
Voltage: .....	220-240 V
Frequency: .....	50-60 Hz
Water protection system: .....	Multiple water protection
Max. spin speed: .....	1400 rpm
Spin speed options: .....	Variable
Digital countdown indicator: .....	Yes
Drying progress indicator: .....	LED-display, LED
Maximum capacity in kg (EU 2017/1369): .....	10.0 kg

WMZ2200 Floor securing component  
 WMZ2381 Extension for cold water inlet /Aquastop



## **Series 8, washing machine, front loader, 10 kg, , Silver inox WGA254AXIN**

---

- speedPerfect
- Reload function
- Capacity: 10 kg
- Maximum Spin Speed: 1400 rpm
- Maximum spin speed: 1400 rpm
- Drum volume: 70 l

### **Design**

- Consumption: energy 0.98 kwh, water 55 l

### **Programmes**

### **Performance**

- touchControl buttons: Start/Reload, Easy iron, SpeedPerfect, Spin speed reduction/Rinse Hold
- Circulatory sensor for optimal water use

### **Key features**

- Anti-Vibration Side Panels reduce vibrations and ensure greater stability during the washing and spinning process
- Multiple Water Protection
- Child-proof lock
- Pre-activated SpeedPerfect
- Unbalanced load detection
- Prewash
- Foam detection system to remove excessive foam
- voltMonitor
- Monsoon Programme
- 32 cm porthole, Silver-inox, black-grey door with 160° opening
- Time delay to select end of time of your wash (1-24 hours) and time remaining indicator
- Reload Function

### **Technical Information**

- Dimensions (H X W X D): 84.5 x 59.8 x 58.8 cm
- Noise level washing: 54 dB; Noise level spinning: 74 dB

**Series 8, washing machine, front loader, 10 kg, Silver inox  
WGA254AXIN**

Measurements in mm

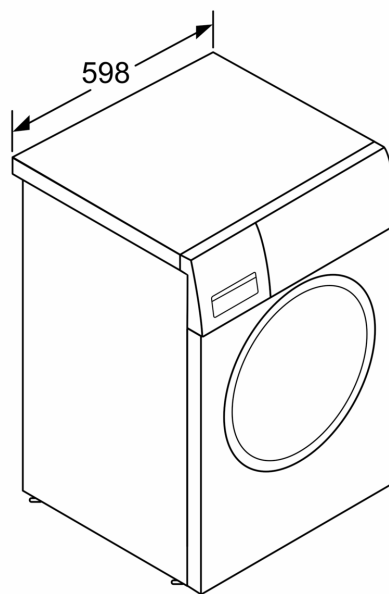
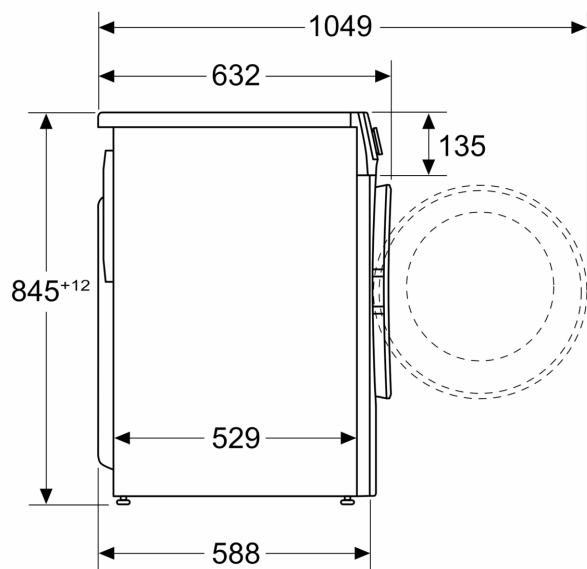

measurements in mm