

Series 4, washing machine, front loader, 7 kg, 1000 rpm WAK2016WIN



WX975600 Floor securing component
WZ10130 Extension for cold water inlet /Aquastop

Minimize tangles by up to 50%

- **Allergy Plus:** developed for allergy sufferers and people with sensitive skin.
- **Speed Perfect:** perfectly clean in up to 65% less time.
- **Vario Drum:** gently and efficiently wash with even water distribution and without creasing garments.
- **Reload function:** forgot an item? Add it easily to the wash.
- **Anti Vibration™ Design:** extremely stable and especially quiet thanks to special vibration protection.

Built-in / Free-standing: Freestanding
Door hinge: left
Color / Material body: White
Length electrical supply cord: 160.0 cm
Height of the appliance: 848 mm
Dimensions of the product: 848 x 598 x 590 mm
Wheels: No
Net weight: 71.0 kg
Drum volume: 58 l
Door Frame: White-black grey
Color Buttons: white
Color Dial: silver white
Noise level washing: 55 dB(A) re 1pW
Connection rating: 2300 W
Fuse protection: 10 A
Voltage: 220-240 V
Frequency: 50 Hz
Energy Star Qualified: No
Cord Included: No
Plug type: India plug (16 Ampere)
Length of supply hose (in): 59.05 "
Dimensions of the packed product: 37.99 x 25.78 x 27.95
Net weight: 156.000 lbs
Gross weight: 168.000 lbs
Length of drain hose: 150.00 cm
Length of supply hose: 150.00 cm
Dimensions of the packed product (HxWxD): 965 x 710 x 655 mm
Gross weight: 76.0 kg
Connection rating: 2300 W
Fuse protection: 10 A
Voltage: 220-240 V
Frequency: 50 Hz
Water protection system: Multiple water protection
Max. spin speed: 1000 rpm
Spin speed options: Variable
Digital countdown indicator: Yes
Drying progress indicator: LED-display, LED
Maximum capacity in kg (EU 2017/1369): 7.0 kg



4 242005 119448

Series 4, washing machine, front loader, 7 kg, 1000 rpm WAK2016WIN

Minimize tangles by up to 50%

Technical Information

- rated capacity: 7 kg
- Maximum Spin Speed: 1000 rpm
- Dimensions (H x W x D): 84.8cm x 59.8cm x 59.0cm (61.8cm with door frame)
- 32 cm porthole, 165° swing door

Programmes

- Cottons Cold, Cottons 40°C, Cottons 60°C Eco, Sportswear 30°C, Synthetics 30°C, Mix Load 30°C, Drum Clean, Spin/Drain, Rinse, Wool, Delicates/Silk 30°C, Kidswear 40°C, Lingerie, Freshen Up 30°C, Super15/30 min

Features

- SpeedPerfect™: high performance programme which reduces wash cycle duration by up to 65%
- ActiveWater™: Pressure sensor that detects half-loads and cuts water intake in half
- VarioDrum's breakthrough wave-droplet design provides a thorough yet gentle clean for fine textiles
- Anti-Vibration Side Panels reduce vibrations and ensure greater stability during the washing and spinning process
- Start/Reload function to pause machine operation for adding in last minute laundry items
- Anti-Tangle feature minimizes tangles in laundry up to 50%

Safety

- Multiple Water Protection with magnetic valve to minimise risk of leakage
- Voltmonitor monitors and regulates voltage fluctuations to protect the washing machine and ensure a smooth wash cycle

Display Screen & Alerts

- LED display screen to indicate Remaining Time, Spin Speed reduction
- Buzzer at the end of the wash programme

**Series 4, washing machine, front
loader, 7 kg, 1000 rpm
WAK2016WIN**

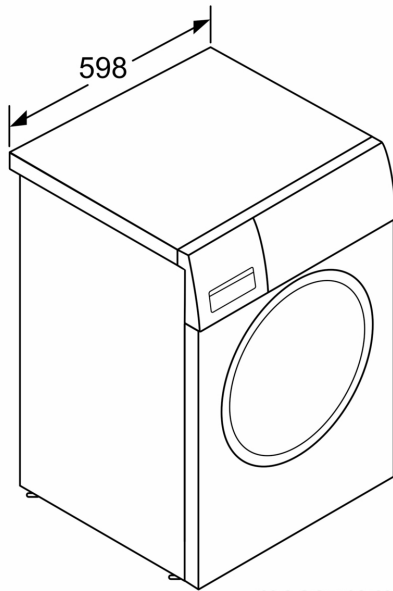

measurements in mm

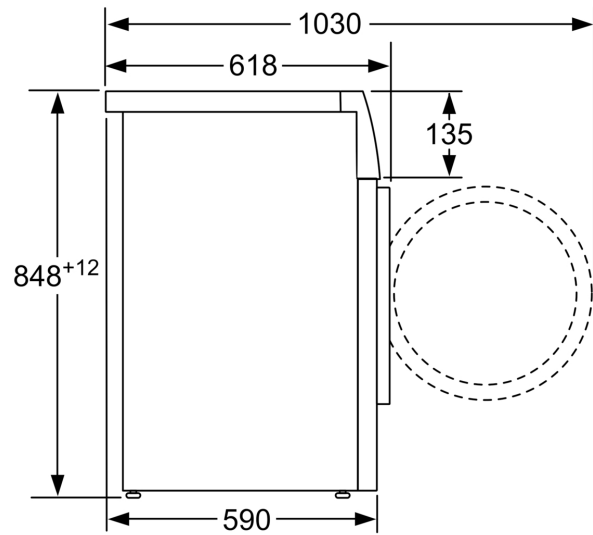

measurements in mm