

Series 4, Washing machine, front loader, 9 kg, 1400 rpm WAN28209GB



Optional accessories

| | |
|----------|--|
| WMZ2200 | Floor securing component |
| WMZ2381 | Extension for cold water inlet /Aquastop |
| WMZPW20W | Platform with pull-out, washer, cubic |

Automatic washing machine with EcoSilence Drive™: quiet operation and durability that you can rely on.

- **Speed Perfect:** get the perfect clean in up to 65% less time.
- **ActiveWater Plus:** For highly efficient use of water even with smaller loads thanks to automatic load detection.
- **EcoSilence Drive™:** quiet and energy-efficient drive, with a 10-year warranty.
- **AllergyPlus:** developed for allergy sufferers and people with sensitive skin.
- **Reload function:** forgot an item? Add it easily to the wash.

Technical Data

| | |
|---|--------------------|
| Energy Efficiency Class: | C |
| Weighted energy consumption in kWh per 100 washing cycles of eco 40-60 programme: | 66 kWh |
| Maximum capacity in kg: | 9.0 kg |
| The water consumption of the eco programme in liters per cycle: | 44 l |
| Duration of eco 40-60 programme in hours and mins at rated capacity: | 3:37 h |
| Spin-drying efficiency class of eco 40-60 programme: | B |
| Airborne acoustical noise emission class: | A |
| Airborne acoustical noise emissions : | 72 dB(A) re 1 pW |
| Built-in / Free-standing: | Free-standing |
| Height of removable worktop: | 0 mm |
| Dimensions of the product: | 848 x 598 x 590 mm |
| Net weight: | 68.8 kg |
| Connection rating: | 2300 W |
| Fuse protection: | 10 A |
| Voltage: | 220-240 V |
| Frequency: | 50 Hz |
| Length electrical supply cord: | 210.0 cm |
| Door hinge: | Left |
| Wheels: | No |
| EAN code: | 4242005318124 |
| Installation typology: | Free-standing |



4 242005 318124

Series 4, Washing machine, front loader, 9 kg, 1400 rpm WAN28209GB

Automatic washing machine with EcoSilence Drive™: quiet operation and durability that you can rely on.

Performance

- Energy Efficiency Class¹: C
- Energy² / Water³: 66 kWh / 44 litres
- Load capacity: 1 - 9 kg
- Programme duration⁴: 3:37 h:min
- Spin drying efficiency class: B
- Spin speed^{**}: 400 - 1400 rpm
- Noise level: 72 dB (A) re 1 pW
- Noise efficiency class: A

Programmes/functions

- Touch control buttons: Prewash, Reduced Ironing option, Ready in, Temperature selection, SpeedPerfect, start/pause with reload function, Spin speed reduction
- Standard programmes: cottons, easy care, delicates, wool hand wash
- Special programmes: Shirts, SportsWear, Mixed Load, Allergy +, Super Quick 15/30, Quiet Wash, jeans/dark laundry, Wool/Handwash, Delicate/Silk programme
- Sensor electronics with safeguard monitoring system that adjusts load and distribution and programme settings to protect clothes

Key features

- SpeedPerfect: perfectly clean in up to 65% less time. ***
- Reload function: Be flexible in adding laundry items even after start of the wash cycle.
- Fully electronic control dial for all wash and special programmes
- AntiVibration Design - for more stability and quietness

Additional features

- Large display for programme progress indication, spin speed, remaining time, 24 hour end time delay and load recommendation
- Drum volume: 63 litres
- Aqua Protection
- Divider for Liquid Detergent
- ActiveWater Plus: for highly efficient use of water even with small loads thanks to automatic load detection.
- Foam detection system
- Metal door catch
- Reload facility
- Buzzer to indicate the end of cycle
- Child lock

Technical Information

- Slide-under installation
- Large silver-white door with 171° opening and 32cm porthole opening
- Dimensions (H x W): 84.8 cm x 59.8 cm
- Appliance depth: 59.0 cm
- Appliance depth incl. door: 63.2 cm

- Appliance depth with open door: 106.3 cm

¹ Scale of Energy Efficiency Classes from A to G

² Energy consumption in kWh per 100 cycles (in programme Eco 40-60)

³ Weighted water consumption in litres per cycle (in programme Eco 40-60)

⁴ Duration of Eco 40-60 programme

^{**} Values are rounded.

^{***} Comparison between the program duration of Easy-care 40°C and the program duration of Easy-care 40°C + activated Speed option

**Series 4, Washing machine, front
loader, 9 kg, 1400 rpm
WAN28209GB**

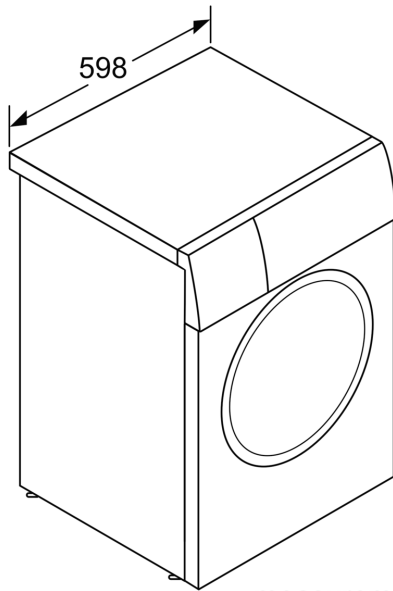

measurements in mm

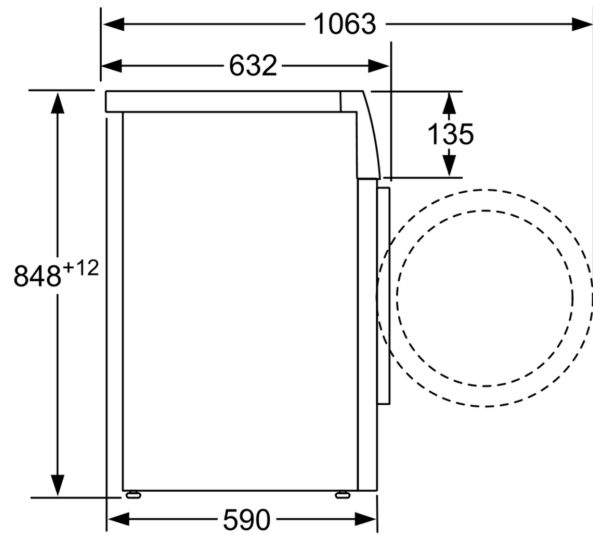

measurements in mm