

**Series 6, Washing machine, front loader, 10 kg, 1400 rpm
WAL28RH1GB**



The Serie|6 washing machine with AntiStain system and Home Connect removes the most common stains with ease and without pre-treatment.

- **AntiStain:** reliably removes four common stains.
- **Home Connect:** home appliances with smart connectivity for an easier everyday life.
- **Voice Control:** stay connected to your washing machine via voice control for ultimate convenience.
- **EcoSilence Drive™:** quiet and energy-efficient drive, with a 10-year warranty.
- **AllergyPlus:** developed for allergy sufferers and people with sensitive skin.

Technical Data

Energy Efficiency Class:C
 Weighted energy consumption in kWh per 100 washing cycles of eco 40-60 programme:67 kWh
 Maximum capacity in kg:10.0 kg
 The water consumption of the eco programme in liters per cycle: 47 l
 Duration of eco 40-60 programme in hours and mins at rated capacity:3:50 h
 Spin-drying efficiency class of eco 40-60 programme:B
 Airborne acoustical noise emission class:B
 Airborne acoustical noise emissions :75 dB(A) re 1 pW
 Built-in / Free-standing:Free-standing
 Height of removable worktop:0 mm
 Dimensions of the product:848 x 598 x 590 mm
 Net weight:76.8 kg
 Connection rating:2300 W
 Fuse protection:10 A
 Voltage:220-240 V
 Frequency:50 Hz
 Length electrical supply cord:210.0 cm
 Door hinge:Left
 Wheels:No
 EAN code:4242005266876
 Installation typology:Free-standing



4 242005 266876

Series 6, Washing machine, front loader, 10 kg, 1400 rpm WAL28RH1GB

The Serie|6 washing machine with AntiStain system and Home Connect removes the most common stains with ease and without pre-treatment.

Performance

- Energy Efficiency Class¹: C
- Energy² / Water³: 67 kWh / 47 litres
- Load capacity: 1 - 10 kg
- Programme duration⁴: 3:50 h:min
- Spin drying efficiency class: B
- Spin speed^{**}: 400 - 1400 rpm
- Noise level: 75 dB (A) re 1 pW
- Noise efficiency class: B

Programmes/functions

- Standard programmes: cottons, easy care, delicates, wool hand wash
- Special programmes: Allergy +, Drum clean with reminder, Shirts, Dark Wash, Drain / Spin, Mixed Load, SportsWear, Single Rinse, Super Quick 15/30

Key features

- Home Connect: Remote Monitoring and Control
- SpeedPerfect: perfectly clean in up to 65% less time. ***
- AntiStain - 4 stain removal options at the touch of a button
- Touch control buttons: Reduced Ironing option, Ready in, stain selection, Child lock, Memory, Night Wash / Silent Wash, Remote Start, Aqua Plus, Rinse hold, start/pause with reload function, Temperature selection, SpeedPerfect, Prewash, Spin speed reduction/Rinse Hold

Additional features

- Reload function: Be flexible in adding laundry items even after start of the wash cycle.
- Large LED-Display for programme status indication, temperature selection, spin speed, remaining time and 24 hours end time delay, load recommendation and consumption indication
- Drum interior light
- VarioDrum: gentle and efficient washing
- Drum clean with reminder function
- Large silver-white door with 171° opening and 32cm porthole opening
- Reload function / pause function
- EcoSilence drive with 10 year warranty
- EcoSilence drive with 10 year warranty
- ActiveWater Plus: for highly efficient use of water even with small loads thanks to automatic load detection.
- Consume indicator energy+water, AntiStain
- AntiVibration Design - for more stability and quietness
- Aqua Protection
- EcoBar Plus function: five possible levels of energy and water consumption
- Control dial with integrated On / Off mode

- Foam detection system
- Overdosage indication
- Sensor electronics with safeguard monitoring system that adjusts load and distribution and programme settings to protect clothes
- Child lock
- Acoustic signals: Buzzer
- Detergent dispensing: easy clean
- Divider for Liquid Detergent

Technical Information

- Slide-under installation
- Drum volume: 70 litres
- Dimensions (H x W): 84.8 cm x 59.8 cm
- Appliance depth: 59.0 cm
- Appliance depth incl. door: 63.2 cm
- Appliance depth with open door: 106.3 cm

¹ Scale of Energy Efficiency Classes from A to G

² Energy consumption in kWh per 100 cycles (in programme Eco 40-60)

³ Weighted water consumption in litres per cycle (in programme Eco 40-60)

⁴ Duration of Eco 40-60 programme

^{**} Values are rounded.

^{***} Comparison between the program duration of Easy-care 40°C and the program duration of Easy-care 40°C + activated Speed option

**Series 6, Washing machine, front
loader, 10 kg, 1400 rpm
WAL28RH1GB**

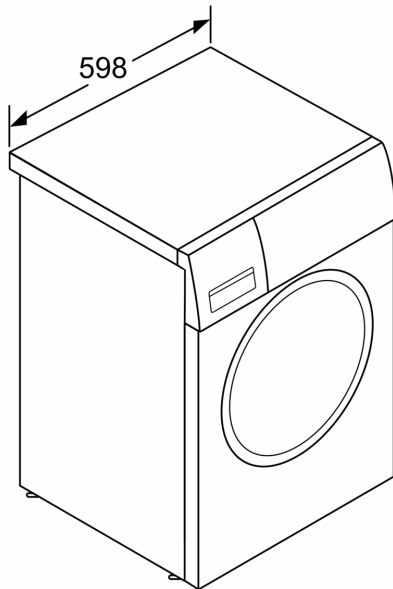

measurements in mm

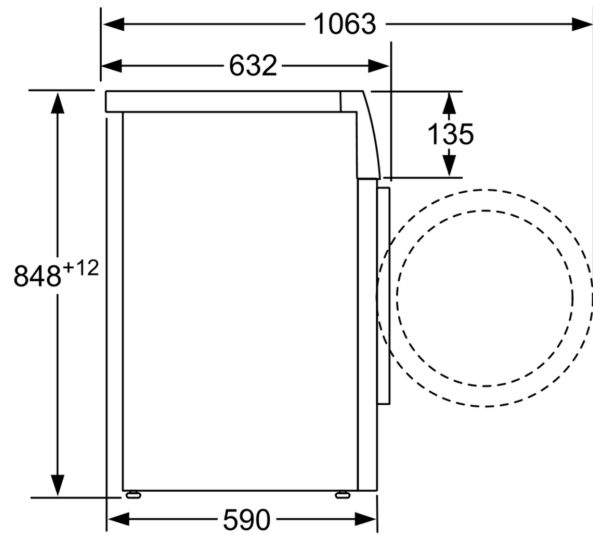

measurements in mm