

Serie | 8, 177.8 x 91.2 cm, Black KAD92HBFP



Included accessories

2 x cold accumulator
1 x connection hose
1 x egg tray

- **Home Connect:** home appliances with smart connectivity for an easier everyday life.
- **XXL capacity:** extra space for your food when you need it.
- **VitaFresh:** keeps food fresh for longer in climate controlled drawers at near 0°C.
- LED lighting - with soft start, lasts for the lifetime of the appliance.
- **Big Box drawer:** for stacking storage containers or for large frozen food items.

Technical Data

Energy Efficiency Class: F

Average annual energy consumption in kilowatt hour per year (kWh/a): 419 kWh/annum

Sum of volume of frozen compartments: 209 l

Sum of volume of chill compartments: 376 l

Airborne acoustical noise emissions : 42 dB(A) re 1 pW

Airborne acoustical noise emission class: D

Built-in / Free-standing: Free-standing

Door panel options: Not possible

Height: 1778 mm

Appliance Width: 912 mm

Depth: 732 mm

Net weight: 159.4 kg

Connection Rating: 190 W

Fuse protection: 10 A

Door hinge: left and right

Voltage: 220-240 V

Frequency: 50-60 Hz

Approval certificates: CE, VDE

Length electrical supply cord: 240 cm

Storage Period in Event of Power Failure (h): 8 h

Number of compressors: 1

Number of independent cooling systems: 2

Interior ventilator: No

Reversible Door Hinge: No

Number of Adjustable Shelves in fridge compartment: 3

Shelves for Bottles: Yes

Capacity of Water Tank: 1.0 l

EAN code: 4242005150205

Brand: Bosch

Product name / Commercial code: KAD92HBFP

Installation typology: N/A



4 242005 150205

Serie | 8, 177.8 x 91.2 cm, Black KAD92HBFP

Design features

- aluminium Vertical door handle
- Electronic control (external in-door LCD display)

Functions

- No Frost, never have to defrost ever again
- Separate temperature control for cooling and freezing section
- SuperCool function
- SuperFreezing function with automatic deactivation
- Optical and acoustical door open warning
- optical and acoustical warning system with failure memory function, optical and accoustical

Ice and Water

- Illuminated water and ice dispenser
- In-door ice and water dispenser: chilled water, crushed ice, ice cubes
- Water Filter Inside

Food freshness system

- ChillerBox - recommended storage area for meat and fish
- MultiAirflow system - improves circulation of air around the fridge
- VitaFresh Plus container on telescopic rails and humidity control for prolonged food storage,
- 1 MultiBox drawer on telescopic rails - Transparent drawer with a corrugated bottom, ideal for storing fruits and vegetables.

Key features - Fridge section

- 2 removable door storage compartments.
- 4 safety glass shelves of which 3 are height adjustable
- 4 height adjustable feet

Key features - Freezer section

- 4 door trays in the freezing compartment
- 2 freezer drawers

Included accessories

- 2 x cold accumulator, 1 x connection hose, 3 x egg tray

Dimension and installation

- Dimensions: 177.8 cm H x 91.2 cm W x 73.2 cm D
- Connection value 190 W
- 220 - 240 V
- Based on the results of the standard 24-hour test. Actual consumption depends on usage/position of the appliance.
- To achieve the declared energy consumption, the distanceholders have to be used. As a result, the appliance depth increases by about 3.5 cm. The appliance used without the distance holder is fully functional, but has a slightly higher energy consumption.

Performance and Consumption

- EU19_EEK_D: F
- Total Volume : 585 l
- Net Fridge Volume : 376 l
- Net Freezer Volume : 209 l
- Freezing capacity 24h : 15 kg
- Annual Energy Consumption: 419 kWh/a
- Climate Class: SN-T
- EU19_Fast freezer facility_D: yes
- Noise Level : 42 dB
- Temperature rise time : EU19_Temperature rise time_D: 8.5 H

Serie | 8, 177.8 x 91.2 cm, Black KAD92HBFP

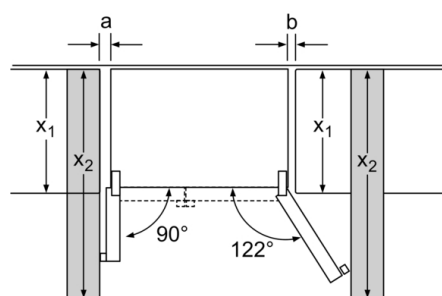
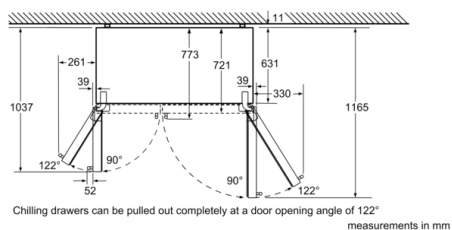

x_1 (unit depth)	a	b
600	39	39
650	39	53
700	39	85
x_2 (wall)	105	330

measurements in mm

measurements in mm

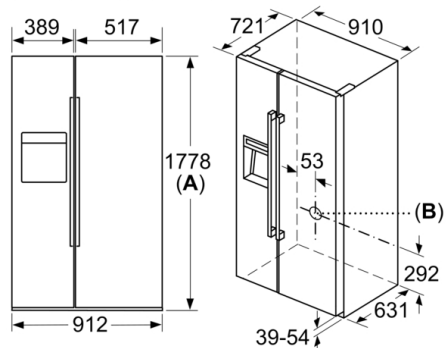

A: Front is adjustable from 1769 to 1784
B: Water connection to the appliance