

**Series 8, washing machine, front loader, 9 kg, 1600 rpm
WGA246UGHK**



- **Allergy Plus:** developed for allergy sufferers and people with sensitive skin.
- **4D Wash System:** highly efficient water and detergent penetration for spotless results.
- **Intensive Plus:** for extra cleaning boost for heavily soiled and full loads.
- **AntiStain:** reliably removes up to 4 most common stains (Blood, Grease&Oil, Cosmetics,Tea).
- **Eco Silence Drive™:** the efficient and highly durable washing machine drive.

Built-in / Free-standing: Free-standing
 Door opening: Left
 Color / Material body: White
 Length electrical supply cord: 210.0 cm
 Height of the appliance: 848 mm
 Dimensions of the product: 848x598x590 mm
 Wheels: No
 Net weight: 82.4 kg
 Drum volume: 70 l
 Door Frame: Chrome, blackgray
 Noise level - Washing: 48 dB(A) re 1pW
 Connection Rating: 2300 W
 Fuse protection: 10 A
 Voltage: 220-240 V
 Frequency: 50-60 Hz
 Energy Star Qualified: No
 Cord Included: Yes
 Plug type: GB plug
 Length of supply hose (in): 59.05 "
 Dimensions of the packed product: 34.44 x 25.19 x 26.57
 Net weight: 182.000 lbs
 Gross weight: 183.000 lbs
 Length of drain hose: 150.00 cm
 Length of supply hose: 150.00 cm
 Dimensions of the packed product (HxWxD): 875 x 640 x 675 mm
 Gross weight: 83.2 kg
 Power consumption standby/network: Please check the user manual for how to switch off the WiFi module.: 1.5 W
 Connection Rating: 2300 W
 Fuse protection: 10 A
 Voltage: 220-240 V
 Frequency: 50-60 Hz
 Water protection system: Aqualstop
 Maximum spin speed: 1600 rpm
 Spin speed options: Variable
 Digital countdown indicator: Yes
 Drying progress indicator: LED-display
 Maximum capacity in kg (EU 2017/1369): 9.0 kg

WMZ2200 Floor securing component
 WMZ2381 Extension for cold water inlet /Aqualstop



Series 8, washing machine, front loader, 9 kg, 1600 rpm WGA246UGHK

Performance

- WGA246UGHK
- Capacity: 9 kg
- Maximum spin speed: 1600 rpm

Key features

- 4D Wash System: highly efficient water and detergent fabric penetration for spotless results.
- Stain-automatic with 6 stain options(Cosmetics/Blood/Sweat/Oil/Coffee/Tea) - actioned with standard programmes
- EcoSilence Drive™ with Anti-vibration sidewalls design
- VarioDrum: gentle and efficient washing
- Large LED-Display for programme status indication
- SpeedPerfect: perfectly clean in up to 68% less time.
- ActiveWater Plus: for highly efficient use of water even with small loads thanks to automatic load detection.
- Indication of energy and water consumption prior to start of programme
- Drum interior light
- AquaStop with guarantee
- Flow-through sensor
- Automatic load detection for precise detection of loaded laundry to adjust automatically the amount of water is needed in every wash.
- DrumClean with reminder function
- Self cleaning detergent drawer
- Buzzer
- Childproof
- Unbalanced load detection

Programmes

- AllergyPlus, Eco 40-60, Cottons, Cottons Colour, Synthetics, Mix, Delicates/Silk, Wool, Quick 15'/30', Shirts, Sportswear, Drum Clean, Spin/Drain, Rinse

Additional options

- Intensive Plus, Anti-Stain, SpeedPerfect, Pre-wash, Extra Rinse, Remote Start, Temperature selection, Spin speed selection, Finish in time selection, Start/Reload

Technical Specification

- Dimensions (H x W x D): 84.8 cm x 59.8 cm x 59.0 cm
- *Exclude door frame or control panel thickness
- Appliance depth: 59.0 cm
- Appliance depth incl. door: 63.2 cm

**Series 8, washing machine, front
loader, 9 kg, 1600 rpm
WGA246UGHK**

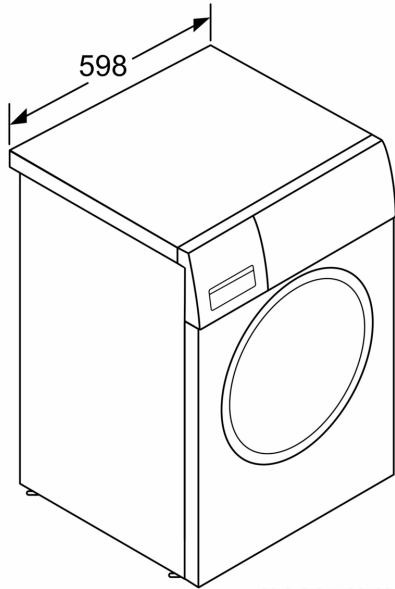

measurements in mm

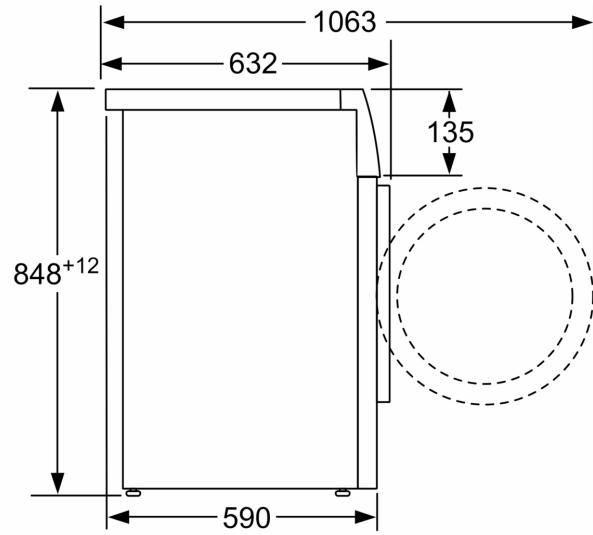

measurements in mm