

**Series 8, washing machine, front loader, 10 kg, 1600 rpm
WAX32LH0HK**



- **AllergyPlus Program:** 99.9%* bacteria removal at low temperature wash
- **ActiveOxygen Refresh :** refreshing your clothes from odors without washing in just 45 min.
- **4D Wash System:** highly efficient water and detergent fabric penetration for spotless results.
- **Intensive Plus:** for extra cleaning boost for heavily soiled and full loads.
- Larger washes and efficient results with 10kg capacity

Technical data

Built-in / Free-standing : Free-standing
 Door hinge : Left
 Color / Material body : White
 Length electrical supply cord : 160 cm
 Height for building under : 850.00 mm
 Height of the product : 848 mm
 Dimensions of the product : 848 x 598 x 590 mm
 Wheels : No
 Net weight : 83.4 kg
 Drum volume : 70 l
 Main colour of product : White
 Door Frame : Chrome, blackgray
 Noise level washing : 48 dB(A) re 1 pW
 Connection Rating : 2300 W
 Fuse protection : 10 A
 Voltage : 220-240 V
 Frequency : 50 Hz
 Energy Star Qualified : No
 Cord Included : Yes
 Plug type : GB plug
 Length of supply hose (in) : 59.05
 Dimensions of the packed product : 34.44 x 25.19 x 26.57
 Net weight : 184.000 lbs
 Gross weight : 186.000 lbs
 Length of drain hose : 150.00 cm
 Length of supply hose : 150.00 cm
 Dimensions of the packed product (HxWxD) : 875 x 675 x 640 mm
 Gross weight : 84.4 kg
 Connection Rating : 2300 W
 Fuse protection : 10 A
 Voltage : 220-240 V
 Frequency : 50 Hz
 Water protection system : Aquastop
 Maximum spin speed : 1600 rpm
 Spin speed options : Variable
 Digital countdown indicator : Yes
 Drying progress indicator : LED-display



Series 8, washing machine, front loader, 10 kg, 1600 rpm WAX32LH0HK

- WAX32LH0HK

Performance

- Capacity: 10 kg
- Maximum spin speed: 1600 rpm

Comfort and Safety

- ActiveOxygen™ Refresh program removes odors and refresh your laundry without washing in 45 minutes
- 4D Wash System: highly efficient water and detergent fabric penetration for spotless results.
- Large LED-Display for programme status indication
- EcoSilence Drive™ with Anti-vibration sidewalls design
- AntiVibration
- VarioDrum: gentle and efficient washing
- Automatic load detection for precise detection of loaded laundry to adjust automatically the amount of water is needed in every wash.
- Drum interior light
- DrumClean with reminder function
- Self cleaning detergent drawer
- AquaStop with guarantee
- Unbalanced load detection
- Childproof
- Buzzer

Programmes

- Cottons, Cottons Eco, Synthetics, Mix, Delicates/Silk, Wool, Rinse, Active Oxygen Refresh, AllergyPlus, Quick 15' /30', Shirts, Sportswear, Drum Clean, Spin/Drain

Additional options

- Intensive Plus, Pre-wash, Extra Rinse, Remote Start, Active Oxygen, SpeedPerfect, Temperature selection, Spin speed selection, Finish In time selection, Start/Reload

Technical Specification

- Dimensions (H x W x D): 84.8 cm x 59.8 cm x 59.0 cm
*Exclude door frame or control panel thickness
- Appliance depth: 59.0 cm
- Appliance depth incl. door: 63.2 cm

**Series 8, washing machine, front loader, 10
kg, 1600 rpm
WAX32LH0HK**

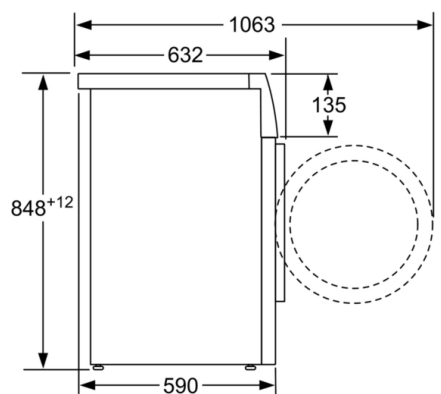

measurements in mm

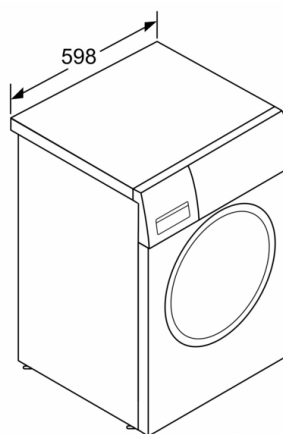

measurements in mm