

**Series 8, Heat pump tumble dryer, 9 kg, White WQB246C9GB**

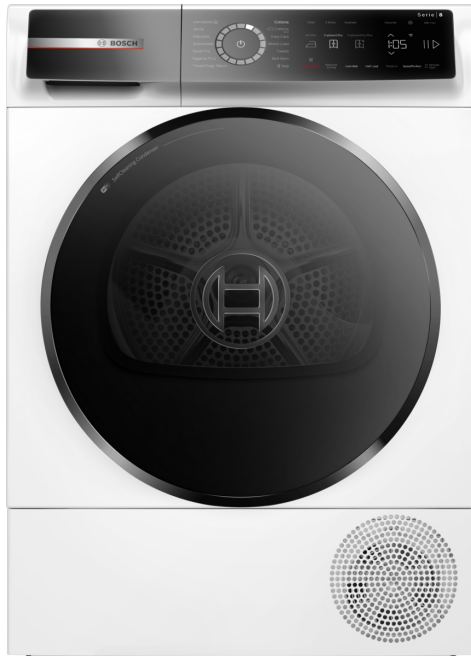

**Optional accessories**

WMZ20600	Wool in basket - accessory
WTZ27500	Stacking kit with pull-out shelf
WTZ27510	Stacking kit
WTZPW20D	Platform with pull-out, dryer, cubic

**An exceptional heatpump dryer with Smart Dry powered by Home Connect. Maximise your energy savings with A+++ -10%\* and the Self Cleaning condenser. Protect your Garments with Auto Dry and reduce your ironing Pile with Iron Assist.**

- **A+++ rated:** Discover our highly efficient dryer
- **Self-Cleaning Condenser:** Automatic fluff-cleaning condenser.
- **Anti Vibration sidewall:** extremely stable and quiet thanks to special vibration protection.
- **Auto Dry:** Automatically senses when your load is dried.
- **Half Load option:** optimises the drying settings (load and duration) for small loads.

**Technical Data**

Built-in / Free-standing:	Freestanding
Removable top:	No
Door hinge:	Right reversible
Length electrical supply cord:	180.0 cm
Dimensions:	842x598x613 mm
Net weight:	55.2 kg
Fluorinated greenhouse gases:	No
Hermetically sealed equipment:	Yes
EAN code:	4242005364428
Connection rating:	600 W
Fuse protection:	10 A
Voltage:	220-240 V
Frequency:	50 Hz
Maximum capacity in kg:	9.0 kg
Energy Efficiency Class <sup>1</sup> :	C
Weighted energy consumption per cycle (EU 2017/1369):	0.95 kWh/cycle
Weighted energy consumption per 100 cycles (EU 2017/1369):	95 kWh/100 cycles
Condensation Efficiency (EU 2017/1369):	91 %
Programme duration half capacity (EU 2017/1369):	2:36
Programme duration rated capacity (EU 2017/1369):	4:20



<sup>1</sup> Scale of Energy Efficiency Classes from A to G

## Series 8, Heat pump tumble dryer, 9 kg, White WQB246C9GB

**An exceptional heatpump dryer with Smart Dry powered by Home Connect. Maximise your energy savings with A+++ -10%\* and the Self Cleaning condenser. Protect your Garments with Auto Dry and reduce your ironing Pile with Iron Assist.**

### Performance

- Energy Efficiency Class<sup>1</sup>: A+++
- 10% more efficient than energy efficiency class A+++\*\*\*
- Energy<sup>2</sup>: 174 kWh
- Capacity: 1 - 9 kg
- Programme time<sup>3</sup>: 260 min
- Noise level: 58 dB (A) re 1 pW
- Condensation efficiency class<sup>4</sup>: A
- Condensation efficiency<sup>5</sup>: 91 %

### Programmes/functions

- Standard programmes: cotton, easy care
- Bed Linen Program: reduces tangling of big items thanks to reversible drum
- Programmes via app: Super 40, Woollens finish, Time program cold
- Special programmes: Cottons, Shirts/blouses, Cotton Eco, Delicates, Towels, Mixed Load, Sportswear, Easy-Care, Timed programme warm

### Key features

- Home Connect: Remote Monitoring and Control, Energy Management, Remote Diagnostics, SmartDry, further programmes via download. Always keep your appliance up to date via firmware update.
- Speed Perfect: Reduce drying time in selected programmes
- Half Load option: optimises drying for smaller loads
- Anti crease cycle 120 min at the end of the programme
- Touch control buttons: Iron dry, Cupboard dry, Cupboard dry+, end Time Delay, Reduced ironing, My favorite, Power button, Remote Start, Low heat, Start / Reload / Pause, speedPerfect, 24 h end Time Delay

### Additional features

- SC1R
- Elegant and ergonomically inclined control panel for easy use
- Load recommendation
- Fully electronic control dial for sensor programmes and timed programmes
- Sensitive drying: large stainless steel drum with textile care and revolution drying system
- AntiVibration design: for greater stability and quietness
- No
- Drum interior light
- Container for condensed water
- Child lock
- Buzzer to indicate the end of cycle

- Usage meter: counts completed programmes
- Door hinge: right-hand, reversible
- Metal door catch

### Technical Information

- slide-under installation
- Dimensions (H x W): 84.2 cm x 59.8 cm
- Appliance depth: 61.3 cm
- Appliance depth incl. door: 65.1 cm
- Appliance depth with open door: 110.5 cm
- Heat pump technology with climate friendly cooling agent

<sup>1</sup> At a range of energy efficiency classes from A+++ to D

<sup>3</sup> Programme time of the standard cotton programme at full load

<sup>4</sup> On a condensation efficiency class scale from A to G

<sup>5</sup> Weighted condensation efficiency for the standard cotton programme at full and partial load

**Series 8, Heat pump tumble dryer, 9  
kg, White  
WQB246C9GB**

Measurements in mm

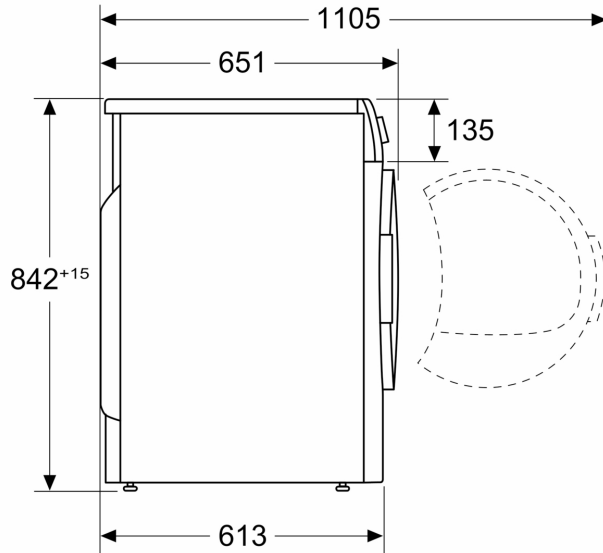

Measurements in mm

