

**Series 8, Washing machine, front loader, 10 kg, 1600 rpm
WAX32M81GB**



The Serie|8 washer with Home Connect, 4 AntiStain programmes and 4D Wash System with Intensive Plus provides spotless results with every load fully automatically.

- **AntiStain:** reliably removes four of the most common stains.
- **4D Wash System:** highly efficient water and detergent penetration for spotless results.
- **10kg VarioDrum:** enough space for big loads or large items
- **Home Connect:** home appliances with smart connectivity for an easier everyday life.
- **EcoSilence Drive™:** quiet and energy-efficient drive, with a 10-year warranty.

Technical Data

Energy Efficiency Class:	B
Weighted energy consumption in kWh per 100 washing cycles of eco 40-60 programme:	59 kWh
Maximum capacity in kg:	10.0 kg
The water consumption of the eco programme in liters per cycle:	47 l
Duration of eco 40-60 programme in hours and mins at rated capacity:	3:59 h
Spin-drying efficiency class of eco 40-60 programme:	A
Airborne acoustical noise emission class:	A
Airborne acoustical noise emissions :	72 dB(A) re 1 pW
Installation type:	Freestanding
Height of removable worktop:	-2 mm
Dimensions of the product:	848 x 598 x 590 mm
Net weight:	72.6 kg
Connection rating:	2300 W
Fuse protection:	10 A
Voltage:	220-240 V
Frequency:	50-60 Hz
Length of electrical supply cord:	160.0 cm
Door hinge:	Left
Wheels:	No
EAN code:	4242005305056
Installation type:	Free-standing

Optional accessories

WMZ2200	Floor securing component
WMZ2381	Extension for cold water inlet /Aquastop
WMZPW20W	Platform with pull-out, washer, cubic



Series 8, Washing machine, front loader, 10 kg, 1600 rpm WAX32M81GB

The Serie|8 washer with Home Connect, 4 AntiStain programmes and 4D Wash System with Intensive Plus provides spotless results with every load fully automatically.

Performance

- Energy Efficiency Class¹: B
- Energy² / Water³: 59 kWh / 47 litres
- Load capacity: 1 - 10 kg
- Programme duration⁴: 3:59 h:min
- Spin drying efficiency class: A
- Spin speed^{**}: 400 - 1600 rpm
- Noise level: 72 dB (A) re 1 pW
- Noise efficiency class: A

Programmes/functions

- Standard programmes: cottons, easy care, delicates, wool hand wash
- Special programmes: Drum clean with reminder, Dark Wash, Shirts, Drain / Spin, Mixed Load, Sportswear, Single Rinse, Super Quick 15/30, Hygiene

Key features

- Home Connect: Remote Monitoring and Control, iService Remote, Energy Management Photovoltaic
- AntiStain - 4 stain removal options at the touch of a button
- Touch control buttons: On/off, Ready in, stain selection, Intensive Plus, Rinse Plus, Remote Start, start/pause with reload function, Temperature selection, SpeedPerfect, Prewash, Spin speed reduction/Rinse Hold

Additional features

- Reload function: Flexibility to add or remove laundry items of any size even after start of the wash cycle.
- Large LCD display for programme status indication, temperature selection, max. spin speed, remaining time and 24 hours end time delay, stain selection and consumption indication
- 4D Wash System: highly efficient water and detergent fabric penetration for spotless results.
- Drum volume: 70 litres
- Drum interior light
- VarioDrum: gentle and efficient washing
- Drum clean with reminder function
- Large chrome, white door with 171° opening
- Reload function: Flexibility in adding laundry items into the drum, even after the wash cycle has started.
- EcoSilence drive with 10 year warranty
- EcoSilence drive with 10 year warranty
- ActiveWater Plus: for highly efficient use of water even with smaller loads thanks to automatic load detection.
- Consump indicator energy+water, AntiStain
- AntiVibration Design - for more stability and quietness
- Sound insulation by additional noise reduction material

- Sound insulation by additional noise reduction material
- Aqua Protection
- EcoBar Plus function: five possible levels of energy and water consumption
- Control dial with integrated On / Off mode
- Foam detection system
- Overdosage indication
- Safeguard monitoring system adjusts load distribution and programme settings to protect clothes
- Child lock
- Acoustic signals: Buzzer
- Detergent dispensing: easy clean
- Divider for Liquid Detergent

Technical Information

- Slide-under installation
- Dimensions (H x W): 84.8 cm x 59.8 cm
- Appliance depth: 59.0 cm
- Appliance depth incl. door: 63.2 cm
- Appliance depth with open door: 106.3 cm

¹ Scale of Energy Efficiency Classes from A to G

² Energy consumption in kWh per 100 cycles (in programme Eco 40-60)

³ Weighted water consumption in litres per cycle (in programme Eco 40-60)

⁴ Duration of Eco 40-60 programme

^{**} Values are rounded.

**Series 8, Washing machine, front
loader, 10 kg, 1600 rpm
WAX32M81GB**

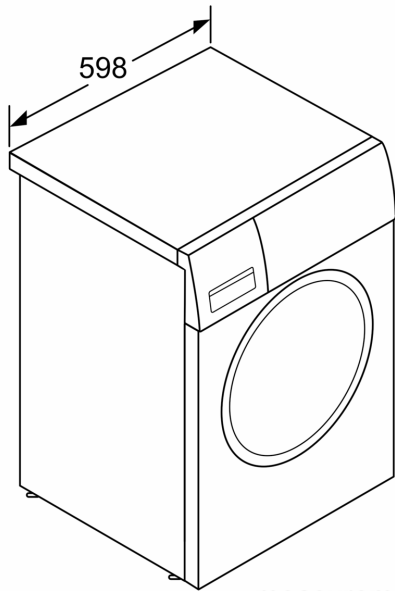

measurements in mm

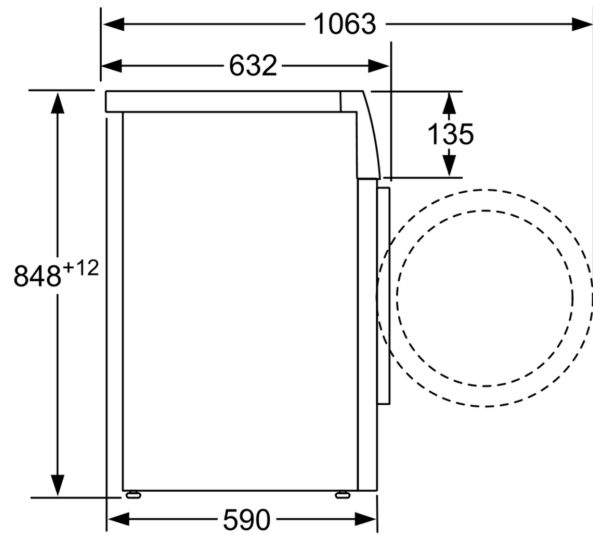

measurements in mm