

**Serie | 8, Washing machine, front loader, 9 kg, 1400 rpm
WAV28MH3GB**



The Serie|8 washer with Home Connect, 4 AntiStain programmes and 4D Wash System with Intensive Plus provides spotless results with every load fully automatically.

- **AntiStain:** reliably removes four of the most common stains.
- **4D Wash System:** highly efficient water and detergent penetration for spotless results.
- **Home Connect:** home appliances with smart connectivity for an easier everyday life.
- **EcoSilence Drive™:** quiet and energy-efficient drive, with a 10-year warranty.
- **AllergyPlus:** developed for allergy sufferers and people with sensitive skin.

Technical Data

Energy Efficiency Class: B
 Weighted energy consumption in kWh per 100 washing cycles of eco 40-60 programme: 57 kWh
 Maximum capacity in kg: 9.0 kg
 The water consumption of the eco programme in liters per cycle: 48 l
 Duration of eco 40-60 programme in hours and mins at rated capacity: 3:40 h
 Spin-drying efficiency class of eco 40-60 programme: B
 Airborne acoustical noise emission class: A
 Airborne acoustical noise emissions : 70 dB(A) re 1 pW
 Construction type: Free-standing
 Height of removable worktop: -2 mm
 Dimensions of the product: 848 x 598 x 590 mm
 Net weight: 72.3 kg
 Connection rating: 2300 W
 Fuse protection: 10 A
 Voltage: 220-240 V
 Frequency: 50 Hz
 Approval certificates: CE, E17D UKCA marking, VDE
 Length of electrical supply cord: 210 cm
 Door hinge: Left
 Wheels: No
 Power consumption standby/network: Please check the user manual for how to switch off the WiFi module.: 1.5 W
 Time auto-standby/network: 5.0 min
 EAN code: 4242005238255
 Installation type: Free-standing

Optional accessories

WMZ2200 : Floor securing component
 WMZ2381 : Extension for cold water inlet /Aquastop



Serie | 8, Washing machine, front loader, 9 kg, 1400 rpm WAV28MH3GB

The Serie|8 washer with Home Connect, 4 AntiStain programmes and 4D Wash System with Intensive Plus provides spotless results with every load fully automatically.

Performance

- Energy Efficiency Class¹: B
- Energy² / Water³: 57 kWh / 48 litres
- Load capacity: 1 - 9 kg
- Programme duration⁴: 3:40 h:min
- Spin drying efficiency class: B
- Spin speed^{**}: 400 - 1400 rpm
- Noise level: 70 dB (A) re 1 pW
- Noise efficiency class: A

Programmes/functions

- Touch control buttons: On/off, Ready in, stain selection, Intensive Plus, Rinse Plus, Remote Start, start/pause with reload function, Temperature selection, SpeedPerfect, Prewash, Spin speed reduction/Rinse Hold
- Standard programmes: cottons, easy care, delicates, wool hand wash
- Special programmes: Allergy +, Drum clean with reminder, Shirts, Drain / Spin, Mixed Load, Sportswear, Single Rinse, Super Quick 15/30
- Safeguard monitoring system adjusts load distribution and programme settings to protect clothes

Key features

- 4D Wash System: highly efficient water and detergent fabric penetration for spotless results.
- Home Connect: Remote Monitoring and Control, Energy Management
- AntiStain - 4 stain removal options at the touch of a button
- Reload function: Flexibility in adding laundry items into the drum, even after the wash cycle has started.
- EcoSilence drive with 10 year warranty
- AntiVibration Design - for more stability and quietness
- EcoBar Plus function: five possible levels of energy and water consumption

Additional features

- Large LCD display for programme status indication, temperature selection, max. spin speed, remaining time and

24 hours end time delay, stain selection and consumption indication

- Control dial with integrated On / Off mode
- VarioDrum: gentle and efficient washing
- Drum interior light
- Drum clean with reminder function
- Consump indicator energy+water, AntiStain
- Sound insulation by additional noise reduction material
- Aqua Protection
- Foam detection system
- Overdosage indication
- Detergent dispensing: easy clean
- Divider for Liquid Detergent
- Child lock
- Acoustic signals: Buzzer

Technical Information

- Slide-under installation
- Large chrome, white door with 171° opening
- Drum volume: 65 litres
- Dimensions (H x W): 84.8 cm x 59.8 cm
- Appliance depth: 59.0 cm
- Appliance depth incl. door: 63.2 cm
- Appliance depth with open door: 106.3 cm

¹ Scale of Energy Efficiency Classes from A to G

² Energy consumption in kWh per 100 cycles (in programme Eco 40-60)

³ Weighted water consumption in litres per cycle (in programme Eco 40-60)

⁴ Duration of Eco 40-60 programme

^{**} Values are rounded.

**Serie | 8, Washing machine, front loader, 9
kg, 1400 rpm
WAV28MH3GB**

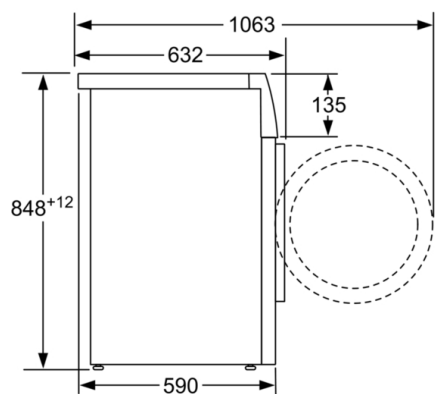

measurements in mm

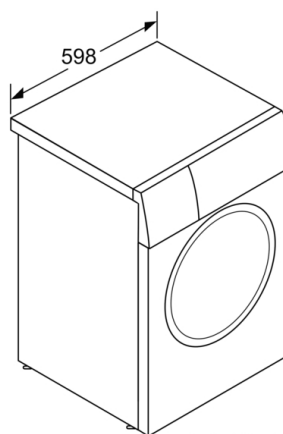

measurements in mm