

Series 4, Free-standing fridge-freezer with freezer at bottom, 203 x 60 cm, Stainless steel look KGN392LEBG



No Frost bottomfreezer : no need to defrost your freezer

- **VitaFresh:** keeps food fresh for longer in climate-controlled drawers at around 0°C.
- **Easy Access Shelf:** a pull-out glass shelf for easier access to everything inside your fridge.
- **Perfect Fit:** place your appliance right next to walls or in a niche.
- **LED lighting:** all your items in perfect view.
- **Individual Temperature Control:** separate temperature settings for your fridge and freezer.

Technical Data

| | |
|----------------------------------------------------------------------|--------------------------|
| Energy Efficiency Class ¹ : | E |
| Average annual energy consumption in kilowatt hour per year (kWh/a): | 238 kWh/annum |
| Sum of volume of frozen compartments: | 89 l |
| Sum of volume of chill compartments: | 279 l |
| Airborne acoustical noise emissions : | 39 dB(A) re 1pW |
| Airborne acoustical noise emission class: | C |
| Built-in / Free-standing: | Freestanding |
| Door panel options: | Not possible |
| Height: | 2030 mm |
| Width of the appliance: | 600 mm |
| Depth: | 660 mm |
| Net weight: | 72.1 kg |
| EAN code: | 4242005512324 |
| Connection rating: | 100 W |
| Fuse protection: | 10 A |
| Door hinge: | Right reversible |
| Voltage: | 220-240 V |
| Frequency: | 50 Hz |
| Length electrical supply cord: | 240 cm |
| Number of compressors: | 1 |
| Number of independent cooling systems: | 2 |
| Interior ventilator: | No |
| Reversible Door Hinge: | Yes |
| Number of Adjustable Shelves in fridge compartment: | 3 |
| Shelves for Bottles: | Yes |
| Frost free system: | Fridge and freezer |
| Installation typology: | Free-standing |



¹ Scale of Energy Efficiency Classes from A to G

Series 4, Free-standing fridge-freezer with freezer at bottom, 203 x 60 cm, Stainless steel look KGN392LEBG

No Frost bottomfreezer : no need to defrost your freezer

- KGN392LEBG
- No Frost, Fridge freezer
- Cambered door, High-door design Stainless steel look

Performance and Consumption

- EU19_EEK_D: E
- Total Volume : 368 l
- Annual Energy Consumption: 238 kWh/a
- Noise Level : 39 dB , EU19_Noise emission class_D: C

Functions

- Stainless steel look doors and Pearl grey (VZF 07127) side panels
- Integrated vertical handle
- Bright interior LED fridge light in fridge section

Design features

- NO_FROST_NEU_BL, never have to defrost ever again
- Separate, electronic temperature control with LED display
- Two separate cooling circuits allow independent temperature control and prevents the transference of humidity between the fridge and freezer cavity
- Super Cooling: automatic deactivation
- Optical and acoustical
- SuperFreeze function with automatic deactivation
- Freezer malfunction warning signal: optical and acoustical warning system

Design features

- Net Fridge Volume : 279 l
- MultiAirflow system - improves circulation of air around the fridge
- 5 safety glass shelves (3 height adjustable)
- Door shelves in fridge door: 1 large and 3 small.

Freshness System

- 1 VitaFresh drawer - Fish and meat stay fresh for longer
- 1 VitaFresh drawer with humidity control - Fruits and vegetables retain vitamins and stay fresh for longer

Food freshness system

- Net Freezer Volume : 89 l
- Freezing capacity 24h : 10 kg
- Temperature rise time : EU19_Temperature rise time_D: 12 H
- EU19_Fast freezer facility_D
- 3 freezer drawers

Dimension and installation

- Dimensions: 203 cm H x 60 cm W x 66 cm D

Key features - Fridge section

- Right hinged door, door reversible
- Height adjustable front feet
- Connection value 100 W

- 220 - 240 V
- Climate Class: SN-T
- Length of power cord:240 cm

Key features - Freezer section

- 1 x ice cube tray

Country Specific Options

- Based on the results of the standard 24-hour test. Actual consumption depends on usage/position of the appliance.
- To achieve the declared energy consumption, the distanceholders have to be used. As a result, the appliance depth increases by about 3.5 cm. The appliance used without the distance holder is fully functional, but has a slightly higher energy consumption.

Design features

Dimension and installation

Additional features

**Series 4, Free-standing fridge-freezer
with freezer at bottom, 203 x 60 cm,
Stainless steel look
KGN392LEBG**

| Appliance Name | a | b | c | d | e | f | g |
|---------------------------|------|-----|-----|-----|-----|------|-----|
| KGN39/KGF39 (int. handle) | 2030 | 600 | 660 | 590 | 600 | 1210 | 660 |
| KGN39/KGF39 (ext. handle) | 2030 | 600 | 660 | 590 | 640 | 1210 | 700 |

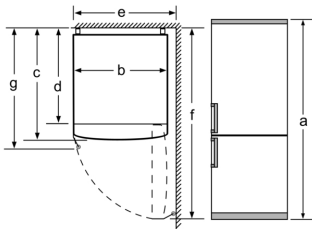

| Specification | |
|---------------|----------------------------------------|
| a | Height |
| b | Width |
| c | Depth with door closed, without handle |
| d | Cabinet depth |
| e | Width with door opened to 90° |
| f | Depth with door opened |
| g | Depth with door closed, with handle |

measurements in mm

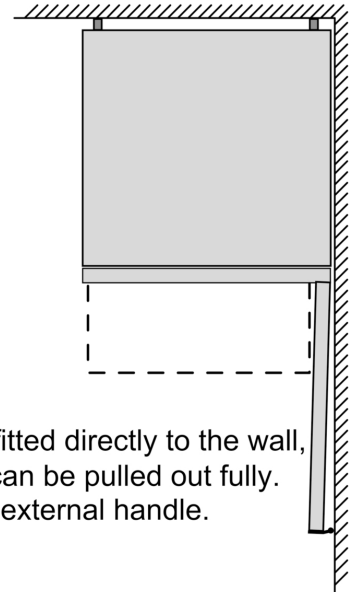

If the appliance is fitted directly to the wall,
all of the drawers can be pulled out fully.
* With and without external handle.