

## Series 8, Built-in compact oven with microwave function, 60 x 45 cm, Stainless steel CMG633BS1



1 x combination grid, 1 x universal pan

AOVG9MF00S Mech. Child safety lock (Gap size: 4mm), HEZ327000 Pizza stone, HEZ530000 Half tray, HEZ531010 Baking tray, non-stick ceramic coated, HEZ532010 Universal pan, non-stick ceramic coated, HEZ617000 Pizza pan, enamelled, HEZ625071 Grill tray, anthracite, HEZ631070 Baking tray, enamelled, HEZ632070 Multipurpose pan, enamelled, HEZ634080 Baking and roasting grid, microwave, HEZ636000 Glass pan, HEZ660050 Cover Strip, HEZ660060 Strip, HEZ664000 Baking and roasting grid, steam, HEZ915003 Glass roasting dish, 5,4 L, HEZG0AS00 Connecting cable 3m

- **Microwave function:** for quick warming up or for fast cooking in combination with hotair.
- **AutoPilot 14:** every dish is a perfect success thanks to 14 pre-set automatic programmes.
- **TFT Touch Display:** easy-to-use thanks to the Control Ring with clear text and symbols.
- **LED-light:** perfect illumination of foods with minimum energy consumption.
- **Flap door with SoftOpen and SoftClose:** the oven door opens and closes especially gently and quietly.

Additional function: ..... Microwave combination  
 Type of control: ..... Electronic  
 Dimensions: ..... 455x594x548 mm  
 Cavity dimensions: ..... 237 x 480 x 392 mm  
 Length electrical supply cord: ..... 150.0 cm  
 Net weight: ..... 35.5 kg  
 Gross weight: ..... 37.8 kg  
 Max. microwave power level: ..... 900 W  
 Number of Power Levels: ..... 5  
 Turntable: ..... No  
 Cavity material: ..... Enamelled steel  
 Door opening: ..... Handle  
 Clock: ..... Yes  
 Included accessories: ..... 1 x combination grid, 1 x universal pan  
 Height of the appliance: ..... 455 mm  
 Width of the appliance: ..... 594 mm  
 Depth of the product: ..... 548 mm  
 Max. microwave power level: ..... 900 W  
 Connection rating: ..... 3600 W  
 Fuse protection: ..... 16 A  
 Voltage: ..... 220-240 V  
 Frequency: ..... 60; 50 Hz  
 Plug type: ..... GARDY plug w/ earthing  
 Alternative colors available: ..... CMG633BB1, CMG633BW1  
 Required cutout/niche size for installation (in): ..... x  
 Dimensions of the packed product: ..... 20.47 x 25.59 x 26.77  
 Net weight: ..... 78.000 lbs  
 Gross weight: ..... 83.000 lbs



4 242002 789149

## **Series 8, Built-in compact oven with microwave function, 60 x 45 cm, Stainless steel CMG633BS1**

---

### **Type of oven / heating system:**

- Compact oven with microwave with 6 heating methods: 4D hotair, Hotair Eco,, Hot air grilling, Full width grill, Half width grill, Preheating
- Additional heating methods with microwave: microwave, combi microwave constant
- Intelligent inverter technology: maximum output power will be regulated to 600 W when used in longer operation
- Cavity volume: 45 l

### **Comfort:**

- 2,5"-TFT-color and text display with touch-control buttons
- Supporting systems: Programs
- Electronic clock
- Automatic rapid heating up
- LED light, Switch for oven illumination
- Integral cooling fan

### **Accessory:**

- universal pan, combination grid

### **Environment and Safety:**

- Child lock
- Automatic switch off Residual heat indicator Start-/Stop button  
Door contact switch

### **Technical Information**

- Length of mains cable: 150 cm
- Total connected load electric: 3.6 KW
- Appliance dimension (hxxwxh): 455 mm x 594 mm x 548 mm
- Niche dimension (hxxwxh): 450 mm - 455 mm x 560 mm - 568 mm x 550 mm
- "Please reference the built-in dimensions provided in the installation drawing"

**Series 8, Built-in compact oven with  
microwave function, 60 x 45 cm,  
Stainless steel  
CMG63BS1**

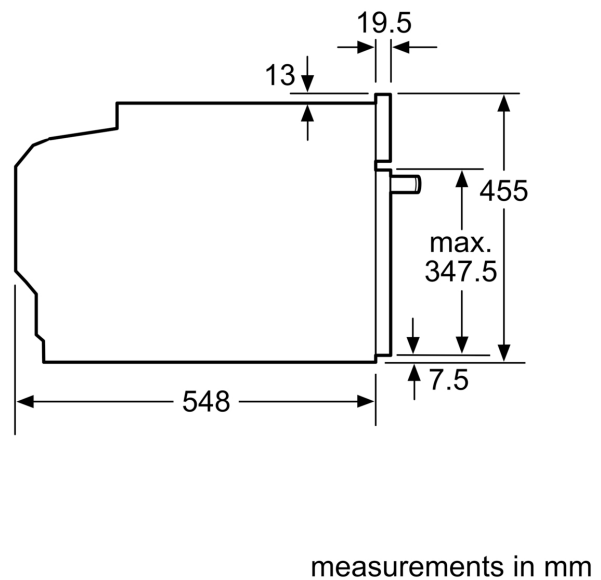
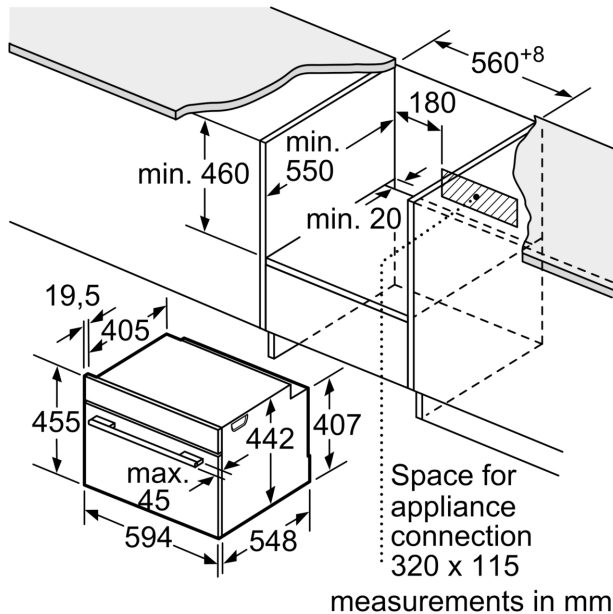

Installation with a hob.

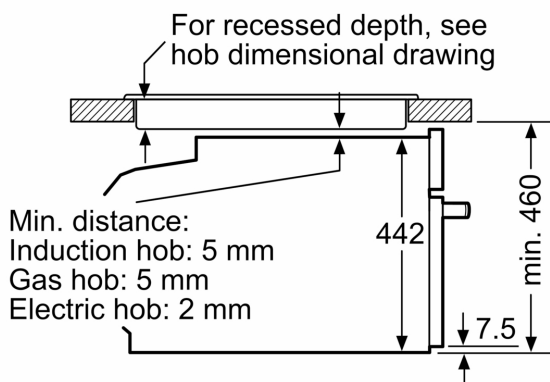

If the compact appliance will be installed underneath a hob, the following worktop thicknesses (including substructure if necessary) must be taken into account.

Hob type	min. worktop thickness	
	fitted	flush
Induction hob	42 mm	43 mm
Full surface Induction hob	52 mm	53 mm
Gas hob	32 mm	43 mm
Electric hob	32 mm	35 mm

