

300 Series, Compact Washer, 1400 rpm WGA12400UC



- **SpeedPerfect™**: washes in a shorter time with the cleaning results of the standard program.
- **ENERGY STAR® Certified**

Leak protection system:Multiple water protection
 Maximum spin speed: 1400 rpm
 Spin speed options: Variable
 Display: Yes
 Status Indicator: LED-Display



WTZPA30US RNA Power Adapter, Dryer (3-Prong)
 WMZ2200 Floor securing component
 WMZPW20W Platform with pull-out, washer, cubic
 WTZPA20UC RNA Power Adapter, Dryer

300 Series, Compact Washer, 1400 rpm WGA12400UC

measurements in inches
Reach of Power cords + Adapter (Not to Scale)

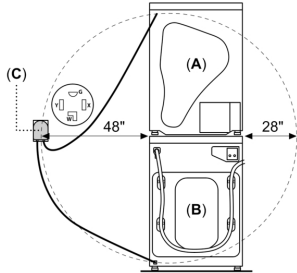

A: Dryer
B: Washer
C: Power Adapter
All references to NEMA 14-30R
Dryer receptacles in this document
have the orientation with the
ground pin up.

Use of two individual NEMA 6-15R or
6-20R receptacles may be used
as alternative means to power
Washer and Dryer.

Dimensions reflect use of stacking kits.

measurements in inches

**Guidance for location of Dryer receptacle
and Water taps to minimize depth
allowance (Not to Scale)**

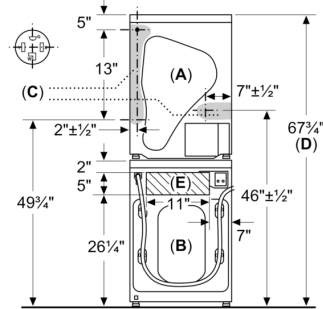

A: Dryer
B: Washer
C: Axis lines, in shaded areas, indicate Center
Line of home's Dryer receptacle for minimal
depth allowance if located entirely behind
appliances.
D: Minimum Stack Height (with Stacking Kit)
E: Hatched area - indicates location for
home's Hot and Cold water taps/outlets
for minimal depth if located entirely behind
appliances.

Installer / Customer is responsible for fit,
function, maintenance and safety of utility
installation.

measurements in inches
Under Counter (Preferred)

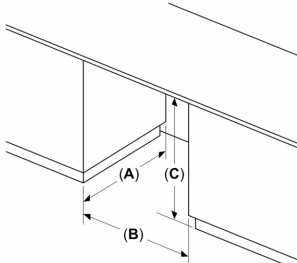

Minimum opening dimensions:

A: Depth - 28"
B: Width - 23 1/4"
C: Height - 34 1/2"

Front of appliance fully open.
No doors or coverings.

measurements in inches

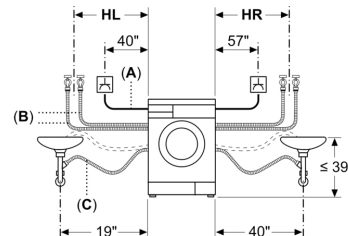

Washer Model	Supply Hose length	
	HL	HR
WAT28400UC	37"	21"
WAW285HxUC	43"	28"

Electrical Receptacle
A: Power Cord
B: Supply Hoses
C: Drain Hose

measurements in inches

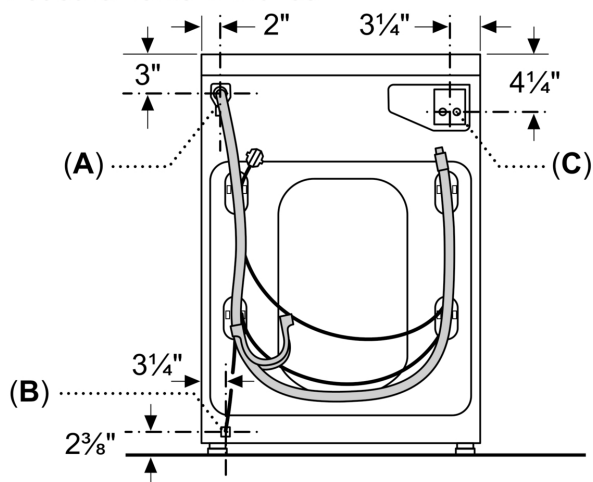

- A:** Drain exit
B: Power cord exit
C: Supply hoses (Hot and Cold)

measurements in inches

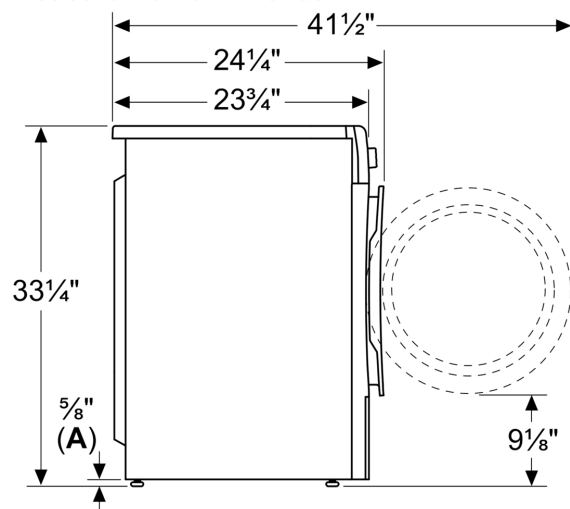

A: 5/8" nominal; 1/2" minimum; 1" maximum

measurements in inches

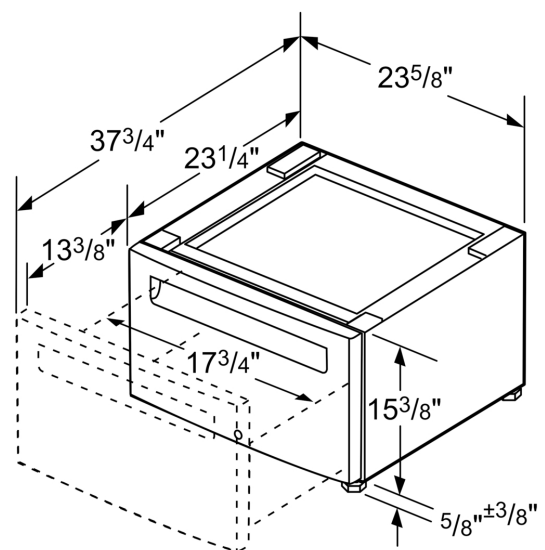
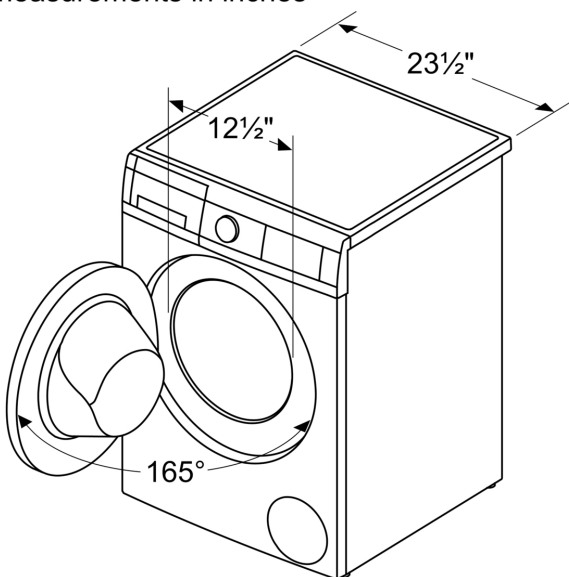

measurements in inches