

Series 4, heat pump tumble dryer, 8 kg, White WTH8300AU



Easy to use heat pump dryer for efficient drying with easy to clean filter

- **ActiveAir Technology:** Reuses existing heat efficiently during the entire drying process.
- **Auto Dry:** Automatically dries to the exact degree of dryness you want.
- **Anti-Vibration Design:** Extremely stable vibration protection ensures high smoothness of operation.
- **Sensitive Drying System:** for gentle drying without wrinkles.
- **Anti-crease:** laundry is automatically loosened once program finished and does not crease.

Built-in / Free-standing: Free-standing
Removable top: No
Door hinge: Right
Length electrical supply cord: 145.0 cm
Dimensions (HxWxD): 842x598x613 mm
Net weight: 46.4 kg
Fluorinated greenhouse gases: No
Hermetically sealed equipment: Yes
The quantity expressed in CO2 equivalent: 0.000 t
EAN code: 4242005311286
Connection rating: 600 W
Fuse protection: 10 A
Voltage: 220-240 V
Frequency: 50 Hz
Capacity: 8.0 kg
Energy efficiency rating: A+

WTZ11400 Stacking kit with pull-out shelf
WTZ20410 Stacking kit
WTZPW20D Platform with pull-out, dryer, cubic
WMZ20600 Wool in basket - accessory
WTZ1110 Condenser drainage kit



Series 4, heat pump tumble dryer, 8 kg, White WTH8300AU

- Dimensions (H x W x D): 84.2 cm x 59.8 cm x 61.3 cm (65.1 cm including door handle)
- Operating noise level: 65 dB(A)

Easy to use heat pump dryer for efficient drying with easy to clean filter

Capacity

- 7 Star energy rating

Consumption rates

- 7 Star energy rating
- Energy consumption 159 kWh per year on Cottons, Cupboard Dry Plus, Drying level 1, used once per week. When tested in accordance with AS/NZS 2442.2. Actual energy use and running costs will depend on how you use the appliance.

Programs

- Special drying programs:
 - Cottons: hard-wearing items made from cotton or linen with four desired dryless level options: Cupboard Extra Dry / Cupboard Dry / Iron Dry / Eco Easy Care: items made from synthetic or blended fabrics with three desired dryless level options: Cupboard Extra Dry / Cupboard Dry / Iron Dry
 - Shirts/Blouses: designed to allow immediate ironing or hanging up shirts/blouses after the program completes.
- Delicates: items made from satin, synthetic or blended fabrics
- Towels: hard wearing towels and dressing gowns made of cotton
- Mixed: items made from cotton or blended fabrics
- Super 40': short program for synthetic fabrics and light cottons
- Sportswear: sports and leisure items made from synthetic fibers, microfiber or fleece
- Timed Program Cold: manually set a custom time for loosening up or airing clothing that has hardly been worn
- Timed Program Warm: manually set a custom time for drying slightly damp or multi layered thick items
- Touch control option settings:
 - Three dryless level options: Cupboard Dry / Cupboard Dry Plus / Iron Dry
 - Easy Iron: the drum moves the laundry at regular intervals after drying to prevent creasing
- Finished in (delayed start): you can delay the start of the program by up to 24 hours

Performance

- ActiveAir heat pump technology, existing heat is reused efficiently during the entire drying process
- Easy clean filter for easy maintenance
- Sensitive drying system: textile friendly drum design and SoftFlow paddles ensure soft, fluffy laundry and helps to reduce creasing

Design

- AntiVibration design: for greater stability and quietness
- Large LED display for easy use
- Large water condensation container: If there is no drain hose connected to the appliance the condensation water from the drying cycle will be stored in the condensation container

Features

- Time delay to select end of time of your wash (1-24 hours) and time remaining indicator

Safety

- Child safety control lock

Technical Information

**Series 4, heat pump tumble dryer, 8
kg, White
WTH8300AU**

Measurements in mm

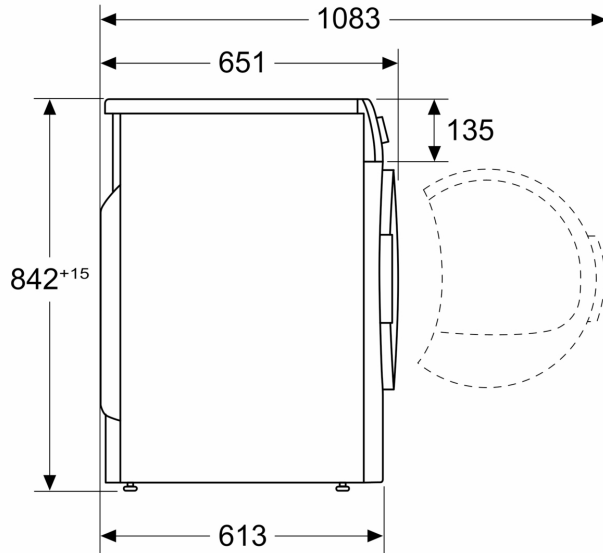

Measurements in mm

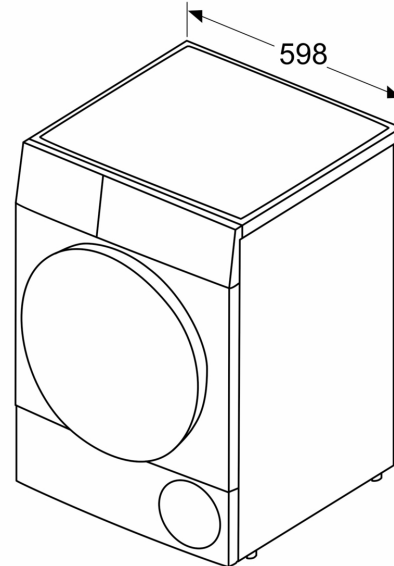

Measurements in mm

