

**Series 8, washing machine, front loader, 9 kg, 1400 rpm
WGG24402AU**



- **AllergyPlus:** Developed for allergy sufferers and people with sensitive skin.
- **Speed Perfect:** Perfectly clean in up to 65% less time
- **Speed Perfect:** Perfectly clean in up to 65% less time
- .
- **Easy Iron:** Reduces wrinkles by up to 50%
- **Drum Clean with reminder function:** Programme for cleaning and maintaining the drum.
- **AntiStain:** Reliably removes 4 common stains.

Technical Data

Built-in / Free-standing : Freestanding
Dimensions of the product : 848x598x590 mm
Net weight : 75.4 kg
Connection Rating : 2300 W
Fuse protection : 10 A
Voltage : 220-240 V
Frequency : 50-60 Hz
Length electrical supply cord : 160 cm
Washing performance class : A
Total annual energy consumption : 215.0 kWh/year
Water consumption : 78.0 l
Door hinge : Left
Wheels : No
EAN code : 4242005350957
Capacity cotton - NEW (2010/30/EC) : 9.0 kg
Energy efficiency rating : Not applicable
Energy consumption : 0.59 kWh
Spin drying performance class : B
Maximum spin speed : 1400 rpm
Noise level washing : 45 dB(A) re 1pW
Noise level spinning : 74 dB(A) re 1pW
Installation type : Freestanding



4 242005 350957

Series 8, washing machine, front loader, 9 kg, 1400 rpm WGG24402AU

Capacity

- Capacity: 9 kg

Consumption rates

- 5 Star Energy Rating
- Energy consumption 215 kWh per year, based on Cottons Eco, 60°C, program at 1400 RPM seven times per week. When tested in accordance with AS/NZS 2040.2. Actual energy use and running costs will depend on how you use the appliance.
- 4.5 Star water rating (WELS)
- Water consumption 78 l litres per wash. Using the Cottons Eco program at 60°C with 1400 RPM spin speed. In accordance with AS/NZS 6400. Actual water consumption will depend on how the appliance is used. AU WELS Registration Number: C02221.

Programs

- Standard programs:
Cottons: hard-wearing items made from cotton, linen or blended fabrics
Cotton Eco: energy-saving program
Easy care: items made from synthetic or blended fabrics
Delicate/Silk: delicate, washable items made from silk, viscose and synthetics
Wool: hand or machine washable items that are made from wool or contain wool
- Additional specialty programs:
AllergyPlus/Hygienic: suits items that need to be hygienically clean such as towels, bed sheets or pillow cases
Drum Clean: cleaning and care program for the drum with reminder function
Shirts/Blouses: non-iron shirts and blouses made from cotton, linen, or blended fabrics
Jeans/Dark Wash: dark coloured cottons and dark coloured easy care fabrics
Spin/Drain: spins and drains the water
Mixed: lightly soiled items made from cotton, linen or blended fabrics
Sportswear: sports and leisure items made from synthetic fibres, microfibre or fleece
Rinse: rinses and then spins the laundry, and then drains the water
Super 15'/30': short program for small lightly soiled items

Performance

- Spin speed 400 - 1400 rpm
- EcoSilence Drive: quiet, durable, and energy-efficient brushless motor (BLDC) with 10-year motor warranty
- ActiveWater Plus: for highly efficient use of water even with small loads thanks to automatic load detection.
- SpeedPerfect: perfectly clean in up to 65% less time.

Features

- Made in Germany, Automatic stain removal system, load size label => VO with 4 stain options - activatable with standard programs. Simply select the type of stain on the display and

then the temperature, drum movement and soaking time will automatically adjust to the optimal settings

- Automatic load detection
- Large LED display for program status, temperature, spin speed, and time remaining
- soft dial
- LED interior drum light bathes the inside of the drum in a brilliant white light when opened
- Reload function to pause machine operation for adding in last minute laundry items
- AquaStop anti-flood protection system provides 100% anti-flood protection
- VarioDrum: thorough yet gentle washing thanks to the unique drum structure design
- Drum Clean reminder function: the LED indicator will flash when a drum clean is required
- Foam detection system to remove excessive foam
- Self cleaning detergent drawer to remove detergent residue, From front

Design

- Large porthole, titan silver, black grey with 165° door for easy loading/unloading
- AntiVibration Side Panels reduce vibrations and noise levels, making it extremely quiet during the spin cycle

Safety

- Child safety control lock

Technical Information

- Slide-under height of 85cm
- Dimensions (H x W x D): 84.8 cm x 59.8 cm x 59.0 cm (63.6 cm including door handle)
- Operating noise level (based on Cotton 60°C program): wash 45 / spin 74 dB(A)

**Series 8, washing machine, front loader, 9
kg, 1400 rpm
WGG24402AU**

Measurements in mm

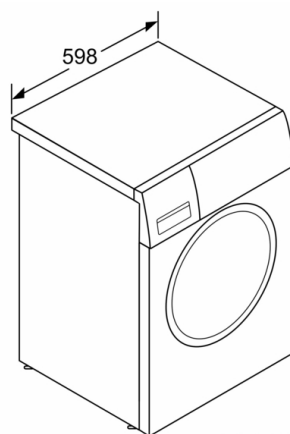
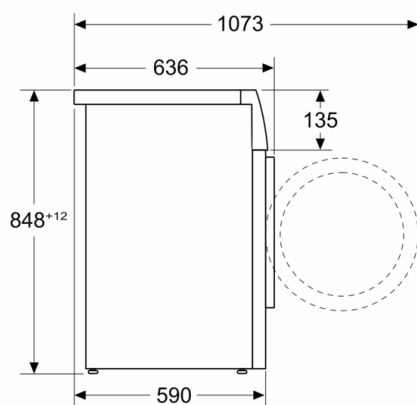

measurements in mm

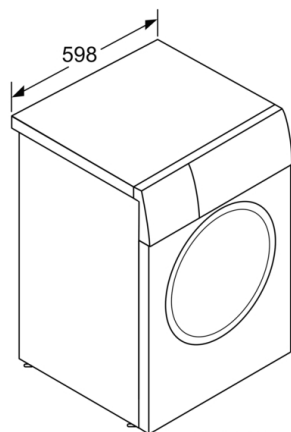

measurements in mm