

**HomeProfessional, washing machine,  
front loader, 9 kg, 1600 rpm  
WAY32891AU**



**9kg. Energy efficient in every way, with 4.5 Energy Stars and 4.5 Water Stars, the intelligent i-DOS dosing system dispenses the precise amount of detergent for every wash.**

- **i-DOS System:** automatically measures the precise amount of detergent and water needed for each load
- **AntiStain:** helps remove 16 most common stains.
- Automatic program intelligently adjusts the settings depending on fabric type and the degree of soiling
- **EcoSilence Drive:** quiet, durable, and energy-efficient brushless motor (BLDC) with 10-year motor warranty
- AllergyPlus is the ideal program for people with allergies and sensitive skin

#### Technical Data

Built-in / Free-standing : Freestanding  
 Height of removable worktop : -2 mm  
 Dimensions of the product : 848 x 598 x 590 mm  
 Height for building under : 850.00 mm  
 Net weight : 82.4 kg  
 Connection Rating : 2300 W  
 Fuse protection : 10 A  
 Voltage : 220-240 V  
 Frequency : 50 Hz  
 Approval certificates : Australia Standards, CE, VDE  
 Length electrical supply cord : 160 cm  
 Total annual energy consumption : 269.0 kWh  
 Water consumption : 77 l  
 Door hinge : Left  
 Wheels : No  
 EAN code : 4242005035328  
 Capacity cotton - NEW (2010/30/EC) : 9.0 kg  
 Energy consumption : 0.74 kWh  
 Spin drying performance class : A  
 Maximum spin speed : 1600 rpm  
 Noise level washing : 47 dB(A) re 1 pW  
 Noise level spinning : 73 dB(A) re 1 pW  
 Installation typology : Freestanding



4 242005 035328

## HomeProfessional, washing machine, front loader, 9 kg, 1600 rpm WAY32891AU

**9kg. Energy efficient in every way, with 4.5 Energy Stars and 4.5 Water Stars, the intelligent i-DOS dosing system dispenses the precise amount of detergent for every wash.**

### Capacity

- Capacity: 9 kg

### Consumption rates

- 4.5 Star energy rating
- 4.5 Star water rating (WELS)
- Operating noise level (based on Cotton 60°C program): wash 47 / spin 73 dB(A)

### Programs

- i-DOS automatic dosing system uses special sensors to determine the laundry's weight and type of textiles to dispense liquid detergents and fabric softener with maximum precision W\_F23-Xi
- Automatic stain removal system with 16 stain options
- Main Programs include:  
Cotton, Easy Care, Mix, Delicates, Wool, Quilts, - Shirts/Blouses: non-iron shirts and blouses made from cotton, linen, or blended fabrics, - Drum Clean: cleaning and care program for the drum with reminder function, - AllergyPlus/Hygienic: suits items that need to be hygienically clean such as towels, bed sheets or pillow cases, - Super 15'/30': short program for small lightly soiled items

### Performance

- i-DOS automatic dosing system uses special sensors to determine the laundry's weight and type of textiles to dispense liquid detergents and fabric softener with maximum precision
- AquaSensor measures degree of soiling for clothes and prescribes an extra rinse for a thorough clean
- EcoSilence Drive: quiet, durable, and energy-efficient brushless motor (BLDC) with 10-year motor warranty
- SpeedPerfect: allows you to reduce cleaning time by up to 65%
- VarioDrum: thorough yet gentle washing thanks to the unique drum structure design
- AntiVibration Side Panels reduce vibrations and noise levels, making it extremely quiet during the spin cycle
- Unbalanced load detection to minimise unnecessary vibration, noise and friction
- Spin speed 400 - 1600 rpm

### Convenience

- 64 litres water consumption per wash and 285 kWh energy consumption per year, based on the Cottons program with 60°C temperature setting, 1100 spin speed, and a cold water connection
- Self cleaning detergent drawer to remove detergent residue
- Drum Clean reminder function: the LED indicator will flash when a drum clean is required
- End of cycle indicator

### Design

- LED interior drum light bathes the inside of the drum in a brilliant white light when opened
- Illuminated control dial with integrated power On/Off button
- Large porthole, chrome, blackgrey with 180° door for easy loading/unloading
- High resolution TFT-cleartext display screen to indicate: Programme Status, Temperature and Spin Speed Selection, Remaining Time, 24 h End Time Delay, i-Dos Selection, Energy and Water Consumption Indicator for selected program, Load recommendation and measurement

### Safety

- AquaStop anti-flood protection system provides 100% anti-flood protection
- Child lock for door and buttons

### Technical Information

- Dimensions (H x W x D): 84.8 cm x 59.8 cm x 59.0 cm (63.2 cm with door frame)

**HomeProfessional, washing machine, front  
loader, 9 kg, 1600 rpm  
WAY32891AU**

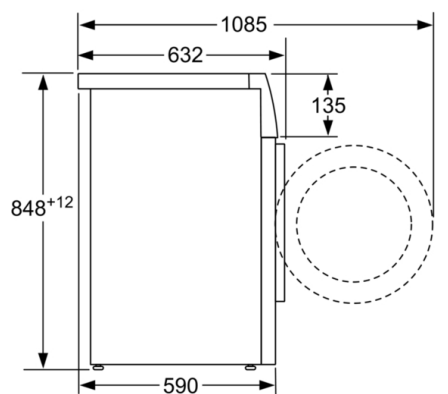

measurements in mm

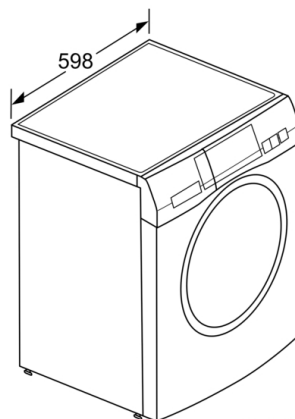

measurements in mm