

**Series 8, washing machine, front loader, 10 kg, 1600 rpm
WAX32K41AU**



i-DOS washing machine with Home Connect Wi-Fi connectivity, 4D Wash System provides spotless results with every load

- **i-DOS:** automatically measures the precise amount of detergent and water needed.
- **Home Connect:** home appliances with smart connectivity for an easier everyday life.
- **4D Wash System:** highly efficient water and detergent penetration for spotless results.
- **Eco Silence Drive™:** the efficient and highly durable washing machine drive.
- **10kg VarioDrum:** enough space for big loads or large items

Maximum capacity in kg : 10.0 kg
 Built-in / Free-standing:Free-standing
 Height of removable worktop:-2 mm
 Dimensions of the product:848 x 598 x 590 mm
 Net weight:83.6 kg
 Connection rating: 2300 W
 Fuse protection:10 A
 Voltage: 220-240 V
 Frequency: 50 Hz
 Length electrical supply cord: 160.0 cm
 Door hinge: Left
 Wheels:No
 EAN code:4242005220984
 Installation typology:Free-standing

WMZ2200 Floor securing component
 WMZ2381 Extension for cold water inlet /Aquastop
 WMZPW20W Platform with pull-out, washer, cubic



Series 8, washing machine, front loader, 10 kg, 1600 rpm WAX32K41AU

i-DOS washing machine with Home Connect Wi-Fi connectivity, 4D Wash System provides spotless results with every load

Capacity

- Capacity: 10 kg

Consumption rates

- 5 Star Energy Rating
- Energy consumption 250 kWh per year, based on Cottons Eco, 60°C, program at 1600 RPM seven times per week. When tested in accordance with AS/NZS 2040.2. Actual energy use and running costs will depend on how you use the appliance.
- 5 Star water rating (WELS)
- Water consumption 72 l litres per wash, using the Cottons Eco, 60°C, program at 1600 RPM. In accordance with AS/NZS 6400. Actual water consumption will depend on how the appliance is used. AU WELS Registration Number: C01890.

Programs

- Standard programs:
 - Cottons: hard-wearing items made from cotton, linen or blended fabrics Cotton Eco: energy-saving program Easy care: items made from synthetic or blended fabrics Delicate/Silk: delicate, washable items made from silk, viscose and synthetics Wool: hand or machine washable items that are made from wool or contain wool
- Additional specialty programs:
 - AllergyPlus/Hygienic: suits items that need to be hygienically clean such as towels, bed sheets or pillow cases
 - Automatic 30°C: gentle laundry care for delicate items, the degree of soiling and the type of fabric are automatically detected and the washing process is adapted Drum Clean: cleaning and care program for the drum with reminder function Shirts/Blouses: non-iron shirts and blouses made from cotton, linen, or blended fabrics Spin/Drain: spins and drains the water Mixed: lightly soiled items made from cotton, linen or blended fabrics Sportswear: sports and leisure items made from synthetic fibres, microfibre or fleece Rinse: rinses and then spins the laundry, and then drains the water Super 15'/30': short program for small lightly soiled items

Performance

- i-DOS automatic dosing system uses special sensors to determine the laundry's weight and type of textiles to dispense liquid detergents and fabric softener with maximum precision.
- ActiveWater Plus highly efficient water management technology automatically detects the exact load to determine the most efficient water flow possible
- Automatic load detection for precise detection of loaded laundry, allows the washing machine to automatically adjust the amount of water needed for every wash
- 4D Wash System: highly efficient and even water and detergent penetration for spotless results
- EcoSilence Drive: quiet, durable, and energy-efficient brushless motor (BLDC) with 10-year motor warranty
- VarioDrum: thorough yet gentle washing thanks to the unique drum structure design

- Spin speed 400 - 1600 rpm

Design

- Large multicolour LED display for program status, temperature, spin speed, energy/water consumption, and time remaining
- AntiVibration Side Panels reduce vibrations and noise levels, making it extremely quiet during the spin cycle

Features

- TouchControl buttons include:
 - Rinse Plus: Adds more rinse cycles, suited for highly soiled clothing
 - Intensive Plus: extend the program by up to 30 minutes, for heavily soiled items Prewash options for stubborn stains and heavily soiled garments Finish in (delayed start): delay the start of the program by up to 24 hours Spin Speed: manually adjust the spin speed Start/Pause with Reload function: allows you to add a forgotten garment even after the wash cycle has started Temperature selection: manually adjust the temperature SpeedPerfect: reduce cleaning time by up to 65%
- Home Connect allows you to control and monitor your appliance via your smartphone or tablet, bringing convenience and additional smart features to your home
- LED interior drum light bathes the inside of the drum in a brilliant white light when opened
- Illuminated control dial with integrated power On/Off button
- Reload function to pause machine operation for adding in last minute laundry items
- Drum Clean reminder function: the LED indicator will flash when a drum clean is required
- Consumption Indication: Information about energy and water consumption for program selected
- Large porthole, chrome, blackgrey with 171° door for easy loading/unloading

Safety

- Aqua Protection Plus anti-flood protection with self-sealing hose, minimises the risk of flooding
- Child lock for door and buttons

Technical Information

- Dimensions (H x W x D): 84.8 cm x 59.8 cm x 59.0 cm (63.2 cm including door handle)
- Operating noise level (based on Cotton 60°C program): wash 48 / spin 74 dB(A)

**Series 8, washing machine, front
loader, 10 kg, 1600 rpm
WAX32K41AU**

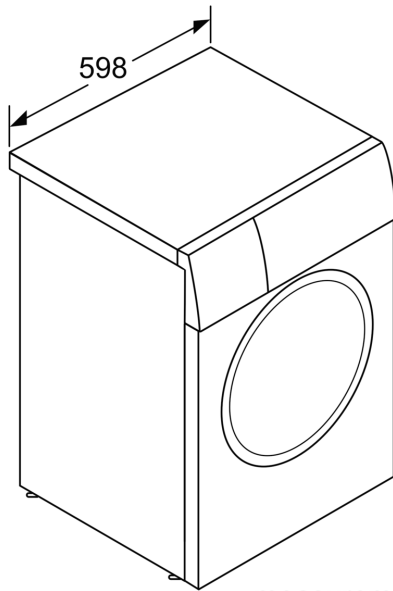

measurements in mm

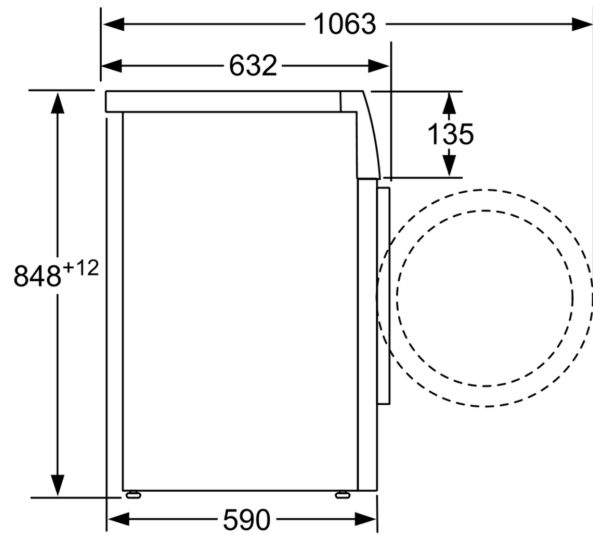

measurements in mm