

Series 6, washing machine, front loader, 8 kg, , White  
WAT28620AU



The smarter way to cleaner laundry is  
100% accurate detergent-dosing everytime  
with iDoS Automatic Dosing technology

- **i-DOS:** Automatically measures the precise amount of detergent and water needed.
- **Automatic programmes:** adjust the wash for the fabric type and degree of soiling.
- **Eco Silence Drive™:** The efficient and highly durable washing machine drive.
- **AllergyPlus:** Developed for allergy sufferers and people with sensitive skin.
- **Speed Perfect:** Perfectly clean in up to 65% less time.<sup>1</sup>

Maximum capacity in kg : ..... 8.0 kg  
Built-in / Free-standing: ..... Free-standing  
Dimensions of the product: ..... 848x598x590 mm  
Net weight: ..... 71.6 kg  
Connection rating: ..... 2300 W  
Fuse protection: ..... 10 A  
Voltage: ..... 220-240 V  
Frequency: ..... 50 Hz  
Length electrical supply cord: ..... 160.0 cm  
Door hinge: ..... Left  
Wheels: ..... No  
EAN code: ..... 4242005083664  
Installation typology: ..... Free-standing



- WMZ20490 Platform with pull-out  
WMZ2200 Floor securing component  
WMZ2381 Extension for cold water inlet /Aquastop  
WMZPW20W Platform with pull-out, washer, cubic

<sup>1</sup> Difference between the duration of Easy Care program 40°C and the duration of Easy Care program 40°C with SpeedPerfect. Duration of time saved varies based on load size.

## Series 6, washing machine, front loader, 8 kg, , White WAT28620AU

### The smarter way to cleaner laundry is 100% accurate detergent-dosing everytime with iDoS Automatic Dosing technology

#### Capacity

- Capacity: 8 kg

#### Consumption rates

- Energy consumption 200 kWh per year, based on Cottons 60, EcoPerfect, Rinse Plus program at 1400 RPM seven times per week. When tested in accordance with AS/NZS 2040.2. Actual energy use and running costs will depend on how you use the appliance.
- 5 Star water rating (WELS)
- Water consumption 58 l litres per wash, using the Cottons 60, EcoPerfect, Rinse Plus program at 1400 RPM. In accordance with AS/NZS 6400. Actual water consumption will depend on how the appliance is used. AU WELS Registration Number: C01730.

#### Programs

- Standard programs:
  - Cottons: hard-wearing items made from cotton, linen or blended fabrics - Cotton Eco: energy-saving program - Easy care: items made from synthetic or blended fabrics - Delicate/Silk: Delicate, washable items made from Silk, viscose and synthetics - Wool: hand or machine washable items that are made from wool or contain wool Additional specialty programs: AllergyPlus/Hygienic: suits items that need to be hygienically clean such as towels, bed sheets or pillow cases
- Automatic: the degree of soiling and the type of fabric are automatically detected and the washing process is adapted Drum Clean: cleaning and care program for the drum with reminder function Dark Wash: dark coloured cottons and dark coloured easy care fabrics Shirts/Blouses: non-iron shirts and blouses made from cotton, linen, or blended fabrics Mixed: lightly soiled items made from cotton, linen or blended fabrics Sportswear: sports and leisure items made from synthetic fibres, microfibre or fleece - Rinse/Spin: rinses and then spins the laundry, and then drains the water Super 15'/30': short program for small lightly soiled items

#### Performance

- i-DOS automatic dosing system uses special sensors to determine the laundry's weight and type of textiles to dispense liquid detergents and fabric softener with maximum precision
- EcoSilence Drive™ friction-free motor minimises wear and tear for a long-lasting performance, quiet operation and perfect wash results.
- VarioDrum's breakthrough wave-droplet design provides a thorough yet gentle clean for fine textiles
- Spin speed 400 - 1400 rpm

#### Design

- Large LED display for program status, temperature, spin speed, energy/water consumption, and time remaining
- Anti-Vibration Side Panels helps reduce vibrations and noise levels, making it extremely quiet during the spin cycle

#### Features

- Touch control option settings include:
- Child safety control lock

- Easy Iron: reduces creasing thanks to a special spin sequence
- i-DOS: activate or deactivate automatic dosing for liquid detergent and fabric softeners for each program Favourite (memory program): set your favourite combination of wash program and options and store it on the favourite button for future quick use Prewash options for stubborn stains and heavily soiled garments Rinse Stop: cancels the final spin cycle to prevent creasing if items will not be taken out immediately after the cycle has ended Rinse Plus: Adds more rinse cycles, suited for highly soiled clothing Soaking: items remain in water for longer before the main wash cycle to help remove stubborn soiling SpeedPerfect: allows you to reduce the wash program time Spin Speed: manually adjust the spin speed Start/Pause with Reload function: allows you to add a forgotten garment even after the wash cycle has started Finish in (delayed start): delay the start of the program by up to 24 hours Temperature selection: manually adjust the temperature
- Reload function to pause machine or add a forgotten laundry item
- Self cleaning detergent drawer to remove detergent residue to remove detergent residue
- Drum Clean reminder function: the LED indicator will flash when a drum clean is required
- Consumption Indication: Information about energy and water consumption for program selected
- SpeedPerfect: allows you to reduce cleaning time by up to 65%
- Large porthole, 171° swing door for easy loading/unloading of clothes

#### Safety

- Aqua Protection Plus anti-flood protection with self-sealing hose, minimises the risk of flooding
- Child lock for door and buttons

#### Technical Information

- Dimensions (H x W x D): 84.8 cm x 59.8 cm x 59.0 cm (63.2 cm with door frame)
- Operating noise level (based on Cotton 60°C program): wash 48 / spin 72 dB(A)

**Series 6, washing machine, front  
loader, 8 kg, , White  
WAT28620AU**

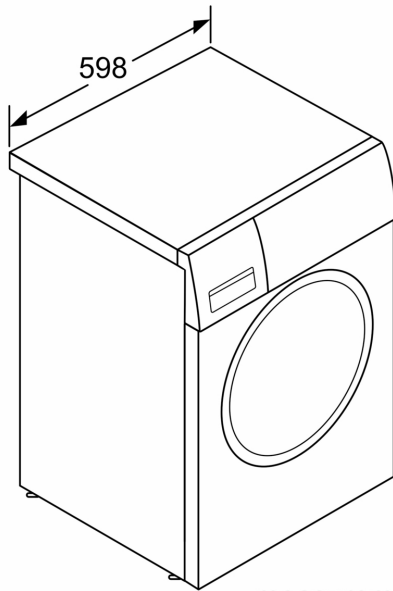

measurements in mm

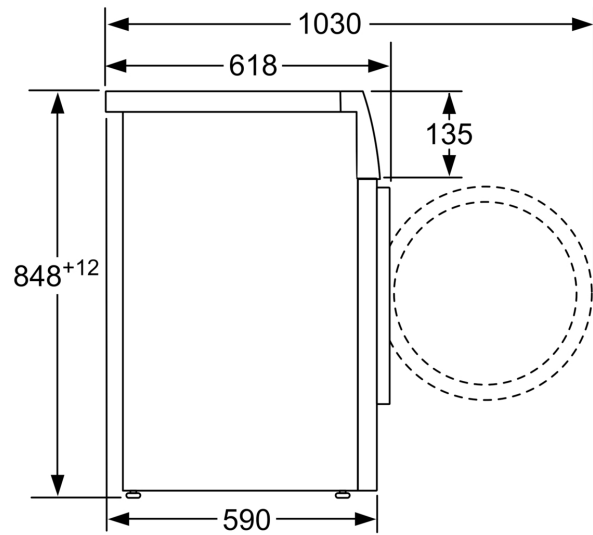

measurements in mm