

Series 4, washing machine, front loader, 8 kg, 1200 rpm WAN24125AU



Washing machine with Iron Assist to reduce your ironing pile and with a long lasting EcoSilence Drive motor.

- **Eco Silence Drive™:** Quiet and energy-efficient drive, with a 10-year warranty.
- **Speed Perfect:** Perfectly clean in up to 65% less time. ¹
- **Vario Drum:** Gently and efficiently wash with even water distribution and without creasing garments.
- **ActiveWater Plus:** For highly efficient use of water even with smaller loads thanks to automatic load detection.
- **Dark Colors program:** ideal for gentle cleaning of dark-coloured laundry, such as jeans.

Maximum capacity in kg : 8.0 kg
 Built-in / Free-standing: Free-standing
 Dimensions of the product: 845x598x590 mm
 Net weight: 71.3 kg
 Connection rating: 2300 W
 Fuse protection: 10 A
 Voltage: 220-240 V
 Frequency: 50 Hz
 Length electrical supply cord: 160 cm
 Door hinge: Left
 Wheels: No
 EAN code: 4242005397747
 Installation type: Free-standing



WMZ2200 Floor securing component
 WMZ2381 Extension for cold water inlet /Aquastop
 WMZPW20W Platform with pull-out, washer, cubic

¹ Difference between the duration of Easy Care program 40°C and the duration of Easy Care program 40°C with SpeedPerfect. Duration of time saved varies based on load size.

Series 4, washing machine, front loader, 8 kg, 1200 rpm WAN24125AU

Washing machine with Iron Assist to reduce your ironing pile and with a long lasting EcoSilence Drive motor.

Capacity

- Capacity: 8 kg
- 4 Star Water rating (WELS)
- Water consumption 80 l litres per wash. Using the Cottons Eco program at 60°C with 1200 rpm spin speed. In accordance with AS/NZS 6400. Actual water consumption will depend on how the appliance is used. C02282.
- 4.5 Stars
- Energy consumption Ener cons in a 4-pers househ: 220 kWh per year based on Cottons Eco program at 60°C, with 1200 rpm spin speed, seven times per week. When tested in accordance with AS/NZS 2040.2. Actual energy consumption will depend on how the appliance is used.

Consumption rates

- Spin speed 0 - 1200 rpm
- Operating noise level (based on Cotton 60°C program): wash 49 / 72 spin dB(A)

Programs

- Standard programs:
- Cottons: hard-wearing items made from cotton, linen or blended fabrics
- Cotton Eco: energy-saving program
- Easy care: items made from synthetic or blended fabrics
- Delicate/Silk: delicate, washable items made from silk, viscose and synthetics
- Wool: hand or machine washable items that are made from wool or contain wool
- Special programmes: Drum Clean: cleaning and care program for the drum with reminder function, Iron Assist - with added steam for wrinkle reduction, Shirts/Blouses: non-iron shirts and blouses made from cotton, linen, or blended fabrics, Easy Care: items made from synthetic or blended fabrics, Spin/Drain: spins and drains the water, Mixed: lightly soiled items made from cotton, linen or blended fabrics, Sportswear: sports and leisure items made from synthetic fibres, microfibre or fleece, Rinse: rinses and then spins the laundry, and then drains the water, Super 15'/30': short program for small lightly soiled items, delicate/silk, wool / hand wash

Performance

- SpeedPerfect: perfectly clean in up to 65% less time.
- Iron Assist: Steam programme that reduces wrinkles on dry clothes
- Touch control option settings include :
- Finish in (delayed start): delay the start of the program by up to 24 hours
- Rinse Plus: Adds more rinse cycles, suited for highly soiled clothing
- Start/Pause with Reload function: allows you to add a forgotten garment even after the wash cycle has started
- Temperature selection: manually adjust the temperature
- SpeedPerfect: reduce cleaning time by up to 65%

- Spin Speed: manually adjust the spin speed

Features

- Reload function to pause machine operation for adding in last minute laundry items
- Large display for spin speed, remaining time, 24 h end time delay and load recommendation
- Drum volume: 65 l
- Aqua Protection Plus anti-flood protection with self-sealing hose, minimises the risk of flooding
- Standard programs:
- Cottons: hard-wearing items made from cotton, linen or blended fabrics
- Cottons + PreWash: for stubborn stains and heavily soiled garments
- Easy care: items made from synthetic or blended fabrics
- Delicate/Silk: Delicate, washable items made from Silk, viscose and synthetics
- Wool: hand or machine washable items that are made from wool or contain wool
- Additional specialty programs:
- Drum Clean: cleaning and care program for the drum with reminder function
- Iron Assist - with added steam for wrinkle reduction
- Shirts/Blouses: non-iron shirts and blouses made from cotton, linen, or blended fabrics
- Easy Care: items made from synthetic or blended fabrics
- Spin/Drain: spins and drains the water
- Mixed: lightly soiled items made from cotton, linen or blended fabrics
- Sportswear: sports and leisure items made from synthetic fibres, microfibre or fleece
- Rinse: rinses and then spins the laundry, and then drains the water
- Super 15'/30': short program for small lightly soiled items
- noise insulation: bottom cover
- AntiVibration Side Panels reduce vibrations and noise levels, making it extremely quiet during the spin cycle
- EcoSilence Drive: quiet, durable, and energy-efficient brushless motor (BLDC) with 10-year motor warranty
- ActiveWater Plus: for highly efficient use of water even with small loads thanks to automatic load detection.
- Foam detection system to remove excessive foam
- Unbalanced load detection
- No
- End of cycle indicator
- Large porthole, silver-black grey with 171° door for easy loading/unloading
- Time delay to select end of time of your wash (1-24 hours) and time remaining indicator
- magnet with pull-open latch

Technical Information

- Slide-under height of 85cm
- Dimensions (H x W x D): 84.5 cm x 59.8 cm x 59.0 cm (63.3 cm including door handle)

**Series 4, washing machine, front
loader, 8 kg, 1200 rpm
WAN24125AU**

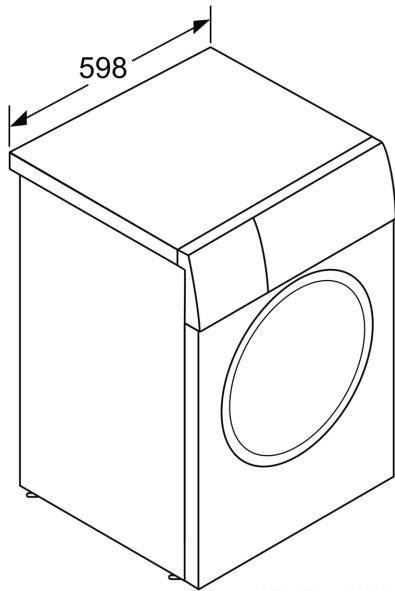

measurements in mm

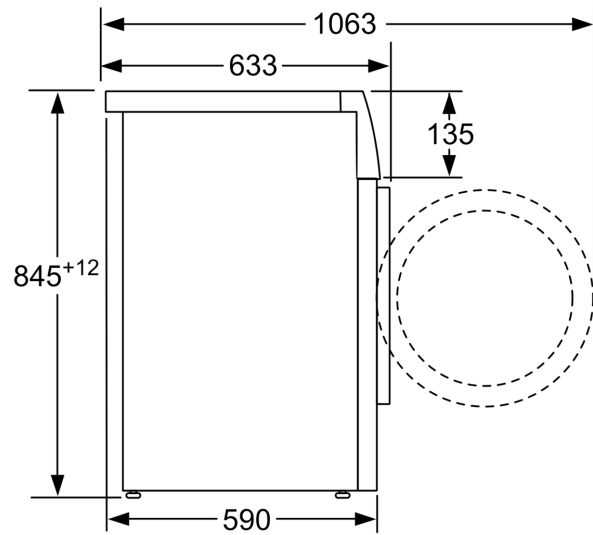

measurements in mm