

**Serie | 4, washing machine, front loader, 7.5 kg, 1100 rpm
WAN22120AU**



The washing machine with EcoSilence Drive™: enjoy quiet operation plus excellent durability and Aquasecure Flood Protection System

- Anti-Vibration Side Panels reduce vibrations and ensure greater stability during the washing and spinning process.
- **EcoSilence Drive™**: quiet and energy-efficient drive, with a 10-year warranty.
- **Reload function**: forgot an item? Add it easily to the wash.
- Drum Clean effectively removes any lingering odour, bacteria and detergent residue from the washing drum
- AquaSecure helps to minimize risk of flooding

Technical Data

Built-in / Free-standing : Freestanding
 Height of removable worktop : 850 mm
 Dimensions of the product : 848 x 598 x 550 mm
 Height for building under : 850.00 mm
 Net weight : 70.050 kg
 Connection Rating : 2050 W
 Fuse protection : 10 A
 Voltage : 220-240 V
 Frequency : 50 Hz
 Approval certificates : Australia Standards
 Length electrical supply cord : 175 cm
 Water consumption : 64 l
 Door hinge : Left
 Wheels : No
 EAN code : 4242002970875
 Capacity cotton - NEW (2010/30/EC) : 7.5 kg
 Energy consumption annual : 285.00 kWh/annum
 Energy consumption : 0.76 kWh
 Spin drying performance class : C
 Maximum spin speed : 1100 rpm
 Noise level washing : 52 dB(A) re 1 pW
 Noise level spinning : 68 dB(A) re 1 pW
 Installation typology : Freestanding



4 242002 970875

Serie | 4, washing machine, front loader, 7.5 kg, 1100 rpm WAN22120AU

The washing machine with EcoSilence Drive™: enjoy quiet operation plus excellent durability and Aquasecure Flood Protection System

Capacity

- Capacity: 7.5 kg

Consumption rates

- 4 Star energy rating
- 4.5 Star water rating (WELS)
- 64 litres water consumption per wash and 285 kWh energy consumption per year, based on the Cottons program with 60°C temperature setting, 1100 spin speed, and a cold water connection

Programs

- Additional specialty programs:
 - Drum clean: cleaning and care program for the Drum
 - Cottons: hard-wearing items made from cotton, linen or blended fabrics
 - Shirts/Blouses: non-iron shirts and blouses made from cotton, linen, or blended fabrics
 - Jeans/Dark Wash: dark coloured cottons and dark coloured easy care fabrics
 - Kidswear: energy optimised program for heat-resistant items made of cotton or linen
 - Mixed: lightly soiled items made from cotton, linen, or blended fabrics
 - Easy care: items made from synthetic or blended fabrics
 - Delicate/Silk: Delicate, washable items made from Silk, viscose and synthetics
 - Sportswear: sports and leisure items made from synthetic fibres, microfibre or fleece
 - Rinse/Spin: rinses and then spins the laundry, and then drains the water
 - Super 15'/30': short program for small lightly soiled items

Performance

- EcoSilence Drive: quiet, durable, and energy-efficient brushless motor (BLDC) with 10-year motor warranty
- SpeedPerfect/EcoPerfect: allows you to reduce cleaning time, or reduce energy consumption
- AntiVibration Side Panels reduce vibrations and noise levels, making it extremely quiet during the spin cycle
- Automatic load adjustment
- Spin speed 400 - 1100 rpm

Convenience

- Time delay to select end of time of your wash (1-24 hours) and time remaining indicator
- Foam detection system to remove excessive foam
- 64 litres water consumption per wash and 285 kWh energy consumption per year, based on the Cottons program with

60°C temperature setting, 1100 spin speed, and a cold water connection

- End of cycle indicator

Design

- Large LED display for program status, temperature, spin speed, and time remaining
- TouchControl buttons include :
 - EcoPerfect/SpeedPerfect: Speed up the selected program without compromising the wash result, or opt for EcoPerfect to reduce energy consumption
 - Start/Pause with Reload function: allows you to add a forgotten garment even after the wash cycle has started
 - Temperature selection: manually adjust the temperature
 - Spin Speed: manually adjust the spin speed
 - Rinse Plus
 - Finish in (delayed start): delay the start of the program by up to 24 hours
- Large porthole, white-black grey with 175° door for easy loading/unloading

Safety

- AquaSecure anti-flood protection with self-sealing hose, minimises the risk of flooding
- Child lock for door and buttons

Technical Information

- Dimensions (H x W x D): 84.8 cm x 59.8 cm x 55.0 cm (60.0 cm with door frame). Note: Due to its shorter depth, it is not recommended to stack a dryer on top of this machine.

**Serie | 4, washing machine, front loader, 7.5
kg, 1100 rpm
WAN22120AU**

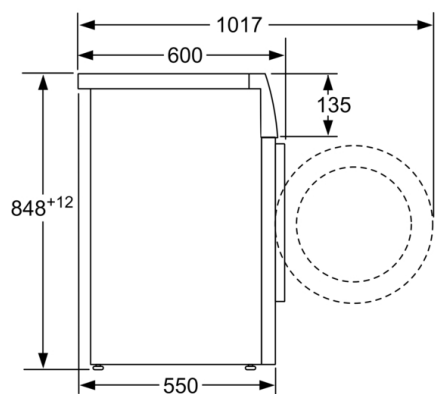

measurements in mm

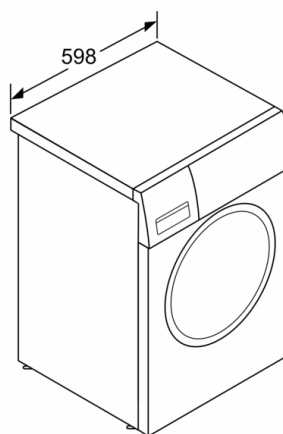

measurements in mm