

Serie | 6, American side by side, 175.6 x 91.2 cm, Inox-easyclean KAD92AI20A



Included accessories

1 x connection hose
1 x egg tray

A nofrost side-by-side fridge-freezer with VitaFresh Plus and ice-&water dispenser with LED illumination and 2 star energy efficiency.

- **XXL capacity:** extra space to store more food items due to the slightly wider build.
- **LED light:** illuminates the refrigerator evenly without glare.
- **NoFrost:** Prevents ice from forming, thus saving you time and effort from defrosting
- **EasyAccess Shelf:** pull-out glass shelf gives you better access to the ingredients inside your fridge.

Technical Data

Built-in / Free-standing : Freestanding
Number of compressors : 1
Number of independent cooling systems : 2
Width of the product : 912 mm
Height : 1756 mm
Depth of the product : 732 mm
Net weight : 129.8 kg
Door panel options : Not possible
Door hinge : left and right
Number of Adjustable Shelves in fridge compartment : 3
Shelves for Bottles : Yes
Interior ventilator : No
Reversible Door Hinge : No
Length electrical supply cord : 240 cm
Noise level : 45 dB(A) re 1 pW
Multi-Flow Air Tower : Yes
Fast cooling switch : Yes
Fast freezing switch : No
Carbon Air Filter : No
Temperature Controlled Drawer : No
Humidity Control Drawer : No
Number of Door Bins - Refrigerator : 5
Door bin adjustability - Refrigerator : No
Tilt-out door bins in fridge : Yes
Number of Gallon storage : 2
No. of shelves in fridge : 4
Number of shelves - Freezer : 2
Shelf Adjustability - Freezer : Yes
Capacity of Water Tank : 1.0 l
Connection Rating : 190 W
Fuse protection : 10 A
Voltage : 220-240 V
Frequency : 50 Hz
Freezer Net capacity : 0 l
Freezing capacity) : 0 kg/24h
Approval certificates : CE, VDE
Color / Material body : Chrome Inox-metallic
Door panel options : Not possible
Noise level : 45 dB(A) re 1 pW
Energy Star Qualified : No
Required cutout/niche size for installation (in) : x x
Dimensions of the packed product : 74.25 x 38.58 x 32.87
Net weight : 286.000 lbs
Gross weight : 302.000 lbs
Product name / Commercial code : KAD92AI20A



4 242002 920870

**Serie | 6, American side by side, 175.6 x 91.2 cm, Inox-easyclean
KAD92AI20A**

Accessories

- 1 x connection hose, 1 x egg tray

A nofrost side-by-side fridge-freezer with VitaFresh Plus and ice-&water dispenser with LED illumination and 2 star energy efficiency.

Performance & Consumption

- 3 Star Energy Rating, 650 kWh energy consumption per year

Design

- Dimensions (H x W x D): 1756 mm x 912 mm x 732 mm

Convenience & Safety

- VitaFresh plus: keeps food fresh for up to twice as long
- FrostFree - never again defrosting!
- Electronic temperature control with independent controls for fridge and freezer
- SuperCooling Function - Automatically brings down the temperature of the refrigerator to cool new groceries rapidly
- SuperFreezing function - Automatically brings down the temperature of the freezer to cool new items rapidly
- Acoustic door open alarm
- MultiAirflow Cooling System - minimises fluctuating temperatures by ensuring optimal and uniform air circulation in the fridge
- LED interior light lighting

Shelving & Compartments

- Fridge Total Net Capacity: 369 l
- Fridge : 4 non-spill safety glass shelves, 3 height-adjustable
- Fridge: 2 door shelves large, 3 door shelves small and dairy compartment
- Fridge : VitaFresh Drawer equipped with humidity control to keep fresh food crisp for longer
- Fridge : Extension rail system for easy pull out of drawer compartments
- MultiBox in Fridge - for extra storage
- Freezing capacity: 12 kg in 24 hours
- Freezer: 2 transparent drawers with telescopic rails
- Freezer: Non-spill safety glass freezer shelves; 2 are height-adjustable
- Visual and acoustic Warning System for temperature increase in fridge & freezer

Ice and Water

- Side-by-Side Fridge-freezer with in-door water and automatic ice cube maker

**Serie | 6, American side by side, 175.6 x 91.2
cm, Inox-easyclean
KAD92AI20A**

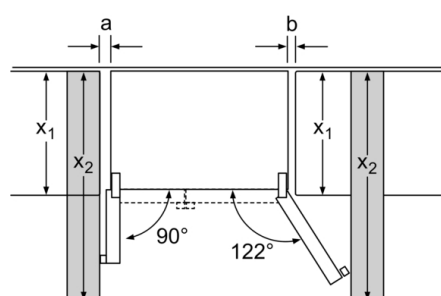
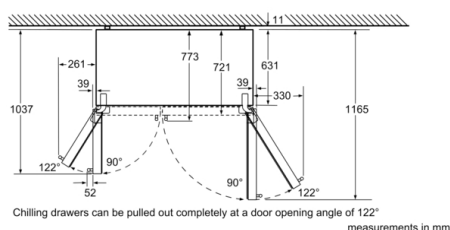

x_1 (unit depth)	a	b
600	39	39
650	39	53
700	39	85
x_2 (wall)	105	330

measurements in mm

