

Series 6, Stainless steel HBG5575S0A



Included accessories

1 x grill tray
2 x combination grid
1 x universal pan

Optional accessories

HEZ327000 : Pizza stone
HEZ531010 : Baking tray, non-stick ceramic coated
HEZ538000 : 1fold telescopic rail, level independent
HEZ538200 : 2 level telescopic shelf rails
HEZ634000 : Baking and roasting grid (standard)

The built-in oven with meat probe and AutoPilot: automatically prepares your dishes to perfection.

- **Meat probe:** measures the optimal core temperature of your roast.
- **AutoPilot 10:** every dish is a perfect success thanks to 10 pre-set automatic programs.
- **Pop-out controls:** Make the front of the oven easy to clean and give it a sleek look.
- **EcoClean Direct:** easy cleaning thanks to a coating that breaks down grease while you bake.
- **Flap door with SoftOpen and SoftClose:** the oven door opens and closes especially gently and quietly.

Technical Data

Color / Material Front : Stainless steel

Built-in / Free-standing : Built-in

Door opening : Drop down

Cleaning : Catalytic liners (all sides), Hydrolytic

Control Panel Material : Stainless steel

Door Material : Glass

Dimensions (HxWxD) : 595 x 594 x 548 mm

Dimensions of the packed product (HxWxD) : 680 x 690 x 660 mm

Min. required niche size for installation (HxWxD) : 585-595 x 560-568 x 550 mm

Cavity dimensions : 357 x 480 x 415 mm

Usable volume of cavity : 71 l

Number of interior lights : 1

Net weight : 35.2 kg

Gross weight : 37.4 kg

EAN code : 4242005057238

Connection Rating : 3400 W

Fuse protection : 16 A

Voltage : 220-240 V

Frequency : 60; 50 Hz

Length electrical supply cord : 120 cm



4 242005 057238

Series 6, Stainless steel HBG5575S0A

**The built-in oven with meat probe and
AutoPilot: automatically prepares your
dishes to perfection.**

Heating Functions

- Oven with 7 heating methods:
3D Hotair
Top/bottom heating Hot air grilling Full width grill Pizza
setting Bottom heating Hotair gentle
- Temperature range 50 °C - 275 °C
- Fast heat

Hook-in racks / rails

Design

- Rotary control knobs, Retractable control knobs
- Enamelled cavity (grey) with 5 shelf positions
- Cavity volume: 71 net usable litres

Cleaning

- EcoClean Direct : ceiling, back panel, side liners
- Full glass inner door

Convenience

- LCD-display control (white)
- Electronic clock/timer with end time programming
- Single-point meat probe
- Halogen lighting
- Cooling fan
- Bar handle

Safety and Environment

- Triple glazed door
- Child lock function, Residual heat indicator

Accessories

- 2 x combination grid, 1 x universal pan, 1 x grill tray

2 year warranty

Technical Info

- Length of mains cable: 120 cm
- Nominal voltage: 220 - 240 V
- Total connected load electric: 3.4 KW

Dimensions

- Appliance dimensions (HxWxD): 595 mm x 594 mm x 548 mm
- Installation dimensions (HxWxD): 585 mm - 595 mm x 560
mm - 568 mm x 550 mm

Series 6, Stainless steel HBG5575S0A

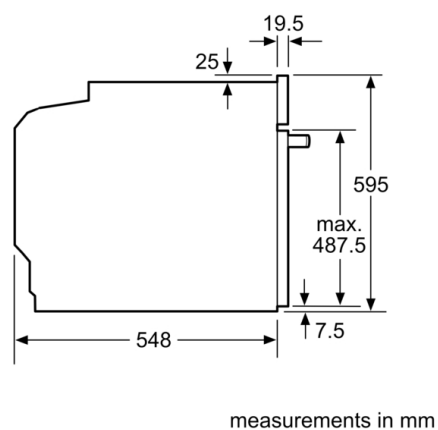
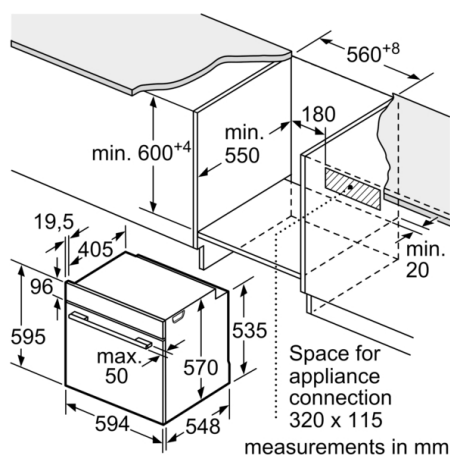

Installation with a hob.

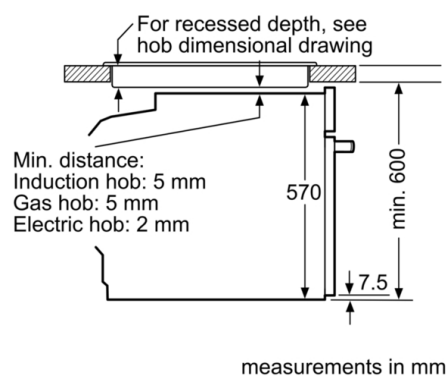

Measurements in mm

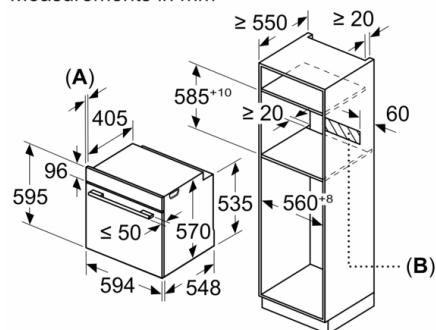

A: 19.5 mm
B: Space for appliance connection 320 x 115 mm