

**Series 4, Built-in oven, 60 x 60 cm,  
Stainless steel  
HBA534BS3A**

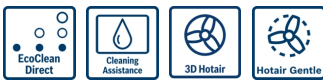

**Included accessories**

2 x combination grid  
1 x universal pan

**Optional accessories**

HEZ327000 : Pizza stone  
HEZ32WA00 : Wireless food thermometer  
HEZ530000 : Half tray  
HEZ531010 : Baking tray, non-stick ceramic coated  
HEZ532010 : Universal pan, non-stick ceramic coated  
HEZ538000 : 1fold telescopic rail, level independent  
HEZ629070 : Air Fry & Grill tray  
HEZ631070 : Baking tray, anthracite enamelled  
HEZ633001 : Lid for professional pan, enamelled  
HEZ634000 : Baking and roasting grid (standard)  
HEZ638000 : Full ext rails, level independent

**Perfect results: 3D hotair for perfect baking and roasting results on up to three levels simultaneously.**

- **EcoClean Direct:** reduces cleaning effort with a special rear-wall coating that absorbs grime.
- **Cleaning Assistance:** reduces cleaning effort with a simple programme designed for light soiling.
- **3D Hotair:** even heat distribution for perfect results on up to three levels.
- **Pizza setting:** ideal for cooking pizza and dishes that require intensive heat from below.
- **Hotair Gentle:** saves energy while baking and roasting on one level.

**Technical Data**

Color / Material Front : Stainless steel

Built-in / Free-standing : Built-in

Door opening : Drop down

Cleaning : EcoClean program, Hydrolytic

Control Panel Material : Stainless steel

Door Material : Glass

Dimensions (HxWxD) : 595x594x548 mm

Dimensions of the packed product (HxWxD) : 675x660x690 mm

Required niche size for installation (HxWxD) : 585-595 x 560-568 x 550 mm

Cavity dimensions : 357 x 480 x 415 mm

Usable volume of cavity : 71 l

Net weight : 33.1 kg

Gross weight : 34.6 kg

EAN code : 4242005464487

Connection Rating : 3400 W

Fuse protection : 16 A

Voltage : 220-240 V

Frequency : 50; 60 Hz

Length electrical supply cord : 120 cm



## **Series 4, Built-in oven, 60 x 60 cm, Stainless steel HBA534BS3A**

**Perfect results: 3D hotair for perfect baking and roasting results on up to three levels simultaneously.**

### **Dimensions**

- Appliance dimensions (HxWxD): 595 mm x 594 mm x 548 mm
- Installation dimensions (HxWxD): 585 mm - 595 mm x 560 mm - 568 mm x 550 mm
- Please reference the built-in dimensions provided in the installation drawing

---

### **Heating Functions**

- Oven with 7 heating methods:  
Full width grill, Hotair gentle, 3D Hotair, Top/bottom heating, Pizza setting, Bottom heating, Hot air grilling
- Temperature range 50 °C - 275 °C
- Cavity volume: 71 net usable litres

### **Racks and Rails**

- Number of shelf levels: 5
- Telescopic rails available as optional accessory

### **Design**

- Rotary control knobs, Retractable control knobs
- Cavity inner surface: enamel
- Extra large capacity oven

### **Cleaning**

- EcoClean Direct: coating of back panel
- Cleaning Assistance (manually)
- Full glass inner door

### **Convenience**

- LED-display control (red)
- Electronic clock/timer with end time programming
- Automatic start, Actual temperature display
- Bar handle
- Fast heat
- Halogen lighting
- Integrated cooling fan

### **Accessories**

- 2 x combination grid, 1 x universal pan

### **Safety Features**

- Maximum door temperature 40° C
- Triple glazed door
- Child lock

### **Technical Information**

- Length of mains cable: 120 cm
- Nominal voltage: 220 - 240 V
- Total connected load electric: 3.4 KW

**Series 4, Built-in oven, 60 x 60 cm, Stainless steel**  
**HBA534BS3A**

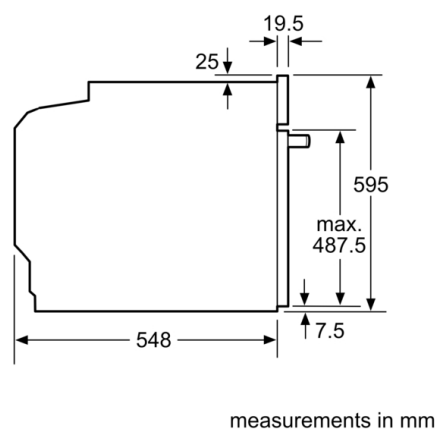
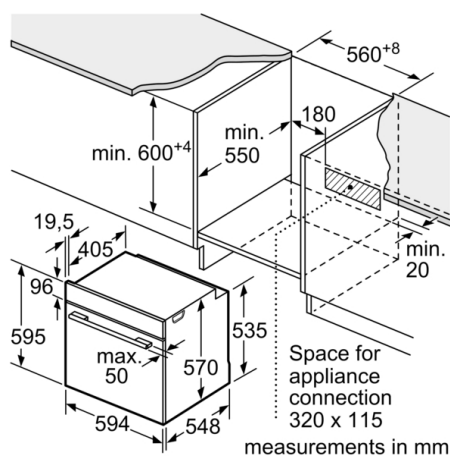

### Installation with a hob.

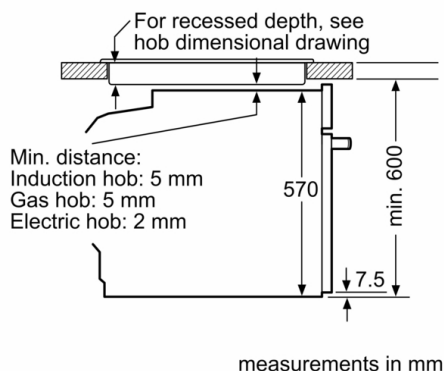

Measurements in mm

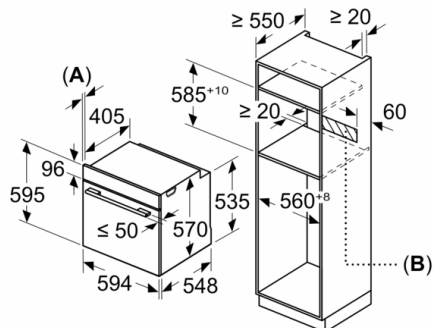

**A:** 19.5 mm  
**B:** Space for appliance connection 320 x 115 mm