



BOSCH

Invented for life

Your Guide to Home Development with Bosch



Welcome to your new home

Congratulations on collecting the keys to your new flat. If you're like most new homeowners, the journey of transforming this generic space into your ideal home can be daunting. There is just so much to consider, so many things to do and choices to make.

Relax - we've created this guide to help.



How To Use This Guidebook

- 1 Start with our overview of the renovation process in Getting Started
- 2 Design each living space with our Room Planning section
- 3 Creating an efficient kitchen can be tricky – become an expert with our dedicated Kitchen Guide

Along the way, we have included practical tips, important considerations and essential checklists to make your renovation enjoyable and successful.





ORANGECUBE

Inspired and motivated to provide a complete package of services from design conception to building completion, The Orange Cube has amassed an impressive portfolio since its establishment in 2003. Design principal Mr Lee Chi Ho has been creating beautiful homes, including many amazing HDB transformations, after leaving HDB as a Senior Executive Architect to pursue his passion in interior design.

www.theorangecube.com

Contents

Getting Started

- 4** Lifestyle
- 5** Theme
- 6** Budget
- 7** Timeline

Planning Your Living Space

- 8** Using your Floor Plan
- 10** Living Room
- 11** Dining Room
- 12** Bedroom
- 13** Bathroom
- 14** Service Yard

Kitchen Guide

- 16** Kitchen Planning
- 18** Kitchen Talk
- 20** Help with Hoods
- 23** Picking your Hobs
- 26** Oven Orientation
- 29** The Right Fridge
- 30** Dishwasher Facts

Useful Tools

- 34** Renovation planner
- 35** Lingo dictionary



Getting Started

4 Important Considerations before you design your home

1. Lifestyle

Above all, a successfully designed home must accommodate the lifestyle needs of you and your family.



Who are the residents?

For comfortable living in your new home, consider the lifestyles of your family members and prepare sufficient bedroom and storage space for their needs.



What are your cooking needs?

Families often bond at mealtimes so think about setting aside space and a budget for appropriate kitchen appliances that will take care of your food preparation.



Do you work from home?

If yes, consider allocating a comfortable, dedicated space so that you can work undisturbed for long stretches.



Do you entertain guests?

If so, think about the seating room you require and consider ideas like an open concept kitchen that allows guests to mingle while you cook.



What are your hobbies and passions?

Plan space and storage for your favourite past-times whether it is a display for your toy collection or a rack for your sporting equipment.



What does the future hold?

Your home should meet your needs for years to come. If you intend to start a family, consider a multi-purpose room that can be converted into a bedroom when needed.



2. Theme

Having a theme in mind gives your home a consistent look and helps when it comes to making decisions on colors, fixtures and furniture.



Scandinavian

Simple, Basic, Friendly, Functional.



Modern Glamour

Glamorous, Elegant, Luxurious Upholstery



Industrial

Raw Materials, Stark, Stylish



Minimalist

Bare, Sleek, Modern, Spacious

3. Budget

Knowing your budget is essential to plan a realistic and smooth renovation.

HDB Renovation & Appliances Costs Snapshot



When planning, it helps to break things up into their main categories. The chart below shows the breakdown of the main cost items in a typical renovation project.

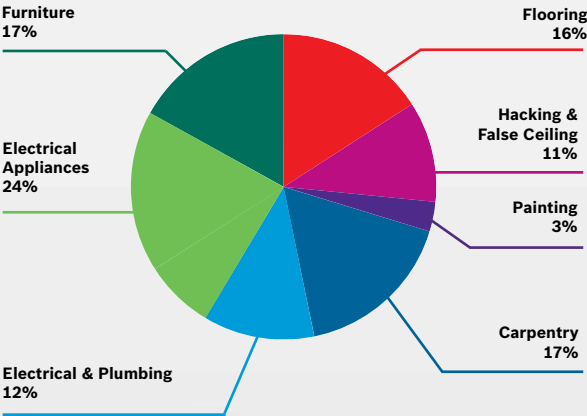

Types of works	Est. Cost Range
Demolishing walls	\$100-\$150 per ft
Hacking floor	\$2,000-\$3,000
New flooring (material cost)	
Tiles	\$3-\$15 per sqf
Hardwood	\$11-\$26 per sqf
Laminate	\$5-\$10 per sqf
Cement screed	\$4-\$6 per sqf
Wall tiling	\$15-\$30 per sqf
Kitchen cabinets and counter	\$3,600 - \$5,000
Kitchen countertop (depending on choice of material)	\$55-\$300 per ft run
Wardrobe carpentry	\$3,200-\$5,000
Electrical works	\$2,500-\$3,000
Plumbing works	\$1,000-\$1,200
Painting	\$1,200-\$2,000
Glass panel	\$1,000-\$1,500
Electrical Appliances	\$7,500-\$14,500

4. Timeline

Considering your timeline lets you allocate enough time for each phase and track your progress.

At a glance – Renovation periods

For a smooth renovation, create a detailed plan with clear milestones for each stage. Then follow your plan and adjust it as you go along.

Simple projects about
4–6wks

On average takes
8–10wks

Complex projects
12wks
or more

1 Shortlisting your appliances



~4 weeks

2 Engaging an Interior Designer

- Conceptualization and planning
- Approve 3D drawings, select tiles and fixtures



~8 weeks

3 Collecting Keys

- Checking for defects and reporting to HDB (3-5 days)
- Opening Singapore Power utilities account



~2 weeks

4 Start of renovation

- Hacking, tiling, running of electrical wiring, false ceiling construction, painting (1-3 weeks)
- Plumbing (3-5 days)
- Fabrication and installation of carpentry and installing counter-top (2-4 weeks)
- Final finishes (1 week)



~4 to 12 weeks

5 Completion of home renovation

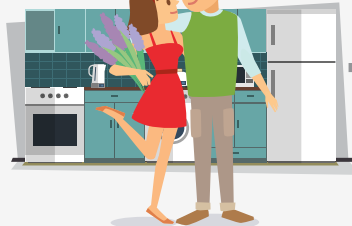

*Actual schedule and times may vary.

Using Your Floor Plan

Windows

Windows and grilles can only be installed by BCA-approved window contractors

Bath / WC

Hacking of floor/wall tiles of the toilet is permitted only after 3 years of completion of the block*

A/C Ledge

The air-conditioning compressor unit must be properly installed by a qualified personnel.

Service Yard

When stacking dryer and washing machine, take note of their height clearance to avoid interfering with the ceiling-mounted clothes rack. Grilles installed have to be of HDB approved designs*

* HDB permit required

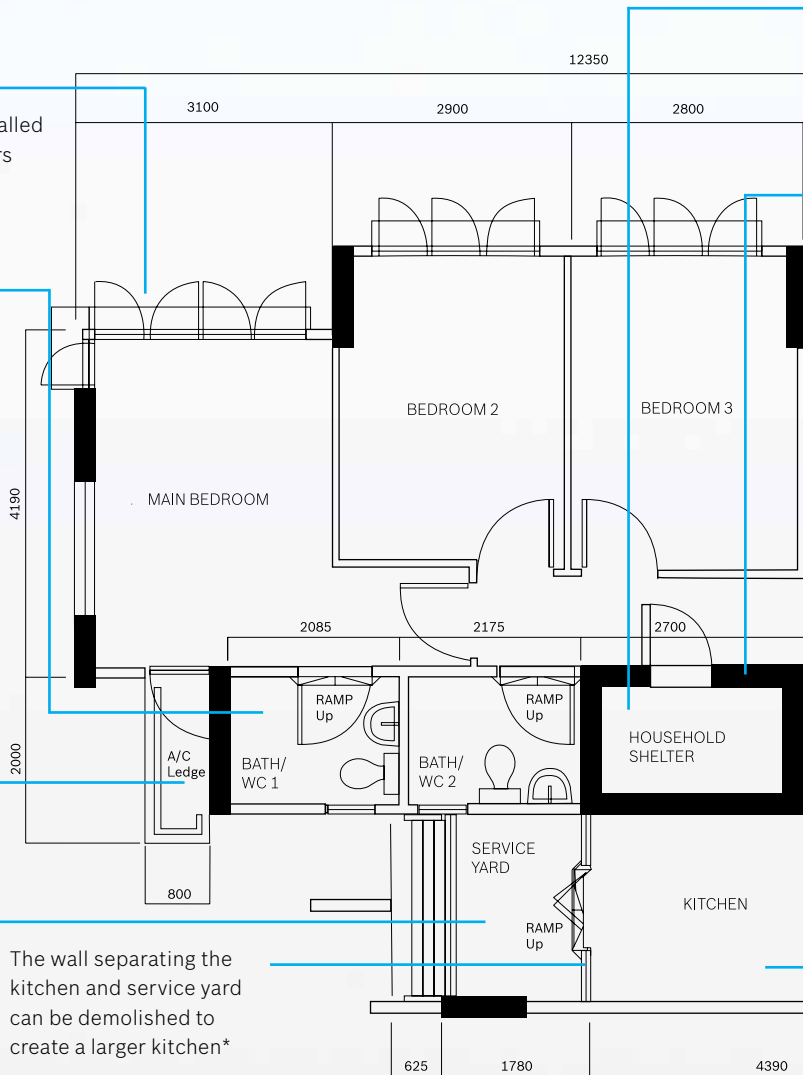

The wall separating the kitchen and service yard can be demolished to create a larger kitchen*

Household Shelter

HDB does not permit tampering with its reinforced walls, ceiling and door. Choose freestanding shelves instead of wall-mounted shelves.

Internal Structural Wall

No hacking or drilling allowed as this weakens the structural integrity of the building

Internal Wall

Hacking is permitted and needs to be completed within 3 days*

Main Circuit Board (MCB)

Newer HDB flats are equipped with a 40A rated MCB, while older flats typically have a 30A rated MCB. Choose appliances that operate safely within these limits to avoid power trips.

Main Door

If your main door opens to the fire escape route, your replacement door needs to have a fire resistancering of at least half an hour.

Kitchen

If you are planning to have an open concept kitchen, note that the basin and cooker top need to be placed within the original kitchen's boundaries.



Room for Creative Planning

You don't have to plan strictly around rooms designated in your floor plan. The option to hack certain walls means that with some creativity, you can reconfigure your home to create some amazing living spaces.

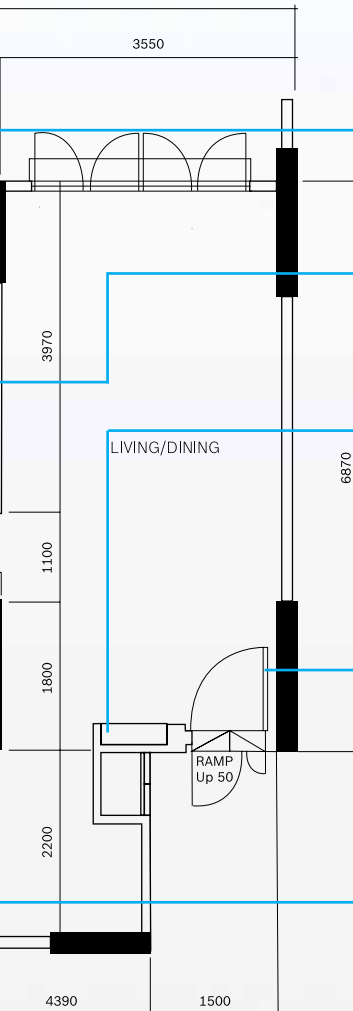

Living Room

Where you socialize and live – here are Ideas and considerations for planning the heart of your home.



Colours

- Choose lighter, cooler colours to make a small space look more spacious.
- Combine natural earthen colours with wood and stone furniture pieces for resort style living.



Lighting

- Warm light is comfortable to the eyes and can be used for general lighting.
- **Tip:** If you sometimes work in the living room, add a task light (e.g. LED desk light) to help you focus.
- **Don't:** Avoid installing a ceiling fan below recessed lights as this results in flickering shadows



Air-conditioning

- Multi-split air-conditioning systems are generally more energy efficient than separate single-split or window systems.
- Avoid placing your fan coil unit at the corner of a room as this restricts air circulation.
- Avoid placing lamps, TV sets or other heat generating appliances too close to your air-conditioner as they can interfere with the proper working of its thermostat.
- Keep your air conditioning unit working at its optimal efficiency by servicing the air filters once a month and replacing them when necessary.
- **Tip:** Before switching off your air-conditioner, try turning it to Fan mode for 15 minutes first. This helps to dry your air-conditioner and prevent mildew and unpleasant odour.

What is the recommended cooling power for your space?

Choose the correct size for your air-conditioning unit for maximum energy efficiency.



Room Area
(in sq ft)

x 65 =



BTU /hr

Dining Room

The lines between living, dining and kitchen areas have been blurred as homeowners opt for a more open layout these days. This maximises each space by making it perform different functions depending on the time and occasion.



1.2m
Rectangular



1.5m
Rectangular



0.85m
Round



1.8m
Rectangular



1.2m
Round



1.5m
Round

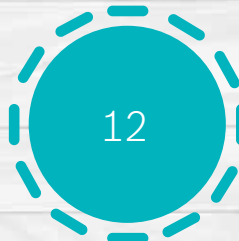

1.8m
Round

Tips for Dining Room

- The dining table can be a homework area for kids, a work desk at night or the centre of a party.
- If you intend to use your dining table as a “hot desk” for work, install an easily accessible electrical outlet nearby.
- Extendable dining tables save space and can easily accommodate more when needed.





Bedroom

A well-designed bedroom affords you a good night's sleep to be ready for the next day.



Creating A Comfortable Bedroom

- Pastel or neutral colours in the bedroom can help put your mind in a relaxed state before you sleep.
- We get the best sleep when it is cool, dark and quiet. To darken your bedroom, heavy fabric curtains or blackout roller blinds can both work to minimise light seepage.
- Avoid using overly stimulating colours (such as purple or gold) for your bedroom walls.



Mattress

- An average person spends a third of his or her life in bed. Buy the best quality mattress you can afford.



Storage

- Where space permits, converting part or all of an adjoining bedroom into an open concept walk-in wardrobe can meet a lot of storage needs.
- Another option is to install a closed bedroom wardrobe. Before drawing up your plans, analyse what you intend to keep there. Are there more full-length clothing (such as dresses and suits) or are there more shirts and short pieces of clothing? For example, installing 2 sets of hanging rods can double your storage space.
- Keep things where you use them. This creates efficiency and prevents things from getting misplaced in the home. This simple principle for storage extends throughout your home.
- Maximize use of space by incorporating storage spaces within your bedframe.

Bathroom

Your bathroom space should be a place where you can unwind and get instantly revitalised. Plan enough surface space for basic necessities and sufficient storage to keep your toiletries and supplies handy.



Rain Showers

Rain showers are increasingly popular among homeowners. This type of showerhead mimics rainfall to gives you a soothing and invigorating experience after a tiring day. But before you jump in, take note of these important considerations:

- Is your water pressure strong enough?
- Decide the size you need – a larger size offers you a wider coverage
- Types of water spray settings offered (some models let you choose from a light trickling drizzle to a heavy storm, and anywhere in between)
- Material – usually made from brass, chrome, stainless steel and plastic (plastic is the cheapest but also the least durable)

Rain shower information provided by **Hoe Kee Hardware Pte Ltd**.



Setting	Effect
Pulsating Rain	For a relaxing spa treatment
Rain-Drenching	For a strong, high pressure shower
Water Droplets	For a light, trickling shower
Randomised	For a realistic rain storm by alternating between the various settings

	Gas Heater (Citygas)	Storage Heater	Instant Heater
What	Piped gas is burned in the gas heater to supply hot water to multiple water points	Uses electricity to heat water in a tank	Electromagnetic induction
Pros	Gas heating is cheaper than electricity	Strongest water pressure and well suited for rain shower	No waiting time required for water heating

Best for	Families requiring hot water in multiple water points in the home	Big families	Small families
----------	---	--------------	----------------

Service Yard

For most families, this would be the natural place to tackle all the laundry needs for the household. In addition to your washer and dryer, plan sufficient shelving units to store your detergents, cleaner, rags and other cleaning supplies.

What is the ideal size for your washer?

2-3 person
≥7kg

3-4 person
≥8kg

4-6 person
≤9kg

Keeping Your Options Open

Select a washing machine with wash programmes that fit your needs - like Bosch washers equipped with Variop Perfect™ that give you options to save time and cost.



Do you have limited space to hang your clothes?

A front-loading washer and dryer can be stacked to minimise space wastage in your home. You can also conveniently dry your clothes anytime of the day, rain or shine.



Do you do your washing at night?

To minimise disturbances when washing and drying at night, Bosch EcoSilence™ system deliver ultra quiet operation without compromising on performance and efficiency.



Should you choose a front load washer?

Homeowners concerned about fabric care and household costs should consider a front-loading washer as they are more gentle on clothes and have excellent energy and water efficiency.



Choosing A Dryer

More households these days are opting for dryers as they can save a massive amount of time from manually hang-drying the clothes – especially for large households with children. No more messing with clothes pegs or having rain impact your drying process.



Maintenance Tips:

- Clean the fluff filter regularly to keep your dryer working at its top efficiency
- For Condenser dryers, always empty the water tank and clean the condensate filter for consistent performance



	Heat pump dryers	Condenser dryers	Vented dryers
Air Vent	No need	No need	✓
Energy Efficient	✓✓✓	✓✓	✓
Cost	\$\$\$	\$\$	\$
Consider	Typically use less than half the energy per load compared to a non heat pump dryer.	Your laundry area will be cooler as the dryer uses an internal heat exchanger to cool the air and condense the water vapour into either a drain pipe or a collection tank	These dryers simply expel warm moist air through a vent or a hose

Kitchen Planning

One of the guiding principles behind good kitchen design is balance. A well-designed kitchen has a good mix of storage and worktop spaces. Its layout allows cooking, washing and food preparation to take place smoothly with minimal fuss.



First, ask yourself these questions:

1

What type of cooking will you do?

- Find the type of hob that works best for you (page 23)
- Find the type of oven that works best for you (page 26)
- Should you install a dishwasher (page 30)

2

What kind of food are you going to store?

- Find the ideal configuration for your fridge (page 29)

3

Do you prefer an open layout or a closed kitchen?

- Determine the air extraction power needed for your hood to work effectively (page 21)



Common Kitchen Layouts

The *work triangle* is an ergonomic zone connecting your wash area (kitchen sink), food storage (fridge) and cooking area (cook top and oven). Once you've outlined your work triangle and decided on your appliances, here are some useful kitchen layouts that you may consider.

Kitchen Type	Description	Layout
Single-wall kitchen (suitable for small homes)	The single-wall kitchen can effectively keep all appliances and cooking essentials within reach. While the work triangle is not evident here, its principle of keeping an ideal distance between different work zones remains.	
Galley kitchen (suitable for most kitchens)	The galley layout is a favourite among chefs. It makes good use of tight spaces and provides flexibility for accessing kitchen appliances and storage.	
L-shaped kitchen (suitable for larger flats with an open layout)	This layout extends itself for guests to mingle in the cooking area. An island can also be incorporated to provide additional worktop or seating space. This open layout will benefit from a powerful extraction hood to keep odours and oil out of your other living areas.	

Kitchen Talk

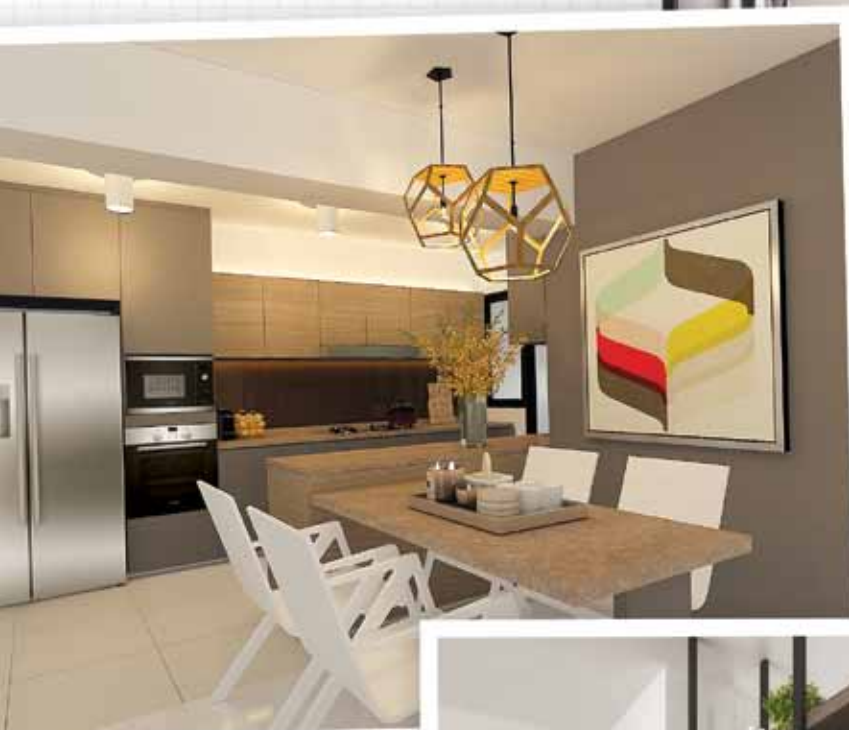

Quick tips on kitchen design
from Lee Chi Ho, Design
Principal, The Orange Cube

Removing an existing wall
opens up the kitchen. A
custom made dining table
marries the kitchen with
the dining area to become
a cohesive space.

After removing the entire
kitchen wall between the
kitchen and dining area,
ceiling-hung cabinets and
open shelves are added to
create storage as well as
creating a dialogue between
the two spaces.



Kitchen cabinets need not be only about storage, they can be treated as display units as well as a library for cook books

Black and white mosaic floor tiles and the use of 'butcher's tiles', transforms the look of the kitchen into a English Country feel.



“New BTO kitchens tend to be small and compact. However, restrictions often offer opportunities for creative solutions.”

Lee Chi Ho

Design Principal,
The Orange Cube





Slimline Hood (60 or 90 cm)

Thin and flat in design with a slide out section, this is ideal for integrating into your kitchen cabinets and will be almost invisible.



Chimney Hood (60 or 90 cm)

Wall-mounted hoods are generally mounted above the hob, on the wall between the wall units. This type of cooker hood fits beautifully into the line of your kitchen units whilst providing effective ventilation that you'll barely see – but you'll notice the amazing effect.

Help with Hoods

Cooker hoods remove excess smoke, steam, grease and fumes while you cook, thereby making sure that your kitchen and the rest of your home smell clean and fresh.



Quick Tip

90cm hoods are the most common size for households.

About Air Recirculation

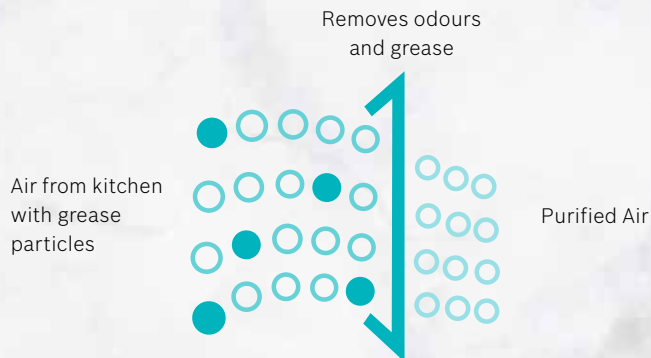

Catering for HDB homes, Bosch extractor hoods feature a powerful, energy-efficient air recirculation mode that reduces grease particles from dispersing and settling on everything in your flat.



The Right Hood

Match your hood with your kitchen to keep your flat smelling clean and fresh. The right hood replaces air in your kitchen ideally 10 times an hour.

What extraction rate do I need from my hood?

$$\begin{array}{c} \text{↕} \\ \text{↕} \\ \text{↕} \end{array} \times 10 = \begin{array}{c} \text{Hood Icon} \\ \text{Minimum} \\ \text{Extraction} \\ \text{Rate Required*} \end{array}$$

Volume of Your Kitchen (m³)

For open layout kitchens, identify the location of your hood and estimate your kitchen volume in the following manner:

When choosing a hood, always match its air delivery power to the size of your kitchen. An effective extractor should be able to replace the air in your kitchen 10 times an hour.

CLOSED CONCEPT

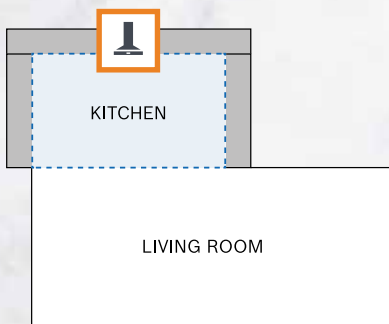

SIZE OF "KITCHEN"

OPEN CONCEPT

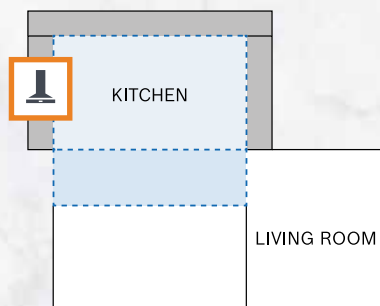

SIZE OF "KITCHEN" + EXTENSION OF KITCHEN $\frac{1}{3}$

OPEN CONCEPT

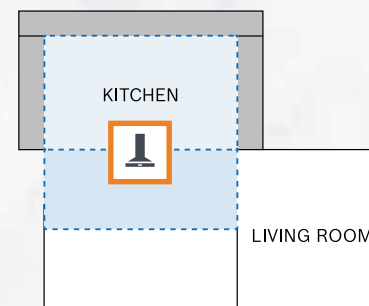

SIZE OF "KITCHEN" + EXTENSION OF KITCHEN $\frac{1}{2}$

*This formula gives a guiding value to the consumer to calculate the appropriate extraction rate in open-plan kitchens. Always ensure adequate fresh air in the room if the appliance is being operated in exhaust air mode at the same time as room air-dependent heat-producing appliance is being operated.



Installing Tips

- Install your hood in a dry place away from direct sunlight
- Mount your hood over the centre of your hob
- Keep a minimum distance of 700mm from gas hob to your hood and 650mm from induction hob to your hood



Caring for Your Extractor Hood

- Always cool the cooker hood and switch off its mains power before cleaning or servicing.
- Clean surfaces with a soft, damp cloth and a mild window cleaner. Soften dried dirt with the damp cloth.
- Avoid using dry cloth, abrasive sponge, or cleaning agents containing soda, acid, or any other aggressive substances as they may damage the hood.





Picking Your Hobs

Choose a hob according to your cooking and taste preference.



Looking for more control over the flame for better cooking?

Bosch gas hobs offer precise flame adjustment to independently control the inner and outer flame rings. This lets you easily control your simmering and frying.



Do you own pots and pans of different sizes?

If you do, consider Bosch induction hobs which have an automatic pan recognition that identifies the size of your pan and only heats up the base of the pan instead of the entire zone. This means greater energy efficiency and savings for you.



Know Your Hobs

There are 3 main types of hobs to choose from based on their heating methods:

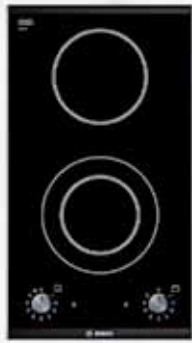

	Gas Hob	Electric Radiant Hobs	Induction Hob
Cooks by	Direct flame	A heating element under ceramic glass	Heat is generated in the cooking vessel directly through induction
Ease of cleaning			
Intelligent features			
Safety features			
Best for	Wok-hei taste/ General cooking	General cooking	Fast cooking with superior control and energy efficiency

	LPG	Town Gas
Source	Gas is stored in a cylinder.	Gas is supplied directly by CityGas.
Consideration	When planning your kitchen cabinetry, allocate a suitable section to store your LPG cylinder in an upright position away from direct heat.	You will need to apply for a utilities account with SP Services and make an appointment for CityGas to turn on your gas line.



Quick Tip

- An induction hob can bring 2 litres of water to boil twice as quickly as electric radiant hob.
- Do check with electrician on how electrical works can be done

What is a good hob size for you?

Hobs varies from 30cm to 92 cm in sizes. Some may opt for two 30cm hobs instead of a single 60cm hob to enjoy the best of both worlds.



Caring for Your Hob

- Always wait for the hob to cool before cleaning.
- Clean the hob's frame using slightly warm soapy water and a soft cloth.



Do You Know?

- Most gas hobs operate at a maximum of 4.5kW while Bosch gas hobs can go up to 6kW. This results in time saving in your cooking.



Quick Tip

The Bosch Domino series (30cm) hobs are designed with this in mind to enjoy a wider range of cooking styles.



Oven Orientation

Getting the right oven depends on your style of cooking and your preference in the taste and texture of your food.



Prefer not to mess with temperature settings when it comes to roasting?

Advanced ovens today come with innovations to reduce or eliminate fiddling with settings while delivering great results. Bosch ovens equipped with PerfectRoast feature precise sensors that measure and control cooking temperatures.



Wish to take out the guesswork when baking?

Baking perfect bread and pastries typically involves careful setting of heating modes, temperatures and baking times. Baking enthusiasts can consider a Bosch oven with PerfectBake sensors that measure and regulate the baking process automatically.



Dislike the hassle of changing oven tray positions when baking?

If you do, you will be delighted by the 4D Hotair technology built into Bosch ovens. You can bake up to 4 different levels simultaneously to achieve the same consistency and result from top to bottom without ever having to change oven tray positions.

What Kind of Chef Are You?



Dry Chef

Definition of different cooking types

Relatively quick process; adds crispness and flavor, but doesn't tenderise.

Moist Chef

Involves cooking with water or stock, like poaching fish and steaming broccoli.

Combi Chef

Often uses slow-cooking techniques to tenderise and break down tough cuts of meat.

Style of Cooking

Grilling, Roasting, Baking

Steaming, Boiling, Simmering

Stewing, Braising

Best for

Meat lovers who enjoy browning while avoiding excess fat

The health conscious and nutrient-lovers

Meat lovers who prefer more bite and strong flavour

Suitable Ovens

Oven
Microwave Oven

Steam Oven

Steam-Combination Oven
Microwave Combination Oven



Caring for Your Oven

- Clean oven exterior using warm soapy water and a dish cloth. Dry with a soft cloth.
- Do not leave the oven door slightly open when cooling, as this may impair the functionality of the control panel.
- Always wait for the oven to cool before cleaning.

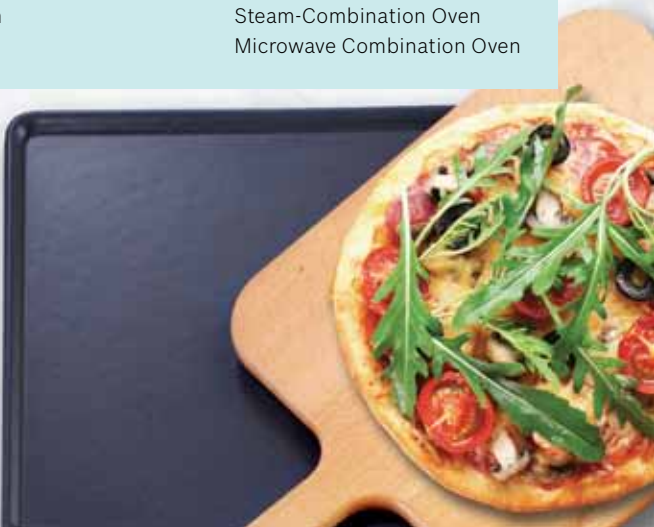

Most Common Ways to Install Your Ovens

When considering where to place your oven, there are several options available:

Tall Boy Cabinet

A popular choice among homeowners, stacking your appliances optimises space and allows you to place the oven at eye level for easy monitoring and accessibility.



- 45cm Oven
- 14cm Warmer Drawer
- 60cm Oven

- 45cm Oven
- 60cm Oven

Built Under

Placing the oven below your tabletop is the ideal option when there is limited cabinet space.



Side by Side

This arrangement allows you to install ovens along with other appliances and operate them easily at the same time.



- 45cm oven with 14cm warmer drawer
- 45cm coffee machine with 14cm warmer drawer
- 60cm Oven



Quick Tip

For easy access to the oven, it is best to install above your waist level for single oven.



Installation Tip

Ensure to get electrician to advise on how electrical works should be done.



The Right Fridge

Consider your family needs to determine the kind of fridge that works best for the food you store. Here are some considerations when selecting a fridge.

Which configuration do you prefer?



Top Freezer

When you use freezer more often



Bottom Freezer

When usage of the main refrigerator compartment is more commonly used. Can access easily



Side by Side

Bigger capacity for both freezer and refrigerator compartment. Suitable for homeowners who seldom does marketing

The Right Way to Store Your Food

Ice Cube

Fish and Raw Meats

Store fish, and raw meats on the freezer, where it's cooler.

Frozen Food

Ice Cream

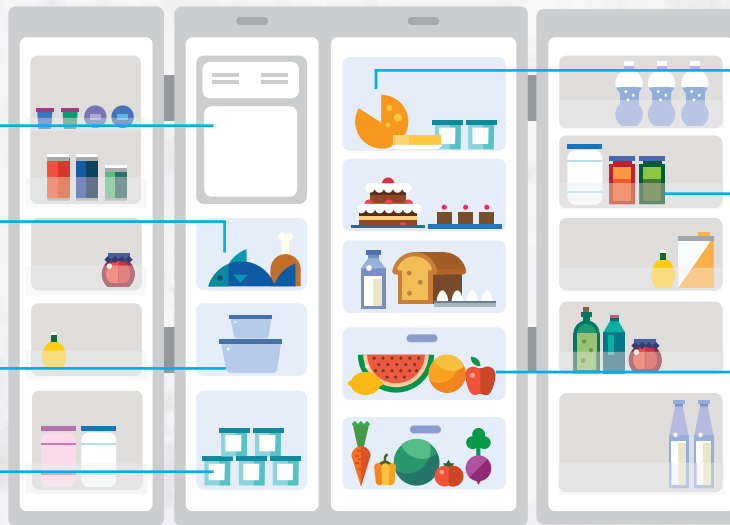

Yogurt, Butter, Cheeses

Condiments, Juice, and Water

The door is the warmest part of the fridge. Keep condiments, juice, and water here.

Fruits and Veggies

Keep fruits and veggies in the drawers, where humidity is the lowest. Be sure to keep them separated as fruits release gases which can accelerate vegetable spoilage.

Dishwasher Facts

In your new kitchen, a dishwasher can be an indispensable help that saves you time and effort. Modern dishwashers are not only efficient and eco-friendly, research has shown that they are much more capable at eliminating harmful germs when compared to washing by hand.

Which dishwasher is most suitable for you?

2 to 3 Person Household
Compact
Table Top
Dishwasher

3 to 4 Person Household
45cm
Dishwasher

4 to 5 Person Household
60cm
Dishwasher



Time savings	Hygiene	Youthful hands
Up to 15 days a year can be spent on hand washing in a typical household.	Unlike hand washing, a dishwasher is able to wash your dishes with water heated up to 70 degrees Celsius.	Contact with detergents may irritate and harm your skin.
A dishwasher saves you time and energy so you can have more quality moments with your family.	This effectively eliminates 99% of harmful bacteria and germs, resulting in better hygiene and health for your family.	A dishwasher minimises contact between your hands and detergents to keep them feeling smooth and supple.

Choosing the Right Dishwasher

There are 3 main types of dishwashers to choose from: Compact, Integrated, and Free Standing.

With the freedom of designing a new kitchen from scratch, the clear choice is the built-in dishwasher, which can be fully integrated into your kitchen design scheme.



Caring for Your Dishwasher

- Use the correct cycle for best performance.
- Check and clean the filters regularly.
- Use dishwasher related detergent for efficient cleaning .



Your New Home Awaits!

Congratulations on coming to the end of your renovation journey. We hope that the process has been smooth and enjoyable as you see your dream home become a reality.

We are glad to have been a part of it and wish you the very best as you embark on your new adventure of moving in and starting life in your new home.

We've a whole range of home appliances to keep your new home in tip-top shape at **www.bosch-home.com.sg**





Things to check together with your ID before moving in



Flooring and wall tiles

Check for defects, cracks, misalignment, etc.



Wall painting

Check that there are no spots missed out or patchy areas; check that walls and ceilings around fixtures have no cracks or gaps.



Windows

Check that all windows open smoothly and shut with a proper seal.



Electricals

Check that all electrical points are working, lights are properly installed, appliances are working correctly and air-conditioning is working.



Plumbing

Check for any water leakage; check that water heaters, water faucets and showerheads are installed and working properly.



Carpentry

Check that laminates are properly applied; check for dents, chips, scratches, ensure doors and drawers operate smoothly.

Week	Sun	Mon	Tue	Wed	Thu	Fri	Sat	Activity
1								Shortlist Appliances
2								
3								
4								
5								Engage ID
6								
7								
8								
9								
10								
11								
12								
13								Collect Keys
14								Renovation
15								
16								
17								
18								
19								
20								
21								
22								
23								
24								



Lingo Dictionary

Air extraction rate: Used to measure the rate of airflow in m³ per hour (a good extractor hood should have an air extraction power to move 6 to 12 times the volume of air in the kitchen in an hour)

Ampere (A): The rate of flow of electricity through electric wires (in Singapore, the typical 3-pin plug used for general electrical appliances is 13A. Air-conditioners use a rounded 15A 3-pin plug)

BTU: Stands for British Thermal Unit to measure the cooling power of air-conditioner units

Built-in appliance: An appliance that needs to be fitted within a casing before installation onto the cabinetry

Built-under appliance: An appliance that does not go into a casing and is mounted directly unto the cabinetry

Cabinetry: Another term for carpentry

Carcass: The structural frame of a cabinet used to organize and position each compartment

Casement window: A window that swings outwards sideways

Cement screed: Flooring or wall finishing constructed using cement (from June 2015 onwards, only pre-packed cement can be used for HDB renovation. It is slightly pricier but will result in more uniform finishes and a cleaner environment)

Cabinetry: The structural frame of a cabinet used to organise and position each compartment

Cornice: Decorative feature installed at the upper part of the wall and ceiling

Cove Light: Indirect lighting that can be built into ledges or recesses in the ceiling or wall that hides lighting fixtures for a very clean look.

Fuse: Protects electrical appliances against damage due to overloading or power surges

Grouting: The process of filling gaps left after the construction process with a mixture of cement and other chemicals

Haulage: The commercial transport of construction materials

Chemical Cement: Adhesive used for overlaying tiles

Laminated Flooring: A synthetic flooring product that is economical, durable and easy to maintain

Louver: An opening with horizontal panes to allow air passage while guarding against rain and sunlight

Masonry: Wall, floor or ceiling constructed using a cement-based material

Pelmet: A drop-down element to cover curtain tracks or sliding door tracks

Rough-in: The distance between the centre of the WC floor opening and the wall. This is important if the owner wishes to change the toilet.

Skirtings: Narrow boards around the margin of a floor

Trap: A bend in a water pipe to hold water so that gases will not get into the home (comes in 2 main types: P-trap and S-trap)

Top hung window: A window that swings outwards on its horizontal top edge

Vinyl Flooring: A popular new type of resilient flooring made from the artificial composite vinyl that has superior moisture-resistance

Veneer: A very thin slice of wood glued onto a core material to form panels that look like wood for cabinetry

Experience Bosch Home Appliances with
an exclusive guided tour – visit us at:

BSH Home Appliances Pte. Ltd. (Reg. No: 199608497E)

11 Bishan Street 21 Bosch Building #04-01

Singapore 573943

Mainline: (65) 6356 1080

Fax: (65) 6507 3818

Visit our official Bosch webpage:

www.bosch-home.com.sg



Follow us on
Instagram

| **[boschhomesg](https://www.instagram.com/boschhomesg)**



Like us on
Facebook

| **[www.facebook.com/
BoschHomeSG](https://www.facebook.com/BoschHomeSG)**

All images are for illustration purposes only.

Whilst every care has been taken in the preparation of this publication, Bosch does not warrant the accuracy or completeness of the information in this publication and Bosch reserves the right to alter specifications without notice. To the extent permitted by law, Bosch excludes all liability, including negligence, for any loss incurred in reliance on the contents of this publication.
©Copyright 2016 by BSH Home Appliances Pte Ltd. Company registration number: 199608497E. Printed in Singapore.