

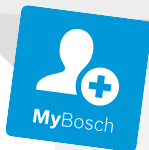

BOSCH



Register your
new appliance
now at MyBosch and
enjoy benefits free of
charge:
[bosch-home.com/
welcome](https://bosch-home.com/welcome)

Tumble dryer

WRB247C9GB

[en] User manual and installation instructions



**You can find additional information and explanations online.
Scan the QR code on the title page.**



Table of contents

1 Safety	3	8.3 Other programmes	21
1.1 Definition of the signal words	3	9 Accessories	22
1.2 General information	4	10 Laundry	22
1.3 Intended use	4	10.1 Preparing the laundry	22
1.4 Restriction on user group	4	10.2 Care symbols on the care labels	22
1.5 Safe installation	5	11 Basic operation	23
1.6 Safe use	7	11.1 Switching on the appliance ..	23
1.7 Safe cleaning and maintenance	9	11.2 Setting a programme	23
2 Preventing material damage	10	11.3 Saving the programme settings	23
3 Environmental protection and saving energy	11	11.4 Opening the door	23
3.1 Disposing of packaging	11	11.5 Loading laundry	24
3.2 Saving energy	11	11.6 Starting the programme	24
3.3 Energy saving mode	11	11.7 Adding laundry	24
4 Installation and connection	11	11.8 Cancelling the programme ...	24
4.1 Unpacking the appliance	11	11.9 Unloading the laundry	24
4.2 Contents of package	11	11.10 Put the appliance into standby mode	24
4.3 Requirements for the installation location	12	11.11 Fluff filter	24
4.4 Water outlet hose	12	11.12 Condensation container	26
4.5 Aligning the appliance	13	12 Dryness level	27
4.6 Reversing the door	14	12.1 Changing the dryness level ..	27
4.7 Connecting the appliance to the electricity supply	14	12.2 Adjusting the dryness level ...	27
5 Familiarising yourself with your appliance	15	13 Childproof lock	27
5.1 Appliance	15	13.1 Activating the childproof lock	27
5.2 Control panel	16	13.2 Deactivating the childproof lock	27
5.3 Operating logic	16	14 Crease-removal function	28
6 Display	16	14.1 Starting a programme with the crease-removal function	28
7 Buttons	18	14.2 Filling the water tank	28
8 Programmes	19	15 Home Connect	29
8.1 Automatic programmes	20	15.1 Setting up Home Connect	29
8.2 Timed programmes	21		

15.2 Deactivating Wi-Fi on the appliance	29	17.3 Running the intensive appliance care programme	33
15.3 Activating Wi-Fi on the appliance	30	18 Cleaning and servicing	34
15.4 Installing the software update	30	18.1 Moisture sensor	34
15.5 Resetting the appliance network settings	30	18.2 Door grille	34
15.6 Remote start	30	19 Troubleshooting	34
15.7 Intelligent programme recommendation	30	20 Transportation, storage and disposal	38
15.8 Remote diagnostics	31	20.1 Emptying the base unit	38
15.9 Data protection	31	20.2 Disposing of old appliance ...	38
16 Basic settings	31	21 Customer Service	39
16.1 Overview of the basic settings	31	21.1 Product number (E-Nr.), production number (FD) and consecutive numbering (Z-Nr.)	39
16.2 Changing the basic settings	32	22 Consumption values	39
17 Appliance care	32	23 Technical data	41
17.1 Preparing for appliance care	32	23.1 Information regarding Free and Open Source Software ..	42
17.2 Running the basic appliance care programme	33	24 Declaration of Conformity	43
		24.1 Statement of Compliance for Great Britain	43

1 Safety

Observe the following safety instructions.

1.1 Definition of the signal words

This is where you can find explanations for the safety signal words used in this manual.

WARNING

This indicates that death or serious injuries may occur as a result of non-observance of this warning.

CAUTION

This indicates that minor or moderate injuries may occur as a result of non-observance of this warning.

ATTENTION

This indicates that damage to the appliance or other material damage may occur as a result of non-compliance with this warning.

Note: This alerts you to important information.

1.2 General information



- Read this instruction manual carefully.
- Keep the instruction manual and the product information safe for future reference or for the next owner.
- Do not connect the appliance if it has been damaged in transit.

1.3 Intended use

Only use this appliance:

- for drying and freshening up fabrics that are washed with water and suitable for dryers.
- in closed rooms in the home and with similar applications, e.g.: in canteens in shops, offices and other work environments; in agricultural businesses; use by customers in hotels, motels and other typical home environments; in bed and breakfasts.
- Up to an altitude of 4000 m above sea level.

1.4 Restriction on user group

This appliance may be used by children aged 8 or over and by people who have reduced physical, sensory or mental abilities or inadequate experience and/or knowledge, provided that they are supervised or have been instructed on how to use the appliance safely and have understood the resulting dangers.

Do not let children play with the appliance.

Cleaning and user maintenance must not be performed by children unless they are being supervised.

Keep children under the age of 3 years and pets away from the appliance.

1.5 Safe installation

⚠ WARNING – Risk of electric shock!

Incorrect installation is dangerous.

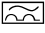
- ▶ Connect and operate the appliance only in accordance with the specifications on the rating plate.
- ▶ Connect the appliance to a power supply with alternating current only via a properly installed socket with earthing.
- ▶ The protective conductor system of the domestic electrical installation must be properly installed. The installation must have a sufficiently large cross section.
- ▶ When using a residual current circuit breaker, only use a type with the  mark.
- ▶ Never equip the appliance with an external switching device, e.g. a timer or remote control.
- ▶ Never connect the appliance to a circuit that is regularly switched on and off by the energy supplier.
- ▶ When the appliance is installed, the mains plug of the power cord must be freely accessible. If free access is not possible, an isolating switch must be integrated into the permanent electrical installation according to the installation regulations.
- ▶ When installing the appliance, check that the power cable is not trapped or damaged.

If the insulation of the power cord is damaged, this is dangerous.

- ▶ Never let the power cord come into contact with hot appliance parts or heat sources.
- ▶ Never let the power cord come into contact with sharp points or edges.
- ▶ Never kink, crush or modify the power cord.

⚠ WARNING – Risk of fire!

It is dangerous to use an extended power cord and non-approved adapters.

- ▶ Do not use extension cables or multiple socket strips.
- ▶ Only use adapters and power cords approved by the manufacturer.
- ▶ If the power cord is too short and a longer one is not available, please contact an electrician to have the domestic installation adapted.

⚠ WARNING – Risk of injury!

The heavy weight of the appliance may result in injury when lifted.

- ▶ Do not lift the appliance on your own.
- If this appliance is not correctly installed in a washer-dryer stack, the installed appliance may fall.
- ▶ Only stack the dryer on a washing machine using the connection kit from the dryer manufacturer. No other installation method is permitted.
 - ▶ Do not install the appliance in a washer-dryer stack if the dryer manufacturer does not offer a suitable connection kit.
 - ▶ Do not install appliances from different manufacturers in a washer-dryer stack. Only install appliances with varying depths and widths in a washer-dryer stack if the connection kit allows this.
 - ▶ Do not install a washer-dryer stack on a platform; the appliances may tip over.

⚠ WARNING – Risk of suffocation!

Children may put packaging material over their heads or wrap themselves up in it and suffocate.

- ▶ Keep packaging material away from children.
- ▶ Do not let children play with packaging material.

⚠ CAUTION – Risk of injury!

The appliance may vibrate or move when in use.

- ▶ Place the appliance on a clean, even, solid surface.
 - ▶ Align the appliance using the appliance feet and a spirit level.
- If hoses and power cords have been laid incorrectly, this causes a tripping hazard.
- ▶ Lay hoses and power cords in such a way that there is no risk of tripping.

If the appliance is moved by holding onto protruding components, such as the appliance door, the parts may break off.

- ▶ Do not move the appliance by holding onto protruding parts.

⚠ CAUTION – Risk of cutting!

Touching sharp edges on the appliance may lead to cuts.

- ▶ Do not touch the sharp edges on the appliance.
- ▶ Wear protective gloves when installing and transporting the appliance.

1.6 Safe use

⚠ WARNING – Risk of electric shock!

If the appliance or the power cord is damaged, this is dangerous.

- ▶ Never operate a damaged appliance.
- ▶ Never pull on the power cord to unplug the appliance. Always unplug the appliance at the mains.
- ▶ If the appliance or the power cord is damaged, immediately unplug the power cord or switch off the fuse in the fuse box.
- ▶ Call customer service. → *Page 39*

An ingress of moisture can cause an electric shock.

- ▶ Only use the appliance in enclosed spaces.
- ▶ Never expose the appliance to intense heat or humidity.
- ▶ Do not use steam- or high-pressure cleaners, hoses or sprays to clean the appliance.

⚠ WARNING – Risk of harm to health!

Children can lock themselves in the appliance, thereby putting their lives at risk.

- ▶ The appliance must not be set up behind a lockable door, a sliding door or a door with a hinge on the side opposite to the appliance, which prevents appliance from opening fully.
- ▶ With redundant appliances, unplug the power cord. Then cut through the cord and damage the lock on the appliance door beyond repair so that the appliance door will no longer close.

⚠ WARNING – Risk of suffocation!

Children may breathe in or swallow small parts, causing them to suffocate.

- ▶ Keep small parts away from children.
- ▶ Do not let children play with small parts.

⚠ WARNING – Risk of explosion!

If there is coal dust or flour in the air around the appliance, this may cause an explosion.

- ▶ Keep the area around the appliance clean during operation.

⚠ WARNING – Risk of poisoning!

Condensation water from this appliance is not suitable for drinking and may be contaminated with fluff.

- ▶ Do not drink or reuse the condensation water from the appliance.

Detergents and care products may result in poisoning if consumed.

- ▶ If accidentally swallowed, seek medical advice.
- ▶ Keep detergents and care products out of the reach of children.

⚠ WARNING – Risk of fire!

The refrigerant R290 in this appliance is environmentally friendly yet combustible and may ignite if it comes into contact with open flames or ignition sources.

- ▶ Keep naked flames and ignition sources away from the appli-



ance.

- ▶ Dispose of the appliance properly.
- ▶ Do not damage the tubing of the refrigerant circuit.

⚠ WARNING – Risk of explosion!

If there is any residual material left in the fluff filter, this may ignite during the drying process.

- ▶ Clean the fluff filter regularly.

Highly flammable objects such as lighters or matches may ignite during the drying process.

- ▶ Remove all highly flammable objects from any pockets in your laundry before the drying process.

Unwashed laundry may ignite during drying.

- ▶ Do not dry laundry in this appliance if the laundry has not been washed first.
- ▶ If laundry has been contaminated with substances such as cooking oil, acetone, alcohol, petrol, kerosene, stain-remover, turpentine, wax and wax-remover, wash it in hot water with an additional quantity of detergent before drying it in the appliance.
- ▶ Rinse the laundry thoroughly with warm water and detergent before drying it in the machine.
- ▶ Do not use the appliance if industrial chemicals have been used to clean the laundry beforehand.

⚠ WARNING – Risk of fire!

If drying is interrupted early, the laundry is not cooled sufficiently and may ignite.

- ▶ Do not interrupt the drying programme early.
- ▶ If drying is interrupted early, remove the laundry immediately and spread it out.

⚠ CAUTION – Risk of injury!

The covering plate may break if you stand on or climb onto the appliance.

- ▶ Do not stand on or climb onto the appliance.

The appliance may tip over if you sit on or lean against the open door.

- ▶ Do not sit on or lean against the appliance door.
- ▶ Do not place any objects on the appliance door.

Reaching into the drum while it is still turning may cause hand injuries.

- ▶ Wait for the drum to come to a complete stop before reaching inside.

1.7 Safe cleaning and maintenance**⚠ WARNING – Risk of electric shock!**

Improper repairs are dangerous.

- ▶ Never make any technical modifications to the appliance or its features.
- ▶ Repairs to the appliance should only be carried out by trained specialist staff.
- ▶ Only use genuine spare parts when repairing the appliance.
- ▶ If the power cord of this appliance is damaged, it must be replaced by the manufacturer, the manufacturer's Customer Service or a similarly qualified person in order to prevent any risk.

An ingress of moisture can cause an electric shock.

- ▶ Before cleaning, pull out the mains plug or switch off the fuse in the fuse box.
- ▶ Do not use steam- or high-pressure cleaners, hoses or sprays to clean the appliance.

⚠ WARNING – Risk of injury!

The use of non-original spare parts and non-original accessories is dangerous.

- ▶ Only use the manufacturer's original spare parts and original accessories.

⚠ WARNING – Risk of poisoning!

Poisonous fumes may be given off if you use cleaning agents that contain solvents.

- ▶ Do not use cleaning agents that contain solvents.

2 Preventing material damage

ATTENTION

The functionality of the appliance may be impaired if you use the wrong quantity of fabric softener, detergent, care product or cleaning agent.

- ▶ Follow the dosage recommendations from the manufacturer.

Exceeding the maximum load capacity impairs the function of the appliance.

- ▶ Observe the maximum load capacity for each programme and do not exceed it. → *Page 19*

The function of the appliance may be impaired if the appliance overheats.

- ▶ Keep the ventilation opening on the appliance clear during operation.
- ▶ Make sure that the area is adequately ventilated.

Light objects such as hair and fluff may be sucked in from the ventilation opening on the appliance during operation and impair the function of the appliance.

- ▶ Keep the area around the appliance clean during operation.
- ▶ Keep light objects away from the appliance.

If you operate the appliance without a fluff guard (e.g. fluff filter, fluff collector, filter mat, etc., depending on appliance specifications), or if the fluff guard is incomplete or defective, this may result in damage to the appliance.

- ▶ Do not operate the appliance without a fluff guard, or with a fluff guard that is incomplete or defective.

Foam and foam rubber may deform or melt during the drying process.

- ▶ Objects such as foam rubber (latex foam), shower caps, waterproof textiles, rubberised items and clothing or cushions with sponge rubber padding must not be dried in the appliance.

Unsuitable cleaning products may damage the surfaces of the appliance.

- ▶ Do not use harsh or abrasive detergents.
- ▶ Do not use cleaning products with a high alcohol content.
- ▶ Do not use hard scouring pads or cleaning sponges.
- ▶ Clean the appliance with nothing but water and a soft, damp cloth.
- ▶ Remove all detergent residue, spray residue or other residues im-

mediately if they come into contact with the appliance.

3 Environmental protection and saving energy

3.1 Disposing of packaging

The packaging materials are environmentally compatible and can be recycled.

- ▶ Sort the individual components by type and dispose of them separately.

3.2 Saving energy

If you follow these instructions, your appliance will use less power.

- Operate the appliance in a well-ventilated room and keep the ventilation opening on the appliance clear.
- Spin the laundry in the washing machine before drying.
- For each drying process, use the maximum load for the programs. → *Page 19*
- Do not exceed the programme's maximum load capacity. → *Page 19*
- After drying, clean the fluff filter. → *Page 24*
- Deactivate Wi-Fi on the appliance if it is not being used. → *Page 29*

3.3 Energy saving mode

If you do not use the appliance for a brief period, it automatically switches to energy-saving mode. All displays go out and ▶ flashes.

Energy-saving mode ends when you use the appliance again.

If you do not use the appliance for an extended period, it automatically switches to standby mode.

4 Installation and connection

4.1 Unpacking the appliance

ATTENTION

Objects remaining in the drum that are not designed for operation with the appliance may cause material damage and damage to the appliance.

- ▶ Remove these objects, along with all supplied accessories, from the drum before starting the appliance.
1. Remove any packaging and protective covers completely from the appliance.
→ *"Disposing of packaging", Page 11*
 2. Check the appliance for visible damage.
 3. Open the door. → *Page 23*
 4. Remove any accessories from the drum.
 5. Close the door.

4.2 Contents of package

After unpacking all parts, check for any damage in transit and completeness of the delivery.

ATTENTION

If the appliance is operated with incomplete or defective accessories, the appliance may not be able to operate properly, or this may result in material damage or damage to the appliance.

- ▶ Do not operate the appliance with incomplete or defective accessories.
- ▶ Replace the accessories in question before operating the appliance.
→ *"Accessories", Page 22*

en Installation and connection

The delivery consists of the following:

- Tumble dryer
- Accompanying documents
- Water jug → *Page 28*

4.3 Requirements for the installation location

Observe the instructions for the installation location.

ATTENTION

If the appliance is tilted at an angle greater than 40°, residual water may leak out of the appliance and cause material damage.

- ▶ Tilt the appliance carefully.
- ▶ Transport the appliance in an upright position.

If residual water in the appliance freezes, this may cause damage to the appliance.

- ▶ Do not install or operate this appliance anywhere that is liable to experience frost or outdoors.

If the appliance is operated immediately after transportation, the refrigerant contained in the appliance may result in damage to the appliance.

- ▶ Immediately after transporting the appliance, leave it to rest for two hours before putting it into operation.

On the floor

Place the appliance on a clean, level and firm surface.

Align the appliance. → *Page 13*

In a washer-dryer stack

Only use the original connection set from the dryer manufacturer when setting up this appliance in a washer-dryer stack.

- Connection kit with pull-out worktop → *Page 22*

This appliance must only be stacked on a washing machine from the

same manufacturer. The depth and width of this appliance must correspond with the dimensions of the washing machine, unless the connection kit allows for varying dimensions. Do not place the washer-dryer stack on a platform.

Against a wall

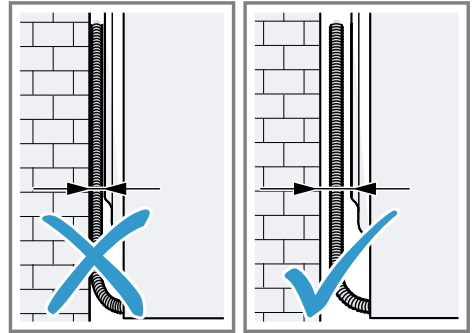

Do not trap the hoses and power cord between the wall and the appliance.

4.4 Water outlet hose

Condensation that forms in the appliance as it dries the laundry is collected by default in the condensation container. Use the water outlet hose to drain away excess condensation directly into the waste water system.

Connecting the water outlet hose

If you do not want to regularly empty the appliance's condensation container, connect the water outlet hose.

ATTENTION

When operating the appliance without the water outlet hose being connected properly, liquid may leak out.

- ▶ Before operating the appliance, ensure that the water outlet hose is properly connected.

Requirements

- The appliance and the accessory have been unpacked. → *Page 11*
 - The appliance is installed at the installation location.
1. Empty the condensation container. → *Page 26*
 2. Insert the condensation container. → *Page 26*
 3. Disconnect the hose clamp on the water outlet hose on the rear of the appliance and pull the water outlet hose out of the condensation container.

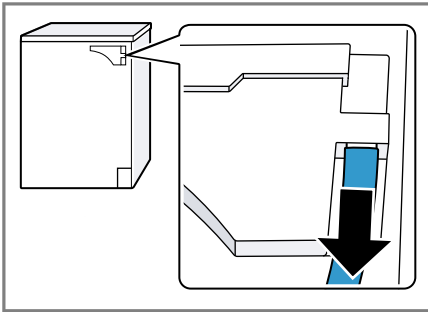

4. Connect the water outlet hose to the water outlet. → *Page 13*

Tip: To collect condensation in the condensation container again (e.g. if you change where the appliance is located), carry out these steps in reverse order.

Water outlet connection types

ATTENTION

In the event of a blocked or covered outlet, accumulated wastewater can flow back into the appliance.

- ▶ Before operating the appliance, ensure that the wastewater drains away quickly and eliminate any blockages.

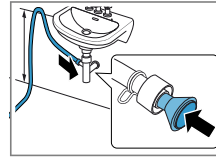

a (12-22 mm) hose clamp. Secure the water outlet hose with a hose guide at a height of at least 80 cm and no more than 100 cm.

Note: You can use the Y-distributor → *Page 22* to connect the water outlet hose of an additional appliance, such as a washing machine, to the same siphon outlet.

Drainage into a wash basin.

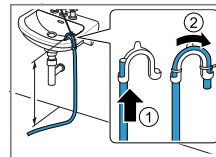

Push the water outlet hose fully through the elbow and secure it using fixing material. Secure the elbow at a height of no more than 100 cm.

Drainage into a gully.

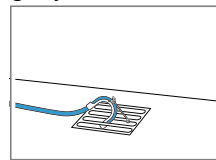

Push the water outlet hose fully through the elbow and secure it using fixing material. Secure the elbow to the gully.

4.5 Aligning the appliance

In order to reduce vibrations and noises, align the appliance correctly.

Drainage into a siphon. Secure the connection point with

en Installation and connection

- ▶ To align the appliance, turn the appliance feet. Check that the appliance is level using a spirit level.

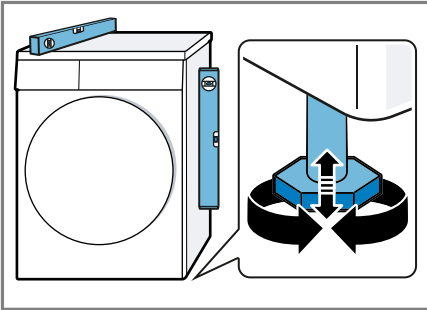

All appliance feet must stand firmly on the ground.

4.6 Reversing the door

Note: You can find more information about changing the door direction online. Scan the QR code on the title page.

4.7 Connecting the appliance to the electricity supply

1. Insert the mains plug of the appliance's power cable in a socket nearby.
The connection details of the appliance can be found under Technical data → *Page 41*.
 2. Check the mains plug is inserted properly.
- ✓ The appliance is now ready for use.

5 Familiarising yourself with your appliance

5.1 Appliance

You can find an overview of the parts of your appliance here.

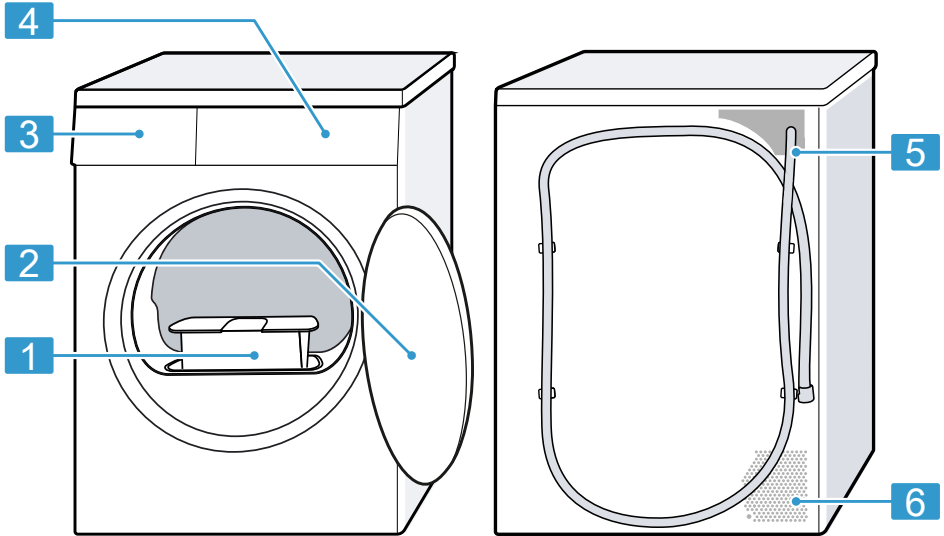

On certain models, specific details such as the colour and shape may differ from those pictured.

1 Fluff filter → *Page 24*

2 Door → *Page 23*

3 Condensation container
→ *Page 26*

4 Control panel → *Page 16*

5 Water outlet hose → *Page 12*

6 Ventilation opening

5.2 Control panel

You can use the control panel to configure all functions of your appliance and to obtain information about the operating status.

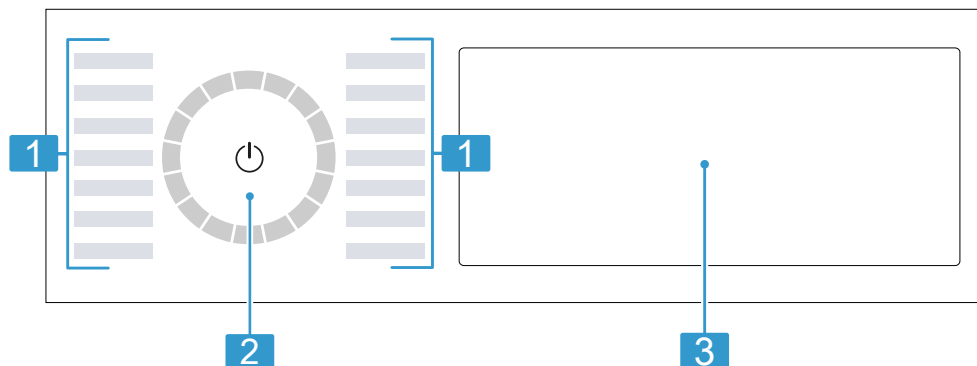

1 Programmes → *Page 19*

2 Programme selector
→ *Page 23*

3 Buttons → *Page 18* and display
→ *Page 16*

5.3 Operating logic

Some areas of the display are buttons and respond to touch. You can activate, deactivate or change settings by pressing the buttons. The activated settings are highlighted brightly on the display.

ATTENTION

Pressing on the display with force may cause damage.

- ▶ Do not apply heavy pressure on the display.
- ▶ Do not press on the display using pointed or sharp objects.

Changing a setting value

If you activate certain settings, the display shows selection buttons and you can change the setting value.

- ▶ Press the selection buttons
→ *Page 18*.
The display shows the setting value.

6 Display



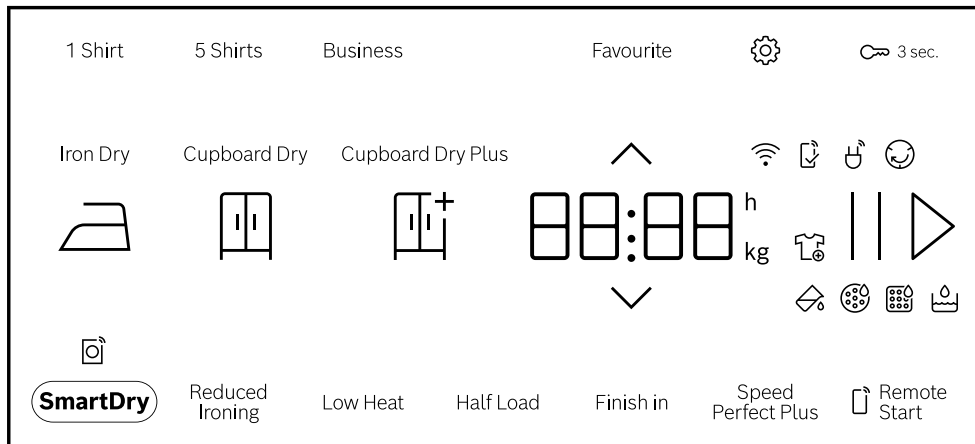

The display shows the current settings, options or relevant information. Depending on the programme status, the display shows some information in the `BB:BB` area, e.g. `E n.d.`

Note: Additional functions may be available as a result of software updates.
→ *Page 30*



If a software update is available, you can find further information in the Home Connect app.



Example: Display

Indicator	Description
0:40 ¹	Expected programme duration or programme time remaining in hours and minutes.
9.0 ¹	Recommendation for the maximum load capacity for the selected program in kg.
10h ¹	Programme end time → <i>Page 19</i>
	You can remove or add laundry, and interrupt the current programme. → <i>Page 24</i>
	Empty and insert the condensation container. → <i>Page 26</i>
	Clean the fluff filter → <i>Page 24</i> .
CArE	Run the basic appliance care programme. → <i>Page 32</i>
	Fill the water tank for the crease-removal function. → <i>Page 28</i>
Hot	The cooling process cools the laundry independently of the programme status for a few minutes while the drum is rotating, in order to avoid damage to the laundry. The cooling process can be cancelled by opening the door. Note: Do not change the set programme.
	<ul style="list-style-type: none"> ■ Lights up: The appliance is connected to your home network via Wi-Fi. ■ Flashes: The appliance is trying to connect to your home network via Wi-Fi.

¹ Example











Indicator	Description
	Settings that are not available on the appliance have been set via the Home Connect app. You can find more information in the Home Connect app.
	Programme status: Crease-reduction function
	Programme status: Pause
End	Programme status: Programme end





7 Buttons

Note: Additional functions may be available as a result of software updates.

→ *Page 30*

If a software update is available, you can find further information in the Home Connect app.

Button	Description
	Start, cancel or pause the programme. If is displayed, you can pause the programme. If ▷ is displayed, you can start the programme.
	Switch on the appliance or put it in standby mode. If the control panel does not respond, press and hold  for approximately 5 seconds to restart the appliance. → <i>Page 36</i>
 3 sec.	Activate or deactivate the childproof lock. → <i>Page 27</i>
	Changing settings. → <i>Page 16</i>
	Call up the basic settings. → <i>Page 31</i>
Favourite	Press the button for approx. 3 seconds to save your customised programme settings. → <i>Page 23</i> If you briefly press the button, you set your saved programme with individual programme settings.
Cupboard Dry Plus 	Change the dryness level. → <i>Page 27</i>
Cupboard Dry 	Change the dryness level. → <i>Page 27</i>
Iron Dry 	Change the dryness level. → <i>Page 27</i>
5 Shirts	Adjust the Iron Assist  programme. Observe the programme description. → <i>Page 19</i> Suitable for dry shirts and blouses that have not been worn for long or at all. Suitable for 2 to 5 items of laundry.

Button	Description
Business	Adjust the Iron Assist  programme. Observe the programme description. → <i>Page 19</i> Suitable for dry suits or skirts that have not been worn for long or at all and that are labelled "Dry clean only". Suitable for one suit or two items of laundry.
1 Shirt	Adjust the Iron Assist  programme. Observe the programme description. → <i>Page 19</i> Suitable for dry shirts and blouses that have not been worn for long or at all. Suitable for one item of laundry.
Reduced Ironing	Activate or deactivate the crease-reduction function. Once the programme has ended, the drum moves the laundry at regular intervals for 120 minutes to prevent creasing.
Speed Perfect Plus	Activate or deactivate a shorter programme duration. Note: Energy consumption and noise emissions increase. This does not impair the drying result.
Low Heat	Activate or deactivate gentle drying. The temperature is reduced for delicate fabrics, e.g. polyacrylic or elastane. The programme duration is extended.
Finish in	Set the programme end time. The programme duration is already included in the set number of hours. Once the programme has started, the programme duration is displayed.
Half Load	Dry individual items of laundry or small loads of laundry.
 SmartDry	Activate or deactivate intelligent programme recommendation. → <i>Page 30</i>
 Remote Start	If you press the button briefly, you can activate or deactivate remote start. → <i>Page 30</i> If you press and hold the button for approx. 3 seconds, the Home Connect settings open. → <i>Page 29</i>

8 Programmes

You can dry your fabrics using either an automatic programme or a timed programme.

Notes

- The laundry's care labels provide you with additional information about programme selection.
→ *"Care symbols on the care labels", Page 22*
- Additional functions may be available as a result of software updates. → *Page 30*

If a software update is available, you can find further information in the Home Connect app.

8.1 Automatic programmes

Automatic programmes are programmes in which humidity sensors measure the residual moisture in the laundry during the drying cycle. The programme only ends once the set dryness level is reached.

Each automatic programme has a dryness level → *Page 27*. The dryness level defines how dry or damp the laundry is after the programme ends.

Tip: Select the dryness level according to the type of fabric or the desired drying result.

Programme	Description	Max. load (kg)
Cottons	Dry hard-wearing, heat-resistant fabrics made of cotton or linen.	9.0
Eco	Dry hard-wearing, heat-resistant fabrics made of cotton or linen. Energy-saving programme.	9.0
Easy Care	Dry items made of synthetic materials or blended fabrics.	3.5
Mixed Load	Dry items made of cotton and synthetics.	3.0
Bed linen	Dry duvet covers, pillowcases and sheets made of cotton. Note: The drum movement is optimised for drying large items of laundry.	3.5
Delicates	Dry delicate items made of satin, synthetics or blended fabrics.	2.0
Hygiene Plus	Dry hard-wearing, heat-resistant fabrics made of cotton or linen. Suitable for increased hygiene requirements.	4.0
Shirts	Suitable for shirts and blouses made of cotton, linen, synthetics or blended fabrics. Note: For optimal drying results, dry a maximum of 5 shirts or 5 blouses at the same time. Once the laundry is dry, iron it or hang it up. The residual moisture is then distributed evenly.	1.5

Programme	Description	Max. load (kg)
Towels	Dry hard-wearing, heat-resistant towels and dressing gowns made of cotton or linen.	6.0
Silent Dry	Dry hard-wearing, heat-resistant fabrics made of cotton or linen. Suitable for quiet drying.	9.0
Iron Assist 	Reduce creasing and airborne odours. → <i>Page 28</i> To adjust the programme with crease-removal function, press the corresponding button. → <i>Page 18</i> Notes <ul style="list-style-type: none"> ▪ To prevent creasing, remove the laundry after the programme ends. ▪ The laundry is not cleaned. 	-

8.2 Timed programmes

Timed programmes are programmes with a defined or adjustable programme duration. The programme ends once this time has elapsed, even if the laundry is still not dry, for example. Timed programmes are suitable for drying individual items of laundry or thin fabrics.

Programme	Description	Max. load (kg)
Wool	Dry machine-washable or hand-washable items made of wool. Note: Remove the items immediately once the programme has ended.	1.0
Timed Progr. Warm	Dry all types of fabric except for wool and silk. Suitable for pre-dried or slightly damp laundry and for drying off multi-layered, thick laundry.	3.0

8.3 Other programmes

Programme	Description
 App	Select additional programmes directly via the Home Connect app. A description of the programmes can be found in the Home Connect app.

Programme	Description
	Note: Your appliance must be connected to your home network and registered in your Home Connect app. → <i>Page 29</i>

9 Accessories

Use original accessories. These have been made especially for your appliance.

Tip: Some accessories are available in other colours. Contact customer service. → *Page 39*

	Use	Order number
Connection kit with pull-out worktop	To save space, stack the appliance on a suitable washing machine from the same manufacturer. The pull-out worktop makes it easier to load and unload the appliance.	WTZ2800
Drying basket	Dry or air sports shoes or soft toys.	WMZ20610
Y-distributor	Connect the water outlet hose of an additional appliance to the same siphon outlet.	15000490
Platform	Install the appliance at a raised height so that it can be easily loaded and unloaded.	WTZPW30D

10 Laundry

10.1 Preparing the laundry

ATTENTION

Objects remaining in the laundry may damage the laundry and the drum.

- ▶ Remove all items from any pockets in your laundry before using the appliance.

Note



The appliance and fabrics are protected when you prepare your laundry.

- Brush off sand and soil
- Sort the laundry according to colour and textiles and observe the care labels
- Close all zips, hook and loop fasteners, hooks and eyes

- Remove curtain fittings and lead strips
- Load the laundry unfolded into the drum
- Spin the laundry before drying

10.2 Care symbols on the care labels

Drying care symbols

Symbol	Fabrics
	Items made from cotton and linen, e.g. towels, bed linen, underwear
	Items made from synthetic, blended or delicate fabrics, e.g. functional garments, shirts

Symbol	Fabrics
☒	Do not tumble dry items made from silk, nylon, air-impermeable and rubber-coated fabrics, synthetic curtains

11 Basic operation

11.1 Switching on the appliance

Note: If you switch the appliance on the first time after you have connected it to the electrical system, the switch-on process takes up to one minute.

Requirement: The appliance has been correctly installed and connected. → *Page 11*

- ▶ Press ϕ .
The switch-on process takes a few seconds.

Note: The lighting for the drum goes out automatically.

11.2 Setting a programme

1. Press the required programme.
→ *Page 19*

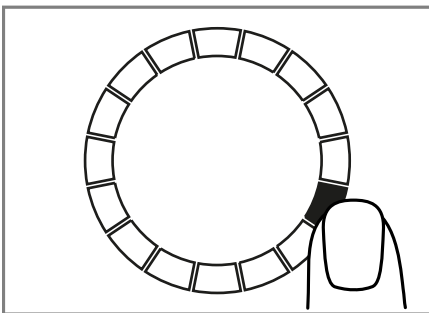

- ✓ The display shows the programme settings.

2. If required, adjust the programme settings. → *Page 18*
Observe the information about operating logic → *Page 16*.
The programme settings are not saved permanently for the programme.

11.3 Saving the programme settings

You can save your individual programme settings as favourites.

Requirement: A programme is set.
→ *Page 23*

- ▶ Press and hold **Favourite** for approx. 3 seconds.
Press **Favourite** to call up the saved programme.

Note: To overwrite the saved programme, repeat the steps above.

11.4 Opening the door

1. Grip under the door handle and pull on the door.

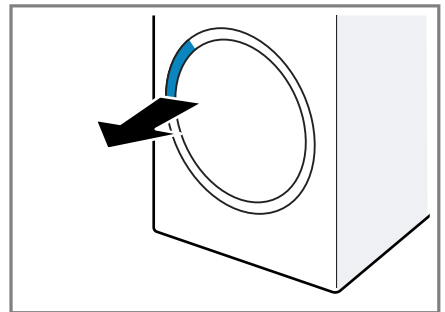

2. Open the door.

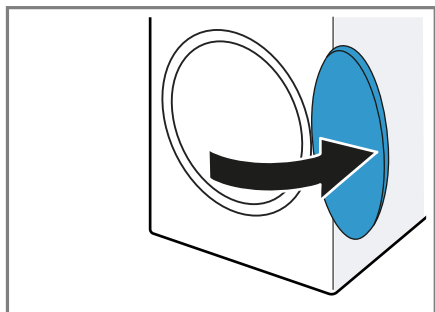

11.5 Loading laundry

Note: To prevent creasing, note the maximum load for the programmes.
→ *Page 19*

Requirements

- The laundry is prepared and sorted. → *Page 22*
 - The drum is empty.
1. Open the door. → *Page 23*
 2. Place the laundry in the drum.
 3. Close the door.
Ensure that there is no laundry trapped in the door.

11.6 Starting the programme

Requirements

- A programme is set. → *Page 23*
- The door is closed.
- ▶ Press **||▷**.
- ✓ The display shows the programme duration or the programme end time.
- ✓ After the programme has ended, the display shows: "End".

Note: When "Hot" is shown on the display, the appliance cools the laundry.
When "Hot" goes out, the laundry has cooled down.

11.7 Adding laundry

After the programme starts, you can remove or add laundry at any time.

1. Press **||▷**.
The cooling process starts automatically after approximately 30 seconds and cools down the laundry while the drum is rotating. If you want to avoid or cancel the cooling process, open the door.
→ *Page 17*
2. Open the door. → *Page 23*
3. Add or remove laundry.
4. Close the door.
5. Start the programme. → *Page 24*

11.8 Cancelling the programme

1. Press **||▷**.
2. Open the door. → *Page 23*
3. Remove the laundry. → *Page 24*

11.9 Unloading the laundry

1. Open the door. → *Page 23*
2. Remove the laundry from the drum.

11.10 Put the appliance into standby mode

- ▶ Press **⏻**.

11.11 Fluff filter

During drying, fluff from the laundry is collected in the fluff filter. The fluff filter protects the appliance from fluff.

Cleaning the fluff filter

If the drying programme has finished or the display shows a notification while the appliance is in operation, clean the fluff filter after the programme end.

Note: If you do not clean the appliance as described, the appliance's functionality may be impaired.

Requirements

- The display shows the following after drying: "End"
- or the display shows the following during operation: 

1. Open the door. → *Page 23*
2. Remove the two-part fluff filter.

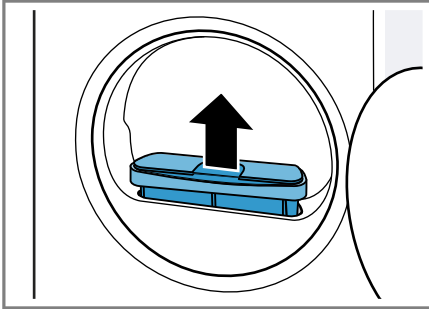

3. Remove the fluff from the recess.

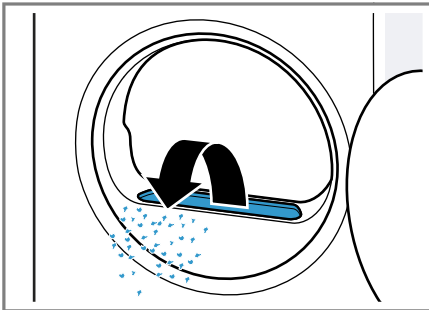

Ensure that no fluff falls into the air channel.

4. Push the centre tab of the fluff filter slightly outwards ① and separate the two-part fluff filter ②.

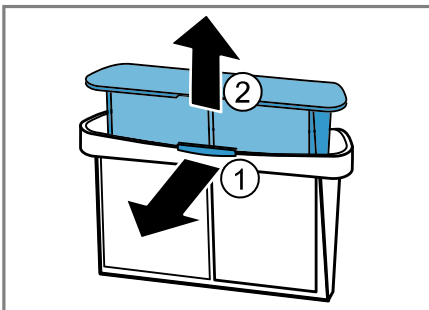

5. Open the two fluff filters ① and remove the fluff ②.

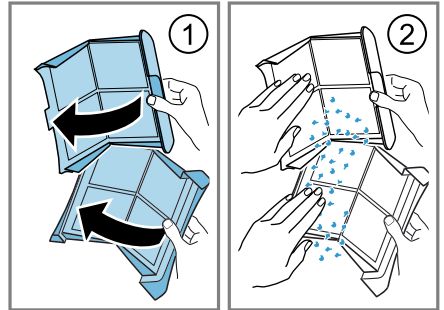

Dispose of the fluff with the household waste in order to prevent the water from being contaminated with microplastics.

6. Clean the two fluff filters thoroughly under warm, running water and then dry them off.

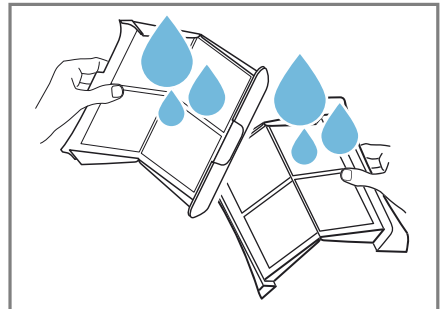

Note: To prevent the waste water from becoming contaminated by microplastics, collect the cleaning water in a container, e.g. a bucket. After cleaning, pour the contents of the container through a filter, e.g. a coffee filter.

Dispose of the coffee filter with your household waste.

en Basic operation

7. Close the two fluff filters and put them together until the tab clicks into place.

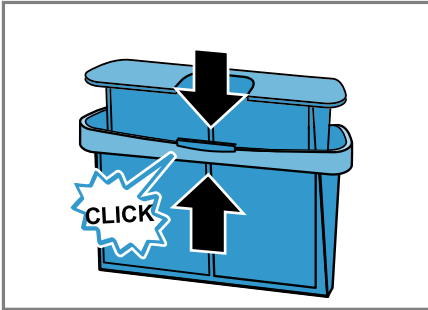

8. Insert the two-part fluff filter.

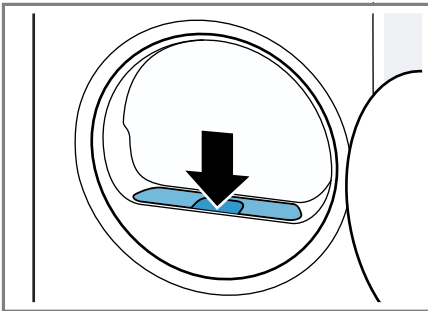

9. Close the door.

11.12 Condensation container

Condensation that forms in the appliance as it dries the laundry is collected by default in the condensation container.

Emptying the condensation container

If the drying programme has finished or the display shows a notification that the drying programme is paused, empty the condensation container.

Requirements

- The display shows the following after drying: "End"
- or the display shows the following while operation is paused: 

1. Pull out the condensation container, keeping it level.

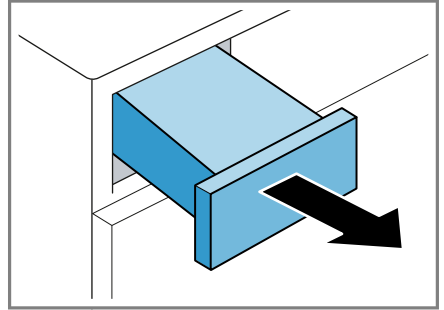

2. Empty the condensation container.

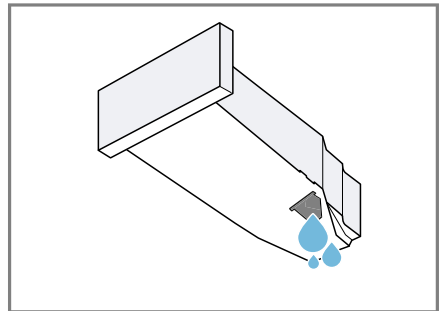

Make sure that you insert the condensation container before operating the appliance. → *Page 26*

3. If the drying programme is paused, start the programme. → *Page 24*

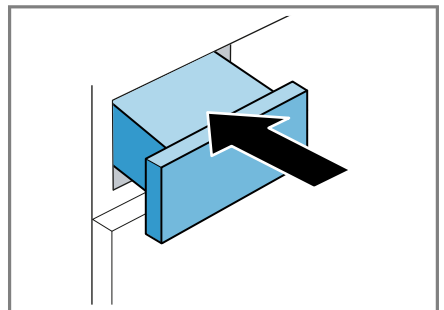

Inserting the condensation container

- ▶ Push the condensation container in as far as it will go.



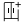

12 Dryness level

Each automatic programme has a specified dryness level. The dryness level defines how dry or damp your laundry is after the programme ends.

Dryness level	Description
	For multi-layered, thick laundry that does not dry readily.
	For normal, single-layered laundry.
	For normal, single-layered laundry. The laundry is still slightly damp after the programme ends. To prevent creasing after drying, iron the laundry or hang it up.

12.1 Changing the dryness level



For some automatic programmes, you can change the dryness level so that your laundry will be drier or more damp.

1. Set an automatic programme.
→ *Page 20*
- ✓ The display shows the specified dryness level.
2. Press **Cupboard Dry** , **Cupboard Dry Plus**  or **Iron Dry** .

12.2 Adjusting the dryness level

If the laundry feels too damp after it has been dried to a particular dryness level, you can adjust the dryness level.

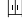
Note: You can also adjust the dryness level in the basic settings.

1. Set an automatic programme.
→ *Page 20*
- ✓ The display shows the specified dryness level.
2. Press and hold **Cupboard Dry** , **Cupboard Dry Plus**  or **Iron Dry**  Δ for approx. 3 seconds.
- ✓ The display shows "0", "1", "2" or "3".
3. Press \wedge or \vee to adjust the dryness level from "0" (dry) to "3" (driest).
4. Press and hold the selected drying target for approx. 3 seconds to return to the automatic programme.

13 Childproof lock

Secure your appliance against being operated unintentionally using the controls.

13.1 Activating the childproof lock

- ▶ Press and hold  **3 sec.** for approx. 3 seconds.
- ✓ The control elements are locked.
- ✓ The childproof lock also remains activated when the appliance is in standby mode and in the event of a power cut.

13.2 Deactivating the childproof lock

Requirement: To deactivate the childproof lock, the appliance must be switched on.

- ▶ Press and hold  **3 sec.** for approx. 3 seconds.

14 Crease-removal function

In order to reduce creasing and airborne odours, such as cigarette smoke, you can use a programme with a crease-removal function for any dry laundry that has not been worn for long or at all.

14.1 Starting a programme with the crease-removal function

Note: Wash items of laundry that have traces of sweat, perfume or deodorant before wearing them again. Do not use dryer cleaning sets. Do not use a programme with the crease-removal function for the following fabrics:

- Wool, leather and viscose
- Fabrics with parts made from metal, wood or plastic
- Waxed jackets and oilskin jackets

Requirement: The laundry is placed in the appliance. → *Page 24*

1. Set a programme with crease-removal function. → *Page 20*
2. If required, adjust the set programme with crease-removal function. → *Page 18*
3. Start the programme. → *Page 24*
If the water tank is empty, the display shows: .
→ *"Filling the water tank", Page 28*

The average programme duration of the crease-removal function is approx. 45 minutes and may be longer or shorter depending on the ambient temperature.

- ✓ After the programme has ended, the display shows: "End".

4. Remove the laundry. → *Page 24*
The results of the crease-removal function may vary depending on the type of fabric, the amount of laundry and the selected programme.
Remove the laundry immediately after the programme has ended to prevent creasing.
5. Hang up the items of laundry and pull them into shape.

14.2 Filling the water tank

Your appliance removes the creases from rarely worn clothing using cold mains water. If the display shows a notification while the appliance is in operation, fill the water tank.

ATTENTION

Operating the appliance with water that is dirty or too hot may result in damage to the appliance.

- ▶ Only fill the water tank with cold drinking water.
- ▶ Never use condensed water, distilled water, additives or descaler for the crease-removal function.

Requirements

- A programme with the crease-removal function has been started. → *Page 28*
- The display shows: .
- The condensation container → *Page 26* is removed from the appliance.

1. Add approx. 180 ml cold mains water through the front opening, using the water jug provided.

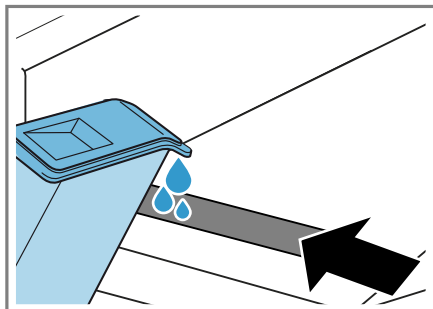

Observe the mark for filling the water tank next to the front opening. If ☒ does not go out on the display, align the appliance correctly. → *"Aligning the appliance"*, Page 13

- ✓ ☒ goes out on the display.
2. Insert the condensation container. → Page 26
 3. Start the programme. → Page 24

15 Home Connect

This appliance is network-capable. Connecting your appliance to a mobile device lets you control its functions via the Home Connect app, adjust its basic settings and monitor its operating status.

The Home Connect services are not available in every country. The availability of the Home Connect function depends on the availability of the Home Connect services in your country. You can find information about this at: www.home-connect.com. The Home Connect app guides you through the entire login process. Follow the instructions, noting the information in the Home Connect app.

Notes

- Please note the safety precautions in this instruction manual and make sure that they are also observed when operating the appliance via the Home Connect app. → *"Safety"*, Page 3
- Operating the appliance on the appliance itself always takes priority. During this time it is not possible to operate the appliance using the Home Connect app.

15.1 Setting up Home Connect

Requirement: The appliance is receiving signals from the WLAN home network (Wi-Fi) at its installation location.

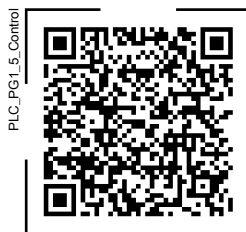

1. Scan the following QR code.



You can install the Home Connect app and connect your appliance via the QR code.

2. Follow the instructions in the Home Connect app.

15.2 Deactivating Wi-Fi on the appliance

1. Press and hold  **Remote Start** for approx. 3 seconds.
 2. Press  **Remote Start** repeatedly until the display shows "on".
 3. Press  to deactivate the Wi-Fi.
- ✓ The display shows "oFF".

Note: To exit the Home Connect settings, press and hold  **Remote Start** for approx. 3 seconds.

15.3 Activating Wi-Fi on the appliance

1. Press and hold **Remote Start** for approx. 3 seconds.
 2. Press **Remote Start** repeatedly until the display shows "oFF".
 3. Press **||▷** to activate the Wi-Fi.
- ✓ The display shows "on".

Notes

- If the Wi-Fi is activated, the display alternately shows "on" and the signal strength of the Wi-Fi connection.
- To exit the Home Connect settings, press and hold **Remote Start** for approx. 3 seconds.

15.4 Installing the software update

Note: If a software update is available, a message appears in the Home Connect app.

- ▶ To install the software update, follow the instructions in the Home Connect app.
- ✓ The control panel is partially locked during the installation.
- ✓ In the event of a malfunction, installation may take up to 40 minutes. Do not reset the network settings or the appliance to the factory settings.

Note: You can find the current software version in the Home Connect app under the appliance information for the appliance.

15.5 Resetting the appliance network settings

1. Press and hold **Remote Start** for approx. 3 seconds.

2. Press **Remote Start** repeatedly until the display shows "rES".
 3. Press and hold **||▷** for approx. 3 seconds.
- ✓ The network settings are reset.

15.6 Remote start

Enable the appliance for remote start via the Home Connect app.

Note

Remote start will be deactivated in the following circumstances:

- The appliance door is opened.
- **||▷** is pressed.
- **Remote Start** is pressed.
- Following a power cut.

Activating remote start

Requirements

- The appliance door is closed.
- The refresher tank is not empty.
- ▶ Press **Remote Start**.
- ✓ **Remote Start** lights up and the appliance is enabled for remote start via the Home Connect app.

Deactivating remote start

- ▶ Press **Remote Start**.
- ✓ **Remote Start** goes out.

15.7 Intelligent programme recommendation



When you activate the intelligent programme recommendation, your appliance recommends a suitable programme for drying the laundry once you have washed your laundry in the washing machine.

Intelligent programme recommendation

Requirements

- Your washing machine has the Home Connect function.
- Your washing machine and your dryer must be connected to your

home network and registered in your Home Connect app.

1. Press  **SmartDry**.
 - ✓ The appliance detects a suitable programme. To cancel the process, set a different programme or switch the appliance to standby mode.
 - ✓ If the appliance finds a suitable programme, the display for the programme lights up and the programme information is displayed.
 - ✓ If the appliance does not find a suitable programme, a signal tone sounds and the display shows "- -".
2. Press  .

15.8 Remote diagnostics

Customer Service can use Remote Diagnostics to access your appliance if you contact them, have your appliance connected to the Home Connect server and if Remote Diagnostics is available in the country in which you are using the appliance.

Tip: For further information and details about the availability of Remote Diagnostics in your country, please visit the service/support section of your local website: *www.home-connect.com*.

15.9 Data protection

Please see the information on data protection.

The first time your appliance is registered on a home network connected to the Internet, your appliance will transmit the following types of data to the Home Connect server (initial registration):

- Unique appliance identification (consisting of appliance codes as well as the MAC address of the in-

stalled Wi-Fi communication module).

- Security certificate of the Wi-Fi communication module (to ensure a secure data connection).
- The current software and hardware version of your appliance.
- Status of any previous resetting to factory settings.

This initial registration prepares the Home Connect functions for use and is only required when you want to use the Home Connect functions for the first time.

Note: Please note that the Home Connect functions can only be utilised with the Home Connect app. Information on data protection can be retrieved in the Home Connect app.

16 Basic settings

You can configure the basic settings for your appliance to meet your needs.

Note: You can also adjust the basic settings in the Home Connect app.

16.1 Overview of the basic settings

Note: Additional functions may be available as a result of software updates. → *Page 30*

If a software update is available, you can find further information in the Home Connect app.

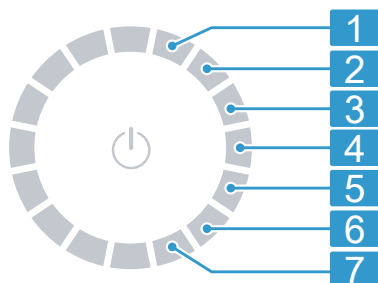

Programme selector with programme positions

-
- 1** Set the volume of the signal at the end of the programme:
0 (off) to 4 (very loud)

 - 2** Set the volume of the signal tone emitted when the buttons are pressed:
0 (off) to 4 (very loud)

 - 3** Set the display brightness:
1 (low) to 4 (very high)

 - 4** Adjust the dryness level
→ *Page 27*:
0 (dry) to 3 (driest)





 - 5** Start the basic (CP1) or intensive (CP2) appliance care programme.
→ *"Appliance care", Page 32*

 - 6** Display the number of started programmes (PC).

 - 7** Restore the appliance to the factory settings (rES).

16.2 Changing the basic settings

1. To call up the basic settings, press .

2. Use the programme selector to select the required basic setting.
→ *Page 31*
3. Adjust the basic setting:
 - ▶ To change the value, press  or .
 - ▶ To reset the appliance to the factory settings, press and hold  for approx. 3 seconds.
4. To exit the basic settings, press .

17 Appliance care

The appliance offers cleaning programmes for basic and intensive appliance care.

To rectify malfunctions, you can run the basic appliance care programme when the display shows "CaRE".

Note: The basic appliance care programme runs for approximately 40 minutes.

To remove any stubborn dirt deposits in the appliance after a downtime of more than one month, you can run the intensive appliance care programme.

Note: The intensive appliance care programme runs for approximately 2 hours 30 minutes and must not be cancelled.

17.1 Preparing for appliance care

Requirement: The drum is empty.



1. Put the appliance into standby mode. → *Page 24*
2. Empty the condensation container.
→ *Page 26*
3. Switch on the appliance.
4. Run the **Timed Progr. Warm** programme without laundry for 30 minutes.
5. Empty the condensation container.
→ *Page 26*

17.2 Running the basic appliance care programme

Requirement: The appliance care is prepared. → *Page 32*

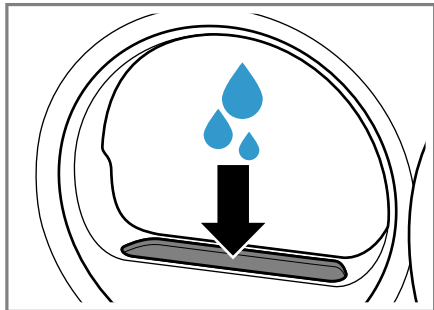
1. Remove and clean the fluff filter, and put it to one side. → *Page 24*
2. Pour approx. 1.6 litres of mains water into the appliance through the recess of the fluff filter.





3. Insert the fluff filter.
4. Close the door.
5. Press .
6. Set the programme selector to position 5. → *Page 31*
- ✓ "CP1" and the programme duration alternate on the display.
- ✓ When enough water has been filled in, a signal tone sounds.
7. Press .
- ✓ The appliance care programme starts and a signal tone sounds.
- ✓ "End" appears on the display and a signal tone sounds once the appliance care programme has ended.
8. If you collect the condensation water in the condensation container, empty the condensation container → *Page 26*.
9. Put the appliance into standby mode. → *Page 24*

17.3 Running the intensive appliance care programme

Starting the intensive appliance care programme

Requirement: The appliance care is prepared. → *Page 32*

1. Remove and clean the fluff filter, and put it to one side. → *Page 24*
2. Pour approx. 1.6 litres of mains water into the appliance through the recess of the fluff filter.
3. Insert the fluff filter.
4. Close the door.
5. Press .
6. Set the programme selector to position 5. → *Page 31*
- ✓ "CP1" and the programme duration alternate on the display.
7. Press .
- ✓ "CP2" and the programme duration alternate on the display.
- ✓ When enough water has been filled in, a signal tone sounds.
8. Press .
- ✓ The appliance care programme starts and a signal tone sounds.
- ✓ After around 1 hour 50 minutes, the appliance pauses the appliance care programme and the remaining programme duration flashes on the display.
9. If you collect the condensation water in the condensation container, empty the condensation container → *Page 26*.

Continuing the intensive appliance care programme

1. Remove and clean the fluff filter, and put it to one side. → *Page 24*
2. Pour approx. 1.6 litres of mains water into the appliance through the recess of the fluff filter.
- ✓ When enough water has been filled in, a signal tone sounds.

en Cleaning and servicing

3. Insert the fluff filter.
4. Close the door.
5. Press II ▷.
- ✓ The appliance care programme continues.
- ✓ "End" appears on the display and a signal tone sounds once the appliance care programme has ended.
6. If you collect the condensation water in the condensation container, empty the condensation container → *Page 26*.
7. Put the appliance into standby mode. → *Page 24*

18 Cleaning and servicing

ATTENTION

Heavy, sharp or rough objects may damage the appliance.

- ▶ Do not use hard or sharp objects, abrasive cleaning products or steel wool for cleaning.
- ▶ Clean the appliance using only water and a soft cloth.

18.1 Moisture sensor

The moisture sensor in this appliance measures how damp the laundry is during the drying cycle. The appliance changes the duration of the automatic programme depending on the residual moisture in the laundry.

Cleaning the moisture sensor

Over time, residue from limescale, detergents and care products can build up on the moisture sensor. Clean the moisture sensor regularly.

Note: If you do not clean the appliance as described, the appliance's functionality may be impaired.

1. Open the door.
2. Clean the moisture sensor with a sponge.

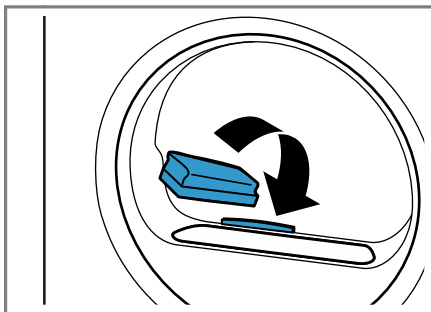

18.2 Door grille

The door grille on the inside of the door helps the air flow during the drying process.

Cleaning the door grille

Fluff can collect in the door grille after some time. This does not have any effect on energy consumption. Clean the door grille if there is any visible dirt.

- ▶ Clean the door grille with a damp cloth.

19 Troubleshooting



You can rectify minor faults on your appliance yourself. Read the troubleshooting information before contacting after-sales service. This will avoid unnecessary costs.

 **WARNING**

Risk of electric shock!

Improper repairs are dangerous.

- ▶ Never make any technical modifications to the appliance or its features.
- ▶ Repairs to the appliance should only be carried out by trained specialist staff.
- ▶ Only use genuine spare parts when repairing the appliance.
- ▶ If the power cord of this appliance is damaged, it must be replaced by the manufacturer, the manufacturer's Customer Service or a similarly qualified person in order to prevent any risk.

Fault	Cause and troubleshooting
The display goes out and ▷ flashes.	Energy-saving mode is active ▶ Press ▷.
All other error codes.	Malfunction <ol style="list-style-type: none"> 1. To restart the appliance, press and hold ⊕ for approximately 5 seconds. 2. If the fault occurs again, disconnect the appliance from the power supply for at least 30 seconds. Unplug the appliance from the mains or switch off the circuit breaker in the fuse box. 3. If the fault persists, call customer service. → <i>Page 39</i> Please specify the exact error message when calling. If possible, document the fault with photos and videos.
"Hot" and the drum rotates.	Not a fault. The cooling process is active. No action required. Note: Do not change the programme during the cooling process. The cooling process takes up to 10 minutes.
 and programme terminated.	The condensation container is full. ▶ Empty the condensation container. → <i>Page 26</i> <hr/> The water outlet hose is not connected correctly, or is kinked or trapped. ▶ Check the installation of the water outlet hose. → <i>Page 12</i> <hr/> Water outlet hose is blocked. ▶ Rinse the water outlet hose with tap water.
"CArE"	The basic appliance care programme should be run. ▶ Run the basic appliance care programme → <i>Page 32</i> .
	Fluff filter is soiled. ▶ Clean the fluff filter. → <i>Page 24</i>

Fault	Cause and troubleshooting
✘	<p>The water tank for the crease-removal function is empty.</p> <ul style="list-style-type: none"> ▶ Fill the water tank. → <i>Page 28</i>
The display and buttons do not respond.	<p>Software fault.</p> <ol style="list-style-type: none"> 1. To restart the appliance, press and hold ϕ for approximately 5 seconds. 2. If the fault occurs again, disconnect the appliance from the power supply for at least 30 seconds. Unplug the appliance from the mains or switch off the circuit breaker in the fuse box.
Home Connect is not working properly.	<p>Different causes are possible.</p> <ol style="list-style-type: none"> 1. Reset the appliance network settings. → <i>Page 30</i> 2. Set up Home Connect again. → <i>Page 29</i> <ul style="list-style-type: none"> ▶ Go to <i>www.home-connect.com</i>.
Water overflows when filling the water tank.	<p>The water tank is completely full. No action required.</p> <p>Note: The overflowing water is harmless. Do not pour any more water into the water tank.</p>
The programme does not start.	<p>Childproof lock is activated.</p> <ul style="list-style-type: none"> ▶ Deactivate the childproof lock. → <i>Page 27</i> <p>Finish in is activated.</p> <ul style="list-style-type: none"> ▶ Check whether Finish in is activated. → <i>Page 19</i>
The length of the programme changes during the drying cycle.	<p>Not a fault. The programme sequence is optimised electronically. No action required.</p>
The drying time is too long.	<p>Fluff filter is soiled.</p> <ul style="list-style-type: none"> ▶ Clean the fluff filter. → <i>Page 24</i> <p>The ambient temperature is lower than 15 °C or higher than 30 °C.</p> <ul style="list-style-type: none"> ▶ Ensure that the ambient temperature is between 15 °C and 30 °C.
	<p>The air circulation at the appliance's installation location is insufficient.</p> <ul style="list-style-type: none"> ▶ Ventilate the appliance's installation location.
	<p>Insufficient condensation for the automatic self-cleaning function when permanently drying small loads of laundry or when permanently using the crease-removal function.</p> <ul style="list-style-type: none"> ▶ Regularly dry a load weighing more than 3 kg of damp laundry until the programme ends.

Fault	Cause and troubleshooting
The drying time is too long.	The appliance's ventilation opening is blocked. ▶ Ensure that the ventilation opening of the appliance is kept clear.
	Heat exchanger is soiled. ▶ Run the basic appliance care programme → <i>Page 32</i> .
Drum movement direction changes during drying.	Not a fault. The laundry is better distributed for optimum drying results. No action required.
The crease-removal function takes too long.	A low ambient temperature extends the duration of the crease-removal function. No action required.
Humming, whirring or pumping noises.	Not a fault. The compressor, compressor ventilation or condensation pump is active. No action required.
The laundry is too damp.	The selected programme is unsuitable for the type of fabric. ▶ Set a time programme for subsequent drying. → <i>Page 21</i>
	The load is too large. ▶ Observe the programme's maximum load capacity. → <i>Page 19</i>
	After the end of the programme, warm laundry feels damper than it actually is. 1. Remove the laundry from the drum as soon as the drying programme has finished. 2. Spread the items of laundry for cooling.
	The selected dryness level is unsuitable. ▶ Change the dryness level. → <i>Page 27</i>
	The dryness level is not adjusted. ▶ Adjust the dryness level. → <i>Page 27</i>
	The load is too small. ▶ Set a time programme for subsequent drying. → <i>Page 21</i>
	The moisture sensor is dirty. ▶ Clean the moisture sensor. → <i>Page 34</i>
	The appliance has interrupted the drying process due to the condensation container being full. ▶ Empty the condensation container. → <i>Page 26</i>

Fault	Cause and troubleshooting
Creasing.	<p>The selected programme is unsuitable for the type of fabric.</p> <ul style="list-style-type: none"> ▶ Set a suitable programme. → <i>Page 19</i> <hr/> <p>The load is unsuitable.</p> <ul style="list-style-type: none"> ▶ Observe the programme's maximum load capacity. → <i>Page 19</i> ▶ Prepare the laundry. → <i>Page 22</i> <hr/> <p>The laundry lies in the drum for too long after drying.</p> <ol style="list-style-type: none"> 1. Remove the laundry from the drum as soon as the drying programme has finished. 2. Spread the items of laundry for cooling. <hr/> <p>Easy Care fabrics have been dried for too long.</p> <ul style="list-style-type: none"> ▶ Change or adjust the dryness level. → <i>Page 27</i> <hr/> <p>The crease-reduction function is not activated.</p> <ul style="list-style-type: none"> ▶ Activate the crease-reduction function. → <i>Page 18</i>
Water is leaking from the appliance.	<p>Appliance is not correctly aligned.</p> <ul style="list-style-type: none"> ▶ Align the appliance. → <i>Page 13</i> <hr/> <p>Water outlet hose is not connected correctly.</p> <ul style="list-style-type: none"> ▶ Check the installation of the water outlet hose. → <i>Page 12</i>

20 Transportation, storage and disposal

20.1 Emptying the base unit

Remove residual water from the base unit before transporting.

1. Empty the condensation container. → *Page 26*
2. Run the **Timed Progr. Warm** programme without laundry for 30 minutes.
3. Empty the condensation container. → *Page 26*

20.2 Disposing of old appliance

Valuable raw materials can be re-used by recycling.

WARNING

Risk of harm to health!

Children can lock themselves in the appliance, thereby putting their lives at risk.

- ▶ The appliance must not be set up behind a lockable door, a sliding door or a door with a hinge on the side opposite to the appliance, which prevents appliance from opening fully.
- ▶ With redundant appliances, unplug the power cord. Then cut through the cord and damage the lock on the appliance door beyond repair so that the appliance door will no longer close.

1. Unplug the appliance from the mains.

2. Cut through the power cord.
3. Dispose of the appliance in an environmentally friendly manner. Information about current disposal methods are available from your specialist dealer or local authority.



This appliance is labelled in accordance with European Directive 2012/19/EU concerning used electrical and electronic appliances (waste electrical and electronic equipment - WEEE). The guideline determines the framework for the return and recycling of used appliances as applicable throughout the EU.

21 Customer Service

Function-relevant genuine spare parts according to the corresponding Eco-design Directive can be obtained from Customer Service for a period of at least 10 years from the date on which your appliance was placed on the market within the European Economic Area.

Furthermore, our Customer Service will continue to provide you with other function-relevant and storable genuine spare parts for up to 15 years from the date on which your appliance was placed on the market. For more information, please contact our Customer Service team.

Note: Under the terms of the manufacturer's warranty the use of Customer Service is free of charge.

Detailed information about the warranty period and the warranty conditions in your country is available via the QR code on the enclosed document on service contacts and warranty conditions, from our customer service or on our website.

You can find the contact details for our customer service via the QR code on the enclosed document on service contacts and warranty conditions or on our website.

21.1 Product number (E-Nr.), production number (FD) and consecutive numbering (Z-Nr.)

If you contact Customer Service, you will require the product number (E-Nr.), the production number (FD) and the consecutive numbering (Z-Nr.), which you can find on the appliance's rating plate.

Depending on the model, the rating plate is located:

- On the inside of the door.
- Underneath the drum opening.
- On the inside of the maintenance flap.
- On the rear of the appliance.

Make a note of your appliance's details and the Customer Service telephone number to find them again quickly.

22 Consumption values

The **Eco** programme is suitable for drying cotton laundry with a normal dampness level, and is the most efficient programme for drying damp cotton laundry in terms of combined energy consumption. This programme serves to assess













en Consumption values

compliance with Regulations (EU) 2023/2533 and (EU) 2023/2534. The consumption values for this programme that are declared on the energy label refer to a moisture content of the laundry of 60%.

The values specified for other programmes are indicative only and were determined in accordance with the applicable standard EN61121.

The actual values may deviate from the indicated values depending on the type of fabric, composition of laundry to be dried, residual moisture in the fabric, set degree of dryness, amount of laundry being loaded, environmental conditions and the activation of additional functions.

The expected programme duration/"Ready in" time that is shown on the appliance display when selecting the programme is based on the spin speed in the washing machine of 1000 rpm when the appliance is delivered.

Programme	Final moisture level (%)	Load (kg)	Spin speed (rpm)	Initial moisture level (%)	Programme duration (h:min)	Energy consumption (kWh/cycle)
Cottons + Cupboard Dry Plus 	-3.0	9.0	1400	50	4:55	1.30
Cottons + Cupboard Dry Plus 	-3.0	4.5	1400	50	2:49	0.68
Cottons + Cupboard Dry Plus 	-3.0	9.0	1000	60	5:18	1.46
Cottons + Cupboard Dry Plus 	-3.0	4.5	1000	60	3:01	0.76
Cottons + Cupboard Dry Plus 	-3.0	9.0	800	70	5:42	1.63
Cottons + Cupboard Dry Plus 	-3.0	4.5	800	70	3:14	0.84
Cottons + Cupboard Dry 	-1.5	9.0	1400	50	4:28	1.18
Cottons + Cupboard Dry 	-1.5	4.5	1400	50	2:45	0.63
Cottons + Cupboard Dry 	-1.5	9.0	1000	60	4:51	1.34
Cottons + Cupboard Dry 	-1.5	4.5	1000	60	2:57	0.71
Cottons + Cupboard Dry 	-1.5	9.0	800	70	5:14	1.50
Cottons + Cupboard Dry 	-1.5	4.5	800	70	3:09	0.79

Programme	Final moisture level (%)	Load (kg)	Spin speed (rpm)	Initial moisture level (%)	Programme duration (h:min)	Energy consumption (kWh/cycle)
Eco	0.0	9.0	1400	50	3:58	1.08
Eco	0.0	4.5	1400	50	3:09	0.56
Eco ¹	0.0	9.0	1000	60	4:25	1.25
Eco	0.0	4.5	1000	60	3:15	0.65
Eco	0.0	9.0	800	70	4:52	1.43
Eco	0.0	4.5	800	70	3:22	0.74
Cottons + Iron Dry \triangleleft	12.0	9.0	1400	50	2:50	0.72
Cottons + Iron Dry \triangleleft	12.0	4.5	1400	50	1:49	0.41
Cottons + Iron Dry \triangleleft	12.0	9.0	1000	60	3:13	0.88
Cottons + Iron Dry \triangleleft	12.0	4.5	1000	60	2:02	0.49
Cottons + Iron Dry \triangleleft	12.0	9.0	800	70	3:37	1.05
Cottons + Iron Dry \triangleleft	12.0	4.5	800	70	2:14	0.57
Easy Care + Cupboard Dry Plus \square	0.0	3.5	800	40	1:37	0.37
Easy Care + Cupboard Dry Plus \square	0.0	3.5	600	50	1:53	0.44
Easy Care + Cupboard Dry \square	2.0	3.5	800	40	1:21	0.30
Easy Care + Cupboard Dry \square	2.0	3.5	600	50	1:37	0.38
Easy Care + Iron Dry \triangleleft	12.0	3.5	800	40	1:05	0.22
Easy Care + Iron Dry \triangleleft	12.0	3.5	600	50	1:21	0.29
Delicates	0.0	2.0	-	-	1:26	0.33

23 Technical data

Appliance height	84.2 cm
Appliance width	59.8 cm
Appliance depth	62.7 cm

Appliance depth with door closed	67.5 cm
Appliance depth with door open	111.9 cm
Weight	53.7 kg

¹ The acoustical noise emissions during the drying cycle are 57 dB.

Maximum load	9.0 kg
Mains voltage	220-240 V, 50 Hz
⇒ Minimum installation protection	10 A
Nominal power	850 W
Ambient temperature	<ul style="list-style-type: none">■ Minimum: 5 °C■ Maximum: 35 °C
Length of the power cord	180 cm

This product contains light sources from energy efficiency class F. These light sources are available as a spare part and must only be replaced by trained specialist staff.

More information about your model can be found online at <https://eprel.ec.europa.eu/qr/2274440>¹.

This web address is linked to the official EU EPREL product database.

23.1 Information regarding Free and Open Source Software

This product includes software components that are licensed by the copyright holders as free software or open source software.

The applicable licence information is stored on your home appliance. You can also access the applicable licence information via your Home Connect app: "Profile -> Legal information -> Licence Information".²

You can also download the licence information on the brand product website. (Please search on the product website for your appliance

model and additional documents). Alternatively, you can request the relevant information from oss-request@bshg.com or BSH Hausgeräte GmbH, Carl-Wery-Str. 34, 81739 Munich, Germany.

The relevant source code will be made available on request.

Please send your request to oss-request@bshg.com or BSH Hausgeräte GmbH, Carl-Wery-Str.34, 81739 Munich, Germany.

Subject: „OSSREQUEST“

The cost of performing your request will be charged to you. This offer is valid for three years from the date of purchase or at least as long as we offer support and spare parts for the relevant appliance.

¹ Only applies to countries in the European Economic Area. This website address is available from 1st July 2025.

² Depending on the appliance specifications

24 Declaration of Conformity

BSH Hausgeräte GmbH hereby declares that the appliance with Home Connect functionality conforms to the essential requirements and other relevant provisions of Directive 2014/53/EU.

A detailed RED Declaration of Conformity can be found online at www.bosch-home.com among the additional documents on the product page for your appliance.



Hereby, BSH Hausgeräte GmbH declares that the appliance with Home Connect functionality is in compliance with relevant statutory requirements.¹

A detailed Declaration of Conformity can be found online at www.bosch-home.co.uk among the additional documents on the product page for your appliance.¹



2.4 GHz band (2400–2483.5 MHz): Max. 100 mW

5-GHz band (5150–5350 MHz + 5470–5725 MHz): max. 150 mW

	BE	BG	CZ	DK	DE	EE	IE	EL	ES
	FR	HR	IT	CY	LI	LV	LT	LU	HU
	MT	NL	AT	PL	PT	RO	SI	SK	FI
	SE	NO	CH	TR	IS	UK (NI)			

5 GHz WLAN (Wi-Fi): For indoor use only.

AL	BA	MD	ME	MK	RS	UK	UA
----	----	----	----	----	----	----	----

5 GHz WLAN (Wi-Fi): For indoor use only.

24.1 Statement of Compliance for Great Britain

The full Statement of Compliance according to the Product Security and Telecommunications Infrastructure (Security Requirements for Relevant Connectable Products) Regulations 2023 can be found online at www.bosch-home.co.uk among the additional documents on the product page for your appliance.

Product type

This statement of compliance covers the products described in this information for use whose model identifier group is seen on the title page. The full model identifier is made up of the characters before the slash in the product number (E no.) which can be found on the rating plate. Alternatively, you can also find the model identifier in the first line of the UK Energy Label.

¹ Only applies to Great Britain

Name and address of manufacturer

BSH Hausgeräte GmbH, Carl-Wery-Strasse 34, 81739 München, Germany

This statement of compliance is prepared by the manufacturer.

The manufacturer, BSH Hausgeräte GmbH deems that it has complied with

- provision 5.1-1 of ETSI EN 303 645 v2.1.1 and, where relevant, provision 5.1-2 of ETSI EN 303 645 v2.1.1;
- provision 5.2-1 of ETSI EN 303 645 v2.1.1;
- provision 5.3-13 of ETSI EN 303 645 v2.1.1.

Support period

BSH Hausgeräte GmbH will provide security updates that are necessary to maintain the main functions free of charge until at least 28/02/2034.



Many thanks for choosing a Bosch home appliance!

Register your new appliance now on MyBosch and benefit directly from:

- **Expert advice and tips to make the most of your appliance**
- **Options for warranty extension**
- **Discounts on spare parts and accessories**
- **Digital information for use and all appliance data to hand**
- **Easy access to Bosch Home Appliance Service**

Simple to register, free of charge – including on mobile devices:

www.bosch-home.com/welcome



Need some help? You can find it here.

Expert advice on your Bosch home appliances, help with problems or repairs by professionals from Bosch.

Discover all the different ways Bosch can assist you:

www.bosch-home.com/service

The contact details of all countries are listed in the attached service directory.

BSH Hausgeräte GmbH
Carl-Wery-Straße 34
81739 München, GERMANY
www.bosch-home.com

A Bosch Company

Valid within Great Britain:
Imported to Great Britain by
BSH Home Appliances Ltd.
Grand Union House
Old Wolverton Road
Wolverton, Milton Keynes
MK12 5PT
United Kingdom



9002045758 (060116)

en