



BOSCH

Register your
new device on
MyBosch now and
get free benefits:
**[bosch-home.com/
welcome](https://bosch-home.com/welcome)**



Washing machine

XQG100-WAU28560HW XQG100-WAU28566HW XQG100-WAU28568HW
XQG100-WAU28569HW

en Instruction Manual and Installation Instructions

Your new washing machine

You have chosen a Bosch washing machine.

Please take a few minutes to read and become familiar with the advantages of your washing machine.

To meet the high quality demands required by Bosch, every washing machine that leaves our factory is carefully checked to ensure that it functions correctly and is in perfect condition.

For more information on our products, accessories, replacement parts and services, see our website www.bosch-home.com or contact our after-sales service centres.

If the operating and installation instructions describe different models, any differences will be pointed out at the relevant points in the text.



Read these operating and installation instructions before switching on the washing machine.

GB standard:

GB4706.1

GB4706.24

GB19606

GB4343.1

GB17625.1

GB/T 4288

GB12021.4

Display rules

Warning!

This combination of symbol and signal word indicates a possibly dangerous situation. Not heeding the warning can cause death or injuries.

Caution!

This signal word indicates a possibly dangerous situation. Not heeding the caution can cause property and/or environmental damage.

Note/tip

Information about the optimum use of the appliance/any other useful information.







1. 2. 3. / a) b) c)

The steps are represented by numbers or letters.

■ / -

Lists are represented by a small box or a dash.

Contents

 Intended use	4	 Overview of programmes	27
 Safety instructions	5	Selectable programme	27
Children/people/pets	5	 Programme default settings	31
Installation	6	Temperature	31
Operation	8	Spin speed	31
Cleaning/Maintenance	10	Finish in	31
 Environmental protection	12	 Additional programme settings	32
Packaging/used appliance	12	提速 (speedPerfect)	32
Tips on economical use	13	节电 (ecoPerfect)	32
 Positioning and connecting	14	除菌液 (Disinfectant)	32
Included with the appliance	14	高水位 (Water plus)	32
Installation	14	轻松熨 (Easy iron)	32
Safety instructions	14	油渍 / 汗渍 / 血渍 / 泥渍 (Stains)	32
Removing the foam block	15	浸泡 (Soaking)	33
Installation surface	16	加漂洗 (Rinse plus)	33
Installation on a base or a wooden joist floor	16	记忆 (Memory)	33
Installation on a platform with drawer	16	夜间 (Silent wash)	33
Installing the appliance in a kitchenette	16	□ (Remote start)	34
Removing the transport locks	16	 Operating the appliance	34
Hose and cable lengths	17	Preparing the appliance	34
Water inlet	18	Switching on the appliance/selecting a programme	35
Water outlet	18	Selecting additional programmes	35
Alignment	19	Placing laundry into the drum	35
Electrical connection	19	Measure and add detergent and care products	36
Before washing for the first time	20	Starting the programme	37
Transportation	20	Childproof lock	37
 Getting to know the appliance 22		Adding/removing laundry	37
Appliance	22	Changing the programme	38
Control panel	23	Cancel the programme	38
Touch-Display	24	Programme end	38
 Laundry	25	Removing laundry/switching off the appliance	38
Protecting your laundry and appliance	25	 Home Connect	38
Sorting laundry	26	Calling up the Home Connect menu	39
		Connecting to the home network and the Home Connect app	39
		Activating/deactivating Wi-Fi	41

Resetting your network settings 42
 Updating the software 42
 Information on data protection 42
 Declaration of Conformity 43

 **Appliance settings 43**

Automatic switch-off 43
 Basic settings 43

 **Sensors 44**

Unbalanced load detection system 44

 **Cleaning and maintenance 45**

Appliance housing/control panel 45
 Drum 45
 Descaling 45
 Detergent drawer and housing 45
 Cleaning the measuring aid A for liquid detergent 46
 Drain pump is blocked 46
 The drain hose at the siphon is blocked 47
 Filter in the water supply is blocked 47

 **Faults and what to do about them 48**

Emergency release 48
 Information on the display panel 49
 Faults and what to do about them 50

 **After-sales service 53**

 **Consumption values 54**

 **Technical data 55**

 **Intended use**

- This appliance is intended for private domestic use only.
- Do not install or operate this appliance anywhere that is liable to experience frost and/or outdoor conditions. There is a risk that the appliance will be damaged if residual water in it freezes. If hoses freeze up, they may crack/burst.
- This appliance must only be used for washing domestic laundry, consisting of machine-washable items and hand-washable woollens (see label on item). Using the appliance for any other purpose is outside of the scope of its intended application and is forbidden.
- This appliance is suitable for operation with mains water and commercially available detergents and care products (must be suitable for use in washing machines).
- This appliance is intended for use up to a maximum height of 4000 metres above sea level.

Before you switch on the appliance:

Check that there is no visible damage to the appliance. Do not operate the appliance if it is damaged. Should you have any problems, please contact your specialist dealer or our customer service.

Read and follow the operating and installation instructions and all other information provided with this appliance.

Retain the documents for subsequent use or for subsequent owners.

Safety instructions

The following safety information and warnings are provided to protect you from injury and to prevent material damage to your surroundings.

It is nevertheless important to take the necessary precautions and to proceed with care when installing, maintaining, cleaning and operating the appliance.

Children/people/pets

Warning **Risk of death!**

Children and other people who are unable to assess the risks involved when using the appliance may injure themselves or may find themselves in life-threatening situations. Therefore please note:

- The appliance may be used by children over the age of 8 years and by persons with reduced physical, sensory or mental capacity or by persons with a lack of experience or knowledge as long as they are supervised or have received instruction on how to use the appliance safely and they have understood the potential risks of using the appliance.
- Children must not play with this appliance.

- Do not allow children to clean or maintain this appliance unsupervised.
- Keep children under 3 years and pets away from this appliance.
- Do not leave the appliance unattended when children or other people who are unable to assess the risks are in the vicinity.

Warning **Risk of death!**

Children may lock themselves inside appliances and find themselves in a life-threatening situation.

- Do not position the appliance behind a door, as this may obstruct the appliance door or prevent it from opening completely.
- Once an appliance has reached the end of its life, pull the mains plug from the socket **before** severing the mains cable, and then destroy the lock on the appliance door.

⚠ Warning

Risk of suffocation!

If allowed to play with the packaging/plastic film or packing components, children may become caught in these or pull them over their heads and suffocate.

Keep packaging, plastic film and packing components away from children.

⚠ Warning

Risk of poisoning!

Detergents and care products may result in poisoning if consumed.

If accidentally swallowed, seek medical advice. Keep detergents and care products out of the reach of children.

⚠ Warning

Risk of burns!

When washing at high temperatures, the glass in the appliance door becomes hot. Stop children from touching the appliance door when it is hot.

⚠ Warning

Eye/skin irritation!

Contact with detergents or care products may cause eye/skin irritation.

Rinse eyes/skin thoroughly if they/it come(s) into contact with detergents or care products. Keep detergents and care products out of the reach of children.

Installation

⚠ Warning

**Risk of electric shock/fire/
material damage/damage to
the appliance!**

If the appliance is not installed properly, this may lead to a dangerous situation. Ensure the following:

- The mains voltage on your power socket must match the rated voltage specified on the appliance (identification plate). The connected loads and the required fuse protection are specified on the identification plate.
- The mains plug and the protective contact socket must match and the earthing system must be correctly installed.
- The installation must have an adequate cross section.
- The mains plug must be freely accessible at all times. If this is not possible, in order to comply with the relevant safety regulations, a switch (all pole disconnection) must be built into the permanent installation in accordance with electrical installation regulations.

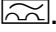
- If using a residual current circuit breaker, only use one that bears the following mark: . The presence of this mark is the only way to be sure that it fulfils all the applicable regulations.

Warning

Risk of electric shock/fire/ material damage/damage to the appliance!

If the appliance's mains cable is altered or damaged, this may result in electric shock, short circuiting or fire due to overheating.

The mains cable must not be kinked, crushed or altered, and must not come into contact with any heat sources.

Warning

Risk of fire/material damage/ damage to the appliance!

The use of extension cords or power strips may result in fire due to overheating or short circuiting.

Connect the appliance directly to an earthed socket that has been correctly installed. Do not use extension cords, power strips or multi-way couplers.

Warning

Risk of injury/material damage/damage to the appliance!

- The appliance may vibrate or move when in operation, potentially resulting in injury or material damage.
Place the appliance on a clean, even, solid surface and, using a spirit level to guide you, level it with the screw-in feet.
- If you take hold of any of the appliance's protruding parts (e.g. the appliance door) in order to lift or move it, these parts may break off and cause injury.
Do not take hold of any of the appliance's protruding parts in order to move the appliance.

Warning

Risk of injury!

- The appliance is very heavy. Lifting it may result in injury. Do not lift the appliance on your own.
- The appliance has sharp edges on which you could cut your hands.
Do not take hold of the appliance by its sharp edges. Wear protective gloves to lift it.

- If the hoses and mains cables are not correctly routed, they may constitute a tripping hazard, which may result in injury.
Route hoses and cables such that they do not constitute a tripping hazard.

Caution!

Material damage/damage to the appliance

- If the water pressure is too high or too low, the appliance may not be able to operate properly, and it may also result in material damage or damage to the appliance. Make sure that the water pressure in the water supply facility is at least 100 kPa (1 bar), and does not exceed 1000 kPa (10 bar).
- If the water hoses are altered or damaged, this may result in material damage or damage to the appliance. The water hoses must not be kinked, crushed, altered or severed.
- The use of hoses supplied by other brands to connect to the water supply may result in material damage or damage to the appliance. Use the hoses supplied with the appliance or genuine spare part hoses only.

- The appliance is secured for transportation by transport locking devices. If the transport locking devices are not removed before the appliance is operated, this may result in damage to the appliance.
It is important to completely remove all transport locking devices before using the appliance for the first time. Make sure that you retain these transport locking devices separately. It is important to refit the transport locking devices if the appliance is to be transported, in order to prevent the appliance from being damaged in transit.

Operation

Warning

Risk of explosions/fire!

Laundry that has been pretreated with cleaning agents that contain solvents, e.g. stain remover/cleaning solvent, may cause an explosion in the drum. Rinse the laundry thoroughly with water before washing it in the machine.

⚠ Warning**Risk of poisoning!**

Poisonous fumes may be given off by cleaning agents that contain solvents, e.g. cleaning solvent.

Do not use cleaning agents that contain solvents.

⚠ Warning**Risk of injury!**

- If you support your weight/sit on the appliance door when it is open, the appliance may tip over, which may result in injury.
Do not support your weight on the appliance door when it is open.
- If you climb onto the appliance, the worktop may break, which may result in injury.
Do not climb onto the appliance.
- If you reach into the drum while it is still rotating, you risk injuring your hands.
Wait until the drum has stopped rotating.

⚠ Warning**Risk of scalding!**

When washing at high temperatures, there is a risk of scalding if you come into contact with hot detergent solution (e.g. when draining hot detergent solution into a washbasin).

Do not reach into the hot detergent solution.

⚠ Warning**Eye/skin irritation!**

Detergent and care products may spray out if the detergent drawer is opened while the appliance is in operation.

Rinse eyes/skin thoroughly if they/it come(s) into contact with detergents or care products. If accidentally swallowed, seek medical advice.

Caution!**Material damage/damage to the appliance**

- If the amount of laundry in the appliance exceeds its maximum load capacity, it may not be able to operate properly, or this may result in material damage or damage to the appliance.
Do not exceed the maximum load capacity of dry laundry. Make sure you comply with the maximum load capacities specified for each of the programs.
- If you pour the wrong quantity of detergent or cleaning agent into the appliance, this may result in material damage or damage to the appliance.
Use detergents/care products/cleaning agents and softeners in accordance with the manufacturers' instructions.

Cleaning/Maintenance

Warning

Risk of death!

The appliance is powered by electricity. There is a risk of electric shock if you come into contact with live components. Therefore please note:

- Switch off the appliance. Disconnect the appliance from the power supply (pull out the plug).
- Never take hold of the mains plug with wet hands.
- When removing the mains plug from the socket, always take hold of the plug itself and never the mains cable, otherwise this may damage the mains cable.
- Do not make any technical modifications to the appliance or its features.
- Repairs and any other work on the appliance must only be conducted by our customer service or by an electrician. The same applies for replacing the mains cable (when necessary).
- Spare mains cables can be ordered from our customer service.

Warning

Risk of poisoning!

Poisonous fumes may be given off by cleaning agents that contain solvents, e.g. cleaning solvent.

Do not use cleaning agents that contain solvents.

Warning

Risk of electric shock/material damage/damage to the appliance!

If moisture penetrates the appliance, this may cause it to short circuit.

Do not use a pressure washer, steam cleaner, hose or spray gun to clean your appliance.

Warning

Risk of injury/material damage/damage to the appliance!

The use of spare parts and accessories supplied by other brands is dangerous and may result in injury, material damage or damage to the appliance. For safety reasons, use genuine spare parts and accessories only.

Caution!**Material damage/damage to the appliance**

Cleaning agents and agents for pretreating laundry (e.g. stain removers, prewash sprays, etc.) may cause damage if they come into contact with the surfaces of the appliance. Therefore please note:

- Do not allow these agents to come into contact with the surfaces of the appliance.
- Clean the appliance with nothing but water and a soft, damp cloth.
- Remove any detergent, spray or other residues immediately.



Environmental protection

Packaging/used appliance

Dispose of packaging in an environmentally-responsible manner. Keep children away from the packaging materials and packaging materials are not toys. Reprocessing and reuse of packaging material saves raw materials, reducing waste. All packaging materials used are in line with environmental protection requirements and reusable.

Name and content of hazardous substances in products

Component name	Hazardous substance					
	Lead (Pb)	Mercury (Hg)	Cadmium (Cd)	Hexavalent chromium (Cr(VI))	Polybrominated biphenyls (PBB)	Polybrominated diphenyl ethers (PBDE)
PCB	x	o	o	o	o	o
Display	x	o	o	o	o	o
Controller	x	o	o	o	o	o
Power cord and connect wiring harness	x	o	o	o	o	o
Pumps and drives	x	o	o	o	o	o
Housing	o	o	o	o	o	o
Door and its constituent parts	x	o	o	o	o	o
Drum-system and its constituent parts	x	o	o	o	o	o
Water supply components (exempted dryer)	x	o	o	o	o	o

This table was developed according to the provisions of SJ/T 11364.

- o The content of such hazardous substance in all homogeneous materials of such component is below the limit required by GB/T 26572.
- x The content of such hazardous substance in a certain homogeneous materials of such component is beyond the limit required by GB/T 26572.

Note: All of component parts in the BSH products that fall into the same category are covered in the table above, the component parts of this product depend on the actual situation. If you have any questions, please contact us by dialling the customer service number in the product.

Indicative Statement of Environment Protection of Product

Please use and maintain the product according to the instruction of the manual, the product may harm to environment and human health due to improper utilization or disposal.

According to the law of 'Statute of Recovery and Disposal of Waste Electrical and Electronic Products', Please hand in the products to the disposal enterprises which are qualified when you plan to throw it. Please refer to the table above for the information about the content of relevant toxic and hazardous substances.

Tips on economical use

- Always fill the appliance with the maximum amount of laundry for each programme.
 - Wash normally soiled laundry without pretreating.
 - For light and normal soiling in laundry, you can save energy and detergent.
 - The selectable temperatures apply to the care labels on the textiles. The temperatures in the appliance may deviate from this so that you get the optimum mix of energy-saving and washing results.
 - **Automatic switch off:** If the appliance is not operated for approx. 5 minutes, it will automatically switch off (depending on the water level inside of appliance) before the programme starts and after the programme has ended. Press the power button ① again to switch on the appliance.
- Note:** If Wi-Fi is switched on at the appliance, the appliance will not automatically switch itself off.
- If the laundry will be dried in a dryer, select the spin speed according to the dryer manufacturer's instructions.



Positioning and connecting

Included with the appliance

Note: Check the appliance for transport damage. Never use a damaged appliance. If you have any complaints, contact the dealer from whom you purchased the appliance or our customer services.

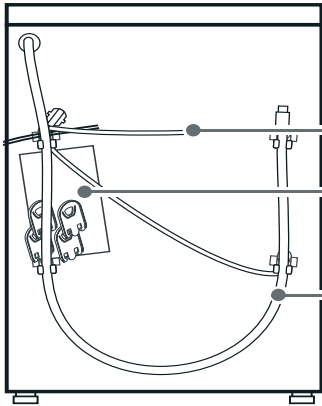

A

B

C

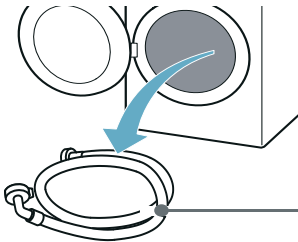

D

E

F

A Mains cable

B Bag:

- Operating and installation instructions
- Warranty
- Supplementary sheet for the operating and installation instructions*
- Bottom cover instruction*
- Home Connect Installation Guides*
- Cover caps for openings after the transport braces have been removed

C Water drain hose

D Water supply hose on standard/ Aqua-Secure models

E Screw*

F Bottom cover*

* Depending on the model

In addition

a hose clamp (24 - 40 mm diameter, available from specialist dealers) is required to connect the water drain hose to a siphon.

Useful tools

- Spirit level for aligning
- Wrench with:
 - WAF13 for loosening the transport braces, and
 - WAF17 for aligning the appliance feet

Installation

Note: Humidity in the drum is caused by the final inspection.

Safety instructions



Warning

Risk of injury!

- The appliance is very heavy. Be careful when lifting/transporting the appliance.

- When the appliance is lifted by its protruding parts (e.g. the appliance door), the components may break off and cause injuries.
Do not lift the appliance by protruding parts.
- If the hose and mains cables are not routed properly, there is a risk of tripping and injury.
Lay hoses and cables in such a way that there is no risk of tripping.

Caution!**Damage to the appliance**

Frozen hoses may rip/burst.
Do not install the appliance in areas exposed to frost or outdoors.

Caution!**Water damage**

The connection points for the water supply hose and water drain hose are under high water pressure. To prevent leaks and water damage, you must follow the instructions in this section.

Notes

- In addition to the safety information listed here, the local water and electricity supplier may have special requirements.
- If in doubt, have the appliance connected by a specialist.

Removing the foam block*

This appliance is secured with a foam block, which has to be removed before using the appliance for the first time. If in doubt, please contact specialist.

Caution!**Damage to the appliance**

If the foam block is not removed, the appliance may be damaged when it is operated.
Before using the appliance for the first time, make sure that you completely remove the foam block.

* depending on the model

Warning**Risk of injury/damage to the appliance!**

Tilting the appliance to the rear may result in injury and damage to the appliance if you accidentally drop the appliance. Do not tilt the appliance on your own and be careful.

Note: Remove the foam block first before you remove the transport locks.

1. Remove the foam block.
 - a) Tilt the appliance to the rear.

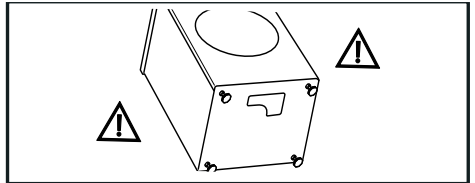

- b) Remove the foam block and bottom pad.

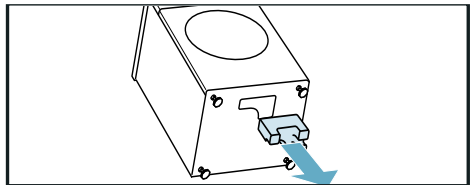
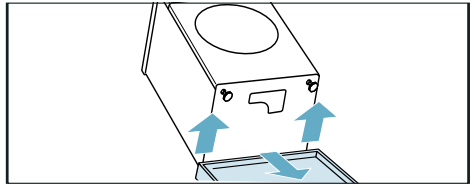

en Positioning and connecting

2. Fit the bottom cover. (You can find it in the drum)
Lock the bottom cover firmly in place by applying pressure to the snap-in hooks.

Note: If necessary, secure bottom cover with screws.

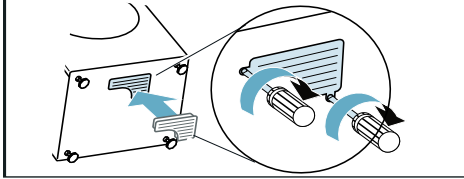

Installation surface

Note: The appliance must be stable aligned so that it does not move around.

- The installation surface must be firm and level.
- Soft floors/floor coverings are not suitable.

Installation on a base or a wooden joist floor

Caution!

Damage to the appliance

The appliance may "wander" and tip/topple from the base when spinning. The feet of the appliance must be secured with holding brackets.

Order no. WMZ 2200, WX 975600, CZ 110600, Z 7080X0.

Note: On wooden joist floors, install the appliance:

- In a corner, if possible,
- On a water-resistant wooden board (min. 30 mm thick) which is screwed tightly to the floor.

Installation on a platform with drawer*

Platform order no.: WMZ20530W, WMZ20530S, WMZ20530G.

Installing the appliance in a kitchenette

⚠ Warning

Risk of death!

There is a risk of electric shock if you touch live components.
Do not remove the appliance covering plate.

Notes

- Recess width of 60 cm required.
- Only install the appliance underneath a continuous worktop that is securely connected to adjacent cabinets.

Removing the transport locks

Caution!

Damage to the appliance

- The appliance is secured for transportation using transport locks. If the transport locks are not removed, the appliance may become damaged when it is operated.
Before using the appliance for the first time, make sure that you completely remove all four transport locks. Keep the locks in a safe place.
- To prevent transport damage from occurring if the appliance is moved at a later date, you must refit the transport locks before transporting the appliance.

Note: Keep the screws and sleeves in a safe place.

* Depending on the model

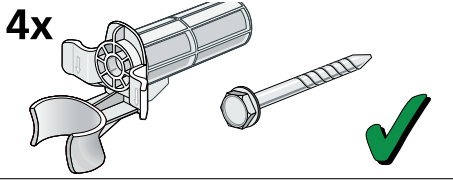

1. Take the hoses out of the holders.

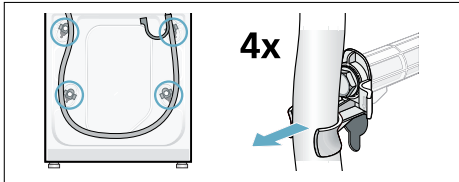

2. Unscrew and remove all four transport brace screws. Remove the sleeves. To do this, remove the mains cable from the holders.

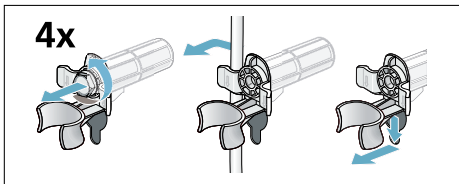

3. Fit the covers. Lock the covers firmly in place by applying pressure to the snap-in hooks.

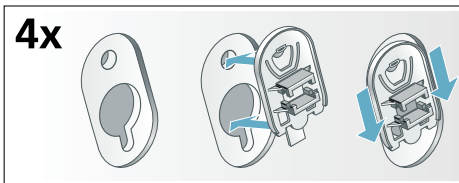

Hose and cable lengths

Connection on left side

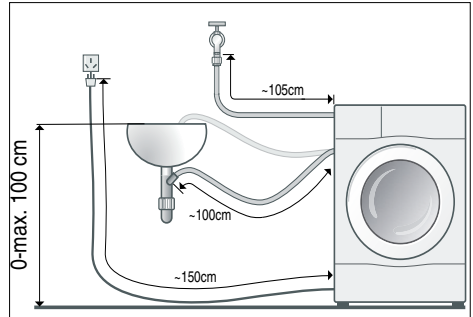

or

Connection on right side

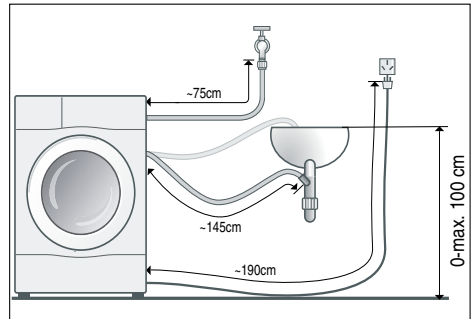

Note: If the hose holders are used, the possible hose lengths are reduced!

Available from dealer/customer service:

- Longer supply hose (approx. 2.20 m).
- Appliance's tap.

Water inlet

⚠ Warning
Risk of death!

There is a risk of electric shock if you touch live components.

Notes

- Only operate the appliance using cold mains water.
- Do not connect the appliance to the mixer tap of an unpressurised hot-water boiler.
- Do not use a used supply hose. Only use the supply hose supplied or one that was purchased from an authorised specialist retailer.
- Do not kink or squash the water supply hose.
- Do not alter (shorten, cut through) the water supply hose (otherwise its strength is no longer guaranteed).
- Only tighten the screw connections by hand. If the screw connections are tightened too much with a tool (pliers), the thread may become damaged.

Optimum water pressure in the supply network

At least 0.1 MPa (1 bar)

Maximum 1 MPa (10 bar)

Notes

- When the tap is open, the water flow rate is at least 8 l/min.
- If the water pressure is higher than this, a pressure-reducing valve must be installed.

Connection

Connect the water supply hose to the tap (26.4 mm = 3/4"):

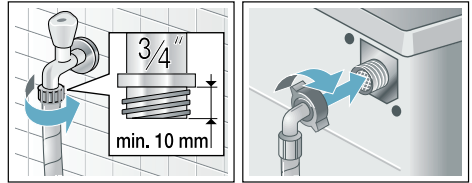

Note: Turn on the tap carefully, checking the leak tightness of the connection points. The screw connection is under mains water pressure.

Water outlet

⚠ Warning
Risk of scalding!

When you are washing at high temperatures, there is a risk of scalding if you come into contact with hot water (e.g. when draining hot water into a washbasin). Do not reach into the hot water.

Caution! Water damage

When water is being pumped away, the outlet hose is under water pressure and may slip out of the wash basin or connection point. Secure the drain hose so that it cannot slip out.

Caution! Damage to the appliance/fabrics

If the end of the drain hose is immersed in the drained water, water may be sucked back into the appliance and may damage the appliance/fabrics.

Make sure that:

- The plug does not block drainage from the washbasin.
- The end of the drain hose is not immersed in the drained water.
- The water drains away quickly enough.

Notes

- Do not kink the water drain hose or put strain on it lengthways.
- The height of water outlet placement: Minimum 0 cm ~ Maximum 100 cm.

Connection

- **Drainage into a washbasin**
Secure the outlet hose so that it cannot slip out.
Elbow available from after-sales service:
Individual part number 00655300

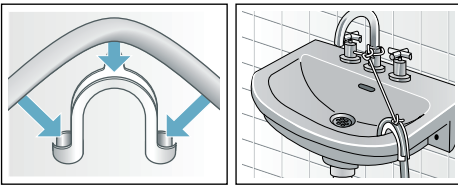

- **Drainage into a siphon**
The connection point must be secured using a hose clamp with a diameter of 24 - 40 mm (available from specialist dealers).

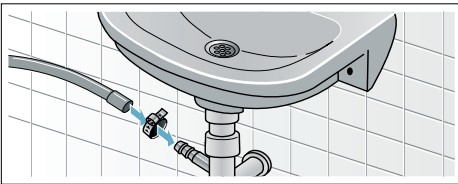

- **Drainage into a plastic pipe with rubber bushing or into a drainage pit**

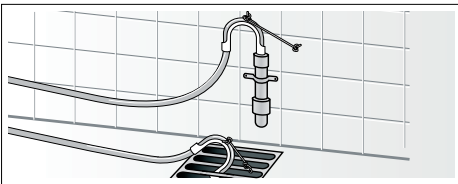

Alignment

Level the appliance using a spirit level. Incorrect levelling may result in intense noise, vibrations and "wandering".

1. Loosen the lock nuts using a wrench, by turning it in a clockwise direction.
2. Check the alignment of the appliance with a spirit level, and adjust it if necessary. Change the height by turning the appliance feet. All four appliance feet must stand firmly on the ground.
3. Tighten the lock nut against the housing.
In doing so, hold the foot tight and do not adjust its height.
The lock nuts on all four appliance feet must be screwed tightly against the housing.

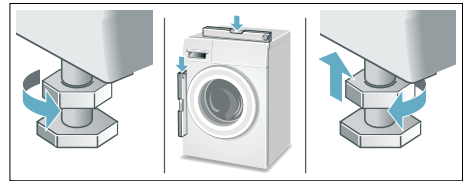

Electrical connection

Electrical safety

Warning **Risk of electric shock!**

- Risk of death if live parts are touched.
- When disconnecting the main plug, always pull the plug itself and not the cable, otherwise the cable could be damaged.
 - Never touch or hold the mains plug with wet hands.
 - Never pull out the mains plug during operation.
 - Only connect the washer dryer to an alternating current using a correctly installed earthed socket.

en Positioning and connecting

- The mains voltage must be the same as the voltage specifications on the washer dryer (appliance rating plate).
- The connected load and the required fuse are also indicated on the appliance rating plate.

Ensure that:

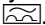
- The mains plug and socket match.
- The cable cross-section is adequate.
- The earthing system has been installed correctly.
- A damaged power cord is only replaced by an electrician. A replacement mains cable can be obtained from customer service.
- You do not use multiple plugs/ couplings or extension cables.
- If a residual-current-operated circuit breaker is used, you use only a type which features this symbol: . Only this symbol guarantees compliance with the currently valid regulations.
- The mains plug is always accessible.
- The power cord is not kinked, crushed, altered or severed and has not come into contact with any heat sources.

Before washing for the first time

The appliance was inspected thoroughly before leaving the factory. To remove any residual test water, run the **Drum clean** programme the first time **without** laundry.

Note:

- The appliance must have been installed and connected properly. → "Positioning and connecting" on page 14
- Never switch on a damaged appliance.

1. Insert mains plug.
2. Turn the water tap on.

3. Press the ① button till the indicator lamp lights up, release the button. The appliance is switched on.
4. Close the door. Do not load any laundry.
5. Select the **Drum clean 90° C** programme.
6. Open the detergent drawer.
7. Pour approx. 1 litre of water into dispenser **II**.
8. Add standard detergent to dispenser **II** according to manufacturer's instructions for light soiling.
Note: To prevent over sudsing, use only half the recommended amount of detergent. Do not use any woollens or mild detergents.
9. Close the detergent drawer.
10. Select ▷|||.
11. When the programme ends, press the ① button till the indicator lamp turns off, release the button.

Your appliance is now ready for use.

Transportation

e.g. when moving home

Preparatory work:

1. Turn off the water tap.
2. Reduce the water pressure in the supply hose. → Page 47
3. Drain any residual water. → Page 46
4. Disconnect the appliance from the mains.
5. Remove the hoses.
6. Empty the dispensers. and → "Cleaning the measuring aid A for liquid detergent" on page 46

Installing the transport locks:

1. Remove the covers and keep them in a safe place.
Use a screwdriver if necessary.

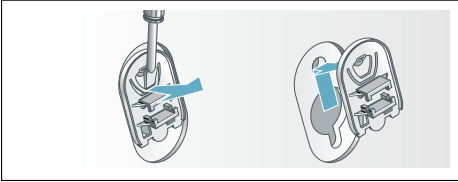

2. Insert all four sleeves.
Clip the mains cable securely in the holders. Insert and tighten the screws.

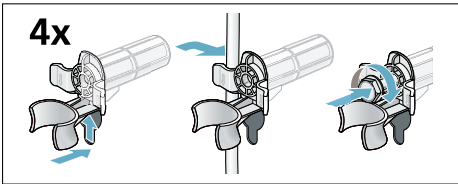
**Before switching on the appliance again:****Notes**

- The support struts **must** be removed.
- The transport braces **must** be removed.
→ "Removing the transport locks" on page 16
- Pour approx. 1 litre of water into compartment II, select the **Rinse** programme or **Spin** and start.
This will prevent detergent from flowing straight into the drain during the next wash.

Getting to know the appliance

Appliance

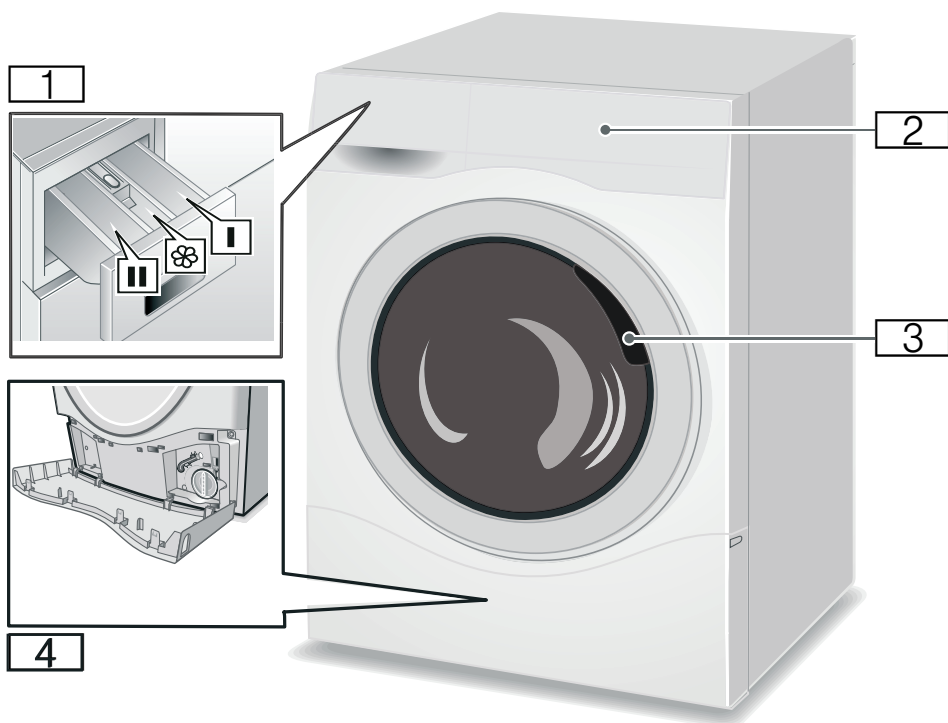

- 1 Detergent drawer
- 2 Operating/display panel
- 3 Loading door
- 4 Service flap

Control panel

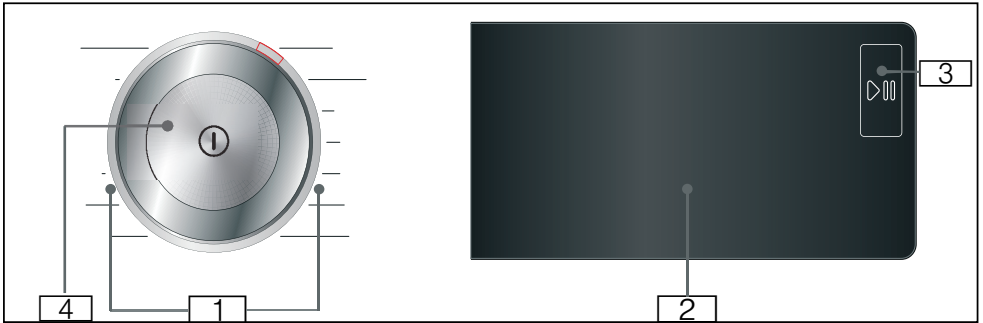

- 1 Programmes that can be selected.
- 2 Touch-Display
- 3 Start/Pause button
Touch ▷|| button to start, interrupt (e.g. reload washing) and cancel the programme.
- 4 Power button
Press the ⓘ button to switch the appliance on/off.

Touch-Display

Caution!

Material damage/damage to the appliance.

Exerting excessive pressure on the display may damage it. Do not use a sharp object on the display or exert excessive pressure on it.

Note: The display on this appliance responds to touch (touch display). You can activate settings by touching lightly on the touch-sensitive buttons in boxes. The activated settings are illuminated particularly brightly to highlight them on the display. You can change or deactivate the activated settings by repeatedly touching on the relevant buttons on the display.

Programme default settings

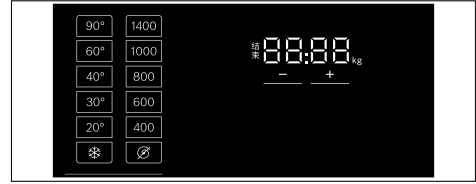

Display	Setting	Description
* - 90°	Temperature	Temperature that can be set in °C * = cold
∅ - 1400*	Spin speed	Spin speed in rpm (revolutions per minute) ∅ = No spin
2:30*	Programme remaining time	Programme remaining time depends on the programme selection in h:min (hours:minutes)
0.5 - 24 h	"Finish in" time	Programme ends after ... h (h = hours)
10.0* kg	Maximum load	Recommended load in kg
* Depending on the selected model and programme.		





Additional programme settings

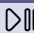

Display	Setting
油渍 / 汗渍 / 血渍 / 泥渍	油渍 / 汗渍 / 血渍 / 泥渍 (Stains)
浸泡	浸泡 (Soaking)
加漂洗	加漂洗 (Rinse plus)
提速	提速 (speedPerfect)
节电	节电 (ecoPerfect)
除菌液	除菌液 (Disinfectant)
高水位	高水位 (Water plus)
轻松熨	轻松熨 (Easy iron)
记忆	记忆 (Memory)
夜间	夜间 (Silent wash)
	Remote start → Page 34 and Home Connect settings

Status indicators for the programme progress (programme sequence)



Display	Setting
	Start/Pause button
	Pretreatment
	Wash
	Rinse
	Spin/Drain
End	Programme end

Further settings

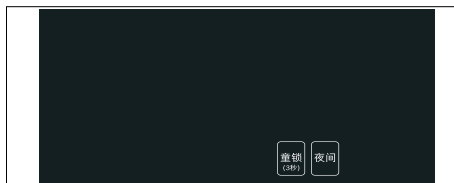

Display	Setting/Description
童锁 (3秒)	Childproof lock: To prevent the set functions from being changed accidentally: To do so, touch and hold 童锁 (3秒) button for approx. 3 seconds. → Page 37
夜间	Basic settings → Page 43



Laundry







Protecting your laundry and appliance

Caution! Damage to the appliance/textiles

Foreign objects (e.g. coins, paper clips, needles, nails) may damage the washing or components of the appliance.

The following instructions must be observed when preparing your laundry:

- Always follow the manufacturer's instructions when dosing all detergents, cleaning aids, care products and cleaning agents.
- Do not exceed maximum load. Overfilling will impair the washing result.

- Keep detergents and agents for the pretreatment of laundry (e.g. stain remover, prewash sprays, etc.) away from the surfaces of the appliance. Using a damp cloth, immediately remove any fine spray residue and other residue or droplets.
 - Empty any pockets. Remove any foreign objects.
 - Remove metal parts (paper clips, etc.).
 - Trousers, knitwear and knitted textiles, e.g. jersey garments, T-shirts or sweatshirts, should be turned inside out.
 - Ensure that underwired bras are appliance-washable.
 - Wash delicates in a net or bag (tights, underwired bras, etc).
 - Close zips, button up covers.
 - Brush sand out of pockets and collars.
 - Remove curtain fittings or place in a net/bag.
- **Stains:** Remove/pretreat stains while they are fresh. First dab with soapy water; do not rub. Then wash the items of laundry with the appropriate programme. Stubborn or dried-in stains can sometimes only be removed by washing several times.
 - Symbols on the care labels
 -  Suitable for normal washing process;
e.g. Cottons programme
 -  A gentle washing process is required;
e.g. Synthetics programme
 -  An especially gentle washing process is required;
e.g. Delicates programme
 -  Suitable for washing by hand;
e.g.  Wool programme
 -  Do not machine wash.

Sorting laundry

Sort your laundry according to the care instructions and manufacturer's information on the care labels, depending on:

- Type of fabric/fibre
- Colour

Note: Laundry may discolour. Wash white and coloured items separately. Wash new coloured items separately the first time you wash them.
- Soiling

Wash laundry with the same level of soiling together.
Some examples of soiling levels can be found in the chapter



 - **Light:** Do not need to pretreat, select the **提速 (speedPerfect)** setting if necessary.
 - **Normal**
 - **Heavy:** Load less laundry, need to pretreat or soak laundry firstly.

Overview of programmes

Selectable programme

Programme/Type of washing	Options/Information
Name of the programme Brief explanation of the programme and for which fabrics it is suitable.	Max. load* as kg selectable temperature** as °C selectable spin speed** in rpm possible programme settings and options** softener
Cottons Hard-wearing fabrics, heat-resistant fabrics made of cotton or linen.	Max. 10.0 kg/5.0*** kg ✱ - 90 °C 400 - 1400 rpm 节电, 提速, 除菌液, 高水位, 轻松熨, 夜间, 记忆, 浸泡, 加漂洗, 油渍, 汗渍, 血渍, 泥渍 possible
Mix Mixed load of cottons and synthetic fabrics.	Max. 4.0 kg ✱ - 40 °C 400 - 1400 rpm 节电, 提速, 除菌液, 高水位, 轻松熨, 夜间, 记忆, 浸泡, 加漂洗, 油渍, 汗渍, 血渍, 泥渍 possible
Synthetics Textiles made of synthetic materials or blended fabrics.	Max. 4.0 kg ✱ - 60 °C 400 - 1000 rpm 节电, 提速, 除菌液, 高水位, 轻松熨, 夜间, 记忆, 浸泡, 加漂洗, 油渍, 汗渍, 血渍, 泥渍 possible
* max. load according to GB12021.4. ** depending on the model and the programme. *** reduced load with 提速 (speedPerfect).	

Programme/Type of washing	Options/Information
Delicates For delicate, washable fabrics, e.g. made of silk, satin, synthetic fibres or blends (e.g. silk blouses, silk scarves).	Max. 2.0 kg
	* - 40 °C
	⌀ - 800 rpm
	节电, 提速, 高水位, 轻松熨, 夜间, 记忆, 浸泡, 加漂洗, 油渍, 汗渍, 血渍, 泥渍
	possible
Rinse For rinsing with a subsequent spin cycle.	-
	-
	⌀ - 1400rpm
	高水位, 轻松熨, 夜间, 记忆, 加漂洗
Spin For spinning with a selectable spin speed and subsequent draining.	-
	-
	⌀ - 1400 rpm
	轻松熨, 夜间, 记忆
APP Selection of additional programmes via Home Connect app. → "Selecting additional programmes" on page 35	depending on selected programme
* max. load according to GB12021.4. ** depending on the model and the programme. *** reduced load with 提速 (speedPerfect).	

Programme/Type of washing	Options/Information
Drum clean Special program for drum hygiene or fluff removal. Do not load any laundry. 90 °C = antibacterial program. 40 °C = antibacterial program, special drum cleaning detergent can be used. * = no antibacterial programme, to remove hair or fluff from the tub. The symbol  (memory function, drum care) flashes if you have not used any programme at a temperature of 60 °C or higher for an extended period.	Max. 0.0 kg *, 40 °C, 90 °C - 夜间, 记忆 not possible
Notes <ul style="list-style-type: none"> ■ Switching the drum-clean information signal on/off. ■ Always follow the manufacturer's instructions when dosing the detergent. 	
 Wool Hand- or appliance-washable fabrics that are made of wool or contain wool; particularly gentle wash programme to prevent laundry from shrinking, with longer pauses in the programme (during which the items rest in the water).	Max. 2.0 kg * - 40 °C ♂ - 800 rpm 夜间, 记忆 possible
Down Appliance-washable fabrics stuffed with down, such as pillows and duvets; also suitable for items stuffed with synthetic fibres	Max. 2.0 kg * - 60 °C 400 - 1000 rpm 节电, 提速, 高水位, 记忆, 加漂洗 not possible
Outdoor+ Weatherproof and outdoor clothing with membrane coating and water-resistant textiles.	Max. 1.0 kg * - 40 °C 400 - 800 rpm 节电, 提速, 高水位, 夜间, 记忆, 加漂洗, 油渍, 汗渍, 血渍, 泥渍 not possible
* max. load according to GB12021.4. ** depending on the model and the programme. *** reduced load with 提速 (speedPerfect).	

Programme/Type of washing	Options/Information
<p>Babycare</p> <p>Suitable for washing soiled babies / kids clothes made of cotton, effectively removing bacteria.</p>	<p>Max. 6.5 kg</p> <p>* - 60 °C</p> <p>400 - 1400 rpm</p> <p>节电, 提速, 除菌液, 高水位, 轻松熨, 夜间, 记忆, 浸泡, 加漂洗, 油渍, 汗渍, 血渍, 泥渍</p> <p>possible</p>
<p>Super 15'</p> <p>Extra-short programme of approx. 15 minutes, suitable for small items of lightly soiled laundry.</p>	<p>Max. 2.0 kg</p> <p>* - 40 °C</p> <p>400 - 1000 rpm</p> <p>夜间, 记忆</p> <p>possible</p>
<p>MyTime</p> <p>Mixed fabrics; for lightly soiled laundry made of cotton and synthetics.</p> <p>The length of the wash programme can be set each time. The maximum programme length is 60 minutes and it can be reduced in 10-minute increments.</p> <p>Notes</p> <ul style="list-style-type: none"> ■ Increase the length of the wash programme-load with 加漂洗 (Rinse plus) programme additional setting. ■ The Finish in programme default setting can not be selected for this programme. 	<p>Max. 2.0 kg</p> <p>* - 40 °C</p> <p>400 - 1000 rpm</p> <p>高水位, 轻松熨, 夜间, 记忆, 加漂洗</p> <p>possible</p>
<p>* max. load according to GB12021.4.</p> <p>** depending on the model and the programme.</p> <p>*** reduced load with 提速 (speedPerfect).</p>	

P+ Programme default settings

You can change the default settings for selected programmes. The settings can be changed even while the selected programme is running. The effects depending on the progress of the programme.

Temperature

(°C)

Depending on what stage the programme is in, you can change the temperature before and during the programme.

The maximum temperature that can be set depending on the model and the programme that has been selected.

Spin speed

(⊖)

Depending on what stage the programme is in, you can change the spin speed (in rpm; revolutions per minute) before and during the programme by adjusting the desired speed on the display.

setting ⊗: ⊗="No spin". The water is only drained.

You can select "No spin" to prevent creasing if the laundry will not be taken out of the appliance immediately after the programme has ended.

The maximum speed that can be set depending on the model and the programme that has been selected.

Finish in

(结束)

Before starting the programme, you can preselect the programme end ("Finish in" time) in 0.5h increments (h = hour) up to a maximum of 24 hours.

To do this:

1. Select a programme (except **MyTime** programme).
The programme duration is displayed for the selected programme, e.g. **2:30** (hours: minutes).
2. Select the **+** button repeatedly until the required number of hours is displayed.
Note: The setting values are increased using the **+** button, and decreased using the **-** button.

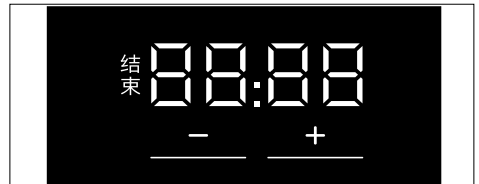

3. Select the **▷|||** button.
The programme starts.
The selected number of hours (e.g. **8h**) is shown in the display panel and counts down until the programme starts. The duration of the programme is then displayed.

Note: The length of the programme is automatically adjusted when the programme is running. Changes to the programme default settings or programme additional settings may also change the programme duration.

After starting the programme (if a Finish in time has been selected and the programme has not yet started), you can change the preselected number of hours as follows:

1. Select the **▷|||** button.
2. Touch the **+** or **-** button to change the number of hours.
3. Select the **▷|||** button.

P+ Additional programme settings

Note: You can find possible additional programme settings in the overview; these differ depending on the model.

By selecting additional programme settings, you can better adapt the washing process to your items of laundry.

The settings can be selected or deselected depending on the progress of the programme.

The button indicator lamps light up if a setting is activated.

The settings are not retained after the appliance is switched off.

提速 (speedPerfect)

(提速)

Washing in a shorter time while achieving a washing result that is consistent with, but uses more energy than the selected programme without the **提速 (speedPerfect)** setting.

Note: Do not exceed the maximum load.

节电 (ecoPerfect)

(节电)

Energy-optimised washing by reducing the temperature while achieving a washing result that is consistent with the selected programme without the **节电 (ecoPerfect)** setting.

除菌液 (Disinfectant)

(除菌液)

For washing with special disinfectants in order to kill bacteria and thereby meet high standards of hygiene

Note: Add disinfectant to dispenser II.

高水位 (Water plus)

(高水位)

Increased water level, gentler treatment of the laundry.

轻松熨 (Easy iron)

(轻松熨)

Reduces creasing thanks to a special spin sequence followed by fluffing and reduced spin speed.

Note: The washing's residual moisture is increased.

油渍 / 汗渍 / 血渍 / 泥渍 (Stains)

(油渍 / 汗渍 / 血渍 / 泥渍)

Types of stain that can be selected:

油渍	Grease and oil
汗渍	Khan stains
血渍	Blood stains
泥渍	Mud stains

Do not let stains dry. Remove solid substances beforehand.

Select a programme with a stain type:

1. Arrange items of washing as usual.
2. Select a programme.
3. Select a stain type (depending on the selected programme).
4. Start the programme.

The appliance adjusts the average washing temperature, drum movement and soaking time to the specific type of stain. Hot or cold water, gentle or intensive washing and long or short soaking ensure that the wash programme sequence is specially adapted to each type of stain. This makes sure that stains are treated in the best possible way.

浸泡 (Soaking)

(浸泡)

Before the main wash cycle starts, the washing remains for longer in the water to partially dissolve intensive soiling.

10'	10 minutes
20'	20 minutes
30'	30 minutes

Notes

- Put detergent in dispenser **II** before starting the appliance.
- Load laundry of the same colour.

加漂洗 (Rinse plus)

(加漂洗)

Settings that can be selected:

+1	+ 1 rinse cycle
+2	+ 2 rinse cycles
+3	+ 3 rinse cycles

Additional rinse cycles for particularly sensitive skin and/or for areas with very soft water.

Longer programme duration, due to additional rinse cycle.

The number of rinse cycles that the programme actually runs depends on the number that is set as a basic setting for the programme.

记忆 (Memory)

(记忆)

You can save a selected programme with your favourite settings here.

To store:

1. Switch on the appliance.
2. Select a programme.
3. If required, change the programme default settings and/or select programme additional settings.
4. Touch and hold **记忆** button for approx. three seconds.

The programme is saved if all of the settings flash briefly.

To use the saved programme, touch **记忆** button briefly after you switch on the appliance.

To change the saved programme, touch and hold **记忆** button again for approx. three seconds after selecting the new settings.

夜间 (Silent wash)

(夜间)

Reduced noise values thanks to special wash and spin cycle and deactivated end signal. Especially suitable for washing at night.

Note: Residual moisture of the washing is slightly increased. The spin result is may not satisfactory. You can select **Spin** programme before hanging.

(Remote start)

Touching  allows you to start the programme remotely via the Home Connect app or to call up the Home Connect settings.

Enabling the programme to be started remotely via the Home Connect app:

Note: Remote start can only be activated if the appliance door is closed and the appliance is connected to your home network.

- Briefly touch .

Note: Remote start will be deactivated for safety reasons in the following circumstances:

You open the door.

There is a power failure.

Once the programme has ended.

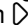
If you touch  on the appliance.

If you briefly touch  again.

If you press  to switch off the appliance.

Calling up Home Connect settings:

- Touch and hold  for at least 3 seconds.

Operating the appliance

Preparing the appliance

The appliance was tested before delivery. To remove residual water from the test procedure, the first wash cycle should be run without laundry using the **Drum clean** programme.

→ "Before washing for the first time"
on page 20

Notes

- Never switch on a damaged appliance!
- Inform customer service!

1. Insert mains plug.

Warning

Risk of death from electric shock!

Risk of death if live parts are touched.

- Never pull out the mains plug by tugging the power cord.
- Insert/pull out the mains plug with dry hands only.

2. Turn the tap on.

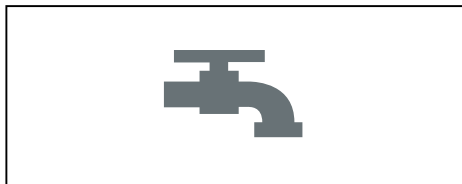

3. Open the appliance door.

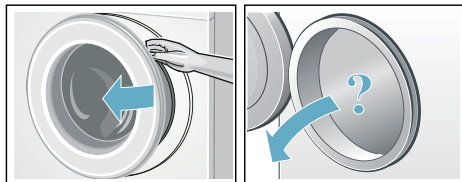

Switching on the appliance/ selecting a programme

Press the  button till the indicator lamp lights up, release the button. The appliance is switched on.

The **Cottons** programme, which is preset at the factory, is then always displayed.

You can use this programme or select a different programme.

Note: If you have activated the childproof lock, you must deactivate it before you can set a programme.

Presettings and maximum load are indicated on the Touch-Display for the selected programme.

You can use the displayed presettings or adjust the selected programme optimally to the items of washing by changing the → "Programme default settings" on page 31 and/or selecting → "Additional programme settings" on page 32.

Selecting additional programmes

You can select additional programmes via Home Connect app.

1. Connect the appliance to your home network and the Home Connect app.
2. Select **APP** programme.
APP appears on the display panel.
Note: You can select the programmes directly via the Home Connect app.
3. Select the desired programme on the Home Connect app.
The settings of the selected programme appear on the display.

4. If necessary, adjust programme settings and touch the  button.

Note: You can start the programme also via Home Connect app by touching briefly  button on the appliance before.

Placing laundry into the drum

Insert the washing.

Close the door.

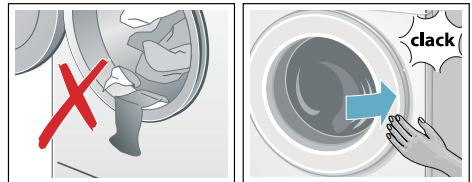

Notes

- Unfold and load presorted items of washing. Mix large and small items. Washing items of different size distribute themselves better during the spin cycle. Individual items of washing may cause an unbalanced load.
- Observe the maximum specified load. Overfilling adversely affects the washing result and promotes creasing. Make sure that no items of laundry are trapped between the door and the rubber seal, and close the door.

Measure and add detergent and care products

Caution!

Damage to the appliance!

Detergents and agents for the pretreatment of laundry (e.g. stain remover, prewash sprays, etc.) may damage the surfaces of the appliance. Keep these agents away from the surfaces of the appliance. Using a damp cloth, immediately remove any fine spray residue and other residue or droplets.

Dosing

Dose the detergents and care products according to:

- water hardness (ask your water supply company),
- the manufacturer's specifications on the packaging,
- the amount of laundry,
- soiling.

Filling the dispensers

1. Pull out the detergent drawer.



Warning

Eye / skin irritation!

If the detergent drawer is opened while the appliance is running, detergent or care product may run out.

Open the drawer carefully.

If detergent or care product comes into contact with eyes or skin, rinse thoroughly.

If accidentally swallowed, seek medical advice.

2. Pour in detergent and/or cleaning product.

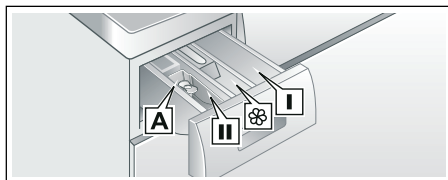

- | | |
|---|---|
| Dispenser I | Clothing disinfectant. (Disinfectant additional programme setting or Disinfectant programme is selected only.) |
| Dispenser  | Softener. Do not exceed the maximum load. |
| Dispenser II | Detergent for main wash, liquid detergent. |
| Measuring aid A * | For dosing liquid detergent. |

* Depending on the model

Notes

- Dilute viscous fabric softener and fabric conditioner with water. This will prevent blockages.
- Be careful when opening the detergent drawer while the appliance is running.

Measuring aid A* for liquid detergent

* Depending on the model

Position the measuring aid for measuring the correct amount of liquid detergent:

1. Pull out the detergent drawer. Insert the liquid detergent container into dispenser **II** for main wash.
2. Pour liquid detergent into liquid detergent container and do not exceed the Maximum mark.

3. Reinsert the drawer.

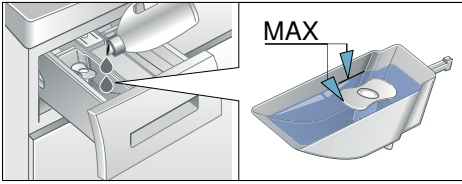

Note: Do not use the viscous liquid detergent.

Starting the programme

Touch and hold  button for 1~2 seconds, then release the button. The programme starts and the appliance door is locked.

The **Finish in** time is shown in the Touch-Display and counts down until the programme starts. After the programme has started, the programme duration is displayed. And the displays for the programme's progress light up. → "Touch-Display" on page 24

Note: Foam detection

If the symbol  also lights up in the Touch-Display, the appliance has detected too much foam during the wash cycle and automatically activated additional rinse cycles to remove the foam.

If you want to lock the programme to prevent it from being adjusted inadvertently, you can select the childproof lock.

Childproof lock

(童锁 (3 秒))

You can lock the appliance to prevent the functions you have set from being changed inadvertently. To do this, activate the childproof lock.

Touch and hold the 童锁 (3 秒) button to **activate/deactivate** the childproof lock.

To activate the childproof lock:

After the programme starts, Touch and hold the 童锁 (3 秒) button for 3 seconds.

- 童锁 (3 秒) lights up: The childproof lock is activated.
- 童锁 (3 秒) flashes: If a button is touched while childproof lock is activated, the 童锁 (3 秒) button will flash.

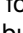
Note: When the programme ends, **End** is displayed. The door is locked. 童锁 (3 秒) and  remain on to remind you to deactivate the childproof lock.

To deactivate the childproof lock:



Touch and hold the 童锁 (3 秒) button until the 童锁 (3 秒) indicator lamp is off.

Adding/removing laundry

After starting the programme, you can add or remove laundry if necessary.

Touch the  button. The appliance checks whether reloading is possible.

If the following appears on the Touch-Display:

- The symbol  disappears, reloading is possible.
- The symbol  lights up, reloading is not possible.

To continue the programme, touch the  button. The programme continues automatically.

Notes

- Do not leave the door open for too long when adding laundry as water from the laundry may leak out.
- For safety reasons, the door remains locked when the water level or temperature is high, or while the drum is turning, and it is not possible to add laundry during this time.

Changing the programme

If you have started the wrong programme by mistake, you can change the programme as follows:

1. Touch the ▷||| button.
2. Select another programme.
3. And touch the ▷||| button again. The new programme starts from the beginning.

Cancel the programme

For programmes at high temperatures:

1. Touch the ▷||| button.
2. To cool down laundry: Select **Rinse**.
3. Touch the ▷||| button.

For programmes at low temperatures:

1. Touch the ▷||| button.
2. Select **Spin**.
3. Touch the ▷||| button.

Programme end

End lights up on the Touch-Display and ▷||| and Ⓢ are off.

Removing laundry/switching off the appliance

1. Press the Ⓢ button till the indicator lamp turns off, release the button. The appliance is switched off.
2. Open the door and remove the laundry.
3. Turn off the water tap.

Note: Not required for Aqua-Stop models.

Notes

- Do not leave any items of laundry in the drum. They may shrink in the next wash or discolour another item.
- Remove any foreign objects from the drum and the rubber seal – risk of rusting.

- Wipe the rubber seal dry.



- Leave the door and detergent drawer open so that any residual water can evaporate.
- Always wait until the programme ends, as the appliance could still be locked. Then switch the appliance on and wait for it to unlock.



Home Connect

This appliance is Wi-Fi-capable and can be remotely controlled using a mobile device.

You can use the Home Connect app to do the following on your appliance from your mobile device:

- Set up programs and launch them.
- Adjust, activate and deactivate program settings.
- Query the status of programs.
- Adjust, activate and deactivate appliance settings.
- Switch off the appliance.

Before you can use the Home Connect functions, you will need to carry out the following steps:

1. Install the Home Connect app on your mobile device.
2. Register in the Home Connect app.
3. Connect your appliance to your home network automatically **or** manually (you only need to do this the first time).
4. Connect your appliance to the Home Connect app.

You can find information about the app on our Home Connect website www.home-connect.com

Home Connect services are not available in every country. The availability of the Home Connect function depends on the availability of Home Connect services in your country. You can find information on this at: www.home-connect.com

Notes

- Please observe the safety precautions in this instruction manual and make sure that these are complied with even when operating the appliance via the Home Connect app while you are away from home. You must also follow the instructions in the Home Connect app.
- You cannot use the Home Connect app to make changes while the controls on the appliance are being operated. However, you can use the Home Connect app to see any adjustments made directly on the appliance itself.

Calling up the Home Connect menu

In the Home Connect menu, you can create and view network connections, reset network settings, activate/deactivate Wi-Fi and find other Home Connect functions.

1. Switch on the appliance.
 2. Press and hold **Remote start**  for at least 3 seconds.
HiFi appears in the display.
- You are now in the Home Connect menu.

Note: Briefly press **Remote start**  to exit the Home Connect menu.

Connecting to the home network and the Home Connect app

Connect your appliance to the home network **automatically** or **manually** (you only need to do this the first time).

Notes

- If your home network router has a WPS function, you can connect the appliance to your home network automatically.
- If your home network router does not have a WPS function, you need to connect the appliance to your home network manually.

You must then connect to the Home Connect app.

Note: To connect your appliance to the home network, **Wi-Fi** must be activated on the appliance. **Wi-Fi** is deactivated on the appliance by default and is activated automatically when you connect your appliance to your home network.

Connecting to your home network automatically

Step 2.1

Ensure that you are in the Home Connect menu. → Page 39

1. Press **Connect to network**.

The appliance now attempts to connect to your home network.  flashes in the display.

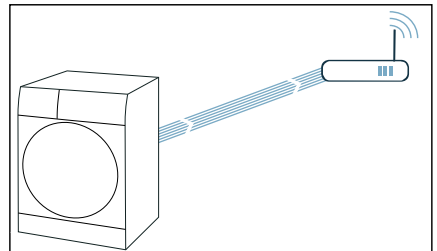

2. Activate the WPS function on your home network router within the next 2 minutes.

If the appliance has connected to your home network successfully, **Your home appliance is connected to your home network.** and  appear in the display and light up continuously.

Note: If you are not able to establish a connection, check whether your appliance is within range of your home network. Try connecting automatically again or connect your appliance manually.

Connecting to your home network manually

Step 2.2

Ensure that you are in the Home Connect menu. → Page 39

Make sure that you have opened the Home Connect app and are logged in.

1. Set the programme to position 2.

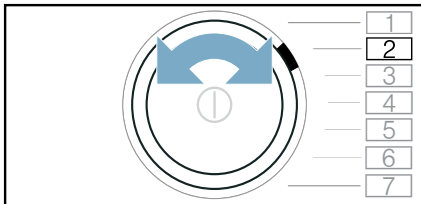

SRP (connect manually) appears in the display.

2. Press **Connect to network**.
The appliance now sets up its own Wi-Fi network with the name (SSID) **HomeConnect**.

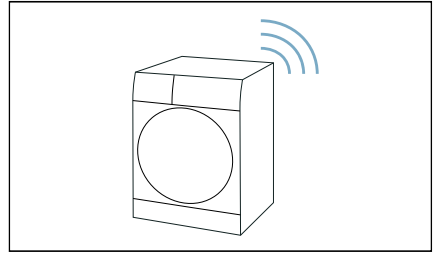

3. Call up the Wi-Fi setting on the mobile device.
4. Connect the mobile device to the **Home Connect Wi-Fi network** and enter the password (key) **HomeConnect**.
Your mobile device now connects to the appliance. The connection process may take up to 60 seconds.

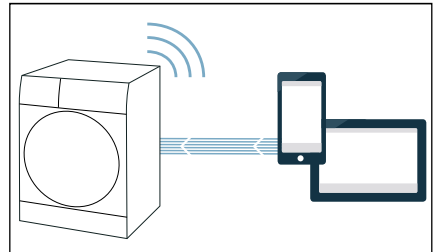

5. Once you have connected successfully, open the Home Connect app on your mobile device and carry out the steps in the app.
6. In the Home Connect app, enter the network name (SSID) and password (key) for **your home network**.
7. Carry out the last steps in the Home Connect app to connect your appliance.

If the appliance has connected to your home network successfully, **Your home appliance is connected to your home network.** and  appear in the display and light up continuously.

Note: If you are not able to establish a connection, check whether your appliance is within range of your home network. Try connecting manually again.

Connecting to the Home Connect app

Step 3

If your appliance is connected to your home network, you can connect it to the Home Connect app.

Ensure that you are in the Home Connect menu. → Page 39

Make sure that you have opened the Home Connect app and are logged in.

1. Set the programme to position 3.

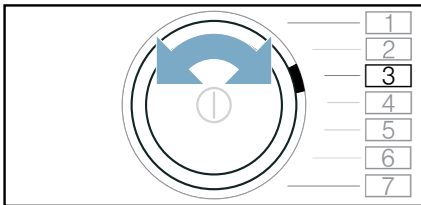

APP (connect to app) appears in the display.

2. Press **Connect with app**.

The appliance now attempts to connect to the Home Connect app.

3. Once your appliance is displayed in the app, carry out the last steps in the Home Connect app.

Note: If you were not able to establish a connection, check whether your mobile end device is within range of your home network or is connected to this. Try connecting to the Home Connect app again.

Activating/deactivating Wi-Fi

If your appliance is already connected to your home network, you can activate or deactivate **Wi-Fi** on your appliance.

Ensure that you are in the Home Connect menu. → Page 39

1. Set the programme to position 4.

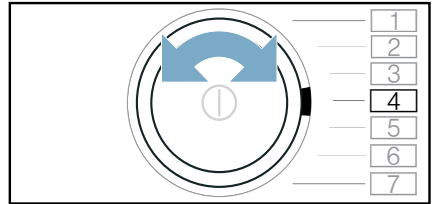

Wi-Fi appears in the display.

2. Press **Wi-Fi**.

If **Wi-Fi** appears in the display, Wi-Fi is activated on the appliance. If **Wi-Fi** appears in the display, Wi-Fi is deactivated on the appliance.

Notes

- If you connect to your home network, Wi-Fi is activated automatically.
- If Wi-Fi is activated, the appliance will not switch itself off automatically.
- If Wi-Fi is switched off on the appliance, it is not possible to use the Home Connect app to start or control the appliance remotely.
- If Wi-Fi is switched off and your appliance was previously connected to your home network, this connection will be re-established automatically when Wi-Fi is switched back on.
- If you activate this function, the energy consumption increases in comparison to the values specified in the consumption value table.

Note: Ensure that the Home Connect functions can be used only in conjunction with the Home Connect app. Information on data protection can be accessed in the Home Connect app.

Declaration of Conformity

Robert Bosch Hausgeräte GmbH hereby declares that the appliance with Home Connect functionality meets the basic requirements and other relevant provisions of the Directive 2014/53/EU.

A detailed RED Declaration of Conformity can be found online at www.bosch-home.com among the additional documents on the product page for your appliance.



2.4 GHz band: max. 100 mW

Appliance settings

Automatic switch-off

If the appliance is not operated for approx. 5 minutes (depending on the water level inside of appliance), it will automatically switch off before the programme starts or after the programme has ended. Press the power button ① again to switch on the appliance.

Note: If Wi-Fi is switched on at the appliance, when it is in Energy saving mode, the appliance will not automatically switch itself off.

Basic settings

To access the basic settings, touch and hold the 夜间 button for approx. 3 seconds. The control panel show:

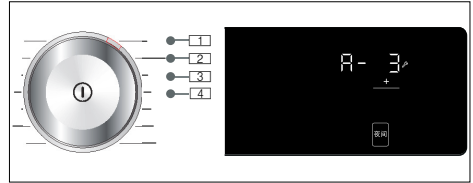

You can change the following basic settings:

- [1]: The volume of the end signal.
- [2]: The volume of the buttons.
- [3]: The brightness of the Touch-Display.
- [4]: Switching the drum care information signal on/off.

End signal

Touch and hold the 夜间 button for approx. 3 seconds. The indicator lamp in position 1 is on. You can use the + button to adjust the volume of the end signal, e.g. A-3.

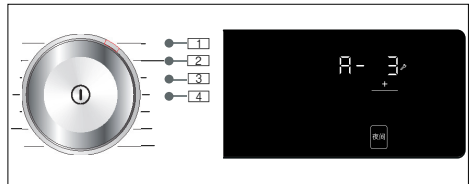

Possible setting values:

- 0 off
- 1 quiet
- 2 medium
- 3 loud
- 4 very loud

Button signal

You can select position **2** and use the + button to adjust the volume of the button signal, e.g. **b- 3**.

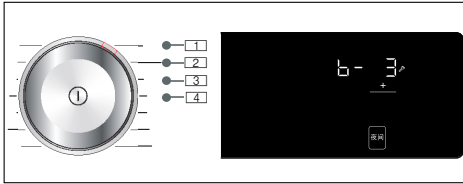

Possible setting values:

- 0 off
- 1 quiet
- 2 medium
- 3 loud
- 4 very loud

Brightness

Possible setting values: 1 - 4

You can select position **3** and use the + button to adjust the brightness of the Touch-Display, e.g. **[- 3**.

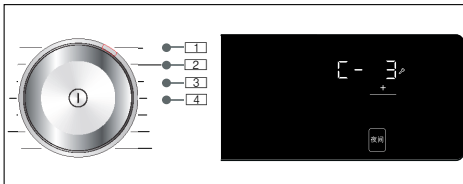

Possible setting values:

- 1 not very bright
- 2 normal level of brightness
- 3 bright
- 4 very bright

Switching the drum-care information signal on/off

You can select position **4** and use the + button to switch the **Drum clean** information signal on or off, e.g. **d- 1**.

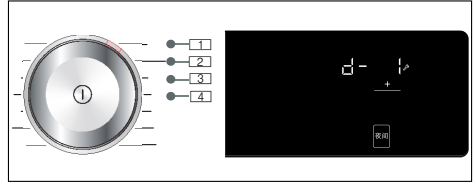

Possible setting values:

- 0 off
- 1 on

Sensors

Unbalanced load detection system

The automatic unbalanced load detection system detects imbalances and ensures even distribution of the laundry by repeatedly starting and stopping drum spinning.

If the laundry is extremely unevenly distributed, the spin speed is reduced or the spin cycle is not performed for safety reasons.

Note: Place large and small items of laundry evenly in the drum.



Cleaning and maintenance

Warning

Risk of death!

There is a risk of electric shock if touch live components.

Press the button  and pull out the mains plug.

Caution!

Fire and explosion hazard!

Toxic vapours can be produced by cleaning agents that contain solvents, e.g. cleaning solvent.

Do not use cleaning agents that contain solvents.

Caution!

The appliance may be damaged!

Cleaning agents that contain solvents, e.g. cleaning solvent, can damage surfaces and components in the appliance.

Do not use cleaning agents that contain solvents.

Appliance housing/control panel

- Remove the detergent residue immediately.
- Wipe the housing and the control panel with a soft, damp cloth.
- Do not use abrasive cloths, sponges or detergents (stainless steel cleaner).
- Do not clean the appliance with a water jet.

Drum

Warning

Risk of injury/material damage/ damage to the appliance!

Permanently washing at low temperatures and a lack of ventilation for the appliance may damage the drum and cause injury.

Regularly run a programme for cleaning the drum or wash at temperatures of at least 60°C.

Leave the appliance to dry after every operation with the door open, and leave the detergent drawer to dry.

Use chlorine-free cleaning agents, do not use steel wool.

If there are odours in the appliance, or to clean the drum, run the **Drum Clean 90°C** programme without laundry.

Descaling

Descaling should not be necessary if the detergent is measured out correctly.

However, if it is required, follow the manufacturer's instructions for the descaling agent. Suitable descalers can be obtained via our website or from customer services.

Detergent drawer and housing

If the appliance contains detergent or fabric softener residues:

1. Pull out the detergent drawer. Press down the insert and fully remove the drawer.
2. To remove the insert: Push the insert upwards from below with your finger.

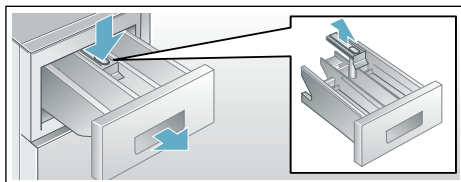

3. Clean the detergent dispenser tray and insert with water and a brush, and dry it. Clean the inside of the housing as well.
4. Fit the insert and lock it in place (push the cylinder onto the guide pin).
5. Push in the detergent drawer.

Note: Leave the detergent drawer open so that any residual water can evaporate.

Cleaning the measuring aid A* for liquid detergent

If it contains liquid detergent residue:

1. Hold the measuring aid, pull the cover upward and disconnect them.

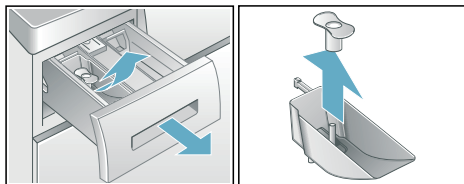

2. Clean the measuring aid and cover with water and brush.

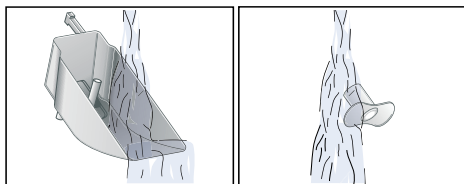

3. Install the cover back to the measuring aid. Pay attention to the assemble mark, and press the cover until click sounds.

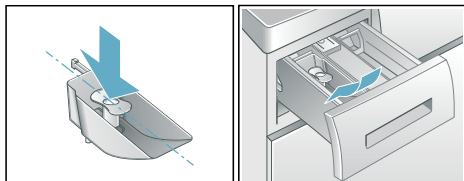

* depending on the model

Drain pump is blocked

Note: Turn the water tap off to prevent more water from flowing in and to ensure that it is drained via the pump.

Warning **Risk of scalding!**

When you wash at high temperatures, the water gets very hot. If you come into contact with the hot water, you may be scalded.

Allow the water to cool down first.

1. Switch off the appliance. Pull out the mains plug.
2. Open the service flap.

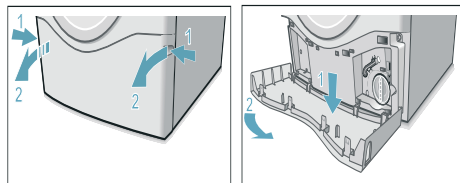

3. Take the drain hose out of the retainer. Remove the sealing cap and pour the water out into a suitable container. Replace the sealing cap and place the drain hose back in the retainer.

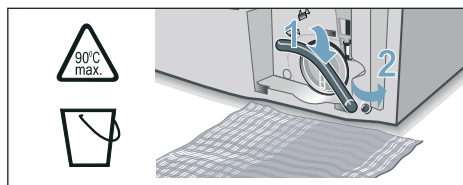

- Carefully unscrew the pump cover; residual water may leak out. Clean the interior, pump cover thread and pump housing. The impeller in the drain pump must be able to rotate. Refit and screw on the pump cover. The handle must be in a vertical position.

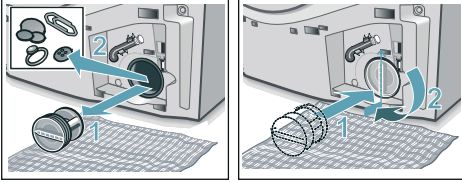

- Close the service flap.

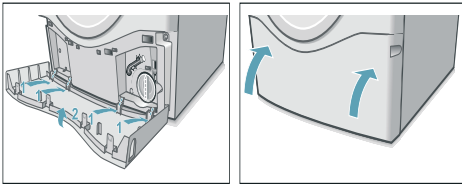

Note: To prevent unused detergent from flowing straight into the drain during the next wash: Pour 1 litre of water into dispenser **II** and start the **Spin** programme.

The drain hose at the siphon is blocked

- Switch off the appliance. Pull out the mains plug.
- Loosen the hose clamp. Carefully remove the drain hose; residual water may leak out.
- Clean the drain hose and siphon connecting piece.

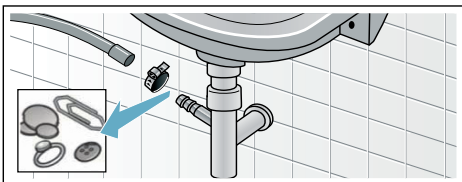

- Re-attach the drain hose and secure the connection point using the hose clamp.

Filter in the water supply is blocked

- Release water pressure in the supply hose:
 - Turn off the water tap.
 - Select any programme (except Rinse and Spin).
 - Select the button. Allow the programme to run for approx. 40 seconds.
 - Press the button. The appliance is switched off.
 - Pull out the mains plug.
- Clean the filters:
 - Disconnect the hose from the tap. Clean the filter with a small brush.

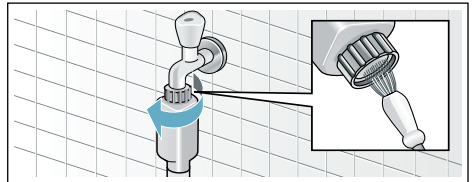

- For standard and Aqua-Secure models, clean the filter on the rear of the appliance: Disconnect the hose from the rear of the appliance. Use pliers to remove the filter and then clean it.

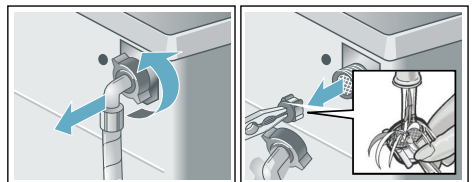

- Connect the hose and check for leaks.

Faults and what to do about them

Emergency release

E.g. power outage or in the event of a loss of power

The programme continues when the power supply is restored.

However, if the laundry has to be removed, the appliance door can be opened as follows:

Warning

Risk of scalding!

When you are washing at high temperatures, there is a risk of scalding if you come into contact with hot water and laundry.

If possible, leave it to cool down first.

Caution!

Risk when reaching into/gripping the rotating drum!

You may injure your hands if you reach into the drum while it is turning. Do not reach into the drum when it is turning.

Caution!

Water damage!

Any escaping water may cause water damage.



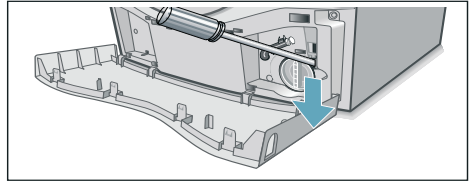

Do not open the door if water can be seen through the glass.

1. Switch off the appliance. Pull out the mains plug.
2. Drain the water → Page 46

3. Pull the emergency release downwards with a tool and release. The door can then be opened.





Information on the display panel

Display	Cause/Remedy
	<ul style="list-style-type: none"> ■ Flashes fast + signal: The door was opened and the water level is too high. Close the door, continue the programme with  button or select Spin. ■ Flashes slowly: The door lock temperature is too high to open the door. Wait approx. 30 seconds until the door lock temperature cools down.
	<ul style="list-style-type: none"> ■ Flashes (no water supply): Tap turned on? Filter in the water supply is blocked? → "Filter in the water supply is blocked" on page 47 Is the supply hose kinked or trapped? ■ Lights up (low water pressure): For information only. This will not affect the programme progress. The programme duration is extended.
E:3610	<p>E:36 alternating display with -10 and End when programme is finished:</p> <ul style="list-style-type: none"> ■ The drain pump is blocked. → "Drain pump is blocked" on page 46 ■ The drain hose at the siphon is blocked. → "The drain hose at the siphon is blocked" on page 47
E:3510 (Suitable for special models)	<p>E:35 alternating display with -10 and End when programme is finished: there is water in the base trough, the appliance is leaking. Turn off the tap. Call customer services.</p>
童锁 (3 秒) lights up	The childproof lock is activated – deactivate it.
 lights up	Too much foam has been detected and an additional wash cycle has been activated. Add less detergent to the next washing cycle with the same load.
The symbol  flashes	<p>Run the Drum clean 90°C programme to clean and care for the drum and the outer tub.</p> <p>Notes</p> <ul style="list-style-type: none"> ■ Run the programme without laundry. ■ Use washing powder or a detergent containing bleach. To prevent foaming, only use half the amount of detergent recommended by the detergent manufacturer. Do not use detergent designed for woollens or delicates. ■ Switching the information signal on/off. → "Switching the drum-care information signal on/off" on page 44

Display	Cause/Remedy
	<p>Lit: Wi-Fi is switched on and the appliance is connected to your home network.</p> <p>Flashing: The appliance is trying to connect to your home network.</p> <p>Off: Wi-Fi is switched off and the appliance is disconnected from your home network.</p>
Other displays	Switch off the appliance, wait for five seconds and then switch it on again. If the display appears again, call customer services.

Faults and what to do about them

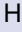
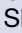
Faults	Cause/Remedy
Water is leaking from the appliance.	<ul style="list-style-type: none"> ■ Attach the drain hose correctly or replace it. ■ Tighten the screw fitting on the supply hose.
The appliance is not filling with water.	<ul style="list-style-type: none"> ■ Programme does not start? ■ Is the tap turned on?
Detergent is not being dispensed.	<ul style="list-style-type: none"> ■ Could the filter in the water supply be blocked? → "Filter in the water supply is blocked" on page 47 ■ Is the supply hose kinked or trapped?
The wrong detergent/fabric softener has been poured into the dispenser(s).	<p>Dispenser(s):</p> <ol style="list-style-type: none"> 1. Empty and clean. 2. Refill.
Detergent/fabric softener has congealed in the dispensers.	Clean and refill the dispensers.
The door cannot be opened.	<ul style="list-style-type: none"> ■ The safety function is activated. Stop the programme? ■ Can the door only be opened by the emergency release? → "Emergency release" on page 48 ■ Childproof lock activated? Deactivate childproof lock. ■ The temperature in drum is too high to open the door. Wait approx. 30 seconds until the temperature in drum cools down. ■ The water level in drum is too high.

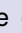
Faults	Cause/Remedy
The programme will not start.	<ul style="list-style-type: none"> ■ Have you touched the  button or selected Finish in time? ■ Is the door closed? ■ Childproof lock activated? Deactivate childproof lock. ■ Shop mode activated? If the display shows  for 5 s after you have switched on or off the appliance, the appliance is in shop mode. Turn off the shop mode as follows: <ol style="list-style-type: none"> 1. Switch the appliance off and on again. 2. Wait for the display message  to disappear. 3. Touch and hold  for at least 5 s. The display shows  and the appliance will automatically switch off. You can use the appliance now as usual.
The water is not draining.	<ul style="list-style-type: none"> ■ Could the drain pump be blocked? → "Drain pump is blocked" on page 46 ■ Could the drain hose at the siphon be blocked? → "The drain hose at the siphon is blocked" on page 47
Water is not visible in the drum.	Not a fault – the water is below the visible area.
The spin result is not satisfactory. Laundry wet/too damp.	<ul style="list-style-type: none"> ■ Not a fault – the unbalanced load detection system has interrupted the spin cycle because the laundry is unevenly distributed. Distribute small and large items of laundry evenly in the drum. ■ Is 轻松熨 (Easy iron) additional programme setting selected (depending on the model)? ■ Is 夜间 (Silent wash) additional programme setting or Silent wash programme selected (depending on the model)? ■ Is the selected speed too low?
The spin cycle runs several times.	Not a fault – the unbalanced load detection system is adjusting an imbalance.
The programme is taking longer than usual.	<ul style="list-style-type: none"> ■ Not a fault – the unbalanced load detection system is adjusting an imbalance by repeatedly distributing the laundry. ■ Not a fault – the foam detection system is activated – a rinse cycle has been switched on.
Foam may come out of the detergent drawer.	<p>Too much detergent used?</p> <p>Mix 1 tablespoon of fabric softener with ½ litre of water and pour into dispenser II. (Not suitable for outdoor clothing, sportswear or items stuffed with down)</p> <p>Reduce detergent dosage for the next wash cycle.</p> <p>Use commercially available low foam detergent and care product which are suitable for machine.</p>
The length of the programme changes during the wash cycle.	Not a fault – the programme sequence is optimised for the specific washing process. This may change the length of the programme shown on the Touch-Display.

Faults	Cause/Remedy
Odours, stain formation in the appliance.	<p>Run the Drum clean 90°C programme without laundry. Add washing powder or a detergent containing bleach.</p> <p>Note: To prevent foaming, only use half the amount of detergent recommended by the detergent manufacturer. Do not use detergents designed for woollens or delicates.</p>
I am unable to connect to my home network.	<ul style="list-style-type: none"> ■ Wi-Fi is switched off. To connect to your home network, switch on Wi-Fi.  must appear on the display. ■ Wi-Fi is switched on but a connection to your home network cannot be established. Check whether your home network is available or try to connect to your home network again.
Home Connect is not working.	<ul style="list-style-type: none"> ■ You can find solutions to problems with Home Connect at www.home-connect.com. ■ The availability of the Home Connect functionality depends on the availability of the Home Connect Services (e.g. provision of the app) in your country. Home Connect Services are not available in every country – for further information please check: www.home-connect.com.
Loud noises, vibrations and appliance "movement" during the spin cycle.	<ul style="list-style-type: none"> ■ Is the appliance aligned? → "Alignment" on page 19 ■ Are the appliance's feet fixed? Secure the appliance's feet. ■ Have the transport locks been removed? → "Removing the transport locks" on page 16
The Touch-Display indicator lights do not work while the appliance is running.	<ul style="list-style-type: none"> ■ Has there been a power failure? ■ Have the fuses blown? Reset/replace the fuses. ■ If the fault occurs repeatedly, call customer services.
There is detergent residue on the laundry.	<ul style="list-style-type: none"> ■ Some phosphate-free detergents contain water-insoluble residue. ■ Select Rinse or brush the laundry after washing.
<p>If you cannot rectify a fault yourself (after switching the appliance off and on again) or a repair is required:</p> <ul style="list-style-type: none"> ■ Switch off the appliance and pull out the mains plug. ■ Turn off the tap and call customer services. 	



After-sales service

If you cannot rectify a fault yourself, (→ "Faults and what to do about them" on page 48), please contact our after-sales service.

We will always find an appropriate solution to avoid unnecessary visits by engineers.

Please provide the after-sales service with the product number (E-Nr.) and the production number (FD) of the appliance.

E-Nr. _____	FD _____
-------------	----------

E-Nr.	Product number
FD	Production number

You can find this information (depending on the model):

- On the inside of the loading door
- On the back of the appliance

Trust the expertise of the manufacturer. Contact us. By doing so, you can be sure that the repairs are carried out by trained service personnel using genuine spare parts.

Advice and repair order in the event of faults

Home Connect	400 828 9898
CN	400 885 5888



Consumption values

Model	XQG100-WAU28560HW XQG100-WAU28566HW XQG100-WAU28568HW XQG100-WAU28569HW
Level*	1
Energy consumption (kWh per cycle)	0.740
Water consumption (litres per cycle)	74
Energy efficiency of washing	1.03
Noise level values**	
Max. value for spinning (dB(A))	69
Max. value for washing (dB(A))	43
* Energy consumption tested with Cottons 60 °C programme and additional programme settings 节电 (ecoPerfect) in accordance with GB12021.4.	
** Noise levels tested in accordance with GB19606.	

 **Technical data**

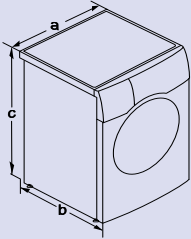

Dimensions	a= 598 mm b= 616 mm c= 848 mm
Weight	81 kg
Mains connection	Nominal voltage 220V, 50 Hz Nominal current 10 A Nominal power 2100 W
Water pressure	0.1-1 MPa (1-10 bar)
Environmental conditions for use (according to GB/T 4288)	Ambient Temperature: 0 °C - 40 °C , non-freezing Relative Humidity: less than 95% (at 25 °C), non-condensing



Thank you for buying a Bosch Home Appliance!

Register your new device on MyBosch now and profit directly from:

- Expert tips & tricks for your appliance
- Warranty extension options
- Discounts for accessories & spare-parts
- Digital manual and all appliance data at hand
- Easy access to Bosch Home Appliances Service

Free and easy registration – also on mobile phones:

www.bosch-home.com/welcome



Looking for help? You'll find it here.

Expert advice for your Bosch home appliances, need help with problems or a repair from Bosch experts.

Find out everything about the many ways Bosch can support you:

www.bosch-home.com/service

Contact data of all countries are listed in the attached service directory.

Robert Bosch Hausgeräte GmbH
Carl-Wery-Straße 34
81739 München, GERMANY
www.bosch-home.com



Bosch Home Appliances Official Wechat



9001278236 (0007)

en