



Register your new Bosch now:  
[www.bosch-home.com/welcome](http://www.bosch-home.com/welcome)



**Washing machine**



**BOSCH**

**en** Instruction Manual and Installation Instructions

## Your new washing machine

You have chosen a Bosch washing machine.

Please take a few minutes to read and become familiar with the advantages of your washing machine.

To meet the high quality demands required by Bosch, every washing machine that leaves our factory is carefully checked to ensure that it functions correctly and is in perfect condition.

For more information on our products, accessories, replacement parts and services, see our website [www.bosch-home.com](http://www.bosch-home.com) or contact our after-sales service centres.

If the operating and installation instructions describe different models, any differences will be pointed out at the relevant points in the text.



Read these operating and installation instructions before switching on the washing machine.

### Display rules

#### **Warning!**

This combination of symbol and signal word indicates a possibly dangerous situation. Not heeding the warning can cause death or injuries.

#### **Caution!**

This signal word indicates a possibly dangerous situation. Not heeding the caution can cause property and/or environmental damage.

### Note/tip

Information about the optimum use of the appliance/any other useful information.











#### **1. 2. 3. / a) b) c)**



The steps are represented by numbers or letters.

■ / -

Lists are represented by a small box or a dash.

# Contents

	<b>Intended use</b> . . . . .	<b>4</b>		<b>Detergent</b> . . . . .	<b>23</b>
	<b>Safety instructions</b> . . . . .	<b>5</b>		Correct selection of detergent . . . . .	23
	Children/people/pets . . . . .	5		Saving energy and detergent . . . . .	23
	Installation . . . . .	6		<b>Additional programme settings</b>	<b>24</b>
	Operation . . . . .	8		Quick wash . . . . .	24
	Cleaning/Maintenance . . . . .	10		Rinse Stop . . . . .	24
	<b>Environmental protection</b> . . . . .	<b>11</b>		Reducing the spin speed . . . . .	24
	Packaging/used appliance . . . . .	11		Easy-Iron . . . . .	24
	Tips on economical use . . . . .	11		Aqua Plus . . . . .	24
	<b>Positioning and connecting</b> . . . . .	<b>12</b>		<b>Operating the appliance</b> . . . . .	<b>24</b>
	Included with the appliance . . . . .	12		Preparing the washing machine . . . . .	24
	Installation . . . . .	12		Select programme/switch on the appliance . . . . .	25
	Secure installation . . . . .	12		Select additional programme settings . . . . .	25
	Installation surface . . . . .	13		Placing laundry into the drum . . . . .	25
	Installation on a base or a wooden joist floor . . . . .	13		Measure and add detergent and care products . . . . .	25
	Installing the appliance in a kitchenette . . . . .	13		Start the programme . . . . .	27
	Removing the transport locks . . . . .	13		Changing the programme . . . . .	27
	Hose and cable lengths . . . . .	14		Cancel the programme . . . . .	27
	Water connection . . . . .	14		Programme end during	
	Water inlet . . . . .	15		▽ Rinse Stop . . . . .	27
	Water outlet . . . . .	15		Programme end . . . . .	27
	Levelling . . . . .	16		Removing laundry/switching off the appliance . . . . .	27
	Electrical connection . . . . .	16		<b>Sensors</b> . . . . .	<b>28</b>
	Before washing for the first time . . . . .	17		Automatic load sensing . . . . .	28
	Transportation . . . . .	17		Unbalanced load detection system . . . . .	28
	<b>Main points in brief</b> . . . . .	<b>19</b>		<b>Cleaning and maintenance</b> . . . . .	<b>28</b>
	<b>Getting to know the appliance</b> . . . . .	<b>20</b>		Machine housing/control panel . . . . .	28
	Washing machine . . . . .	20		Drum . . . . .	28
	Control panel . . . . .	21		Descaling . . . . .	28
	<b>Laundry</b> . . . . .	<b>21</b>		Detergent drawer and housing . . . . .	29
	Prepare the laundry . . . . .	21		Detergent solution pump blocked . . . . .	29
	Sorting laundry . . . . .	22		The drain hose at the siphon is blocked . . . . .	30
	Starching . . . . .	22		Filter in the water supply blocked . . . . .	30
	Dyeing/bleaching . . . . .	22			
	Soaking . . . . .	22			

	<b>Faults and what to do about them. ....</b>	<b>31</b>
	Emergency release .....	31
	Information about the indicator lights .....	31
	Faults and what to do about them. .	32
	<b>After-sales service .....</b>	<b>34</b>
	<b>Technical data.....</b>	<b>34</b>

---

## **Intended use**

- This appliance is intended for private domestic use only.
- Do not install or operate this appliance anywhere that is liable to experience frost and/or outdoor conditions. There is a risk that the appliance will be damaged if residual water in it freezes. If hoses freeze up, they may crack/burst.
- This appliance must only be used for washing domestic laundry, consisting of machine-washable items and hand-washable woollens (see label on item). Using the appliance for any other purpose is outside of the scope of its intended application and is forbidden.
- This appliance is suitable for operation with mains water and commercially available detergents and care products (must be suitable for use in washing machines).
- This appliance is intended for use up to a maximum height of 4000 metres above sea level.

### **Before you switch on the appliance:**

Check that there is no visible damage to the appliance. Do not operate the appliance if it is damaged. Should you have any problems, please contact your specialist dealer or our customer service.

Read and follow the operating and installation instructions and all other information provided with this appliance.

Retain the documents for subsequent use or for subsequent owners.

## **Safety instructions**

The following safety information and warnings are provided to protect you from injury and to prevent material damage to your surroundings.

It is nevertheless important to take the necessary precautions and to proceed with care when installing, maintaining, cleaning and operating the appliance.

### **Children/people/pets**

#### **Warning** **Risk of death!**

Children and other people who are unable to assess the risks involved when using the appliance may injure themselves or may find themselves in life-threatening situations. Therefore please note:

- The appliance may be used by children over the age of 8 years and by persons with reduced physical, sensory or mental capacity or by persons with a lack of experience or knowledge as long as they are supervised or have received instruction on how to use the appliance safely and they have understood the potential risks of using the appliance.

- Children must not play with this appliance.
- Do not allow children to clean or maintain this appliance unsupervised.
- Keep children under 3 years and pets away from this appliance.
- Do not leave the appliance unattended when children or other people who are unable to assess the risks are in the vicinity.

#### **Warning** **Risk of death!**

Children may lock themselves inside appliances and find themselves in a life-threatening situation.

- Do not position the appliance behind a door, as this may obstruct the appliance door or prevent it from opening completely.
- Once an appliance has reached the end of its life, pull the mains plug from the socket **before** severing the mains cable, and then destroy the lock on the appliance door.

### **Warning**

#### **Risk of suffocation!**

If allowed to play with the packaging/plastic film or packing components, children may become caught in these or pull them over their heads and suffocate.

Keep packaging, plastic film and packing components away from children.

### **Warning**

#### **Risk of poisoning!**

Detergents and care products may result in poisoning if consumed.

If accidentally swallowed, seek medical advice. Keep detergents and care products out of the reach of children.

### **Warning**

#### **Risk of burns!**

When washing at high temperatures, the glass in the appliance door becomes hot. Stop children from touching the appliance door when it is hot.

### **Warning**

#### **Eye/skin irritation!**

Contact with detergents or care products may cause eye/skin irritation.

Rinse eyes/skin thoroughly if they/it come(s) into contact with detergents or care products. Keep detergents and care products out of the reach of children.

## **Installation**

### **Warning**

#### **Risk of electric shock/fire/ material damage/damage to the appliance!**

If the appliance is not installed properly, this may lead to a dangerous situation. Ensure the following:

- The mains voltage on your power socket must match the rated voltage specified on the appliance (identification plate). The connected loads and the required fuse protection are specified on the identification plate.
- The appliance must only be connected to alternating voltage via a protective contact socket that has been correctly installed. This plug socket must be freely accessible at all times.
- The mains plug and the protective contact socket must match and the earthing system must be correctly installed.
- The installation must have an adequate cross section.

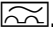
- The mains plug must be freely accessible at all times. If this is not possible, in order to comply with the relevant safety regulations, a switch (all pole disconnection) must be built into the permanent installation in accordance with electrical installation regulations.
- If using a residual current circuit breaker, only use one that bears the following mark: . The presence of this mark is the only way to be sure that it fulfils all the applicable regulations.

### **Warning**

#### **Risk of electric shock/fire/ material damage/damage to the appliance!**

If the appliance's mains cable is altered or damaged, this may result in electric shock, short circuiting or fire due to overheating.

The mains cable must not be kinked, crushed or altered, and must not come into contact with any heat sources.

### **Warning**

#### **Risk of fire/material damage/ damage to the appliance!**

The use of extension cords or power strips may result in fire due to overheating or short circuiting.

Connect the appliance directly to an earthed socket that has

been correctly installed. Do not use extension cords, power strips or multi-way couplers.



### **Warning**

#### **Risk of injury/material damage/damage to the appliance!**

- The appliance may vibrate or move when in operation, potentially resulting in injury or material damage. Place the appliance on a clean, even, solid surface and, using a spirit level to guide you, level it with the screw-in feet.
- If you take hold of any of the appliance's protruding parts (e.g. the appliance door) in order to lift or move it, these parts may break off and cause injury. Do not take hold of any of the appliance's protruding parts in order to move the appliance.



### **Warning**

#### **Risk of injury!**

- The appliance is very heavy. Lifting it may result in injury. Do not lift the appliance on your own.
- The appliance has sharp edges on which you could cut your hands. Do not take hold of the appliance by its sharp edges. Wear protective gloves to lift it.

- If the hoses and mains cables are not correctly routed, they may constitute a tripping hazard, which may result in injury.  
Route hoses and cables such that they do not constitute a tripping hazard.

### **Caution!**

#### **Material damage/damage to the appliance**

- If the water pressure is too high or too low, the appliance may not be able to operate properly, and it may also result in material damage or damage to the appliance.  
Make sure that the water pressure in the water supply facility is at least 100 kPa (1 bar), and does not exceed 1000 kPa (10 bar).
- If the water hoses are altered or damaged, this may result in material damage or damage to the appliance.  
The water hoses must not be kinked, crushed, altered or severed.
- The use of hoses supplied by other brands to connect to the water supply may result in material damage or damage to the appliance.  
Use the hoses supplied with the appliance or genuine spare part hoses only.

- The appliance is secured for transportation by transport locking devices. If the transport locking devices are not removed before the appliance is operated, this may result in damage to the appliance.  
It is important to completely remove all transport locking devices before using the appliance for the first time.  
Make sure that you retain these transport locking devices separately. It is important to refit the transport locking devices if the appliance is to be transported, in order to prevent the appliance from being damaged in transit.

### **Operation**

#### **Warning**

#### **Risk of explosions/fire!**

Laundry that has been pretreated with cleaning agents that contain solvents, e.g. stain remover/cleaning solvent, may cause an explosion in the drum. Rinse the laundry thoroughly with water before washing it in the machine.

 **Warning****Risk of poisoning!**

Poisonous fumes may be given off by cleaning agents that contain solvents, e.g. cleaning solvent.

Do not use cleaning agents that contain solvents.

 **Warning****Risk of injury!**

- If you support your weight/sit on the appliance door when it is open, the appliance may tip over, which may result in injury.

Do not support your weight on the appliance door when it is open.

- If you climb onto the appliance, the worktop may break, which may result in injury.

Do not climb onto the appliance.

- If you reach into the drum while it is still rotating, you risk injuring your hands. Wait until the drum has stopped rotating.

 **Warning****Risk of scalding!**

When washing at high temperatures, there is a risk of scalding if you come into contact with hot detergent solution (e.g. when draining hot detergent solution into a washbasin).

Do not reach into the hot detergent solution.

 **Warning****Eye/skin irritation!**

Detergent and care products may spray out if the detergent drawer is opened while the appliance is in operation.

Rinse eyes/skin thoroughly if they/it come(s) into contact with detergents or care products. If accidentally swallowed, seek medical advice.

**Caution!****Material damage/damage to the appliance**

- If the amount of laundry in the appliance exceeds its maximum load capacity, it may not be able to operate properly, or this may result in material damage or damage to the appliance.

Do not exceed the maximum load capacity of dry laundry.

Make sure you comply with the maximum load capacities specified for each of the programs → Supplementary sheet for the operating and installation instructions.

- If you pour the wrong quantity of detergent or cleaning agent into the appliance, this may result in material damage or damage to the appliance. Use detergents/care products/cleaning agents and softeners in accordance with the manufacturers' instructions.

## Cleaning/Maintenance

### **Warning** **Risk of death!**

The appliance is powered by electricity. There is a risk of electric shock if you come into contact with live components. Therefore please note:

- Switch off the appliance. Disconnect the appliance from the power supply (pull out the plug).
- Never take hold of the mains plug with wet hands.
- When removing the mains plug from the socket, always take hold of the plug itself and never the mains cable, otherwise this may damage the mains cable.
- Do not make any technical modifications to the appliance or its features.

- Repairs and any other work on the appliance must only be conducted by our customer service or by an electrician. The same applies for replacing the mains cable (when necessary).
- Spare mains cables can be ordered from our customer service.

### **Warning** **Risk of poisoning!**

Poisonous fumes may be given off by cleaning agents that contain solvents, e.g. cleaning solvent.

Do not use cleaning agents that contain solvents.

### **Warning** **Risk of electric shock/material damage/damage to the appliance!**

If moisture penetrates the appliance, this may cause it to short circuit.

Do not use a pressure washer, steam cleaner, hose or spray gun to clean your appliance.



## Warning

### **Risk of injury/material damage/damage to the appliance!**

The use of spare parts and accessories supplied by other brands is dangerous and may result in injury, material damage or damage to the appliance. For safety reasons, use genuine spare parts and accessories only.

## Caution!

### **Material damage/damage to the appliance**

Cleaning agents and agents for pretreating laundry (e.g. stain removers, prewash sprays, etc.) may cause damage if they come into contact with the surfaces of the appliance. Therefore please note:

- Do not allow these agents to come into contact with the surfaces of the appliance.
- Clean the appliance with nothing but water and a soft, damp cloth.
- Remove any detergent, spray or other residues immediately.



## Environmental protection

### **Packaging/used appliance**



Dispose of packaging in an environmentally friendly manner.

This appliance is designated according to European Directive 2012/19/EC, which governs waste electrical and electronic equipment (WEEE).

The directive provides a framework for the collection and recycling of old appliances, which is valid across the EU.

### **Tips on economical use**

- Always fill the appliance with the maximum amount of laundry for each programme.  
Programme overview → Supplementary sheet for the installation and operating instructions
- Wash normally soiled laundry without prewash.
- Refer to the care labels on the textiles for the selectable temperature. The temperatures in the machine may deviate from this for an optimum mix of energy-saving and washing results.
- If the laundry will be dried in a dryer, select the spin speed according to the dryer manufacturer's instructions.



## Positioning and connecting

### Included with the appliance

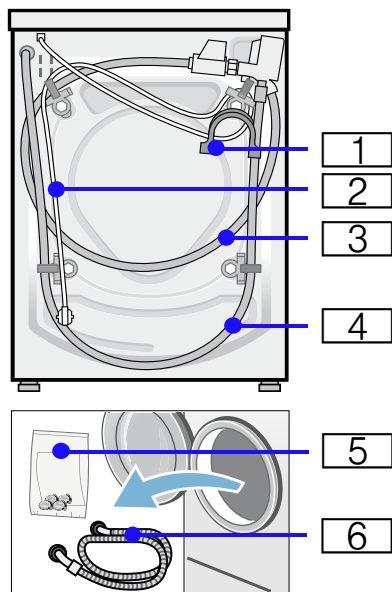

- 1 Elbow for securing the water drain hose\*
- 2 Mains cable
- 3 Water supply hose on AquaStop/  
AquaSecure models
- 4 Water drain hose
- 5 Bag\*:
  - Installation and operating instructions
  - After-sales service location directory\*
  - Warranty\*
  - Cover caps for openings after the transportation safety devices have been removed
  - Spanner\*
- 6 Water supply hose on standard models  
\* depending on the model

### Notes

- Check the machine for transport damage. Never use a damaged machine. If you have any complaints, contact the retailer from whom you purchased the appliance, or our after-sales service.
- Moisture in the drum is due to the final inspection.

**In addition**, a hose clamp (24 – 40 mm diameter, available from specialist retailers) is required to connect the water drain hose to a siphon.

### Useful tools

- Spirit level for aligning
- Wrench with:
  - WAF13 for loosening the transportation safety devices and
  - WAF17 for aligning the appliance feet

## Installation

**Note:** Moisture in the drum is due to the final inspection.

## Secure installation



### Warning Risk of injury!

- The washing machine is very heavy. Be careful when lifting/transporting the washing machine; wear protective gloves.
- If the washing machine is lifted by protruding components (e.g. the washing machine door), the components may break off and cause injuries. Do not lift the washing machine by protruding parts.
- If the hose and mains cables are not laid properly, there is a risk of tripping and injury. Lay hoses and cables in such a way that there is no risk of tripping.

**Caution!****Damage to the appliance**

- Frozen hoses may crack/burst. Do not install the washing machine in areas exposed to frost and/or outdoors.

**Note:** If in doubt, have the appliance connected by a technician.

**Installation surface**

**Note:** The washing machine must be stable so that it does not move around.

- The installation surface must be firm and level.
- Soft floors/floor coverings are not suitable.

**Installation on a base or a wooden joist floor****Caution!****Damage to the appliance**

The washing machine may “wander” and tip/topple from the base during the Spin cycle.

Always secure the washing machine feet with fixing brackets.

Order no. WMZ2200, WX975600, Z7080X0

**Note:** On wooden joist floors, install the washing machine:

- In a corner, if possible,
- On a water-resistant wooden board (min. 30 mm thick) which is screwed tightly to the floor.

**Installing the appliance in a kitchenette****Warning****Risk of death!**

There is a risk of electric shock if live components are touched. Disconnect the appliance from the power supply.

**Notes**

- A recess width of 60 cm is required.
- Only install the washing machine underneath a continuous worktop that is securely connected to adjacent cabinets.

**Warning****Risk of electric shock!**

If you remove the appliance covering plate for installation underneath the worktop or in a unit, you must always replace it with a metal cover\*.

\* Order no. WMZ2420, WZ10190

**Removing the transport locks****Caution!****Damage to the appliance**

- The machine is secured for transportation using transport locks. If the transport locks are not removed, the machine may become damaged when it is operated. Before using the appliance for the first time, make sure that you completely remove all four transport locks. Keep the locks in a safe place.
- To prevent transport damage from occurring if the appliance is moved at a later date, you must refit the transport locks before transporting the appliance.

**Note:** Keep the screws and sleeves screwed together in a safe place.

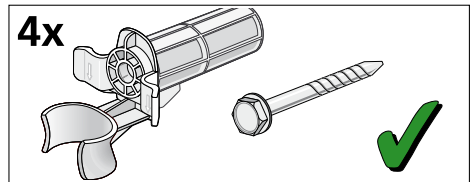

1. Take the hoses out of the holders.

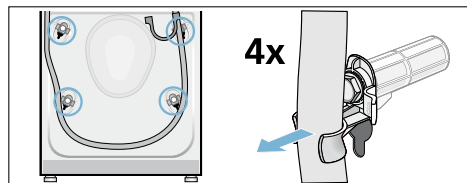

2. Remove the mains cable from the holders. Unscrew and remove all four transport lock screws. Remove the sleeves.

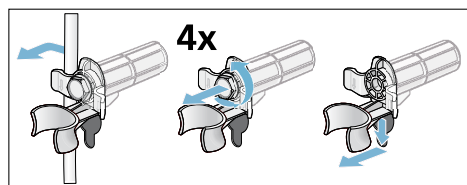

3. Fit the covers. Lock the covers firmly in place by applying pressure to the snap-in hooks.

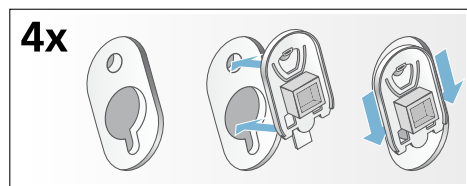

## Hose and cable lengths

### Left-hand connection

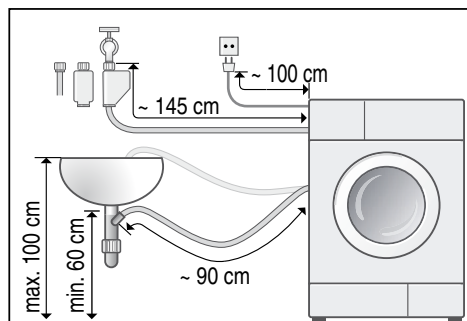

### Right-hand connection

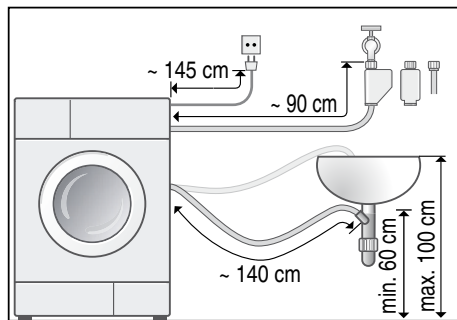

### Tip:

The following are available from specialist retailers/our after-sales service:

- Extension for the AquaStop and cold water supply hose (approx. 2.50 m). Order no. WMZ2380, WZ10130, Z7070X0
- A longer supply hose (approx. 2.20 m) for standard models. Individual component number for the after-sales service: 00353925

## Water connection



### Warning Risk of death!

There is a risk of electric shock if live components are touched.  
Do not immerse the AquaStop safety valve in water (it contains an electric valve).

### Caution! Water damage

The connection points for the water supply hose and water drain hose are under high water pressure. To prevent leaks and water damage, you must follow the instructions in this section.

Observe the following when connecting the machine:

### Notes

- In addition to the information listed here, the local water and electricity supplier may have special requirements.
- Only operate the washing machine using cold mains water.
- Do not connect the washing machine to the mixer tap of an unpressurised hot-water boiler.
- Do not use a used supply hose. Only use the supply hose supplied or one that was purchased from an authorised specialist retailer.
- If in doubt, have the appliance connected by a technician.

## Water inlet

### Notes

- Do not bend, squash, modify or cut through the water supply hose (otherwise its strength is no longer guaranteed).
- Only tighten the screw connection by hand. If the screw connections are tightened too much with a tool (pliers), the thread may be damaged.

### Optimum water pressure in the supply network

**At least** 100 kPa (1 bar)

**Maximum** 1000 kPa (10 bar)

- When the tap is open, the water flow rate is at least 8 l/min.
- If the water pressure is higher than this, a pressure-reducing valve must be installed.

### Connection

Connect the water supply hose to the tap ( $\frac{3}{4}$ " = 26.4 mm) and to the appliance (not necessary for AquaStop models as this is permanently installed):

#### ■ Standard model

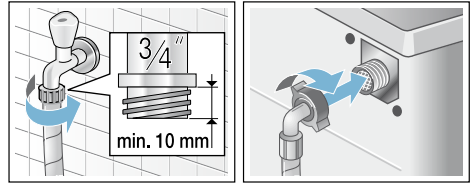

#### ■ AquaSecure model

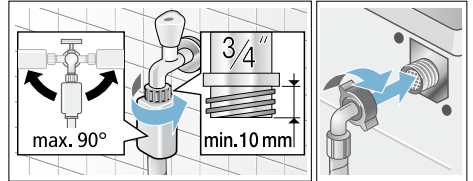

#### ■ AquaStop model

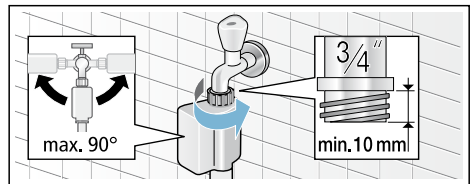

Carefully turn the tap on, and check that the connection points are not leaking.

**Note:** The screw connection is under mains water pressure.

## Water outlet

### Caution! Water damage

If the drain hose slips out of the washbasin or the connection point during draining due to high water pressure, any escaping water may cause water damage. Secure the drain hose so that it cannot slip out.

### Notes

- Do not kink the water drain hose or stretch it lengthways.

- Height difference between the installation surface and the drain:  
Min. 60 cm, max. 100 cm

You can lay the water outlet hose as follows:

### ■ Drainage into a washbasin

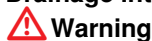

#### **Warning**

#### **Risk of scalding!**

When washing at high temperatures, there is a risk of scalding if you come into contact with hot detergent solution (e.g. when draining hot detergent solution into a wash basin).

Do not reach into the hot detergent solution.

#### **Caution!**

#### **Damage to the appliance/fabrics**

If the end of the drain hose is immersed in the drained water, water may be sucked back into the appliance and may damage the appliance/fabrics.

Make sure that:

- The plug does not block drainage from the wash basin.
- The end of the drain hose is not immersed in the drained water.
- The water drains away quickly enough.

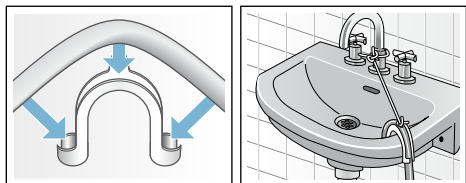

### ■ Drainage into a siphon

The connection point must be secured using a hose clamp with a diameter of 24 – 40 mm (available from specialist retailers).

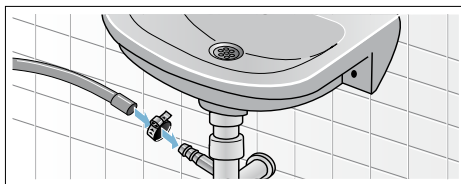

## Levelling

Align the appliance using a spirit level.

Incorrect alignment may result in loud noises, vibrations and machine "movement".

1. Loosen the lock nuts using a spanner, turning it in a clockwise direction.
2. Check the alignment of the washing machine with a spirit level, and adjust it if necessary. Change the height by turning the appliance feet. All four appliance feet must stand firmly on the ground.
3. Tighten the lock nut against the housing.

In doing so, hold the foot tight and do not adjust its height.

The lock nuts on all four appliance feet must be screwed tightly against the housing.

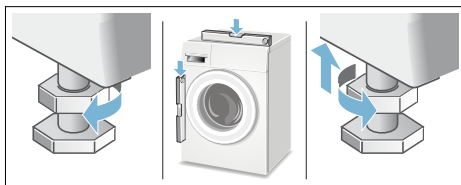

## Electrical connection



#### **Warning**

#### **Risk of death!**

There is a risk of electric shock if live components are touched.

- Never touch or hold the mains plug with wet hands.

- Only pull out the mains cable by the plug and never by the cable, as this could damage it.
- Never unplug the mains plug during operation.

Observe the following information and ensure that:

### Notes

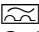
- The mains voltage and voltage indicated on the washing machine (rating plate) are the same. The connected load and fuse required are specified on the rating plate.
- The washing machine is only connected to an alternating current supply via a properly installed earthed socket.
- The mains plug fits the socket.
- The cable cross-section is adequate.
- The earthing system is properly installed.
- If the mains cable needs replacing, only a qualified electrician may do it. Replacement mains cables are available from the after-sales service.
- Do not use multiple plugs/couplings or extension cables.
- If an earth-leakage circuit breaker is used, only a type which displays this  symbol can be fitted. Only this symbol guarantees compliance with the currently applicable regulations.
- The mains plug can be accessed at all times.
- Do not bend, squash, modify, cut through, or bring the mains cable into contact with heat sources.

## Before washing for the first time

The washing machine was thoroughly tested before leaving the factory. In order to remove any water which may be left over from the test, run the first washing cycle **without** any laundry.

### Notes

- The washing machine **must be correctly installed and connected** (from → *Page 12*).
- Never use a damaged machine. Inform the after-sales service. → *Page 34*

1. Check the washing machine.
  2. Connect the mains plug.
  3. Turn on the tap.
  4. Switch on the appliance.
  5. Close the washing machine door (do not load any laundry).
  6. Select the **Cottons 90 °C** programme.
  7. Open the detergent drawer.
  8. Pour approximately 1 litre of water into compartment **II**.
  9. Add standard detergent to compartment **II** according to manufacturer's instructions for light soiling.
- Note:** To prevent foaming, only use half the recommended amount of detergent. Do not use detergents designed for woollens or delicates.
10. Close the detergent drawer.
  11. Press the **Start button**.
  12. Switch off the appliance when the programme has finished.

**Your washing machine is now ready to use.**

## Transportation

e.g. when moving home

### Preparatory work:

1. Turn off the water tap.
2. Reduce the water pressure in the supply hose.
3. Drain the remaining detergent solution.
4. Disconnect the washing machine from the mains.
5. Remove the hoses.

### Installing the transport locks:

1. Remove the covers and keep them in a safe place.  
Use a screwdriver if necessary.

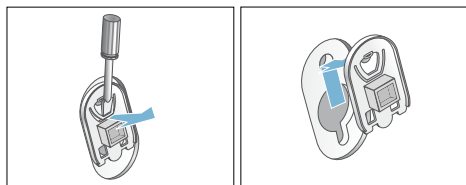

2. Insert all four sleeves.  
Clip the mains cable securely in the holders. Insert and tighten the screws.

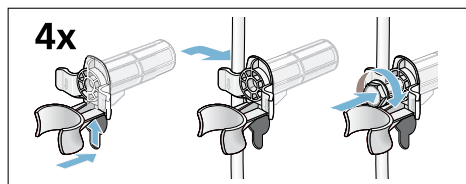

### Before switching on the appliance again:

#### Notes

- The transport locks **must** be removed.
- To prevent unused detergent from flowing straight into the drain during the next wash: Pour approx. 1 litre of water into compartment **II** and start the **Empty** programme.

## Main points in brief

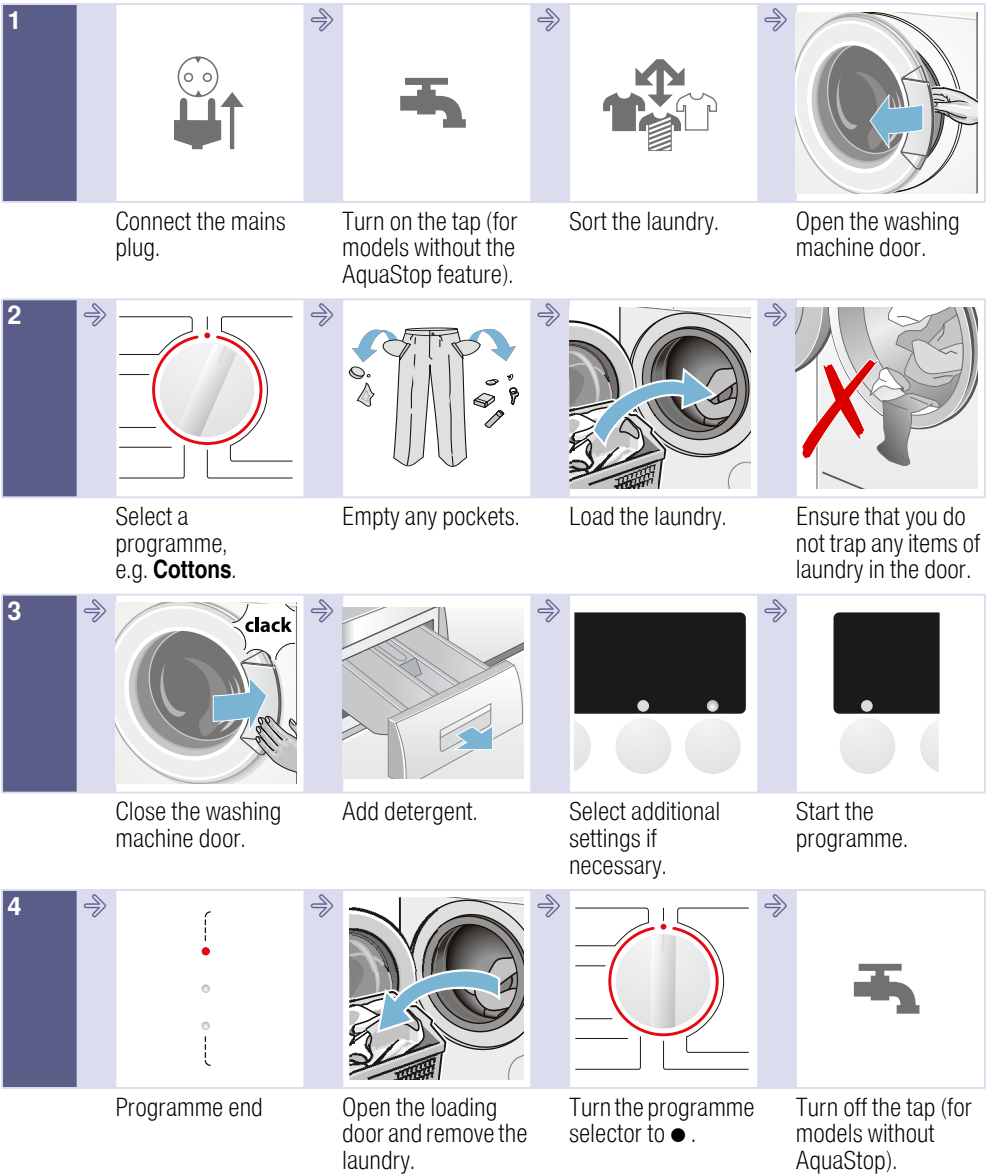



## Getting to know the appliance

### Washing machine

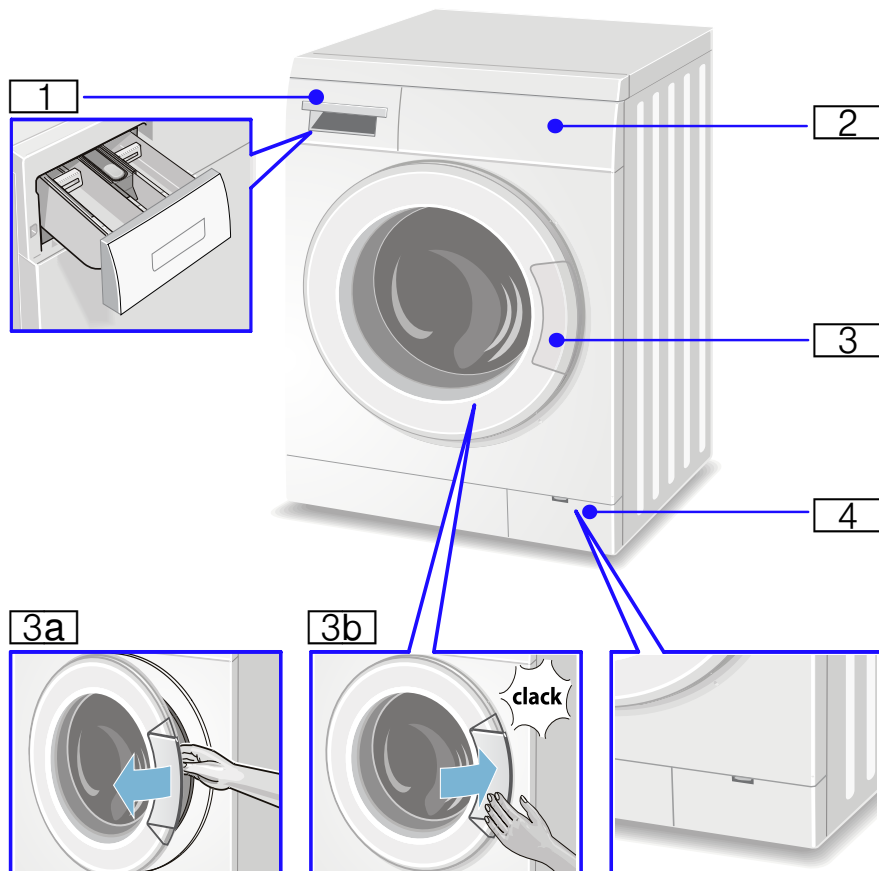

- 1** Detergent drawer → *Page 25*
- 2** Control panel
- 3** Door with door handle
- 3a** Open the door
- 3b** Close the door
- 4** Service flap

## Control panel

You can find additional programme settings in the overview; these differ depending on the model.

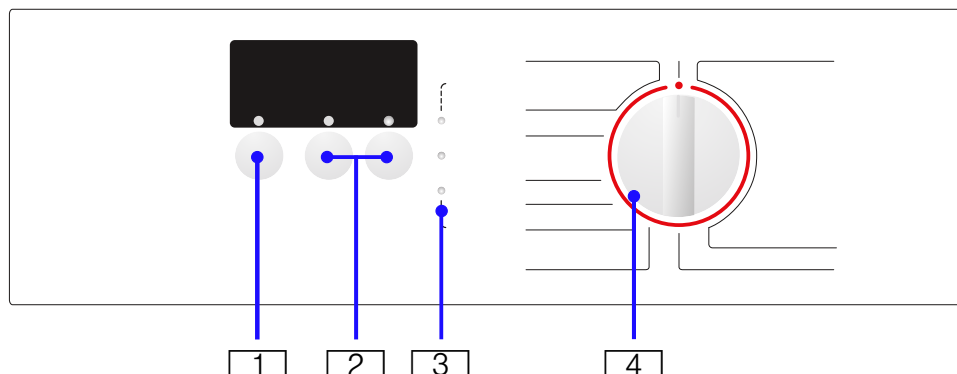

- 1 Start button** for starting, interrupting and cancelling a programme
- 2 Additional programme settings** can be selected (depending on the model)  
Overview of all additional programme settings → *Page 24*
- 3 Status indicators**  
Programme status indicators:  
→ **Ready**  
🧺 **Wash/Active**  
🚰 **Rinse**  
🌀 **Spin**  
↳ **Ready/End**
- 4 Programme selector** for selecting a programme and for switching the washing machine on and off



## Laundry

### Prepare the laundry

#### Caution!

#### Damage to the appliance/fabrics

Foreign objects (e.g. coins, paperclips, needles, nails) may damage the laundry or components in the washing machine.

You should therefore note the following tips when preparing your laundry:

- Empty any pockets.

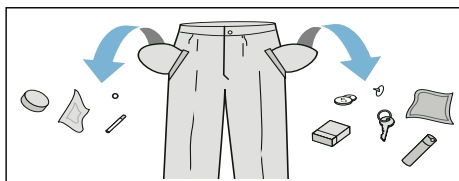







- Look out for metal items (paperclips, etc.) and remove them.
- Wash delicates in a laundry bag (tights, underwired bras, etc.).
- Close any zips; button up any cover buttons.

- Brush sand out of pockets and collars.
- Remove curtain fittings or place curtains in a laundry bag.

## Sorting laundry

Sort your laundry according to the care instructions and manufacturer's information on the care labels, depending on:

- Type of fabric/fibre.
- Colour:  
**Note:** Laundry can discolour or not be cleaned correctly. Wash white and coloured items separately. Wash new coloured items separately the first time you wash them.
- Soiling:  
Wash laundry with the same level of soiling together.  
Examples of levels of soiling:
  - **Light:** Do not prewash
  - **Normal**
  - **Heavy:** Load less laundry, select a programme with prewash
  - **Stains:** Remove/pretreat stains while they are fresh. Firstly, dab with soapy water; do not rub. Then wash the items of laundry with the appropriate programme. Stubborn or dried-in stains can sometimes only be removed by washing several times.
- Symbols on the care labels:  
The numbers in the symbols indicate the maximum washing temperature that may be used.
  - : Suitable for a normal washing process; e.g. the Cottons programme.
  - : A gentle washing process is required; e.g. the Easy-Care programme.
  - : An especially gentle washing process is required; e.g. the Delicates/Silk programme

- : Suitable for washing by hand; e.g. the  / Wool programme.
- : Do not wash the laundry in the machine.

## Starching

**Note:** Laundry should not be treated with fabric softener.

Starching is possible in all wash programmes if liquid starch is used. Measure starch into compartment  in accordance with the manufacturer's instructions (clean first if necessary).

## Dyeing/bleaching

Dye should only be used in normal household quantities. Salt may damage stainless steel. Always follow the dye manufacturer's instructions.

Do **not** use the washing machine to bleach clothes.

## Soaking

1. Pour soaking agent/detergent into compartment **II** in accordance with the manufacturer's instructions.
2. Turn the programme selector to the **Cottons 20 °C or 30 °C** programme.
3. Press the **Start button** to start the programme.
4. After approx. 10 minutes, press the **Start button** again to pause the programme.
5. After the required soaking time, press the **Start button** again if the programme is to be continued or changed.

### Notes

- Load laundry of the same colour.
- No additional detergent is required; the soaking solution is used for washing.



## Detergent

### Correct selection of detergent

The care label is crucial to ensure correct detergent selection, temperature and laundry treatment. → See also [www.sartex.ch](http://www.sartex.ch)

Visit [www.cleanright.eu](http://www.cleanright.eu) to find further information on detergents, care products and cleaning agents for domestic use.

- **Standard detergent with optical brighteners**  
Suitable for heat-resistant white laundry made from linen or cotton  
Select the Cottons programme, cold – max. 90 °C.
- **Detergent for colours without bleach or optical brighteners**  
Suitable for coloured laundry made from linen or cotton  
Select the Cottons programme, cold – max. 60 °C.
- **Detergent for colours/delicates without optical brighteners**  
Suitable for coloured laundry made from easy-care fibres or synthetic fibres  
Select the Easy-Care programme, cold – max. 60 °C.
- **Detergent for delicates**  
Suitable for delicate, fine fabrics, silk or viscose  
Select the Delicates/Silk programme, cold – max. 40 °C.
- **Detergent for woollens**  
Suitable for woollen fabrics  
Select the Wool programme, cold – max. 40 °C.

### Saving energy and detergent

For light and normal soiling, you can save energy (by lowering the washing temperature), and detergent.

Saving	Soiling/note
Reduced temperature and detergent quantity as per the recommended dosage	<b>Light</b> No visible dirt or stains. Clothing has absorbed body odours, e.g.: <ul style="list-style-type: none"> <li>■ Light summer/sports clothing (worn for a few hours)</li> <li>■ T-shirts, shirts, blouses (worn for up to one day)</li> <li>■ Guest bed linen and hand towels (used for one day)</li> </ul>
	<b>Normal</b> Visible dirt or a few light stains, e.g.: <ul style="list-style-type: none"> <li>■ T-shirts, shirts, blouses (sweat-soaked, worn a few times)</li> <li>■ Towels, bedding (used for up to one week)</li> </ul>
	<b>Heavy</b> Dirt and/or stains clearly visible, e.g. tea towels, baby items, work clothing
Temperature as per the care label, and detergent quantity as per the recommended dosage for heavy soiling	

**Note:** When measuring the amount of all detergents/additives/care products and cleaning agents, please always check the manufacturer's instructions and information.

## P<sup>+</sup> Additional programme settings

**Note:** You can find possible additional programme settings in the overview; these differ depending on the model.

### Quick wash

(🕒, **Quick, express wash, speed**)

For a shorter wash time with a comparable washing effect to the standard programme.

**Note:** Do not exceed the maximum load.

Programme overview →  
Supplementary sheet for the installation and operating instructions

### Rinse Stop

(🛑 **no final spin**)

The laundry remains in the water last used for rinsing.

You can select this function to prevent creasing if the laundry will not be taken out of the washing machine immediately after the programme has ended.

### Reducing the spin speed

(e.g.  $\frac{1000}{600}$ ,  $\frac{1000}{600}$ ,  $\frac{1000}{800}$ ,  $\frac{1000}{600}$ , 🌀)

### Easy-Iron

(👔, **Anti-Crease**)

For a gentle final spin with subsequent fluffing. Residual moisture of the laundry is increased slightly.

### Aqua Plus

(💧, **Aqua Plus**)

Increased water level and additional rinse cycle, extended washing time. For

areas with very soft water or for further enhancing the rinsing result.

### Rinse Plus

(🚰, **Rinse Plus**)

Additional rinse cycle. For areas with very soft water or for further enhancing the rinsing result.



## Operating the appliance

**Note: Correctly install and connect** the washing machine. From  
→ Page 12

Before the first wash, run a wash  
**without** any laundry. → Page 17

## Preparing the washing machine

### Notes

- Never switch on a damaged washing machine.
  - Inform the after-sales service.  
→ Page 34
1. Connect the mains plug.
  2. Turn on the tap.
  3. Open the washing machine door.
  4. Check that the drum is completely drained. Drain if necessary.

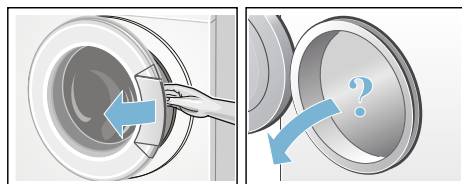

## Select programme/switch on the appliance

Use the programme selector to select the programme you require. The programme selector can be turned in either direction.

## Select additional programme settings

By selecting additional settings, you can better adapt the washing process to your items of laundry.

The settings can be selected or deselected depending on the progress of the programme.

The button indicator lamps light up if a setting is activated.

The settings are not saved when the appliance is switched off.

Additional settings → *Page 24*

Programme overview from →  
Supplementary sheet for the installation and operating instructions

## Placing laundry into the drum

### **Warning**

#### **Danger of death!**

Items of laundry pretreated with solvent-based cleaning agents, e.g. stain remover/cleaning solvent, may cause an explosion after being loaded into the washing machine.

Hand-rinse these items of laundry thoroughly beforehand.

### **Notes**

- Mix items of laundry of varying sizes. Laundry items of different sizes distribute themselves better during the spin cycle. Washing laundry items individually may result in an unbalanced load.

- Do not exceed the specified maximum load. Overfilling the appliance adversely affects the washing result and encourages creasing.

1. Unfold pre-sorted items of laundry before placing them in the washing drum.
2. Make sure that no items of laundry are trapped between the washing machine door and the rubber seal when you close the door.

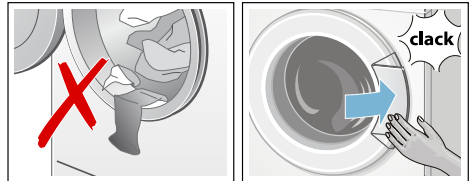

The indicator light of the Start button flashes.

## Measure and add detergent and care products

### **Caution!**

#### **Damage to the appliance**

Cleaning agents and agents for pretreating laundry (e.g. stain removers, prewash sprays, etc.) may cause damage if they come into contact with the surfaces of the washing machine. Do not allow these agents to come into contact with the surfaces of the washing machine. If necessary, immediately wipe away spray residue and other residues/droplets with a damp cloth.

## Measuring

Dose the detergents and care products according to:

- The water hardness (ask your water supply company)
- The manufacturer's instructions on the packaging
- The amount of laundry
- Soiling → *Page 23*

## Filling

### **Warning** **Eye/skin irritation!**

Detergent and care products may run out if the detergent drawer is opened while the machine is in operation. Open the drawer carefully. Rinse eyes/skin thoroughly if they come into contact with detergents or care products. If swallowed accidentally, seek medical advice.

## Notes

- When measuring the amount of all detergents, additives, care products and cleaning agents, always follow the manufacturer's instructions.
- Dilute thick-consistency fabric softener and fabric conditioner with a little water. This will prevent blockages.
- Pour liquid detergent into the corresponding dispenser and place it in the drum.

Pour the detergent and care products into the appropriate compartments:

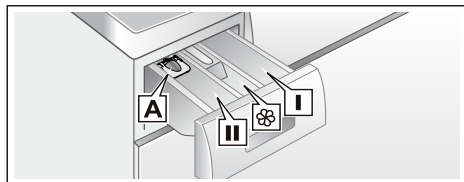

Measuring aid\* For liquid detergent

**A**

Compartment **II** Detergent for the main wash, water softener, bleach, stain remover

Compartment  Softener, starch, do not exceed the maximum

Compartment **I** Detergent for prewash

1. Pull out the detergent drawer as far as possible.
2. Add detergent and/or care products.
3. Close the detergent drawer.

## Measuring aid\* for liquid detergent

\*depending on the model

Position the measuring aid for dosing the correct amount of liquid detergent:

1. Pull out the detergent drawer. Press down the insert and fully remove the drawer.
2. Slide the measuring aid forward, fold it down and click it into place.
3. Reinsert the drawer.

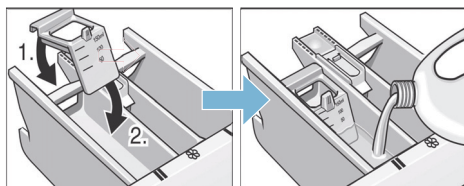

**Note:** Do not use the measuring aid for gel detergents and washing powder, or for programmes with prewash.

**For models without a measuring aid,** pour the liquid detergent into the appropriate dispenser and place it in the drum.

## Start the programme

Press the **Start button**. The indicator light will be lit and the programme will start\*.

\*The **Start button** indicator light, depending on the model

## Changing the programme

If you have started the wrong programme by mistake, you can change it as follows:

1. Press the **Start button** to cancel the programme.
2. Select a different programme.
3. Press the **Start button** again. The new programme starts from the beginning.

## Cancel the programme

1. Press the **Start button** to cancel the programme.
2. To cool the laundry: Select the **Rinse** programme.
3. Press the **Start button** again. The Rinse programme starts.

After the programme has ended, you can remove the laundry.

## Programme end during

### ▽ Rinse Stop

The ▽ **Rinse Stop** indicator light will be lit and the Ⓢ **Spin** and **Start button** indicator lights will flash\*.

\*The **Start button** indicator light, depending on the model

To end the programme:

1. Select the **Spin** or **Empty** programme.
2. Press the **Start button**.  
(Setting depends on the model)

## Programme end

The Ⓢ **Spin** and **Start button** indicator lights will flash\*.

\*The **Start button** indicator light, depending on the model

## Removing laundry/switching off the appliance

1. Open the washing machine door and remove the laundry.  
**Note:** If you cannot open the washing machine door, the appliance is still locked. Wait until the programme has ended.
2. Set the programme selector to the **Off** position. The appliance is switched off.
3. Turn off the tap.

**Note:** Not required for AquaStop models.

Scope of delivery → Page 12

### Notes

- Do not leave any items of laundry in the drum. They may shrink in the next wash or discolour another item.
- Remove any foreign objects from the drum and the rubber seal – risk of rusting.

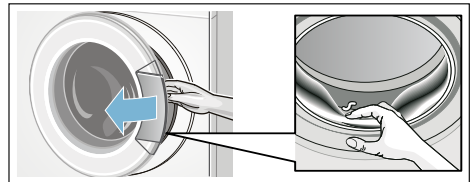

- Leave the washing machine door and detergent drawer open so that any residual water can evaporate.
- Always remove the laundry.
- Always wait until the programme has ended, as the appliance could still be locked.



## Sensors

### Automatic load sensing

The automatic load sensing function optimally adjusts the water consumption to each programme depending on the type of fabric and the load.

### Unbalanced load detection system

The automatic unbalanced load detection system detects imbalances and ensures even distribution of the laundry by repeatedly starting and stopping drum spinning.

If the laundry is extremely unevenly distributed, the speed is reduced or the spin cycle is not performed for safety reasons.

**Note:** Place large and small items of laundry in the drum (from → *Page 32*).



## Cleaning and maintenance



### Warning Risk of death!

There is a risk of electric shock if live components are touched. Switch off the appliance and pull out the mains plug.



### Warning Risk of poisoning!

Toxic vapours can be produced from cleaning agents that contain solvents, e.g. cleaning solvent. Do not use cleaning agents that contain solvents.

### Caution!

#### Damage to the appliance

Cleaning agents that contain solvents, e.g. cleaning solvent, can damage surfaces and components in the machine.

Do not use cleaning agents that contain solvents.

### Machine housing/control panel

- Wipe the housing and the control panel with a soft, damp cloth.
- Do not use any abrasive cloths, scourers or cleaning agents (stainless-steel cleaners).
- Remove the detergent residue immediately.
- Cleaning with a water jet is prohibited.

### Drum

Wipe the inside of the rubber seal dry with a cloth. Leave the washing machine door open so that the drum can dry. Use chlorine-free cleaning agents; do not use steel wool.

**Note:** In order to keep the washing machine clean, run it through on the **Cottons 90 °C** programme on a regular basis.

### Descaling

**Note:** Make sure that there is no laundry in the machine.

Descaling should not be necessary if the detergent is measured out correctly. However, if it is required, follow the manufacturer's instructions for the descaling agent. Suitable descalers can be obtained via our website or from our after-sales service. → *Page 34*

## Detergent drawer and housing

If there is detergent or fabric softener residue:

1. Pull out the detergent drawer. Press down the insert and fully remove the drawer from the housing.
2. To remove the insert: Push the insert upwards from below with your finger.

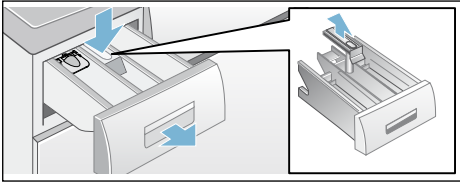

3. Clean the detergent dispenser tray and insert with water and a brush, and dry. Also remove any detergent or fabric softener residue in the housing.
4. Fit the insert and lock it in place (push the cylinder onto the guide pin).
5. Push in the detergent drawer.

**Note:** Leave the detergent drawer open so that any residual water can evaporate.

## Detergent solution pump blocked

### **Warning** **Risk of scalding!**

When washing at high temperatures, the detergent solution becomes hot. If you come into contact with the hot detergent solution, you may be scalded. Allow the detergent solution to cool down.

1. Turn off the water tap so that no more water can flow in and has to be drained via the detergent solution pump.
2. Switch off the appliance. Pull out the mains plug.

3. Open and remove the service flap.

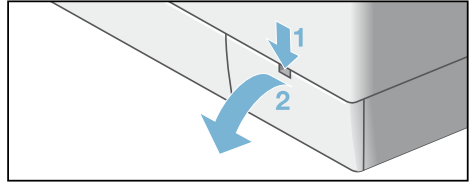

4. For models:
  - **With a drainage hose:** Remove the drainage hose from its holder and remove the sealing cap. Allow the detergent solution to flow out into a suitable container. Replace the sealing cap on the drainage hose, and place the drainage hose back in its holder.

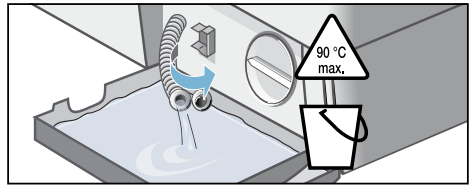

- **Without a drainage hose::** Carefully unscrew the pump cover until the detergent solution begins to flow out. When the service flap is half full, close the pump cover and drain the service flap. Repeat the above steps until all the detergent solution has completely drained out.

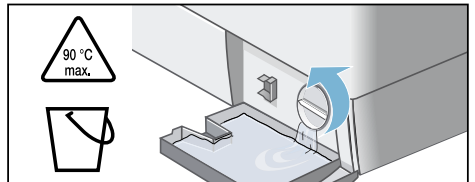

5. Carefully unscrew the pump cover; residual water may leak out. Clean the interior, pump-cover thread and pump housing. The impeller in the detergent solution pump must be able to rotate.

Refit and screw on the pump cover. The handle must be in a vertical position.

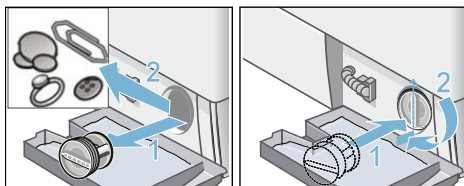

6. Put the service flap back on, lock it into place and close it.

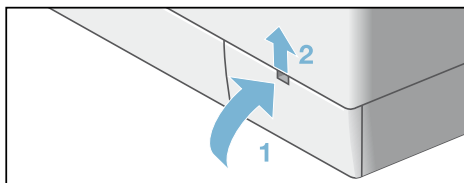

**Note:** To prevent unused detergent from flowing straight into the drain during the next wash: Pour 1 litre of water into compartment II and start the **Empty** programme.

## The drain hose at the siphon is blocked

1. Switch off the appliance. Pull out the mains plug.
2. Loosen the hose clamp. Carefully remove the drain hose; residual water may leak out.
3. Clean the drain hose and siphon connecting piece.

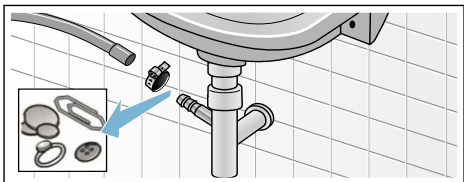

4. Re-attach the drain hose and secure the connection point using the hose clamp.

## Filter in the water supply blocked

**Warning**  
**Risk of electric shock!**

Do not immerse the AquaStop safety valve in water (it contains an electric valve).

First, reduce the water pressure in the supply hose:

1. Turn off the tap.
2. Select any programme (except **Rinse/Spin/Empty**).
3. Press the **Start button**. Allow the programme to run for approximately 40 seconds.
4. Set the programme selector to the **Off** position. Pull out the mains plug.
5. Clean the filter on the tap:  
Disconnect the hose from the tap.  
Clean the filter with a small brush.

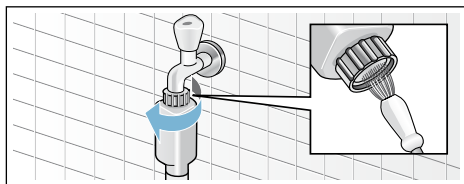

6. For standard and AquaSecure models, clean the filter on the rear of the appliance:  
Disconnect the hose from the rear of the appliance,  
Use pliers to remove the filter and then clean it.

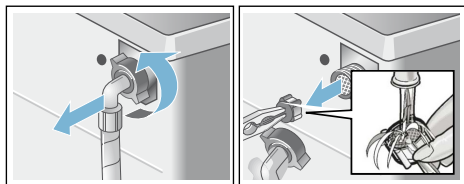

7. Connect the hose and check for leaks.

## **Faults and what to do about them.**

### **Emergency release**

E.g. in the event of a power cut

The programme continues when the power supply is restored.

However, if the laundry has to be removed, the washing machine door can be opened as follows:

#### **Warning**

##### **Risk of scalding!**

When you are washing at high temperatures, there is a risk of scalding if you come into contact with hot detergent solution and laundry. If possible, leave it to cool down first.

#### **Warning**

##### **Risk of injury!**

Reaching into the drum while it is still turning may cause hand injuries. Do not reach into the drum when it is turning. Wait until the drum has stopped turning.

#### **Caution!** **Water damage**



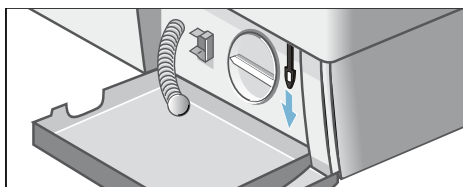

Any escaping water may cause water damage.

Do not open the washing machine door if water can be seen through the glass.



1. Switch off the appliance. Pull out the mains plug.
2. Drain the detergent solution
3. Use a tool to pull the emergency release downwards and then release.  
The washing machine door can then be opened.

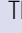
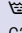
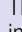

## **Information about the indicator lights**

Indicator/symbol	Cause/remedy
The  <b>Rinse</b> and  <b>Wash</b> status indicators are flashing	Close the washing machine door properly; washing may be trapped.
The  <b>Spin</b> and  <b>Wash</b> status indicators are flashing	<ul style="list-style-type: none"> <li>■ Turn the tap on fully,</li> <li>■ The supply hose is kinked/trapped,</li> <li>■ The water pressure is too low. Clean the filter → <i>Page 30</i></li> </ul>
The  <b>Spin</b> and  <b>Rinse</b> status indicators are flashing	<ul style="list-style-type: none"> <li>■ The drain pump is blocked. Clean the drain pump → <i>Page 29</i></li> <li>■ The drain hose/drain pipe is blocked. Clean the drain hose at the siphon → <i>Page 30</i></li> </ul>
The  <b>Rinse</b> status indicator is flashing	Motor fault. Call the after-sales service.
All the status indicators are flashing	Turn off the tap. Call the after-sales service.

## Faults and what to do about them.

Faults	Cause/remedy
Water is leaking from the appliance.	<ul style="list-style-type: none"> <li>■ Attach the drain hose correctly or replace it. → <i>Page 15</i></li> <li>■ Tighten the threaded joint on the supply hose. → <i>Page 15</i></li> </ul>
The appliance is not filling with water.	<ul style="list-style-type: none"> <li>■ Has the <b>Start button</b> been pressed?</li> <li>■ Is the tap turned on? → <i>Page 15</i></li> </ul>
Detergent is not being dispensed.	<ul style="list-style-type: none"> <li>■ Could the filter be clogged? Clean the filter. → <i>Page 30</i></li> <li>■ Is the supply hose kinked or trapped?</li> </ul>
The door will not open.	<ul style="list-style-type: none"> <li>■ The safety function is active. Do you want to cancel the programme? → <i>Page 27</i></li> <li>■ Is  <b>Rinse Stop</b>* selected (no final spin)?</li> <li>■ Can the door only be opened by the emergency release? → <i>Page 31</i></li> </ul>
The programme will not start.	<ul style="list-style-type: none"> <li>■ Has the <b>Start button</b> been pressed to pause the programme?</li> <li>■ Is the door closed?</li> </ul>
The water is not draining.	<ul style="list-style-type: none"> <li>■ Is  <b>Rinse Stop</b>* selected (no final spin)?</li> <li>■ Clean the drain pump. → <i>Page 29</i></li> <li>■ Clean the drain pipe and/or the drain hose. → <i>Page 30</i></li> </ul>
Water is not visible in the drum.	<ul style="list-style-type: none"> <li>■ Not a fault – the water is below the visible area.</li> </ul>
The spin result is not satisfactory.	<ul style="list-style-type: none"> <li>■ Not a fault – the unbalanced load detection system has interrupted the spin because the laundry is unevenly distributed.</li> </ul>
Laundry wet/too damp.	<ul style="list-style-type: none"> <li>■ Distribute small and large items of laundry evenly in the drum.</li> <li>■ Has the additional programme setting for  <b>Easy-Iron</b>* been selected?</li> <li>■ Is the selected speed too low?</li> </ul>
The spin cycle starts up several times.	<ul style="list-style-type: none"> <li>■ Not a fault – the unbalanced load detection system is adjusting an imbalance.</li> </ul>
Residual water in the care product dispenser.	<ul style="list-style-type: none"> <li>■ Not a fault – the effectiveness of the care product is not affected.</li> <li>■ If necessary, clean the insert and detergent drawer. → <i>Page 29</i></li> </ul>
Odours or greasy deposits in the washing machine.	<ul style="list-style-type: none"> <li>■ Run the <b>Cottons 90 °C</b> programme without any laundry. Use standard detergent for this.</li> </ul>
Foam leaking from the detergent drawer.	<ul style="list-style-type: none"> <li>■ Have you used too much detergent? Mix one tablespoon of fabric softener with 1/2 litre of water and pour into compartment <b>II</b> (not for outdoor clothing or items made with down). Use less detergent in the next wash cycle.</li> </ul>
Loud noises, vibrations and machine “wandering” during the spin cycle.	<ul style="list-style-type: none"> <li>■ Is the appliance level? Make the appliance level. → <i>Page 16</i></li> <li>■ Are the appliance's feet secured? Secure the appliance's feet. → <i>Page 16</i></li> <li>■ Have the transportation braces been removed? Remove the transportation braces. → <i>Page 13</i></li> </ul>
Noises during spin and drain cycles.	<ul style="list-style-type: none"> <li>■ Clean the drain pump → <i>Page 29</i></li> </ul>
* Depends on the model	

Faults	Cause/remedy
The indicator lights do not work while the appliance is running.	<ul style="list-style-type: none"> <li>■ Has there been a power failure?</li> <li>■ Has the fuse blown/has the circuit breaker tripped? Switch the circuit breaker on/replace the fuse.</li> <li>■ If the fault occurs repeatedly, call the after-sales service. → <i>Page 34</i></li> </ul>
There is detergent residue on the laundry.	<ul style="list-style-type: none"> <li>■ Some phosphate-free detergents contain water-insoluble residue.</li> <li>■ Select the <b>Rinse</b> programme or brush the laundry after washing.</li> </ul>
<p>If you cannot rectify a fault yourself (after switching the machine off and then on again) or a repair is required:</p> <ul style="list-style-type: none"> <li>■ Set the programme selector to the <b>Off</b> position. The appliance is now switched off.</li> <li>■ Unplug the mains plug from the socket.</li> <li>■ Turn off the tap and call the after-sales service. → <i>Page 34</i></li> </ul>	
* Depends on the model	



## After-sales service

If you cannot rectify the fault yourself (Faults – what to do? → *Page 34*), please contact customer services. → Cover page

We will always find an appropriate solution to avoid unnecessary visits by engineers.

Please provide the after-sales service with the product number (E no.) and the production number (FD) of the appliance.

E-Nr. _____ FD _____	
Product number	Production number

You can find this information (\* depending on the model):

On the inside of the washing machine door\*/in the opened service flap\* and on the rear of the appliance.

### **Trust the expertise of the manufacturer.**

Contact us. By doing so, you can be sure that the repairs are carried out by trained service personnel using genuine spare parts.



## Technical data

### **Dimensions:**

850 x 600 x 550 mm  
(height x width x depth)

### **Weight:**

68 - 75 kg (depending on model)

### **Mains connection:**

Mains voltage 220 - 240 V/50 Hz

Nominal current 10 A

Nominal power 2000 – 2300 W

### **Water pressure:**

100 - 1000 kPa (1 - 10 bar)

### **Power consumption when switched off:**

0.20 W

### **Power consumption when ready for use (left-on mode):**

1.90 W

This image shows a full page of blank white paper with horizontal ruling lines. The lines are evenly spaced and run across the width of the page, providing a template for writing or drawing. There are no margins, text, or other markings on the page.



### **Advice and repair order in the event of faults**

GB 0344 892 8979 (Calls charged at local or mobile rate.)  
IE 01450 2655 (0.03 € per minute at peak. Off peak 0.0088 € per minute.)

You can find the contact information for all countries in the attached after-sales service directory.

Robert Bosch Hausgeräte GmbH  
Carl-Wery-Straße 34  
81739 München, GERMANY



9001271126 (9902)