

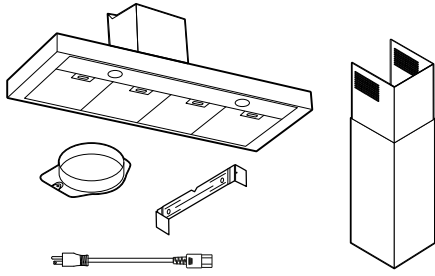

9001193313 960517

en Installation instructions

zh-tw 安裝說明



- 2 x
- 2 x
- 6 x
- 6 x
- 2 x



A

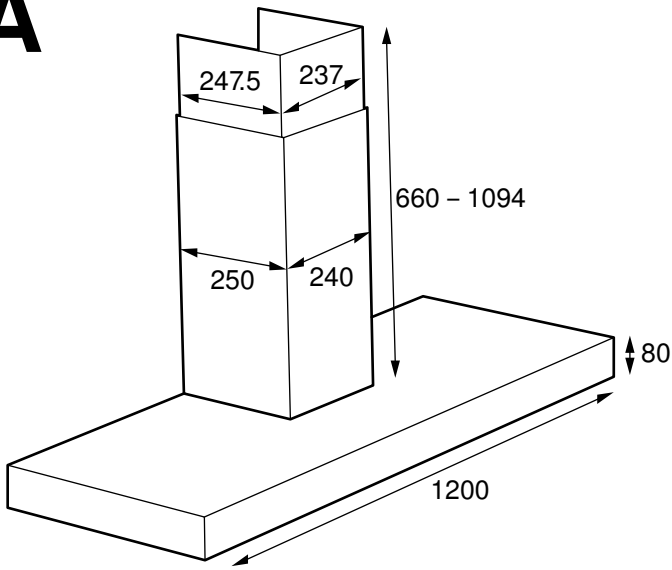

B

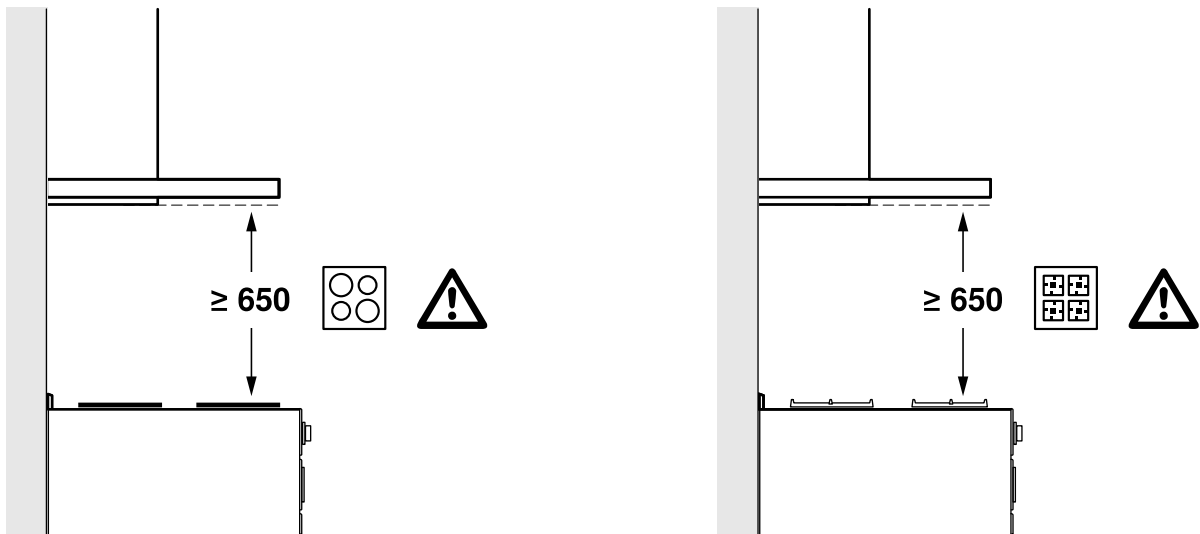

1

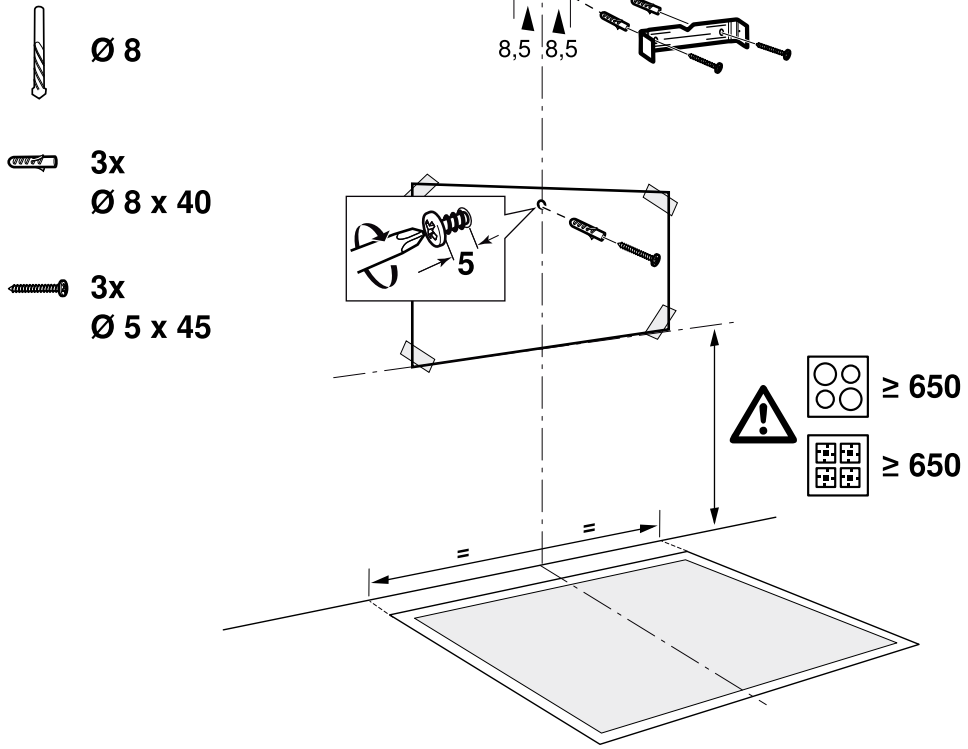

2

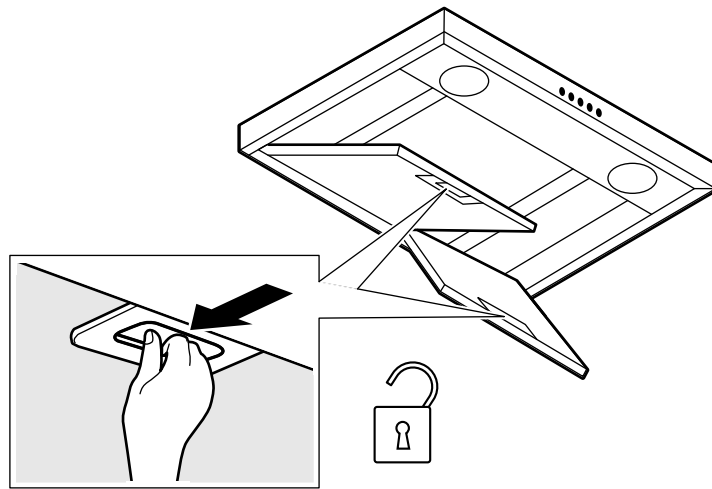

3 a

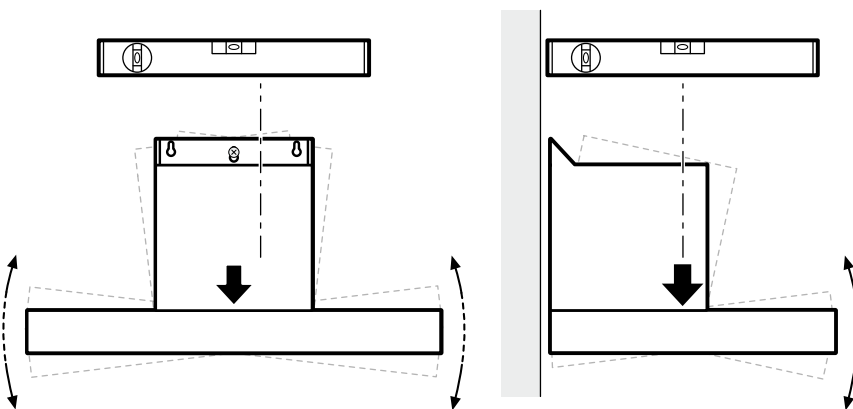

b

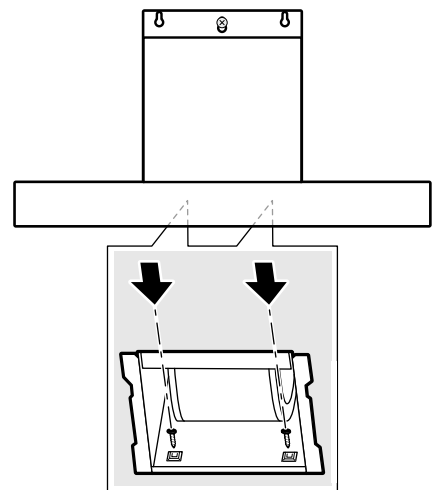

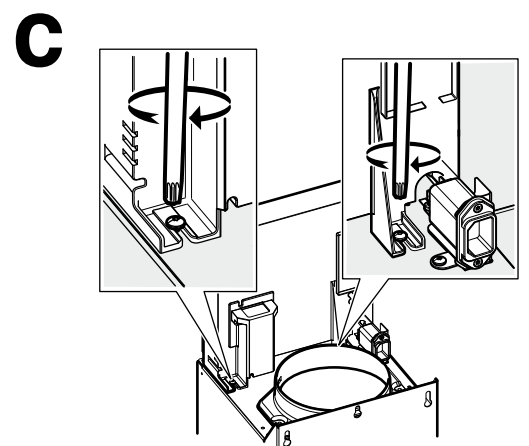
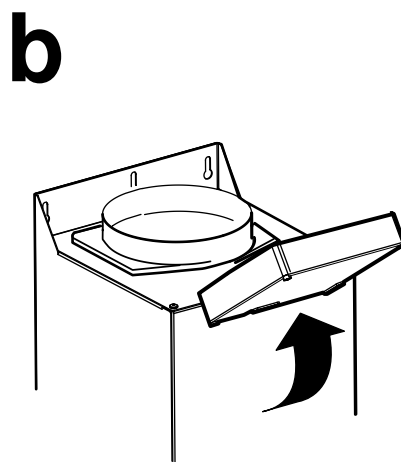
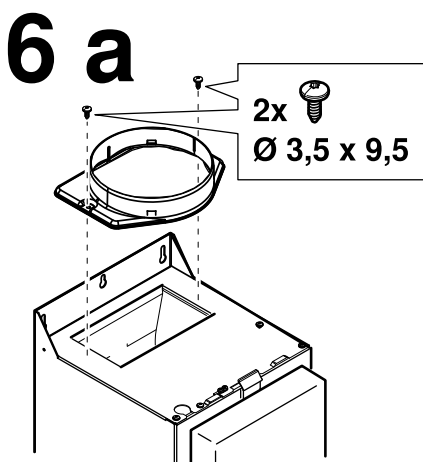
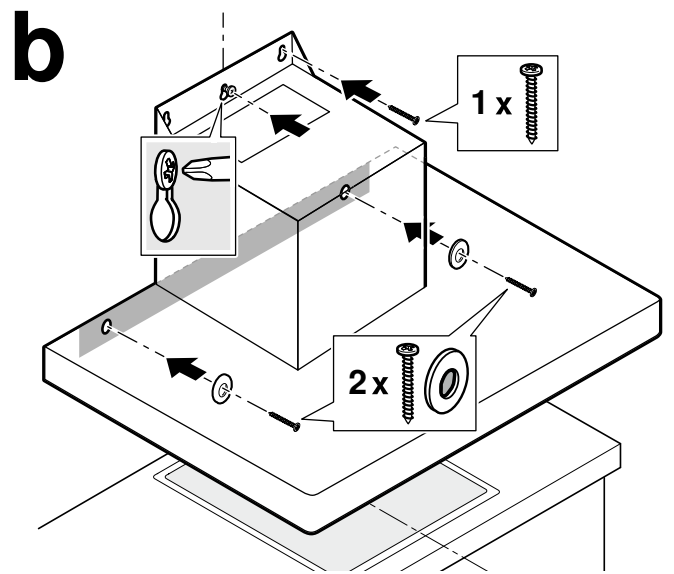
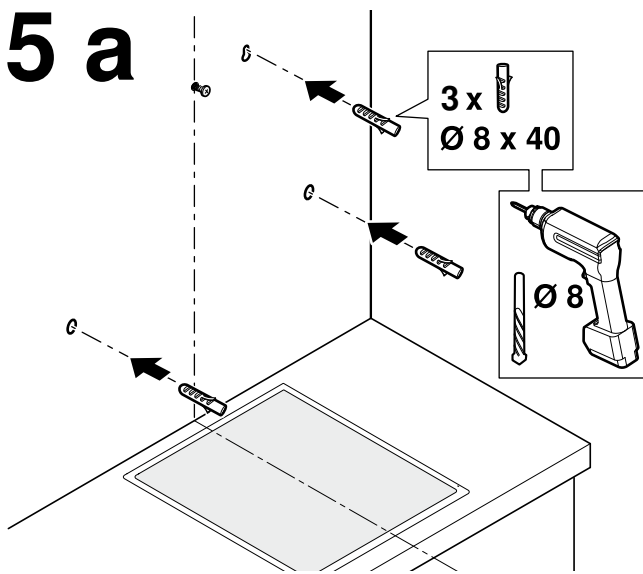
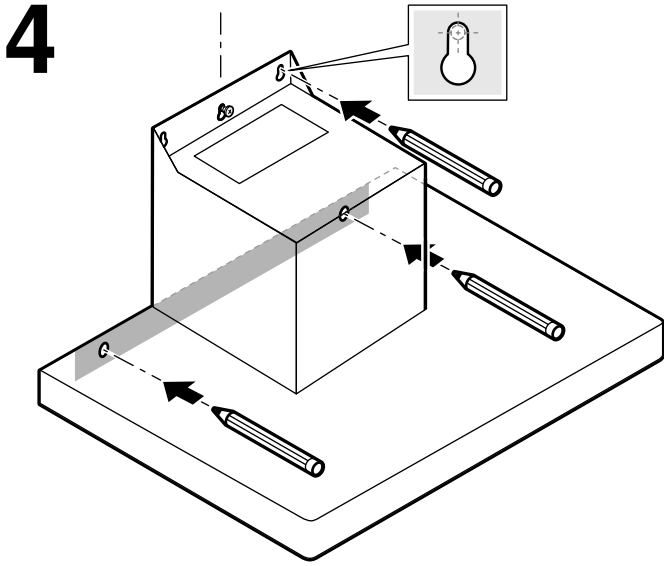

7

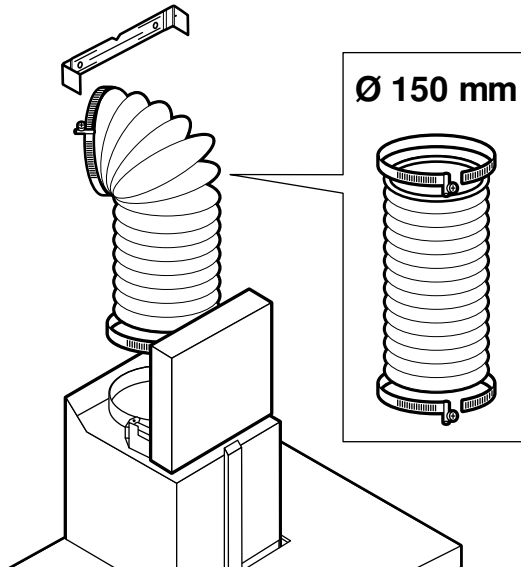

8

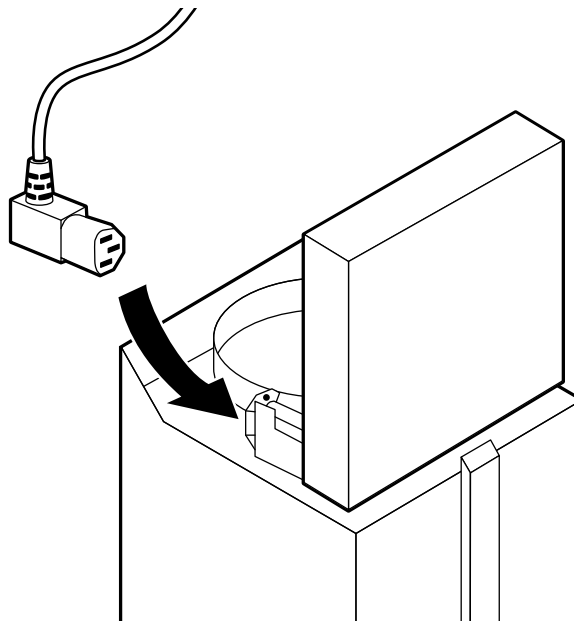

9 a

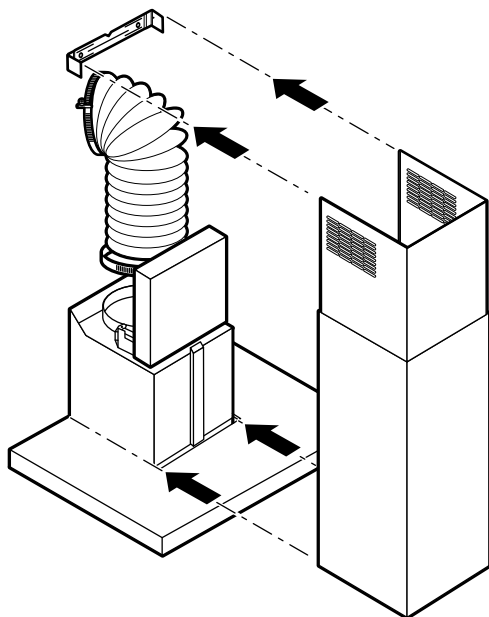

b

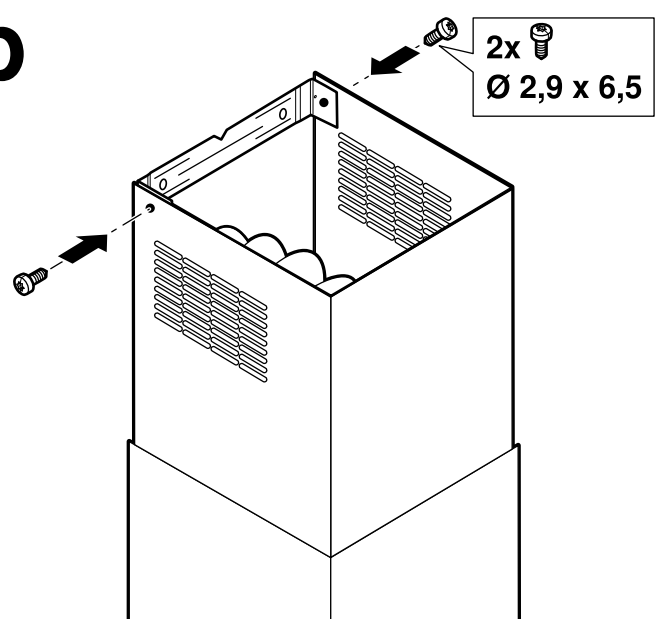

⚠ Important safety information

Read these instructions carefully. Only then will you be able to operate your appliance safely and correctly. Retain the instruction manual and installation instructions for future use or for subsequent owners.

Check the appliance for damage after unpacking it. Do not connect the appliance if it has been damaged in transport.

The appliance can only be used safely if it is correctly installed according to the safety instructions. The installer is responsible for ensuring that the appliance works perfectly at its installation location.

The width of the extractor hood must correspond at least with the width of the hob.

For the installation, observe the currently valid building regulations and the regulations of the local electricity and gas suppliers.

When conveying the exhaust air, official and legal regulations (e.g. state building regulations) must be followed.

Danger of death!

Risk of poisoning from flue gases that are drawn back in.

Always ensure adequate fresh air in the room if the appliance is being operated in exhaust air mode at the same time as room air-dependent heat-producing appliance is being operated.

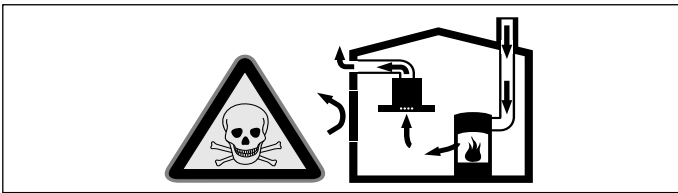

Room air-dependent heat-producing appliances (e.g. gas, oil, wood or coal-operated heaters, continuous flow heaters or water heaters) obtain combustion air from the room in which they are installed and discharge the exhaust gases into the open air through an exhaust gas system (e.g. a chimney).

In combination with an activated vapour extractor hood, room air is extracted from the kitchen and neighbouring rooms - a partial vacuum is produced if not enough fresh air is supplied. Toxic gases from the chimney or the extraction shaft are sucked back into the living space.

- Adequate incoming air must therefore always be ensured.
- An incoming/exhaust air wall box alone will not ensure compliance with the limit.

Safe operation is possible only when the partial vacuum in the place where the heat-producing appliance is installed does not exceed 4 Pa (0.04 mbar). This can be achieved when the air needed for combustion is able to enter through openings that cannot be sealed, for example in doors, windows, incoming/exhaust air wall boxes or by other technical means.

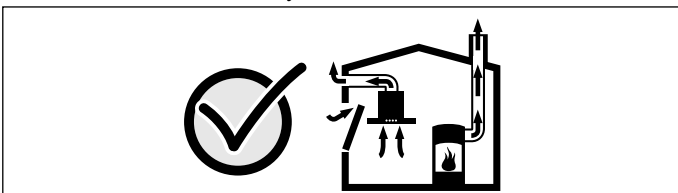

In any case, consult your responsible Master Chimney Sweep. He is able to assess the house's entire ventilation setup and will suggest the suitable ventilation measures to you.

Unrestricted operation is possible if the vapour extractor hood is operated exclusively in the circulating-air mode.

Risk of death!

Risk of poisoning from flue gases that are drawn back in. The exhaust air must not be conveyed into a functioning smoke or exhaust gas flue or into a shaft which is used to ventilate installation rooms that contain heating appliances. If the exhaust air is to be conveyed into a non-functioning smoke or exhaust gas flue, you must obtain the consent of the heating engineer responsible.

Danger of suffocation!

Packaging material is dangerous to children. Never allow children to play with packaging material.

Risk of electric shock!

Components inside the appliance may have sharp edges. These may damage the connecting cable. Do not kink or pinch the connecting cable during installation.

Risk of fire!

- Fatty deposits in the grease filter may catch fire. The specified safety clearances must be complied with in order to prevent a build-up of heat. Refer to the information provided for your cooker. If gas and electric hobs are being operated together, the largest specified clearance applies.

The appliance must be installed with no more than one side directly next to a high-sided unit or a wall. The clearance between the appliance and the wall or high-sided unit must be at least 500 mm.

- Grease deposits in the grease filter may catch fire. Never work with naked flames close to the appliance (e.g. flambéing). Do not install the appliance near a heat-producing appliance for solid fuel (e.g. wood or coal) unless a closed, non-removable cover is available. There must be no flying sparks.

Risk of injury!

- Components inside the appliance may have sharp edges. Wear protective gloves.
- The appliance may fall down if it has not been properly fastened in place. All fastening components must be fixed firmly and securely.
- The appliance is heavy. To move the appliance, 2 people are required. Use only suitable tools and equipment.
- Changes to the electrical or mechanical assembly are dangerous and may lead to malfunctions. Do not make any changes to the electrical or mechanical assembly.

General information

Caution!

Damage to the appliance

The surfaces of the appliance are sensitive. Avoid damaging them during installation.

Exhaust air mode

Note: The air must not be discharged into a flue that is used for exhausting fumes from appliances burning gas or other fuels (not applicable to appliances that only discharge the air back into the room).

- Before conveying the exhaust air into a non-functioning smoke or exhaust gas flue, obtain the consent of the heating engineer responsible.
- If the exhaust air is conveyed through the outer wall, a telescopic wall box should be used.

Exhaust duct

Note: The device manufacturer does not assume any warranty for complaints attributable to the pipe section.

- The device achieves its optimum performance by means of a short, straight exhaust air pipe and as large a pipe diameter as possible.
- As a result of long rough exhaust air pipes, many pipe bends or pipe diameters that are smaller than 150 mm, the optimum extraction performance is not achieved and fan noise is increased.
- The pipes or hoses for laying the exhaust air line must consist of non-combustible material.

Round pipes

An inner diameter of 150 mm, but at least 120 mm, is recommended.

Flat ducts

The inner cross-section must correspond to the diameter of the round pipes.

dia. 150 mm ca. 177 cm²

dia. 120 mm ca. 113 cm²

- Flat ducts should not have any sharp deflections.
- Use sealing strips for deviating pipe diameters.

Circulating-air mode

Note: The appliance must only be operated when it is securely installed and the pipework is connected.

Electrical connection

⚠ Risk of electric shock!

Components inside the appliance may have sharp edges. These may damage the connecting cable. Do not kink or pinch the connecting cable during installation.

The required connection data can be found on the rating plate inside the appliance; to do this, remove the metal mesh grease filter.

This appliance complies with the EC interference suppression regulations.

This appliance may be connected to a correctly installed earthed socket only.

Attach the earthed socket preferably inside the flue duct.

- The earthed socket should be connected via its own circuit.
- If the earthed socket is no longer accessible following installation of the appliance, a disconnecter must be fitted as for a permanent connection.

If a permanent connection is required, the installation must feature an all-pole disconnecter (circuit breakers, fuses and contactors) with a min. 3 mm contact opening. The permanent connection may be installed by an electrician only.

Preparing for installation

Checking the wall

- The wall must be level, vertical and adequately load-bearing.
- The depth of the bore holes must be the same length as the screws. The wall plugs must have a secure grip.
- The enclosed screws and wall plugs are suitable for solid brickwork. Suitable fasteners must be used for other structures (e.g. plasterboard, porous concrete, perforated bricks).
- The maximum weight of the extractor hood is **16 kg**.

Appliance dimensions and safety clearances

- Observe the appliance's dimensions. **(Fig. A)**
- Comply with the safety clearances. **(Fig. B)**

If the installation instructions for the gas cooking appliance specify a different distance, the larger of the two must always be provided for.

Preparing the wall

Caution!

Ensure that there are no electric wires, gas or water pipes in the area where holes are to be made.

1. Mark a vertical centre line on the wall from the ceiling to the lower edge of the extractor hood. **(Fig. 1)**
2. Mark holes for the angle brackets in the chimney. The centre of the angle bracket is marked with a notch. Place the angle brackets in the middle of the centre line, align them horizontally and mark the positions of the holes. The distance X between the two angle brackets is the same as the length of the upper part of the chimney.
3. Mark holes for the appliance's mounting brackets.
4. Drill the holes.
5. Press in the wall plugs flush with the wall.

Fitting the wall bracket

1. Screw on the fixing bracket for the flue duct. **(Fig.1)**
2. Screw in the screws for the appliance bracket loosely; do not tighten them fully. **(Fig.1)**

Preparing the appliance

1. Take hold of the filter cover with two hands and open it. **(Fig.2)**
2. Remove the metal grease filter.

Installing the appliance

⚠ Risk of injury!

Components inside the appliance may have sharp edges. Wear protective gloves.

⚠ Risk of injury!

The appliance is heavy. To move the appliance, 2 people are required. Use only suitable tools and equipment.

Attaching and aligning the appliance

⚠ Risk of injury!

Components inside the appliance may have sharp edges. Wear protective gloves.

1. First remove the protective foil from the back of the appliance and, following installation, remove the foil completely.
2. Fit the appliance.
3. Align the appliance horizontally. **(Fig.3a)**
4. Align the appliance horizontally by turning the screws on the mounting brackets. The screws are accessible from the inside of the appliance. **(Fig.3b)**
5. Mark the upper right and lower holes. **(Fig.4)**
6. Disconnect the appliance.
7. Drill screw holes for the upper right and lower holes. **(Fig.5a)**
8. Fit the appliance.
9. Tighten the screws. **(Fig.5b)**
10. Install the metal grease filters.

Connecting the appliance

Connecting the air extractor and establishing a connection to the mains

Notes

- For exhaust-air operation, a backflow flap should be fitted. If a backflow flap has not been included with the appliance, it can be obtained from a specialist retailer.
- If the exhaust air is conveyed through the outer wall, a telescopic wall box should be used.

Establishing the connection for the exhaust air

Note: If an aluminium pipe is used, smooth the connection area beforehand.

1. Tighten the backflow flap. **(Fig.6a)**
2. Swivel the motor control upwards **(Fig.6b)** and tighten it. **(Fig.6c)**
3. Attach the exhaust air pipe directly to the air pipe connector. **(Fig.7)**
4. Connect it to the exhaust air opening.
5. Seal the joints appropriately.

Connecting the power supply

1. Plug the mains plug into the earthed socket. **(Fig.8)**
2. If a fixed connection is required, follow the instructions in the Electrical connection section.

Attaching the flue duct

⚠ Risk of injury!

Components inside the appliance may have sharp edges. Wear protective gloves.

1. Remove the protective foil from both flue ducts.
2. Fit the upper flue duct. Gently bend the two side panels on the upper flue duct away from each other, hook them in behind the angle brackets and push them together as far as they will go. **(Fig.9a)**

Note: If recirculation is required, fit the flue duct with its slots facing downwards.

3. Screw in the upper flue duct at the side to both angle brackets. **(Fig.9b)**
4. Fit the lower flue duct. Gently push the two side panels of the lower flue duct apart and hook them in behind the upper flue duct.

Note: To prevent scratches, lay paper over the edges of the lower flue duct to protect the surface.

5. Press together the lower flue duct fully and screw it onto the side of the appliance.

Removing the appliance

1. Disconnect the appliance from the power supply.
2. Remove the flue duct.
3. Loosen the exhaust air lines.
4. Remove the metal grease filter.
5. Unscrew in the screws for the appliance bracket slightly; do not loosen them fully.
6. Remove the appliance.
7. Remove the angle bracket for the flue duct.

⚠ 重要安全資訊

請詳細閱讀說明。才可以安全且正確地使用本產品。請妥善保管說明手冊及安裝說明，以便未來使用或交給下一位持有人。
開箱後請檢查電器有無損壞。若在運送過程中已發生損壞，請勿將電器連接電源。

請按照安全指示正確安裝電器，以確保能安全使用。安裝者須負責確保電器在安裝位置運作正常。

排油煙機的寬度必須至少與爐面寬度對應。

安裝時，請遵從有效的建築條例以及當地電力和瓦斯公司的相關規定。

排放廢氣時，務必遵循政府與法規規定，例如建築法規。

致命危險！

倒吸的廢氣可能會導致中毒。

使用此電器的消耗空氣模式時，如果同時使用依賴室內空氣的製熱裝置，務必確保室內有足夠的新鮮空氣。

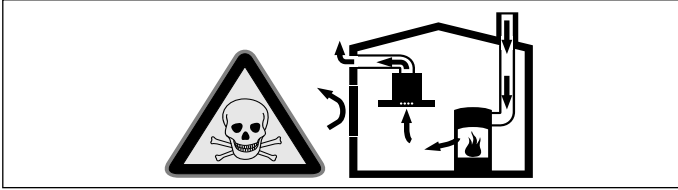

依賴室內空氣的製熱裝置（例如以瓦斯、汽油、木材或以煤炭為燃料的暖爐、續流式暖爐或熱水器）係從其安裝處取得空氣加以燃燒，再經由排氣系統（例如煙囪）將廢氣排放至室外。

抽油煙機運作時，也會從廚房與鄰近房間抽走室內空氣，如果新鮮空氣不足，將形成局部真空狀態。煙囪或抽氣豎井中的有毒氣體，會被倒吸入起居空間內。

- 因此請確保有適量的新鮮空氣進入室內。
- 單靠進氣 / 排氣牆箱無法確保足量空氣流入。

為確保安全運作，製熱電器安裝處的局部真空程度不得超過 4 帕斯卡 (0.04 毫帕)。只要讓燃燒所需的空氣能夠從非密閉的缺口進入，例如門、窗戶、進氣 / 排氣牆箱或藉由其他技術性手段，即可滿足上述要求。

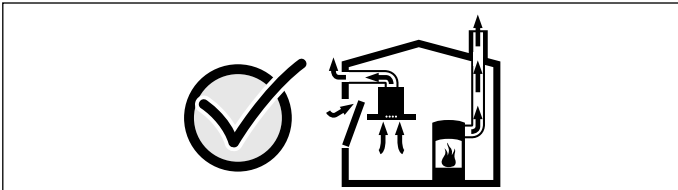

如有任何狀況，請向負責打掃煙囪的專業人員查詢。該人員可以評估整個房子的通風設施，建議合適的通風方法。

如果抽油煙機單以循環空氣模式運作，則不受任何限制。

致命危險！

倒吸的廢氣可能會導致中毒。排出的廢氣不可傳送到運作中的煙霧或排氣煙道中，又或是由置有加熱設備的房間所使用的通風口。若要將廢氣排放到閒置的煙道或排氣煙道內，應先取得加熱設備工程師的同意。

窒息危險！

包裝材料可能會對兒童造成危險。請勿讓孩童將包裝材料當做玩具。

觸電風險！

電器內部零件可能有銳利邊緣。這些地方可能會讓電源連接線受損。因此，安裝時請勿彎折或擠壓電源連接線。

火災風險！

- 沈積在濾油網的油垢可能會造成火災。必須保持指定的安全距離，才能防止聚熱。請參閱烹調器具提供的資訊。如果同時使用瓦斯爐具和電子爐具，請將兩者保持指定的最大距離。

此電器僅能有一側面直接安裝至高隔間或牆面。此電器與牆面或高隔間的距離必須至少 500 mm。

- 沈積在濾油網的油垢可能會造成火災。請勿讓明火接近本電器（例如烹飪火焰）。請勿將本電器安裝在使用固態燃料加熱的電器附近（例如木材或煤炭），除非該加熱電器配有不可拆除的閉合式外罩。附近不得有火花飛濺的情況。

受傷風險！

- 電器內部零件可能有銳利邊緣。請戴上保護手套。
- 如果沒有適當固定好電器，可能會掉落。必須穩固安裝所有緊固元件。
- 電器很重。要搬動電器需要 2 個人一同合作。請使用適當的工具及裝備。
- 任何對電氣或機械配件做的變更都很危險並可能導致故障。請勿改造電氣或機械配件。

一般資訊

注意！

電器損壞

電器表面容易損傷。安裝時請避免損傷。

排氣模式

提示：空氣不得排放到用於排出設備燃燒氣體或其他燃料時所產生油煙的煙道（不適用於只會將氣體排放回室內的設備）。

- 將排出的廢氣輸送到閒置的煙霧或排氣煙道前，請先取得加熱電器工程師的同意。
- 如果廢氣排放路徑會通過外牆，請使用直筒式牆箱。

排氣管

提示：任何與管道有關的投訴，一概不在裝置製造商的保養範圍之內。

- 短型、直式且最大可能直徑的排氣管，能讓抽油煙機發揮最佳性能。
- 排氣管如果過長、凹凸不平、管子彎曲太多或直徑小於 150 mm，抽油煙機將無法發揮最佳性能，風扇噪音也會隨之增加。
- 鋪設排氣管道所使用的管子或軟管必須由不可燃材質製成。

圓管

建議內徑 150 公厘，或不少於 120 公厘。

扁平管

內側斷面必須配合圓管直徑。

直徑 150 公釐 ca. 177 公分²

直徑 120 公釐 ca. 113 公分²

- 扁平管不可偏折過大。
- 管道直徑如有差異，請使用密封條。

空氣循環模式

提示：需完整安裝後接上管路才能啟動此電器。

電源連接

△ 觸電風險！

電器內部零件可能有銳利邊緣。這些地方可能會讓電源連接線受損。因此，安裝時請勿彎折或擠壓電源連接線。

排油煙機內的標牌上列有必要的連接資料，拆下金屬濾油網即可看見標牌。

本電器符合歐盟對於干擾抑制的相關規定。

本電器僅限插入正確安裝的已接地插座。

最好能將已接地插座安裝至抽油煙管內。

- 已接地插座應連接自己的電路。
- 如果已接地插座無法再接觸到以下安裝設備，必須固定連接隔離開關。

如果需要固定式連接，安裝時必須配備一個 3 毫米接觸開口的全極隔離開關（斷路器、保險絲和接觸器）。僅限專業電工安裝固定式連接。

安裝準備事項

檢查牆壁

- 牆壁必須平整、垂直並有足夠的負載力。
- 鑽口深度必須與螺絲長度相同。壁釘必須可穩定支撐。
- 隨附的螺絲與壁釘適用於實心磚造。其他結構如石膏板、透水混凝土與粘土空心磚，必須使用合適的扣件。
- 排油煙機重量上限為 **16 kg**。

電器尺寸 與安全距離

- 觀察電器的尺寸。(圖 A)
- 遵從安全距離的指示。(圖 B)

若瓦斯爐電器的安裝指南有規定不同的距離，請務必擇其較大者。

將牆壁準備好

注意！

請確保鑽孔區域沒有電線、瓦斯管或水管。

1. 沿著天花板到排油煙機的下緣劃一條垂直中線。(圖 1)
2. 在煙囪中標示角狀支架的孔洞。角狀支架的中心以凹痕表示。將角狀支架放置中心線中央，與之水平對齊，並標記鑽孔位置。兩個角狀支架間的距離 X 與煙囪上半部的長度相同。
3. 標示此電器固定支架的孔洞。
4. 鑽孔。
5. 釘入壁釘與牆面平齊。

安裝牆面支架

1. 用螺絲鎖上排氣管的固定支架。(圖 1)
2. 將電器支架的螺絲轉鬆；不要完全鎖緊。(圖 1)

準備電器

1. 用雙手拿住濾油網蓋，將蓋子打開。(圖 2)
2. 拆下金屬濾油網。

安裝電器

△ 受傷風險！

電器內部零件可能有銳利邊緣。請戴上保護手套。

△ 受傷風險！

電器很重。要搬動電器需要 2 個人一同合作。請使用適當的工具及裝備。

裝上排油煙機並調整對齊

△ 受傷風險！

電器內部零件可能有銳利邊緣。請戴上保護手套。

1. 先從電器後方撕除保護膜，再隨著安裝進度，撕除所有保護膜。
2. 裝上電器。
3. 調整電器的水平位置。(圖 3a)
4. 轉動固定支架上的螺絲以調整抽油煙機的水平位置。於抽油煙機內部可觸得螺絲。(圖 3b)
5. 標示右上方與下方的孔洞。(圖 4)
6. 拔掉電器電源。
7. 鑽出右上方與下方孔洞的螺絲孔。(圖 5a)
8. 裝上電器。
9. 鎖緊螺絲。(圖 5b)
10. 安裝金屬濾油網。

連接 電器

接上抽風機，並與電源接上

提示

- 排氣前，應先安裝回流閥。如果排油煙機未包括回流閥，請向專業零售商查詢。
- 如果廢氣排放路徑會通過外牆，請使用直筒式牆箱。

建立排氣連接

提示：如果使用鋁製排氣管，安裝前請先將連接部位磨平。

1. 鎖緊回流閥。(圖 6a)
2. 將馬達控制器向上旋轉(圖 6b) 將它鎖緊。(圖 6c)
3. 將排氣管直接接到排氣管接頭上。(圖 7)
4. 連接至排氣口。
5. 將接合處妥善地封好。

連接電源

1. 將主電源線插入已接地的插座。(圖 8)
2. 如需固定式連接電源，請遵從電源連接章節的說明。

安裝抽油煙管

△ 受傷風險！

電器內部零件可能有銳利邊緣。請戴上保護手套。

1. 撕除兩支抽油煙管的保護膜。
2. 安裝上段抽油煙管。將上段抽油煙管上兩側的嵌版些微彎曲以分開，掛在角狀支架後方並將之盡可能地推近。(圖 9a)

提示：如果需要循環，請將抽油煙管插槽朝下裝入。

3. 將上段排油煙管面對兩個角形支架的一面用螺絲固定。(圖 9b)
4. 安裝下段抽油煙管。將下段抽油煙管兩側的嵌版些微推離，然後掛在上段抽油煙管後方。

提示：為防止刮傷表面，在下段抽油煙管的邊緣放上紙張。

5. 將下段抽油煙管整個向下壓，然後用螺絲將煙管固定在此電器的側面。

拆除電器

1. 拔掉電器電源。
2. 拆下抽油煙管。
3. 鬆開排氣管。
4. 拆下金屬濾油網。
5. 稍微鬆開電器支架上的螺絲；不要完全鬆開。
6. 拆下電器。
7. 取下抽油煙管的角形支架。