



Register your new Bosch now:
www.bosch-home.com/welcome



TCC78K751C



BOSCH

zh 安装说明书
en Installation instructions

1

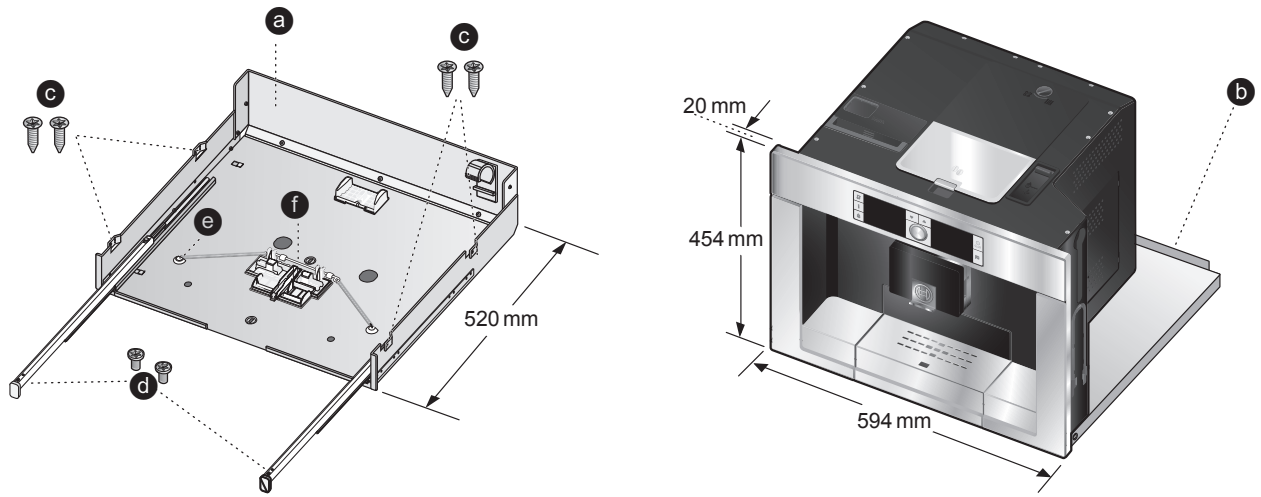

2

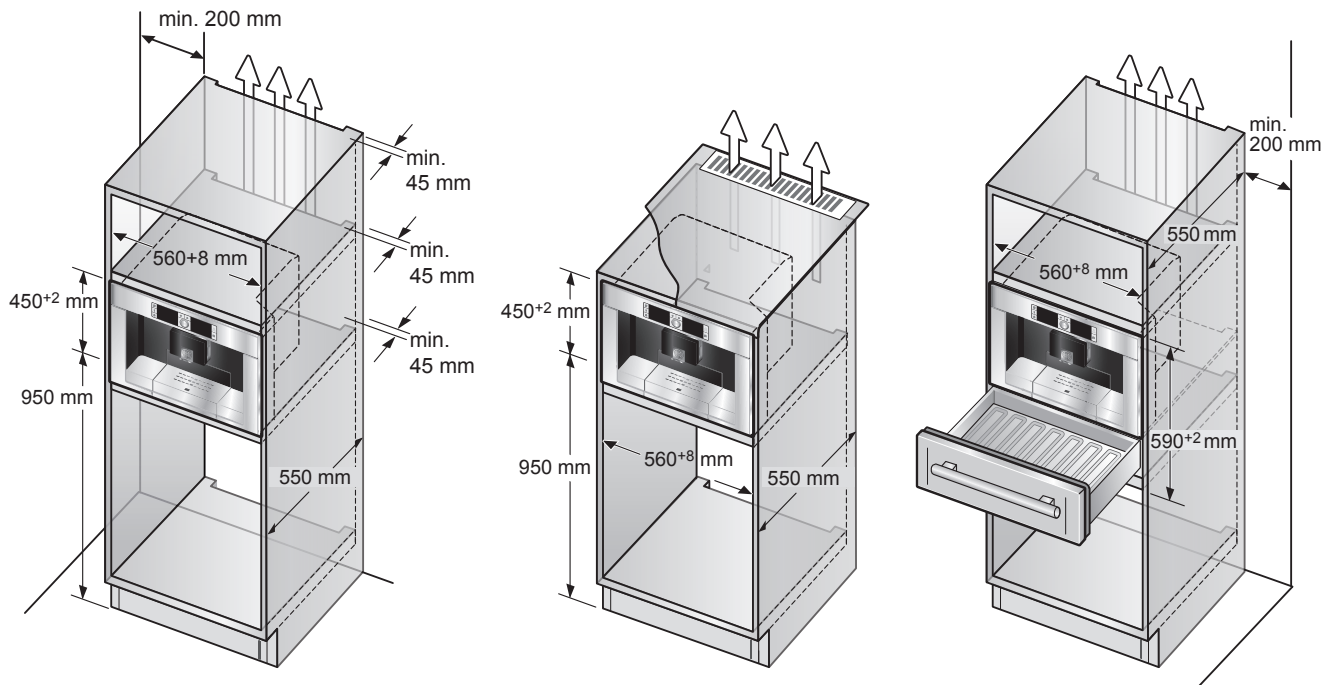

3

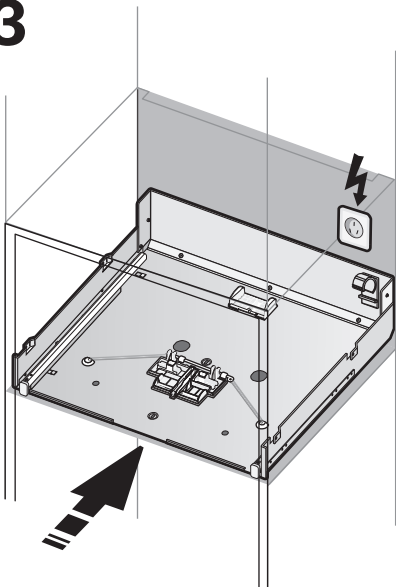

4

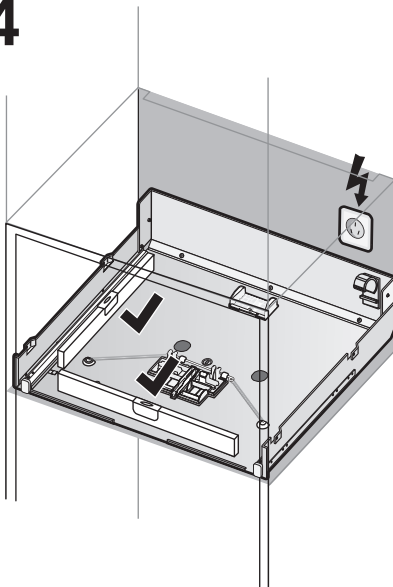

5

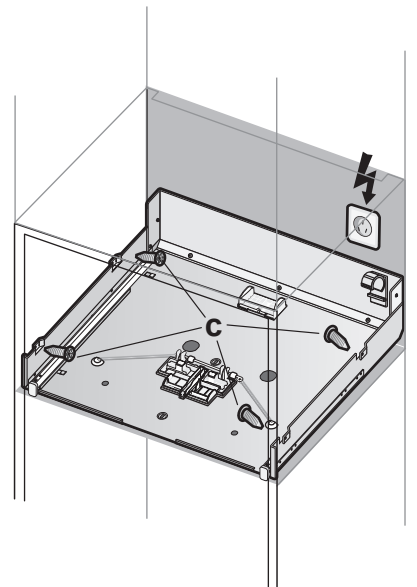

6

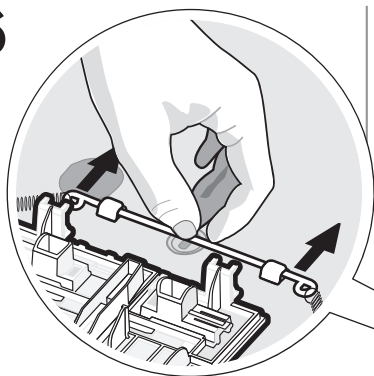

I.

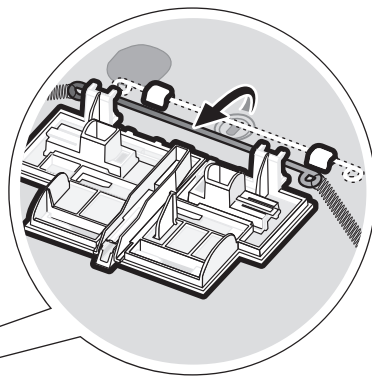
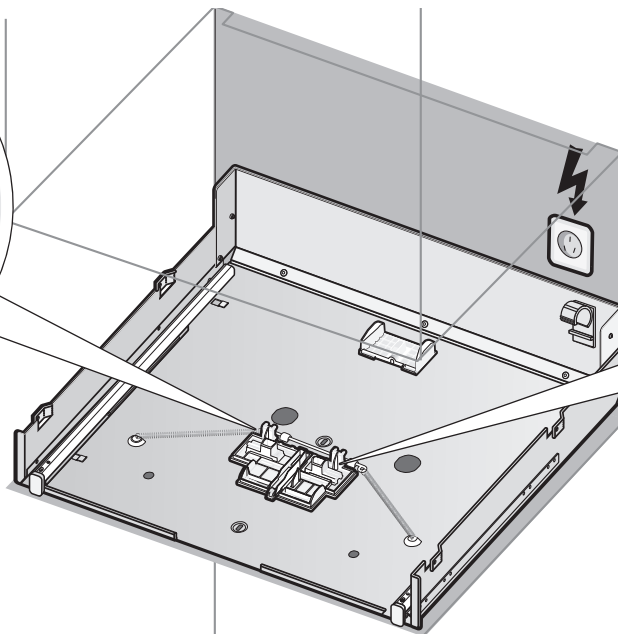

II.

7

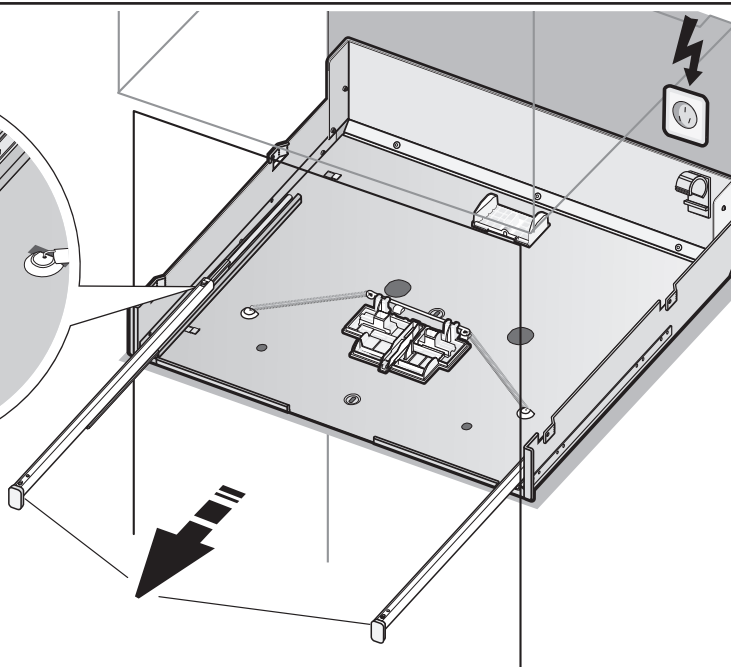
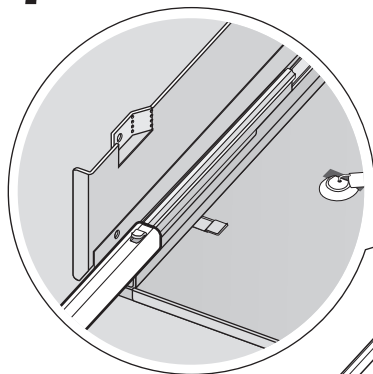

8

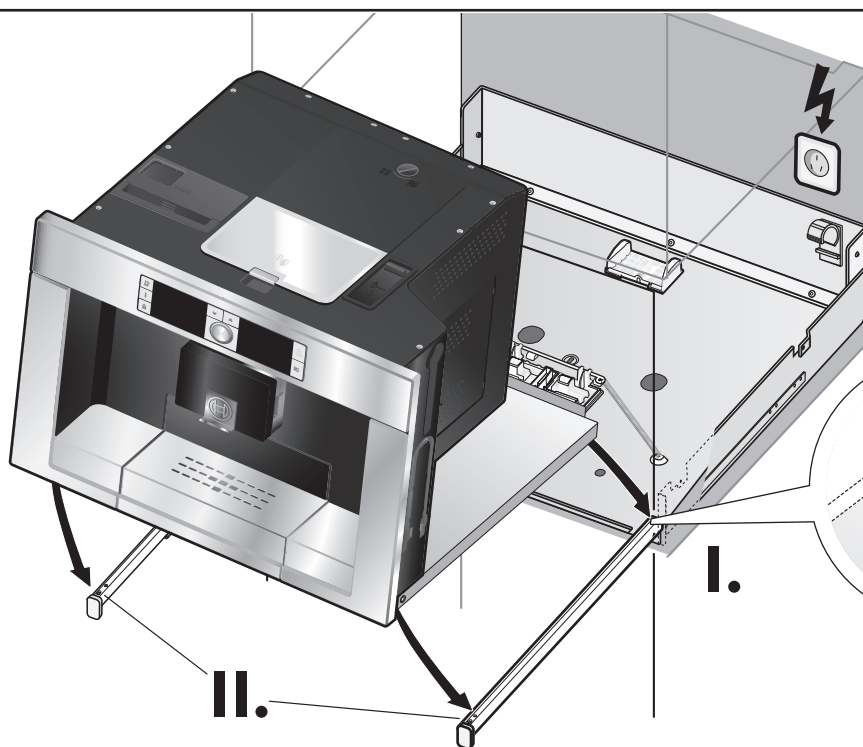

I.

II.

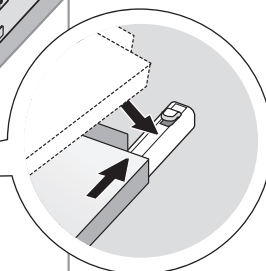

9

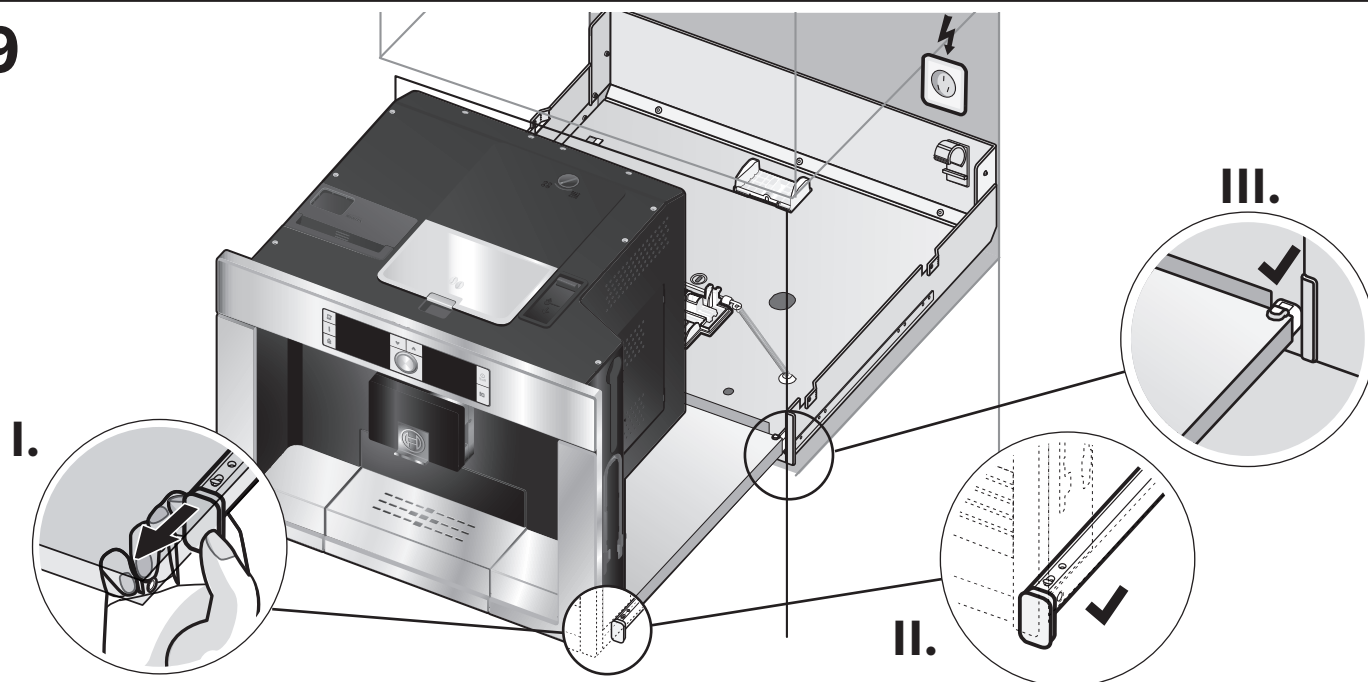

10

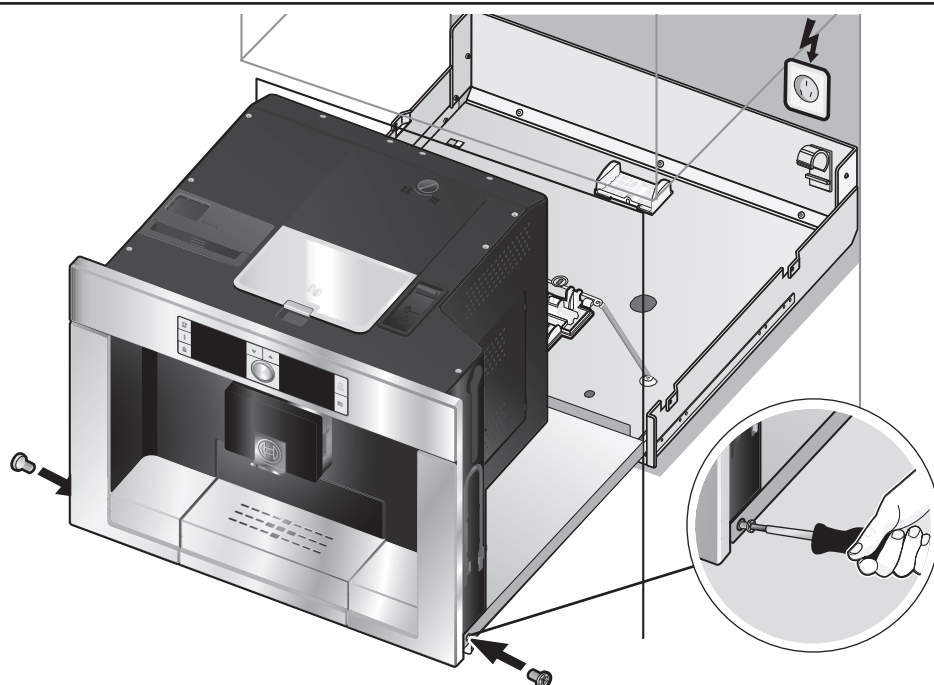

11

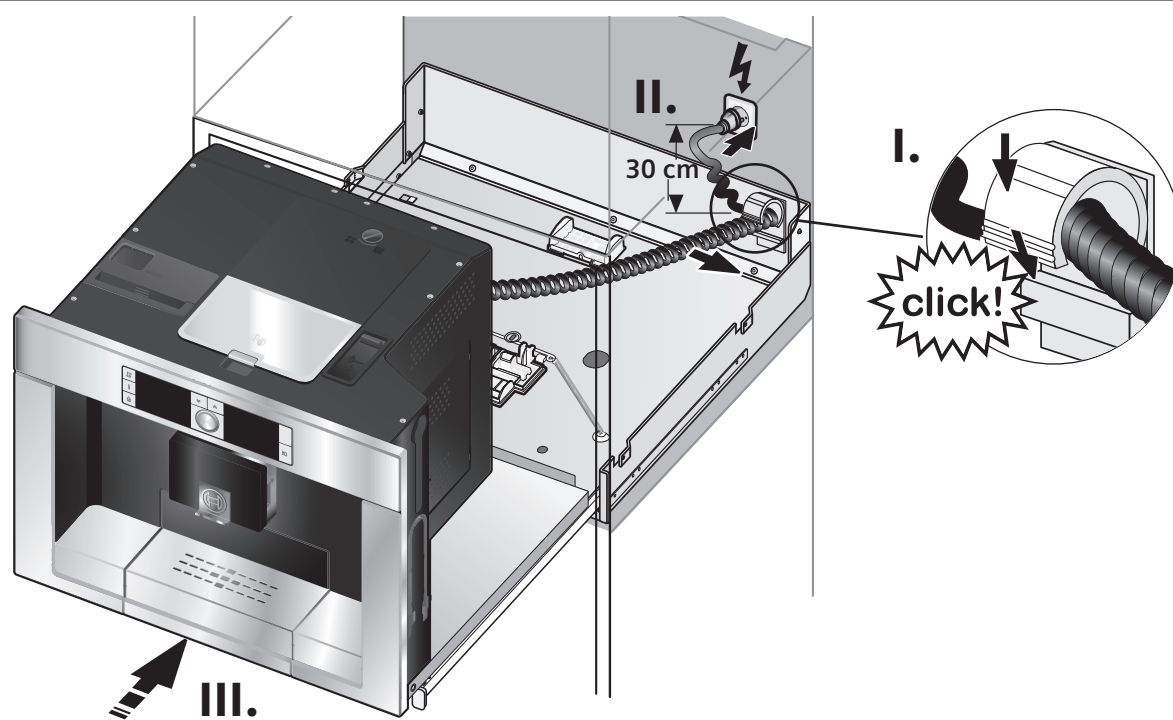

12

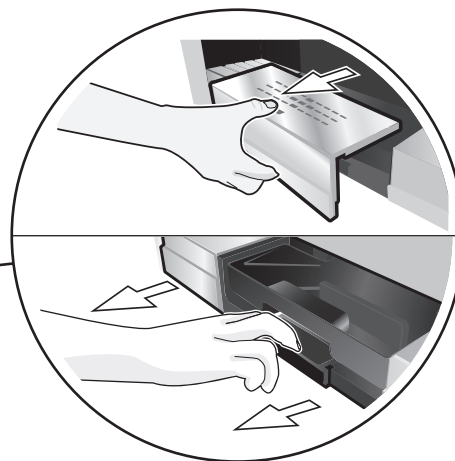
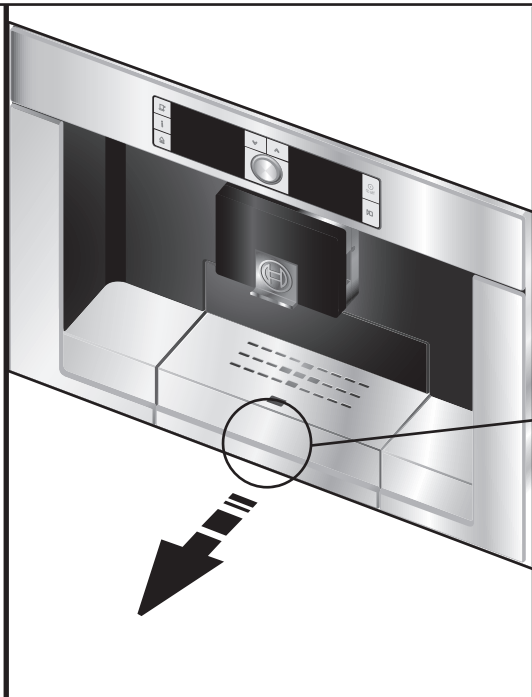

13

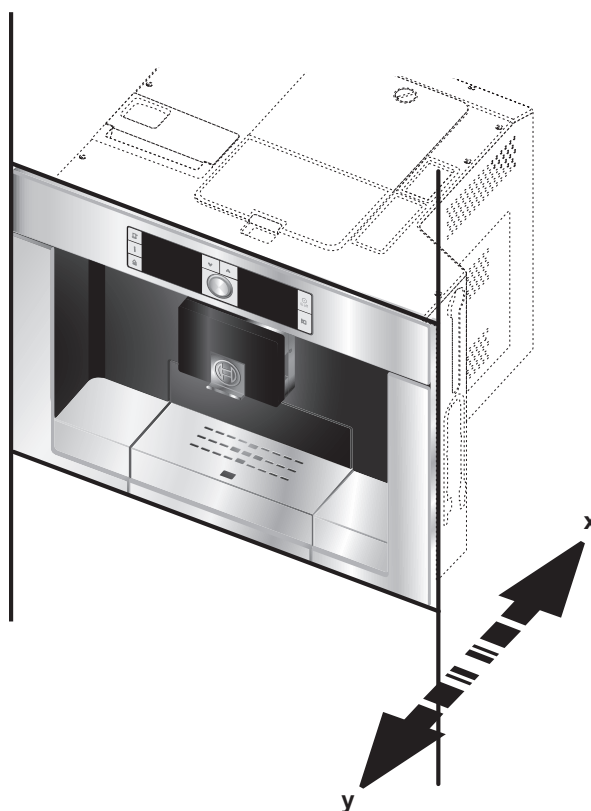
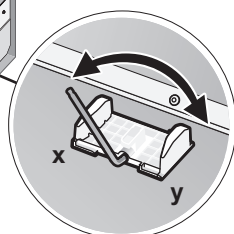
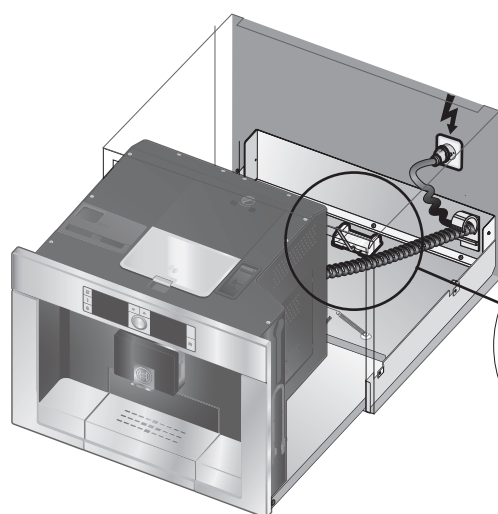

连接

本电器装有插头，只能连接到带有正确接地措施的插座上。只能由电气专业人员按照有关规定来安装插座或更换电源线。安装后，电器的插头不易接近原有插座时，必须在安装侧使用一个全极断开开关，触点间隙至少为 3 mm。只有根据以上安装说明正确安装，电器才能安全使用。使用常规支架将活动橱柜固定到墙上。

供货清单

- a 底座 (带有伸缩滑轨)
- b 装有电器和前面板的支承板
- c 木螺钉 (4 个)
- d 自攻螺钉 (2 个)
- e 弹簧
- f 弹簧支架

安装电器

墙壁与嵌入式外壳之间必须至少保持 200 mm 的距离。确保良好的通风情况。为此，请拆下后面板，或切割一个 500 x 400 mm 的开口。墙壁与橱柜底座或与上方橱柜后面板之间必须保持至少 45 mm 的距离。不得遮盖通风槽和入口。同时请遵照安装在上方或下方的电器的安装说明。如果将电器安装在暖碟抽屉上方，则凹槽的高度必须为 590 mm。如果电器安装在装饰面板正下方，请确保有一个至少 200 cm² 的通风口。全自动咖啡机的理想安装高度为 95 cm (从地板到电器的下部边缘之间的测量距离)。

1. 首先根据说明取出所有零部件，检查运输途中是否有损坏。请勿开启损坏的电器。
2. 请注意特殊型号的安裝尺寸。
3. 请将底座 ● a 插入嵌入式外壳。
4. 请使用水平仪检查插入的底座 ● a。
5. 然后用四个附带的螺钉 ● c 将底座 ● a 居中安装，正面对齐。
6. 从运输支架上取下弹簧 ● e，将其装入弹簧座 ● f，从而激活接入系统。
7. 请将伸缩滑轨完全拉出。
8. 请将支承板 ● b 连同电器一起放在两个伸缩滑轨上。

重要：电器必须放置在完全展开的伸缩滑轨上，以便将电器推入时能够激活展开机构。

9. 检查两个伸缩滑轨。两个伸缩滑轨必须朝向正前方，电器必须在后侧钩住。
10. 使用两个螺钉 ● d 固定伸缩滑轨和电器。
11. 将螺旋电缆固定到电缆轴衬内，并插入插座。将电器推入。
12. 最后，请检查展开机构在完全展开的情况下电动和手动的运作是否正常。
13. 如果电器在推入后有所突出或未接合，可以进行调节。
 - 如果电器突出：插入内六角板手 SW3，将其转至左侧 X 处。
 - 如果电器未正确接合：插入内六角板手 SW3，将其转至右侧 Y 处。

Connection

The appliance is supplied with a fitted plug and may only be connected to a correctly installed earthed socket. Only an electrician may fit a socket or replace the power cord, in compliance with the relevant regulations.

If the plug is no longer accessible following installation of the appliance, there must be an all-pole disconnector with a contact gap of at least 3 mm on the installation side.

Only an appliance which has been correctly installed according to these installation instructions can be used safely.

Attach loose furniture to the wall with a conventional bracket.

Included in delivery

- a** Chassis (with telescopic slides)
- b** Support plate with appliance and front panel
- c** Wood screws (4x)
- d** Self-tapping screws (2x)
- e** Spring
- f** Spring holder

Installing the appliance

The minimum spacing between wall and built-in housing of 200 mm must be maintained.

Make sure there is adequate aeration. To do this, remove the rear panel or cut out an opening of 500 x 400 mm.

There must be a gap of at least 45 mm between the wall and base of the unit or the rear panel of the unit situated above.

The ventilation slots and intake openings must not be covered. Also follow the installation instructions for the appliance situated above or below.

If installing the appliance above a warming drawer, the height of the recess must be 590 mm.

If the appliance is installed directly under a décor panel, ensure that there is a ventilation slot of at least 200 cm².

The ideal installation height for the fully automatic espresso machine, measured from the floor to the lower edge of the appliance, is 95 cm.

1. First unpack all parts according to the instructions and check for damage in transit.
Do not switch on a damaged appliance.
2. Take note of the installation dimensions of the particular model.
3. Insert the chassis **a** into the built-in housing.
4. Check the inserted chassis **a** using the spirit level.
5. Then attach the chassis **a** centered and flush at the front using the 4 enclosed screws **c**.
6. Remove the spring **e** from the transit supports, guiding it to the spring holder **f** in order to activate the access system.
7. Pull out the two telescopic slides **fully**.
8. Place the support plate **b** with the appliance on the two telescopic slides.

Important: The appliance must be placed on the telescopic slides only when they are fully extended, so that the deployment mechanism is activated when it is pushed in.

9. Check both telescopic slides. They must be positioned right to the front and the appliance must be hooked in at the back.
10. Attach the telescopic slides and the appliance with both screws **d**.
11. Fix the helix cable in the strain relief and insert into the socket. Push in the appliance.
12. Finally, check that the electrical and manual deployment mechanism works correctly in completely extended state.
13. If the appliance protrudes or does not engage after being pushed in, this can be adjusted.
 - If the appliance protrudes:
Insert Allen key SW3 and turn it to the left **X**.
 - If the appliance does not engage:
Insert Allen key SW3 and turn it to the right **Y**.

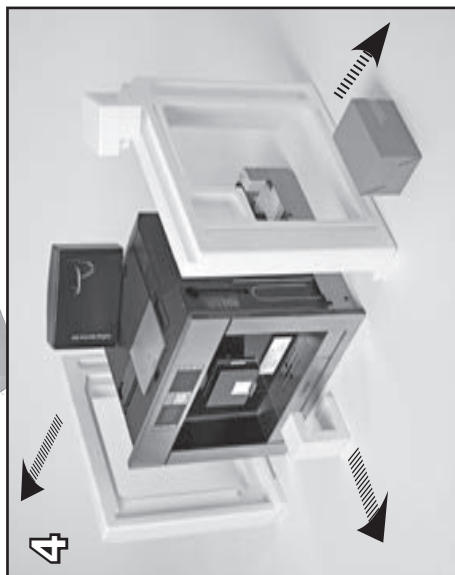
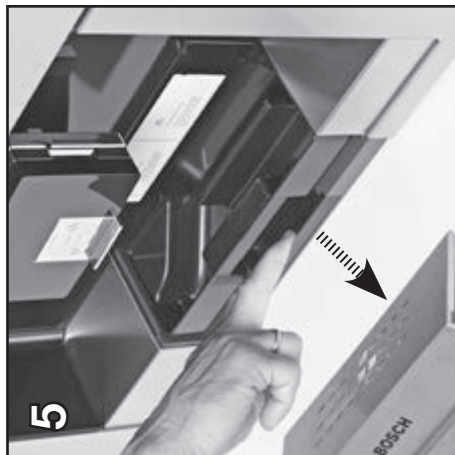
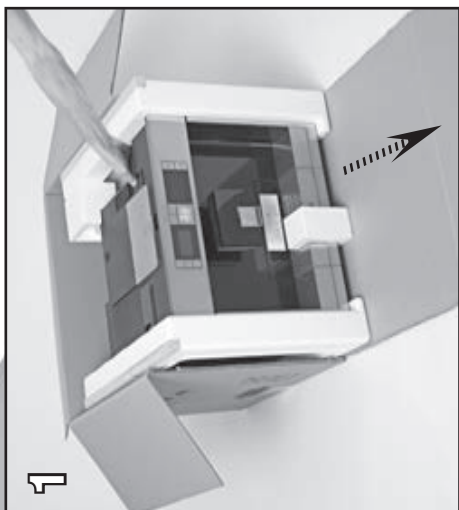
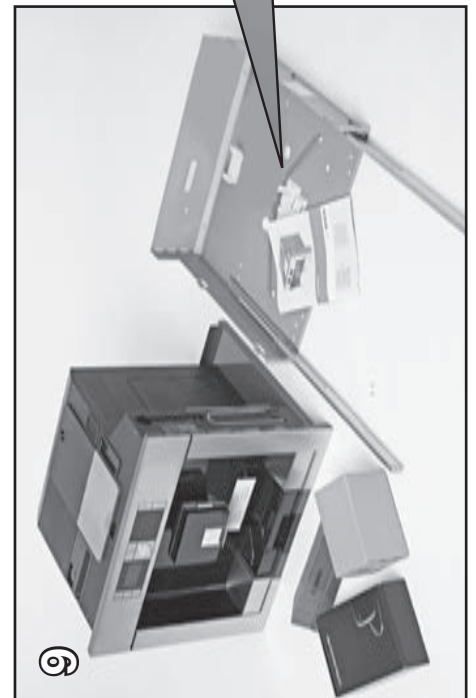
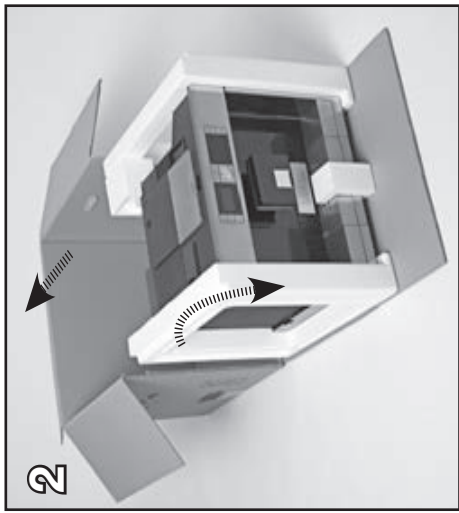
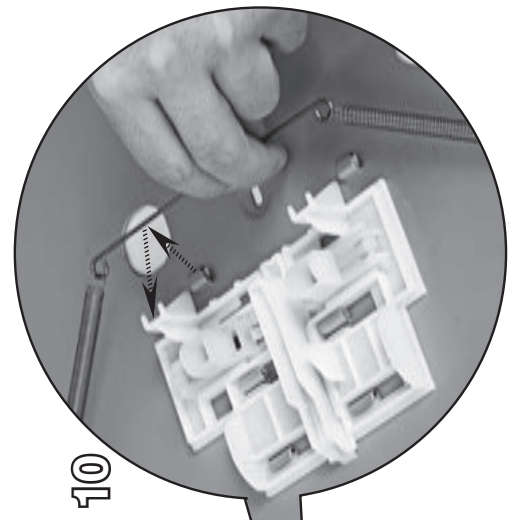
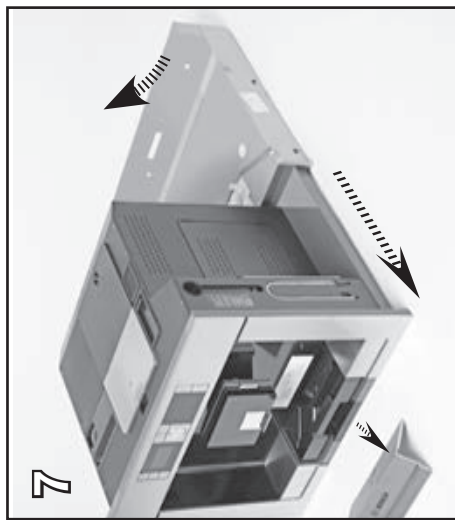
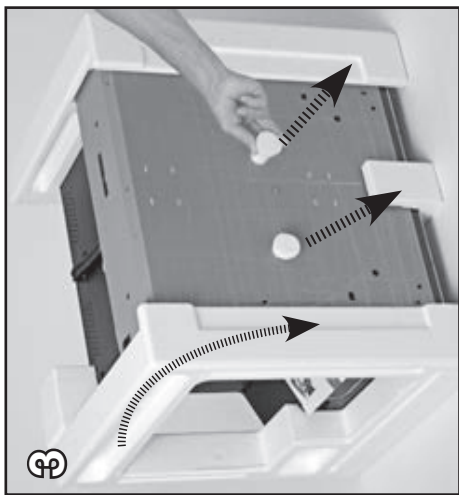

Robert Bosch Hausgeräte GmbH
 Carl-Wery-Str. 34
 81739 München, Germany
www.bosch-home.com

9000 957 546 – 01/14