

zh 安装说明

请保存

en Installation Instructions

please keep

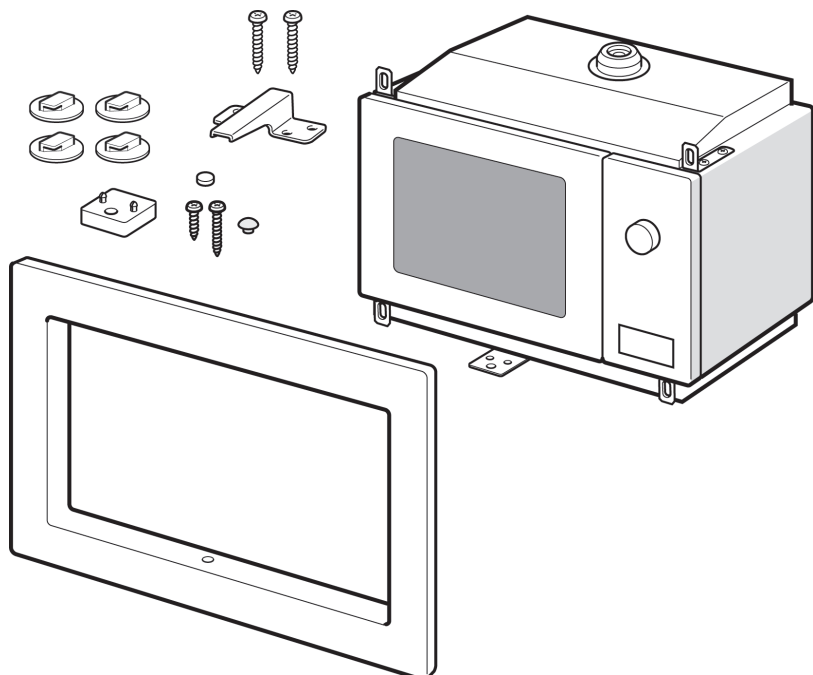

1

A

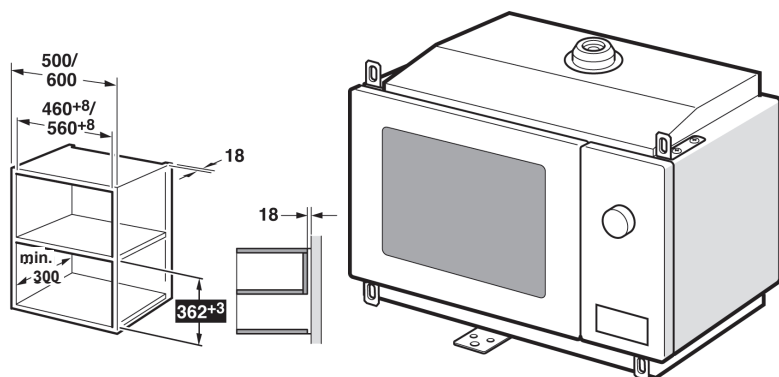

B

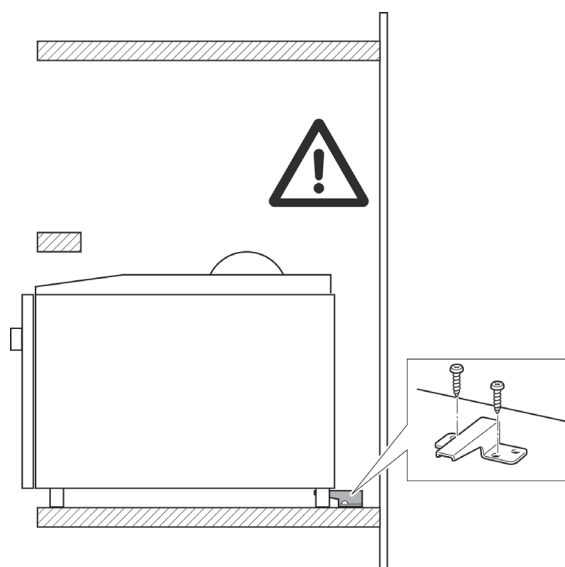
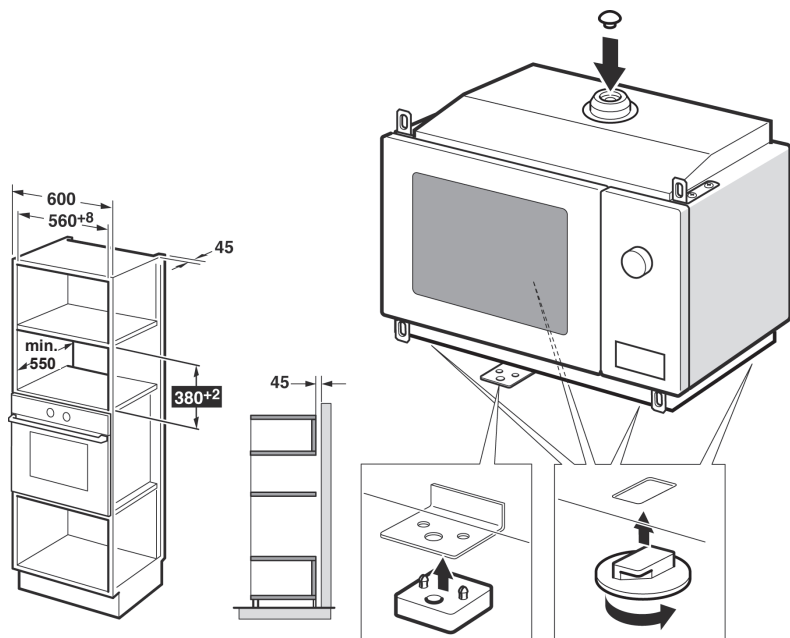

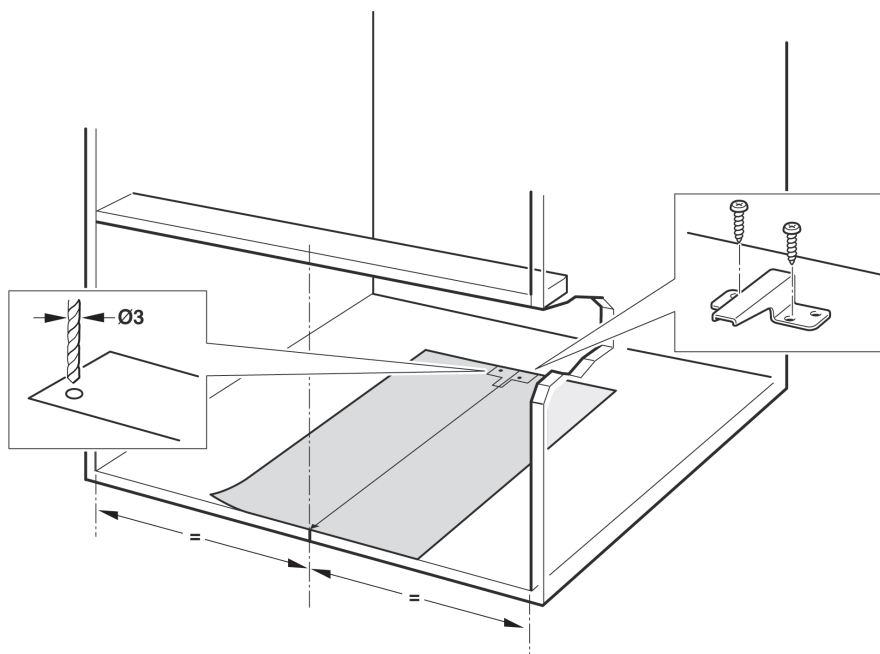

2

A

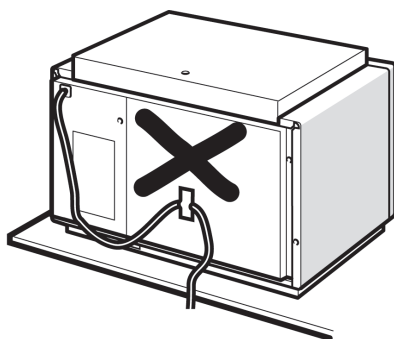
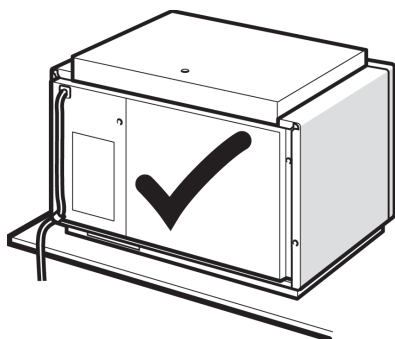

A

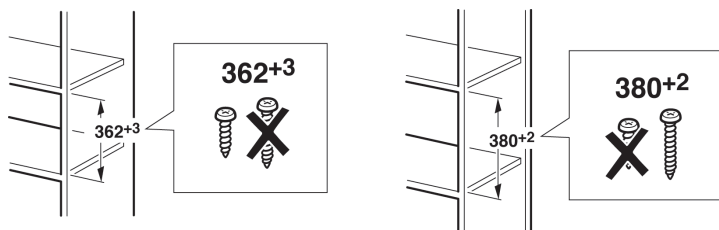
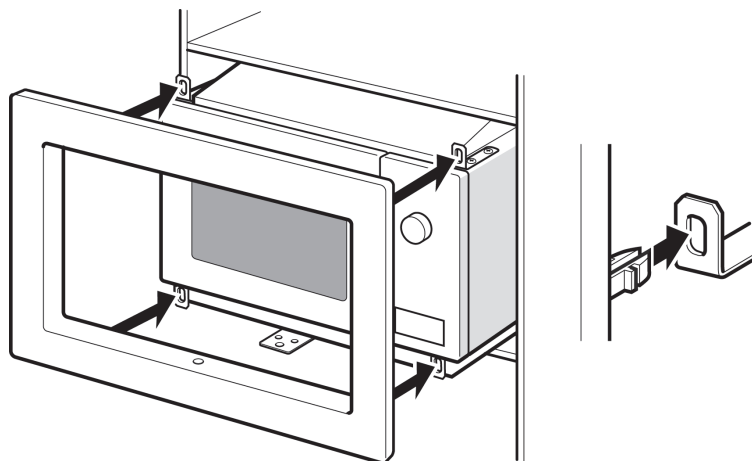

B

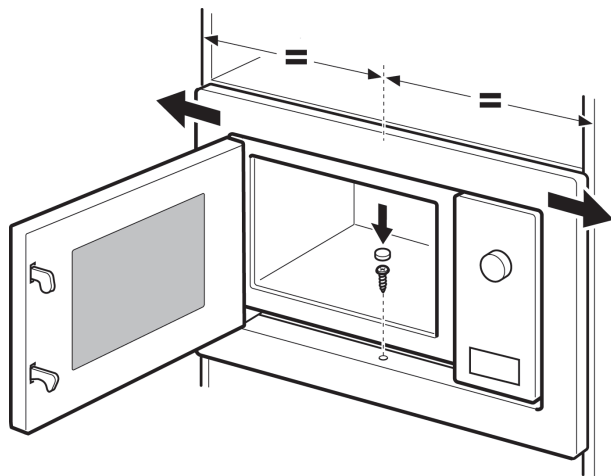

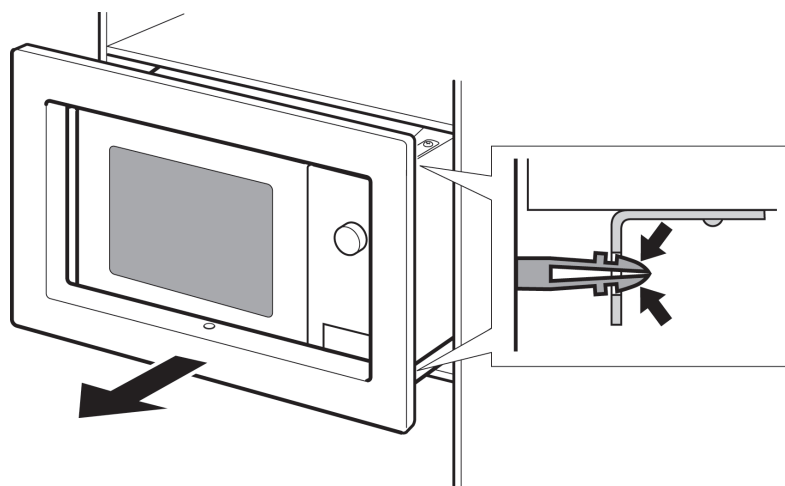

ZH

请注意

电气连接

本烤箱装有插头，只能连接到带有正确接地措施的插座上。只能由合格的电工安装插座和更换连接电缆，并要遵守适用的规定。安装后，如果插头使用不便，则必须在安装侧安装一个全电极隔离开关，触点间隙至少为 3 mm。

图 1

嵌入式橱柜

嵌入式橱柜不应有后壁 (在电器后方)。

最小安装高度 85 cm。

请勿覆盖通风槽和进气口。

A 在壁橱中安装

B 在高柜中安装。

图 2

安装烤箱

注意：

请勿缠绕或扭结电源线。

EN

Please note

Electrical connection

The oven is fitted with a plug and must only be connected to a properly installed earthed socket. The socket must only be installed and the connecting cable must only be replaced by a qualified electrician, and in accordance with the appropriate regulations. If the plug is no longer accessible following installation, an all-pole isolating switch must be present on the installation side with a contact gap of at least 3 mm.

Fig. 1

Built-in furniture

The built-in cabinet shall not have a rear wall behind the appliance.

Minimum installation height 85 cm.

Do not cover ventilation slots and air intake points.

A Installation in a wall unit

B Installation in a high cabinet.

Fig. 2

Installing the oven

Note:

Do not trap or kink the mains lead.

