

Your new dryer

Congratulations - You have chosen a modern, high-quality Bosch domestic appliance. The vented dryer is distinguished by its economical energy consumption. Every dryer which leaves our factory is carefully checked to ensure that it functions correctly and is in perfect condition. Should you have any questions, our after-sales service will be pleased to help.

Disposal in an environmentally-responsible manner
Dispose of packaging in an environmentally-responsible manner. This appliance is labelled in accordance with the European guideline 2002/96/EG on waste electrical and electronic equipment - WEEE. The guideline provides an EU-wide framework for the return and recycling of old appliances.

For further information about our products, accessories, spare parts and services, please visit: www.bosch-home.com

Observe the safety instructions on page 11.
 Read these instructions before operating the dryer. Also observe the separate installation instructions for the exhaust air duct!

Contents	Page
■ Preparation	2
■ Setting the programmes	2
■ Drying	3/4
■ Information on laundry	5
■ Care and cleaning	6
■ Programme overview	7
■ Installation	8
■ Frost protection/transport	8
■ Technical data	9
■ Optional accessories	9
■ What to do if... / After-sales service	10
■ Safety instructions	11

Intended use

- for domestic use only,
- only to be used for drying fabrics that have been washed with water.

Do not leave children unsupervised near the dryer. Keep pets away from the dryer.

Preparing for installation, see Page 8

Never start the dryer if it is damaged! Inform your after-sales service.

Make sure your hands are dry. Hold the plug only.

Remove all items from pockets. Check for cigarette lighters. The drum must be empty prior to loading. See programme overview on page 7. See also separate instructions for "Woolens basket" (depending on model)

Inspecting the dryer

Connecting the mains plug

Sorting and loading laundry

Selecting and adjusting the programme

Select the drying programme ...

... and adapt to individual requirements

Additional functions	Display panel	Time remaining	Programme selector
Buzzer	<input type="radio"/> Drying <input type="radio"/> Iron Dry <input type="radio"/> Cupboard Dry <input type="radio"/> Anti-crease/End		<input type="radio"/> Easy-Care Very Dry <input type="radio"/> Cupboard Dry <input type="radio"/> Iron Dry <input type="radio"/> Super Quick 40' <input type="radio"/> Timed Programme warm 20' <input type="radio"/> Timed Programme warm 40' <input type="radio"/> Cottons Extra Dry <input type="radio"/> Very Dry <input type="radio"/> Cupboard Dry <input type="radio"/> Iron Dry <input type="radio"/> Woolens finish
Low Heat	<input type="radio"/> Door <input type="radio"/> Filter / Venting Hose		
Reduced Ironing			
h:min End of programme in 1*24 hours (Press button several times if required) (*depending on the selected programme, e.g. duration 1:54h → 2h. Can always be selected to the next full hour.			
Service displays Door Filter/Venting Hose Close door. Clean the fluff filter. Check exhaust air line. → page 6.			
Buzzer	Select On/Off for an acoustic signal at end of programme.		
Low Heat	Reduced temperature for delicate fabrics that require a longer drying time; e.g. for polyacrylics, polyamide, elastane or acetate.		
Reduced Ironing	Reduces creasing and extends the anti-creasing phase once the program has ended.		



Drying

Cleaning the fluff filter

- Clean the fluff filter **after** each drying operation.
1. Open the door, remove fluff from door/door area.
 2. Pull out and fold open the fluff filter.
 3. Remove the fluff (by wiping the filter with your hand). If the fluff filter is very dirty or blocked, rinse with warm water and dry thoroughly.
 4. Close and reinsert the fluff filter.

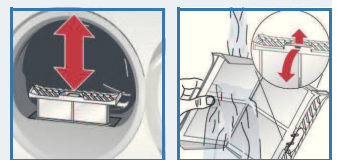

Switching off the dryer

Turn the programme selector to **Off**. Do not leave laundry in the dryer.

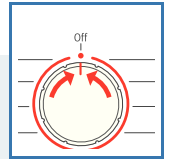

Removing the laundry

The automatic anti-crease function causes the drum to move at specific intervals, the washing remains loose and fluffy for an hour (two hours if the additional **Reduced Ironing** function is also selected depending on model).

Programme end once lights up in the display.

Interrupt programme removing or adding laundry.

The drying cycle can be interrupted for a brief period so that laundry may be added or removed. The programme selected must then be resumed and completed.

Never switch the dryer off before the drying process has ended. Drum and door may be hot!

1. Open door, the drying process is interrupted.
2. Load or remove laundry and close door.
3. If required, select a new programme and additional functions.
4. Press the **Start/Stop** button.

Information on laundry ...

Labelling of fabrics
Follow the manufacturer's care information.

- Drying at normal temperature.
- Drying at low temperature → also select **Low Heat**.
- Do not machine dry.

Observe safety instructions without fail → Page 11!
Do not tumble-dry the following fabrics for example:

- Impermeable fabrics (e.g. rubber-coated fabrics).
- Delicate materials (silk or curtains made from synthetic material) → they may crease.
- Dripping wet washing high → energy consumption!
- Laundry contaminated with oil.

Drying tips

- To ensure a consistent result, sort the laundry by fabric type and drying programme.
- Always dry very small items (e.g. baby socks) together with large items of laundry (e.g. hand towel).
- Close zips, hooks and eyelets, and button up covers. Tie fabric belts, apron strings, etc. together
- Do not over-dry easy-care laundry → risk of creasing! Allow laundry to finish drying in the air.
- Do not dry woolens in the dryer, only use to freshen them up → Page 7, **Woolens finish Programme** (depending on model).
- Do not iron laundry immediately after drying, fold items up and leave for a while → the remaining moisture will then be distributed evenly.
- Machine-knitted fabrics (e.g. T-shirts or jerseys) often shrink the first time they are dried → do not use the **Extra Dry** programme.
- Starched laundry is not always suitable for dryers → starch leaves behind a coating that adversely affects the drying operation.
- Use the correct dosage of fabric softener as per the manufacturer's instructions when washing the laundry to be dried.
- Use the timer programme for small loads → this improves the drying result.

Environmental protection/energy-saving tips

- Before drying, spin the laundry thoroughly in the washing machine → the higher the spin speed the shorter the drying time will be (consumes less energy), also spin easy-care laundry.
- Put in, but do not exceed, the maximum recommended quantity of laundry → programme overview → Page 7.
- Make sure the room is well ventilated during drying.
- Clean the fluff filter after every drying cycle → Page 4.
- Do not obstruct or seal up the air inlet.

Care and cleaning Only when switched off!

Dryer housing, Control panel, Air inlet, Moisture sensors

- Wipe off with a soft, damp cloth.
- Do not use abrasive cleaners or solvents.
- Remove detergent and cleaning agent residue immediately.

Exhaust air duct
Check the exhaust air duct. Clean the exhaust air duct every six months. Do not bend the exhaust air duct.

1. Switch off the dryer and allow it to cool down.
2. Disconnect the mains plug.
3. Remove the exhaust air duct.
4. Clean the exhaust air duct.
5. Refit the exhaust air duct → Installation instructions for exhaust air duct.

Moisture sensors
The dryer is equipped with stainless steel moisture sensors. Moisture sensors measure the moisture level of the laundry. After sustained, repeated operation, a fine layer of limescale may form on the moisture sensors.

1. Open the door.
2. Clean the moisture sensors using a slightly damp sponge with a rough surface.



Do not use steel wool or abrasive materials.

After drying: laundry is to be ...	max. 8 kg	max. 3.5 kg	max. 3 kg	max. 2 kg	max. 3 kg
Ironed	✓	✓	✓	✓	✓
lightly ironed dry	✓	✓	✓	✓	✓
not ironed	✓	✓	✓	✓	✓
passed through a mangle	✓	✓	✓	✓	✓
Cottons	✓	✓	✓	✓	✓
Iron Dry	✓	✓	✓	✓	✓
Cupboard Dry	✓	✓	✓	✓	✓
Very Dry	✓	✓	✓	✓	✓
Extra Dry	✓	✓	✓	✓	✓
Easy-Care	✓	✓	✓	✓	✓
Iron Dry	✓	✓	✓	✓	✓
Cupboard Dry	✓	✓	✓	✓	✓
Very Dry	✓	✓	✓	✓	✓
Woolens finish	✓	✓	✓	✓	✓
SuperQuick 40'	✓	✓	✓	✓	✓
Timed Programmes	✓	✓	✓	✓	✓
40 min/20 min	✓	✓	✓	✓	✓

For whites and coloureds/cotton or linen. For non-iron laundry made of synthetic fibres and blended fabric, cotton. For woolen fabrics suitable for machine-washing. Fabrics become fluffier but not dry. Remove fabrics once the programme has ended and allow to dry. For laundry made of synthetic fibres, cotton or blended fabrics (for example) that needs to be dried quickly. The values may differ from the those specified depending on the type of fabric, mixture of laundry to be dried, residual moisture in the fabric and loading capacity. For pre-dried, multi-layered, sensitive fabrics made of acrylic fibres, or separate small items of laundry. Also for subsequent drying.

0111 / 9000619968
 Robert Bosch Hausgeräte GmbH
 Carl-Wery-Str. 34
 D-81739 Munich/Germany
 WTW74307UK



Installation

- Delivery specification: dryer, instructions for installation and use, woollens basket (depending on model).
- Check dryer for transport damage.
- The dryer is very heavy. Do not attempt to lift it on your own.
- Be careful to avoid sharp edges.
- Do not lift the dryer by any of the protruding parts (e.g. the door) as they may break off.
- Do not set up in a room that is susceptible to frost.
- Freezing water may cause damage.
- If in doubt, have the appliance connected by an expert.

1. Setting up the dryer

- The appliance plug must always be accessible.
- Ensure that the appliance is installed on a clean, level and solid surface.
- Keep the cooling grille at the front of the dryer unobstructed.
- Keep the area around the dryer clean.
- Make the dryer level using the threaded feet and a spirit level.
- Do not remove the threaded feet under any circumstances.

! Take all accessory parts out of the drum. The drum must be empty.

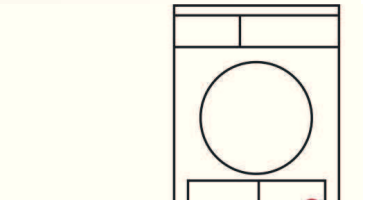

! Do not set up the dryer behind a door or sliding door as this may obstruct or prevent the dryer door from opening. This will prevent a potentially fatal danger to children from locking themselves in.

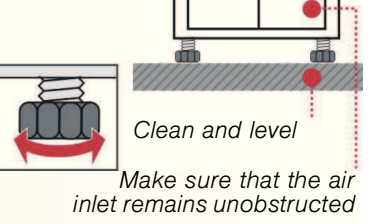

2. Mains connection

- see safety instructions → Page 11.
- Connect to an AC earthed socket. If in doubt have the socket checked by an expert.
- The mains voltage and the voltage shown on the rating plate (→ Page 9) must correspond.
- The connected load and necessary fuse protection are specified on the rating plate.

Frost protection / Transport

Preparation

1. Select any programme using the programme selector.
2. Press the **Start/Stop** button.
3. Turn the programme selector to **Off**.

! Do not operate the dryer if there is a danger of frost.

Technical data

Dimensions (DxWxH)	60 x 60 x 85 cm (height adjustable)
Weight	approximately 36 kg
Max. capacity	8 kg
Ambient temperature	5 - 35 °C
Connection voltage	
Connected load	
Fuse protection	see appliance rating plate
Ambient temperature	
Product number/ Production number	

You can find the rating plate on the back of the dryer.

Consumption rates These are guide values determined under standard conditions. Fluctuations up to 10% are possible.

	Spin speed in rpm (residual moisture)	Drying time in min.**	Energy consumption in kWh**
Cottons 8 kg		13 A	13 A
Cupboard Dry*	1400 (approx. 50 %)	95	3.50
	1000 (approx. 60 %)	118	4.20
	800 (approx. 70 %)	135	4.79
Iron Dry*	1400 (approx. 50 %)	67	2.37
	1000 (approx. 60 %)	90	3.15
	800 (approx. 70 %)	107	3.84
Easy-Care 3.5 kg			
Cupboard Dry*	800 (approx. 40 %)	37	1.18
	600 (approx. 50 %)	44	1.48

*Test program according to DIN EN 61121.
 **The values may differ from the those specified depending on the type of fabric, mixture of laundry to be dried, residual moisture in the fabric and loading capacity.

- Drum interior light (depending on model) (bulb E14, 25 W)**
 The drum is illuminated after the door is opened or closed, and also after the programme is started. It goes out automatically. Replacing the bulb → Page 10.

Optional accessories (order from the after-sales service using the order number)

WTZ 1130	Exhaust air set (depending on model) The exhaust air is conveyed directly via a hose.
WTZ 11310	Washer-dryer stack connection set The dryer can be placed on top of a suitable washing machine with the same width and depth to save space. This connection set must always be used to secure the dryer to the washing machine. With pull-out worktop: WTZ 11300
WTZ 10290	Installation underneath the worktop Risk of electric shock! Instead of the appliance covering plate, you must have a metal cover fitted by an expert.
WMZ 20460	Platform For better loading and unloading. The basket contained in the drawer can be used to carry the laundry.

What to do if ...

! If you cannot rectify a fault yourself, please contact our after-sales service. We will always find an appropriate solution and will avoid unnecessary visits by engineers. Trust the expertise of the manufacturer and rest assured that the repair will be carried out by trained service technicians using original spare parts. The contact details of your local after-sales service can be found in the enclosed after-sales service directory, or by calling one of these numbers: - GB 0844 8928979 (Calls from a BT landline will be charged at up to 3 pence per minute. A call set-up fee of up to 6 pence may apply.) - IE 01450 2655 When contacting the after-sales service, please quote the appliance's product number (E no.) and production number (FD) (see the inside of the door). Set the programme selector to Off and remove the appliance plug from the socket.	
● The Start/Stop indicator lamp does not light up.	Mains plug plugged in? Programme selected?
● The Filter/Venting Hose and Start/Stop indicator lights are flashing.	Clean the fluff filter → page 4 Exhaust air duct blocked or knicked? → Clean the exhaust air duct → page 6. If necessary, clean the insect screen on the exhaust air pipe.
● Dryer does not start.	Start/Stop button selected? Door closed? Programme set?
● The door opens by itself and/or the Door indicator light is lit.	Push the door closed until you hear it engage.
● Programme terminated shortly after starting.	Ambient temperature higher than 5 °C?
● Water is running out.	Align dryer horizontally.
● The required degree of dryness was not achieved or the drying time was too long.	Clean the fluff filter → page 4. Ambient temperature higher than 35 °C → airing. Was an unsuitable programme selected? → page 7. Has the dryer been installed with sufficient space on all sides? Ensure that air can circulate. Power failure → restart dryer. Fine layer of scale on the moisture sensors → Clean the moisture sensors → page 6.
● Laundry damp.	Use the next drying programme up or use the timer programme as a supplement → Page 7. Warm laundry feels damper than it really is!
● The moisture content of the room has increased significantly.	Make sure the room is sufficiently ventilated.
● One or more indicator lights for programme status are flashing.	Clean the fluff filter → page 4. Check installation conditions → page 8. Exhaust air duct blocked or knicked? → Clean the exhaust air duct → page 6. If necessary, clean the insect screen on the exhaust air pipe. Switch off, leave to cool down, switch on again, restart programme.
● Mains failure.	Remove laundry from the dryer immediately and spread out. This allows the heat to dissipate.
● The interior light is not working (depending on model).	Pull out the appliance plug, remove the cover cap in the interior above the door (use Torx 20 screw driver) and replace the bulb. Close the cover cap. Never operate the dryer without a cover cap.
● Condensation in the exhaust air duct.	Exhaust air duct too long? Check the maximum exhaust air duct length. Further information → <i>Installation instructions for exhaust air duct.</i>

Safety instructions

! Emergency ONLY use the dryer...	- Pull the appliance plug out of the socket immediately or disconnect the fuse. - In rooms inside the house. - To dry fabrics.
The dryer must NEVER...	- Be used for other purposes than those described above. - Be modified in terms of its technology or attributes.
Dangers	- The dryer must not be used by children or persons who have not been instructed in its use. - Do not leave children unsupervised near the dryer. - Keep pets away from the dryer. - Remove all objects from pockets. - Make especially sure that cigarette lighters are removed as they constitute an → explosion hazard. - Do not lean or sit on the door → risk of tipping. - Open the door with care. Hot steam may escape.
Installation	- Secure loose cables → tripping hazard. - Do not operate the dryer if there is a risk of frost. - The safety information in the separate installation instructions for the exhaust air duct must be observed without fail.
Mains connection	- Connect the dryer according to specifications to an AC earthed socket, as otherwise it cannot be guaranteed that the appliance is completely safe. - The cable cross-section must be sufficient. - Only use earth-leakage circuit breakers with the following symbol: - The appliance plug and socket must be compatible. - Do not use multiple plugs/couplings and/or extension cables. - Do not hold the appliance plug with wet hands → risk of electric shock. - Never pull the appliance plug out of the socket by its cable. - Do not damage the mains lead → risk of electric shock.
Operation	- Only load the drum with laundry. - Check the contents before you switch the dryer on. - Do not use the dryer if the laundry has been in contact with solvents, oil, wax, grease or paint (e.g. hair setting spray, nail polish remover, stain remover, cleaning solvent, etc.) → fire/explosion hazard. - Dust (e.g. coal dust, flour) poses a danger: do not use the dryer → explosion hazard. - Do not put laundry containing foamed material/rubber in the dryer → elastic material may be destroyed and the dryer may be damaged due to possible deformation of the foamed material. - Switch off the dryer once the programme has ended.
Defect	- Do not use the dryer if it is defective or if you suspect it is. Repairs must only be carried out by the after-sales service. - Do not use the dryer if the mains cable is defective. To avoid danger, only have the defective mains cable replaced by the after-sales service. - Always pull the mains plug out of the socket before changing the bulb for the interior light → risk of electric shock.
Spare parts	- Only use genuine spare parts and accessories for safety reasons.
Disposal	- Dryer: pull out the appliance plug, then cut off the mains cable from the appliance. - Dispose of at municipal waste disposal facility. - Packaging: do not leave children alone with packing parts → risk of suffocation. - All materials are environmentally sound and can be reused. Dispose of in an environmentally-responsible manner.



Dryer **BOSCH**

en Instruction manual

Your new dryer

Congratulations - You have chosen a modern, high-quality Bosch domestic appliance.
The vented dryer is distinguished by its economical energy consumption.

Every dryer which leaves our factory is carefully checked to ensure that it functions correctly and is in perfect condition.
Should you have any questions, our after-sales service will be pleased to help.

Disposal in an environmentally-responsible manner

Dispose of packaging in an environmentally-responsible manner.
This appliance is labelled in accordance with the European guideline 2002/96/EG on waste electrical and electronic equipment - WEEE.
The guideline provides an EU-wide framework for the return and recycling of old appliances.

For further information about our products, accessories, spare parts and services, please visit: www.bosch-home.com



Observe the safety instructions on page 11.

Read these instructions before operating the dryer.
Also observe the separate installation instructions for the exhaust air duct!

Contents

Page

■ Preparation	2
■ Setting the programmes	2
■ Drying	3/4
■ Information on laundry	5
■ Care and cleaning	6
■ Programme overview	7
■ Installation	8
■ Frost protection/transport	8
■ Technical data	9
■ Optional accessories	9
■ What to do if... / After-sales service	10
■ Safety instructions	11

Intended use

- for domestic use only,
- only to be used for drying fabrics that have been washed with water.



Do not leave children unsupervised near the dryer.
Keep pets away from the dryer.

Preparing for installation, see Page 8



Never start the dryer if it is damaged!
Inform your after-sales service.



Make sure your hands are dry.
Hold the plug only.

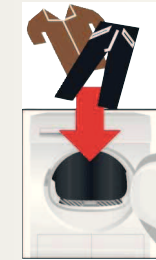

Sorting and loading

Remove all items from pockets.
Check for cigarette lighters.
The drum must be empty prior to loading.
See programme overview on page 7.
See also separate instructions for "Woollens ba" (depending on model)

Selecting and adjusting the programme

Select the d

... and adapt to individ

Additional functions	Display panel	Time remaining	Programme selector
Buzzer <input type="checkbox"/> Low Heat <input type="checkbox"/> Reduced Ironing <input type="checkbox"/>	<input type="radio"/> Drying <input type="radio"/> Iron Dry <input type="radio"/> Cupboard Dry <input type="radio"/> Anti-crease/End <input type="radio"/> Door <input type="radio"/> Filter / Venting Hose		Easy-Care Very Dry Cupboard Dry Iron Dry Super Quick 40' Timed Programme warm 20' Timed Programme warm 40' Off Cottons Extra Dry Very Dry Cupboard Dry Iron Dry Woollens finish



All buttons are need to be tou

Press the



Only operate the fluff filter i

h:min End of programme in 1*-24 hours (Press button several times if required) (*depending on the selected programme, e.g. duration 1:54h → 2h. Can always be selected to the next full hour.

Service displays

Door Filter/Venting Hose

Close door.
Clean the fluff filter. Check exhaust air line. → page 6.

Buzzer	Select On/Off for a acoustic signal at end of programme.
Low Heat	Reduced temperature for delicate fabrics <input type="checkbox"/> that require a longer drying time; e.g. for polyacrylics, polyamide, elastane or acetate.
Reduced Ironing	Reduces creasing and extends the anti-creasing phase once the program has ended.

Inspecting the dryer

Connecting the mains plug

Loading laundry

Basket

Programme

Drying programme ...

Individual requirements

Sensitive and only touched lightly.

Start/Stop button

the dryer with inserted!

Drying



1
2

3



Drying



Cleaning the fluff filter

Clean the fluff filter **after** each drying operation.

1. Open the door, remove fluff from door/door area.
2. Pull out and fold open the fluff filter.
3. Remove the fluff (by wiping the filter with your hand).
If the fluff filter is very dirty or blocked, rinse with warm water and dry thoroughly.
4. Close and reinsert the fluff filter.

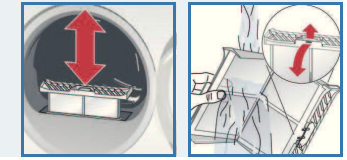

Switching off the dryer

Turn the programme selector to **Off**.
Do not leave laundry in the dryer.

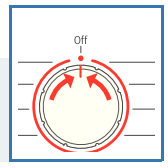

Removing the laundry

The automatic anti-crease function causes the drum to move at specific intervals, the washing remains loose and fluffy for an hour (two hours if the additional **Reduced Ironing** function is also selected - depending on model).

Programme end once lights up in the display.

Interrupt programme removing or adding laundry.



The drying cycle can be interrupted for a brief period so that laundry may be added or removed. The programme selected must then be resumed and completed.



Never switch the dryer off before the drying process has ended. Drum and door may be hot!

1. Open door, the drying process is interrupted.
2. Load or remove laundry and close door.
3. If required, select a new programme and additional functions.
4. Press the **Start/Stop** button.



Information on laundry ...



Labelling of fabrics

Follow the manufacturer's care information.

- Drying at normal temperature.
- Drying at low temperature → also select **Low Heat**.
- Do not machine dry.



Observe safety instructions without fail → *Page 11!*

Do not tumble-dry the following fabrics for example:

- Impermeable fabrics (e.g. rubber-coated fabrics).
- Delicate materials (silk or curtains made from synthetic material) → they may crease.
- Dripping wet washing high → energy consumption!
- Laundry contaminated with oil.



Drying tips

- To ensure a consistent result, sort the laundry by fabric type and drying programme.
- Always dry very small items (e.g. baby socks) together with large items of laundry (e.g. hand towel).
- Close zips, hooks and eyelets, and button up covers.
Tie fabric belts, apron strings, etc. together
- Do not over-dry easy-care laundry → risk of creasing!
Allow laundry to finish drying in the air.
- Do not dry woolens in the dryer, only use to freshen them up → *Page 7, Woollens finish Programme (depending on model)*.
- Do not iron laundry immediately after drying, fold items up and leave for a while → the remaining moisture will then be distributed evenly.
- Machine-knitted fabrics (e.g. T-shirts or jerseys) often shrink the first time they are dried → do not use the **Extra Dry** programme.
- Starched laundry is not always suitable for dryers → starch leaves behind a coating that adversely affects the drying operation.
- Use the correct dosage of fabric softener as per the manufacturer's instructions when washing the laundry to be dried.
- Use the timer programme for small loads → this improves the drying result.

Environmental protection/energy-saving tips

- Before drying, spin the laundry thoroughly in the washing machine → the higher the spin speed the shorter the drying time will be (consumes less energy), also spin easy-care laundry.
- Put in, but do not exceed, the maximum recommended quantity of laundry → programme overview → *Page 7*.
- Make sure the room is well ventilated during drying.
- Clean the fluff filter after every drying cycle → *Page 4*.
- Do not obstruct or seal up the air inlet.

Care and cleaning



Only when switched off!



Dryer housing, Control panel, Air inlet, Moisture sensors

- Wipe off with a soft, damp cloth.
- Do not use abrasive cleaners or solvents.
- Remove detergent and cleaning agent residue immediately.



Exhaust air duct

Check the exhaust air duct. Clean the exhaust air duct every six months.
Do not bend the exhaust air duct.

1. Switch off the dryer and allow it to cool down.
2. Disconnect the mains plug.
3. Remove the exhaust air duct.
4. Clean the exhaust air duct.
5. Refit the exhaust air duct → Installation instructions for exhaust air duct.



Moisture sensors

The dryer is equipped with stainless steel moisture sensors.
Moisture sensors measure the moisture level of the laundry.
After sustained, repeated operation, a fine layer of limescale may form on the moisture sensors.

1. Open the door.
2. Clean the moisture sensors using a slightly damp sponge with a rough surface.



Do not use steel wool or abrasive materials.





After drying: laundry is to be ...	max. 8 kg	For whites and coloureds/cotton or linen.	T-shirt	Shirts	Trousers	Skirts/dresses	Sportswear	Work clothing	Anoraks	Towelling gowns	Underwear	Socks	Bed linen	Table linen	Terry towels	Tea towels/ towels
☑ ironed	☑	☑	☑	☑	☑	☑	☑	☑	☑	☑	☑	☑	☑	☑	☑	☑
☑ lightly ironed dry	☑	☑	☑	☑	☑	☑	☑	☑	☑	☑	☑	☑	☑	☑	☑	☑
☑ not ironed	☑	☑	☑	☑	☑	☑	☑	☑	☑	☑	☑	☑	☑	☑	☑	☑
☑ passed through a mangle	☑	☑	☑	☑	☑	☑	☑	☑	☑	☑	☑	☑	☑	☑	☑	☑
Cottons																
Iron Dry	☑	☑	☑	☑	☑	☑	☑	☑	☑	☑	☑	☑	☑	☑	☑	☑
Cupboard Dry	☑	☑	☑	☑	☑	☑	☑	☑	☑	☑	☑	☑	☑	☑	☑	☑
Very Dry	☑	☑	☑	☑	☑	☑	☑	☑	☑	☑	☑	☑	☑	☑	☑	☑
Extra Dry	☑	☑	☑	☑	☑	☑	☑	☑	☑	☑	☑	☑	☑	☑	☑	☑
Easy-Care																
Iron Dry	☑	☑	☑	☑	☑	☑	☑	☑	☑	☑	☑	☑	☑	☑	☑	☑
Cupboard Dry	☑	☑	☑	☑	☑	☑	☑	☑	☑	☑	☑	☑	☑	☑	☑	☑
Very Dry	☑	☑	☑	☑	☑	☑	☑	☑	☑	☑	☑	☑	☑	☑	☑	☑
Woolens finish																
max. 3 kg	☑	☑	☑	☑	☑	☑	☑	☑	☑	☑	☑	☑	☑	☑	☑	☑
SuperQuick 40'																
max. 2 kg	☑	☑	☑	☑	☑	☑	☑	☑	☑	☑	☑	☑	☑	☑	☑	☑
Timed Programmes																
40 min/20 min	☑	☑	☑	☑	☑	☑	☑	☑	☑	☑	☑	☑	☑	☑	☑	☑

For woolen fabrics suitable for machine-washing. Fabrics become fluffier but not dry.

Remove fabrics once the programme has ended and allow to dry.
For laundry made of synthetic fibres, cotton or blended fabrics (for example) that needs to be dried quickly. The values may differ from the those specified depending on the type of fabric, mixture of laundry to be dried, residual moisture in the fabric and loading capacity.

For pre-dried, multi-layered, sensitive fabrics made of acrylic fibres, or separate small items of laundry.
Also for subsequent drying.

0111 / 9000619968



Robert Bosch Hausgeräte GmbH
Carl-Wery-Str. 34
D-81739 Munich/Germany

WTV74307UK

1.

Setting up the dryer

- The appliance plug must always be accessible.
- Ensure that the appliance is installed on a clean, level and solid surface.
- Keep the cooling grille at the front of the dryer unobstructed.
- Keep the area around the dryer clean.
- Make the dryer level using the threaded feet and a spirit level.
Do not remove the threaded feet under any circumstances.



Do not set up the dryer behind a door or sliding door as this may obstruct or prevent the dryer door from opening. This will prevent a potentially fatal danger to children from locking themselves in.



Take all accessory parts out of the drum. The drum must be empty.

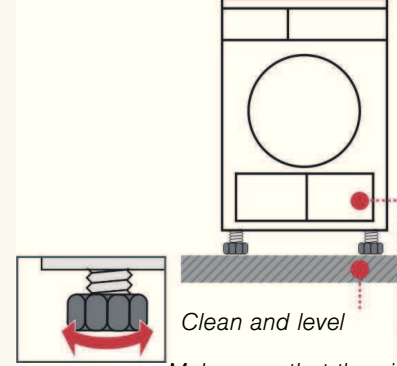

Clean and level

Make sure that the air inlet remains unobstructed

2.

Mains connection see safety instructions → Page 11.

- Connect to an AC earthed socket. If in doubt have the socket checked by an expert.
- The mains voltage and the voltage shown on the rating plate (→ Page 9) must correspond.
- The connected load and necessary fuse protection are specified on the rating plate.



Preparation

1. Select any programme using the programme selector.
2. Press the **Start/Stop** button.
3. Turn the programme selector to **Off**.

Frost protection / Transport



Do not operate the dryer if there is a danger of frost.

Technical data

● Dimensions (DxWxH)	60 x 60 x 85 cm (height adjustable)
Weight	approximately 36 kg
Max. capacity	8 kg
Ambient temperature	5 - 35 °C
Connection voltage	
Connected load	
Fuse protection	see appliance rating plate
Ambient temperature	
Product number/ Production number	

You can find the rating plate on the back of the dryer.

● Consumption rates	These are guide values determined under standard conditions. Fluctuations up to 10% are possible.			
	Spin speed in rpm (residual moisture)	Drying time in min.**	Energy consumption in kWh**	
👤👤 Cottons 8 kg		13 A	13 A	
Cupboard Dry*	1400 (approx. 50 %)	95	3.50	
	1000 (approx. 60 %)	118	4.20	
	800 (approx. 70 %)	135	4.79	
Iron Dry*	1400 (approx. 50 %)	67	2.37	
	1000 (approx. 60 %)	90	3.15	
	800 (approx. 70 %)	107	3.84	
👤 Easy-Care 3.5 kg				
	Cupboard Dry*	800 (approx. 40 %)	37	1.18
		600 (approx. 50 %)	44	1.48

*Test program according to DIN EN 61121.

**The values may differ from the those specified depending on the type of fabric, mixture of laundry to be dried, residual moisture in the fabric and loading capacity.

- **Drum interior light** (depending on model) (bulb E14, 25 W)
The drum is illuminated after the door is opened or closed, and also after the programme is started. It goes out automatically. Replacing the bulb → Page 10.

Optional accessories (order from the after-sales service using the order number)

WTZ 1130	Exhaust air set (depending on model) The exhaust air is conveyed directly via a hose.
WTZ 11310	Washer-dryer stack connection set The dryer can be placed on top of a suitable washing machine with the same width and depth to save space. This connection set must always be used to secure the dryer to the washing machine. With pull-out worktop: WTZ 11300
WTZ 10290	Installation underneath the worktop Risk of electric shock! Instead of the appliance covering plate, you must have a metal cover fitted by an expert.
WMZ 20460	Platform For better loading and unloading. The basket contained in the drawer can be used to carry the laundry.

What to do if ...



If you cannot rectify a fault yourself, please contact our after-sales service. We will always find an appropriate solution and will avoid unnecessary visits by engineers. Trust the expertise of the manufacturer and rest assured that the repair will be carried out by trained service technicians using original spare parts. The contact details of your local after-sales service can be found in the enclosed **after-sales service** directory, or by calling one of these numbers:
 – **GB** 0844 8928979 (Calls from a BT landline will be charged at up to 3 pence per minute.
 A call set-up fee of up to 6 pence may apply.)
 – **IE** 01450 2655

When contacting the after-sales service, please quote the appliance's product number (E no.) and production number (FD) (see the inside of the door).

Set the programme selector to **Off** and remove the appliance plug from the socket.

● The ① Start/Stop indicator lamp does not light up.	Mains plug plugged in? Programme selected?
● The Filter/Venting Hose and ① Start/Stop indicator lights are flashing.	Clean the fluff filter → page 4 Exhaust air duct blocked or knicked? → Clean the exhaust air duct → page 6. If necessary, clean the insect screen on the exhaust air pipe.
● Dryer does not start.	① Start/Stop button selected? Door closed? Programme set?
● The door opens by itself and/or the Door indicator light is lit.	Push the door closed until you hear it engage.
● Programme terminated shortly after starting.	Ambient temperature higher than 5 °C?
● Water is running out.	Align dryer horizontally.
● The required degree of dryness was not achieved or the drying time was too long.	Clean the fluff filter → page 4. Ambient temperature higher than 35 °C → airing. Was an unsuitable programme selected? → page 7. Has the dryer been installed with sufficient space on all sides? Ensure that air can circulate. Power failure → restart dryer. Fine layer of scale on the moisture sensors → Clean the moisture sensors → page 6.
● Laundry damp.	Use the next drying programme up or use the timer programme as a supplement → Page 7. Warm laundry feels damper than it really is!
● The moisture content of the room has increased significantly.	Make sure the room is sufficiently ventilated.
● One or more indicator lights for programme status are flashing.	Clean the fluff filter → page 4. Check installation conditions → page 8. Exhaust air duct blocked or knicked? → Clean the exhaust air duct → page 6. If necessary, clean the insect screen on the exhaust air pipe. Switch off, leave to cool down, switch on again, restart programme.
● Mains failure.	Remove laundry from the dryer immediately and spread out. This allows the heat to dissipate.
● The interior light is not working (depending on model).	Pull out the appliance plug, remove the cover cap in the interior above the door (use Torx 20 screw driver) and replace the bulb. Close the cover cap. Never operate the dryer without a cover cap.
● Condensation in the exhaust air duct.	Exhaust air duct too long? Check the maximum exhaust air duct length. Further information → <i>Installation instructions for exhaust air duct.</i>

Safety instructions



- Emergency** – Pull the appliance plug out of the socket immediately or disconnect the fuse.
- ONLY use the dryer...** – In rooms inside the house.
– To dry fabrics.
- The dryer must NEVER...** – Be used for other purposes than those described above.
– Be modified in terms of its technology or attributes.
- Dangers** – The dryer must not be used by children or persons who have not been instructed in its use.
– Do not leave children unsupervised near the dryer.
– Keep pets away from the dryer.
– Remove all objects from pockets.
Make especially sure that cigarette lighters are removed as they constitute an → **explosion hazard**.
– Do not lean or sit on the door → **risk of tipping**.
– Open the door with care. Hot steam may escape.
- Installation** – Secure loose cables → **tripping hazard**.
– Do not operate the dryer if there is a risk of frost.
– The safety information in the separate installation instructions for the exhaust air duct must be observed without fail.
- Mains connection** – Connect the dryer according to specifications to an AC earthed socket, as otherwise it cannot be guaranteed that the appliance is completely safe.
– The cable cross-section must be sufficient.
– Only use earth-leakage circuit breakers with the following symbol: 
– The appliance plug and socket must be compatible.
– Do not use multiple plugs/couplings and/or extension cables.
– Do not hold the appliance plug with wet hands → **risk of electric shock**.
– Never pull the appliance plug out of the socket by its cable.
– Do not damage the mains lead → **risk of electric shock**.
- Operation** – Only load the drum with laundry.
Check the contents before you switch the dryer on.
– Do not use the dryer if the laundry has been in contact with solvents, oil, wax, grease or paint (e.g. hair setting spray, nail polish remover, stain remover, cleaning solvent, etc.) → **fire/explosion hazard**.
– Dust (e.g. coal dust, flour) poses a danger: do not use the dryer → **explosion hazard**.
– Do not put laundry containing foamed material/rubber in the dryer → elastic material may be destroyed and the dryer may be damaged due to possible deformation of the foamed material.
– Switch off the dryer once the programme has ended.
- Defect** – Do not use the dryer if it is defective or if you suspect it is.
Repairs must only be carried out by the after-sales service.
– Do not use the dryer if the mains cable is defective. To avoid danger, only have the defective mains cable replaced by the after-sales service.
– Always pull the mains plug out of the socket before changing the bulb for the interior light → **risk of electric shock**.
- Spare parts** – Only use genuine spare parts and accessories for safety reasons.
- Disposal** – Dryer: pull out the appliance plug, **then** cut off the mains cable from the appliance.
Dispose of at municipal waste disposal facility.
– Packaging: do not leave children alone with packing parts → **risk of suffocation**.
– All materials are environmentally sound and can be reused. Dispose of in an environmentally-responsible manner.



Dryer

en Instruction manual