

Your washing machine

Congratulations - you have opted for a modern, high-quality domestic appliance manufactured by Bosch. The washing machine is distinguished by its economical water- and energy consumption. Each machine that leaves our factory is inspected thoroughly to ensure that it functions properly and is in perfect condition.

Further information: www.bosch-home.com

Environmentally friendly waste disposal

All packaging must be disposed of in accordance with environmental guidelines. This appliance is certified in accordance with European Directive 2002/96/EEC on waste electrical and electronic equipment (WEEE). This directive provides the framework for the EU-wide collection and reuse of used appliances.

Contents

■ Intended use	1
■ Programmes	1
■ Setting and adjusting the programme	3
■ Washing	3/4
■ After washing	4
■ Individual settings	5
■ Important information	6
■ Overview of programmes	7
■ Safety instructions	8
■ Consumption values	8
■ Care	9
■ Information on the display panel	9
■ Maintenance	10
■ What to do if...	11

Environmental protection/Conservation tips

- Always fill the washing machine with a maximum amount of laundry for the relevant programme.
- Wash normally soiled laundry without a pre-wash.
- Instead of **Cottons 90 °C**, choose the programme **@ Cottons Eco 60 °C**. Comparable cleaning result with significantly lower energy consumption.
- Measure the detergent according to the manufacturer's instructions and water hardness.
- If the laundry is then dried in the tumble dryer, select the spin speed according to the instructions of the dryer manufacturer.

Intended use

- for domestic use only,
- for machine-washable fabrics and hand-washable wool in detergent solution,
- to be operated with cold drinking water and commercially available detergents and care products which are suitable for use in washing machines.
- when determining the dosage of all washing powders, additives and cleaning agents, you must follow the manufacturer's instructions.

- ⚠ Do not leave children unattended near the washing machine.
- ⚠ The washing machine is not to be used by children or persons not familiar with the operating instructions.
- ⚠ Keep pets away from the washing machine.

Preparation

Correct installation according to the separate Installation instructions.

Checking the machine

- Never use a damaged machine.
- Inform the after-sales service.

Connecting the mains plug

Make sure your hands are dry. Take hold of the plug only.

Turning the tap on

Sorting and loading laundry

Follow the manufacturer's care information. According to the information on the care labels. According to type, colour, soiling and temperature. Do not exceed the maximum load -> page 7.

Follow important instructions -> page 6. Insert large and small items of laundry. Close the washing machine door and the rubber seal between the washing machine door and the drum.

Add detergent and care products

Measure accordingly: Amount of laundry, soiling, water hardness (ask your water supply company) and manufacturer's instructions. Pour liquid detergent into the appropriate dispenser and place in the drum.

Compartment II: Detergent for the main wash, water softener, bleach, stain remover
Compartment ⌘: Fabric softener, starch
Compartment I: Detergent for pre-wash

Setting and adjusting programmes**

Before washing for the first time
Wash once without any laundry -> page 9.

Washing

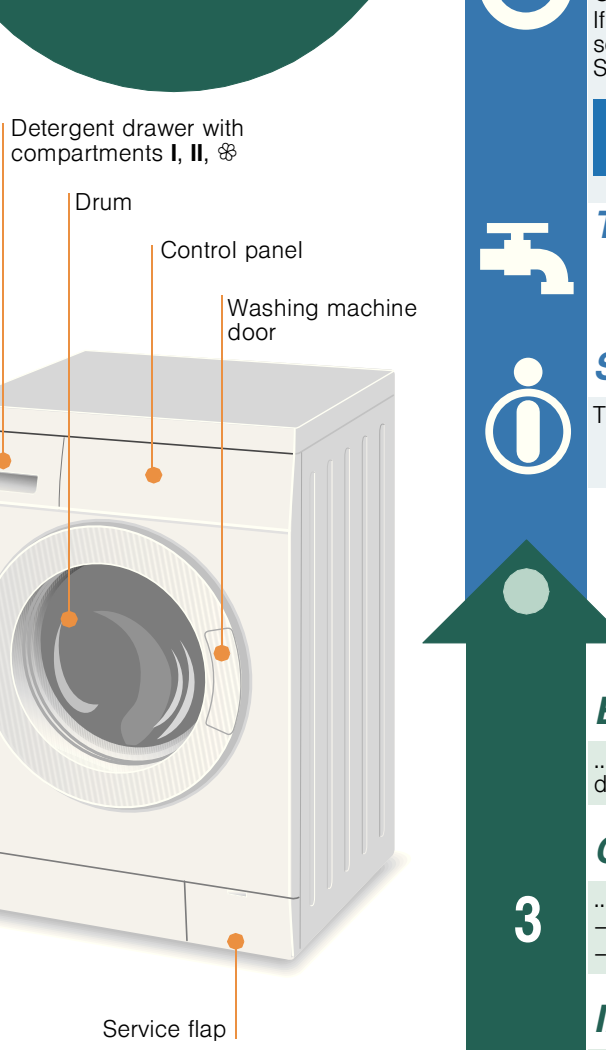

Removing the washing

Open the washing machine door and remove the washing. If **Drain** (without final spin) is active: Turn the programme selector to **Drain** or select the spin speed. Select **Start/Pause**.

- Remove any foreign objects - risk of rusting.
- Leave the washing machine door and detergent drawer open so that any residual water can evaporate.

Turning the tap off

Switching off

Turn the programme selector to **Off**.

End of programme when ...

... the **Start/Pause** flashes and **-0-** is displayed on the display panel.

Changing the programme, if ...

- ... you have selected the wrong programme by mistake:
 - Reselect the programme.
 - Select **Start/Pause**.

Interrupting the programme

- Programmes at high temperatures:
- Cool washing: Select **Rinse/Freshen up**. Washing machine door remains locked.
 - Select **Off**.
 - Select **Spin** or **Drain**.
 - Select **Start/Pause**.

Individual settings

Options buttons

The spin speed and temperature can be changed before and during the selected programme runs. The effects depend on the programme progress.

Temp. in °C

You can change the displayed washing temperature. The maximum washing temperature that can be selected depends on the programme that has been set.

Ready in

The respective programme duration is displayed by selecting the programme. The programme start can be delayed before the programme begins. The Ready in- time can be set in hour- steps up to a maximum of 24 hours. Press the **Ready in**-button repeatedly until the required number of hours is displayed (h = hour). Select **Start/Pause**.

rpm (Spin speed in rpm/no final spin)

You can change the displayed spin speed. The maximum selectable spin speed depends on the model and on which programme is currently selected.

Additional function -> and overview of programmes, see page 7

Intensive	Extension of the washing time for a more intensive washing of highly soiled washing or 6.5 kg of cottons and coloureds.
Prewash	For heavily soiled, hard-wearing washing, e.g. made of cotton or linen. Prewash at 30 °C.
Easy- Iron (depending on model)	Special Spin sequence with subsequent fluffing. Gentle final spin-residual moisture in the washing increased slightly.
Rinse Plus (depending on model)	Additional rinse cycle. For areas with very soft water or for further improvement of the rinsing result.

Start/Pause

For starting or interrupting the programme.

Signal

1. Activating the mode for setting the signal volume

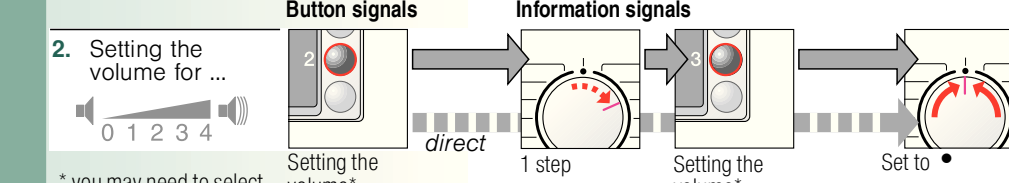
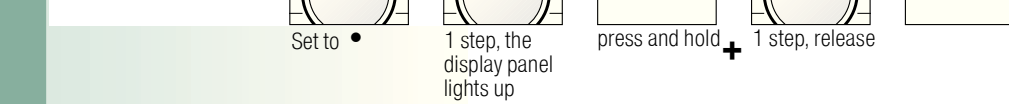

* you may need to select the function several times.

Important information

Protecting the laundry and the machine

- Empty pockets.
- Look out for metal items (paperclips, etc.).
- Wash delicates in a laundry bag (tights, curtains, underwired bras).
- Fasten zips, do up any buttons.
- Brush sand out of pockets and collars.
- Remove curtain fittings or place in the laundry bag.

Laundry with varying degrees of soiling

light	Wash new items of clothing separately. Do not pre-wash. If required, Pre-treat any stains as necessary. Choose the Intensive additional function.
heavy	Do not load as much laundry. Choose the Prewash additional function.

Soaking

Load laundry of the same colour

Pour soaking agent/detergent into compartment **II** in accordance with the manufacturer's instructions. Turn the programme selector to **Cottons 30 °C** and select **Start/Pause**. After approx. 10 minutes, press **Start/Pause** to pause the programme. Once the required soaking time has elapsed, select **Start/Pause** again to continue the programme, or select a different programme.

Starching

Laundry must not be treated with fabric softener

Starching is possible in all wash programmes if liquid starch is used. Pour the starch in accordance with the manufacturer's instructions into fabric softener compartment **⌘** (rinse first if necessary).

Dyeing/bleaching

Dye should only be used in normal household quantities. Salt may damage stainless steel. Always follow the dye manufacturer's instructions! Do **not** use the washing machine for bleaching clothes!

Freshen up

Use programme **Rinse/Freshen up**

For items, that have been tucked away or stored for a period of time, to remove creases caused by folding and storage and to eliminate odours. Use fabric conditioner for "fresh" smell.

Your washing machine

Congratulations - you have opted for a modern, high-quality domestic appliance manufactured by Bosch. The washing machine is distinguished by its economical water- and energy consumption. Each machine that leaves our factory is inspected thoroughly to ensure that it functions properly and is in perfect condition.

Further information: www.bosch-home.com

Environmentally friendly waste disposal



All packaging must be disposed of in accordance with environmental guidelines. This appliance is certified in accordance with European Directive 2002/96/EEC on waste electrical and electronic equipment (WEEE). This directive provides the framework for the EU-wide collection and reuse of used appliances.

Contents

	Page
Intended use	1
Programmes	1
Setting and adjusting the programme	3
Washing	3/4
After washing	4
Individual settings	5
Important information	6
Overview of programmes	7
Safety instructions	8
Consumption values	8
Care	9
Information on the display panel	9
Maintenance	10
What to do if...	11



Environmental protection/Conservation tips

- Always fill the washing machine with a maximum amount of laundry for the relevant programme.
- Wash normally soiled laundry without a pre-wash.
- Instead of **Cottons 90 °C**, choose the programme **Cottons Eco 60 °C**. Comparable cleaning result with significantly lower energy consumption.
- Measure the detergent according to the manufacturer's instructions and water hardness.
- If the laundry is then dried in the tumble dryer, select the spin speed according to the instructions of the dryer manufacturer.

Intended use

- for domestic use only,
- for machine-washable fabrics and hand-washable wool in detergent solution,
- to be operated with cold drinking water and commercially available detergents and care products which are suitable for use in washing machines.
- when determining the dosage of all washing powders, additives and cleaning agents, you must follow the manufacturer's instructions.



- Do not leave children unattended near the washing machine.
- The washing machine is not to be used by children or persons not familiar with the operating instructions.
- Keep pets away from the washing machine.

Preparation



Correct installation according to the separate Installation instructions.



Checking the machine

- Never use a damaged machine.
- Inform the after-sales service.



Connecting the mains plug



Make sure your hands are dry. Take hold of the plug only.



Turning the tap on

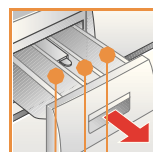

Compartment II: Detergent for the main wash, water softener, bleach, stain remover

Compartment ⌘: Fabric softener, starch

Compartment I: Detergent for pre-wash

Programmes

Detailed overview of programmes -> page 7. Temperature and spin speed can be selected individually, depending on the selected programme and programme progress.

Cottons	
Cottons Stains	hard-wearing fabrics
Cottons Eco	
Delicate/Silk	delicate washable fabrics
Wool	hand-/machine-washable wool
Easy-Care	easy-care fabrics
Dark Load	dark textiles
Rinse/Freshen up	with subsequent spin cycle; for hand-washed items, starching or freshen up items -> page 6.
Spin	washing washed by hand
Gentle Spin	washing washed by hand at reduced spin speed
Drain	the rinsing water if occurs
Mixed Load	different types of laundry
Express 15'	short programme
Sportswaer	textiles made of microfibres
Skin Care	hard-wearing fabrics

Additional functions*

Intensive
 Prewash
 Easy Iron
 Rinse Plus

Display panel/ options buttons

Start/ Pause

Pro

Skin Care
 Sportswear
 Express 15'
 Mixed Load
 Drain
 Gentle Spin
 Spin

*depending on model	⌘ - 90 Temp. °C	Selecting the temperature (⌘)
1 - 24h	Ready in	Programme ends in ...
- 1200* rpm		Select the spin speed (* depends on spin, laundry soaks in the last 15 minutes)
Status displays		Programme progress display
-0-		Washing, Rinse, Spin, End

Before washing for the first time
Wash once without any laundry → page 9.

Sorting and loading laundry

Follow the manufacturer's care information. According to the information on the care labels. According to type, colour, soiling and temperature. Do not exceed the maximum load → page 7.

Follow important instructions → page 6.
Insert large and small items of laundry.

Close the washing machine door. Take care not to trap items of laundry between the washing machine door and the rubber seal.

Add detergent and care products

Measure accordingly:
Amount of laundry, soiling, water hardness (ask your water supply company) and manufacturer's instructions.
Put liquid detergent into the appropriate dispenser and place in the drum.

i Dilute thick fabric softener and fabric conditioner with water. This prevents blockages.

Setting** and adjusting programmes

Programme selector

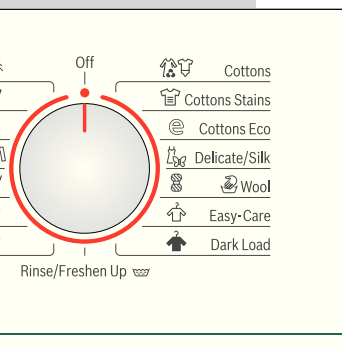

* = cold)

Depending on the model) or ☐ (no final
st rinsing water)

ys

Additional functions and options
buttons → Individual settings, page 5.

i All buttons are sensitive, they only need to be touched gently! If the options buttons are touched for longer, the setting options run automatically!

i Programme selector for switching the machine on and off and for selecting the programme. Can be turned in either direction.

Select ▷ Start/Pause

Washing

Detergent drawer with compartments I, II, ☐

Drum

Control panel

Washing machine door

Service flap

Washing

Removing the washing

Open the washing machine door and remove the washing. If ☐ (without final spin) is active: Turn the programme selector to ☐ **Drain** or select the spin speed. Select **Start/Pause** ▷.



- Remove any foreign objects - risk of rusting.
- Leave the washing machine door and detergent drawer open so that any residual water can evaporate.

Turning the tap off

Switching off

Turn the programme selector to **Off**.

End of programme when ...

... the ▷ **Start/Pause** flashes and **-0-** is displayed on the display panel.

Changing the programme, if ...

- ... you have selected the wrong programme by mistake:
- Reselect the programme.
 - Select ▷ **Start/Pause**.

Interrupting the programme

Programmes at high temperatures:

- Cool washing: Select ☐ **Rinse/Freshen up**. Washing machine door remains locked.
- Select **Off**.
- Select ☐ **Spin** or ☐ **Drain**.
- Select ▷ **Start/Pause**

Individual settings

Options buttons

The spin speed and temperature can be changed before and during the selected programme runs. The effects depend on the programme progress.

Temp. in °C

You can change the displayed washing temperature. The maximum washing temperature that can be selected depends on the programme that has been set.

Ready in

The respective programme duration is displayed by selecting the programme. The programme start can be delayed before the programme begins. The Ready in-time can be set in hour-steps up to a maximum of 24 hours. Press the **Ready in**-button repeatedly until the required number of hours is displayed (h = hour). Select **Start/Pause**.

rpm (Spin speed in rpm/no final spin)

You can change the displayed spin speed. The maximum selectable spin speed depends on the model and on which programme is currently selected.

Additional function -> and overview of programmes, see page 7

Intensive	Extension of the washing time for a more intensive washing of highly soiled washing or 6.5 kg of cottons and coloureds.
Prewash	For heavily soiled, hard-wearing washing, e.g. made of cotton or linen. Prewash at 30 °C.
Easy- Iron (depending on model)	Special Spin sequence with subsequent fluffing. Gentle final spin-residual moisture in the washing increased slightly.
Rinse Plus (depending on model)	Additional rinse cycle. For areas with very soft water or for further improvement of the rinsing result.

Start/Pause

For starting or interrupting the programme.

Signal

1. Activating the mode for setting the signal volume

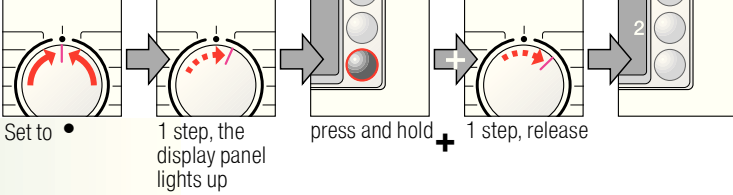

2. Setting the volume for ...

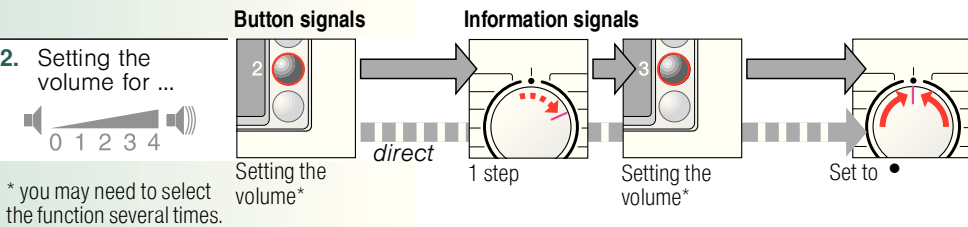

* you may need to select the function several times.



Important information





Protecting the laundry and the machine

- Empty pockets.
- Look out for metal items (paperclips, etc.).
- Wash delicates in a laundry bag (tights, curtains, underwired bras).
- Fasten zips, do up any buttons.
- Brush sand out of pockets and collars.
- Remove curtain fittings or place in the laundry bag.



Laundry with varying degrees of soiling

light		Wash new items of clothing separately. Do not pre-wash. If required,
heavy		Pre-treat any stains as necessary. Choose the Intensive additional function. Do not load as much laundry. Choose the Prewash additional function.



Soaking

Load laundry of the same colour

Pour soaking agent/detergent into compartment **II** in accordance with the manufacturer's instructions. Turn the programme selector to **Cottons 30 °C** and select **Start/Pause**. After approx. 10 minutes, press **Start/Pause** to pause the programme. Once the required soaking time has elapsed, select **Start/Pause** again to continue the programme, or select a different programme.



Starching

Laundry must not be treated with fabric softener

Starching is possible in all wash programmes if liquid starch is used. Pour the starch in accordance with the manufacturer's instructions into fabric softener compartment **8** (rinse first if necessary).



Dyeing/bleaching

Dye should only be used in normal household quantities. Salt may damage stainless steel. Always follow the dye manufacturer's instructions! Do **not** use the washing machine for bleaching clothes!



Freshen up

Use programme **Rinse/Freshen up**

For items, that have been tucked away or stored for a period of time, to remove creases caused by folding and storage and to eliminate odours. Use fabric conditioner for "fresh" smell.

Overview of programmes

-> Refer to the table of consumption values on page 8 and notes on page 6.

Programmes	°C (* = cold)	max.	Type of laundry	Additional functions; information
Cottons	❄ - 90 °C			
Cottons Stains	❄ - 60 °C			
Cottons Eco***	❄ - 60 °C	7.0 kg*	Hard-wearing fabrics, heat-resistant fabrics made of cotton or linen	Intensive , Prewash , Easy-Iron , Rinse Plus
Skin Care	❄ - 60 °C			Intensive , Prewash , Easy-Iron , Rinse Plus ; for particularly sensitive skin, prolonged washing at selected temperature, higher water level, additional rinse cycle
Easy-Care	❄ - 60 °C		Easy-care fabrics made of cotton, linen, synthetic fibres or blended fabrics	Intensive , Prewash , Easy-Iron , Rinse Plus
Mixed Load	❄ - 40 °C	3 kg*	Fabrics made of cotton or easy-care fabrics	Intensive , Prewash , Easy-Iron , Rinse Plus ; different types of laundry can be washed together
Dark Load	❄ - 40 °C		Dark textiles made of cotton and dark easy-care textiles	Intensive , Prewash , Easy-Iron , Rinse Plus ; reduced rinse and final spin cycles
Delicate/Silk	❄ - 30 °C		For delicate, washable fabrics, e.g. made of silk, satin, synthetic fibres or blended fabrics (e.g. curtains)	Intensive , Prewash , Easy-Iron , Rinse Plus ; No spin between rinse cycles
Wool	❄ 40 °C	2 kg	Hand- or machine-washable fabrics made of wool or containing wool	Particularly gentle wash programme to prevent shrinkage of laundry. Longer programme breaks (fabrics rest in the detergent solution)
Sportswear	❄ - 40 °C		Textiles made of microfibres	Intensive , Prewash , Easy-Iron , Rinse Plus
Express 15'	❄ - 40 °C		Easy-care fabrics made of cotton, linen, synthetic fibres or blended fabrics	Short programme, approx. 15 minutes, suitable for refreshing
Additional programmes				
Rinse/ Freshen up, Spin, Gentle Spin, Drain				
i The programmes are time-controlled for lightly soiled textiles. If textiles are heavily soiled, reduce the load or select additional functions, e.g. Intensive . Programmes without Prewash - add detergent to compartment II , programmes with Prewash - distribute the detergent between compartments I and II . * When washing the maximum load for programmes marked with *, always select the Intensive additional function. Regardless of the type of washing, Easy-Care 40 °C with maximum spin speed is the best short programme for the job. ** according to model *** The Cottons Eco 60 °C, 1200 rpm programme is recommended for normal use.				

Robert Bosch Hausgeräte GmbH
Carl-Wery-Str. 34
81739 München / Deutschland

9000 581 231
0511



Safety instructions

- Read the instruction manual and installation instructions and all other information enclosed with the washing machine and act accordingly.
- Retain the documents for subsequent use.

Risk of electric shock

- Never pull the cable to disconnect the mains plug.
- Never insert/disconnect the mains plug with damp hands.

Danger to life

For worn-out appliances:

- Disconnect the mains plug.
- Sever the mains cable and discard along with the plug.
- Destroy the lock on the washing machine door. This will prevent children from locking themselves in and risking their lives.

Danger of suffocation

- Keep packaging, film and packaging parts out of the reach of children.

Risk of poisoning

Risk of explosion

- Keep detergents and care products out of the reach of children.
- Items of laundry pretreated with cleaning agents containing solvents, e.g. stain remover/cleaning solvent may cause an explosion after being loaded into the washing machine. Rinse items of laundry thoroughly by hand beforehand.

Risk of injury

- The washing machine door can become very hot.
- Be careful when draining hot detergent solution.
- Do not climb onto the washing machine.
- Do not lean on the open washing machine door.
- Do not reach into the drum if it is still rotating.
- Be careful when opening the detergent drawer while the machine is in operation.

Consumption values

Programme	Additional function	Load	Electricity consumption**	Water**	Programme duration**
Cottons 40 °C	Intensive	7.0 kg	0,60 kWh	72 l	2:47 h
Cottons Eco 60 °C*	Intensive	7.0 kg	1,19 kWh	49 l	2:36 h
Cottons 90 °C	Intensive	7.0 kg	2,00 kWh	72 l	2:33 h
Easy-Care 40 °C	Intensive	3 kg	0.55 kWh	50 l	1:24 h
Easy-Care 40 °C	-	3 kg	0.54 kWh	40 l	0:55 h
Mixed Load 30 °C	-	3 kg	0.32 kWh	35 l	0:44 h
Delicate/Silk 30 °C	-	2 kg	0.25 kWh	38 l	0:32 h
Wool 30 °C	-	2 kg	0.15 kWh	34 l	0:40 h

* Programme setting with maximum spin speed for testing according to or in accordance with AS/NZS 2040.2 and AS/NZS 6400.

Note on comparative tests: test the test programme with maximum load, **Intensive** additional function selected, maximum spin speed.

A **short programme** which can be used for coloured items is **Easy-Care 40 °C**, without the **Intensive** additional function selected and set to maximum spin speed.

** The values deviate from the indicated values depending on water pressure, hardness, and inlet temperature, ambient temperature, type, amount and soiling of the laundry, detergent used, fluctuations in the power supply and selected additional functions.

Care



- Risk of electric shock. Disconnect the mains plug.
- Risk of explosion. No solvents.



Before washing for the first time

Do not load any laundry into the machine. Turn on the tap.

Add the following to compartment **II**:

- approx. 1 litre water
- detergent (dosage according to the manufacturer's instructions for light soiling and the appropriate degree of water hardness)

Set the programme selector to **Easy-Care**  **60 °C** and select  **Start/Pause**. At the end of the programme, turn the programme selector to **Off**.



Machine housing, control panel

- Remove detergent residue immediately.
- Wipe away with a soft, damp cloth.
- Do not clean with a jet of water.



Cleaning the detergent drawer ...

... if it contains detergent or fabric softener residues.

1. Pull out, press insert down, remove drawer completely.
2. Open the cover.
3. Clean the detergent dispenser tray and insert with water and a brush and dry it.
4. Attach the insert and engage (connect the cylinder to the guide pin).
5. Push in the detergent drawer.

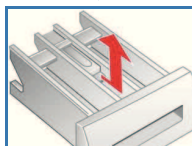
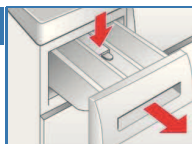

Leave the detergent drawer open so that any residual water can evaporate.



Drum

Leave the washing machine door open so that the drum can dry out.
Rust stains - use chlorine-free cleaning agent, not steel wool.



Descaling

Ensure there is no laundry in the machine

Descal the appliance according to the descaler manufacturer's instructions. This should not be necessary if the correct dosage of detergent is used.

Information on the display panel depending on model

F:16	Close the washing machine door properly; laundry may be caught.
F:17	Open the tap completely, supply hose kinked or trapped; Clean the filter → <i>page 10</i> , Water pressure too low.
F:18	Detergent solution pump blocked; Clean the detergent solution pump → <i>page 10</i> . Drainage hose/waste pipe blocked; Clean the drainage hose at the siphon → <i>page 10</i> .
F:21	Motor fault. Call customer service.
F:23	Water in the base pan, appliance leaking. Call customer service!

Maintenance



- Risk of scalding. Allow the detergent solution to cool down.
- Turn off the tap.



Detergent solution pump

Turn the programme selector to **Off** and disconnect the mains plug.

1. Open and remove the service flap.
2. **For models with a drainage hose:** Remove the drainage hose from the retainer and pull it from the housing. Remove the container. Remove the sealing cap, allow the detergent solution to flow out. Replace the sealing cap and place the drainage hose in the retainer.
- 2* **For models without a drainage hose:** Carefully unscrew the pump cover until the detergent solution begins to flow out. When the service flap is half full, close the pump cover and empty the service flap. Repeat the above steps until all the detergent solution has completely drained out.
3. Carefully unscrew the pump cover (residual water).
4. Clean the interior, pump cover thread and pump housing (the impeller in the detergent solution pump must rotate).
5. Replace the pump cover and screw it tightly.
6. Place the service flap back on and close.

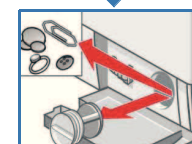
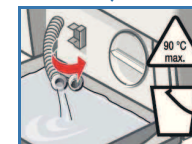
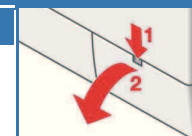

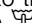
To prevent unused detergent from flowing straight into the drain during the next wash: Pour 1 litre of water into compartment **II** and start the  **Drain** programme.



Drainage hose at the siphon

Turn the programme selector to **Off** and disconnect the mains plug.

1. Loosen the hose clamp, carefully remove the drainage hose (residual water).
2. Clean the drainage hose and siphon connecting piece.
3. Reattach the drainage hose and secure the connection with the hose clamp.



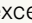
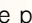

Filter in the water supply

Reduce the water pressure in the supply hose:

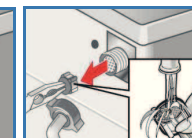
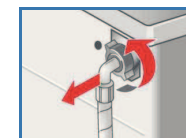
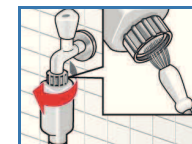
1. Turn off the tap.
2. Select any programme (except  **Spin**/ **Drain**).
3. Select  **Start/Pause**. Let the programme run for approximately 40 seconds.
4. Turn the programme selector to **Off**. Disconnect the mains plug.
5. Disconnect the hose from the tap.
6. Clean the filter using a small brush.
7. Depending on model, remove hose from rear of the appliance and clean filter.
8. Connect the hose and check for leaks.

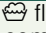
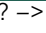

What to do if ...

Water is leaking out.	<ul style="list-style-type: none"> – Attach/replace the drainage hose correctly. – Tighten the screw connection of the supply hose.
No water supply. Detergent not dispensed.	<ul style="list-style-type: none"> – Is Start/Pause not selected? – Tap not turned on? – Filter blocked? Clean the filter → <i>page 10</i>. – Supply hose kinked or trapped?
Washing machine door cannot be opened.	<ul style="list-style-type: none"> – Safety function active. Wait approx. 2 minutes. – Start/Pause (without final spin) selected? → <i>page 4</i>.
Programme does not start.	<ul style="list-style-type: none"> – Start/Pause or Ready in selected? – Washing machine door closed?
Detergent solution is not drained.	<ul style="list-style-type: none"> – Start/Pause (without final spin) selected? → <i>page 4</i>. – Clean the detergent solution pump → <i>page 10</i>. – Clean the waste pipe and/or drainage hose.
Water not visible in the drum.	<ul style="list-style-type: none"> – Not a fault - water below the visible area.
Unsatisfactory spin result. Laundry wet/too damp.	<ul style="list-style-type: none"> – Not a fault - the unbalanced-load detection system has cancelled the spin cycle because of uneven distribution of the laundry. Distribute small and large items of laundry evenly inside the drum. – Speed selected too low? → <i>page 5</i>.
The programme duration changes during the wash cycle.	<ul style="list-style-type: none"> – Not a fault – the programme sequence is optimised for the particular wash process. This may result in changes to the programme duration in the display field.
Spin cycle performed several times.	<ul style="list-style-type: none"> – Not a fault - unbalanced load detection system adjusts the imbalance.
Residual water in the compartment for care products.	<ul style="list-style-type: none"> – Not a fault - the action of the care product is not affected. – Clean the insert if necessary → <i>page 9</i>.
Odour formation in the washing machine.	<ul style="list-style-type: none"> – Run programme Cottons Stains 90 °C without laundry. Use standard detergent.
Status display  flashes. Foam may be coming out of the detergent drawer.	<ul style="list-style-type: none"> – Too much detergent used? Mix 1 tablespoon of fabric softener with ½ litre of water and pour into dispenser II (not for outdoor and down-filled textiles!). – Reduce the detergent dosage for the next wash cycle.
Intense noise formation, vibrations and “wandering” during the spin cycle.	<ul style="list-style-type: none"> – Are the appliance feet fixed? Secure the appliance feet → <i>Installation instructions</i>. – Transportation safety devices removed? Remove the transportation safety devices → <i>Installation instructions</i>.
Spin result not satisfactory.	<ul style="list-style-type: none"> – Easy-Iron  selected? → <i>page 5</i>.
Display panel/indicator lamps do not function during operation.	<ul style="list-style-type: none"> – Power cut? – Fuses triggered? Reset/change the fuses. – If the fault occurs repeatedly, call the after-sales service.
Programme sequence longer than usual.	<ul style="list-style-type: none"> – Not a fault - unbalanced load detection system adjusts imbalance by repeatedly distributing the laundry. – Not a fault - foam detection system active - adds an additional rinse cycle.
Detergent residues on the laundry.	<ul style="list-style-type: none"> – Occasionally, phosphate-free detergents contain water-insoluble residues. – Select Rinse/Freshen up  or brush the laundry after washing.

If you cannot correct a fault yourself (switching on/off) or a repair is required:

- Turn the programme selector to **Off** and remove the mains plug from the socket.
- Turn off the water supply and call the after-sales service → *Installation instructions*.



Washing machine



en Instruction manual