

Your washing machine

Congratulations – You have opted for a modern, high-quality domestic appliance manufactured by Bosch. The washing machine is distinguished by its economical energy consumption.

Each appliance which leaves our factory is inspected thoroughly to ensure that it functions properly and is in perfect condition.

For further information go to our web site:
http://www.bosch-home.com

Environmental disposal

Dispose of packaging in an environmentally friendly manner. This appliance has been identified in accordance with the European Directive 2002/96/EG on Waste Electrical and Electronic Equipment (WEEE). The Directive specifies the framework for an EU-wide valid return and recycling of waste appliances.



Contents

Page

Intended use	1
Overview of programmes	1
Selecting and adjusting a programme	3
Washing	3/4
After washing	4
Individual settings	5/6
Important information	6
Overview of programmes	7
Safety instructions	8
Consumption values	8
Care	9
Information on the display panel	9
Maintenance	10
What to do if ...	11

Protection of the environment/ conservation tips

- Utilise the maximum amount of washing for the particular programme.
- Wash normally soiled washing without prewash.
- Instead of the **Cottons 90 °C** programme, select **Cottons Eco 60 °C** and **Wash Plus** additional function. Comparable cleaning result with significantly lower energy consumption.
- Meter detergent according to the manufacturer's instructions and water hardness.
- If the washing is then dried in the tumble dryer, select spin speed according to the instructions of the dryer manufacturer.

Intended use

- for use in the household only,
- for the washing of machine-washable textiles in a detergent solution,
- to be operated with cold drinking water and commercially available detergents and care products which are suitable for use in washing machines.

- Do not leave children unattended near the washing machine!
- The appliance is not intended for use by young children or infirm persons without supervision.
- Keep pets away from the washing machine!

Programmes

For detailed overview of programmes see -> Page 7. Temperature and spin speed can be selected individually irrespective of the selected programme and programme

- Cottons** ... hard-wearing textiles
- Cottons Stains** ... hard-wearing textiles
- Cottons Eco** ...
- Easy-Care** ... easy-care textiles
- Silk** ... delicate washable textiles
- Mixed Load** ... different types of washing
- Rinse** ... with subsequent spin cycle
- Spin** ... washing washed by hand
- Drain** ... the rinsing water if occurs
- Wool** ... hand/machine washable textiles
- Dark Wash** ... dark textiles
- PowerWash** ... hard-wearing textiles
- SuperQuick** ... short programme
- Sports wear** ... textiles made of microfibres
- Sensitive** ... hard-wearing textiles

Preparation

Correct installation according to separate installation instructions!

Checking the machine

Never switch on a damaged machine! Inform your customer service!

Insert mains plug

With dry hands only! Take hold of the plug only!

Turn on the tap

Dispenser II: detergent for main wash, softener, bleaching agent, stain remover
Dispenser ⌘: fabric softener, starch
Dispenser I: detergent for prewash

Before using your washing machine for the first time wash once without any washing -> Page 9.

Sorting and inserting the washing

Follow manufacturer's care information! According to the information on the care labels. According to type; colour; soiling and temperature. Do not exceed maximum load -> Page 7.

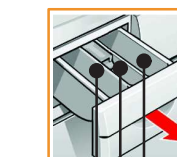

Add detergent and care product

Meter accordingly: Washing amount, soiling, water hardness (ask your water supply company) and manufacturer's instructions. Pour liquid detergent into the appropriate dispenser and place in the drum.

Dilute viscous fabric softener and fabric conditioner with water. Prevents blockage of the overflow.

Selecting** and adjusting a programme

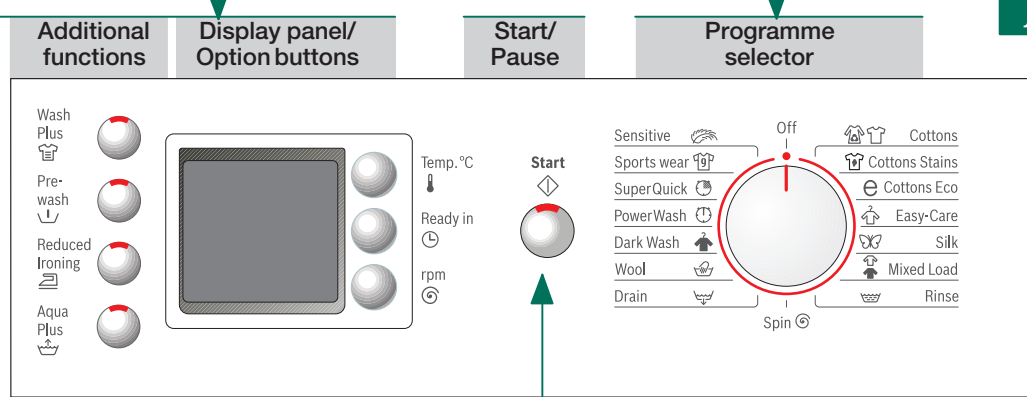

** If the symbol -> flashes on the display panel, childproof lock active -> Deactivate, Page 5. Additional functions and option buttons -> Individual settings, Page 5.

All buttons are sensitive, they only need to be touched gently! If the Option buttons are touched for longer, the selected options will run automatically!

Select **Start**

Programme selector for switching the machine on and off and for selecting the programme. Can be rotated in either direction.

* - 90	Select the temperature (* = cold)
1 - 24h	Programme ends in ...
- 1400 *	Select the spin speed (* depending on model) or (without final spin)
Status displays	Programme progress displays:
-0-	Washing, Rinse, Spin, programme duration or end (-0-)
o	Childproof lock -> Page 5.
o	Open door, top up washing -> Pages 4, 5.

Washing

Detergent drawer with dispensers I, II, ⌘

Drum

Fascia

Door

Service flap

1

2

3

Washing

3

Washing

3

Removing the washing

Open washing machine door and remove washing. Remove any foreign objects – risk of rusting. Leave door and detergent drawer open so that residual water can evaporate.

Turn off tap

Not required for Aqua-Stop models -> Installation instructions.

Switch off

Set programme selector to **Off**.

End of programme when ...

... **Start** flashes and **-0-** is indicated on the display panel.
If (Rinse stop = without final spin) active: Set programme selector to **Drain** or select spin speed. Select **Start**.

Terminating the programme

Programmes with high temperature, first:
- Cool washing: Select **Rinse**. Washing machine door remains locked.
- Select **Off**.
- Select **Spin** or **Drain**.
- Select **Start**.

Change programme if ...

... you have mistakenly selected a wrong programme:
- Reselect programme.
- Select **Start**. The new programme starts from the beginning.

Top up washing if ... -> Page 5.

... **Start** selected and then **YES + o** are lit on the display panel. If **NO**, the door cannot be opened.
- Select **Start**.

4

Individual settings

Option buttons

You can change the spin speed and temperature beforehand and while the selected programme is running. Effects dependent on the programme progress.

Temp. °C

You can change the indicated washing temperature. The maximum washing temperature which can be selected depends on the set programme.

Ready in

The respective programme duration is displayed by selecting the programme. The programme start can be delayed before the programme begins. The Ready in-time can be set in hour-steps up to maximum 24h. Keep pressing the **Ready in** button until the required number of hours is indicated (h=hour). Select **Start**.

rpm (Revolutions per minute)

You can change the indicated spin speed. The maximum spin speed which can be selected depends on the set programme.

Additional functions -> see also Overview of programmes, Page 7.

- Wash Plus** Extension of the washing time for a more intensive washing of highly soiled washing or for washing at maximum load -> Overview of programmes, Page 7.
- Prewash** For heavily soiled, hard-wearing washing, e.g. made of cotton or linen. Prewash at 30 °C.
- Reduced Ironing** Special spin sequence with subsequent fluffing. Gentle final spin – residual moisture in the washing increased slightly.
- Aqua Plus** Increased water level and additional rinse cycle, extended washing time. For areas with very soft water or for further improvement of the rinsing result.

Childproof lock and top up

Childproof lock/appliance lockout Secure the washing machine to prevent the set functions from being unintentionally changed.
ON/OFF: After the programme starts/ends press Start/Pause for approx. 5 seconds.
Note: Childproof lock may remain activated until the next programme starts, even after the machine has been switched off! Then deactivate the childproof lock before the programme starts and, if required, re-activate after the programme starts.

YES + o Top up Select **Start** button if you want to add more items of washing after the programme starts. The machine checks whether a top-up is possible.
YES + o are lit: Top up possible.
YES flashes: Spin speed too high, wait until **YES + o** are lit.
NO: Top up not possible.
Note: At a high water level and/or temperature or during the spin cycle the door remains locked for reasons of safety. To continue the programme, select the **Start** button.

Top up if Ready in button was selected Set programme selector to **Off**. Reselect programme and, if required, **Ready in** time. Open door. Top up washing. Close door again. Select **Start** button.

Start

To start the programme or top up washing and to activate/deactivate the childproof lock.

5

Individual settings

Signal

1. Activate setting mode for signal volume
turn to • 1 step to right, display panel is lit + 1 step to right, keep selected and release

2. Set volume for ...
Set volume * 1 step to right Set volume * set to •
* If required, select repeatedly

Important information

Protecting the washing and the machine

- Empty pockets.
- Remove metal parts (paper clips, etc.).
- Wash delicates in the net/bag (tights, curtains, underwired bras).
- Close zips, button up covers.
- Brush sand out of pockets and collars.
- Remove curtain fittings or include in the net/bag.

Washing with different degrees of soiling

Light	Wash new items separately. Do not prewash.
Medium	If required, pretreat stains. Select Wash Plus additional function.
Heavy	Load less washing. Prewash. If required, select additional option Wash Plus .

Soaking

Load washing of the same colour. Pour soaking agent/detergent into dispenser II according to the manufacturer's instructions. Set programme selector to **Cottons 30 °C** and select **Start**. After approx. 10 minutes select **Start**. After the required soaking time reselect **Start** if the programme is to be continued or change the programme.

Starching

Washing should not be treated with fabric softener. Liquid starch can be used in all wash programmes. Pour starch into the fabric softener dispenser according to manufacturer's specifications ⌘ (if required clean beforehand).

Dyeing/Bleaching

Dye in household quantities only. Salt may attack stainless steel! Observe specifications of the dye manufacturer! Do not bleach washing in the washing machine.

6

Programme	°C	max.	Type of washing	Additional functions; information
☀ Cottons	90 °C		Hard-wearing textiles, heat-resistant textiles made of cotton or linen	☑ Wash Plus, ☑ Prewash, ☑ Reduced Ironing, ☑ Aqua Plus
☀ Cottons Stains	60 °C	7 kg *	Hardwearing textiles made of cotton or linen	☑ Wash Plus, ☑ Prewash, ☑ Reduced Ironing, ☑ Aqua Plus; for especially sensitive skin, extended wash cycle at selected temperature, higher water level, additional rinse cycle
☀ Cottons Eco	60 °C		Hardwearing textiles made of cotton or blended fabrics	☑ Wash Plus, ☑ Prewash, ☑ Reduced Ironing, ☑ Aqua Plus; short programme for normally soiled washing.
☀ Sensitive	60 °C		Hardwearing textiles made of cotton, linen, synthetic fibres or blended fabrics	☑ Wash Plus, ☑ Prewash, ☑ Reduced Ironing, ☑ Aqua Plus; different types of washing can be washed together
☀ PowerWash	60 °C	4 kg	Easy-care textiles made of cotton, linen, synthetic fibres or blended fabrics	☑ Wash Plus, ☑ Prewash, ☑ Reduced Ironing, ☑ Aqua Plus; reduced rinse and final spin cycle
☀ Easy-Care	60 °C	3 kg *	Textiles made of cotton and easy-care textiles	☑ Wash Plus, ☑ Prewash, ☑ Reduced Ironing, ☑ Aqua Plus; especially gentle wash programme to prevent shrinkage, longer programme pauses (textiles rest in wash liquor)
☀ Mixed Load	40 °C		Dark textiles made of cotton and dark easy-care textiles	☑ Wash Plus, ☑ Prewash, ☑ Reduced Ironing, ☑ Aqua Plus; no spin cycle between the rinse cycles
☀ Dark Wash	40 °C		For delicate, washable textiles, e.g. made of silk, satin, synthetic fibres or blended fabrics (e.g. curtains)	☑ Wash Plus, ☑ Prewash, ☑ Reduced Ironing, ☑ Aqua Plus; especially gentle wash programme to prevent shrinkage, longer programme pauses (textiles rest in wash liquor)
☀ Silk	30 °C		Hand or machine-washable wool or rich-wool textiles	☑ Wash Plus, ☑ Prewash, ☑ Reduced Ironing, ☑ Aqua Plus; short programme approx. 15 minutes suitable for washing lightly soiled items
☀ Wool	40 °C	2 kg	Easy-care textiles made of cotton, linen, synthetic fibres or blended fabrics	☑ Wash Plus, ☑ Prewash, ☑ Reduced Ironing, ☑ Aqua Plus; suitable for washing lightly soiled items
☀ SuperQuick	40 °C		Textiles made of microfibrils	☑ Wash Plus, ☑ Prewash, ☑ Reduced Ironing, ☑ Aqua Plus
☀ Sports wear	40 °C		Textiles made of microfibrils	☑ Wash Plus, ☑ Prewash, ☑ Reduced Ironing, ☑ Aqua Plus

Additional programmes ☑ **Rinse**, ☑ **Spin**, ☑ **Drain**

The programmes are time-controlled for lightly soiled textiles. If textiles are heavily soiled select additional functions **Wash Plus**.
* When washing at maximum load, in the appropriate programme always select **Wash Plus** additional function. Irrespective of type of washing, **Easy-Care 40 °C** at max. spin speed is optimally suitable as **Short programme**. Programmes without prewash – pour detergent into dispenser II, programmes with prewash – divide detergent between dispensers I and II.

Robert Bosch Hausgeräte GmbH
Carl-Wery-Str. 34
81739 München/Germany
9000 422 500
0110
WAE24468GB ...

Safety instructions

- Read and follow the operating and installation instructions and all other information enclosed with the washing machine.
- Retain documents for subsequent use.

Risk of electric shock

- Never pull out the mains plug by tugging the power cord!
- Never insert/pull out the mains plug with damp hands.

Danger to life

On redundant appliances:

- Pull out the mains plug!
- Sever the power cord and discard together with the plug.
- Destroy the lock on the washing machine door. This will prevent children from locking themselves in and suffocating.

Risk of suffocation

- Keep packaging, plastic film and packaging parts out of the reach of children.
- Keep detergents and care products out of the reach of children.
- Caused by detergents containing solvents, e.g. stain remover/items of washing pretreated with solvent naphtha may result in an explosion after being loaded into the washing machine. Before hand thoroughly rinse items of washing by hand.

Risk of poisoning

Risk of explosion

- Washing machine door may become very hot.
- Caution when draining hot detergent solution.
- Do not climb on the washing machine.
- Do not lean on the open washing machine door.
- Do not reach into the drum in case it is still rotating.
- Caution when opening the detergent drawer while the appliance is running!

Consumption values

Programme	Additional function	Load	Current**	Water**	Programme duration**
☀ Cottons 40 °C *	☑ Wash Plus	7 kg	0.65 kWh	60 l	2:30 h
☀ Cottons Eco 60 °C *	☑ Wash Plus	7 kg	1.05 kWh	47 l	2:58 h
☀ Cottons 90 °C	☑ Wash Plus	7 kg	2.00 kWh	75 l	2:33 h
☀ Easy-Care 40 °C *	☑ Wash Plus	3 kg	0.55 kWh	50 l	1:24 h
☀ Easy-Care 40 °C * (also suitable as Short programme)	–	3 kg	0.54 kWh	40 l	0:55 h
☀ Mixed Load 30 °C	–	3 kg	0.32 kWh	35 l	0:44 h
☀ Silk 30 °C	–	2 kg	0.25 kWh	38 l	0:32 h
☀ Wool 30 °C *	–	2 kg	0.15 kWh	34 l	0:40 h

* Programme setting for test according to currently valid European standard 60456. Information about comparability tests: The test programmes test at: maximum load, ☑ **Wash Plus** additional function, maximum spin speed. Select the ☑ **Easy-Care 40 °C** programme without ☑ **Wash Plus** additional function and at maximum spin speed as **Short programme** for coloureds wash.
** The values deviate from the indicated values depending on water pressure, water hardness, water inlet temperature, room temperature, type and amount of washing and degree of soiling, utilised detergent, fluctuations in the mains voltage and selected additional functions.

Care

Before using your washing machine for the first time

- Do not put any washing in the washing machine! Turn on the tap, fill the appliance with approx. 1 litre of water and then pour ½ measuring cup of detergent into dispenser II. Set programme selector to ☑ **Easy-Care 60 °C** and select ☑ **Start**. At the end of the programme set the programme selector to **Off**.

Machine housing, control panel

- Wipe with a soft, damp cloth.
- Do not use abrasive cloths, sponges or detergents (stainless steel cleaner).
- Immediately remove washing and cleaning agent residue.
- Do not clean the appliance with a water jet.

Clean the detergent drawer ...

... if it contains detergent or fabric softener residue.

- Pull out, depress insert, take out drawer all the way. Take out insert: using your finger, press insert upwards.
- Clean detergent dispenser and insert with water and a brush and dry.
- Attach insert and lock into position (push cylinder onto guide pin).
- Insert detergent drawer.

Leave detergent drawer open so that residual water can evaporate.

Drum

- Leave washing machine door open so that the drum can dry out. Rust stains – use chlorine-free cleaning agent, not steel wool.

Descaling No washing in the machine!

Descal according to the instructions of the descaling agent-manufacturer, not required for correct detergent dosage.

Emergency release, e.g. if power failure occurs

The programme continues running when the power is restored. If the washing is still to be removed, the door can be opened as described below:

Risk of scalding! Wash liquor and washing may be hot. If required, leave to cool down. Do not reach into the drum in case it is still rotating. Do not open the door if you can still see water through the glass.

- Select programme selector to **Off**, pull out the mains plug.
- Drain detergent solution → Page 10.
- Pull down emergency release with a tool and release. Door can then be opened.

Information on display panel

depending on model

F:16	Close the washing machine door properly; washing may be caught.
F:17	Turn on the tap all the way, supply hose kinked/jammed; clean filter → Page 10, water pressure too low.
F:18	Filter blocked; clean detergent solution pump → Page 10. Outlet pipe/drainage hose blocked; clean detergent solution pump → Page 10.
F:21	Motor fault. Call customer service!
F:23	Water in the base pan, appliance leaking. Call customer service!

Maintenance

Detergent solution pump

Set programme selector to **Off**, pull out the mains plug.

- Open and remove service flap.

For models with drainage hose:

- Take drainage hose out of the holder and pull out of the housing. Place a container on the floor. Remove sealing cap, allow detergent solution to flow out. Press on sealing cap and insert drainage hose into the holder.

For models without drainage hose:

- Carefully unscrew pump cover until the detergent solution begins to run out. When the service flap is half full, screw back the pump cover and empty the service flap. Repeat steps until all the detergent solution has run out.

- Carefully unscrew the pump cover (residual water).
- Clean the interior, pump cover thread and pump housing (fan impeller in the detergent solution pump must rotate).
- Reinsert and screw on pump cover.
- Insert and close service flap.

To prevent unused detergent from flowing into the outlet during the next wash: Pour 1 litre of water into dispenser II and start the **Drain** programme.

Drainage hose on the siphon

Set programme selector to **Off**, pull out the mains plug.

- Loosen hose clip, carefully remove drainage hose (residual water).
- Clean drainage hose and siphon spigot.
- Re-attach drainage hose and secure connection point with hose clip.

Filters in the water supply

Risk of electric shock! Do not immerse Aqua-Stop safety device in water (contains electric valve).

Release water pressure in the supply hose:

- Turn off the tap!
- Select any programme (except ☑ **Spin**/☑ **Drain**).
- Select ☑ **Start**. Leave programme for approx. 40 seconds.
- Set programme selector to **Off**. Pull out the mains plug!

Clean the filter: According to model:

- Remove hose from tap. Clean filter with small brush.

and/or for standard and Aqua-Secure models:

- Remove hose from the rear of the appliance. Take out filter with pliers and clean. Connect the hose and check for leaks.

What to do if ...

- Water is running out.
 - Correctly attach/replace drainage hose.
 - Tighten screw-fitting on the supply hose.
- Water not flowing in. Detergent not washed in.
 - ☑ **Start** not selected?
 - Tap not open?
 - Filter blocked? Clean filter → Page 10.
 - Supply hose kinked or jammed?
- Washing machine door cannot be opened.
 - Safety function active. Stop programme? → Page 4.
 - ☑ (without final spin) selected? → Page 4.
 - Can be opened via emergency release only? → Page 9.
- Programme does not start.
 - ☑ **Start** or ☑ **Ready in-time** selected?
 - Door closed?
 - Childproof lock active? Deactivate → Page 5.
- Detergent solution is not drained.
 - Clean detergent solution pump → Page 10.
 - Clean outlet pipe and/or drainage hose.
- Water not visible in the drum.
 - Not a fault – water below the visible area.
- Spin result not satisfactory.
 - Distribute small and large items of washing in the drum.
 - ☑ **Reduced Ironing** selected → Page 5.
 - Too low speed selected → Page 5.
- Spin cycle actuated several times.
 - Not a fault – unbalanced load detection system adjusts imbalance.
- Residual water in the dispenser for care product.
 - Not a fault – effect of the care product not impaired.
 - If required, clean insert → Page 9.
- Odour formation in the washing machine.
 - Run ☑ **Cottons 90 °C** programme without washing. Use standard detergent.
- Status display ☑ flashes. Overdosage of detergent detected.
 - Too much detergent used? If detergent comes out of the detergent drawer: mix 1 tablespoon of fabric softener with ½ litre of water and pour into dispenser II (not for outdoor textiles).
 - Reduce detergent dosage for the next wash cycle.
- Loud noise formation, vibrations and "Wandering" during spin cycle.
 - Appliance feet fixed? Secure appliance feet → Installation instructions.
 - Transportation safety devices removed? Remove transportation safety devices → Installation instructions.
- Display panel/indicator lights do not function while the appliance is running.
 - Power failure?
 - Fuse tripped? Switch on/replace fuse.
 - If the fault occurs repeatedly, call customer service.
- Programme progress longer than usual.
 - Not a fault – unbalanced load detection system adjusts imbalance by repeatedly distributing the washing.
 - Not a fault – foam detection system active – a rinse cycle is switched on.
- Detergent residue on the washing.
 - Occasionally phosphate-free detergents contain water insoluble residue.
 - Select ☑ **Rinse** or brush the laundry after washing.
- If a fault cannot be rectified or a repair is required:
 - Set programme selector to **Off** and pull out the mains plug.
 - Turn off the tap and call customer service → Installation instructions.

Washing machine

en

Operating instructions

BOSCH

Follow the safety instructions on Page 8!

Do not switch on the washing machine until you have read these instructions and the separate installation instructions!

Your washing machine

Congratulations— You have opted for a modern, high-quality domestic appliance manufactured by Bosch. The washing machine is distinguished by its economical energy consumption.

Each appliance which leaves our factory is inspected thoroughly to ensure that it functions properly and is in perfect condition.

For further information go to our web site:
<http://www.bosch-home.com>

Environmental disposal

Dispose of packaging in an environmentally friendly manner. This appliance has been identified in accordance with the European Directive 2002/96/EG on Waste Electrical and Electronic Equipment (WEEE).

The Directive specifies the framework for an EU-wide valid return and recycling of waste appliances.



Contents

Page

Intended use	1
Overview of programmes	1
Selecting and adjusting a programme	3
Washing	3/4
After washing	4
Individual settings	5/6
Important information	6
Overview of programmes	7
Safety instructions	8
Consumption values	8
Care	9
Information on the display panel	9
Maintenance	10
What to do if ...	11



Protection of the environment/ conservation tips

- Utilise the maximum amount of washing for the particular programme.
- Wash normally soiled washing without prewash.
- Instead of the **Cottons 90 °C** programme, select **Cottons Eco 60 °C** and **Wash Plus** additional function. Comparable cleaning result with significantly lower energy consumption.
- Meter detergent according to the manufacturer's instructions and water hardness.
- If the washing is then dried in the tumble dryer, select spin speed according to the instructions of the dryer manufacturer.

Intended use

- for use in the household only,
- for the washing of machine-washable textiles in a detergent solution,
- to be operated with cold drinking water and commercially available detergents and care products which are suitable for use in washing machines.

- Do not leave children unattended near the washing machine!
- The appliance is not intended for use by young children or infirm persons without supervision.
- Keep pets away from the washing machine!

Programmes

For detailed overview of programmes see → Page 7. Temperature and spin speed can be selected individually irrespective of the selected programme and programme

- Cottons** } hard-wearing textiles
- Cottons Stains** } hard-wearing textiles
- Cottons Eco** } hard-wearing textiles
- Easy-Care** } easy-care textiles
- Silk** } delicate washable textiles
- Mixed Load** } different types of washing
- Rinse** } with subsequent spin cycle
- Spin** } washing washed by hand
- Drain** } the rinsing water if occurs
- Wool** } hand/machine washable textiles
- Dark Wash** } dark textiles
- PowerWash** } hard-wearing textiles
- SuperQuick** } short programme
- Sports wear** } textiles made of microfibres
- Sensitive** } hard-wearing textiles

Preparation

Correct installation according to separate installation instructions!

Checking the machine

Never switch on a damaged machine! Inform your customer service!

Insert mains plug

With dry hands only! Take hold of the plug only!

Turn on the tap

Dispenser II: detergent for main wash, softener, bleaching agent, stain remover
Dispenser ⌘: fabric softener, starch
Dispenser I: detergent for prewash

Additional functions

- Wash Plus
- Pre-wash
- Reduced Ironing
- Aqua Plus

Display panel/ Option buttons

Temp. °C
 Ready in
 rpm

Start/ Pause

Start

Programme selection

- Sensitive
- Sports wear
- SuperQuick
- PowerWash
- Dark Wash
- Wool
- Drain

Temperature and Spin Speed Selection

- ⌘ – 90 °C
- 1 – 24h
- ☒ – 1400 * rpm

Status displays

- ☒ ☒ ☒ – 0- (Washing, Rinse, Spin, programme progress)
- ☒ (Childproof lock → Page 5)
- Ⓞ (Open door, top up washing → Page 5)

Before using your washing machine for the first time

wash once without any washing -> Page 9.

Sorting and inserting the washing

Follow manufacturer's care information!
According to the information on the care labels.
According to type; colour; soiling and temperature.
Do not exceed maximum load -> Page 7.



Follow important instructions! -> Page 6!

Insert large and small items of washing!
Turn off the tap. Do not jam items of washing between the washing machine door and rubber seal.

Add detergent and care product

Meter accordingly:

Washing amount, soiling, water hardness (ask your water supply company) and manufacturer's instructions. Pour liquid detergent into the appropriate dispenser and place in the drum.



Dilute viscous fabric softener and fabric conditioner with water. Prevents blockage of the overflow.

Selecting** and adjusting a programme



** If the symbol flashes on the display panel, childproof lock active -> Deactivate, Page 5.
Additional functions and option buttons -> Individual settings, Page 5.



All buttons are sensitive, they only need to be touched gently!
If the Option buttons are touched for longer, the selected options will run automatically!

Programme selector

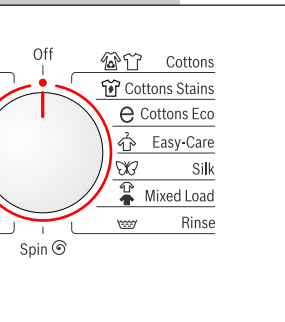

Select Start



Programme selector for switching the machine on and off and for selecting the programme. Can be rotated in either direction.

Washing

Detergent drawer with dispensers I, II, III

Drum

Fascia

Door



Service flap



Removing the washing

Open washing machine door and remove washing.
Remove any foreign objects – risk of rusting.
Leave door and detergent drawer open so that residual water can evaporate.

Turn off tap

Not required for Aqua-Stop models -> Installation instructions.

Switch off

Set programme selector to **Off**.

End of programme when ...

... Start flashes and **-0-** is indicated on the display panel.

If (Rinse stop = without final spin) active:
Set programme selector to **Drain** or select spin speed.
Select **Start**.

Terminating the programme

- Programmes with high temperature, first:
- Cool washing: Select **Rinse**.
Washing machine door remains locked.
 - Select **Off**.
 - Select **Spin** or **Drain**.
 - Select **Start**.

Change programme if ...

- ... you have mistakenly selected a wrong programme:
- Reselect programme.
 - Select **Start**. The new programme starts from the beginning.

Top up washing if ... -> Page 5.

- ... **Start** selected and then **YES** + are lit on the display panel. If **NO**, the door cannot be opened.
- Select **Start**.

1

2

3

Washing

Individual settings

Option buttons

You can change the spin speed and temperature beforehand and while the selected programme is running. Effects dependent on the programme progress.

Temp. °C

You can change the indicated washing temperature. The maximum washing temperature which can be selected depends on the set programme.



Ready in

The respective programme duration is displayed by selecting the programme. The programme start can be delayed before the programme begins. The Ready in-time can be set in hour-steps up to maximum 24h. Keep pressing the **Ready in** button until the required number of hours is indicated (h=hour). Select **Start**.

rpm (Revolutions per minute)

You can change the indicated spin speed. The maximum spin speed which can be selected depends on the set programme.

Additional functions → see also Overview of programmes, Page 7.

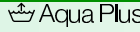
	Wash Plus	Extension of the washing time for a more intensive washing of highly soiled washing or for washing at maximum load → Overview of programmes, Page 7.
	Prewash	For heavily soiled, hard-wearing washing, e.g. made of cotton or linen. Prewash at 30 °C.
	Reduced Ironing	Special spin sequence with subsequent fluffing. Gentle final spin – residual moisture in the washing increased slightly.
	Aqua Plus	Increased water level and additional rinse cycle, extended washing time. For areas with very soft water or for further improvement of the rinsing result.

Childproof lock and top up

Childproof lock/appliance lockout Secure the washing machine to prevent the set functions from being unintentionally changed.
ON/OFF: After the programme starts/ends press Start/Pause for approx. 5 seconds.
 Note: Childproof lock may remain activated until the next programme starts, even after the machine has been switched off!
 Then deactivate the childproof lock before the programme starts and, if required, re-activate after the programme starts.

YES + Ready in Select **Start** button if you want to add more items of washing after the programme starts. The machine checks whether a top-up is possible.
YES + Ready in are lit: Top up possible.
YES flashes: Spin speed too high, wait until **YES + Ready in** are lit.
NO: Top up not possible.
 Note: At a high water level and/or temperature or during the spin cycle the door remains locked for reasons of safety.
 To continue the programme, select the **Start** button.

Top up if Ready in button was selected Set programme selector to **Off**. Reselect programme and, if required, **Ready in** time. Open door. Top up washing. Close door again. Select **Start** button.

Start

To start the programme or top up washing and to activate/deactivate the childproof lock.

Individual settings

Signal

1. Activate setting mode for signal volume

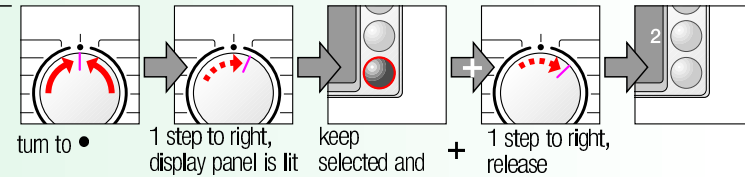

2. Set volume for ...

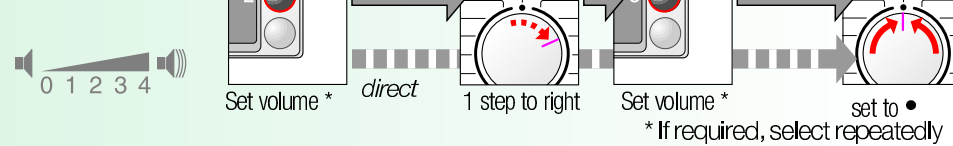

Important information





Protecting the washing and the machine

- Empty pockets.
- Remove metal parts (paper clips, etc.).
- Wash delicates in the net/bag (tights, curtains, underwired bras).
- Close zips, button up covers.
- Brush sand out of pockets and collars.
- Remove curtain fittings or include in the net/bag.



Washing with different degrees of soiling

		Wash new items separately.
Light		Do not prewash. If required, pretreat stains. Select Wash Plus additional function.
Heavy		Load less washing. Prewash. If required, select additional option Wash Plus .



Soaking

Load washing of the same colour.

Pour soaking agent/detergent into dispenser II according to the manufacturer's instructions. Set programme selector to **Cottons 30 °C** and select **Start**. After approx. 10 minutes select **Start**. After the required soaking time reselect **Start** if the programme is to be continued or change the programme.



Starching

Washing should not be treated with fabric softener.

Liquid starch can be used in all wash programmes. Pour starch into the fabric softener dispenser according to manufacturer's specifications (if required clean beforehand).



Dyeing/Bleaching

Dye in household quantities only. Salt may attack stainless steel! Observe specifications of the dye manufacturer! Do **not** bleach washing in the washing machine.

Overview of programmes → Observe table of consumption values on Page 8 and instructions on Page 6!

Additional functions; information



Type of washing

°C

max.

Programmes	°C	max.	Type of washing	Additional functions; information
Cottons	*-90 °C		Hard-wearing textiles, heat-resistant textiles made of cotton or linen	Wash Plus, Prewash, Reduced Ironing, Aqua Plus
Cottons Stains	*-60 °C			
Cottons Eco	*-60 °C	7 kg *		Wash Plus, Prewash, Reduced Ironing, Aqua Plus; for especially sensitive skin, extended wash cycle at selected temperature, higher water level, additional rinse cycle
Sensitive	*-60 °C		Hardwearing textiles made of cotton or linen	Wash Plus, Prewash, Reduced Ironing, Aqua Plus; short programme for normally soiled washing.
PowerWash	*-60 °C	4 kg	Hardwearing textiles made of cotton or blended fabrics	Wash Plus, Prewash, Reduced Ironing, Aqua Plus
Easy-Care	*-60 °C		Easy-care textiles made of cotton, linen, synthetic fibres or blended fabrics	Wash Plus, Prewash, Reduced Ironing, Aqua Plus; different types of washing can be washed together
Mixed Load	*-40 °C	3 kg *	Textiles made of cotton and easy-care textiles	Wash Plus, Prewash, Reduced Ironing, Aqua Plus
Dark Wash	*-40 °C		Dark textiles made of cotton and dark easy-care textiles	Wash Plus, Prewash, Reduced Ironing, Aqua Plus; reduced rinse and final spin cycle
Silk	*-30 °C		For delicate, washable textiles, e.g. made of silk, satin, synthetic fibres or blended fabrics (e.g. curtains)	Wash Plus, Prewash, Reduced Ironing, Aqua Plus; no spin cycle between the rinse cycles
Wool	*-40 °C	2 kg	Hand or machine-washable wool or rich-wool textiles	especially gentle wash programme to prevent shrinkage, longer programme pauses (textiles rest in wash liquor)
SuperQuick	*-40 °C		Easy-care textiles made of cotton, linen, synthetic fibres or blended fabrics	short programme approx. 15 minutes suitable for washing lightly soiled items
Sports wear	*-40 °C		Textiles made of microfibres	Wash Plus, Prewash, Reduced Ironing, Aqua Plus

Additional programmes

Rinse, Spin, Drain

i The programmes are time-controlled for lightly soiled textiles. If textiles are heavily soiled select additional functions Wash Plus.

* When washing at maximum load, in the appropriate programme always select Wash Plus additional function.

Irrespective of type of washing, Easy-Care 40 °C at max. spin speed is optimally suitable as Short programme.

Programmes without prewash – pour detergent into dispenser II, programmes with prewash – divide detergent between dispensers I and II.

Robert Bosch Hausgeräte GmbH
Carl-Wery-Str. 34
81739 München/Germany

9000 422 500

WAE24468GB ...

0110

Safety instructions

- Read and follow the operating and installation instructions and all other information enclosed with the washing machine.
- Retain documents for subsequent use.

Risk of electric shock

- Never pull out the mains plug by tugging the power cord!
- Never insert/pull out the mains plug with damp hands.

Danger to life

On redundant appliances:

- Pull out the mains plug!
- Sever the power cord and discard together with the plug.
- Destroy the lock on the washing machine door. This will prevent children from locking themselves in and suffocating.

Risk of suffocation

- Keep packaging, plastic film and packaging parts out of the reach of children.

Risk of poisoning

Risk of explosion

- Keep detergents and care products out of the reach of children.
- Caused by detergents containing solvents, e.g. stain remover/items of washing pretreated with solvent naphtha may result in an explosion after being loaded into the washing machine. Before hand thoroughly rinse items of washing by hand.

Risk of injury

- Washing machine door may become very hot.
- Caution when draining hot detergent solution.
- Do not climb on the washing machine.
- Do not lean on the open washing machine door.
- Do not reach into the drum in case it is still rotating.
- Caution when opening the detergent drawer while the appliance is running!

Consumption values

Programme	Additional function	Load	Current**	Water**	Programme duration**
Cottons 40 °C *	Wash Plus	7 kg	0.65 kWh	60 l	2:30 h
Cottons Eco 60 °C *	Wash Plus	7 kg	1.05 kWh	47 l	2:58 h
Cottons 90 °C	Wash Plus	7 kg	2.00 kWh	75 l	2:33 h
Easy-Care 40 °C *	Wash Plus	3 kg	0.55 kWh	50 l	1:24 h
Easy-Care 40 °C * (also suitable as Short programme)	–	3 kg	0.54 kWh	40 l	0:55 h
Mixed Load 30 °C	–	3 kg	0.32 kWh	35 l	0:44 h
Silk 30 °C	–	2 kg	0.25 kWh	38 l	0:32 h
Wool 30 °C *	–	2 kg	0.15 kWh	34 l	0:40 h

* Programme setting for test according to currently valid European standard 60456. Information about comparability tests: The test programmes test at: maximum load, Wash Plus additional function, maximum spin speed. Select the Easy-Care 40 °C programme without Wash Plus additional function and at maximum spin speed as Short programme for coloureds wash.

** The values deviate from the indicated values depending on water pressure, water hardness, water inlet temperature, room temperature, type and amount of washing and degree of soiling, utilised detergent, fluctuations in the mains voltage and selected additional functions.

Care



- Risk of electric shock!
Pull out the mains plug!
- Risk of explosion! No solvents!

i Before using your washing machine for the first time

Do not put any washing in the washing machine! Turn on the tap, fill the appliance with approx. 1 litre of water and then pour ½ measuring cup of detergent into dispenser II. Set programme selector to **Easy-Care 60 °C** and select **Start**. At the end of the programme set the programme selector to **Off**.

i Machine housing, control panel

- Wipe with a soft, damp cloth.
- Do not use abrasive cloths, sponges or detergents (stainless steel cleaner).
- Immediately remove washing and cleaning agent residue.
- Do not clean the appliance with a water jet.



Clean the detergent drawer ...

... if it contains detergent or fabric softener residue.

1. Pull out, depress insert, take out drawer all the way. Take out insert: using your finger, press insert upwards.
2. Clean detergent dispenser and insert with water and a brush and dry.
3. Attach insert and lock into position (push cylinder onto guide pin).
4. Insert detergent drawer.

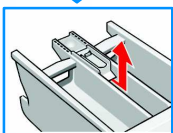
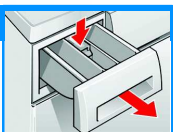

i Leave detergent drawer open so that residual water can evaporate.

i Drum

Leave washing machine door open so that the drum can dry out. Rust stains – use chlorine-free cleaning agent, not steel wool.

i Descaling No washing in the machine!

Descale according to the instructions of the descaling agent-manufacturer, not required for correct detergent dosage.



Emergency release, e.g. if power failure occurs

The programme continues running when the power is restored. If the washing is still to be removed, the door can be opened as described below:

Risk of scalding!

Wash liquor and washing may be hot. If required, leave to cool down. Do not reach into the drum in case it is still rotating. Do not open the door if you can still see water through the glass.

1. Select programme selector to **Off**, pull out the mains plug.
2. Drain detergent solution -> Page 10.
3. Pull down emergency release with a tool and release. Door can then be opened.

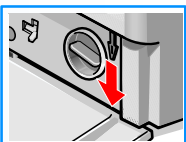

Information on display panel

depending on model

F:16	Close the washing machine door properly; washing may be caught.
F:17	Turn on the tap all the way, supply hose kinked/jammed; clean filter -> Page 10, water pressure too low.
F:18	Filter blocked; clean detergent solution pump -> Page 10. Outlet pipe/drainage hose blocked; clean detergent solution pump -> Page 10.
F:21	Motor fault. Call customer service!
F:23	Water in the base pan, appliance leaking. Call customer service!

Maintenance



- Risk of scalding!
Allow detergent solution to cool down!
- Turn off the tap!

Detergent solution pump

Set programme selector to **Off**, pull out the mains plug.

1. Open and remove service flap.

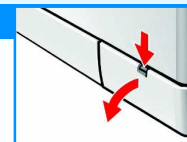

2. For models with drainage hose: Take drainage hose out of the holder and pull out of the housing. Place a container on the floor. Remove sealing cap, allow detergent solution to flow out. Press on sealing cap and insert drainage hose into the holder.



- 2* For models without drainage hose: Carefully unscrew pump cover until the detergent solution begins to run out. When the service flap is half full, screw back the pump cover and empty the service flap. Repeat steps until all the detergent solution has run out.



3. Carefully unscrew the pump cover (residual water).

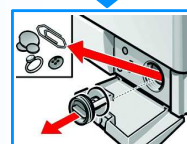

4. Clean the interior, pump cover thread and pump housing (fan impeller in the detergent solution pump must rotate).

5. Reinsert and screw on pump cover.
6. Insert and close service flap.

i To prevent unused detergent from flowing into the outlet during the next wash: Pour 1 litre of water into dispenser II and start the **Drain** programme.

Drainage hose on the siphon

Set programme selector to **Off**, pull out the mains plug.

1. Loosen hose clip, carefully remove drainage hose (residual water).
2. Clean drainage hose and siphon spigot.
3. Re-attach drainage hose and secure connection point with hose clip.

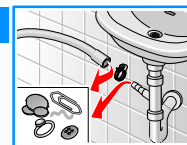

Filters in the water supply

! Risk of electric shock! Do not immerse Aqua-Stop safety device in water (contains electric valve).

Release water pressure in the supply hose:

1. Turn off the tap!
2. Select any programme (except **Spin**/ **Drain**).
3. Select **Start**. Leave programme for approx. 40 seconds.
4. Set programme selector to **Off**. Pull out the mains plug!



Clean the filter: According to model:

1. Remove hose from tap. Clean filter with small brush.



- and/or** for standard and Aqua-Secure models:
Remove hose from the rear of the appliance. Take out filter with pliers and clean.
2. Connect the hose and check for leaks.

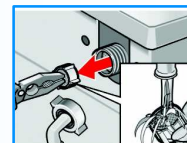

What to do if ...

- Water is running out.

 - Correctly attach/replace drainage hose.
 - Tighten screw-fitting on the supply hose.
- Water not flowing in.
Detergent not washed in.

 - **Start** not selected?
 - Tap not open?
 - Filter blocked? Clean filter → Page 10.
 - Supply hose kinked or jammed?
- Washing machine door cannot be opened.

 - Safety function active. Stop programme? → Page 4.
 - (without final spin) selected? → Page 4.
 - Can be opened via emergency release only? → Page 9.
- Programme does not start.

 - **Start** or **Ready in-time** selected?
 - Door closed?
 - Childproof lock active? Deactivate → Page 5.
- Detergent solution is not drained.

 - Clean detergent solution pump → Page 10.
 - Clean outlet pipe and/or drainage hose.
- Water not visible in the drum.

 - Not a fault – water below the visible area.
- Spin result not satisfactory.

 - Distribute small and large items of washing in the drum.
 - **Reduced Ironing** selected → Page 5.
 - Too low speed selected → Page 5.
- Spin cycle actuated several times.

 - Not a fault – unbalanced load detection system adjusts imbalance.
- Residual water in the dispenser for care product.

 - Not a fault – effect of the care product not impaired.
 - If required, clean insert → Page 9.
- Odour formation in the washing machine.

 - Run **Cottons 90 °C** programme without washing. Use standard detergent.
- Status display flashes.
Overdosage of detergent detected.

 - Too much detergent used?
If detergent comes out of the detergent drawer: mix 1 tablespoon of fabric softener with ½ litre of water and pour into dispenser II (not for outdoor textiles!).
 - Reduce detergent dosage for the next wash cycle.
- Loud noise formation, vibrations and "Wandering" during spin cycle.

 - Appliance feet fixed?
Secure appliance feet → Installation instructions.
 - Transportation safety devices removed?
Remove transportation safety devices → Installation instructions.
- Display panel/indicator lights do not function while the appliance is running.

 - Power failure?
 - Fuse tripped? Switch on/replace fuse.
 - If the fault occurs repeatedly, call customer service.
- Programme progress longer than usual.

 - Not a fault – unbalanced load detection system adjusts imbalance by repeatedly distributing the washing.
 - Not a fault – foam detection system active – a rinse cycle is switched on.
- Detergent residue on the washing.

 - Occasionally phosphate-free detergents contain water insoluble residue.
 - Select **Rinse** or brush the laundry after washing.
- If a fault cannot be rectified or a repair is required:

 - Set programme selector to **Off** and pull out the mains plug.
 - Turn off the tap and call customer service → Installation instructions.



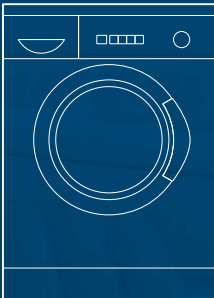

Washing machine

en

Operating instructions



Follow the safety instructions on Page 8!



Do not switch on the washing machine until you have read these instructions and the separate installation instructions!