

# Your washing machine

**Congratulations** – You have opted for a modern, high-quality domestic appliance manufactured by Bosch. The washing machine is distinguished by its economical energy consumption.

Each appliance which leaves our factory is inspected thoroughly to ensure that it functions properly and is in perfect condition.

For further information and a selection of our products go to our web site:  
http://www.bosch-hausgeraete.de or contact our customer service centres

## Environmental disposal

Dispose of packaging in an environmentally friendly manner.

This appliance has been identified in accordance with the European Directive 2002/96/EG on Waste Electrical and Electronic Equipment (WEEE).

The Directive specifies the framework for an EU-wide valid return and recycling of waste appliances.

# Contents

■ Intended use	1
■ Programmes	1
■ Setting programme	3
■ Washing	3/4
■ After washing	4
■ Individual settings	5
■ Important information	6
■ Overview of programmes	7
■ Safety instructions	8
■ Consumption values	8
■ Care	9
■ Information on the display panel	9
■ Maintenance	10
■ What to do if ...	11

## Intended use

- for use in the household only,
- for the washing of machine-washable textiles in a detergent solution,
- to be operated with cold drinking water and commercially available detergents and care products which are suitable for use in washing machines.

- ⚠ Do not leave children unattended near the washing machine!
- Keep pets away from the washing machine!

## Programmes

For detailed overview of programmes → page 7.

Temperature and spin speed can be selected individually.

👕 Cottons	.....	} hard-wearing textiles
👕 Cottons-Stains Plus	.....	
👕 Cottons-Stains	.....	} easy-care textiles
👕 Sensitive	.....	
👕 Easy-Care	.....	easy-care textiles
👕 Silk	.....	delicate washable textiles
👕 Wool	.....	hand/machine-washable textiles
👕 Drain	.....	the rinsing water if ☹ occurs
👕 Spin	.....	washing washed by hand
👕 Gentle Spin	.....	washing washed by hand at reduced spin speed
🌟 Rinse/Freshen Up	.....	with subsequent spin cycle; for hand-washed items, starching or "freshen up" items, → page 6.
👕 Sports Wash	.....	textiles made of microfibres
👕 Super Quick	.....	short programme
👕 Mixed Load	.....	different types of washing
👕 Dark Wash	.....	dark textiles

## Preparation

⚠ Correct installation according to separate installation instructions.

### Checking the machine

- Never switch on a damaged machine!
- Inform your customer service!

### Turn on the tap

### Insert mains plug

- ⚠ With dry hands only! Take hold of the plug only!

### Sorting and inserting the washing

Follow manufacturer's care information! According to the information on the care labels. According to type, colour, soiling and temperature. Do not exceed maximum load → page 7.

Follow important instructions! → page 6!

Insert large and small items of washing! Close the washing machine door. Take care not to trap any items of clothing between the loading door and rubber seal.

### Add detergent and care product

Meter accordingly: Washing amount, soiling, water hardness (ask your water supply company) and manufacturer's instructions. Pour liquid detergent into the appropriate dispenser and place in the drum.

- Dispenser I: Detergent for prewash
- Dispenser II: Fabric softener, starch
- Dispenser III: Detergent for main wash, fabric softener, bleaching agent, stain remover

ⓘ Dilute viscous fabric softener and fabric conditioner with water. Prevents blockage. Do not use detergent for programme option **Rinse/Freshen Up**!

## Set and adjust programme

For additional functions and option buttons see individual settings, → page 5.

ⓘ All buttons are sensitive, they only need to be touched gently! If the Option buttons are touched for longer, the setting options will automatically run!

ⓘ Programme selector for switching the machine on and off and for selecting the programme. Can be rotated in either direction.

### Select Start

Additional functions

Wash Plus  
Pre-wash  
Reduced Ironing  
Aqua Plus

Display panel/Option buttons

Temp. °C  
Ready in  
rpm

Start/Pause

Start

Programme selector

Sensitive  
Sports Wash  
Super Quick  
Mixed Load  
Drain  
Gentle Spin  
Spin  
Off  
Cottons  
Cottons-Stains Plus  
Cottons-Stains  
Silk  
Wool  
Easy-Care  
Dark Wash

🌟 – 90	Temp. °C ↓	Select the temperature (🌟 = cold)
1 – 24h	Ready in ⌚	Programme ends in ...
☹ – 1400*	rpm ⌚	Select the spin speed (* depending on model) or ☹ (Rinse hold = without final spin)
Status displays		Programme progress displays: Washing, Rinse, Spin, End
👕	👕	👕 – 0–

Before washing for the first time, wash once without any washing. → page 6

# Wash

1

2

# Wash

3

## Removing washing

Open washing machine door and remove washing. If ☹ (Rinse hold = without final spin) active: Set programme selector to **Drain** ☹ or select spin speed. Select **Start** ⏮. Remove any foreign objects – risk of rusting.

## Turn off the tap

Not required for Aqua-Stop models.

## Switch off

Set programme selector to **Off**.

## End of programme when ...

... **Start** ⏮ flashes and -0- is indicated on the display panel.

## Change programme ...

If you have mistakenly selected a wrong programme:  
– Reselect programme.  
– Select **Start** ⏮.

## ... or terminate

Programmes with high temperature, first:  
– Cool washing: Select **Rinse/Freshen Up** 🌟.  
– Washing machine door remains locked.  
– Select **Off**.  
– Select **Spin** ⌚ or **Drain** ☹.  
– Select **Start** ⏮.

## Individual settings

### Option buttons

You can change the spin speed and temperature beforehand and while the selected programme is running. Effects dependent on the programme progress.

#### Temp. °C ↓

You can change the indicated washing temperature. The maximum washing temperature which can be selected depends on the set programme.

#### Ready in ⌚

The respective programme duration is displayed by selecting the programme. The programme start can be delayed before the programme begins. The **Ready in** ⌚-time can be set in hour-steps up to maximum 24h. Keep pressing the **Ready in** ⌚ button until the required number of hours is indicated (h=hour). Select **Start** ⏮.

#### rpm ⌚

You can change the indicated spin speed. The maximum spin speed which can be selected depends on the set programme.

### Additional functions see also programme overview

Wash Plus 🧺	Extension of the washing time for a more intensive washing of highly soiled washing or 7 kg of cottons and coloureds.
Prewash ☹	For heavily soiled, hard-wearing washing, e.g. made of cotton or linen. Prewash at 30 °C.
Reduced Ironing 🧺	Special spin sequence with subsequent fluffing. Gentle final spin – residual moisture in the washing increased slightly.
Aqua Plus 🌊	Increased water level and additional rinse cycle, extended washing time. For areas with very soft water or for further improvement of the rinsing result.

### Start ⏮

For starting or interrupting the programme.

### Signal

1. Activate setting mode for signal volume

Set to •

1 step to right, the indicator light is on

keep selected and

+ 1 step to right; release

2. Set volume for ...

Set volume \*

1 step to right

Set volume \*

Set to •

\* If required, select repeatedly

## Important information

### Protecting the washing and the machine

- Empty pockets.
- Remove metal parts (paper clips, etc.).
- Wash delicates in the net/bag (tights, curtains, underwired bras).
- Close zips, button up covers.
- Brush sand out of pockets and collars.
- Remove curtain fittings or include in the net/bag.

### Before washing for the first time

Do not put any washing in the washing machine! Turn on the tap, fill the appliance with approx. 1 litre of water and then pour ½ measuring cup of detergent into dispenser II. Set programme selector to **Easy-Care 60 °C** and select **Start** ⏮. At the end of the programme set the programme selector to **Off**.

### Washing with different degrees of soiling

Light	Wash new items separately. Do not prewash.
Medium	If required, pretreat stains. Select <b>Wash Plus</b> 🧺 additional function.
Heavy	Load less washing. Prewash.

### Soaking Load washing of the same colour

Pour soaking agent/detergent into dispenser II according to the manufacturer's instructions. Set programme selector to **Cottons 30 °C** and select **Start** ⏮. After approx. 10 minutes select **Start** ⏮. After the required soaking time reselect **Start** ⏮ if the programme is to be continued or change the programme.

### Starching Washing should not be treated with fabric softener

Liquid starch can be used in all wash programmes. Meter starch into the fabric softener dispenser 🧺 according to manufacturer's specifications.

### Dyeing/Bleaching

Dye in small quantities only. Salt can corrode stainless steel. Observe the dye manufacturer's specifications. Do **not** bleach laundry in the washing machine.

### Freshen up Use programme Rinse/Freshen Up 🌟

For items, that have been tucked away or stored for a period of time, to remove creases caused by folding and storage and to eliminate odours. Use fabric conditioner for "fresh" smell.

### Protection of the environment/conservation tips

- Utilise the maximum amount of washing for the particular programme.
- Wash normally soiled washing without prewash.
- Instead of **Cottons 90 °C** select **Cottons-Stains 60 °C** programme. Comparable cleaning result with significantly lower energy consumption.
- Meter detergent according to the manufacturer's instructions and water hardness.
- If the washing is then dried in the tumble dryer, select spin speed according to the instructions of the dryer manufacturer.

1

2

4

5

6



Programmes		°C	max.	Type of washing	Additional functions; information	
	Cottons	40-90 °C		Hard-wearing textiles, heat-resistant textiles made of cotton or linen	Wash Plus  , Prewash  , Reduced Ironing  Aqua Plus	
	Cottons-Stains Plus	40-60 °C			Wash Plus  , Prewash  , Reduced Ironing  Aqua Plus  ; for particularly sensitive skin, prolonged washing at selected temperature, higher water level, additional rinse cycle	
	Cottons-Stains	40-60 °C	7 kg*		Wash Plus  , Prewash  , Reduced Ironing  Aqua Plus	
	Sensitive	40-60 °C			Wash Plus  , Prewash  , Reduced Ironing  Aqua Plus	
	Easy-Care	40 °C		Easy-care textiles made of cotton, linen, synthetic fibres or blended fabrics	Wash Plus  , Prewash  , Reduced Ironing  Aqua Plus	
	Mixed Load	40 °C	3 kg*		Wash Plus  , Prewash  , Reduced Ironing  Aqua Plus  ; Different types of washing can be washed together	
	Dark Wash	40 °C			Wash Plus  , Prewash  , Reduced Ironing  Aqua Plus  ; reduced rinse and final spin cycle	
	Silk	30 °C			Wash Plus  , Prewash  , Reduced Ironing  Aqua Plus  ; For delicate, washable textiles, e.g. made of silk, satin, synthetic fibres or blended fabrics (e.g. curtains)	
	Wool	40 °C	2 kg	Hand or machine-washable wool or rich-wool textiles	Wash Plus  , Prewash  , Reduced Ironing  Aqua Plus  ; Especially gentle wash programme to prevent shrinkage, prolonged programme pauses (textiles rest in the detergent solution).	
	Sports Wash	40 °C			Wash Plus  , Prewash  , Reduced Ironing  Aqua Plus	
	Super Quick	40 °C			Short programme approx. 15 minutes suitable for lightly soiled laundry	
	Additional programmes				Rinse/Freshen Up  , Spin  , Drain  , Gentle Spin	

The programmes are time-controlled for lightly soiled textiles. If textiles are heavily soiled, select additional function **Wash Plus** additional function. When washing the maximum load for programmes marked with \*, always select the **Wash Plus** additional function. Regardless of the type of washing, **Easy-Care 40 °C** with maximum spin speed is the best short programme for the job. Programmes without prewash – pour detergent into dispenser II, programmes with prewash – divide detergent between dispensers I and II.

Robert Bosch Hausgeräte GmbH  
Carl-Wery-Str. 34  
81739 München / Germany

WAE2846SUK  
WAE28467UK

9000 198 728  
0208

### Safety instructions

- Read and follow the operating and installation instructions and all other information enclosed with the washing machine.
- Retain documents for subsequent use.

**Risk of electric shock**

- Never pull out the mains plug by tugging the power cord!
- Never insert/pull out the mains plug with damp hands.

**Risk of injury**

- Washing machine door may become very hot.
- Caution when draining hot detergent solution.
- Do not climb on the washing machine.
- Do not lean on the open washing machine door.
- Do not touch the drum in case it is still spinning.
- Caution when opening the detergent drawer while washing machine is running!
- Keep detergents and care products out of the reach of children.
- Keep packaging, plastic film and packaging parts out of the reach of children.

**Risk of poisoning**

**Risk of suffocation**

**Danger to life**

**Risk of explosion**

On redundant appliances:

- Pull out the mains plug.
- Sever the power cord and discard together with the plug.
- Destroy the lock on the washing machine door. This will prevent children from locking themselves in and suffocating.
- Caused by detergents containing solvents, e.g. stain remover/items of washing pretreated with solvent naphtha may result in an explosion after being loaded into the washing machine. Beforehand thoroughly rinse items of washing by hand.

Programme	Additional function	Load	Current **	Water **	Programme duration **
Cottons 40 °C*	Wash Plus	7 kg	0.65 kWh	60 l	2:30 h
Cottons-Stains 60 °C*	Wash Plus	7 kg	1.19 kWh	49 l	2:36 h
Cottons 90 °C	Wash Plus	7 kg	2.00 kWh	75 l	2:33 h
Easy-Care 40 °C*	Wash Plus	3 kg	0.55 kWh	50 l	1:24 h
Easy-Care 40 °C* (also suitable as short programme)	–	3 kg	0.54 kWh	40 l	0:55 h
Mixed Load 30 °C	–	3 kg	0.32 kWh	35 l	0:44 h
Silk 30 °C	–	2 kg	0.25 kWh	38 l	0:32 h
Wool 30 °C*	–	2 kg	0.15 kWh	34 l	0:40 h

\* Programme setting to be tested in accordance with European standard 60 456.

Note on comparative tests: test the test programme with maximum load, **Wash Plus** additional function selected, maximum spin speed.

A **short programme** which can be used for coloured items is **Easy-Care 40 °C**, without the **Wash Plus** additional function selected and set to maximum spin speed.

\*\* The values deviate from the indicated values depending on water pressure, water hardness, water inlet temperature, room temperature, type and amount of washing and degree of soiling, utilised detergent, fluctuations in the mains voltage and selected additional functions.

### Care

- Risk of electric shock! Pull out the mains plug!
- Risk of explosion! No solvents!

**Machine housing, control panel**

- Wipe with a soft, damp cloth.
- Do not use any abrasive cloths, sponges or cleaning agents (stainless-steel cleaner).
- Immediately remove washing and cleaning agent residue.
- Do not clean the appliance with a water jet.

**Clean the detergent drawer ...**

... if it contains detergent or fabric softener residue.

1. Pull out, depress insert, completely remove.
2. Open the cover.
3. Clean with water and dry.
4. Close and lock the cover (place cylinder on guide pin).
5. Insert detergent drawer.

Leave detergent drawer open so that residual water can evaporate.

**Drum**

Leave washing machine door open so that the drum can dry out.

Rust stains – use chlorine-free cleaning agent, not steel wool.

**Descaling** No washing in the machine!

Descale according to the instructions of the descaling agent-manufacturer, not required for correct detergent dosage.

Information on the display panel		depending on model
F:16	Close the washing machine door properly; washing may be caught.	
F:17	Turn the tap on fully, supply hose kinked/jammed; clean filter -> page 10, water pressure too low.	
F:18	Detergent solution pump blocked; clean the detergent solution pump -> page 10. Drainage hose / waste pipe blocked; clean the drainage hose at the siphon -> page 10.	
F:21	Motor fault. Call customer service!	
F:23	Water in the base pan, appliance leaking. Call customer service!	

### Maintenance

- Risk of scalding! Allow detergent solution to cool down!
- Turn off the tap!

**Detergent-solution pump**

Set programme selector to **Off**, pull out the mains plug.

1. Open and remove service flap.

For models with drainage hose:

2. Take drainage hose out of the holder and pull out of the housing. Remove sealing cap, allow detergent solution to flow out. Press on sealing cap and insert drainage hose into the holder.

For models without drainage hose:

- 2\*. Carefully unscrew pump cover until the detergent solution begins to run out. When the service flap is half full, screw back the pump cover and empty the service flap. Repeat steps until all the detergent solution has run out.

3. Carefully unscrew the pump cover (residual water).
4. Clean the interior, pump cover thread and pump housing (fan impeller in the detergent-solution pump must rotate).
5. Reinsert and screw on pump cover.
6. Insert and close service flap.

To prevent unused detergent from flowing into the outlet during the next wash: Pour 1 litre of water into dispenser II and select the **Drain** programme.

**Drainage hose at the siphon**

Set programme selector to **Off**, pull out the mains plug.

1. Loosen the hose clamp, carefully remove the drainage hose (residual water).
2. Clean the drainage hose and siphon connecting piece.
3. Reattach the drainage hose and secure the connection with the hose clamp.

**Filters in the water supply**

**Risk of electric shock!** Do not immerse Aqua-Stop safety device in water (contains electric valve).

Release water pressure in the supply hose:

1. Turn off the tap!
2. Select any programme (except **Spin** / **Drain** ).
3. Press **Start** . Leave programme for approx. 40 seconds.
4. Set programme selector to **Off**.
5. Remove hose from tap.
6. Clean filter with small brush.
7. Depending on the model, remove hose from the rear of the appliance and clean the filter.
8. Connect the hose and check for leaks.

### What to do if ...

- Water is running out. – Correctly attach/replace drainage hose. – Tighten screw-fitting on the supply hose.
- Water not flowing in. Detergent not washed in. – **Start** not selected? – Tap not open? – Filter blocked? Clean filter -> page 10. – Supply hose kinked or jammed?
- Washing machine door cannot be opened. – Safety function active. Wait approx. 2 minutes. – (Rinse hold = without final spin) selected?
- Programme does not start. – **Start** selected? – Door closed?
- Detergent solution is not drained. – Clean detergent-solution pump -> page 10.
- Washing not spun correctly. – Clean outlet pipe and/or drainage hose. – Distribute small and large items of washing in the drum.
- Spin cycle actuated several times. – Not a fault – unbalanced load detection system adjusts imbalance.
- Water not visible in the drum. – Not a fault – water below the visible area.
- Residual water in the dispenser for care product. – Not a fault – effect of the care product not impaired.
- Odour formation in the washing machine. – Run **Cottons 90 °C** programme without washing. Use standard detergent.
- Foam is coming out of the detergent drawer. – Too much detergent used? Mix 1 tablespoon of fabric softener with ½ litre of water and pour into compartment II (*not with outdoor fabrics!*). – Reduce detergent dosage for the next wash cycle.
- Vibrations during spin cycle. – Appliance feet fixed? Secure appliance feet -> *Installation instructions*. – Transportation safety devices removed? Remove transportation safety devices -> *Installation instructions*.
- Spin result not satisfactory. – **Reduced Ironing** selected? -> page 5.
- Display panel/indicator lights do not function while the appliance is running. – Power failure? – Fuse tripped? Switch on/replace fuse. – If the fault occurs repeatedly, call customer service.
- Programme progress longer than usual. – Not a fault – unbalanced load detection system adjusts imbalance by repeatedly distributing the washing. – Not a fault – Foam detection system active - a rinse cycle is started.
- Detergent residue on the washing. – Occasionally phosphate-free detergents contain water-insoluble residue. – Select **Rinse/Freshen Up** or brush the laundry after washing.
- If a fault cannot be rectified or a repair is required: – Set programme selector to **Off** and pull out the mains plug. – Turn off the tap and call customer service -> *Installation instructions*.

## Washing machine

en

## Operating instructions

Read these instructions before switching on the washing machine! Also follow the separate Installation instructions. Follow the safety instructions on page 8!



# Your washing machine

**Congratulations** – You have opted for a modern, high-quality domestic appliance manufactured by Bosch. The washing machine is distinguished by its economical energy consumption.

Each appliance which leaves our factory is inspected thoroughly to ensure that it functions properly and is in perfect condition.

For further information and a selection of our products go to our web site:

<http://www.bosch-hausgeraete.de> or contact our customer service centres

## Environmental disposal

Dispose of packaging in an environmentally friendly manner.

This appliance has been identified in accordance with the European Directive 2002/96/EG on Waste Electrical and Electronic Equipment (WEEE).

The Directive specifies the framework for an EU-wide valid return and recycling of waste appliances.



## Contents

Page

Intended use	1
Programmes	1
Setting programme	3
Washing	3/4
After washing	4
Individual settings	5
Important information	6
Overview of programmes	7
Safety instructions	8
Consumption values	8
Care	9
Information on the display panel	9
Maintenance	10
What to do if ...	11

## Intended use

- for use in the household only,
- for the washing of machine-washable textiles in a detergent solution,
- to be operated with cold drinking water and commercially available detergents and care products which are suitable for use in washing machines.

- Do not leave children unattended near the washing machine!
- Keep pets away from the washing machine!

## Preparation

 Correct installation according to separate installation instructions.

 **Checking the machine**  
– Never switch on a damaged machine!  
– Inform your customer service!

 **Turn on the tap**

 **Insert mains plug**  
 With dry hands only!  
Take hold of the plug only!













 Dilute viscous fabric softener.  
Do not use detergent.

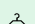

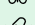
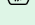
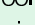
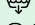
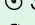
## Programmes

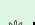
For detailed overview of programmes -> page 7.

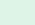
Temperature and spin speed can be selected individually.

 Cottons	.....	} hard-wearing textiles
 Cottons-Stains Plus	.....	
 Cottons-Stains	...	
 Sensitive	.....	
 Easy-Care	.....	easy-care textiles
 Silk	.....	delicate washable textiles
 Wool	.....	hand/machine-washable textiles
 Drain	.....	the rinsing water if  occurs
 Spin	.....	washing washed by hand
 Gentle Spin	.....	washing washed by hand at reduced spin speed
 Rinse/Freshen Up	..	with subsequent spin cycle; for hand-washed items, starching or "freshen up" items, -> page 6.
 Sports Wash	.....	textiles made of microfibres
 Super Quick	.....	short programme
 Mixed Load	....	different types of washing
 Dark Wash	.....	dark textiles

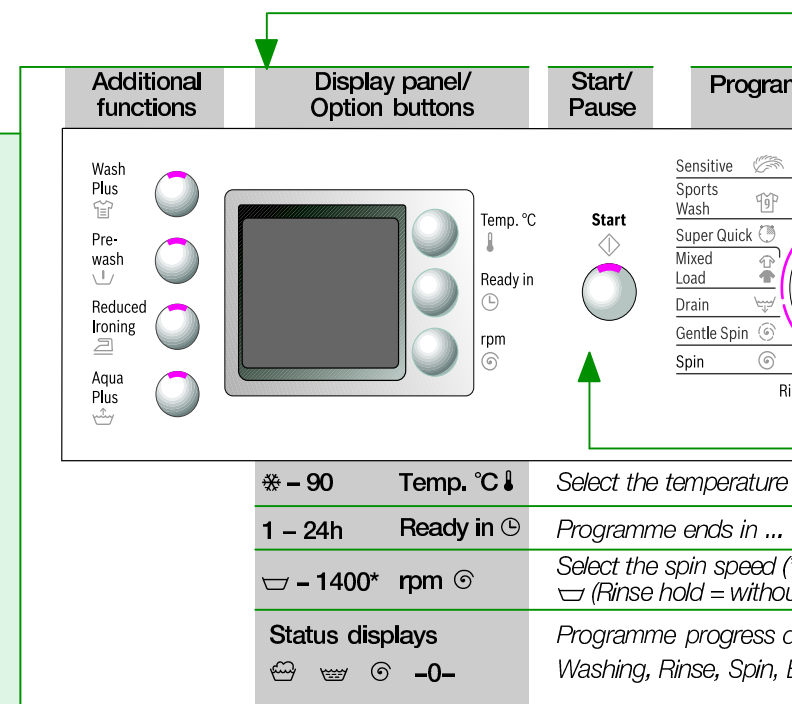

*Before washing for the first time,  
wash once without any washing. -> page 6*

## Sorting and inserting the washing

Follow manufacturer's care information!  
According to the information on the care labels.  
According to type, colour, soiling and temperature.  
Do not exceed maximum load -> page 7.

*Follow important instructions! -> page 6!*

Insert large and small items of washing! Close the washing machine door. Take care not to trap any items of clothing between the loading door and rubber seal.

## Add detergent and care product

Meter accordingly:  
Washing amount, soiling, water hardness (ask your water supply company) and manufacturer's instructions. Pour liquid detergent into the appropriate dispenser and place in the drum.

**Dispenser I:** Detergent for prewash  
**Dispenser II:** Fabric softener, starch  
**Dispenser III:** Detergent for main wash, fabric softener, bleaching agent, stain remover  
Fabric softener and fabric conditioner with water. Prevents blockage.  
Detergent for programme option **Rinse/Freshen Up!**

## Set and adjust programme

For additional functions and option buttons see individual settings, -> page 5.

**i** All buttons are sensitive, they only need to be touched gently!  
If the Option buttons are touched for longer, the setting options will automatically run!

**i** Programme selector for switching the machine on and off and for selecting the programme. Can be rotated in either direction.

**Select Start**

Programme selector

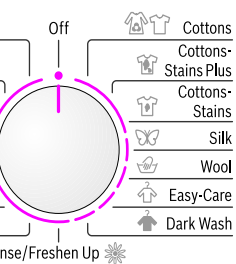

(\* = cold)

\* depending on model) or  
without final spin)

displays:

End

# Wash

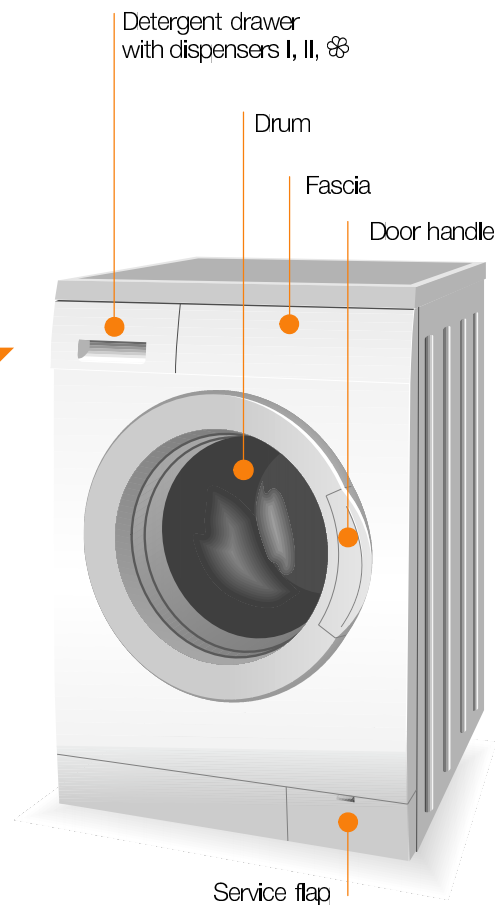

1

2



3

## Removing washing

Open washing machine door and remove washing.  
If (Rinse hold = without final spin) active: Set programme selector to **Drain** or select spin speed. Select **Start** .

## Turn off the tap

Not required for Aqua-Stop models.

## Switch off

Set programme selector to **Off**.

## End of programme when ...

... **Start** flashes and **-0-** is indicated on the display panel.

## Change programme ...

If you have mistakenly selected a wrong programme:  
- Reselect programme.  
- Select **Start** .

## ... or terminate

Programmes with high temperature, first:  
- Cool washing: Select **Rinse/Freshen Up** .  
Washing machine door remains locked.  
- Select **Off**.  
- Select **Spin** or **Drain** .

# Individual settings

## Option buttons

You can change the spin speed and temperature beforehand and while the selected programme is running. Effects dependent on the programme progress.

### Temp. °C

You can change the indicated washing temperature. The maximum washing temperature which can be selected depends on the set programme.

### Ready in

The respective programme duration is displayed by selecting the programme. The programme start can be delayed before the programme begins. The **Ready in** -time can be set in hour-steps up to maximum 24h. Keep pressing the **Ready in** button until the required number of hours is indicated (h=hour). Select **Start**.

### rpm

You can change the indicated spin speed. The maximum spin speed which can be selected depends on the set programme.

## Additional functions *see also programme overview*

Wash Plus	Extension of the washing time for a more intensive washing of highly soiled washing or 7 kg of cottons and coloureds.
Prewash	For heavily soiled, hard-wearing washing, e.g. made of cotton or linen. Prewash at 30 °C.
Reduced Ironing	Special spin sequence with subsequent fluffing. Gentle final spin – residual moisture in the washing increased slightly.
Aqua Plus	Increased water level and additional rinse cycle, extended washing time. For areas with very soft water or for further improvement of the rinsing result.

## Start

For starting or interrupting the programme.

## Signal

1. Activate setting mode for signal volume

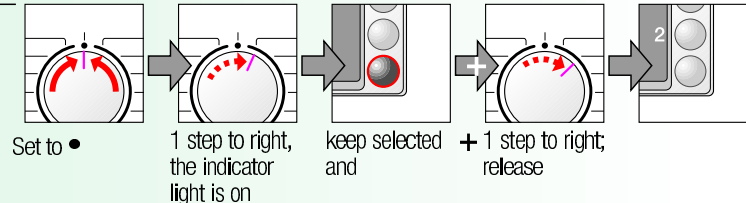

2. Set volume for ...

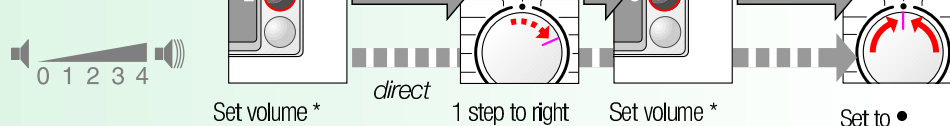

\* If required, select repeatedly

\* If required, select repeatedly



# Important information



## Protecting the washing and the machine

- Empty pockets.
- Remove metal parts (paper clips, etc.).
- Wash delicates in the net/bag (tights, curtains, underwired bras).
- Close zips, button up covers.
- Brush sand out of pockets and collars.
- Remove curtain fittings or include in the net/bag.



## Before washing for the first time

Do not put any washing in the washing machine! Turn on the tap, fill the appliance with approx. 1 litre of water and then pour ½ measuring cup of detergent into dispenser II. Set programme selector to **Easy-Care 60 °C** and select **Start**. At the end of the programme set the programme selector to **Off**.



## Washing with different degrees of soiling

Light	Wash new items separately.
	Do not prewash.
	If required, pretreat stains. Select <b>Wash Plus</b> additional function.
Heavy	Load less washing.
	Prewash.



## Soaking *Load washing of the same colour*

Pour soaking agent/detergent into dispenser II according to the manufacturer's instructions. Set programme selector to **Cottons 30 °C** and select **Start**. After approx. 10 minutes select **Start**. After the required soaking time reselect **Start** if the programme is to be continued or change the programme.



## Starching *Washing should not be treated with fabric softener*

Liquid starch can be used in all wash programmes. Meter starch into the fabric softener dispenser according to manufacturer's specifications.



## Dyeing/Bleaching

Dye in small quantities only. Salt can corrode stainless steel. Observe the dye manufacturer's specifications. Do **not** bleach laundry in the washing machine.



## Freshen up *Use programme Rinse/Freshen Up*

For items, that have been tucked away or stored for a period of time, to remove creases caused by folding and storage and to eliminate odours. Use fabric conditioner for "fresh" smell.



## Protection of the environment/conservation tips

- Utilise the maximum amount of washing for the particular programme.
- Wash normally soiled washing without prewash.
- Instead of **Cottons 90 °C** select **Cottons-Stains 60 °C** programme. Comparable cleaning result with significantly lower energy consumption.
- Meter detergent according to the manufacturer's instructions and water hardness.
- If the washing is then dried in the tumble dryer, select spin speed according to the instructions of the dryer manufacturer.

# Programme overview → Pay attention to the Consumption values table on page 8 and the information on page 6.

Programmes	°C	max.	Type of washing	Additional functions; information
Cottons	☼-90 °C			
Cottons-Stains Plus	☼-60 °C			
Cottons-Stains	☼-60 °C	7 kg*	Hard-wearing textiles, heat-resistant textiles made of cotton or linen	Wash Plus , Prewash , Reduced Ironing , Aqua Plus
Sensitive	☼-60 °C			Wash Plus , Prewash , Reduced Ironing , Aqua Plus , for particularly sensitive skin, prolonged washing at selected temperature, higher water level, additional rinse cycle
Easy-Care	☼-60 °C		Easy-care textiles made of cotton, linen, synthetic fibres or blended fabrics	Wash Plus , Prewash , Reduced Ironing , Aqua Plus
Mixed Load	☼-40 °C	3 kg*	Textiles made of cotton and easy-care textiles	Wash Plus , Prewash , Reduced Ironing , Aqua Plus , Different types of washing can be washed together
Dark Wash	☼-40 °C		Dark textiles made of cotton and dark easy-care textiles	Wash Plus , Prewash , Reduced Ironing , Aqua Plus , reduced rinse and final spin cycle
Silk	☼-30 °C		For delicate, washable textiles, e.g. made of silk, satin, synthetic fibres or blended fabrics (e.g. curtains)	Wash Plus , Prewash , Reduced Ironing , Aqua Plus , no spin cycle between the rinse cycles
Wool	☼-40 °C	2 kg	Hand or machine-washable wool or rich-wool textiles	Especially gentle wash programme to prevent shrinkage, prolonged programme pauses (textiles rest in the detergent solution).
Sports Wash	☼-40 °C		Textiles made of microfibres	Wash Plus , Prewash , Reduced Ironing , Aqua Plus
Super Quick	☼-40 °C		Easy-care textiles made of cotton, linen, synthetic fibres or blended fabrics	Short programme approx. 15 minutes suitable for lightly soiled laundry
Additional programmes				
Rinse/Freshen Up , Spin , Drain , Gentle Spin				

The programmes are time-controlled for lightly soiled textiles. If textiles are heavily soiled, select additional function **Wash Plus** . When washing the maximum load for programmes marked with \*, always select the **Wash Plus** additional function.

Regardless of the type of washing, **Easy-Care 40 °C** with maximum spin speed is the best short programme for the job.

Programmes without prewash – pour detergent into dispenser II, programmes with prewash – divide detergent between dispensers I and II.

Robert Bosch Hausgeräte GmbH  
Carl-Wery-Str. 34  
81739 München / Germany

WAE2846SUK  
WAE28467UK

9000 198 728  
0208



## Safety instructions

- Read and follow the operating and installation instructions and all other information enclosed with the washing machine.
- Retain documents for subsequent use.

### Risk of electric shock

- Never pull out the mains plug by tugging the power cord!
- Never insert/pull out the mains plug with damp hands.

### Risk of injury

- Washing machine door may become very hot.
- Caution when draining hot detergent solution.
- Do not climb on the washing machine.
- Do not lean on the open washing machine door.
- Do not touch the drum in case it is still spinning.
- Caution when opening the detergent drawer while washing machine is running!
- Keep detergents and care products out of the reach of children.
- Keep packaging, plastic film and packaging parts out of the reach of children.

### Risk of positioning Risk of suffocation

### Danger to life

On redundant appliances:

- Pull out the mains plug.
- Sever the power cord and discard together with the plug.
- Destroy the lock on the washing machine door. This will prevent children from locking themselves in and suffocating.
- Caused by detergents containing solvents, e.g. stain remover/items of washing pretreated with solvent naphtha may result in an explosion after being loaded into the washing machine. Beforehand thoroughly rinse items of washing by hand.

### Risk of explosion

## Consumption values

Programme	Additional function	Load	Current **	Water **	Programme duration **
Cottons 40 °C*	Wash Plus	7 kg	0.65 kWh	60 l	2:30 h
Cottons-Stains 60 °C*	Wash Plus	7 kg	1.19 kWh	49 l	2:36 h
Cottons 90 °C	Wash Plus	7 kg	2.00 kWh	75 l	2:33 h
Easy-Care 40 °C*	Wash Plus	3 kg	0.55 kWh	50 l	1:24 h
Easy-Care 40 °C* (also suitable as <b>short programme</b> )	–	3 kg	0.54 kWh	40 l	0:55 h
Mixed Load 30 °C	–	3 kg	0.32 kWh	35 l	0:44 h
Silk 30 °C	–	2 kg	0.25 kWh	38 l	0:32 h
Wool 30 °C*	–	2 kg	0.15 kWh	34 l	0:40 h

\* Programme setting to be tested in accordance with European standard 60 456.

Note on comparative tests: test the test programme with maximum load, **Wash Plus** additional function selected, maximum spin speed.

A **short programme** which can be used for coloured items is **Easy-Care 40 °C**, without the **Wash Plus** additional function selected and set to maximum spin speed.

\*\* The values deviate from the indicated values depending on water pressure, water hardness, water inlet temperature, room temperature, type and amount of washing and degree of soiling, utilised detergent, fluctuations in the mains voltage and selected additional functions.



# Care



- Risk of electric shock! Pull out the mains plug!
- Risk of explosion! No solvents!



## Machine housing, control panel

- Wipe with a soft, damp cloth.
- Do not use any abrasive cloths, sponges or cleaning agents (stainless-steel cleaner).
- Immediately remove washing and cleaning agent residue.
- Do not clean the appliance with a water jet.



## Clean the detergent drawer ...

... if it contains detergent or fabric softener residue.

1. Pull out, depress insert, completely remove.
2. Open the cover.
3. Clean with water and dry.
4. Close and lock the cover (place cylinder on guide pin).
5. Insert detergent drawer.

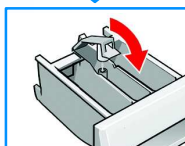
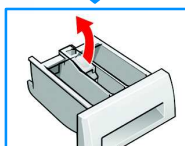
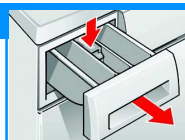

Leave detergent drawer open so that residual water can evaporate.



## Drum

Leave washing machine door open so that the drum can dry out.  
Rust stains – use chlorine-free cleaning agent, not steel wool.



## Descaling No washing in the machine!

Descale according to the instructions of the descaling agent-manufacturer, not required for correct detergent dosage.

# Information on the display panel depending on model

**F:16** Close the washing machine door properly; washing may be caught.

**F:17** Turn the tap on fully, supply hose kinked/jammed; clean filter -> page 10, water pressure too low.

**F:18** Detergent solution pump blocked; clean the detergent solution pump -> page 10. Drainage hose / waste pipe blocked; clean the drainage hose at the siphon -> page 10.

**F:21** Motor fault. Call customer service!

**F:23** Water in the base pan, appliance leaking. Call customer service!

# Maintenance



- Risk of scalding! Allow detergent solution to cool down!
- Turn off the tap!



## Detergent-solution pump

Set programme selector to **Off**, pull out the mains plug.

1. Open and remove service flap.
2. For models with drainage hose:  
Take drainage hose out of the holder and pull out of the housing. Remove sealing cap, allow detergent solution to flow out.  
Press on sealing cap and insert drainage hose into the holder.
- For models without drainage hose:
- 2\* Carefully unscrew pump cover until the detergent solution begins to run out. When the service flap is half full, screw back the pump cover and empty the service flap. Repeat steps until all the detergent solution has run out.
3. Carefully unscrew the pump cover (residual water).
4. Clean the interior, pump cover thread and pump housing (fan impeller in the detergent-solution pump must rotate).
5. Reinsert and screw on pump cover.
6. Insert and close service flap.

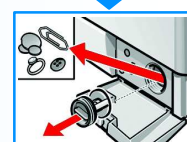
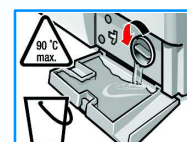
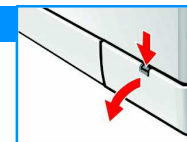

To prevent unused detergent from flowing into the outlet during the next wash: Pour 1 litre of water into dispenser II and select the **Drain** programme.



## Drainage hose at the siphon

Set programme selector to **Off**, pull out the mains plug.

1. Loosen the hose clamp, carefully remove the drainage hose (residual water).
2. Clean the drainage hose and siphon connecting piece.
3. Reattach the drainage hose and secure the connection with the hose clamp.

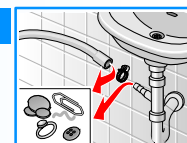

## Filters in the water supply



**Risk of electric shock!** Do not immerse Aqua-Stop safety device in water (contains electric valve).

Release water pressure in the supply hose:

1. Turn off the tap!
2. Select any programme (except **Spin** or **Drain**).
3. Press **Start**. Leave programme for approx. 40 seconds.
4. Set programme selector to **Off**.
5. Remove hose from tap.
6. Clean filter with small brush.
7. Depending on the model, remove hose from the rear of the appliance and clean the filter.
8. Connect the hose and check for leaks.

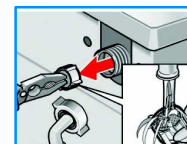



# What to do if ...

- Water is running out.

  - Correctly attach/replace drainage hose.
  - Tighten screw-fitting on the supply hose.
- Water not **flowing in**.  
Detergent not washed in.

  - **Start**  not selected?
  - Tap not open?
  - Filter blocked? Clean filter → *page 10*.
  - Supply hose kinked or jammed?
- Washing machine door cannot be opened.

  - Safety function active. Wait approx. 2 minutes.
  -  (Rinse hold = without final spin) selected?
- Programme does not start.

  - **Start**  selected?
  - Door closed?
- Detergent solution is not drained.

  - Clean detergent-solution pump → *page 10*.
  - Clean outlet pipe and/or drainage hose.
- Washing not spun correctly.

  - Distribute small and large items of washing in the drum.
- Spin cycle actuated several times.

  - Not a fault – unbalanced load detection system adjusts imbalance.
- Water not **visible** in the drum.

  - Not a fault – water below the **visible** area.
- Residual water in the dispenser for care product.

  - Not a fault – effect of the care product not impaired.
- Odour formation in the washing machine.

  - Run  **Cottons 90 °C** programme without washing. Use standard detergent.
- Foam is coming out of the detergent drawer.

  - Too much detergent used?
  - Mix 1 tablespoon of fabric softener with ½ litre of water and pour into compartment II (*not with outdoor fabrics!*).
  - Reduce detergent dosage for the next wash cycle.
- Vibrations during spin cycle.

  - Appliance feet **fixed**?  
Secure appliance feet → *Installation instructions*.
  - Transportation safety devices removed?  
Remove transportation safety devices → *Installation instructions*.
- Spin result not satisfactory.

  - **Reduced Ironing**  selected? → *page 5*.
- Display panel/indicator lights do not function while the appliance is running.

  - Power failure?
  - Fuse tripped? Switch on/replace fuse.
  - If the fault occurs repeatedly, call customer service.
- Programme progress longer than usual.

  - Not a fault – unbalanced load detection system adjusts imbalance by repeatedly distributing the washing.
  - Not a fault – Foam detection system active - a rinse cycle is started.
- Detergent residue on the washing.

  - Occasionally phosphate-free detergents contain water-insoluble residue.
  - Select **Rinse/Freshen Up**  or brush the laundry after washing.
- If a fault cannot be rectified or a repair is required:

  - Set programme selector to **Off** and pull out the mains plug.
  - Turn off the tap and call customer service → *Installation instructions*.

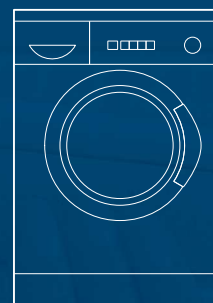

Washing machine

en

Operating instructions



**BOSCH**



Read these instructions before switching on the washing machine!  
Also follow the separate Installation instructions.  
Follow the safety instructions on page 8!