

Brief and handy: everything your dishwasher needs...  
Before using for the first time, read the installation and operating instructions!

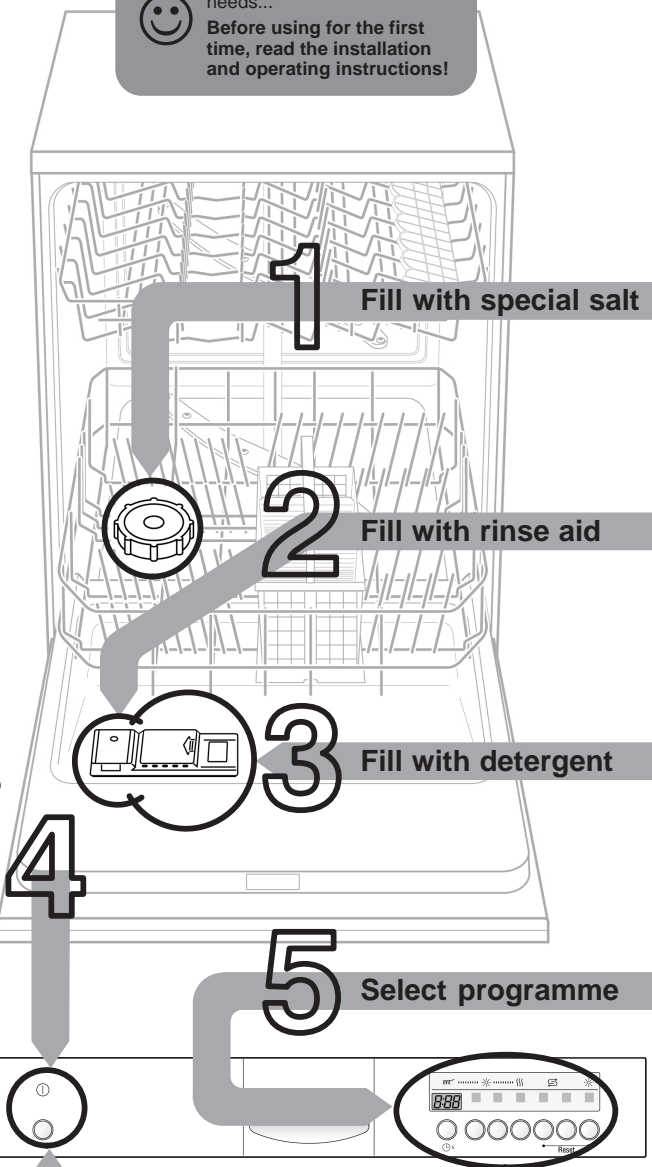

### Adjusting the water softening system \*

Request the water hardness value in your area from your water supply company and enter it here ...

\* only before first use of the appliance or if the water hardness changes

Read off the correct setting for your water hardness

Wasser-Härtewert °dH	Härte-stufe	mmol/l	Einstellwert an der Maschine
0 - 6	I	0 - 1,1	H:00
7 - 8	I	1,2-1,4	H:01
9 - 10	II	1,5-1,8	H:02
11-12	II	1,9-2,1	H:03
13-16	III	2,2-2,9	H:04
17-21	III	3,0-3,7	H:05
22-30	IV	3,8-5,4	H:06
31-50	IV	5,5-8,9	H:07

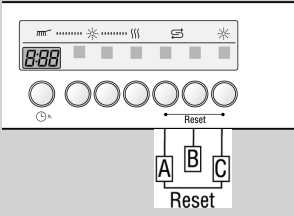

Dissolves limescale (not required for set value 0!)

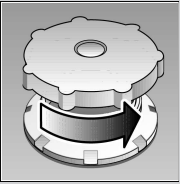

Unscrew the lid.



Only before using the dishwasher for the first time pour approx. 1 l / 2 pt water into the salt opening.

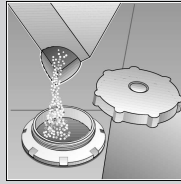

Pour in max. 1.5 kg / 3 lb 5 oz salt (never detergent!)

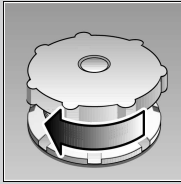

Screw on the lid. Switch on dishwasher immediately.

Everything is sparkling clean ...

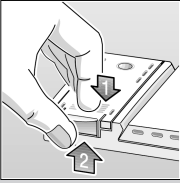

Press mark 1, lift up lid 2.



Refill whenever level indicator is light!

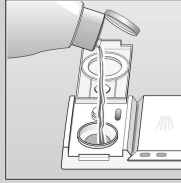

Pour in rinse aid.

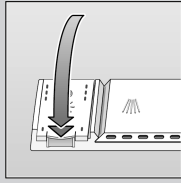

Close the lid. CLICK!

Very dirty dishes, a lot of detergent ...

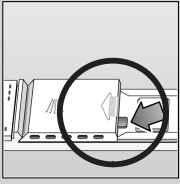

If required, open the lid (press the pin).

Warning, combination products are not suitable for all programmes, follow manufacturer's instructions.

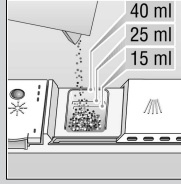

Pour in detergent.

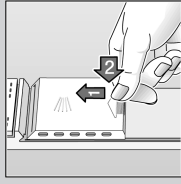

Push the lid shut, press. PLOP!

Quick, economical or intensive

#### Programme Overview

This overview shows the maximum number of programmes available. You'll find the corresponding programmes of your device on your control panel.

The programme data are laboratory read-outs according to European Standard EN 50242. In practice, deviations are possible.

	Intensive 70°	Auto 55°/65°	Eco 50°	Gentle 40°	Quick 45°	Prerinse
Duration: hs/mins	2:15	1:25-2:20	2:20	1:12	0:30	0:19
Energy Consumption: kWh	1,60	1,05-1,60	1,05	0,80	0,70	0,05
Water Consumption: litres	16	10-17	12	14	10	4
With Aquasensor	13	-	-	11	-	-

#### Additional programmes \*\*

**Soak**  
...crockery in the lower basket, programme starts automatically, remember to add an extra 5g of cleaning agent when the door unlocks.

**Time reduction/ time saving**  
...shortens the cleaning time, reduces the drying.

**Saving time (VarioSpeed)**  
... is obtained by increased energy consumption at a constant cleaning and drying performance.

**Half load**  
... for a few items, saves water, energy and time

**Time selection**  
...switches on as soon as you press the time selection button: Alters the programme start in hourly steps

\*\* some models

#### Quickly sorted

##### How to adjust the water softening system

- Hold down programme button **B** and press main switch until the digital display illuminates, then release the buttons. The LED for button **B** flashes and the digital display displays the factory setting **H:04**.
- Each time button **B** is pressed, the setting increases by 1; after **H:07**, the setting goes back to **H:00**.
- Switch off the main switch. The chosen setting has now been stored.

Maintenance and care

Strainers ...

Check, if required, clean

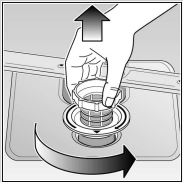

Rotate filter cylinder, remove filter system ...

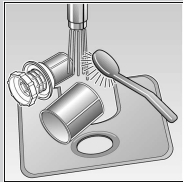

rinse under flowing water ...

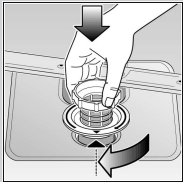

Insert ...

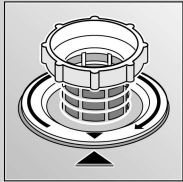

Screw in filter system NOTE MARK!

Spray arms ...

Remove blockages/deposits

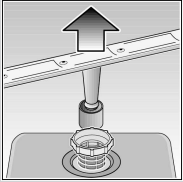

Pull lower arm upwards ...

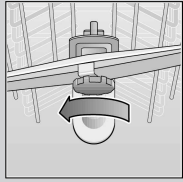

Unscrew upper arm ...

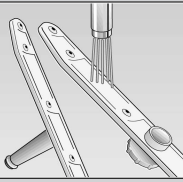

Clean spray nozzles under flowing water (perhaps with toothpick) ...

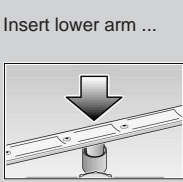

Insert lower arm ...

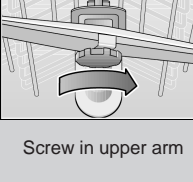

Screw in upper arm

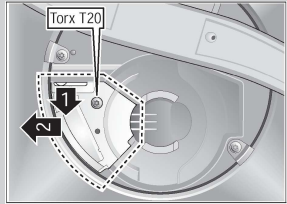

Cleaning the waste-water pump \*

\* With some models

- Ladle out water and remove filters
- Unscrew cover (Torx T20)
- Check area of fan impeller for foreign objects
- Screw in cover and insert filters

Eliminating minor faults yourself ...

... Self-help pays!

Fault	Possible Cause	Remedy
Residual water in the device	Waste-water pump blocked Programme not yet ended	<ul style="list-style-type: none"><li>▶ Clean waste-water pump (see above).</li><li>▶ Close and switch on appliance or terminate programme (see Terminating the programme).</li></ul>
Device does not work/stops	Supply fitting not open Supply hose kinked Supply fitting jammed or calcified	<ul style="list-style-type: none"><li>▶ Open supply fitting.</li><li>▶ Lay supply hose without kinks.</li><li>▶ 1. Unscrew water connection. 2. Clean filter in the water connection. 3. Flow rate must be min. 9 l/min when the water inlet is open. If the flow rate is less, replace the supply fitting.</li></ul>
Plastic parts / parts of dishes discoloured	Too little cleaning product Discoloration caused by food colourings (tomato sauce)	<ul style="list-style-type: none"><li>▶ Follow manufacturer's specifications (detergent).</li><li>▶ Discoloration is quite safe; fades after subsequent rinse cycles.</li></ul>
Cutlery rusty	Cutlery not rust-proof Hard knife blades are more susceptible Extraneous rust	<ul style="list-style-type: none"><li>▶ Use dishwasher-proof cutlery.</li><li>▶ Never wash rusting parts in the appliance.</li></ul>

Fault	Possible Cause	Remedy
Dishes not clean Sand or grainy residues on dishes	Utensils are situated too close to each other or on top of each other Too little cleaning product Unsuitable programme selected Spray nozzles blocked Filters dirty, not installed securely Spray arms blocked	<ul style="list-style-type: none"><li>▶ Spread out the utensils, avoid contact between the utensils.</li><li>▶ Follow manufacturer's specifications (detergent).</li><li>▶ Select more intensive programme.</li><li>▶ Clean spray arms (see above).</li><li>▶ Clean the strainers (see above).</li><li>▶ Arrange the utensils so that the spray arms can rotate freely.</li></ul>
Stains and streaks	Rinse aid dosage too high / too low	<ul style="list-style-type: none"><li>▶ Streaks: Reduce dosage.</li><li>▶ Water or limescale stains: Increase dosage.</li></ul>
Milky residues on dishes (can be removed)	Water softening system incorrectly set; no special salt	<ul style="list-style-type: none"><li>▶ Set water softening system correctly.</li><li>▶ Refill with special salt.</li></ul>
Milky film, glasses cloudy / dull (cannot be removed)	Glasses not dishwasher-proof.	<ul style="list-style-type: none"><li>▶ Use dishwasher-proof glasses.</li><li>▶ Use glass-friendly cleaning products.</li></ul>

Further advice can be found in the instruction manual

Stopping the programme ...

Press and hold the two reset buttons simultaneously for approximately 3 seconds while the programme is running (RESET)

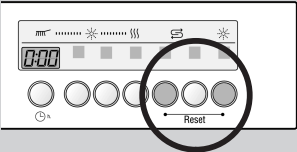

"0:00" appears  
The programme will stop after 1 minute



Switch off the appliance.

Loading the dishwasher correctly ...

Arrange dishwasher-proof utensils (having removed any ash, wax, grease, ink, sticky labels; remove, large remnants of jam, dairy products and food) according to the operating instructions and check that the spray arms can rotate freely.