

Your washing machine

Congratulations – You have opted for a modern, high-quality domestic appliance manufactured by Bosch. The washing machine is distinguished by its economical energy consumption.

Each appliance which leaves our factory is inspected thoroughly to ensure that it functions properly and is in perfect condition.

Environmental disposal

Dispose of packaging in an environmentally friendly manner.

This appliance has been identified in accordance with the European Directive 2002/96/EG on Waste Electrical and Electronic Equipment (WEEE).

The Directive specifies the framework for an EU-wide valid return and recycling of waste appliances.

Contents

	Page
■ Intended use	1
■ Setting programmes	2
■ After washing	4
■ Individual settings	5
■ Important information	6
■ Overview of programmes	7
■ Care	8
■ Information on the display panel	8
■ Maintenance	9
■ What to do if ...	10
■ Safety instructions	11
■ Consumption values	11

Intended use

- for use in the household only,
- for the washing of machine-washable textiles in a detergent solution,
- to be operated with cold drinking water and commercially available detergents and care products which are suitable for use in washing machines.

Environmental disposal

Dispose of packaging in an environmentally friendly manner.

This appliance has been identified in accordance with the European Directive 2002/96/EG on Waste Electrical and Electronic Equipment (WEEE).

The Directive specifies the framework for an EU-wide valid return and recycling of waste appliances.

Programmes

For detailed overview of programmes see Page 7.

Spin speed can be selected individually.

👕 Cottons	hard-wearing textiles
👖 Stains	hard-wearing textiles
👕👖 Mixed Load	different types of washing
👗 Easy-Care	easy-care textiles
👗 Delicates	delicate washable textiles
👗 Woolens	hand/machine-washable textiles
👗 Drain	the rinsing water if Rinse Hold occurs
🌀 Spin	washing washed by hand
🌟 Freshen Up/Rinse	...	with subsequent spin cycle; for hand-washed items, starching or "freshen up" items, see Page 6.

Preparation

Correct installation according to separate installation instructions.

Checking the machine

- Never switch on a damaged machine!
- Inform your customer service!

Turn on the tap

Do not leave children unattended near the washing machine!

Keep pets away from the washing machine!

Insert mains plug

With dry hands only!
Take hold of the plug only!

Sorting and inserting the washing

Follow manufacturer's care information! According to the information on the care labels. According to type; colour; soiling and temperature.

Follow important instructions! See page 6!

Insert large and small items of washing! Do not jam items of washing between the washing machine door and rubber seal.

Add detergent and care product

Meter accordingly: Washing amount, soiling, water hardness (ask your water supply company) and manufacturer's instructions. Pour liquid detergent into the appropriate dispenser and place in the drum.

- I Prewash: Detergent, starch
 - II Care product: Fabric softener
 - III Main wash: Detergent, water softener, bleach, stain remover
- Dilute viscous fabric softener and fabric conditioner with water. Prevents blockage of the overflow. Do not use detergent for programme option 🌟 Freshen up/Rinse!

Set and adjust programme

For additional functions and option buttons see individual settings, page 5.

All buttons are sensitive, they only need to be touched gently!

Programme selector for switching the machine on and off and for selecting the programme. Can be rotated in either direction.

Select Start

Wash

Detergent container

Drum

Fascia

Door handle

Service flap

Removing washing

Possible approx. 2 minutes after the programme ends!

Open washing machine door and remove washing.

If **Rinse Hold** (without final spin) active: Set programme selector to **Drain** or select spin speed. Select **Start**.

Remove any foreign objects – risk of rusting.

Turn off the tap

Not required for Aqua-Stop models.

Switch off

Set programme selector to **Off**.

End of programme when ...

... **Start** flashes and **End** is lit on the indicator light.

Change programme ...

If you have mistakenly selected a wrong programme:

- Reselect programme.
- Select **Start**.

... or terminate

Programmes with high temperature, first:

- Cool washing: Select **Freshen Up/Rinse**.
- Washing machine door remains locked.
- Select **Off**.
- Select **Spin** or **Drain**.
- Select **Start**.

Individual settings

Spin

The spin speed or **Rinse Hold** (without final spin) can be set before and while the selected programme is running. Effects dependent on the programme progress. The maximum selectable spin speed depends on the model and the set programme.

Additional functions* see also programme overview (* depending on model)

Wash Plus Extension of the washing time for a more intensive washing of highly soiled washing or 6 kg of cottons and coloureds.

Prewash For heavily soiled, hard-wearing washing, e.g. made of cotton or linen. Prewash at 30 °C.

Reduced Ironing Special spin sequence with subsequent fluffing. Gentle final spin – residual moisture in the washing increased slightly.

Aqua Plus Increased water level and additional rinse cycle, extended washing time. For areas with very soft water or for further improvement of the rinsing result.

Start

For starting or interrupting the programme.

Signal

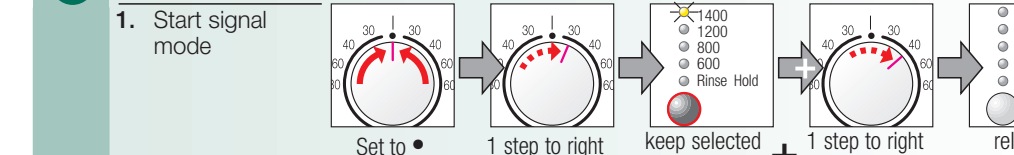

Optional:

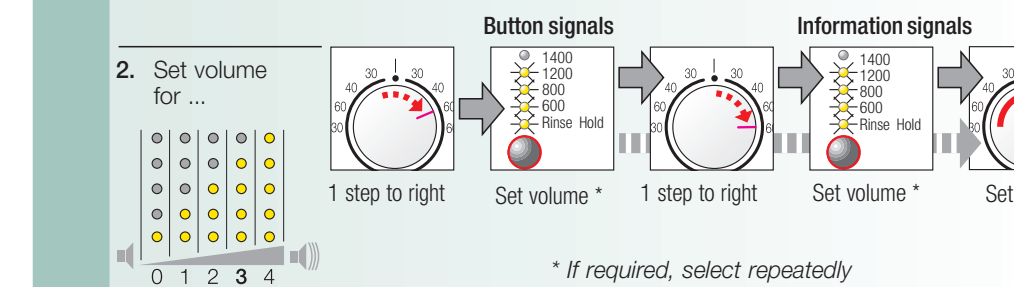
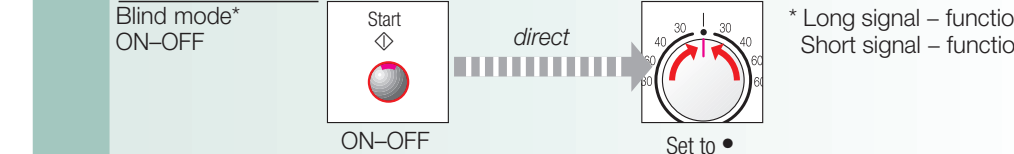

* If required, select repeatedly

Important information

Protecting the washing and the machine

- Empty pockets.
- Remove metal parts (paper clips, etc.).
- Wash delicates in the net/bag (tights, curtains, underwired bras).
- Close zips, button up covers.
- Brush sand out of pockets and collars.
- Remove curtain fittings or include in the net/bag.

Before washing for the first time

Do not put any washing in the washing machine! Turn on the tap, fill the appliance with approx. 1 litre of water and then pour ½ measuring cup of detergent into dispenser II. Set programme selector to **Easy-Care 60 °C** and select **Start**. At the end of the programme set the programme selector to **Off**.

Washing with different degrees of soiling

	Light	Heavy
	Wash new items separately. Do not prewash.	If required, pretreat stains. Select Wash Plus additional function.
		Load less washing. Prewash.

Filling weight

Do not exceed maximum load:

- Cottons and coloureds 6 kg
- Easy-Care 3 kg
- Delicates, silk and woollens 2 kg

Soaking

Load washing of the same colour. Pour soaking agent/detergent into dispenser II according to the manufacturer's instructions. Set programme selector to **Cottons 30 °C** and select **Start**. After approx. 10 minutes select **Start**. After the required soaking time reselect **Start** if the programme is to be continued or change the programme.

Starching

Washing should not be treated with fabric softener. Dissolve an amount of starch for approx. 15 litres of water according to the manufacturer's instructions. Set programme selector to **Freshen Up/Rinse**, set spin speed and select **Start**. As soon as water runs in: Pour the starch solution into dispenser I.

Dyeing/Bleaching

Do not dye/bleach washing in the washing machine.

Freshen up Use programme Freshen Up/Rinse

For items, that have been tucked away or stored for a period of time, to remove creases caused by folding and storage and to eliminate odours. Use fabric conditioner for "fresh" smell.

Protection of the environment/conservation tips

- Utilise the maximum amount of washing for the particular programme.
- Wash normally soiled washing without prewash.
- Instead of **Cottons 90 °C** select **Stains 60 °C** programme. Comparable cleaning result with significantly lower energy consumption.
- Meter detergent according to the manufacturer's instructions and water hardness.
- If the washing is then dried in the tumble dryer, select spin speed according to the instructions of the dryer manufacturer.

Programmes	°C	max.	Type of washing	Additional functions (depending on model); information
Cottons	30, 40, 60, 90 °C	6 kg*	Hard-wearing textiles, heat-resistant textiles made of cotton or linen	Wash Plus, Prewash, Reduced Ironing, Aqua Plus
Stains	60 °C			
Easy-Care	30, 40, 60 °C	3 kg	Easy-care textiles made of cotton, linen, synthetic fibres or blended fabrics	Wash Plus, Prewash, Reduced Ironing, Aqua Plus; (also suitable as Short programme)
Mixed Load	30 °C		Textiles made of cotton and easy-care textiles	Wash Plus, Prewash, Reduced Ironing, Aqua Plus; Different types of washing can be washed together
Delicates	30 °C	2 kg	For delicate, washable textiles, e.g. made of silk, satin, synthetic fibres or blended fabrics (e.g. curtains)	Wash Plus, Prewash, Reduced Ironing, Aqua Plus; no spin cycle between the rinse cycles
Woolens	cold, 40 °C		Hand or machine-washable wool or rich-wool textiles	also suitable for hand-washable silk; reduced rinse and final spin cycle
Additional programmes				
Freshen Up/Rinse Spin Drain Wash Plus				

For further information and a selection of our products go to our web site: <http://www.bosch-hausgeraete.de> or contact our customer service centres

Robert Bosch Hausgeräte GmbH
Carl-Wery-Str. 34
81739 München / Germany

WAE28162GB...
0506
9000 132 543

Care



- Risk of electric shock!
Pull out the mains plug!
- Risk of explosion! No solvents!



Machine housing, control panel

- Wipe with a soft, damp cloth.
- Do not use abrasive detergents.
- Immediately remove washing and cleaning agent residue.
- Do not clean the appliance with a water jet.



Clean the detergent drawer ...

... if it contains detergent or fabric softener residue.

1.

Pull out, depress insert, completely remove.

2.

Open the cover.

3.

Clean with water and dry.

4.

Close and lock the cover (place cylinder on guide pin).

5.

Insert detergent drawer.



Leave detergent drawer open so that residual water can evaporate.



Drum

Leave washing machine door open so that the drum can dry out.

Rust stains – use chlorine-free cleaning agent, not steel wool.



Descaling

No washing in the machine!

Descale according to the instructions of the descaling agent-manufacturer, not required for correct detergent dosage.

Information on the display panel

depending on model

A signal sounds and indicator lights for the spin speed flash:

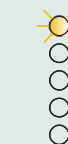

Close the washing machine door properly; washing may be caught.



Turn on the tap, supply hose kinked/jammed; clean filter (page 9), water pressure too low.



Clean detergent-solution pump (page 9), outlet pipe/drainage hose blocked.



Water in the base pan, appliance leaking. Call customer service!

Maintenance



- Risk of scalding!
Allow detergent solution to cool down!
- Turn off the tap!



Detergent-solution pump

Set programme selector to **Off**, pull out the mains plug.

1.

Open and remove service flap.

2.

For models with drainage hose:
Take drainage hose out of the holder and pull out of the housing. Remove sealing cap, allow detergent solution to flow out.
Press on sealing cap and insert drainage hose into the holder.

2*

For models without drainage hose:
Carefully unscrew pump cover until the detergent solution begins to run out.
When the service flap is half full, screw back the pump cover and empty the service flap.
Repeat steps until all the detergent solution has run out.

3.

Carefully unscrew the pump cover (residual water).

4.

Clean the interior, pump cover thread and pump housing (fan impeller in the detergent-solution pump must rotate).

5.

Reinsert and screw on pump cover.

6.

Insert and close service flap.



To prevent unused detergent from flowing into the outlet during the next wash:
Pour 1 litre of water into dispenser II and select the **Drain** programme.



Filters in the water supply

Risk of electric shock! Do not immerse Aqua-Stop safety device in water (contains electric valve).

Release water pressure in the supply hose:

1.

Turn off the tap!

2.

Select any programme (except **Spin** /Drain).

3.

Press **Start** . Leave programme for approx. 40 seconds.

4.

Set programme selector to **Off**.

5.

Remove hose from tap.

6.

Clean filter with small brush.

7.

Depending on the model, remove hose from the rear of the appliance and clean the filter.

8.

Connect the hose and check for leaks.

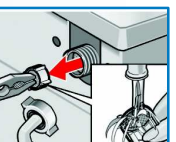
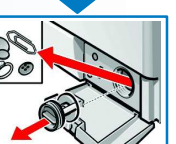
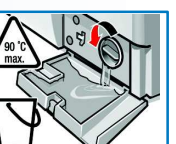
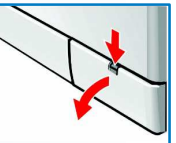

What to do if ...



Water is running out.

- Correctly attach/replace drainage hose.
- Tighten screw-fitting on the supply hose.



Water not flowing in.
Detergent not washed in.

- **Start** not selected?
- Tap not open?
- Filter blocked? Clean filter (page 9).
- Supply hose kinked or jammed?



Washing machine door cannot be opened.

- Safety function active, wait for approx. 2 minutes.
- **Rinse Hold** (without final spin) selected?



Programme does not start.

- **Start** selected?
- Door closed?



Detergent solution is not drained.

- Clean detergent-solution pump (page 9).
- Clean outlet pipe and/or drainage hose.



Washing not spun correctly.

- Distribute small and large items of washing in the drum.



Spin cycle actuated several times.

- Not a fault – unbalanced load detection system adjusts imbalance.



Water not visible in the drum.

- Not a fault – water below the visible area.



Residual water in the dispenser for care product.

- Not a fault – effect of the care product not impaired.



Odour formation in the washing machine.

- Run **Cottons 90 °C** programme without washing. Use standard detergent.



Foam is coming out of the detergent drawer.

- Too much detergent used?
Mix 1 tablespoon of fabric conditioner with ½ litre of water and pour into dispenser II in the detergent drawer.
- Reduce detergent dosage for the next wash cycle.



Vibrations during spin cycle.

- Appliance feet fixed? Secure appliance feet (*Installation instructions*).
- Transportation safety devices removed? Remove transportation safety devices (*Installation instructions*).



Spin result not satisfactory.

- **Reduced Ironing*** selected (page 5)? (* depending on model)



Display panel/indicator lights do not function while the appliance is running.

- Power failure?
- Fuse tripped? Switch on/replace fuse.
- If the fault occurs repeatedly, call customer service.



Programme progress longer than usual.

- Not a fault – unbalanced load detection system adjusts imbalance by repeatedly distributing the washing.



Detergent residue on the washing.

- Occasionally phosphate-free detergents contain water-insoluble residue.
- Select **Rinse/Freshen Up** or brush the laundry after washing.



If a fault cannot be rectified or a repair is required:

- Set programme selector to **Off** and pull out the mains plug.
- Turn off the tap and call customer service (*Installation instructions*).

Safety instructions



- Read and follow the operating and installation instructions and all other information enclosed with the washing machine.
- Retain documents for subsequent use.

Risk of electric shock

- Never pull out the mains plug by tugging the power cord!
- Never insert/pull out the mains plug with damp hands.
- Washing machine door may become very hot.
- Caution when draining hot detergent solution.
- Do not climb on the washing machine.

Risk of injury

- Do not lean on the open washing machine door.
- Keep detergents and care products out of the reach of children.
- Keep packaging, plastic film and packaging parts out of the reach of children.

Risk of poisoning

Risk of suffocation

- On redundant appliances:
- Pull out the mains plug.
- Sever the power cord and discard together with the plug.
- Destroy the lock on the washing machine door. This will prevent children from locking themselves in and suffocating.

Danger to life

- Caused by detergents containing solvents, e.g. stain remover/items of washing pretreated with solvent naphtha may result in an explosion after being loaded into the washing machine. Beforehand thoroughly rinse items of washing by hand.

Risk of explosion

Consumption values

Programme	Additional function	Load	Current **	Water **	Programme duration **
Cottons 40 °C *	Wash Plus	6 kg	0.60 kWh	53 l	2:13 h
Cottons 60 °C	–	6 kg	1.20 kWh	55 l	1:30 h
Stains 60 °C*	Wash Plus	6 kg	1.02 kWh	45 l	2:15 h
Cottons 90 °C	Wash Plus	6 kg	1.90 kWh	60 l	2:13 h
Easy-Care 40 °C *	Wash Plus	3 kg	0.55 kWh	50 l	1:24 h
Easy-Care 40 °C (also suitable as Short programme)	–	3 kg	0.54 kWh	40 l	0:55 h
Mixed Load	–	3 kg	0.59 kWh	35 l	0:50 h
Delicates 30 °C	–	2 kg	0.22 kWh	32 l	0:32 h
Wool 30 °C *	–	2 kg	0.14 kWh	30 l	0:40 h

* Programme setting with **Wash Plus** option and maximum spin speed for testing according to or in accordance with EN 60 456 and IEC 60 456.

** The values deviate from the indicated values depending on water pressure, water hardness, water inlet temperature, room temperature, type and amount of washing and degree of soiling, utilised detergent, fluctuations in the mains voltage and selected additional functions.

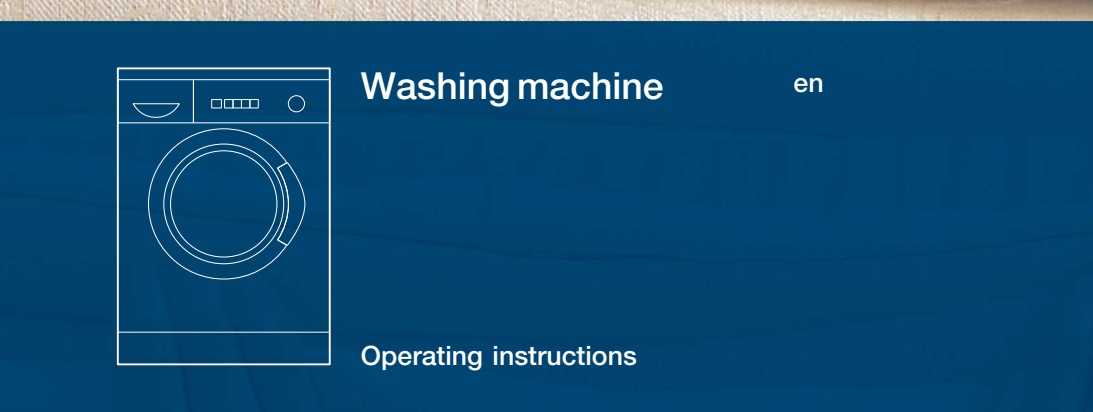

Read these instructions before switching on the washing machine!
Also follow the separate Installation instructions.
Follow the safety instructions on page 11!

Your washing machine

Congratulations – You have opted for a modern, high-quality domestic appliance manufactured by Bosch. The washing machine is distinguished by its economical energy consumption.

Each appliance which leaves our factory is inspected thoroughly to ensure that it functions properly and is in perfect condition.



Environmental disposal

Dispose of packaging in an environmentally friendly manner.

This appliance has been identified in accordance with the European Directive 2002/96/EG on Waste Electrical and Electronic Equipment (WEEE).

The Directive specifies the framework for an EU-wide valid return and recycling of waste appliances.

Contents

Page

Intended use	1
Setting programmes	2
After washing	4
Individual settings	5
Important information	6
Overview of programmes	7
Care	8
Information on the display panel	8
Maintenance	9
What to do if ...	10
Safety instructions	11
Consumption values	11

Intended use

- for use in the household only,
- for the washing of machine-washable textiles in a detergent solution,
- to be operated with cold drinking water and commercially available detergents and care products which are suitable for use in washing machines.



- Do not leave children unattended near the washing machine!
- Keep pets away from the washing machine!

Preparation



Correct installation according to separate installation instructions.



Checking the machine

- Never switch on a damaged machine!
- Inform your customer service!



Turn on the tap



Insert mains plug



With dry hands only!
Take hold of the plug only!



* depend

Programmes

For detailed overview of programmes see Page 7.

Spin speed can be selected individually.

	Cottons	hard-wearing textiles
	Stains	hard-wearing textiles
	Mixed Load	different types of washing
	Easy-Care	easy-care textiles
	Delicates	delicate washable textiles
	Woolens	hand/machine-washable textiles
	Drain	the rinsing water if Rinse Hold occurs
	Spin	washing washed by hand
	Freshen Up/Rinse	with subsequent spin cycle; for hand-washed items, starching or "freshen up" items, see Page 6.

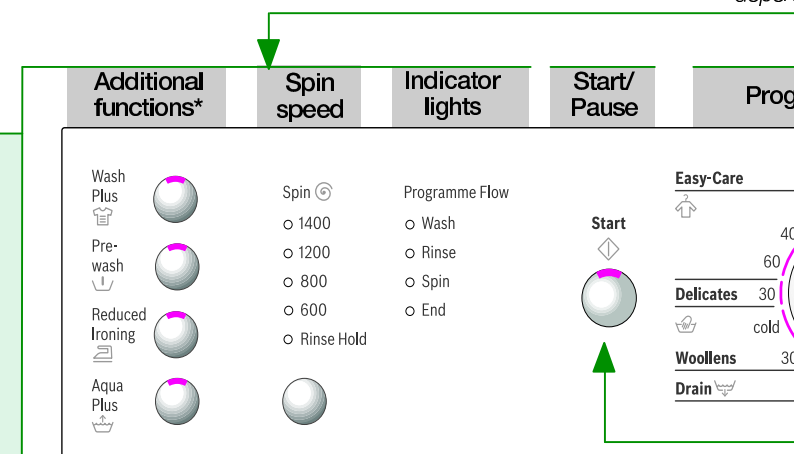

Before washing for the first time,
wash once without any washing. See page 6

Sorting and inserting the washing

Follow manufacturer's care information!
According to the information on the care labels.
According to type; colour; soiling and temperature.

Follow important instructions! See page 6!

Insert large and small items of washing! Do not jam items of washing
between the washing machine door and rubber seal.

Add detergent and care product

Meter accordingly:
Washing amount, soiling, water hardness (ask your water supply
company) and manufacturer's instructions. Pour liquid detergent
into the appropriate dispenser and place in the drum.

Prewash: Detergent, starch

Care product: Fabric softener

Main wash: Detergent, water softener, bleach, stain remover

Dilute viscous fabric softener and fabric conditioner with water.

Prevents blockage of the overflow.

Do not use detergent for programme option * **Freshen up/Rinse!**

Depending on model

Set and adjust programme

For additional functions and option
buttons see individual settings, page 5.

i All buttons are sensitive, they
only need to be touched gently!

Programme selector for switching
the machine on and off and for
selecting the programme. Can be
rotated in either direction.

Select Start ◀

Programme selector

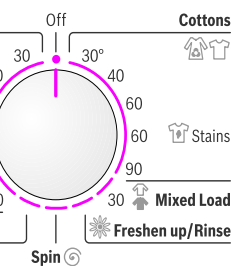

Wash

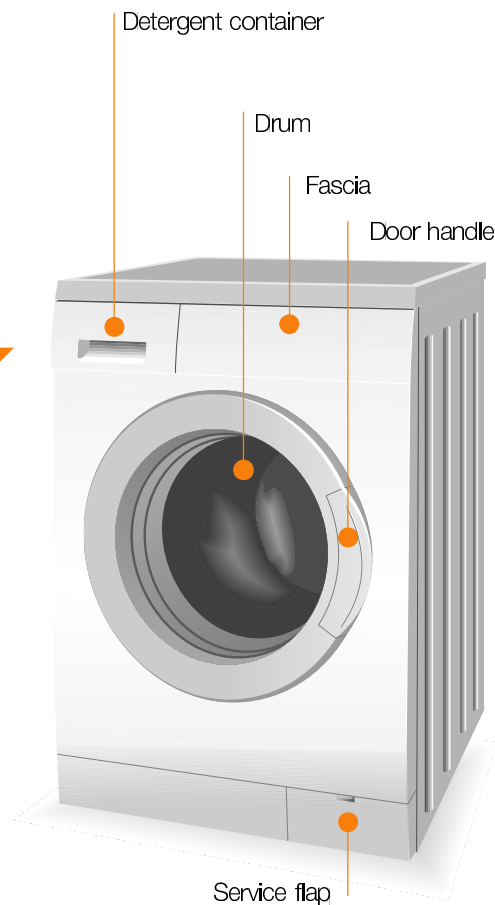

Wash

Removing washing

Possible approx. 2 minutes after the programme ends!

Open washing machine door and remove washing.

If **Rinse Hold** (without final spin) active: Set programme
selector to **Drain** or select spin speed.
Select **Start**.

Remove any foreign objects – risk of rusting.

Turn off the tap

Not required for Aqua-Stop models.

Switch off

Set programme selector to **Off**.

End of programme when ...

... **Start** flashes and **End** is lit on the indicator light.

Change programme ...

If you have mistakenly selected a wrong programme:

- Reselect programme.
- Select **Start**.

... or terminate

Programmes with high temperature, first:

- Cool washing: Select **Freshen Up/Rinse**.
- Washing machine door remains locked.
- Select **Off**.
- Select **Spin** or **Drain**.
- Select **Start**.

Individual settings

Spin

The spin speed or **Rinse Hold** (without final spin) can be set before and while the selected programme is running. Effects dependent on the programme progress. The maximum selectable spin speed depends on the model and the set programme.

Additional functions* see also programme overview (* depending on model)

Wash Plus	Extension of the washing time for a more intensive washing of highly soiled washing or 6 kg of cottons and coloureds.
Prewash	For heavily soiled, hard-wearing washing, e.g. made of cotton or linen. Prewash at 30 °C.
Reduced Ironing	Special spin sequence with subsequent fluffing. Gentle final spin – residual moisture in the washing increased slightly.
Aqua Plus	Increased water level and additional rinse cycle, extended washing time. For areas with very soft water or for further improvement of the rinsing result.

Start

For starting or interrupting the programme.

Signal

1. Start signal mode

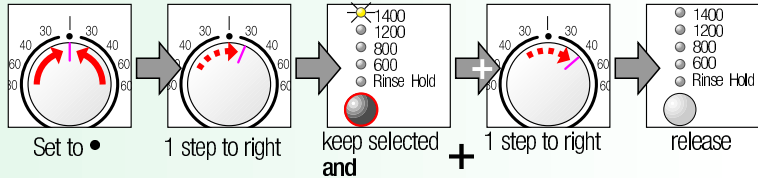

Optional:

Blind mode*
ON-OFF

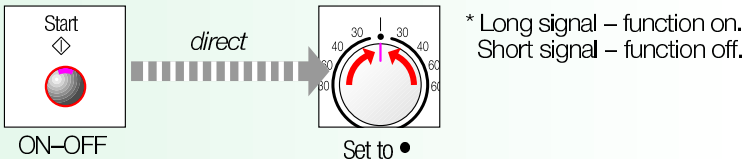

2. Set volume for ...

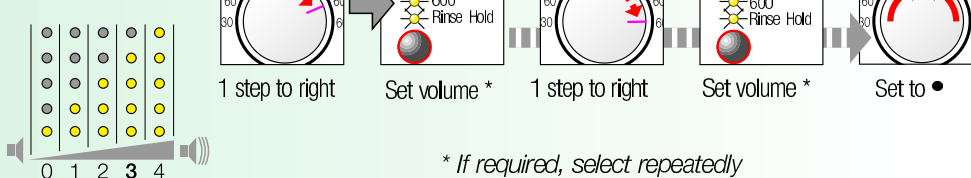

Important information



Protecting the washing and the machine

- Empty pockets.
- Remove metal parts (paper clips, etc.).
- Wash delicates in the net/bag (tights, curtains, underwired bras).
- Close zips, button up covers.
- Brush sand out of pockets and collars.
- Remove curtain fittings or include in the net/bag.



Before washing for the first time

Do not put any washing in the washing machine! Turn on the tap, fill the appliance with approx. 1 litre of water and then pour ½ measuring cup of detergent into dispenser II. Set programme selector to **Easy-Care 60 °C** and select **Start**. At the end of the programme set the programme selector to **Off**.



Washing with different degrees of soiling

Light	Wash new items separately.
Medium	Do not prewash.
Heavy	If required, pretreat stains. Select Wash Plus additional function.
	Load less washing.
	Prewash.



Filling weight

Do not exceed maximum load:

- Cottons and coloureds 6 kg
- Easy-Care 3 kg
- Delicates, silk and woollens 2 kg



Soaking

Load washing of the same colour

Pour soaking agent/detergent into dispenser II according to the manufacturer's instructions. Set programme selector to **Cottons 30 °C** and select **Start**. After approx. 10 minutes select **Start**. After the required soaking time reselect **Start** if the programme is to be continued or change the programme.



Starching

Washing should not be treated with fabric softener

Dissolve an amount of starch for approx. 15 litres of water according to the manufacturer's instructions.

Set programme selector to **Freshen Up/Rinse**, set spin speed and select **Start**. As soon as water runs in: Pour the starch solution into dispenser I.



Dyeing/Bleaching

Do not dye/bleach washing in the washing machine.



Freshen up

Use programme **Freshen Up/Rinse**

For items, that have been tucked away or stored for a period of time, to remove creases caused by folding and storage and to eliminate odours. Use fabric conditioner for "fresh" smell.



Protection of the environment/conservation tips

- Utilise the maximum amount of washing for the particular programme.
- Wash normally soiled washing without prewash.
- Instead of **Cottons 90 °C** select **Stains 60 °C** programme. Comparable cleaning result with significantly lower energy consumption.
- Meter detergent according to the manufacturer's instructions and water hardness.
- If the washing is then dried in the tumble dryer, select spin speed according to the instructions of the dryer manufacturer.

Programmes	max.	°C	Type of washing	Additional functions (depending on model); information
Cottons	6 kg*	30, 40, 60, 90 °C	Hard-wearing textiles, heat-resistant textiles made of cotton or linen	Wash Plus, 1 Prewash, 2 Reduced Ironing, 3 Aqua Plus
Stains		60 °C		
Easy-Care	3 kg	30, 40, 60 °C	Easy-care textiles made of cotton, linen, synthetic fibres or blended fabrics	Wash Plus, 1 Prewash, 2 Reduced Ironing, 3 Aqua Plus; (also suitable as Short programme)
Mixed Load		30 °C	Textiles made of cotton and easy-care textiles	Wash Plus, 1 Prewash, 2 Reduced Ironing, 3 Aqua Plus; Different types of washing can be washed together
Delicates	2 kg	30 °C	For delicate, washable textiles, e.g. made of silk, satin, synthetic fibres or blended fabrics (e.g. curtains)	Wash Plus, 1 Prewash, 2 Reduced Ironing, 3 Aqua Plus; no spin cycle between the rinse cycles
Woollens		cold, 40 °C	Hand or machine-washable wool or rich-wool textiles	also suitable for hand-washable silk; reduced rinse and final spin cycle
Additional programmes				
Freshen Up/Rinse*, Spin, Drain				

The programmes are time-controlled for lightly soiled textiles. If textiles are heavily soiled, reduce the load or select additional functions, e.g. **Wash Plus**. Programmes without prewash – pour detergent into dispenser **II**, programmes with prewash – divide detergent between dispensers **I** and **II**.

* Select the **Wash Plus** additional function if washing 6 kg of cottons and coloureds.

For further information and a selection of our products go to our web site: <http://www.bosch-hausgeraete.de> or contact our customer service centres

Robert Bosch Hausgeräte GmbH
Carl-Wery-Str. 34
81739 München / Germany

WAE28162GB...
0506
9000 132 543

Care



- Risk of electric shock! Pull out the mains plug!
- Risk of explosion! No solvents!



Machine housing, control panel

- Wipe with a soft, damp cloth.
- Do not use abrasive detergents.
- Immediately remove washing and cleaning agent residue.
- Do not clean the appliance with a water jet.



Clean the detergent drawer ...

... if it contains detergent or fabric softener residue.

1. Pull out, depress insert, completely remove.
2. Open the cover.
3. Clean with water and dry.
4. Close and lock the cover (place cylinder on guide pin).
5. Insert detergent drawer.

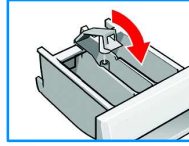
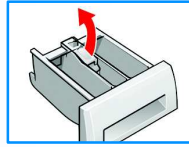
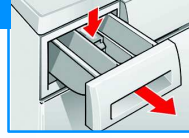

Leave detergent drawer open so that residual water can evaporate.



Drum

Leave washing machine door open so that the drum can dry out.
Rust stains – use chlorine-free cleaning agent, not steel wool.



Descaling No washing in the machine!

Descal according to the instructions of the descaling agent-manufacturer, not required for correct detergent dosage.

Information on the display panel depending on model

A signal sounds and indicator lights for the spin speed flash:



Close the washing machine door properly; washing may be caught.

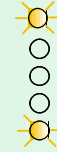

Turn on the tap, supply hose kinked/jammed; clean filter (page 9), water pressure too low.



Clean detergent-solution pump (page 9), outlet pipe/drainage hose blocked.



Water in the base pan, appliance leaking. Call customer service!



- Risk of scalding!
Allow detergent solution to cool down!
- Turn off the tap!

Detergent-solution pump

Set programme selector to **Off**, pull out the mains plug.

1. Open and remove service flap.
2. For models with drainage hose:
Take drainage hose out of the holder and pull out of the housing. Remove sealing cap, allow detergent solution to flow out.
Press on sealing cap and insert drainage hose into the holder.
- 2* For models without drainage hose:
Carefully unscrew pump cover until the detergent solution begins to run out.
When the service flap is half full, screw back the pump cover and empty the service flap.
Repeat steps until all the detergent solution has run out.
3. Carefully unscrew the pump cover (residual water).
4. Clean the interior, pump cover thread and pump housing (fan impeller in the detergent-solution pump must rotate).
5. Reinsert and screw on pump cover.
6. Insert and close service flap.

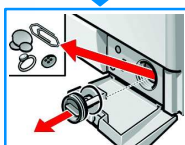
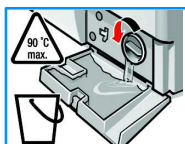
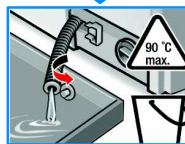
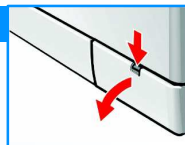

To prevent unused detergent from flowing into the outlet during the next wash:
Pour 1 litre of water into dispenser II and select the **Drain** programme.

Filters in the water supply



Risk of electric shock! Do not immerse Aqua-Stop safety device in water (contains electric valve).

Release water pressure in the supply hose:

1. Turn off the tap!
2. Select any programme (except **Spin** /**Drain** .
3. Press **Start** . Leave programme for approx. 40 seconds.
4. Set programme selector to **Off**.
5. Remove hose from tap.
6. Clean filter with small brush.
7. Depending on the model, remove hose from the rear of the appliance and clean the filter.
8. Connect the hose and check for leaks.

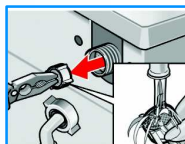

- Water is running out.
 - Correctly attach/replace drainage hose.
 - Tighten screw-fitting on the supply hose.
- Water not flowing in.
Detergent not washed in.
 - **Start** not selected?
 - Tap not open?
 - Filter blocked? Clean filter (page 9).
 - Supply hose kinked or jammed?
- Washing machine door cannot be opened.
 - Safety function active, wait for approx. 2 minutes.
 - **Rinse Hold** (without final spin) selected?
- Programme does not start.
 - **Start** selected?
 - Door closed?
- Detergent solution is not drained.
 - Clean detergent-solution pump (page 9).
 - Clean outlet pipe and/or drainage hose.
- Washing not spun correctly.
 - Distribute small and large items of washing in the drum.
- Spin cycle actuated several times.
 - Not a fault – unbalanced load detection system adjusts imbalance.
- Water not visible in the drum.
 - Not a fault – water below the visible area.
- Residual water in the dispenser for care product.
 - Not a fault – effect of the care product not impaired.
- Odour formation in the washing machine.
 - Run **Cottons 90 °C** programme without washing. Use standard detergent.
- Foam is coming out of the detergent drawer.
 - Too much detergent used?
Mix 1 tablespoon of fabric conditioner with ½ litre of water and pour into dispenser II in the detergent drawer.
 - Reduce detergent dosage for the next wash cycle.
- Vibrations during spin cycle.
 - Appliance feet fixed?
Secure appliance feet (*Installation instructions*).
 - Transportation safety devices removed?
Remove transportation safety devices (*Installation instructions*).
- Spin result not satisfactory.
 - **Reduced Ironing*** selected (page 5)?
(* depending on model)
- Display panel/indicator lights do not function while the appliance is running.
 - Power failure?
 - Fuse tripped? Switch on/replace fuse.
 - If the fault occurs repeatedly, call customer service.
- Programme progress longer than usual.
 - Not a fault – unbalanced load detection system adjusts imbalance by repeatedly distributing the washing.
- Detergent residue on the washing.
 - Occasionally phosphate-free detergents contain water-insoluble residue.
 - Select **Rinse/Freshen Up** or brush the laundry after washing.
- If a fault cannot be rectified or a repair is required:
 - Set programme selector to **Off** and pull out the mains plug.
 - Turn off the tap and call customer service (*Installation instructions*).



Safety instructions

- Read and follow the operating and installation instructions and all other information enclosed with the washing machine.
- Retain documents for subsequent use.

Risk of electric shock

- Never pull out the mains plug by tugging the power cord!
- Never insert/pull out the mains plug with damp hands.

Risk of injury

- Washing machine door may become very hot.
- Caution when draining hot detergent solution.
- Do not climb on the washing machine.
- Do not lean on the open washing machine door.

Risk of poisoning

Risk of suffocation

- Keep detergents and care products out of the reach of children.
- Keep packaging, plastic film and packaging parts out of the reach of children.

Danger to life

On redundant appliances:

- Pull out the mains plug.
- Sever the power cord and discard together with the plug.
- Destroy the lock on the washing machine door. This will prevent children from locking themselves in and suffocating.
- Caused by detergents containing solvents, e.g. stain remover/items of washing pretreated with solvent naphtha may result in an explosion after being loaded into the washing machine. Beforehand thoroughly rinse items of washing by hand.

Risk of explosion

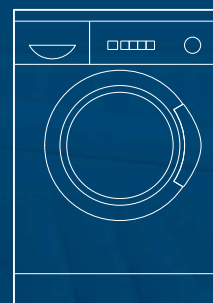

Washing machine

en

Operating instructions



BOSCH



Read these instructions before switching on the washing machine!
Also follow the separate Installation instructions.
Follow the safety instructions on page 11!

Consumption values

Programme	Additional function	Load	Current **	Water **	Programme duration **
Cottons 40 °C *	Wash Plus	6 kg	0.60 kWh	53 l	2:13 h
Cottons 60 °C	–	6 kg	1.20 kWh	55 l	1:30 h
Stains 60 °C*	Wash Plus	6 kg	1.02 kWh	45 l	2:15 h
Cottons 90 °C	Wash Plus	6 kg	1.90 kWh	60 l	2:13 h
Easy-Care 40 °C *	Wash Plus	3 kg	0.55 kWh	50 l	1:24 h
Easy-Care 40 °C (also suitable as Short programme)	–	3 kg	0.54 kWh	40 l	0:55 h
Mixed Load	–	3 kg	0.59 kWh	35 l	0:50 h
Delicates 30 °C	–	2 kg	0.22 kWh	32 l	0:32 h
Wool 30 °C *		2 kg	0.14 kWh	30 l	0:40 h

* Programme setting with **Wash Plus** option and maximum spin speed for testing according to or in accordance with EN 60 456 and IEC 60 456.

** The values deviate from the indicated values depending on water pressure, water hardness, water inlet temperature, room temperature, type and amount of washing and degree of soiling, utilised detergent, fluctuations in the mains voltage and selected additional functions.