

Your washing machine

Congratulations – You have opted for a modern, high-quality domestic appliance manufactured by Bosch. The washing machine is distinguished by its economical energy consumption.

Each appliance which leaves our factory is inspected thoroughly to ensure that it functions properly and is in perfect condition.

Environmental disposal

Dispose of packaging in an environmentally friendly manner.

This appliance has been identified in accordance with the European Directive 2002/96/EG on Waste Electrical and Electronic Equipment (WEEE).

The Directive specifies the framework for an EU-wide valid return and recycling of waste appliances.

Contents

	Page
Intended use	1
Setting programmes	2
After washing	4
Individual settings	5
Important information	6
Overview of programmes	7
Care	8
Information on the display panel	8
Maintenance	9
What to do if ...	10
Safety instructions	11
Consumption values	11

Intended use

- for use in the household only,
- for the washing of machine-washable textiles in a detergent solution,
- to be operated with cold drinking water and commercially available detergents and care products which are suitable for use in frontloading-washing machines.

- Do not leave children unattended near the washing machine!
- The appliance is not intended for use by young children or infirm persons without supervision.
- Keep pets away from the washing machine!

Programmes

For detailed overview of programmes see Page 7.

Temperature and spin speed can be selected individually.

Cotton	hard-wearing textiles
Cotton stains	
Cotton eco	easy-care textiles
Skin care	
Easy-care	delicate washable textiles
Delicate/Silk	
Wool/Woolcare	hand/machine-washable textiles
Drain	the rinsing water if Drain occurs
Spin	washing washed by hand
Gentle spin	washing washed by hand at reduced spin speed
Rinse	with subsequent spin cycle
Sports light	textiles made of microfibres
Express 15	short programme
Mixed load	different types of washing
Dark load	dark textiles

Preparation

Correct installation according to separate installation instructions.

Checking the machine

- Never switch on a damaged machine!
- Inform your customer service!

Turn on the tap

- With dry hands only! Take hold of the plug only!

Insert mains plug

- With dry hands only! Take hold of the plug only!

Sorting and inserting the washing

Follow manufacturer's care information! According to the information on the care labels. According to type; colour; soiling and temperature.



i Dilute viscous fabric softener and fabric conditioner with water. Prevents blockage of the overflow.

- I Prewash: Detergent, starch
- ☞ Care product: Fabric softener
- II Main wash: Detergent, water softener, bleach, stain remover

Add detergent and care product

Meter accordingly: Washing amount, soiling, water hardness (ask your water supply company) and manufacturer's instructions. Pour liquid detergent into the appropriate dispenser and place in the drum.

Set and adjust programme

For additional functions and option buttons see individual settings, page 5.

i All buttons are sensitive, they only need to be touched gently!

Programme selector for switching the machine on and off and for selecting the programme. Can be rotated in either direction.

Select Start/Pause

* depending on model	* – 90	Temp. °C ↓	Select the temperature (* = cold)
	1 – 19h	Ready in ⌚	Programme ends in ...
	▽ – 1200*	rpm ⌚	Select the spin speed (* depending on model) or (without final spin)
	Status displays		Programme progress displays: Washing, Rinse, Spin, End
			☞ ☞ ⌚ –0–

Wash

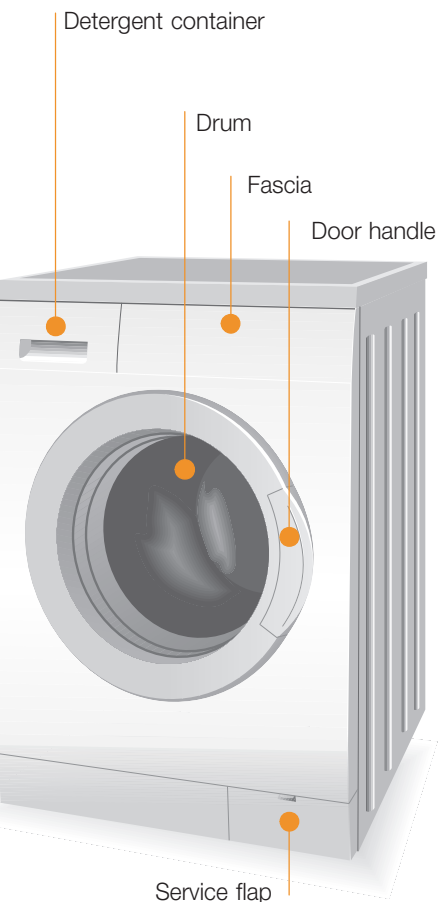

Removing washing

Possible approx. 2 minutes after the programme ends!

- Open washing machine door and remove washing.
- If Drain (without final spin) active: Set programme selector to **Drain** or select spin speed. Select **Start/Pause**.
- Remove any foreign objects – risk of rusting.

Turn off the tap

Switch off

Set programme selector to **Off**.

End of programme when ...

... **Start/Pause** flashes and **-0-** is indicated on the display panel.

Change programme ...

- If you have mistakenly selected a wrong programme:
 - Reselect programme.
 - Select **Start/Pause**.

... or terminate

- Programmes with high temperature, first:
 - Cool washing: Select **Rinse**.
 - Washing machine door remains locked.
 - Select **Off**.
 - Select **Spin** or **Drain**.
 - Select **Start/Pause**.

Individual settings

Option buttons

You can change the spin speed and temperature beforehand and while the selected programme is running. Effects dependent on the programme progress.

Temp. °C ↓

You can change the indicated washing temperature. The maximum washing temperature which can be selected depends on the set programme.

Ready in ⌚

The respective programme duration is displayed by selecting the programme. The programme start can be delayed before the programme begins. The **Ready in** time can be set in hour-steps up to maximum 19h. Keep pressing the **Ready in** button until the required number of hours is indicated (h=hour). Select **Start/Pause**.

rpm ⌚

You can change the indicated spin speed. The maximum spin speed which can be selected depends on the set programme.

Additional functions see also programme overview

Intensive ☞	Extension of the washing time for a more intensive washing of highly soiled washing or 7 kg of cottons and coloureds.
Prewash ↓	For heavily soiled, hard-wearing washing, e.g. made of cotton or linen. Prewash at 30 °C.
Easy iron (depending on model)	Special spin sequence with subsequent fluffing. Gentle final spin – residual moisture in the washing increased slightly.
Rinse plus (depending on model)	Additional rinse cycle. For areas with very soft water or for further improvement of the rinsing result.

Start/Pause

For starting or interrupting the programme.

Signal

1. Start signal mode

2. Set volume for ...

* If required, select repeatedly

Important information

Protecting the washing and the machine

- Empty pockets.
- Remove metal parts (paper clips, etc.).
- Wash delicates in the net/bag (tights, curtains, underwired bras).
- Close zips, button up covers.
- Brush sand out of pockets and collars.
- Remove curtain fittings or include in the net/bag.

Before washing for the first time

Do not put any washing in the washing machine! Turn on the tap, fill the appliance with approx. 1 litre of water and then pour ½ measuring cup of detergent into dispenser II. Set programme selector to **Easy-care 60 °C** and select **Start/Pause**. At the end of the programme set the programme selector to **Off**.

Washing with different degrees of soiling

Light	Do not prewash.
Medium	If required, pretreat stains. Select Intensive additional function.
Heavy	Load less washing. Prewash.

Filling weight

Do not exceed maximum load:

- Cottons and coloureds 7 kg
- Easy-Care 3 kg
- Delicates, silk and woollens 2 kg

Soaking Load washing of the same colour

Pour soaking agent/detergent into dispenser II according to the manufacturer's instructions. Set programme selector to **Cotton 30 °C** and select **Start/Pause**. After approx. 10 minutes select **Start/Pause**. After the required soaking time reselect **Start/Pause** if the programme is to be continued or change the programme.

Starching Washing should not be treated with fabric softener

Dissolve an amount of starch for approx. 15 litres of water according to the manufacturer's instructions. Set programme selector to **Rinse**, set spin speed and select **Start/Pause**. As soon as water runs in: Pour the starch solution into dispenser I.

Dyeing/Bleaching

Do not dye/bleach washing in the washing machine.

Protection of the environment/conservation tips

- Utilise the maximum amount of washing for the particular programme.
- Wash normally soiled washing without prewash.
- Instead of **Cotton 90 °C** select **Cottons eco 60 °C** programme. Comparable cleaning result with significantly lower energy consumption.
- Meter detergent according to the manufacturer's instructions and water hardness.
- If the washing is then dried in the tumble dryer, select spin speed according to the instructions of the dryer manufacturer.

Programmes	°C	max.	Type of washing
Cotton	*-90 °C		
Cotton stains		7- kg	Hard-wearing textiles, heat-resistant textiles made of cotton or linen
Cotton eco	*-60 °C		
Skin care			
Easy-care	*-60 °C		Easy-care textiles made of cotton, linen, synthetic fibres or blended fabrics
Mixed load	*-40 °C	3 kg	Textiles made of cotton and easy-care textiles
Dark load	*-40 °C		Dark textiles made of cotton and dark easy-care textiles
Delicate/Silk	*-30 °C		For delicate, washable textiles, e.g. made of silk, satin, synthetic fibres or blended fabrics (e.g. curtains)
Wool/🐑	*-40 °C	2 kg	Hand or machine-washable wool or rich-wool textiles
Sports light	*-40 °C		Textiles made of microfibres
Express 15	*-30 °C		Easy-care textiles made of cotton, linen, synthetic fibres or blended fabrics
Additional programmes			
<p>Rinse, Spin, Drain, Gentle spin</p> <p>The programmes are time-controlled for lightly soiled textiles. If textiles are heavily soiled, reduce the load or select additional functions, e.g. Intensive. Programmes without prewash – pour detergent into dispenser II, programmes with prewash – divide detergent between dispensers I and II.</p> <p>* Select the Intensive additional function if washing 7 kg of cottons and coloureds.</p> <p>** according to model</p>			

For further information and a selection of our products go to our web site: <http://www.boschappliances.com.au>

WAE22460AU
WAE24460AU
WAE26470AU
9000 117 984

Robert Bosch Hausgeräte GmbH
Carl-Wery-Str. 34
81739 München / Germany

Care



- Risk of electric shock! Pull out the mains plug!
- Risk of explosion! No solvents!

Machine housing, control panel

- Wipe with a soft, damp cloth.
- Do not use abrasive detergents.
- Immediately remove washing and cleaning agent residue.
- Do not clean the appliance with a water jet.

Clean the detergent drawer ...

... if it contains detergent or fabric softener residue.

1. Pull out, depress insert, completely remove.
2. Open the cover.
3. Clean with water and dry.
4. Close and lock the cover (place cylinder on guide pin).
5. Insert detergent drawer.

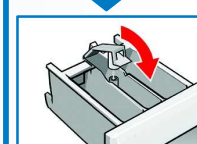
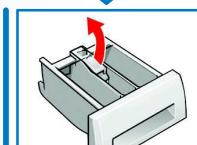
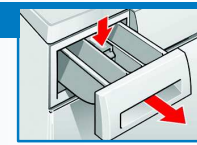

Leave detergent drawer open so that residual water can evaporate.

Drum

Leave washing machine door open so that the drum can dry out.
Rust stains – use chlorine-free cleaning agent, not steel wool.

Descaling *No washing in the machine!*

Descale according to the instructions of the descaling agent-manufacturer, not required for correct detergent dosage.

Information on the display panel *depending on model*

F:16	Close the washing machine door properly; washing may be caught.
F:17	Turn on the tap, supply hose kinked/jammed; clean filter (page 9), water pressure too low.
F:18	Clean detergent-solution pump (page 9), outlet pipe/drainage hose blocked.
F:23	Water in the base pan, appliance leaking. Call customer service!

Maintenance



- Risk of scalding! Allow detergent solution to cool down!
- Turn off the tap!

Detergent-solution pump

Set programme selector to **Off**, pull out the mains plug.

1. Open and remove service flap.
2. For models with drainage hose: Take drainage hose out of the holder and pull out of the housing. Remove sealing cap, allow detergent solution to flow out. Press on sealing cap and insert drainage hose into the holder.
For models without drainage hose: Carefully unscrew pump cover until the detergent solution begins to run out. When the service flap is half full, screw back the pump cover and empty the service flap. Repeat steps until all the detergent solution has run out.
3. Carefully unscrew the pump cover (residual water).
4. Clean the interior, pump cover thread and pump housing (fan impeller in the detergent-solution pump must rotate).
5. Reinsert and screw on pump cover.
6. Insert and close service flap.

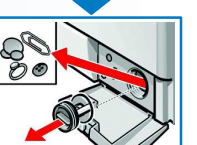
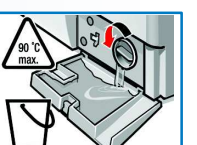
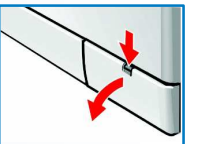

To prevent unused detergent from flowing into the outlet during the next wash: Pour 1 litre of water into dispenser II and select the **Drain** programme.

Filters in the water supply

Release water pressure in the supply hose:

1. Turn off the tap!
2. Select any programme (except **Spin/Drain**).
3. Press **Start/Pause** ⏸. Leave programme for approx. 40 seconds.
4. Set programme selector to **Off**.
5. Remove hose from tap.
6. Clean filter with small brush.
7. Depending on the model, remove hose from the rear of the appliance and clean the filter.
8. Connect the hose and check for leaks.

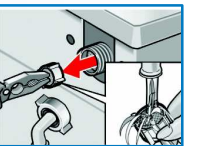

What to do if ...

- Water is running out.
 - Correctly attach/replace drainage hose.
 - Tighten screw-fitting on the supply hose.
- Water not flowing in. Detergent not washed in.
 - **Start/Pause** ⏸ not selected?
 - Tap not open?
 - Filter blocked? Clean filter (page 9).
 - Supply hose kinked or jammed?
 - Safety function active.
 - ⏸ (without final spin) selected?
 - **Start/Pause** ⏸ selected?
 - Door closed?
- Washing machine door cannot be opened.
 - Safety function active.
 - ⏸ (without final spin) selected?
- Programme does not start.
 - **Start/Pause** ⏸ selected?
 - Door closed?
- Detergent solution is not drained.
 - Clean detergent-solution pump (page 9).
 - Clean outlet pipe and/or drainage hose.
- Washing not spun correctly.
 - Distribute small and large items of washing in the drum.
- Spin cycle actuated several times.
 - Not a fault – unbalanced load detection system adjusts imbalance.
- Water not visible in the drum.
 - Not a fault – water below the visible area.
- Residual water in the dispenser for care product.
 - Not a fault – effect of the care product not impaired.
- Odour formation in the washing machine.
 - Run **Cotton 90 °C** programme without washing. Use standard detergent.
- Foam is coming out of the detergent drawer.
 - Too much detergent used? Mix 1 tablespoon of fabric conditioner with ½ litre of water and pour into dispenser II in the detergent drawer.
 - Reduce detergent dosage for the next wash cycle.
- Vibrations during spin cycle.
 - Appliance feet fixed? Secure appliance feet (*Installation instructions*).
 - Transportation safety devices removed? Remove transportation safety devices (*Installation instructions*).
- Spin result not satisfactory.
 - **Easy iron** 🧺 selected (page 5)?
- Display panel/indicator lights do not function while the appliance is running.
 - Power failure?
 - Fuse tripped? Switch on/replace fuse.
 - If the fault occurs repeatedly, call customer service.
- Programme progress longer than usual.
 - Not a fault – unbalanced load detection system adjusts imbalance by repeatedly distributing the washing.
- Detergent residue on the washing.
 - Occasionally phosphate-free detergents contain water-insoluble residue.
 - Select **Rinse** or brush the laundry after washing.
- If a fault cannot be rectified or a repair is required:
 - Set programme selector to **Off** and pull out the mains plug.
 - Turn off the tap and call customer service (*Installation instructions*).

Safety instructions

- Read and follow the operating and installation instructions and all other information enclosed with the washing machine.
- Retain documents for subsequent use.
- Risk of electric shock**
 - Never pull out the mains plug by tugging the power cord!
 - Never insert/pull out the mains plug with damp hands.
- Risk of injury**
 - Washing machine door may become very hot.
 - Caution when draining hot detergent solution.
 - Do not climb on the washing machine.
 - Do not lean on the open washing machine door.
 - Keep detergents and care products out of the reach of children.
- Risk of poisoning**
- Risk of suffocation**
 - Keep packaging, plastic film and packaging parts out of the reach of children.
- Danger to life**
 - On redundant appliances:
 - Pull out the mains plug.
 - Sever the power cord and discard together with the plug.
 - Destroy the lock on the washing machine door. This will prevent children from locking themselves in and suffocating.
 - Caused by detergents containing solvents, e.g. stain remover/items of washing pretreated with solvent naphtha may result in an explosion after being loaded into the washing machine. Beforehand thoroughly rinse items of washing by hand.
- Risk of explosion**

Consumption values

Programme	Additional function	Load	Current *	Water *	Programme duration *
Cotton 40 °C	Intensive ☑	7 kg	0.75 kWh	63 l	2:13 h
Cotton 60 °C	-	7 kg	1.25 kWh	57 l	1:30 h
Cotton eco 60 °C	Intensive ☑	7 kg	1.19 kWh	49 l	2:36 h
Cottons 90 °C	Intensive ☑	7 kg	2.25 kWh	70 l	1:52 h
Easy-care 40 °C	Intensive ☑	3 kg	0.56 kWh	50 l	1:24 h
Easy-care 40 °C	-	3 kg	0.54 kWh	40 l	0:55 h
Mixed load	-	3 kg	0.59 kWh	37 l	0:50 h
Delicate/Silk 30 °C	-	2 kg	0.23 kWh	34 l	0:32 h
Wool/🐑 30 °C	-	2 kg	0.14 kWh	31 l	0:40 h

* The values deviate from the indicated values depending on water pressure, water hardness, water inlet temperature, room temperature, type and amount of washing and degree of soiling, utilised detergent, fluctuations in the mains voltage and selected additional functions.

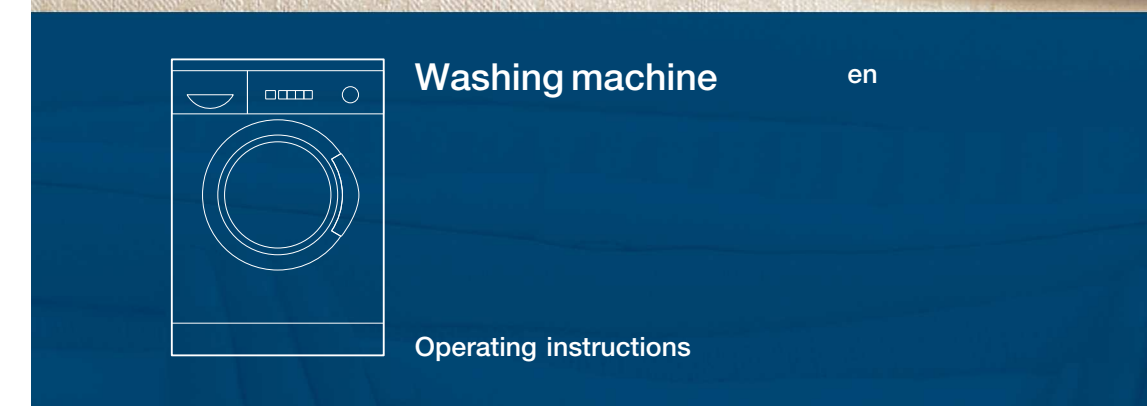

Read these instructions before switching on the washing machine!
Also follow the separate Installation instructions.
Follow the safety instructions on page 11!

Your washing machine

Congratulations – You have opted for a modern, high-quality domestic appliance manufactured by Bosch. The washing machine is distinguished by its economical energy consumption.

Each appliance which leaves our factory is inspected thoroughly to ensure that it functions properly and is in perfect condition.



Environmental disposal

Dispose of packaging in an environmentally friendly manner.

This appliance has been identified in accordance with the European Directive 2002/96/EG on Waste Electrical and Electronic Equipment (WEEE).

The Directive specifies the framework for an EU-wide valid return and recycling of waste appliances.

Contents

Page

Intended use	1
Setting programmes	2
After washing	4
Individual settings	5
Important information	6
Overview of programmes	7
Care	8
Information on the display panel	8
Maintenance	9
What to do if ...	10
Safety instructions	11
Consumption values	11

Intended use

- for use in the household only,
 - for the washing of machine-washable textiles in a detergent solution,
 - to be operated with cold drinking water and commercially available detergents and care products which are suitable for use in frontloading-washing machines.
- ⚠ – Do not leave children unattended near the washing machine!
- The appliance is not intended for use by young children or infirm persons without supervision.
- Keep pets away from the washing machine!

Preparation

⚠ *Correct installation according to separate installation instructions.*

Checking the machine

- Never switch on a damaged machine!
- Inform your customer service!

Turn on the tap

Insert mains plug

⚠ *With dry hands only!
Take hold of the plug only!*



Programmes

For detailed overview of programmes see *Page 7*.
Temperature and spin speed can be selected individually.

Cotton	} hard-wearing textiles
Cotton stains	
Cotton eco	
Skin care	
Easy-care	} easy-care textiles
Delicate/Silk	} delicate washable textiles
Wool/🐑	} hand/machine-washable textiles
Drain	} the rinsing water if ☒ occurs
Spin	} washing washed by hand
Gentle spin	} washing washed by hand at reduced spin speed
Rinse	} with subsequent spin cycle
Sports light	} textiles made of microfibres
Express 15	} short programme
Mixed load	} different types of washing
Dark load	} dark textiles

Additional functions*	Display panel/Option buttons	Start/Pause	Program
Intensive	Temp. °C ↓	Start/Pause	Skin care
Prewash	Ready in		Sports light
Easy iron	rpm		Express 15
Rinse plus			Mixed load
			Drain
			Gentle spin
			Spin
* depending on model	* – 90	Temp. °C ↓	Select the temperature
	1 – 19h	Ready in	Programme ends in ...
	☒ – 1200*	rpm	Select the spin speed (☒ without final spin)
	Status displays		Programme progress
	🧺 🧺 ⏱ –0–		Washing, Rinse, Spin, ...

Before washing for the first time,
wash once without any washing. See page 6

Sorting and inserting the washing

Follow manufacturer's care information!
According to the information on the care labels.
According to type; colour; soiling and temperature.

Follow important instructions! See page 6!

Insert large and small items of washing! Do not jam items of washing between the washing machine door and rubber seal.

Add detergent and care product

Meter accordingly:
Washing amount, soiling, water hardness (ask your water supply company) and manufacturer's instructions. Pour liquid detergent into the appropriate dispenser and place in the drum.

Prewash: Detergent, starch

Care product: Fabric softener

Main wash: Detergent, water softener, bleach, stain remover

Dilute viscous fabric softener and fabric conditioner with water.
Prevents blockage of the overflow.

Set and adjust programme

For additional functions and option buttons see individual settings, page 5.

i All buttons are sensitive, they only need to be touched gently!

Programme selector for switching the machine on and off and for selecting the programme. Can be rotated in either direction.

Select **Start/Pause** ◊

Programme selector

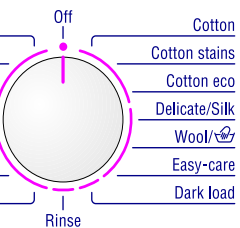

(* = cold)

* depending on model) or

displays:
End

Wash



1

2

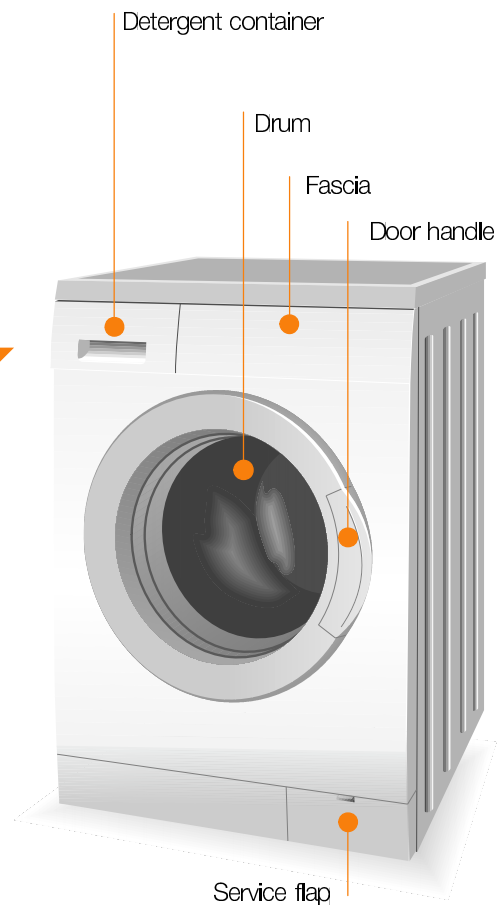

3

Removing washing

Possible approx. 2 minutes after the programme ends!

Open washing machine door and remove washing.
If (without final spin) active: Set programme selector to **Drain** or select spin speed.
Select **Start/Pause** ◊.
Remove any foreign objects – risk of rusting.

Turn off the tap

Switch off

Set programme selector to **Off**.

End of programme when ...

... **Start/Pause** ◊ flashes and **-0-** is indicated on the display panel.

Change programme ...

If you have mistakenly selected a wrong programme:
– Reselect programme.
– Select **Start/Pause** ◊.

... or terminate

Programmes with high temperature, first:
– Cool washing: Select **Rinse**.
Washing machine door remains locked.
– Select **Off**.
– Select **Spin** or **Drain**.
– Select **Start/Pause** ◊.

Wash

Individual settings

Option buttons

You can change the spin speed and temperature beforehand and while the selected programme is running. Effects dependent on the programme progress.

Temp. °C

You can change the indicated washing temperature. The maximum washing temperature which can be selected depends on the set programme.

Ready in

The respective programme duration is displayed by selecting the programme. The programme start can be delayed before the programme begins. The **Ready in** time can be set in hour-steps up to maximum 19h. Keep pressing the **Ready in** button until the required number of hours is indicated (h=hour). Select **Start/Pause**.

rpm

You can change the indicated spin speed. The maximum spin speed which can be selected depends on the set programme.

Additional functions *see also programme overview*

Intensive	Extension of the washing time for a more intensive washing of highly soiled washing or 7 kg of cottons and coloureds.
Prewash	For heavily soiled, hard-wearing washing, e.g. made of cotton or linen. Prewash at 30 °C.
Easy iron (depending on model)	Special spin sequence with subsequent fluffing. Gentle final spin – residual moisture in the washing increased slightly.
Rinse plus (depending on model)	Additional rinse cycle. For areas with very soft water or for further improvement of the rinsing result.

Start/Pause

For starting or interrupting the programme.

Signal

1. Start signal mode

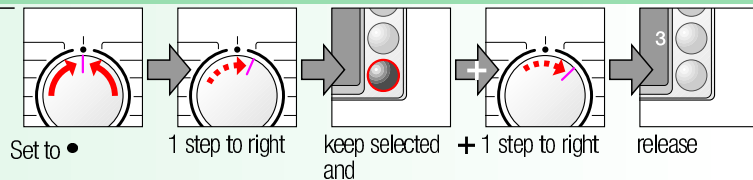

2. Set volume for ...

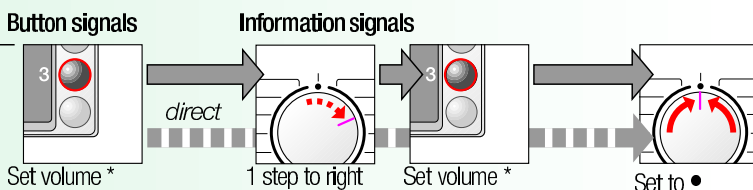

* If required, select repeatedly

* If required, select repeatedly



Important information



Protecting the washing and the machine

- Empty pockets.
- Remove metal parts (paper clips, etc.).
- Wash delicates in the net/bag (tights, curtains, underwired bras).
- Close zips, button up covers.
- Brush sand out of pockets and collars.
- Remove curtain fittings or include in the net/bag.



Before washing for the first time

Do not put any washing in the washing machine! Turn on the tap, fill the appliance with approx. 1 litre of water and then pour ½ measuring cup of detergent into dispenser II. Set programme selector to **Easy-care 60 °C** and select **Start/Pause**. At the end of the programme set the programme selector to **Off**.



Washing with different degrees of soiling

Light	Wash new items separately. Do not prewash. If required, pretreat stains. Select Intensive additional function.
Heavy	Load less washing. Prewash.



Filling weight

Do not exceed maximum load:

- Cottons and coloureds 7 kg
- Easy-Care 3 kg
- Delicates, silk and woollens 2 kg



Soaking *Load washing of the same colour*

Pour soaking agent/detergent into dispenser II according to the manufacturer's instructions. Set programme selector to **Cotton 30 °C** and select **Start/Pause**. After approx. 10 minutes select **Start/Pause**. After the required soaking time reselect **Start/Pause** if the programme is to be continued or change the programme.



Starching *Washing should not be treated with fabric softener*

Dissolve an amount of starch for approx. 15 litres of water according to the manufacturer's instructions. Set programme selector to **Rinse**, set spin speed and select **Start/Pause**. As soon as water runs in: Pour the starch solution into dispenser I.



Dyeing/Bleaching

Do not dye/bleach washing in the washing machine.



Protection of the environment/conservation tips

- Utilise the maximum amount of washing for the particular programme.
- Wash normally soiled washing without prewash.
- Instead of **Cotton 90 °C** select **Cottons eco 60 °C** programme. Comparable cleaning result with significantly lower energy consumption.
- Meter detergent according to the manufacturer's instructions and water hardness.
- If the washing is then dried in the tumble dryer, select spin speed according to the instructions of the dryer manufacturer.



Cotton	☼-90 °C	7* kg	Hard-wearing textiles, heat-resistant textiles made of cotton or linen	Intensive ☼, Prewash ▽, Easy iron ▾, Rinse plus ☼**
Cotton stains				
Cotton eco	☼-60 °C			
Skin care				
Easy-care	☼-60 °C		Easy-care textiles made of cotton, linen, synthetic fibres or blended fabrics	Intensive ☼, Prewash ▽, Easy iron ▾, Rinse plus ☼**
Mixed load	☼-40 °C	3 kg	Textiles made of cotton and easy-care textiles	Intensive ☼, Prewash ▽, Easy iron ▾, Rinse plus ☼** Different types of washing can be washed together
Dark load	☼-40 °C		Dark textiles made of cotton and dark easy-care textiles	Intensive ☼, Prewash ▽, Easy iron ▾, Rinse plus ☼** reduced rinse and final spin cycle
Delicate/Silk	☼-30 °C		For delicate, washable textiles, e.g. made of silk, satin, synthetic fibres or blended fabrics (e.g. curtains)	Intensive ☼, Prewash ▽, Easy iron ▾, Rinse plus ☼** no spin cycle between the rinse cycles
Wool	☼-40 °C	2 kg	Hand or machine-washable wool or rich-wool textiles	also suitable for hand-washable silk; reduced rinse and final spin cycle
Sports light	☼-40 °C		Textiles made of microfibres	Intensive ☼, Prewash ▽, Easy iron ▾, Rinse plus ☼**
Express 15	☼-30 °C		Easy-care textiles made of cotton, linen, synthetic fibres or blended fabrics	Short programme approx. 15 minutes suitable for refreshing

Additional programmes

Rinse, Spin, Drain, Gentle spin

i The programmes are time-controlled for lightly soiled textiles. If textiles are heavily soiled, reduce the load or select additional functions, e.g. Intensive ☼. Programmes without prewash – pour detergent into dispenser **II**, programmes with prewash – divide detergent between dispensers **I** and **II**.

* Select the intensive ☼ additional function if washing 7 kg of cottons and coloureds.

** according to model

For further information and a selection of our products go to our web site:
<http://www.boschappliances.com.au>

WAE22460AU
WAE24460AU
WAE26470AU
0306
9000 117 984

Robert Bosch Hausgeräte GmbH
Carl-Wery-Str. 34
81739 München / Germany

Care



- Risk of electric shock!
Pull out the mains plug!
- Risk of explosion! No solvents!



Machine housing, control panel

- Wipe with a soft, damp cloth.
- Do not use abrasive detergents.
- Immediately remove washing and cleaning agent residue.
- Do not clean the appliance with a water jet.



Clean the detergent drawer ...

... if it contains detergent or fabric softener residue.

1. Pull out, depress insert, completely remove.
2. Open the cover.
3. Clean with water and dry.
4. Close and lock the cover (place cylinder on guide pin).
5. Insert detergent drawer.

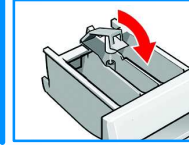
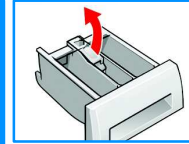
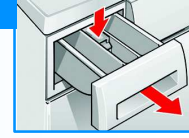

Leave detergent drawer open so that residual water can evaporate.



Drum

Leave washing machine door open so that the drum can dry out.
Rust stains – use chlorine-free cleaning agent, not steel wool.



Descaling *No washing in the machine!*

Descale according to the instructions of the descaling agent-manufacturer, not required for correct detergent dosage.

Information on the display panel depending on model

F:16	Close the washing machine door properly; washing may be caught.
F:17	Turn on the tap, supply hose kinked/jammed; clean filter (page 9), water pressure too low.
F:18	Clean detergent-solution pump (page 9), outlet pipe/drainage hose blocked.
F:23	Water in the base pan, appliance leaking. Call customer service!



- Risk of scalding!
Allow detergent solution to cool down!
- Turn off the tap!

Detergent-solution pump

Set programme selector to **Off**, pull out the mains plug.

1. Open and remove service flap.
2. For models with drainage hose:
Take drainage hose out of the holder and pull out of the housing.
Remove sealing cap, allow detergent solution to flow out.
Press on sealing cap and insert drainage hose into the holder.
- 2* For models without drainage hose:
Carefully unscrew pump cover until the detergent solution begins to run out.
When the service flap is half full, screw back the pump cover and empty the service flap.
Repeat steps until all the detergent solution has run out.
3. Carefully unscrew the pump cover (residual water).
4. Clean the interior, pump cover thread and pump housing (fan impeller in the detergent-solution pump must rotate).
5. Reinsert and screw on pump cover.
6. Insert and close service flap.

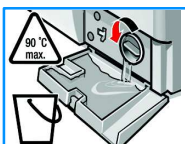
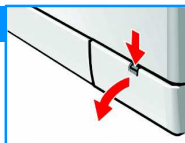

i To prevent unused detergent from flowing into the outlet during the next wash:
Pour 1 litre of water into dispenser II and select the **Drain** programme.

Filters in the water supply

Release water pressure in the supply hose:

1. Turn off the tap!
2. Select any programme (except **Spin/Drain**).
3. Press **Start/Pause** \diamond . Leave programme for approx. 40 seconds.
4. Set programme selector to **Off**.
5. Remove hose from tap.
6. Clean filter with small brush.
7. Depending on the model, remove hose from the rear of the appliance and clean the filter.
8. Connect the hose and check for leaks.

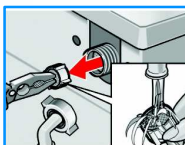

- Water is running out.
 - Correctly attach/replace drainage hose.
 - Tighten screw-fitting on the supply hose.
- Water not flowing in.
Detergent not washed in.
 - **Start/Pause** \diamond not selected?
 - Tap not open?
 - Filter blocked? Clean filter (page 9).
 - Supply hose kinked or jammed?
- Washing machine door cannot be opened.
 - Safety function active.
 - \square (without final spin) selected?
- Programme does not start.
 - **Start/Pause** \diamond selected?
 - Door closed?
- Detergent solution is not drained.
 - Clean detergent-solution pump (page 9).
 - Clean outlet pipe and/or drainage hose.
- Washing not spun correctly.
 - Distribute small and large items of washing in the drum.
- Spin cycle actuated several times.
 - Not a fault – unbalanced load detection system adjusts imbalance.
- Water not visible in the drum.
 - Not a fault – water below the visible area.
- Residual water in the dispenser for care product.
 - Not a fault – effect of the care product not impaired.
- Odour formation in the washing machine.
 - Run **Cotton 90 °C** programme without washing.
Use standard detergent.
- Foam is coming out of the detergent drawer.
 - Too much detergent used?
Mix 1 tablespoon of fabric conditioner with ½ litre of water and pour into dispenser II in the detergent drawer.
 - Reduce detergent dosage for the next wash cycle.
- Vibrations during spin cycle.
 - Appliance feet fixed?
Secure appliance feet (Installation instructions).
 - Transportation safety devices removed?
Remove transportation safety devices (Installation instructions).
- Spin result not satisfactory.
 - **Easy iron** $\underline{\text{a}}$ selected (page 5)?
- Display panel/indicator lights do not function while the appliance is running.
 - Power failure?
 - Fuse tripped? Switch on/replace fuse.
 - If the fault occurs repeatedly, call customer service.
- Programme progress longer than usual.
 - Not a fault – unbalanced load detection system adjusts imbalance by repeatedly distributing the washing.
- Detergent residue on the washing.
 - Occasionally phosphate-free detergents contain water-insoluble residue.
 - Select **Rinse** or brush the laundry after washing.
- If a fault cannot be rectified or a repair is required:
 - Set programme selector to **Off** and pull out the mains plug.
 - Turn off the tap and call customer service (Installation instructions).



Safety instructions

– Read and follow the operating and installation instructions and all other information enclosed with the washing machine.

– Retain documents for subsequent use.

Risk of electric shock

- Never pull out the mains plug by tugging the power cord!
- Never insert/pull out the mains plug with damp hands.

Risk of injury

- Washing machine door may become very hot.
- Caution when draining hot detergent solution.
- Do not climb on the washing machine.
- Do not lean on the open washing machine door.

Risk of poisoning

- Keep detergents and care products out of the reach of children.

Risk of suffocation

- Keep packaging, plastic film and packaging parts out of the reach of children.

Danger to life

On redundant appliances:

- Pull out the mains plug.
- Sever the power cord and discard together with the plug.
- Destroy the lock on the washing machine door. This will prevent children from locking themselves in and suffocating.

Risk of explosion

- Caused by detergents containing solvents, e.g. stain remover/items of washing pretreated with solvent naphtha may result in an explosion after being loaded into the washing machine. Beforehand thoroughly rinse items of washing by hand.

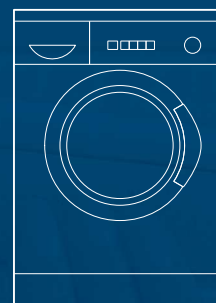

Washing machine

en

Operating instructions



BOSCH

Consumption values

Programme	Additional function	Load	Current *	Water *	Programme duration *
Cotton 40 °C	Intensive	7 kg	0.75 kWh	63 l	2:13 h
Cotton 60 °C	–	7 kg	1.25 kWh	57 l	1:30 h
Cotton eco 60 °C	Intensive	7 kg	1.19 kWh	49 l	2:36 h
Cottons 90 °C	Intensive	7 kg	2.25 kWh	70 l	1:52 h
Easy-care 40 °C	Intensive	3 kg	0.56 kWh	50 l	1:24 h
Easy-care 40 °C	–	3 kg	0.54 kWh	40 l	0:55 h
Mixed load	–	3 kg	0.59 kWh	37 l	0:50 h
Delicate/Silk 30 °C	–	2 kg	0.23 kWh	34 l	0:32 h
Wool/ 30 °C	–	2 kg	0.14 kWh	31 l	0:40 h

* The values deviate from the indicated values depending on water pressure, water hardness, water inlet temperature, room temperature, type and amount of washing and degree of soiling, utilised detergent, fluctuations in the mains voltage and selected additional functions.



Read these instructions before switching on the washing machine!
Also follow the separate Installation instructions.
Follow the safety instructions on page 11!