



Brief and handy:  
everything your dishwasher  
needs ...

**Before using for the first  
time, read the operating  
instructions!**

1

## Adjusting the water softening

Ask your water supply  
company what the  
water hardness is  
and enter ...

\* only **before the first wash**  
or if the **water hardness**  
has been changed

Read off the correct setting for your  
water hardness

°dH	°fH	°Clarke	mmol/l	Set value on the appliance
0-6	0-11	0-8	0-1,1	0
7-16	12-29	9-20	1,2-2,9	1
17-21	30-37	21-26	3,0-3,7	2
22-35	38-62	27-44	3,8-6,2	3





End

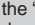

Quickly sorted ...

### How to adjust the water softening system

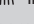
- Rotate the programme button from the 12 o'clock position by one notch to the left.
- Switch on the main switch and hold down for at least 3 seconds. The salt refill indicator  flashes, the "Check water supply" display  and the programme sequence display  light up (factory setting 2).
- Change the set value by rotating the programme selector (0-3).
- Switch off the main switch. The set value is saved.

2

### Filling the salt dispenser

Dissolves limescale (not required for set value 0!)

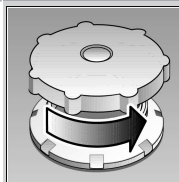

Unscrew  
the lid.

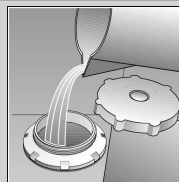

**Only before using  
the dishwasher  
for the first time  
pour approx. 1 l /  
1 1/4 pt water into  
the salt opening.**

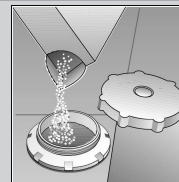

Pour in max.  
1.5 kg / 3 lb 5 oz  
**salt** (never deter-  
gent!)

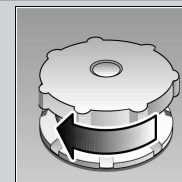

Screw on the  
lid. Switch on  
dishwasher  
immediately.

3

### Adding rinse aid

Everything is sparkling clean ...

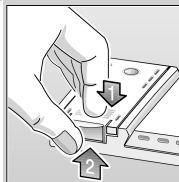

Press mark 1,  
lift up lid 2.



Refill whenever level indicator is light!

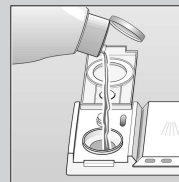

Pour in  
**rinse aid**.

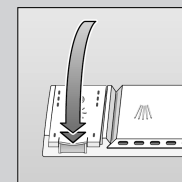

Close the  
lid. **CLICK!**

4

### Adding detergent

Very dirty dishes, a lot of detergent ...

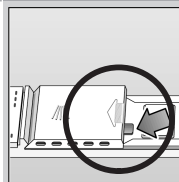

If required, open  
the lid (press the  
pin).



**Warning,**  
combination  
products are not  
suitable for all  
programmes,  
follow manufac-  
turer's instructions.

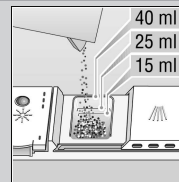

Pour in  
**detergent**.

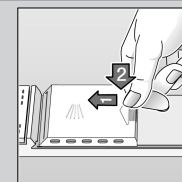

Push the lid  
shut, press.  
**PLOP!**

6







### Select programme

Quick, economical or intensive ...

#### Overview of programmes

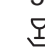
This overview indicates the max. possible number of  
programmes. The programmes which correspond to your  
appliance can be found on your appliance fascia.

The programme data are values measured in the  
laboratory in compliance with Standard EN 50242.  
Deviations in practice are possible.

	Intensive 70° 	Normal 65° 	Eco 50° 	Gentle 40° 	Quick 35° 	Prerinse 
Duration in minutes	115	140	140	75	30	19
Power consumption in kWh	1,70	1,60	1,05	0,90	0,70	0,10
Water consumption in litres	21	19	14	15	10	4

## Additional programmes \*\*

Increased flexibility ...



**Soak**  
...crockery in the lower  
basket, programme  
starts automatically,  
remember to add an  
extra 5g of cleaning  
agent when the door  
unlocks.



**Time reduction/  
time saving**  
...shortens the  
cleaning time, reduces  
the drying.



**Upper basket cleaning**  
...Only the crockery in the  
upper basket is cleaned



**Lower basket cleaning**  
...Only the crockery in the  
lower basket is cleaned

\*\* on some models

5

Turn on tap Water flows in ...



7

Switch on the appliance Here we go ...

Close the door. Press the main switch, programme  
sequence display lights up.

9

Switch off the appliance Everything o.k. ...

When the "end of programme" display lights up, switch  
off the main switch.  
Turn off the tap.

8

Maintenance and care

Filters

Check and, if required, clean:

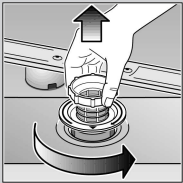

Rotate filter cylinder, remove filter system

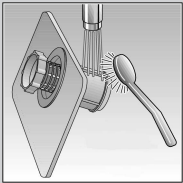

Rinse under running water

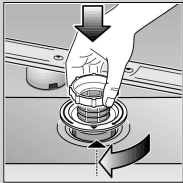

Insert

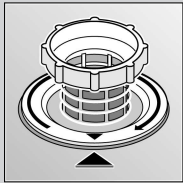

Screw on filter system. NOTE MARK!

Spray arms

Remove blockages/ deposits

Pull up lower arm

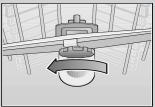
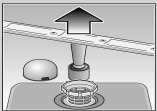

Unscrew upper arm

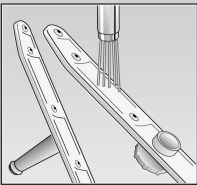

Clean under running water (if required, use a toothpick)

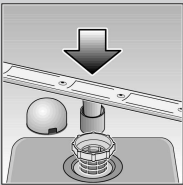

Insert lower arm

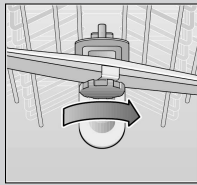

Screw on upper arm

Rectifying minor faults yourself ...

... as it is worth doing it yourself!

Fault	Possible causes	Remedial action
Residual water in the appliance	Waste water pump blocked The programme has not yet ended	<ul style="list-style-type: none"><li>▶ Clean waste-water pump (see above).</li><li>▶ Close the appliance, switch on and wait until the programme ends ("end of programme" display lights up) or terminate programme (see Terminating the programme).</li></ul>
Appliance is not running / stops  Check water supply Display lights up	Supply fitting not open Supply hose kinked Supply fitting jammed or calcified	<ul style="list-style-type: none"><li>▶ Open supply fitting.</li><li>▶ Install supply hose without kinks.</li><li>▶ 1. Unscrew water connection. 2. Clean filter in the water connection. 3. Flow rate must be min. 9 l/min. when water supply is open. If the flow rate is less, replace the supply fitting.</li></ul>
Plastic / utensils discoloured	Too little detergent  Discoloration caused by food colourings (tomato sauce)	<ul style="list-style-type: none"><li>▶ Follow manufacturer's instructions (detergent).</li><li>▶ Discoloration is harmless; subsequent rinse cycles will cause it to fade.</li></ul>

Fault

Possible causes

Remedial action

Utensils are not clean  
Sand or gritty residue on the utensils

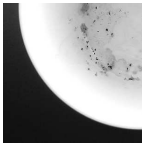

Utensils are situated close together or one above the other  
Too little detergent  
Unsuitable programme selected  
Spray arm nozzles blocked  
Filters dirty, not seated firmly  
Spray arms blocked

- ▶ Separate the utensils, prevent contact points.
- ▶ Follow manufacturer's instructions (detergent).
- ▶ Select a more intensive programme.
- ▶ Clean the spray arms (see above).
- ▶ Clean the filters (see above).
- ▶ Arrange the utensils so that the spray arms can rotate freely.

Stains and streaks

Rinse-aid dosage too high / too low

- ▶ Streaks: reduce dosage.
- ▶ Water or limescale stains: increase dosage.

Milky film on the utensils (removable)

Water softening system incorrectly set;  
No salt

- ▶ Correctly set water softening system.
- ▶ Refill with salt.

Milky film, glasses cloudy / dull (not removable)

Glasses not dishwasher-proof.

- ▶ Use dishwasher-proof glasses.
- ▶ Use a detergent suitable for glasses.

Rust on the cutlery

Cutlery not rust-resistant  
Hard knife blades are more susceptible  
Extraneous rust

- ▶ Use dishwasher-proof cutlery.
- ▶ Never wash rusting parts in the appliance.

More information can be found in the operating instructions

Interrupting the programme...

Terminating the programme ...

- Switch off the main switch.
- To continue, close the door. Switch on the main switch again.

- While the programme is running, rotate the programme selector to the Reset pos.
- The programme sequence lasts approx. 1 min.
- When the programme has run, switch off the main switch.

Loading the dishwasher

Dishwasher-proof utensils (not soiled with ash, wax, lubricating grease, ink or adhesive labels; remove large remnants of jam, milk products and food according to the operating instructions and check that the spray arms can rotate freely).

Waste water pump \*

\* some models

- Set main switch to OFF
- Scoop out any water
- Remove the filters
- Remove the cover (⇒A)
- Check the inner compartment for foreign objects and, if required, remove foreign objects
- Re-insert the cover (⇒B)
- Re-insert the filters and screw into position

