



Brief and handy:  
everything your dishwasher  
needs ...

Before using for the first  
time, read the operating  
instructions!

1

## Adjusting the water softening

Ask your water supply  
company what the  
water hardness is  
and enter ...

\* only before the first wash  
or if the water hardness  
has been changed

Read off the correct setting for your  
water hardness

°dH	°fH	°Clarke	mmol/l	Set value on the appliance
0-6	0-11	0-8	0-1,1	0
7-16	12-29	9-20	1,2-2,9	1
17-21	30-37	21-26	3,0-3,7	2
22-35	38-62	27-44	3,8-6,2	3





End

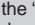

Quickly sorted ...

### How to adjust the water softening system

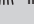
- Rotate the programme button from the 12 o'clock position by one notch to the left.
- Switch on the main switch and hold down for at least 3 seconds. The salt refill indicator  flashes, the "Check water supply" display  and the programme sequence display  light up (factory setting 1).
- Change the set value by rotating the programme selector (0-3).
- Switch off the main switch. The set value is saved.

2

### Filling the salt dispenser

Dissolves limescale (not required for set value 0!)

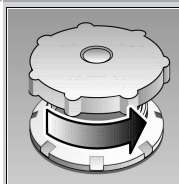

Unscrew  
the lid.

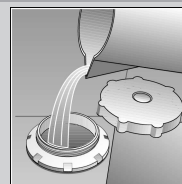

Only before using  
the dishwasher  
for the first time  
pour approx. 1 l /  
2 pt water into the  
salt opening.

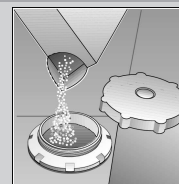

Pour in max.  
1.5 kg / 3 lb 5 oz  
salt (never deter-  
gent!)

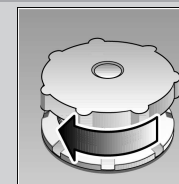

Screw on the  
lid. Switch on  
dishwasher  
immediately.

3

### Adding rinse aid

Everything is sparkling clean ...

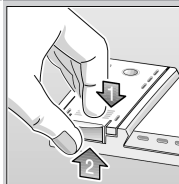

Press mark 1,  
lift up lid 2.



Refill whenever level indicator is light!

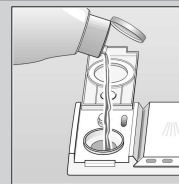

Pour in  
rinse aid.

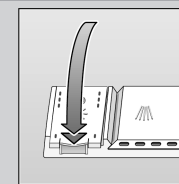

Close the  
lid. CLICK!

4

### Adding detergent

Very dirty dishes, a lot of detergent ...

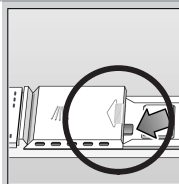

If required, open  
the lid (press the  
pin).

Warning,  
combination  
products are not  
suitable for all  
programmes,  
follow manufac-  
turer's instructions.

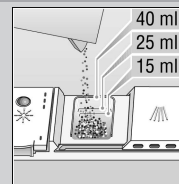

Pour in  
detergent.

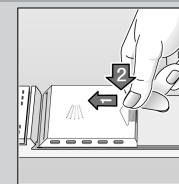

Push the lid  
shut, press.  
PLOP!

5

Turn on tap Water flows in ...

6







### Select programme

Quick, economical or intensive ...

#### Overview of programmes

This overview indicates the max. possible number of  
programmes. The programmes which correspond to your  
appliance can be found on your appliance fascia.

The programme data are values measured in the  
laboratory in compliance with Standard EN 50242.  
Deviations in practice are possible.

	Intensive 70° 	Normal 65° 	Eco 50° 	Gentle 40° 	Quick 35° 	Prerinse 
Duration in minutes	115	140	140	75	30	19
Power consumption in kWh	1,70	1,45	1,05	0,90	0,70	0,10
Water consumption in litres	21	18	16	15	10	4,0

## Additional programmes \*\*

Increased flexibility ...



**Soak**  
...crockery in the lower  
basket, programme  
starts automatically,  
remember to add an  
extra 5g of cleaning  
agent when the door  
unlocks.



**Time reduction/  
time saving**  
...shortens the  
cleaning time, reduces  
the drying.



**Upper basket cleaning**  
...Only the crockery in the  
upper basket is cleaned



**Lower basket cleaning**  
...Only the crockery in the  
lower basket is cleaned

\*\* on some models

7

Switch on the appliance Here we go ...

Close the door. Press the main switch, programme  
sequence display lights up.

9

Switch off the appliance Everything o.k. ...

When the "end of programme" display lights up, switch  
off the main switch.  
Turn off the tap.

8

Maintenance and care

Strainers ...

Check, if required, clean

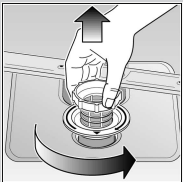

Rotate filter cylinder, remove filter system ...

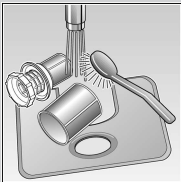

rinse under flowing water ...

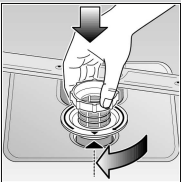

Insert ...

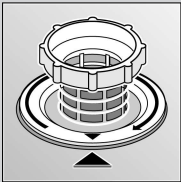

Screw in filter system NOTE MARK!

Cleaning the waste-water pump \*

- \* With some models
- Ladle out water and remove filters
- Unscrew cover (Torx T20)
- Check area of fan impeller for foreign objects
- Screw in cover and insert filters

Spray arms ...

Remove blockages/deposits

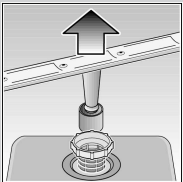

Pull lower arm upwards ...

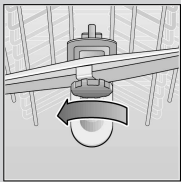

Unscrew upper arm ...

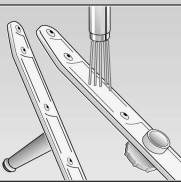

Clean spray nozzles under flowing water (perhaps with toothpick) ...

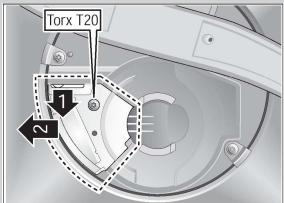
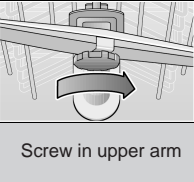
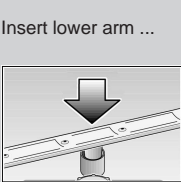

Rectifying minor faults yourself ...

... as it is worth doing it yourself!

Fault	Possible causes	Remedial action	Fault	Possible causes	Remedial action
Residual water in the appliance	Waste water pump blocked The programme has not yet ended	<ul style="list-style-type: none"><li>▶ Clean waste-water pump (see above).</li><li>▶ Close the appliance, switch on and wait until the programme ends ("end of programme" display lights up) or terminate programme (see Terminating the programme).</li></ul>	Utensils are not clean Sand or gritty residue on the utensils	Utensils are situated close together or one above the other Too little detergent Unsuitable programme selected Spray arm nozzles blocked Filters dirty, not seated firmly Spray arms blocked	<ul style="list-style-type: none"><li>▶ Separate the utensils, prevent contact points.</li><li>▶ Follow manufacturer's instructions (detergent).</li><li>▶ Select a more intensive programme.</li><li>▶ Clean the spray arms (see above).</li><li>▶ Clean the filters (see above).</li><li>▶ Arrange the utensils so that the spray arms can rotate freely.</li></ul>
Appliance is not running / stops Check water supply Display lights up	Supply fitting not open Supply hose kinked Supply fitting jammed or calcified	<ul style="list-style-type: none"><li>▶ Open supply fitting.</li><li>▶ Install supply hose without kinks.</li><li>▶ 1. Unscrew water connection. 2. Clean filter in the water connection. 3. Flow rate must be min. 9 l/min. when water supply is open. If the flow rate is less, replace the supply fitting.</li></ul>	Stains and streaks	Rinse-aid dosage too high / too low	<ul style="list-style-type: none"><li>▶ Streaks: reduce dosage.</li><li>▶ Water or limescale stains: increase dosage.</li></ul>
Plastic / utensils discoloured	Too little detergent Discoloration caused by food colourings (tomato sauce)	<ul style="list-style-type: none"><li>▶ Follow manufacturer's instructions (detergent).</li><li>▶ Discoloration is harmless; subsequent rinse cycles will cause it to fade.</li></ul>	Milky film on the utensils (removable)	Water softening system incorrectly set; No salt	<ul style="list-style-type: none"><li>▶ Correctly set water softening system.</li><li>▶ Refill with salt.</li></ul>
			Milky film, glasses cloudy / dull (not removable)	Glasses not dishwasher-proof.	<ul style="list-style-type: none"><li>▶ Use dishwasher-proof glasses.</li><li>▶ Use a detergent suitable for glasses.</li></ul>
			Rust on the cutlery	Cutlery not rust-resistant Hard knife blades are more susceptible Extraneous rust	<ul style="list-style-type: none"><li>▶ Use dishwasher-proof cutlery.</li><li>▶ Never wash rusting parts in the appliance.</li></ul>

More information can be found in the operating instructions

Interrupting the programme...

- Switch off the main switch.
- To continue, close the door. Switch on the main switch again.

Terminating the programme ...

- While the programme is running, rotate the programme selector to the Reset pos.
- The programme sequence lasts approx. 1 min.
- When the programme has run, switch off the main switch.

Loading the dishwasher

Dishwasher-proof utensils (not soiled with ash, wax, lubricating grease, ink or adhesive labels; remove large remnants of jam, milk products and food according to the operating instructions and check that the spray arms can rotate freely.