

TASSIMO

智能胶囊咖啡机
multi-beverage machine

vivy 2



TAS 140xCN

使用说明书

Instruction manual

1

使用产品前请仔细阅读本使用说明书，
并请妥善保管。



BOSCH

5 中文
10 English



安全须知
Safety instructions



产品概览
At a glance



故障排除
Troubleshooting

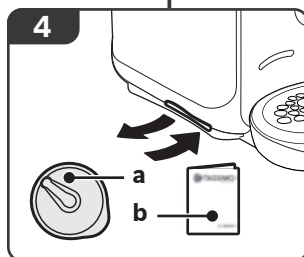
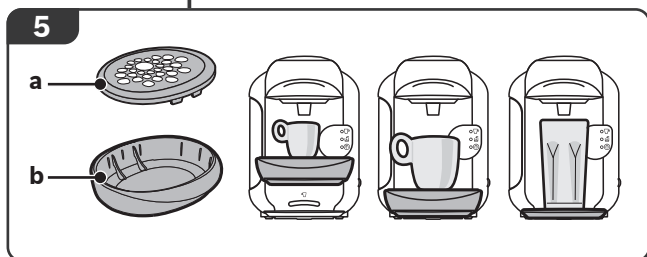
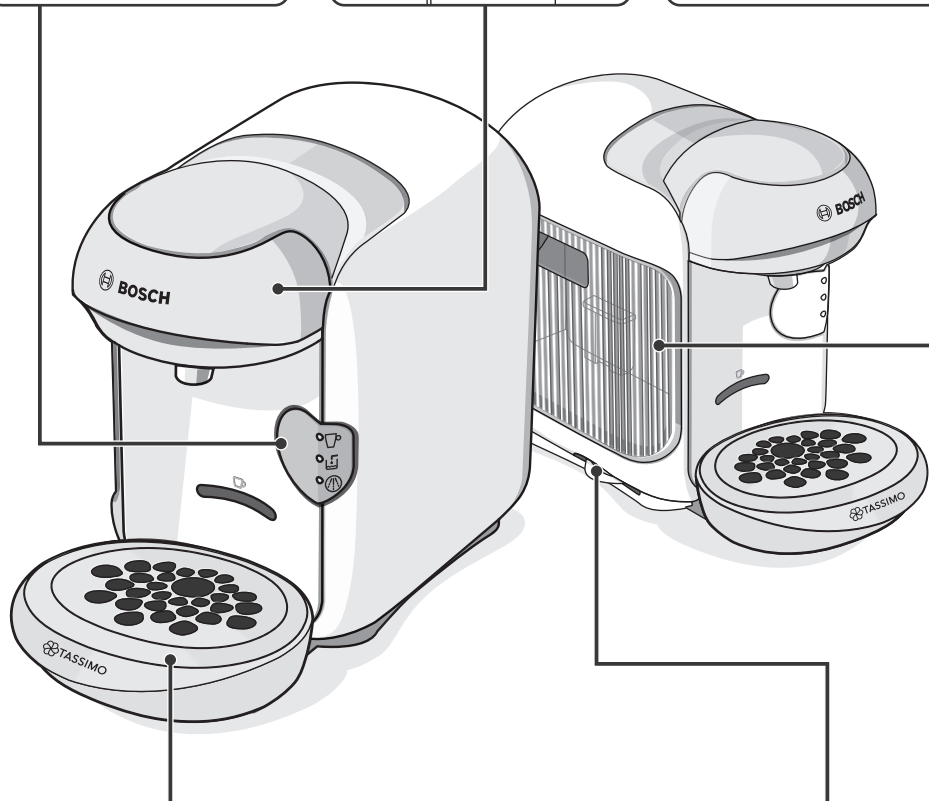
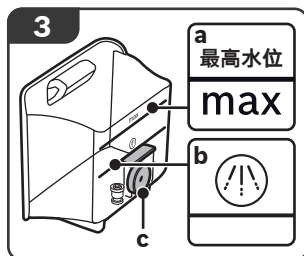
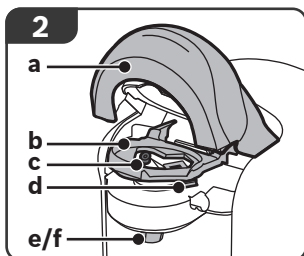
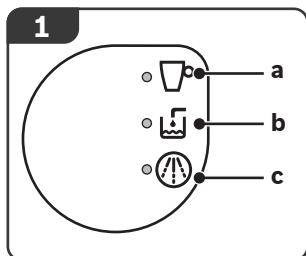



产品不当操作可能导致
电击危险!

Risk of electric shock!



产品不当操作可能导致
灼伤危险!

Risk of burns!



如胶囊破损或已使用,
请勿使用!

Do not use damaged
T DISCS!



请勿清洁、冲洗清洗盘; 若遗
失清洗盘除垢程序将无法
启动!

Do not put the yellow
Service T DISC in the
dishwasher. Do not
throw it away since it
is needed to start the
cleaning programs.

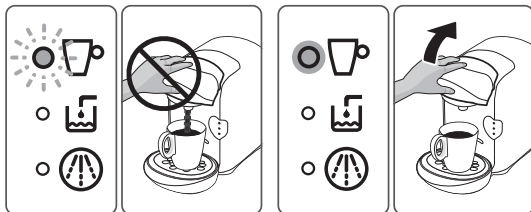



安全须知

按照规程的使用

打开包装后检查电器。出现运输损坏时不得进行连接。

本设备规定只可用于私人家庭和家用环境。

仅限在室温及海拔 2000 米以下的室内使用本机。

重要安全须知

请务必在使用本机前仔细阅读本说明书第 1 部分和第 2 部分,以便采取相应的措施,并妥善保存这两本说明书以便日后参考。请将此说明书提供给所有使用者。

严禁 8 岁以下的儿童操作本机。凡年满 8 岁的儿童,身体、感官或智力有缺陷的人士以及缺乏相关经验和/或知识的人士,应在负责安全使用机器人员的监督或指导下,了解使用机器可能带来的危险后,方能使用本机。严禁儿童将本机用于嬉戏。8 岁以上的儿童除非在监督下,否则不得进行清洁及维护的工作。请确保 8 岁以下的儿童远离本机及其电源线。

本产品仅限使用 40°C 以下的纯净水,严禁使用自来水、矿泉水、地下水!

请勿使用任何化学除垢的水。

请于操作过程中随时监看本机器!

⚠ 产品不当操作可能导致电击危险!

- 仅限按照铭牌上的说明操作和连接本机。
- 本机仅能通过按规定的接地插座与带交流电的供电系统相连接。请您确保,建筑内已按规定安装电气接地系统。
- 对机器进行清洁之前,请先拔出电源插头。
- 只有在电源线或机器未受损的情况下,才可使用您的智能胶囊咖啡机(TASSIMO)。
- 若发生故障,请立即拔出电源插头。
- 机器修理事宜,如更换损坏的电源线,仅由我们的客户服务进行,才能避免危险发生。
- 请勿将机器或电源线浸泡在水中。
- 不得在机器插头连接处溢出任何液体。
- 应遵守说明书中有关清洁的特殊注意事项。

⚠ 产品不当操作可能导致灼伤危险!

- 切勿尝试于机器运行过程中打开萃取单元。请注意,流出的液体非常烫。胶囊(T DISC)、穿孔装置及饮料出口在经过萃取后将变得非常烫。请先让本机冷却。
- 请勿使用受损的胶囊(T DISC)。
- 每个胶囊(T DISC)仅限使用一次。
- 使用过后,电器表面会持续发热一段时间。
- 刚制备好的饮料可能十分烫。如有必要,可以将其稍微冷却。



安全须知

⚠ 火灾危险!

- 本电器会变得很热。
- 切勿在橱柜中操作本电器。

⚠ 受伤危险!

- 不当使用该产品可能会导致受伤。
- 请勿饮用除垢溶液。

⚠ 窒息危险!

- 请勿让儿童用包装材料玩耍。
- 请妥善保管小零件,以避免吞食。

⚠ 注意!



请清洁与食物接触的表面! 请注意图片说明中关于清洁的特别注意事项。



产品概览

在您进一步阅读本说明书之前,请您将本说明书首页往左摊开,即显示相关的图示页。

1 开始/停止键(含指示灯)

- a 工作指示灯 
- b 水箱加水指示灯 
- c 除垢指示灯 

2 萃取单元

- a 胶囊锁定装置
- b 胶囊托架
- c 胶囊穿孔装置
- d 智能扫码区
- e 饮料出口
- f 防溅罩

3 可拆卸式水箱

- a 最高水位线标记 **max**
- b 除垢水位线标记 
- c 水位感应器

4 储藏格

- a 清洗盘
- b 快速指南

5 可调节杯座(也可移除)

- a 接水格栅板
- b 接水盒



废弃物处理

对本设备根据有关电气和电子设备报废的欧洲规定 2012/19/EU (waste electrical and electronic equipment — WEEE)进行标记。该规定管理在欧洲范围内对报废设备的回收和再生。

请咨询专业零售商,了解可用的处置方式。



信息

博世仅为智能胶囊咖啡机(TASSIMO)的制造商。因此,博世对于任何智能胶囊咖啡机(TASSIMO)专用的胶囊(T DISC)不提供送货保证。

您可向专卖店购买智能胶囊咖啡机(TASSIMO)专用的胶囊(T DISC)。

同时,您也可以致电TASSIMO服务热线,了解更多可供选择的热饮以及其他相关信息。



配件

| 配件 | 网店订单号 |
|-------------------------|---|
| 除垢片剂 | TCZ6004 / 00311530 www.bosch-home.cn |
| 清洗盘 (Service T DISC) | 00576836 www.bosch-home.cn |



信息

经销商: 博西家用电器(中国)有限公司

地址: 江苏省南京市中山路129号中南国际大厦20—21层

邮编: 210005

制造商: 博西华电器(江苏)有限公司

地址: 江苏省南京经济技术开发区尧新大道208号

邮编: 210046

执行标准:

GB 4706.1-2005

家用和类似用途电器的安全 第1部分:
通用要求

GB 4706.19-2008

家用和类似用途电器的安全 液体加热器的特殊要求

全国统一客户服务热线:

4008855888

客户服务电子邮箱:

careline.china@bshg.com

公司网站:

www.bosch-home.cn

技术数据:

| | |
|-------------------|-----------------------|
| 电气连接 (电压 - 频率) | 220-240V~ 50/60 Hz |
| 额定功率 | 1300 W |
| 尺寸(高 x 宽 x 深) | 251 x 169 x 310 毫米 |



故障排除

若在使用本机时出现问题或故障,您可在下表中查看相关的解决办法,便可轻松自行解决。若您无法对您的具体问题找到适当的解决办法,请联系我们的客户服务。

更多的客户服务信息敬请拨打TASSIMO服务热线: 400 601 0068 (仅限中国)

| 故障 | 原因 | 解决办法 |
|-------------------------------|-------------------------|---|
| 本机无法进行操作,没有任何指示灯(LED)亮起。 | 本机无电源。 | 检查本机是否已连接到电源。 |
| 已开始萃取,但没有任何饮料流出。 | 水箱未正确插入。 | 检查水箱是否正确插入。 |
| | 在萃取过程中已移除水箱或系统内有空气。 | 请使用清洗盘开始清洁程序,请参见说明书第二部分“ 启用 ”章节中的步骤 I - IV。 |
| | 水箱中的水位感应器卡住。 | 清洁水箱,以便让水位感应器流动。 |
| 无法开始萃取。 | 没有放入任何胶囊(T DISC)。 | 检查是否已放入胶囊(T DISC)。 |
| | 已放入的胶囊(T DISC)条码无法识别。 | 使用柔软的湿布清洁胶囊(T DISC)扫描窗口。 用手指设法抚平胶囊(T DISC)的薄膜,以便让条码可以被读取。 使用一个新的胶囊(T DISC)。 若仍无法解决问题,请联系TASSIMO服务热线。 |
| | 萃取单元未正确锁定。 | 使用柔软的湿布清洁萃取单元,尤其是在锁定装置的区域。 |
| | 放入T-DISC时,本机器未插上电源。 | 请放入一个新的T-DISC,并确保本机器在T-DISC 放入前 已连接了电源。 |
| 萃取单元无法关上。 | 胶囊(T DISC)未正确放入。 | 请勿使用受损的胶囊(T DISC),更换新的一个。将胶囊(T DISC)的条码打印面朝下放置,使碟盖口位在指定的凹槽中。 |
| | 萃取单元未正确锁定。 | 使用柔软的湿布清洁萃取单元,尤其是在锁定装置的区域。 按压胶囊锁定装置,直到可听到卡入的声音。 |
| 萃取单元无法打开。 | 萃取单元仍处于锁定状态。 | 状态指示灯 停止闪烁并保持亮起,才能打开萃取单元。 |
| | | 经上述操作后,若萃取单元仍保持锁定状态,请联系TASSIMO服务热线。 |
| 加注水箱指示灯 亮起。 | 水箱中没有足够的水。 | 请加注干净的冷水至最高水位标记(max)。重新插入水箱。 |
| 尽管水箱有足够的水,但加注水箱指示灯 亮起。 | 水箱中的水位感应器卡住。 | 清洁水箱,以便让水位感应器流动。 |
| | 水箱未正确插入。 | 检查水箱是否正确插入。 |
| 加注水箱指示灯 和除垢指示灯 同时闪烁,无法进行萃取。 | 本机发生技术故障。 | 请联系TASSIMO信息专线。 |
| 除垢指示灯 亮起或闪烁。 | 本机应进行除垢程序。 | 请对本机进行除垢。相关信息请参见说明书第二部分“ 除垢 ”章节。 |
| 尽管已使用经除垢处理的软水,但除垢指示灯 仍亮起或闪烁。 | 即使是经除垢处理的软水多少仍含有少量的石灰质。 | 请对本机进行除垢。相关信息请参见说明书第二部分“ 除垢 ”章节。 |



故障排除

| 故障 | 原因 | 解决办法 |
|--------------|--|--|
| 咖啡脂质量下降。 | 饮料出口卡住或变脏。 | 清洁饮料出口。相关信息请参见说明书第二部分“ 清洁 ”章节。 请使用清洗盘清洁萃取单元, 相关信息请参见说明书第二部分“ 清洁 ”章节。 |
| | 机器结垢。 | 请对本机进行除垢。相关信息请参见说明书第二部分“ 除垢 ”章节。 |
| 水从萃取单元中滴出。 | 胶囊(T DISC)已受损或未密封好。 胶囊(T DISC)未被正确穿孔。 | 请勿使用任何受损的胶囊(T DISC)。每个胶囊(T DISC)仅限使用一次。 请等到萃取过程结束且机器冷却。取出胶囊(T DISC), 并清洁萃取单元。相关信息请参见说明书第二部分“ 清洁 ”章节。 |
| | 胶囊穿孔装置未正确插入。 | 请用双手大拇指将穿孔装置压入其固定单元内(可听到卡入的声音)。 |
| 杯座表面积水。 | 此为冷凝水。 | 冷凝水产生为一正常现象, 并非故障。请用布将水擦干。 |
| 清洗盘已受损或丢失。 | | 胶囊(T DISC)黄色清洗盘可向博世客户服务(产品编号:00576836, 联系方式请参见本说明书的末页)购买。 |
| 饮料份量不符合您的需求。 | 胶囊(T DISC)的条码为每杯饮料提供最佳的饮料份量。此值可以单独调整。 | 降低份量: 在煮过程中按下 开始/停止 键, 中断煮过程。 提高份量: 按住 开始/停止 键不放, 直到达到所需的饮料份量为止。 |
| | 机器产生钙沉积可能导致饮料份量减少。 | 请对本机进行除垢。相关信息请参见说明书第二部分“ 除垢 ”章节。 |



Safety instructions

Intended use

Check the appliance after unpacking it. Do not connect the appliance if it has been damaged in transit.

This appliance is intended for domestic use only.

Only use the appliance indoors at room temperature and up to 2000 m above sea level.

Important safety information

Please read parts 1 and 2 of these manuals carefully before using the product and keep them for future reference.

Pass them on to all users.

Children younger than 8 years may not operate the appliance.

This appliance may be used by children aged 8 years and older and by persons with reduced physical, sensory or mental capabilities or who lack experience and/or knowledge if they are supervised or have been given instruction in the safe use of the appliance and have understood the dangers involved. Children may not play with the appliance. Cleaning and user maintenance may be carried out by children of 8 years and older under supervision. The appliance and its connection cable must be kept away from children younger than 8 years of age.

For optimum results, fill the tank only with cool, fresh, non-carbonated water under 40°C each day. Do not use ground water!

Do not use chemically softened water. Never leave the appliance unattended while it is in operation!

Risk of electric shock!

- Operate and connect the appliance only in accordance with the instructions given on the nameplate.
- The appliance may only be connected to a power supply with alternating current via a correctly installed socket with earthing. Ensure that the protective conductor system of the domestic supply has been correctly installed.
- Before cleaning the appliance, pull out the mains plug.
- Only use your TASSIMO appliance if the power cable and appliance show no signs of damage.
- Disconnect the appliance from the mains as soon as a fault is detected.
- Any repairs, such as replacing a damaged power cable, may only be carried out by our Customer Services team in order to avoid potential danger.



Safety instructions

- Never immerse the appliance or power cable in water.
- Avoid spillage on the connector.
- Please note the special information on cleaning in the instructions.

⚠ Risk of burns!

- Never attempt to open the brewing unit during operation. Please note that any escaping liquids will be very hot. The T DISC, the piercing unit and the beverage outlet may be very hot immediately after brewing. Allow to cool first.
- Do not use T DISCs that are damaged.
- Only use each T DISC once.
- After the use the heating element surfaces can be subjected to residual heat.
- Freshly prepared beverages are very hot. Leave to cool a little if necessary.

⚠ Risk of fire!

- The appliance gets hot.
- Never operate the appliance in a cupboard.

⚠ Risk of injury!

- A misuse of the appliance can potentially lead to injury.
- Under no circumstances you should drink the descaling liquid.

⚠ Risk of suffocation!

- Do not allow children to play with packaging material.
- Store small parts safely as they can be easily swallowed.

⚠ Caution!

- **Cleaning surfaces which come into contact with foodstuffs!** Please note the special information on cleaning in the illustrated instructions.



At a glance

Before reading on, please unfold the illustrations page at the start of the booklet.

1 Start/Stop button with display elements

- a Status LED
- b Fill water tank
- c Descale

2 Brewing unit

- a Lid
- b T DISC support
- c T DISC piercing unit
- d T DISC reading window
- e Beverage outlet
- f Splash guard

3 Removable water tank

- a max mark
- b "Descaling"
- c Float

4 Storage compartment

- a Yellow Service T DISC
- b Brief cleaning/descaling instructions

5 Cup stand

- (removable and height adjustable)
- a Drip grate
 - b Drip tray



Disposal

Dispose of packaging in an environmentally-friendly manner. This appliance is labelled in accordance with European Directive 2012/19/EU concerning used electrical and electronic appliances (waste electrical and electronic equipment – WEEE). The guideline determines the framework for the return and recycling of used appliances as applicable throughout the EU.

Please ask your specialist retailer about current disposal facilities.



Info

Bosch is the manufacturer of the TASSIMO machine. Therefore, it cannot provide any delivery guarantee for the TASSIMO T DISCs.

TASSIMO T DISCs are available from specialist retailers.

Or contact the TASSIMO hotline to discover the large variety of beverages available and for further information.



Accessories

| Accessories | Order number Webshop |
|--------------------------|--|
| Descaling tabs | TCZ6004 / 00311530 www.bosch-home.cn |
| Yellow Service T DISC | 00576836 www.bosch-home.cn |



Info

Exclusive distributor: BSH Home Appliances (China) Co., Ltd.

Address: 20/F,21/F, CN International Mansion,
129 Zhongshan Road, Nanjing,
Jiangsu Province, PRC.

Zip code: 210005

Manufacturer: BSH Electrical Appliances (Jiangsu) Co., Ltd.

Address: No.208 Yaoxin Road, Nanjing Economy and Technology Development Zone(Xingang), Nanjing, Jiangsu Province, China

Zip code: 210046

Applicable standards:

GB 4706.1-2005

Safety of Household and Similar Electrical Appliances Part 1: General Requirements

GB 4706.19-2008

Safety of Household and similar electrical appliances

Particular requirements for for heating liquids

Careline:

4008855888

Service E-mail:

careline.china@bshg.com

Company website:

www.bosch-home.cn



Technical specifications:

| | |
|---|-----------------------|
| Electrical connection (voltage – frequency) | 220-240V~ 50/60 Hz |
| Power rating | 1300 W |
| Dimensions (H x W x D) | 251 x 169 x 310 mm |





Troubleshooting

The following table contains solutions to problems or faults which may occur during operation of the appliance and that can be easily rectified at home. If you are not satisfied with the solutions provided here, please contact our Customer Service department. For further customer service information call the tassimo hotline: 400 601 0068 (China only).

| Problem | Cause | Solution |
|--|---|--|
| The appliance is not working and none of the display elements (LEDs) are lighting. | The appliance has no power supply. | Check to see whether the appliance is connected to the mains. |
| The brewing starts, however there is no beverage dispensed. | The water tank is not inserted correctly. | Check that the water tank is correctly inserted. |
| | The water tank was removed during the brewing stage or there is air in the system. | Start the cleaning process with the yellow Service T DISC. Please refer here to the section First Time Use , Steps I. - IV. |
| | The float in the water tank is stuck. | Clean the water tank and free the float. |
| The brewing will not start. | No T DISC inserted. | Check that a T DISC has been inserted. |
| | The appliance does not recognise the T DISC bar code. | Clean the T DISC reading window with a soft, damp cloth. |
| | | Smooth out the foil of the T DISC with your finger so that the bar code can be read. |
| | | Use a new T DISC. |
| | If the problem persists, contact the TASSIMO careline. | |
| The brewing unit is not closed properly. | Clean the brewing unit with a soft, damp cloth, paying particular attention to the lid area. | |
| The appliance was not plugged in when the T DISC was inserted. | Insert a new T DISC and check that the appliance is plugged into the power supply before inserting the T DISC. | |
| The brewing unit cannot be closed. | The piercing unit and/or the T DISC support have not been correctly inserted. | Press the piercing unit into its holder using both thumbs and check the position of the T DISC support. |
| | The T DISC has not been correctly inserted. | Replace the damaged T DISC with a new one. Place the T DISC with the printed side facing downwards so that the tab is resting in the intended slot. |
| | The brewing unit is not closed properly. | Clean the brewing unit with a soft, damp cloth, paying particular attention to the lid area. |
| Press the lid down until it audibly clicks into place. | | |
| The brewing unit cannot be opened. | The brewing unit is still locked. | Wait until the Status LED  has stopped blinking before attempting to open the brewing unit. |
| | | If the brewing unit stays locked, contact the TASSIMO careline. |
| Fill water tank  lights up. | There is not enough water in the water tank. | Fill the tank with cold, fresh water as far as the max mark. Reinsert the water tank. |

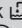
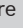
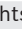

Troubleshooting

| Problem | Cause | Solution |
|--|--|--|
| Fill water tank  lights up even though there is enough water in the water tank. | The float in the water tank is stuck. | Clean the water tank and free the float. |
| | The water tank is not inserted correctly. | Check that the water tank has been correctly inserted. |
| Fill water tank  and Descal  are flashing simultaneously and it is not possible to prepare drinks. | There is a fault on the machine. | Please contact the TASSIMO careline. |
| Descal  lights up or starts flashing. | The appliance needs to be descaled. | Descal the appliance. Please refer here to the section Descaling . |
| Descal  lights up or starts flashing even though decalcified water has been used. | Even decalcified water contains low amounts of calcium carbonate. | Descal the appliance. Please refer here to the section Descaling . |
| The quality of the crema has deteriorated. | The beverage outlet is sticky or dirty. | Clean the beverage outlet. Please refer here to the section Cleaning . Clean the brewing unit with the yellow Service T DISC. Please refer here to the section Cleaning . |
| | Build-up of limescale in the appliance. | Descal the appliance. Please refer here to the section Descaling . |
| Water is dripping from the brewing unit. | The T DISC is damaged or leaky. The T DISC has not been pierced correctly. | Do not use T DISCs that are damaged. Only use each T DISC once. Wait until the brewing stage has come to an end and the appliance has cooled down. Remove the T DISC and clean the brewing unit. Please refer here to the section Cleaning . |
| | The piercing unit has not been inserted correctly. | Press the piercing unit into its holder using both thumbs (until an audible click is heard). |
| On the surface below the cup stand there is water. | This is condensation. | Condensation may appear and is not caused by any fault with the appliance. Wipe the water away with a cloth. |
| The yellow Service T DISC is damaged or lost. | | The yellow Service T DISC can be requested from Bosch Customer Services (item no. 00576836, contact information included at the end of these instructions). |
| The beverage quantity does not meet your requirements. | The T DISC bar code provides the recommended volume for every beverage selected. This volume can also be adapted to personal requirements. | Reduced quantity: During the brewing process, press the Start/Stop button to interrupt this stage. Increased quantity: Press and hold the Start/Stop button until the required beverage quantity has been reached. |
| | Build-up of limescale in the appliance could cause reduced quantity. | Descal the appliance. Please refer here to the section Descaling . |



Customer Service

CN China, 中国
BSH Home Appliances Service Jiangsu Co. Ltd.
20/F, CN International Mansion
No. 129 Zhongshan Road
210005 Nanjing, Jiangsu Province
Service Tel.: 400 885 5888*
Careline Tel.: 800 828 0088*
Fax: 025 8470 1672
mailto:careline.china@bshg.com
www.bosch-home.cn
*phone rate depends on the network used



TASSIMO服务热线

希望了解更多产品信息、咨询相关问题以及离您最近的博世家电授权维修网点地址，请拨打TASSIMO服务热线。
TASSIMO服务热线: 400 601 0068 (仅限中国)

TASSIMO hotline

For information, questions or locations of authorised Bosch service centres nearest you, please contact TASSIMO hotline.
TASSIMO hotline: 400 601 0068 (China only)

制造商: 博西华电器(江苏)有限公司
地址: 江苏省南京经济技术开发区
尧新大道208号
网址: www.bosch-home.cn